

# AED Trainer 3

INSTRUCTIONS FOR USE

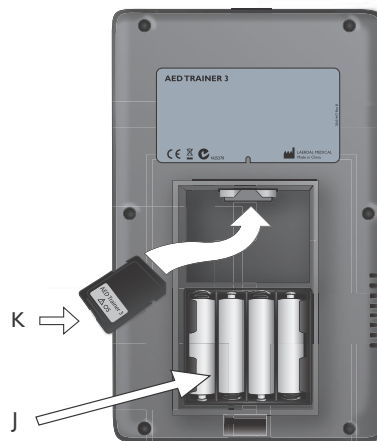

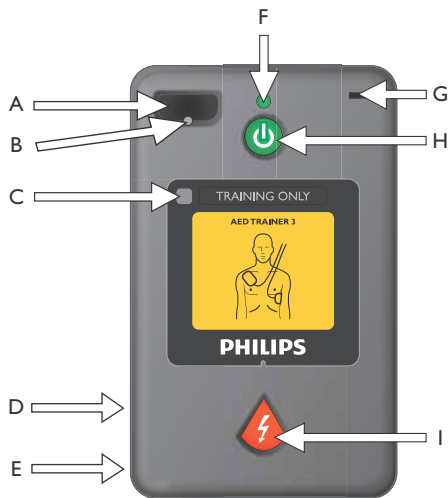

## AED TRAINER 3 USER INTERFACE

**A. Training Pads Connector Socket** — Receptacle for the training pads connector plug.

**B. Pads Connector LED** — Flashes to indicate the socket location when device is turned on. Inserted pads connector plug covers the LED, which stops flashing when connector plug is properly seated.

**C. Remote Control Receiver Window** — Receives signals from the optional remote control.

**D. Speaker** — Delivers voice instructions from the AED Trainer 3. Speaker volume can be adjusted with the remote control or set in the device configuration.

**E. Connector** — For future use.

**F. Green Ready Light** — Illuminates when the AED Trainer 3 is turned on; flashes when device is receiving commands from the remote control; stays off when the device is not in use.

**G. Infant/Child Key Port** — Receptacle for the Training Infant/Child Key. When Key is inserted, the AED Trainer 3 operates in Infant/Child mode to simulate defibrillation of an infant or child under 8 years old or 25 kg (55 lbs).

**H. Green On/Off Button** — Turns on the AED Trainer 3 and starts voice instructions.

**I. Orange Shock Button** — Controls delivery of simulated shock. The button flashes when a shock is advised during a scenario.

**J. Battery Compartment** — Contains the four replaceable AA size alkaline batteries (not provided) used to power the AED Trainer 3.

**K. Operating System Card** — Contains the Trainer operating system, all voice commands, and device configuration. The Operating System Card must be installed in the AED Trainer 3 to use the device.

# AED Trainer 3

861467

INSTRUCTIONS FOR USE

Edition I

PHILIPS MEDICAL SYSTEMS

The Philips logo, consisting of the word "PHILIPS" in a bold, blue, sans-serif typeface.

## About this edition

The information in this guide applies to the AED Trainer 3 model 861467. This information is subject to change. Please contact Philips at [www.philips.com/productdocs](http://www.philips.com/productdocs) or your local Philips representative for information on revisions.

## Edition history

### Edition I

Publication date: April 2011

Publication number: 453564269201

## Copyright

© 2011 Laerdal Medical AS. All Rights Reserved.

## Device Manufacturer

Laerdal Medical AS

Tanke Svilandsgate 30

N-4002 Stavanger, Norway

## For Technical Support

If you need technical support, please contact your local Philips representative or go to [www.philips.com/AEDsupport](http://www.philips.com/AEDsupport).

# CONTENTS

## INTRODUCTION

Description and Intended Use .....	I
Features .....	I

## HOW SUPPLIED

Standard Package Contents .....	2
Optional Accessories .....	3

## SETTING UP THE AED TRAINER 3

Checking the Operating System Card .....	4
Installing the batteries .....	4
Selecting a Language .....	5
Changing the Configuration .....	6
Connecting the Training Pads .....	7
Accessing the Training Infant/Child Key .....	9

## USING THE AED TRAINER 3

Preparing to use the AED Trainer 3 .....	10
Selecting a training scenario .....	11
Running a Training Scenario .....	12
Using the Optional Remote Control .....	12

## APPENDICES

Parameter Settings .....	15
Training Scenarios .....	17
Remote Control .....	19
Troubleshooting Tips .....	21
Specifications .....	23
Regulatory Information .....	24
Glossary of Symbols .....	25

INTENTIONALLY BLANK

## INTRODUCTION

### DESCRIPTION AND INTENDED USE

The model 861467 AED Trainer 3 is designed to prepare emergency responders to use the HeartStart FR3 automatic external defibrillator (AED) and other AEDs. Together with appropriate manikins, the AED Trainer 3 is intended to give realistic training on delivering correct treatment, including shock delivery and CPR, to a cardiac arrest victim.

The AED Trainer 3 provides eight training scenarios that simulate realistic episodes of sudden cardiac arrest (SCA) and help responders become familiar with use of the HeartStart FR3 AED in an emergency. These scenarios are compatible with training programs developed by internationally recognized responder programs.

The AED Trainer 3 is shipped with a factory default setup that complies with the ERC (European Resuscitation Council) and AHA (American Heart Association) 2010 Guidelines. The device may also be configured to conform to local protocols or Guideline Updates.

**NOTE:** Before using the HeartStart FR3 Defibrillator, the responder should have completed an appropriate responder training program, which may include the use of the AED Trainer 3. Having completed such a course, the responder should demonstrate a proficiency in assessing the patient for lack of responsiveness and absence of breathing, cardiopulmonary resuscitation (CPR), and knowledge of applicable medical protocols and procedures.

### FEATURES

The AED Trainer 3 is designed to replicate the operation of the HeartStart FR3 AED. However, it has no high-voltage capabilities, ensuring safety during training. It provides simulated shock delivery.

The AED Trainer 3 can be used to provide training on the following key features of the HeartStart FR3 AED:

- Fast delivery of therapy. The AED Trainer 3 carry case duplicates the auto-on feature of the FR3 carry case. When the case is opened, the AED Trainer 3 automatically turns on.
- Pre-connected pads. Like the FR3 AED, the AED Trainer 3 uses pre-connected pads to help optimize response time.
- Infant/Child Key. The AED Trainer 3 comes with a Training Infant/Child Key to replicate the infant/child mode of the FR3 AED.
- Voice prompts. The AED Trainer 3 guides you through each step of the training scenario with the same voice prompts as the FR3 AED.
- Extensive configurability. Like the FR3 AED, the AED Trainer 3 configuration can be customized and its operation easily updated as needed.

NOTE: The Training Infant/Child Key cannot be used with the HeartStart FR3 AED. An FR3 Infant/Child Key is required for use with the AED.

## HOW SUPPLIED

### STANDARD PACKAGE CONTENTS

The AED Trainer 3 is shipped with the following items as standard:

- one AED Trainer 3
- one Carry Case
- one Training Infant/Child Key, pre-installed on tether in carry case
- one External Manikin Adapter
- one pre-installed AED Trainer 3 Operating System Card containing the AED Trainer 3 operating system
- one reusable HeartStart Training Pads III interconnect cable
- one set of reusable HeartStart Training Pads III



- one printed *Instructions for Use* in English and Japanese
- one CD-ROM containing *Instructions for Use* in additional languages
- one multi-language Quick Start Guide
- one set of “Training Only” stickers in multiple languages



AED Trainer 3

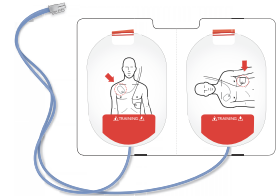

Philips Training Pads III

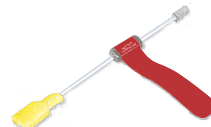

Reusable Training Pads III  
Interconnect cable

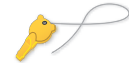

Training infant/child key  
with tether



Operating  
System Card

## OPTIONAL ACCESSORIES

The following accessories are available separately for use with the AED Trainer 3:

- Remote Control, with one replaceable lithium CR2025 3V battery [REF: 989803171631]
- Replacement Carry Case for AED Trainer 3 [REF: 989803171731]
- Replacement AED Trainer 3 Operating System Card [REF: 989803171641]
- Replacement HeartStart Training Pads III Interconnect Cable [REF: 989803150201]
- Replacement HeartStart Training Pads III [REF: 989803150181]
- Replacement External Manikin Adapters, set of 5 [REF: M5089A]
- Laerdal LINK Technology Training Pads [REF: M3755A]



Carry Case

## SETTING UP THE AED TRAINER 3

To set up the AED Trainer 3 for operation, you will need to ensure that the Operating System Card is properly installed, install the batteries (not provided), select a different language if you do not wish to use U.S. English, and connect the training pads. Instructions for each of these tasks follow.

### CHECKING THE OPERATING SYSTEM CARD

The AED Trainer 3 Operating System Card contains the operating system for the AED Trainer 3. The AED Trainer 3 is shipped with the Operating System Card pre-installed. To remove, re-install, or replace the Operating System Card, follow the steps below:

1. Squeeze the latch on the battery compartment lid to release the lid. Lift out the lid and set it aside.
2. Check that the Operating System Card is installed in the slot at the top of the compartment. If not, install the Operating System Card in the orientation shown.



PHILIPS MEDICAL SYSTEMS

### INSTALLING THE BATTERIES

The AED Trainer 3 requires four AA size alkaline batteries (not included). To install or replace the batteries in the AED Trainer 3, follow the steps below:

1. Squeeze the latch on the battery compartment lid to release the lid. Lift out the lid and set it aside.
2. Install four AA size alkaline batteries in the battery compartment oriented as illustrated inside the compartment.

**NOTE:** Use only fresh batteries of the same type.

3. Replace the battery compartment lid.
4. Return the AED Trainer 3 to its case.

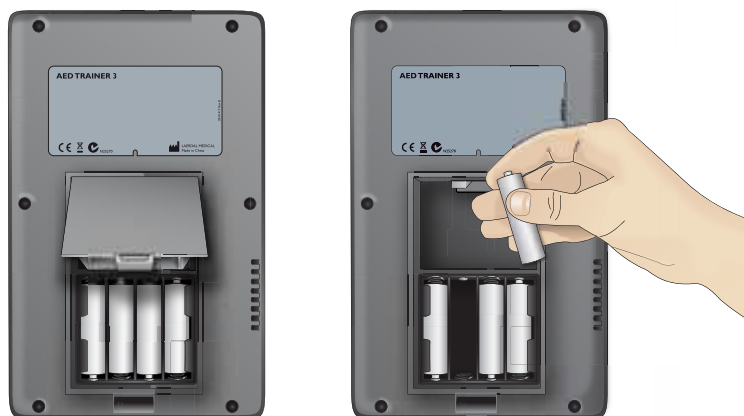

## SELECTING A LANGUAGE

The default language of the AED Trainer 3 is U.S. English. To set up the AED Trainer 3 for another language, follow the steps below.

1. Press and hold *both* the green On/Off button and the orange Shock button for about three seconds. The AED Trainer 3 announces the default language, “U.S. English.”
2. Release both buttons.
3. Press and hold the orange Shock button to scroll through each available language. The AED Trainer 3 announces each new language.
4. When the desired language is announced, press the green On/Off button to turn off the AED Trainer 3 and store the selected language. The AED Trainer 3 will use this language when it is next turned on.\*
5. Apply the appropriate “Training Only” sticker for the language selected, as illustrated below.

\* The AED Trainer 3 can be turned on by pressing either the On/Off button or the shock button.



## CHANGING THE CONFIGURATION

The AED Trainer 3 is shipped with a configuration replicating the default factory settings of the FR3 AED. If you want to change the AED Trainer 3 configuration to match local protocols or for other training purposes, follow the steps below:

1. Squeeze the latch on the battery compartment lid to release the lid. Lift out the lid and set it aside.
2. Remove the Operating System Card from the slot at the top of the compartment.
3. Insert the Operating System Card into the card slot of your computer or, if no slot is available, install the card into a standard card reader and connect it to your computer.
4. Open the AED Trainer 3 Configuration program and adjust the parameter settings as desired. See page 15 for detailed information about the available settings.

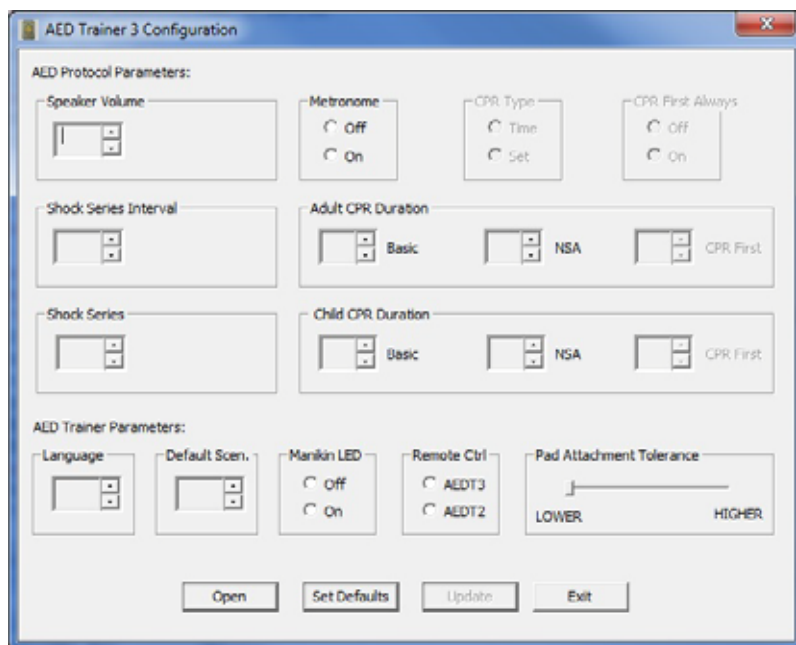

5. After making all desired changes, click on “Update.”
6. Click “Exit” to close the configuration program.
7. Remove the Operating System Card from the computer or card reader and replace it in the AED Trainer 3. See page 4 for directions on installing the card. The AED Trainer 3 configuration will be updated automatically the next time the AED Trainer 3 is turned on.

## CONNECTING THE TRAINING PADS

The AED Trainer 3 may be used with either HeartStart Training Pads III or Laerdal LINK Technology Training Pads.

### HEARTSTART TRAINING PADS III

To connect the HeartStart Training Pads III to the AED Trainer 3, follow the steps below.

1. Remove the HeartStart Training Pads III from their storage bag, leaving them on their liner.
2. Remove the interconnect cable from its storage bag. Connect the pads cable to the interconnect cable.

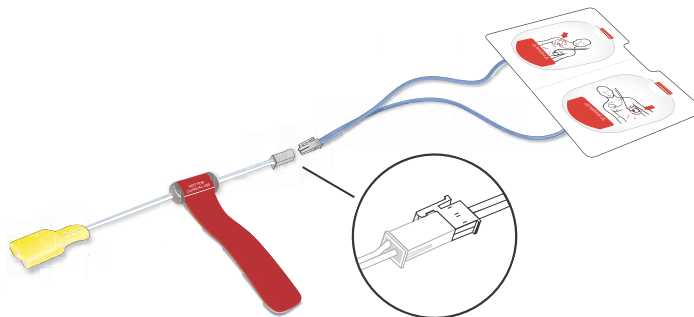

3. Plug the interconnect cable's yellow connector into the pads connector socket on the front of the AED Trainer 3. Be sure the connector clicks into place.
4. Place the AED Trainer 3 with the pre-connected pads in the carry case. The case is designed to store the AED Trainer 3 with the pads pre-connected.

The HeartStart Training Pads III are designed for up to 100 uses. To help ensure continued performance, avoid leaving the pads in heat or direct sunlight. To replace the pads, disconnect the connector plug from the AED Trainer 3 and repeat Steps 1 through 3, above.

### LAERDAL LINK TECHNOLOGY TRAINING PADS

To connect the Laerdal LINK Technology Training Pads to the AED Trainer 3, follow the steps below.

1. Remove the Laerdal LINK Technology Training Pads from their storage bag, leaving them on their liner.

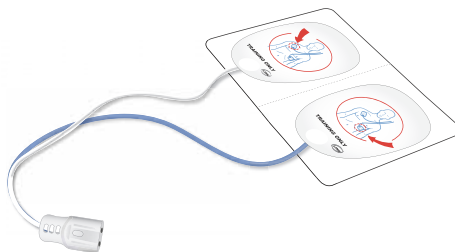

2. Plug the pads connector into the pads connector socket on the front of the AED Trainer 3. Be sure the connector clicks into place.
3. Place the AED Trainer 3 with the pre-connected pads in the carry case. The case is designed to store the AED Trainer 3 with the pads pre-connected.

## ACCESSING THE TRAINING INFANT/CHILD KEY

The Training Infant/Child Key is supplied on a tether pre-installed in the AED Trainer 3 carry case. To access the Training Infant/Child Key for use, remove it from its compartment in the case lid, and extend the tether to insert the Key into the Infant/Child Key port on the AED Trainer 3.

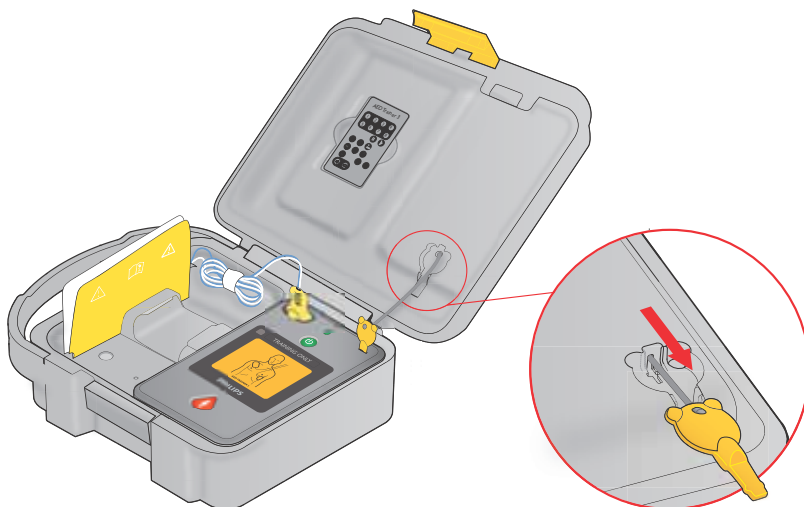

**NOTE:** Do not store the Training Infant/Child Key installed in the AED Trainer 3. Install the Training Infant/Child Key in the AED Trainer 3 only when teaching defibrillation of infants or children under 8 years old or 55 lbs (25 kg).

## USING THE AED TRAINER 3

### PREPARING TO USE THE AED TRAINER 3

Before turning on the AED Trainer 3, follow the steps below:

1. Check that the pads are pre-connected as described on page 7. If no training pads are connected when the AED Trainer 3 is turned on, the AED Trainer 3 will provide a voice instruction to place the pads on the patient's bare chest and then plug in the pads connector by the flashing light.
2. If you are using HeartStart Training Pads III, attach the external manikin adapter provided to the skin of the training manikin as shown below.
3. Place the pads on the adapter as shown.

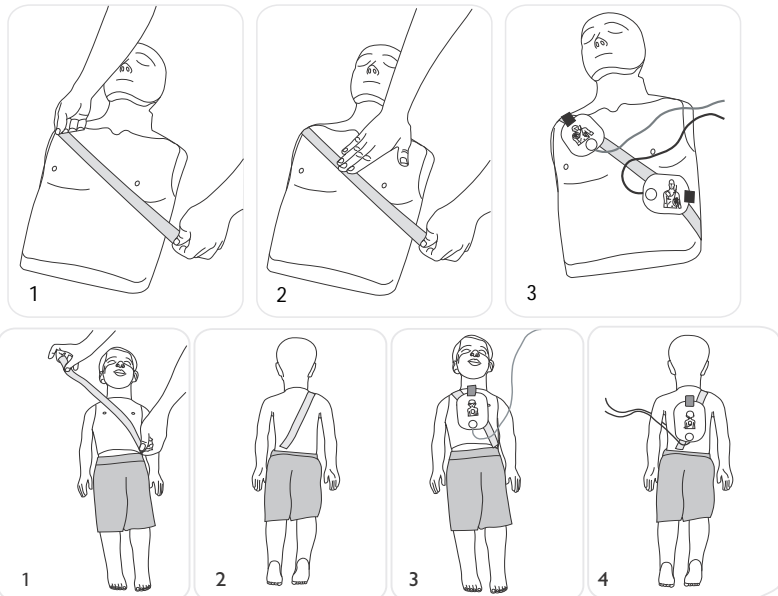



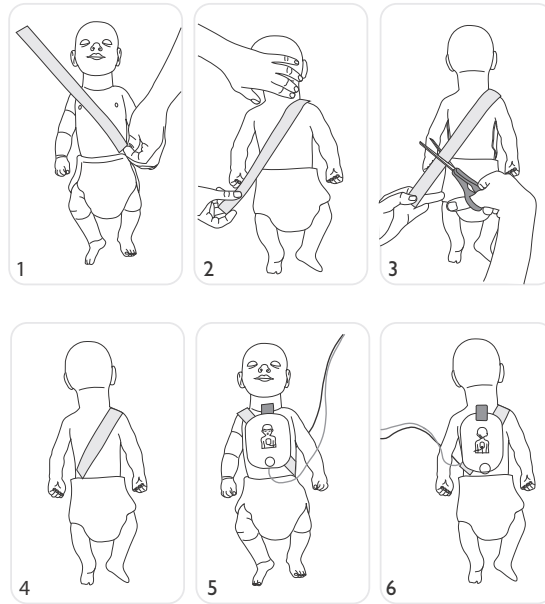

4. If you are using Laerdal LINK Technology Training Pads, use any Laerdal manikin equipped with Laerdal LINK Technology, such as Laerdal AED Resusci Anne or AED Little Anne. (The Laerdal LINK technology will indicate correct placement of the pads on the manikin.)
5. If you are training in infant/child defibrillation, insert the training Infant/Child Key in the port identified on the diagram on the inside front cover of this manual. The infant/child mode is intended for training in defibrillation of an infant or child under 8 years old or 55 lbs (25 kg).\*

## SELECTING A TRAINING SCENARIO

When you are ready to use the AED Trainer 3, follow the steps below:

1. Press and hold the green On/Off button for approximately six seconds. The AED Trainer 3 will announce “Training” and instruct you to press the orange Shock button to select a training scenario.

\* The training Infant/Child Key should be kept with the AED Trainer 3, but not connected until you are ready to use the AED Trainer 3 in a pediatric scenario.

2. Press the orange Shock button as directed. The AED Trainer 3 announces the current training scenario number.
3. To select a different scenario, press and hold the orange Shock button to scroll through each of the eight scenarios in sequence. The AED Trainer 3 announces each scenario number as it is reached. See page 17 for a detailed description of each scenario.
4. When you reach the desired scenario, press the On/Off button to turn off the AED Trainer 3 and store the scenario selection on the Operating System Card. The selected scenario will be active the next time the AED Trainer 3 is turned on.

**NOTE:** The AED Trainer 3 automatically turns off if it is inactive for ten minutes.

## RUNNING A TRAINING SCENARIO

To run a training scenario, press the On/Off button to turn on the AED Trainer 3, and following the AED Trainer 3's voice instructions to simulate use of the FR3 AED in an emergency. For troubleshooting assistance, see page 21.

## USING THE OPTIONAL REMOTE CONTROL

If desired, the AED Trainer 3 can be used with an optional remote control that allows the instructor to select and override training scenarios.

The remote control uses infrared light and requires a direct or indirect light path from the remote control to the receiver window on the AED Trainer 3. *Do not cover the receiver window when using the remote control.* The location of the receiver window is identified on the diagram on the inside front cover of this manual.



**NOTE:** If a direct line is blocked, pointing the remote control at the ceiling may provide a good indirect light path.

See page 19 for a description of the Remote Control operation.

**NOTE:** The AED Trainer 3 can be configured for use with the AED Trainer 2 remote control, if desired. See page 6 for directions on changing the configuration.

## APPENDICES

PARAMETER SETTINGS

TRAINING SCENARIOS

REMOTE CONTROL

TROUBLESHOOTING TIPS

SPECIFICATIONS

REGULATORY INFORMATION

GLOSSARY OF SYMBOLS





## PARAMETER SETTINGS

The following parameter settings are available in the AED Trainer 3. Default settings are shown in **boldface**.



PARAMETER	SETTINGS	DESCRIPTION
Volume	<b>loud</b> , medium, soft	Sets the AED Trainer 3 speaker volume.
Shock Series	<b>1</b> , 2, 3, 4	Sets the number of shocks in a series that must be delivered before the AED Trainer 3 automatically activates a Basic CPR protocol.
Shock Series Interval (minutes)	<b>1.0</b> , 2.0, infinite	Sets the time interval used to determine if a delivered shock should be counted as part of the current shock series. This parameter applies only when the shock series setting is greater than 1.
Metronome	on, <b>off</b>	Enables (ON) and disables (OFF) audio beats for CPR compressions
AED Trainer 2 Remote Control	AEDT2 , <b>AEDT3</b>	Enables or disables use of the AED Trainer 2 Remote Control rather than the AED Trainer 3 Remote Control.
Adult Basic CPR Duration (minutes)	1.0, 1.5, <b>2.0</b> , 2.5, 3.0	Sets the length of the CPR protocol for adult Basic CPR.
Infant/Child Basic CPR Duration (minutes)	1.0, 1.5, <b>2.0</b> , 2.5, 3.0	Sets the length of the CPR protocol for infant/child Basic CPR.





PARAMETER	SETTINGS	DESCRIPTION
Adult NSA CPR Duration (minutes)	1.0, 1.5, <b>2.0</b> , 2.5, 3.0	Sets the length of the CPR protocol for adult Basic CPR.
Infant/Child NSA CPR Duration (minutes)	1.0, 1.5, <b>2.0</b> , 2.5, 3.0	Sets the length of the CPR protocol for infant/child Basic CPR.
Adult CPR First Duration (minutes)		Parameter currently non-functional.
Infant/Child CPR First Duration (minutes)		Parameter currently non-functional.
CPR Type		Parameter currently non-functional
Scenario	<b>1</b> , 2, 3, 4, 5, 6, 7	Sets the training scenario used when the AED Trainer 3 is turned on.
LINK Pads attachment tolerance	Slide Scale: Lower to Higher	Determines the required placement accuracy of training pads on a Laerdal LINK manikin. Lower tolerance equates to a more accurate pad placement requirement.
Manikin LED	<b>on</b> , off	Enables (On) or Disables (Off) the automatic illumination of the electrode pad LEDs in the Manikin Chest Skin indicating correct pad placement. When OFF the LEDs may only be illuminated using the remote control (Please note this function is only applicable when using Laerdal LINK electrodes and a Laerdal Link Manikin.)

# TRAINING SCENARIOS

	Shockable rhythm detected by AED Trainer 3.
	Non-shockable rhythm detected by AED Trainer 3.
	Pads problem detected by AED Trainer 3.
	CPR First protocol initiated by AED Trainer 3.

The following training scenarios are available for use with the AED Trainer 3:









SCENARIO	SYMBOL	DESCRIPTION
1	 One shock for conversion	<ul style="list-style-type: none"><li>• Shockable rhythm</li><li>• One shock needed for conversion</li><li>• Non-shockable rhythm</li></ul>
2	 One shock for conversion	<ul style="list-style-type: none"><li>• Non-shockable rhythm</li><li>• Shockable rhythm</li><li>• One shock needed for conversion</li><li>• Non-shockable rhythm</li></ul>
3	 Troubleshooting pads, one shock for conversion	<ul style="list-style-type: none"><li>• Poor pads contact</li><li>• Shockable rhythm</li><li>• One shock needed for conversion</li><li>• Non-shockable rhythm</li></ul>





SCENARIO	SYMBOL	DESCRIPTION
4	 Refibrillation after conversion	<ul style="list-style-type: none"> <li>• Shockable rhythm</li> <li>• One shock needed for conversion</li> <li>• Non-shockable rhythm</li> <li>• Return to shockable rhythm after three minutes</li> <li>• One shock needed for conversion</li> <li>• Non-shockable rhythm</li> </ul>
5	 Non-shockable rhythm	<ul style="list-style-type: none"> <li>• Non-shockable rhythm throughout</li> </ul>
6	 Two shocks for conversion	<ul style="list-style-type: none"> <li>• Shockable rhythm</li> <li>• Two shocks needed for conversion</li> <li>• Non-shockable rhythm</li> </ul>
7	 CPR first, one shock for conversion	<ul style="list-style-type: none"> <li>• Shockable rhythm</li> <li>• CPR First</li> <li>• Shockable rhythm</li> <li>• One shock needed for conversion</li> <li>• Non-shockable rhythm</li> </ul>
8	 Shockable rhythm	<ul style="list-style-type: none"> <li>• Shockable rhythm throughout</li> </ul>



## REMOTE CONTROL

A description of the button functions of the remote control is provided below.

BUTTON	FUNCTION
	<b>Scenario selection.</b> Press to select one of the eight standard scenarios. (The AED Trainer 3 will start the selected scenario.)
	<b>Pause/Resume.</b> Press Pause to freeze all activity in the AED Trainer 3. (The AED Trainer 3's On/Off light will flash at a slow rate when the AED Trainer 3 is paused.) Press Resume to continue the activity from the point at which it was paused.
	<b>Shockable Rhythm.</b> Press to initiate simulated shockable rhythm. (This function overrides the running scenario.)
	<b>Non-Shockable Rhythm.</b> Press to initiate simulated non-shockable rhythm. (This function overrides the running scenario.)
	<b>CPR First.</b> Press to simulate a shockable rhythm that will generate a CPR First decision by the AED Trainer 3 for the first rhythm analysis, and a shock decision for subsequent rhythm analyses. (This function overrides the running scenario.)
	<b>Good Pads Connection.</b> Press to simulate good pads connection to the AED Trainer 3. (This function overrides the detection of physical pad placement.)
	<b>Poor Pads Connection.</b> Press to simulate poor pads connection to the AED Trainer 3. (This function overrides the detection of physical pads connection.)
	<b>Motion Artifact.</b> Press to simulate motion artifact interference with rhythm analysis. (This function interrupts analysis and the AED Trainer 3 gives a voice prompt instructing the trainee to stop all motion.)

BUTTON	FUNCTION
	<b>Manikin Pads LEDs.</b> Press to illuminate LEDs for pads placement on the manikin chest. (Applicable only when using Laerdal LINK electrodes and a Laerdal LINK manikin.)
	<b>Error Condition.</b> Press to simulate an AED error condition in the AED Trainer 3. (The AED Trainer 3 turns off and chirps every 10 seconds. NOTE: To clear the error condition and turn on the AED Trainer 3 for further use, press the green On/Off button twice.)
	<b>AED Low Battery.</b> Press once to simulate a Low Battery condition in the AED Trainer 3. Press a second time to initiate a Replace Battery prompt.
	<b>Speaker Volume.</b> Press buttons to adjust AED Trainer 3 speaker volume to any of three levels: soft, medium, and high.

## TROUBLESHOOTING TIPS

The following table provides troubleshooting tips for using the AED Trainer 3. If you need additional assistance, please contact your local Philips representative or go to [www.philips.com/AEDsupport](http://www.philips.com/AEDsupport).

ISSUE	POSSIBLE CAUSE	SUGGESTED ACTION
AED Trainer 3 does not work and gives beeping signals when turned on.	<ul style="list-style-type: none"> <li>No Operating System Card is installed.</li> <li>Incorrect card is installed.</li> <li>Operating System Card has corrupt or missing files.</li> </ul>	<ul style="list-style-type: none"> <li>Install the Operating System Card.</li> <li>Install the original Operating System Card.</li> <li>Obtain replacement Operating System Card.</li> </ul>
AED Trainer 3 gives “Analyzing” prompt before pads are applied to manikin.	<ul style="list-style-type: none"> <li>The HeartStart Training Pads II are connected; the AED Trainer 3 senses that pads are in place as soon as the pads connector plug is inserted.</li> </ul>	<ul style="list-style-type: none"> <li>To use HeartStart Training Pads II, apply the pads to the manikin before connecting them to the AED Trainer 3. Alternatively, use HeartStart Training Pads III or the Laerdal LINK system, so that the AED Trainer 3 automatically detects when pads are correctly placed.</li> </ul>
AED Trainer 3 does not respond when pads are applied to manikin.	<ul style="list-style-type: none"> <li>Laerdal LINK Technology Training Pads are incorrectly placed on the Laerdal LINK Technology manikin.</li> </ul>	<ul style="list-style-type: none"> <li>Correct the pads position.</li> </ul>

ISSUE	POSSIBLE CAUSE	SUGGESTED ACTION
AED Trainer 3 battery depletes prematurely.	<ul style="list-style-type: none"> <li>One or more of the batteries is incorrectly oriented.</li> </ul>	<ul style="list-style-type: none"> <li>Reinstall batteries as illustrated inside the battery compartment.</li> </ul>

## SPECIFICATIONS

AED TRAINER 3	
Size	8.6" x 5.2" x 2.2" (218 mm x 133 mm x 57 mm)
Weight (with batteries)	1.3 lb (600 g)
Battery type and quantity	4 AA size alkaline batteries (LR6)
Battery capacity	> 10 hours
Environmental specifications	Operating temperature: 50° - 95° F (10° - 35° C) Storage temperature: 32° - 104° F (0° - 40° C) Relative humidity: 0 - 90% non-condensing
Material	Housing: Acrylonitrile butadiene styrene (ABS) Control buttons: Silicone Foot: Polyurethane (PU)
CARRY CASE	
Size	14.3" x 11.2" x 5.2" (362 x 290 x 132 mm)
Weight	10.5 oz (300 g)
Material	Nylon
REMOTE CONTROL	
Size	3.8" x 2.1" x 0.2" (96 mm x 54 mm x 6 mm)
Battery type	Lithium CR2025 3V
TRAINING INFANT/CHILD KEY	
Size	1.8" x 1.0" x 0.3" (48 x 25 x 7 mm)
Material	Polycarbonate and polybutylene terephthalate (PC + PBT)

## REGULATORY INFORMATION

The product is in compliance with the essential requirements of Directive 2004/108/EC on electromagnetic compatibility through compliance with:





- IEC 61000-6-3 Electromagnetic Compatibility (EMC) - Part 6-3: generic Standards - Emission standard for residential, commercial and light-industrial environments(2006)
- IEC 61000-6-1 Electromagnetic Compatibility (EMC) - Part 6-1: Generic standards - Immunity for residential, commercial and light-industrial environments

The product is in compliance with FCC Part 15 Radio Frequency Devices, Subpart B - Unintentional Radiators (May 2004). This device complies with part 15 of the FCC Rules. Operation is subject to the following two conditions: (1) This device may not cause harmful interference, and (2) this device must accept any interference received, including interference that may cause undesired operation.

This equipment has been tested and found to comply with the limits for a Class B digital device, pursuant to part 15 of the FCC Rules. These limits are designed to provide reasonable protection against harmful interference in a residential installation. This equipment generates, uses, and can radiate radio frequency energy and, if not installed and used in accordance with the instructions, may cause harmful interference to radio communications. However, there is no guarantee that interference will not occur in a particular installation. If this equipment does cause harmful interference to radio or television reception, which can be determined by turning the equipment off and on, the user is encouraged to try to correct the interference by one or more of the following measures:

- Reorient or relocate the receiving antenna.
- Increase the separation between the equipment and receiver.
- Connect the equipment into an outlet on a circuit different from that to which the receiver is connected.
- Consult the dealer or an experienced radio/TV technician for help.

## GLOSSARY OF SYMBOLS

SYMBOL	DEFINITION
	The product is in compliance with the essential requirements of Directive 2004/108/EC on electromagnetic compatibility
	This product does not contain natural rubber latex.
	Australian Communication Authority compliance mark.
	Printed on recycled paper.
	This appliance is marked according to the European directive 2002/96/EC on Waste Electrical and Electronic Equipment (WEEE).

INTENTIONALLY BLANK



INTENTIONALLY BLANK

# PHILIPS

Philips Medical Systems is part of  
Royal Philips Electronics

## **Philips Medical Systems**

### **United States**

Philips Medical Systems  
2301 Fifth Avenue, Suite 200  
Seattle, WA 98121-1825, USA  
(800) 263-3342

### **Canada**

Philips Healthcare, a Division of Philips Electronics Ltd.  
281 Hillmount Road  
Markham, Ontario  
L6C 2S3 Canada  
(800) 291-6743

### **Europe, Middle East, and Africa**

Philips Medizin Systeme Boeblingen GmbH  
Cardiac and Monitoring Systems  
Hewlett-Packard Strasse 2  
71034 Boeblingen, Germany  
(+49) 7031 463-2254

### **Latin America**

Philips Medical Systems Ltda.  
Rua Verbo Divino - 1400 - 7o Andar  
04719-002 -Sao Paulo, Brazil  
0800 7017789

### **Asia Pacific**

Philips Electronics Hong Kong Ltd.  
6/F, Core Building I  
1 Science Park East Avenue  
Hong Kong Science Park  
Shatin, New Territories, Hong Kong  
(852) 2821 5888

