

EasyDiagnost Eleva

Preferred Room Layout

The layout shown below is based upon a typical equipment configuration and should be considered as a general design guideline. Site conditions, application requirements, customer preferences, and/or equipment configuration may significantly impact suite design and equipment layout. It is recommended to request site-specific drawings from a Philips representative early in the design process.

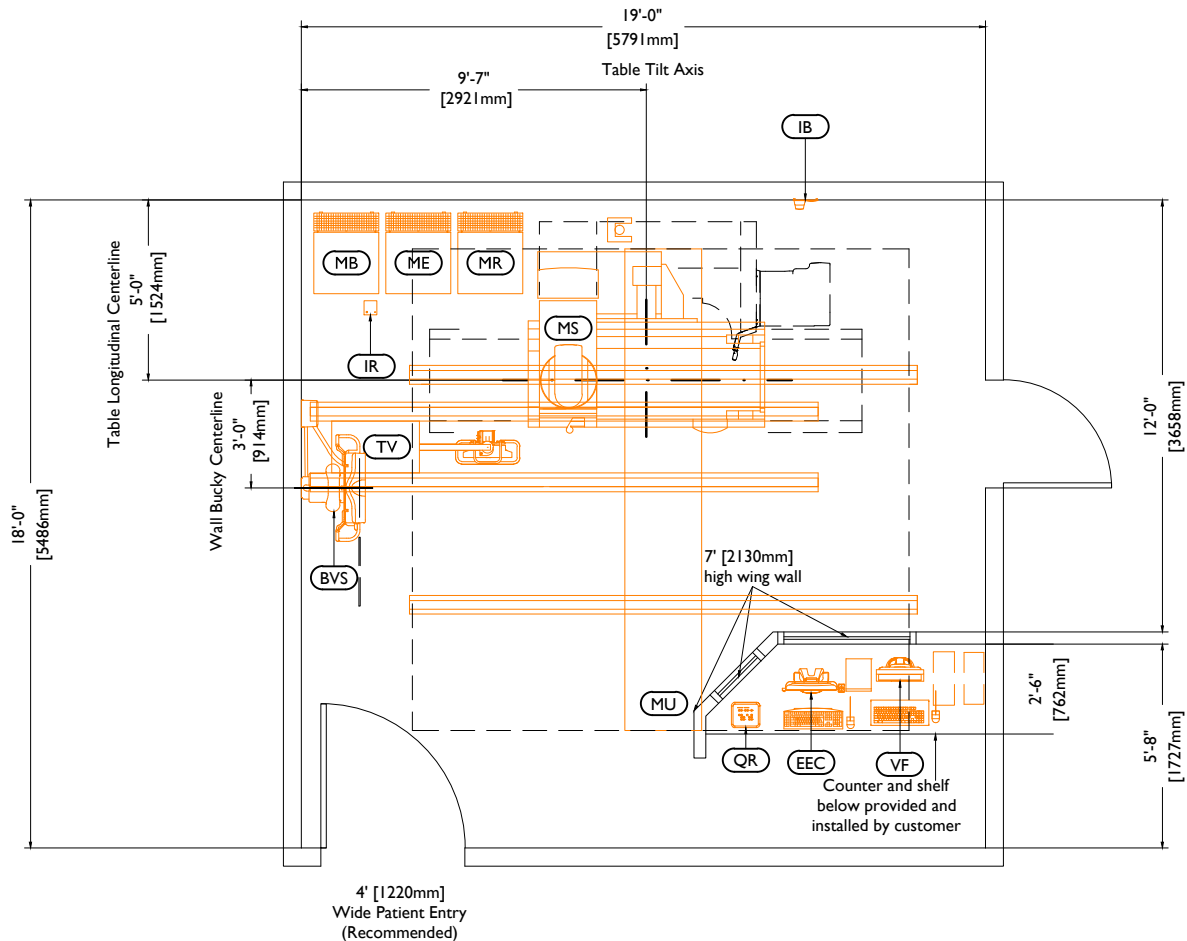

Equipment Layout

Recommended Ceiling Height: 9' - 1" (2770mm) (tube arm up) / 10' - 4" (3150mm) (tube arm down)

Ceiling heights (from top of floorplate to bottom of Unistrut) other than recommended may impact equipment functionality; consult with Philips.

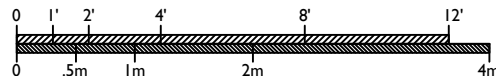

Equipment Legend

- A Furnished and installed by Philips
- B Furnished by customer/contractor and installed by customer/contractor
- C Installed by customer/contractor
- D Furnished by Philips and installed by contractor
- E Existing
- F Future
- G Optional item furnished by Philips

Equipment Designation

		Description	Weight lbs [kg]	Heat Load Btu/hr [W]
A	(MS)	EasyDiagnost Eleva	3044 [1381]	2047 [600]
A	(MU)	CS 4 Tube Crane	922 [418]	1297 [380]
A	(TV)	One LCD Monitor Suspension (Hamburg)	500 [227]	272 [80]
A	(ME)	Velara 80 Generator Cabinet (40E Rack)	521 [237]	1536 [450]
A	(MR)	EasyDiagnost R Rack (40E Rack)	213 [97]	1024 [300]
A	(MB)	Digital Imaging Control Cabinet (40E Rack)	454 [206]	3757 [1101]
A	(VF)	ViewForum Workstation - 18" LCD Monitor - Keyboard & Mouse - APC Smart UPS 1400 (on shelf under counter) - CPU (on shelf under counter)	146 [66]	1000 [293]
A	(BVS)	BuckyDiagnost VS Advanced (Left)	439 [199]	546 [160]
A	(IB)	Indication Box	2 [0.9]	34 [10]
A	(IR)	Infra Red Receiver	1 [0.5]	3 [0.9]
A	(QR)	Quick Review Console	3 [1.4]	7 [2.1]
A	(EEC)	Eleva Examination Control Economy - Eleva Examination Control - Acquisition Workspot (on shelf under counter) - Keyboard and Mouse	51 [23]	635 [186]

Environmental Requirements for General Equipment Locations

Heating, ventilating, air conditioning requirement for general equipment locations must maintain temperature at 75° +/-11° F (24° +/- 6° C) and non-condensing relative humidity at 47% +/- 28%.

Power Requirements

Velara 65/90

Supply Configuration: 3 phase, 3 wire power and ground. Delta or Wye.
3 phase, 4 wire power with neutral and ground. Wye.

Nominal Line Voltage: 400, 440, 460, or 480 VAC, 60 Hz

Branch Power Requirement: 167 kVA

Circuit Breaker to ME (CB1): 3 pole, 100 A (@ 480 V)

Circuit Breaker to MR (CB2): 3 pole, 30 A (@ 480 V)

Remote Service Diagnostics

Medical Imaging equipment to be installed by Philips is equipped with a service diagnostic feature which allows for remote and on-site service diagnostics. To establish this feature, a RJ45 type Ethernet 10/100/1000 Mbit network connector must be installed. Access to customer's network via their remote access server is needed for Remote Service Network (RSN) connectivity. All costs with this feature are the responsibility of the customer.



© Koninklijke Philips Electronics N.V. 2009.
All rights reserved.

Reproduction in whole or in part is
prohibited without prior written consent of
the copyright holder.

Rev. 09.00