

**PHILIPS**

ePaper Display

2000 Series Tableaux

13BDL2250I



# User Manual (English)

[www.philips.com/ppds](http://www.philips.com/ppds)

## Safety Instructions

### Warnings and Precautions

#### KNOW THESE SAFETY SYMBOLS



**CAUTION:** TO REDUCE THE RISK OF ELECTRIC SHOCK, DO NOT REMOVE COVER (OR BACK). NO USER SERVICEABLE PARTS INSIDE. REFER SERVICING TO QUALIFIED SERVICE PERSONNEL.



This symbol indicates high voltage is present inside. It is dangerous to make any kind of contact with any inside part of this product.



The electronic paper screen is composed of plastic film and ultra-thin glass, which is different from the LCD screen normally used. It cannot withstand any external impact, such as single-point or heavy object pressure, which may cause damage or breakage of the screen; please pay special attention to its use. The warranty does not cover screen breakage.



This symbol alerts you that important literature concerning operation and maintenance has been included with this product.

**CAUTION:** FCC/CSA regulations state that any unauthorized changes or modifications to this equipment may void the user's authority to operate it.

**CAUTION:** To prevent electric shock, match the wide blade of plug to the wide slot, and fully insert the plug.

TO PREVENT DAMAGE WHICH MAY RESULT IN FIRE OR ELECTRIC SHOCK HAZARD, DO NOT EXPOSE THIS APPLIANCE TO RAIN OR MOISTURE.

The Socket-outlet should be installed near the apparatus and be easily accessible.



**Read and follow these instructions when connecting and using your ePaper display:**

- Unplug the display if you are not going to use it for an extensive period of time.
- Unplug the display if you need to clean it with a slightly damp cloth. The screen may be wiped with a dry cloth when the power is off. However, never use alcohol, solvents or ammonia-based liquids.
- Consult a service technician if the display does not operate normally when you have followed the instructions in this manual.
- The casing cover should be opened only by qualified service personnel.

- Keep the display out of direct sunlight and away from stoves or any other heat sources.
- Keep the display away from oil, otherwise the plastic cover may be damaged.
- Remove any object that could fall into the vents or prevent proper cooling of the display's electronics.
- Keep the display dry. To avoid electric shock, do not expose it to rain or excessive moisture.
- If turning off the display by detaching the power cable, wait for 6 seconds before re-attaching the power cable for normal operation.
- To avoid the risk of shock or permanent damage to the set do not expose the display to rain or excessive moisture.
- When positioning the display, make sure the power plug and outlet are easily accessible.
- The product only supports the use of LPS-compliant adapters.
- **IMPORTANT:** Always activate a screen saver program during your application. If a still image in high contrast remains on the screen for an extended period of time, it may leave an 'after-image' or 'ghost image' on the front of the screen. This is a well-known phenomenon that is caused by the shortcomings inherent in Microcapsule technology. In most cases the afterimage will disappear gradually over a period of time after the power has been switched off. Be aware that the after-image symptom cannot be repaired and is not covered under warranty.

#### Environmental Condition:

Item		Specifications
Temperature	Operational	0 ~ 40°C
	Storage	-25 ~ 60°C
Humidity	Operational	30 ~ 80% RH (No condensation)
	Storage	5 ~ 95% RH (No condensation)
Altitude	Operational	0 ~ 3,000 m
	Storage / Shipment	0 ~ 9,000 m

- Please confirm that the power distribution system installed in the building provides a circuit breaker for a rated voltage of 120/240V and a maximum of 20A.
- If provided with a 3-pin attachment plug on the power cord, plug the cord into a grounded (earthed) 3-pin outlet. Do not disable the power cord grounding pin, for example, by attaching a 2-pin adapter. The grounding pin is an important safety feature.
- **Stability Hazard.**  
The device may fall, causing serious personal injury or death. To prevent injury, this device must be securely attached to the floor/wall in accordance with the installation instructions.

#### Important Safety Instructions

1. Read these instructions.
2. Keep these instructions.
3. Read all warnings.
4. Follow all instructions.
5. Do not use this apparatus near water.
6. Clean only with dry cloth.
7. Install in accordance with the manufacturer's instructions.

8. Do not install near any heat sources such as radiators, heat registers, stoves, or other apparatus (including amplifiers) that produce heat.
9. Do not defeat the safety purpose of the polarized or grounding-type plug. A polarized plug has two blades with one wider than the other. A grounding type plug has two blades and a third grounding prong. The wide blade or the third prong are provided for your safety. If the provided plug does not fit into your outlet, consult an electrician for replacement of the obsolete outlet.
10. Protect the power cord from being walked on or pinched particularly at plugs, convenience receptacles, and the point where they exit from the apparatus.
11. Only use attachments/accessories specified by the manufacturer.
12. Use only with the cart, stand, tripod, bracket, or table specified by the manufacturer, or sold with the apparatus. When a cart is used, use caution when moving the cart/apparatus combination to avoid injury from tip-over. 
13. Unplug this apparatus during lightning storms or when unused for long periods of time.
14. Refer all servicing to qualified service personnel. Servicing is required when the apparatus has been damaged in any way, such as power-supply cord or plug is damaged, liquid has been spilled or objects have fallen into the apparatus, the apparatus has been exposed to rain or moisture, does not operate normally, or has been dropped.

**WARNING:** TO REDUCE THE RISK OF FIRE OR ELECTRIC SHOCK, DO NOT EXPOSE THIS APPARATUS TO RAIN OR MOISTURE.

**WARNING:** Apparatus shall not be exposed to dripping or splashing and no objects filled with liquids, such as vases, shall be placed on the apparatus.

**WARNING:** The batteries (batteries not included in the package contents) shall not be exposed to excessive heat such as sunshine, fire or the like.

**WARNING:** The mains plug or appliance coupler is used as the disconnect device, the disconnect device shall remain readily operable.

**WARNING:** To prevent the spread of fire, keep candles or other open flames away from this product at all times.



**WARNING:** To prevent injury, this apparatus must be securely attached to the floor/wall in accordance with the installation instructions.

**CAUTION:** These servicing instructions are for use by qualified service personnel only. To reduce the risk of electric shock, do not perform any servicing other than that contained in the operating instructions unless you are qualified to do so.

## Important information

Never place a Display in an unstable location. A Display may fall, causing serious personal injury or death. Many injuries, particularly to children, can be avoided by taking simple precautions such as:

- Using cabinets or stands recommended by the manufacturer of the Display.
- Only using furniture that can safely support the Display.
- Ensuring the Display is not overhanging the edge of the supporting furniture.
- Not placing the Display on tall furniture (for example, cupboards or bookcases) without anchoring both the furniture and the Display to a suitable support.
- Not placing the Display on cloth or other materials that may be located between the Display and supporting furniture.
- Educating children about the dangers of climbing on furniture to reach the Display or its controls.
- Do not place the side Wi-Fi near any metal objects or metal walls. If the side Wi-Fi needs to be placed beside a metal object or metal wall, please keep a distance of at least 1.2 meters. Do not place it in front of any metal object, metal wall or metal desk. If it is placed directly in front of a metal object or against a metal wall, please keep a distance of at least 1.2 meters.

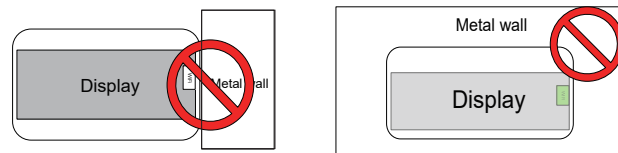

- It is recommended to place the router behind the electronic screen without any metal or solid wall in the middle.
- "Burn-in" may appear if the screen is not refreshed for a long time, and it is recommended to refresh the screen at least once every 48 hours. If the "burn-in" problem occurs, reduce the problem by alternating all black and all white pictures. The number of times alternating black and white pictures required depends on how long the screen has not been refreshed.
- The optical values of EPD will be different in the three temperature ranges of low (15~19°C), middle (20~29°C) and high (30~35°C), resulting in slight discoloration of the displayed color, which belongs to the EPD characteristics with high sensitivity to temperature. It is normal that the temperature change picture will have color differences in a short time, and will not have adverse effects on the functional operation of the whole machine.

Caution: Risk of explosion if battery is replaced by an incorrect type. Dispose of used batteries according to the instructions.

Battery abuse or mishandling can cause overheating, liquid leakage, or an explosion.

To avoid possible injury, follow these instructions:

DO NOT open, disassemble, or service any battery.

DO NOT crush or puncture the battery.

DO NOT short-circuit the battery, or expose it to water or other liquids.

DO NOT dispose of in fire.

Do NOT use another type of battery to replace the batteries.

Do NOT attempt to charge the battery with the device.

Do NOT mix to use the old and new batteries.

Keep away from children.

Batteries are to be inserted with the correct polarity.

Exhausted batteries or not using equipment for a long time, must be removed the batteries from the product.

After replacing the batteries, ensure that the battery compartment cover is locked.

Stop using the battery if it is damaged, or if you notice any discharge or the buildup of foreign materials on the battery leads.

Do not put the battery in trash that is disposed of in landfills. When disposing of the battery, comply with local ordinances or regulations.

## Waste Electrical and Electronic Equipment- WEEE

### Attention users in European Union private households



This marking on the product or on its packaging illustrates that, under European Directive 2012/19/EU governing used electrical and electronic appliances, this product may not be disposed of with normal household waste. You are responsible for disposal of this equipment through a designated waste electrical and electronic equipment collection. To determine the locations for dropping off such waste electrical and electronic, contact your local government office, the waste disposal organization that serves your household or the store at which you purchased the product.

### Attention users in United States:

Please dispose of according to all Local, State and Federal Laws. For the disposal or recycling information, contact: [www.mygreenelectronics.com](http://www.mygreenelectronics.com) or [www.eiae.org](http://www.eiae.org).

### End of Life Directives-Recycling



Your new Public Information Display contains several materials that can be recycled for new users. Please dispose of according to all Local, State, and Federal laws.

## Batteries



For EU: The crossed-out wheeled bin implies that used batteries should not be put to the general household waste! There is a separate collection system for used batteries, to allow proper treatment and recycling in accordance with legislation.

Please contact your local authority for details on the collection and recycling schemes.

For Switzerland: The used battery is to be returned to the selling point.

For other non-EU countries: Please contact your local authority for correct method of disposal of the used battery.

According to EU directive 2006/66/EC, the battery can't be disposed improperly. The battery shall be separated to collect by local service.

---

# Contents

1.	Unpacking and Installation .....	1
1.1.	Unpacking .....	1
1.2.	Package Contents .....	1
1.3.	Installation Notes.....	1
1.4.	Mounting on a Wall .....	1
1.4.1.	Battery installation and removal method (optional)- For service personnel only .....	2
2.	Parts and Functions.....	3
2.1.	Control Panel.....	3
2.2.	Input/Output Terminals.....	4
3.	Cleaning and Troubleshooting .....	5
3.1.	Cleaning.....	5
3.2.	Troubleshooting.....	5
4.	Technical Specifications .....	6

# 1. Unpacking and Installation

## 1.1. Unpacking

- This product is packed in a carton, together with the standard accessories.
- Any other optional accessories will be packed separately.
- After opening the carton, ensure that the contents are complete and in good condition.

## 1.2. Package Contents

Please verify that you received the following items with your package content:

- ePaper Display
- Quick Start guide
- USB C Cable

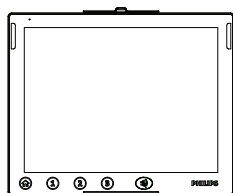

ePaper Display



Quick Start Guide



USB C Cable

- \* Items may differ in different locations
- \* Display design and accessories may differ from the images shown.

### NOTES:

- Keep the packaging materials appropriately after unpacking the product.

## 1.3. Installation Notes

- Only use the power cable provided with this product. If an extension cord is required, please consult your service agent.
- The product should be installed on a flat surface, or the product may tip over. Leave a space between the rear of the product and the wall for proper ventilation. Do not install the product in a kitchen, bathroom or a place exposed to moisture, failure to do so may shorten the life of the internal parts.
- Do not install the product where it is 3,000m and higher in altitude. Failure to do so may result in malfunctions.

## 1.4. Mounting on a Wall

1. Spread the protective film (wrapped around the bedside card) on the table. Put the front side of the bedside card on the protective film to prevent scratches.
2. Prepare all accessories (wall-mount frame x 1, screws x 4, plastic wall anchors x 4).
3. Select the wall (cement) for product installation and ensure the space for installation.
4. Drill holes on the wall (VESA size: 75x75mm) with a concrete drill bit at  $\text{Ø}6\text{--}6.3\text{mm}$  to a depth of 43mm.
5. Hammer the plastic wall anchors in the VESA holes (ensure that the head of plastic wall anchors is on the wall surface).
6. Secure the frame on the wall with the screws (ensure the frame does not move after installation).
7. Install the product on the frame (insert product from top to bottom until you hear a click).
8. Wall-mount interfaces complying with TUV-GS and/or UL1678 are recommended.
9. Device weight = 0.88 kg. During the test, the equipment and related installation tools remain robust. For use with UL-listed wall mount frames with a minimum weight/load of 2.7 kg.

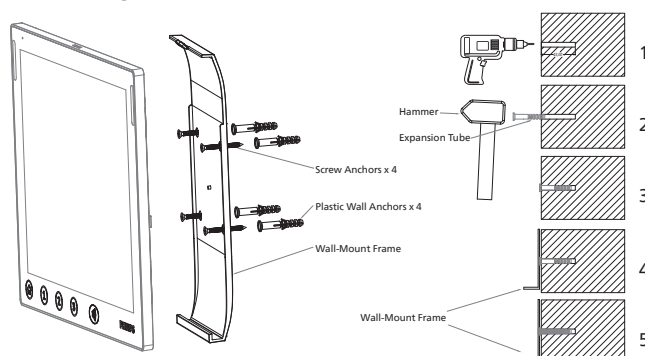

Description

- This only describes the specifications of the wall-mount frame. The case behind is for illustration only.
- The screw hole on the frame at the back of the product is only 15mm deep. Screws longer than this length may cause irrecoverable damage.
- If users cannot ensure product integrity in wall-mount installation, please contact professional workers or technicians.
- This wall-mount frame is suitable for use on concrete walls or brick walls. Special fixing is required when installing on wooden or gypsum panel walls. Do not directly use the wall-mount frame on these walls. Make sure that the load of each installed plastic wall anchor can support one third of the product weight.

1.4.1. Battery installation and removal method (optional)- For service personnel only

1. Dismount product from the wall-mount frame from the top as shown below.
2. Press the battery compartment cover pin to remove the battery compartment cover.
3. Check the battery direction to install or remove the battery.
4. The built-in battery is a rechargeable battery, please charge it strictly according to the battery manual provided by the battery manufacturer.

Manufacturer/ Trademark Model	Type/model	Technical Information
Shenzhen Cholipower Technology Co., LTD	Lithium-ion polymer battery 346388	Capacity: 3000mAh Rated voltage: 3.85V Charging voltage: 4.4V Charging temperature, charging: 0~45°C Discharging temperature: -20~60°C

NOTE:

- Disposal of a battery into fire or a hot oven, or mechanically crushing or cutting of a battery can result in an explosion; leaving a battery in an extremely high temperature surrounding environment can result in an explosion or the leakage of flammable liquid or gas; and a battery subjected to extremely low air pressure may result in an explosion or the leakage of flammable liquid or gas.
- Replacement of a battery with an incorrect type that can defeat a safeguard.
- DO NOT short-circuit the battery, or expose it to water or other liquids.

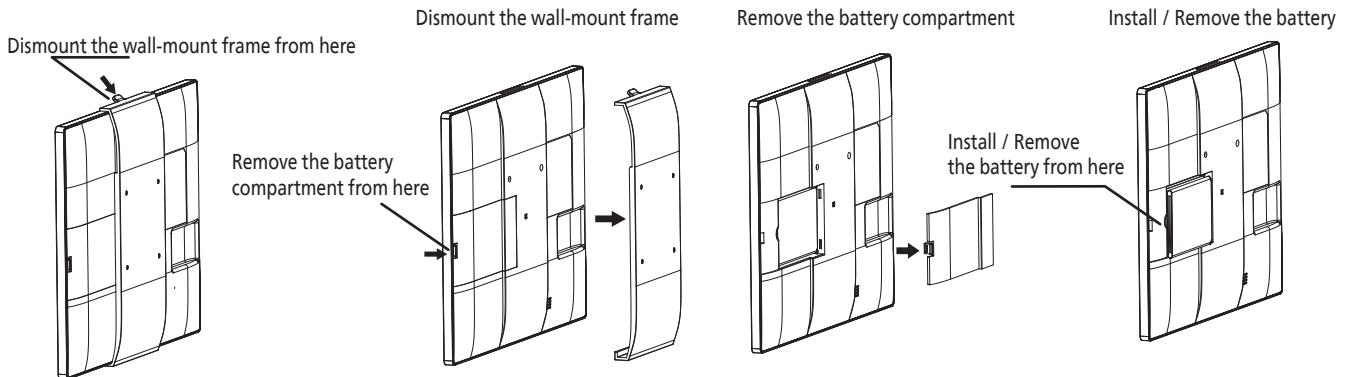

## 2. Parts and Functions

### 2.1. Control Panel

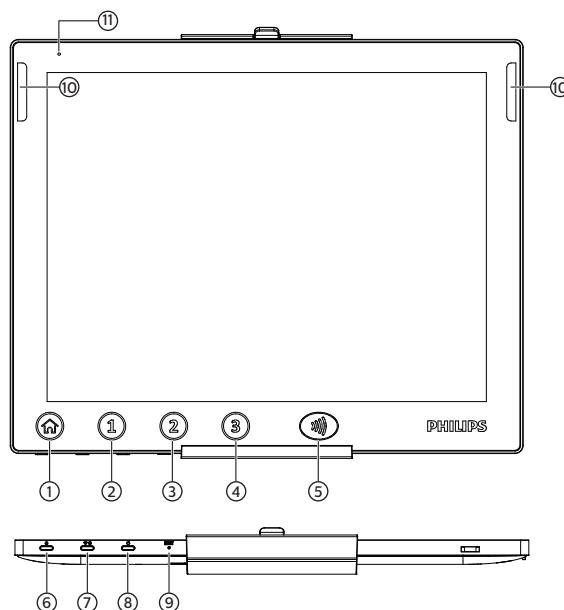

No.	Function
①	User Key
②	User Key
③	User Key
④	User Key
⑤	NFC (Near-field communication), Unlocked by card/function.
⑥	Power Switch: Activate or Standby
⑦	Wi-Fi/Bluetooth Switch
⑧	Message Update
⑨	Machine Reset
⑩	State Indicator
⑪	Power Indicator: Green-power on Red-Mode 1: Light is off: No Battery or Charging is finished Mode 2: Light is on: Charging

## 2.2. Input/Output Terminals

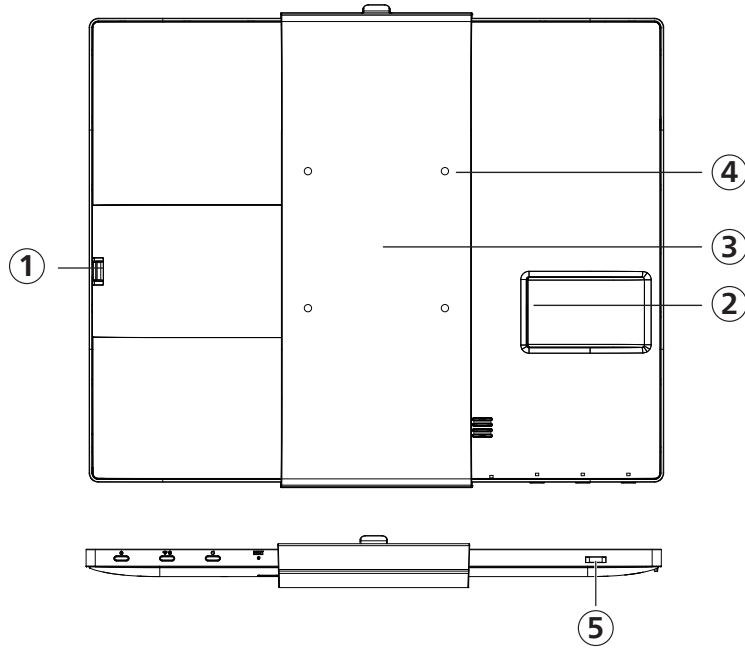

No.	Function
①	Battery (optional)
②	USB-C power input (5V)
③	HIPAA privacy rules
④	VESA Mounting Standard
⑤	Anti theft hole

**NOTE:**

- The rear view is for reference only. Please subject to the actual product.

## 3. Cleaning and Troubleshooting

### 3.1. Cleaning

#### Caution When Using the Display

- Be sure to disconnect all cables before moving the monitor. Moving the monitor with its cables attached may damage the cables and thus cause fire or electric shock.
- Disconnect the power plug from the wall outlet as a safety precaution before carrying out any type of cleaning or maintenance procedure.

#### Front Panel Cleaning Instructions

- The front of the display has been specially treated. Wipe the surface gently using only a cleaning cloth or a soft, lint-free cloth.
- If the surface becomes dirty, soak a soft, lint-free cloth in a mild detergent solution. Wring the cloth to remove excess liquid. Wipe the surface of the display to remove dirt. Then use a dry cloth of the same type to dry.
- Do not scratch or hit the surface of the panel with fingers or hard objects of any kind.
- Do not use volatile substances such as insect sprays, solvents and thinners.

#### Cabinet Cleaning Instructions

- If the cabinet becomes dirty, wipe the cabinet with a soft, dry cloth.
- If the cabinet is extremely dirty, soak a lint-free cloth in a mild detergent solution. Wring the cloth to remove as much moisture as possible. Wipe the cabinet. Use another dry cloth to wipe over until the surface is dry.
- Do not use solution that contains oil to clean the plastic parts. Such product damage the plastic parts and void the warranty.
- Do not allow any water or detergent to come into contact with the surface of the display. If water or moisture gets inside the unit, operating problems, electrical and shock hazards may result.
- Do not scratch or hit the cabinet with fingers or hard objects of any kind.
- Do not use volatile substances such as insect sprays, solvents and thinners on the cabinet.
- Do not place anything made from rubber or PVC near the cabinet for any extended periods of time.

### 3.2. Troubleshooting

Before calling for service, please check if the trouble can be resolved according to the table below.

If the trouble cannot be resolved after trying all instructions in this guide, please call for service.

Phenomenon	Troubleshooting
Image interference	<ul style="list-style-type: none"> <li>• Find the appliance that may affect the product and relocate it away from the product.</li> </ul>

#### Disclaimer

- Pictures and descriptions contained in this manual are for reference only and may be different from the actual product. Please refer to the actual product. (This disclaimer applies to all parts of this manual.)
- Specifications are subject to change without prior notice.
- The software content service of this project is subject to the software contractor. Part of the software may not be used due to network, regional, and service cycle problems and is irrelevant to product quality. Please contact your suppliers for detail.

## 4. Technical Specifications

### Display

Item	Specifications
Screen Size (Active Area)	337.82 mm / 13.3 inches
Aspect Ratio	4:3
Number of pixels	1600 (H) x 1200 (V)
Pixel pitch	0.169 (H) x 0.169 (V) [mm]
Displayable colors	Black/White/Red/Yellow/Blue/Green colors

### In/Out Terminals:

Item	Specifications
USB input/output	USB Type C

### General:

Item	Specifications
Power Input	5V $\equiv$ 2A
Power Consumption (Typ.)	7 W (Average during picture update only)
Power Consumption (Standby & Off)	<3.5 W
Dimensions (Without Stand) [W x H x D]	314.6 x 264.4 x 28.4 mm
Weight	0.85 kg

### Environmental Condition:

Item		Specifications
Temperature	Operational	0 ~ 40°C
	Storage	-25 ~ 60°C
Humidity	Operational	30 ~ 80% RH (No condensation)
	Storage	5 ~ 95% RH (No condensation)
Altitude	Operational	0 ~ 3,000 m
	Storage / Shipment	0 ~ 9,000 m

## Warranty policy for Philips Professional Display Solutions

Thank you for purchasing this Philips product. Philips products are designed and manufactured with high standards and deliver high quality performance, ease of use and ease of installation. If you encounter any difficulties while using your product, we recommend that you first consult the user manual or the information in the support section of the website, where (depending on the product type) you may find a downloadable user manual, frequently asked questions, instruction videos or a support forum.

### LIMITED WARRANTY

In the unlikely event the product requires service, we will arrange for your Philips product to be serviced free-of-charge within the warranty period, provided that the product was used in accordance with the user manual (e.g. in the intended environment).

For these product categories, a partner company of Philips is the warrantor of the product. Please check the documentation supplied with your product.

### WHO IS COVERED?

Your Warranty coverage begins from the first date of purchase of the product. You need to provide proof of purchase to receive warranty service. A valid sales receipt or other valid document showing that you purchased the product is considered proof of purchase.

### WHAT IS COVERED?

If any defect due to faulty materials and/or workmanship occurs within the warranty period, we will make arrangements for a free of charge service. Where a repair is not possible or not commercially viable, we may replace the product with a new or equivalent refurbished product with similar functionality. Replacement will be offered at our discretion and the warranty will continue from the date of original purchase of the first date of purchase of the product. Please note that all parts, including repaired and replaced parts, are covered only for the duration of the original warranty period.

### WHAT IS EXCLUDED? Your warranty does not cover:

- Consequential damages (including but not limited to loss of data or loss of income), nor compensation for activities done by yourself, such as regular maintenance, installing firmware updates or saving or restoring data (Some states do not allow the exclusion of incidental or consequential damages, so the above exclusion may not apply to you. This includes, but is not limited to, prerecorded material, whether copyrighted or not copyrighted.)
- Labor charges for installation or setup of the product, adjustment of customer controls on the product, and installation or repair of various types of external devices (e.g., WiFi, antenna, USB dongles, OPS type devices) and other systems outside of the product.
- Reception problems caused by signal conditions or cable or antenna systems outside the unit.
- A product that requires modification or adaptation to enable it to operate in any country other than the country for which it was designed, manufactured, approved and/or authorized, or repair of products damaged by these modifications.
- If the model or production number on the product has been altered, deleted, removed or made illegible.

The warranty applies on condition that the product has been handled properly for its intended use and in accordance with the operating instructions

#### To Obtain Warranty Service And Information

For detailed warranty coverage information and additional support requirement and help line, please contact the seller and/or system integrator you purchased the product from. Please note in the USA, this limited warranty is only valid for Products purchased in the Continental United States, Alaska, and Hawaii.

#### Before Requesting Service

Please check your user's manual before requesting service. Adjustments of the controls discussed there may save you a service call.

#### WARRANTY PERIOD

Warranty period for PHILIPS signage display is listed as below, for areas not covered in this table, please follow their warranty statement.

Standard warranty period for PHILIPS signage display is listed as below, for areas not covered in this table, please follow the local warranty statement.

<b>Region</b>	<b>Standard Warranty Period</b>
USA, Canada	3 years
China	3 years
Japan	3 years
Rest of world	3 years
Mexico	3 years
Brazil	3 years
Chile	3 years
Peru	3 years

Note that for professional products, the specific warranty terms of the sale- or purchase agreement may apply.



2025 © TOP Victory Investments Ltd. All rights reserved.

This product has been manufactured by and is sold under the responsibility of Top Victory Investments Ltd., and Top Victory Investments Ltd. is the warrantor in relation to this product. Philips and the Philips Shield Emblem are registered trademarks of Koninklijke Philips N.V. and are used under license.

Specifications are subject to change without notice.

Version: V1.02 2025-6-16