

Introduction

Congratulations on your purchase and welcome to Philips Avent! To fully benefit from the support that Philips Avent offers, register your product at www.philips.com/welcome.

Philips Avent Premium Connected Baby Monitor with SenseIQ technology makes the invisible visible for complete reassurance. It's simple and intuitive for parents to see, hear, and know their baby is safe and sound from home or away. SenseIQ helps parents stay connected with wearable-free sleep and breathing rate tracking providing a real-time picture of their baby's wellbeing. Personalized notifications and auto-generated sleep logs gives parents quick and easy insights and understanding into their baby's sleep patterns and cycles.

Identifying your baby monitor model

The Philips Avent Premium Baby Connected monitor come in two specific versions. To help identify your mode more easily, this user manual will refer to them as the **2-in-1 mount version** (SCD971/26, SCD973/26) and the **wall-only mount version** (SCD974/26).

2-in-1 mount version

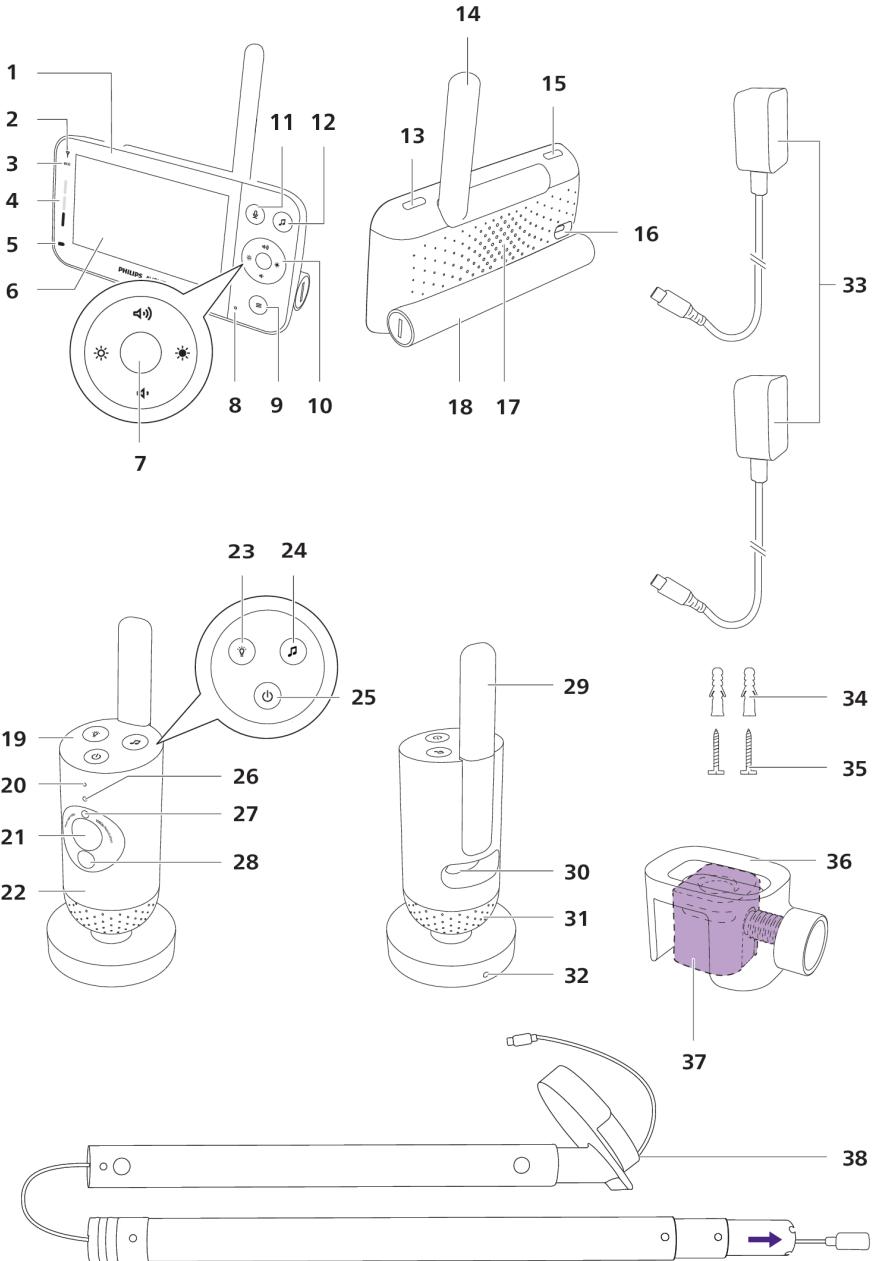

General description

- 1 Parent unit
- 2 Link light
- 3 Eco-mode light
- 4 Sound level lights
- 5 Battery status light
- 6 Display
- 7 Confirm button
- 8 Microphone
- 9 Menu button
- 10 Control button (menu navigation/volume/brightness)
- 11 True talk-back button
- 12 Soothing sounds button
- 13 On/Off button
- 14 Foldable antenna
- 15 Mode button
- 16 USB-C socket
- 17 Speaker
- 18 Battery compartment
- 19 Baby Unit
- 20 Microphone
- 21 Camera
- 22 Nightlight
- 23 Nightlight button
- 24 Soothing sounds button
- 25 On/Off button
- 26 Status light
- 27 Ambient light sensor
- 28 Infrared light
- 29 Antenna
- 30 USB-C socket
- 31 Speaker
- 32 Temperature sensor
- 33 Power adapter (2x)
- 34 Anchor (2x)
- 35 Screw (2x)
- 36 Clamp
- 37 Wall mount bracket
- 38 2-in-1 mount (Crib mount & Wall mount)

Wall-only mount version

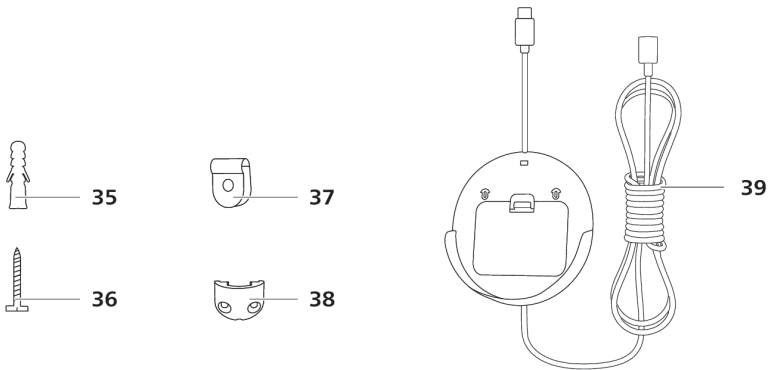
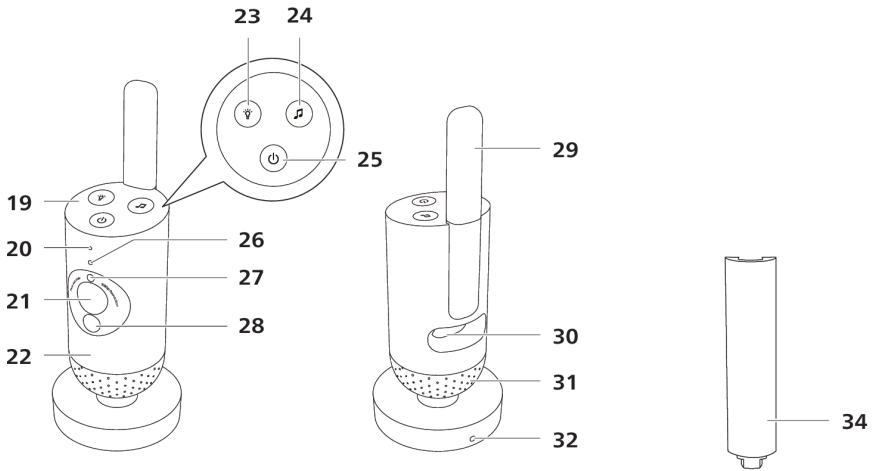
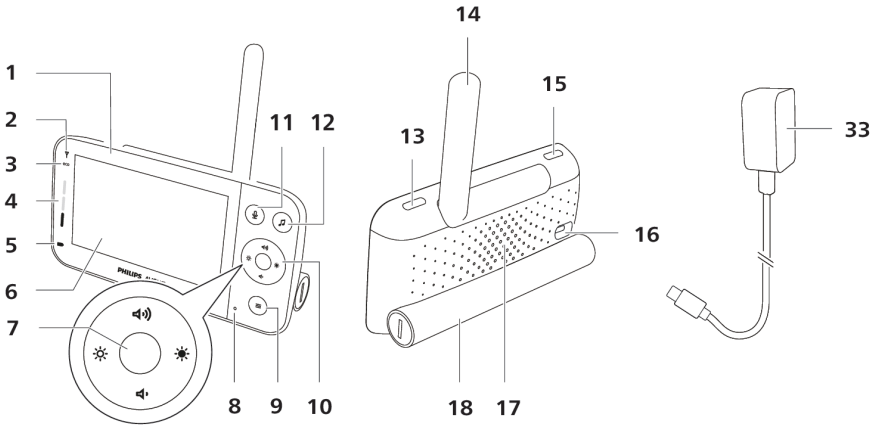

General description

- 1 Parent Unit
- 2 Link light
- 3 Eco-mode light
- 4 Sound level lights
- 5 Battery status light
- 6 Display
- 7 Confirm button
- 8 Microphone
- 9 Menu button
- 10 Control button (menu navigation/volume/brightness)
- 11 True talk-back button
- 12 Soothing sounds button
- 13 On/Off button
- 14 Foldable antenna
- 15 Mode button
- 16 USB-C socket
- 17 Speaker
- 18 Battery compartment
- 19 Baby Unit
- 20 Microphone
- 21 Camera
- 22 Nightlight
- 23 Nightlight button
- 24 Soothing sounds button
- 25 On/Off button
- 26 Status light
- 27 Ambient light sensor
- 28 Infrared light
- 29 Antenna
- 30 USB-C socket
- 31 Speaker
- 32 Temperature sensor
- 33 Power adapter (2x)
- 34 Cable cover (7x)
- 35 Anchor (7x)
- 36 Screw (7x)
- 37 Cable clamp (3x)
- 38 Exit cover
- 39 Wall mount bracket

Important safety information

Read this important information carefully before you use the appliance and save it for future reference.

IMPORTANT

This baby monitor is intended as an aid. It is not a substitute for responsible and proper adult supervision and should not be used as such.

Never leave your baby alone in your home. Always make sure there is someone present to look after the baby and take care of its needs.

Disclaimer

Please note that you use this baby monitor at your own risk. Koninklijke Philips N.V. and its subsidiary companies are not responsible for the operation of this baby monitor or your use of it and therefore do not accept any liability in connection with your use of this baby monitor.

Philips Avent Premium Connected Baby Monitor is not a medical device. Philips Avent Baby Monitor+ App is not a medical app.

The Philips Avent Premium Connected Baby Monitor is in NO way intended to diagnose, treat or cure any disease or other health related condition, including but not limited to, Sudden Infant Death Syndrome (SIDS), and is therefore NOT a medical device. This baby monitor is intended for household use only and is a connected consumer product designed and intended to help understand how a baby sleeps, moves and cries.

This product is NOT intended to detect breathing interruptions, breathing disorders or other medical conditions. This product will NOT notify users of all their baby's breathing or sleep irregularities, patterns, cries and/or current status that may occur.

The Philips Avent Premium Connected Baby Monitor should never be a substitute or replacement for adult supervision, nor affect the decision to consult a medical professional. Users should consult a medical professional if concerned about their baby's health and should NEVER solely rely on the readings from this product to diagnose and make medical decisions about their baby's health and care.

Always follow official safe sleep, health, and care guidelines to ensure your child's safety and wellbeing

Danger

- Never immerse any part of the baby monitor in water or any other liquid. Do not place the appliance where water or any other liquid can drip or splash onto it. Never use the baby monitor in moist places or close to water.
- Never put any object on top of the baby monitor and do not cover it. Do not block any ventilation openings. Install according to the manufacturer's instructions.

Warning

- **Long cable. Strangulation hazard!**
- Check if the voltage indicated on the adapter corresponds to the local mains voltage before you connect the appliance.
- Do not modify or cut off any part of the adapter and its cord, as this causes a hazardous situation.
- Only use the adapter supplied.
- If the adapter is damaged, always have it replaced with one of the original type to avoid a hazard.
- Keep the baby monitor and its accessories away from your baby and children.

- This appliance can be used by children aged from 8 years and above and persons with reduced physical, sensory or mental capabilities or lack of experience and knowledge if they have been given supervision or instruction concerning use of the appliance in a safe way and understand the hazards involved. Children shall not play with the appliance. Cleaning and user maintenance shall not be made by children without supervision.
- Protect the mains cord from being walked on or pinched particularly at plugs, convenience receptacles, and the point where they exit from the appliance.
- Make sure that you place the baby monitor in such a way that its cord does not obstruct a doorway or passage. If you place the baby monitor on a table or low cabinet, do not let the mains cord hang over the edge of the table or cabinet. Make sure the cord does not lie on the floor where it presents a tripping hazard.
- Keep the packaging materials (cardboard buffers, etc.) out of the reach of children, as they are not a toy.
- To prevent electric shock, do not open the housing of the baby unit or parent unit.

Battery safety instructions

- Only use the product for its intended purpose. Read this information carefully before you use the product and its batteries and accessories, and save it for future reference. Misuse can lead to hazards or serious injuries. Accessories supplied may vary for different products.
- Only use original Philips accessories or consumables. Only use detachable* supply unit ASSA105X-050100 (x=B or E) series.
- Charge, use and store the product at a temperature between 0 °C and 40 °C.
- Keep product and batteries away from fire and do not expose them to direct sunlight or high temperatures.
- If the product becomes abnormally hot or smelly, changes color or if charging takes longer than usual, stop using and charging the product and contact Philips.
- Do not place products and their batteries in microwave ovens or on induction cookers.
- Do not place products and their batteries on ceramic cookers.
- Do not open, modify, pierce, damage or dismantle the product or battery to prevent batteries from heating up or releasing toxic or hazardous substances. Do not short-circuit, overcharge or reverse charge batteries.
- If batteries are damaged or leaking, avoid contact with the skin or eyes. If this occurs, immediately rinse well with water and seek medical care.

Caution

- Do not install the appliance near any heat sources such as radiators, heat registers, stoves or other apparatus (including amplifiers) that produce heat.
- Make sure that your hands are dry when you handle adapters, plugs and the mains cord.
- Screw covers / rubber pad can detach from the appliance, check on a regular basis.
- All required markings on the Baby Unit, Parent Unit and power adapter are located on the bottom of the Baby Unit, Parent Unit and power adapter.
- If your baby monitor includes the 2-in1 mount, please also note:

The mounting accessory works best on a crib of which the square bar width is between 15 mm to 32 mm. Avoid using it on round or soft rails.

If your baby crib has a round edge, the mounting bracket is best mounted to the wall.

Remove the crib mount from your baby's crib and mount it on the wall when your baby can pull themselves up on their own or show signs of standing.

Declaration of conformity

Hereby, Philips Consumer Lifestyle B.V. declares that this product is in compliance with the essential requirements and other relevant provisions of Directive 2014/53/EU. A copy of the EC Declaration of Conformity (DoC) is available online at www.philips.com/support.

Electromagnetic fields (EMF)

This Philips appliance complies with all applicable standards and regulations regarding exposure to electromagnetic fields.

General Information

Lithium-ion rechargeable battery (2600 mAh)

Modulation type: IEEE 802.11 b/g/n

Operating frequency range: 2412 - 2472 MHz

Maximum radio-frequency power: ≤ 20 dBm e.i.r.p

Off mode power consumption:

Baby unit: < 0.3 W

Parent unit: < 0.3 W (< 1 min)

*Supply unit:

Model: ASSA105x-050100 (x = E (EU plug) / x = B (UK plug))

Input: 100-240 V~, 50/60 Hz, 0.35 A

Output: 5.0 Vdc, 1.0 A, 5.0 W

Average active efficiency: ≥ 73.62 %

No-load power consumption: < 0.1 W

Preparing for use

Download the Baby Monitor+ app



To fully experience and activate the SenseIQ and Cry Translation features, we recommend downloading the Baby Monitor+ app before using your baby monitor.

With the Philips Avent Baby Monitor+ app, you can see and hear your baby and check on their wellness from anywhere in the world by using Wi-Fi or mobile internet.

Before you start the set-up procedure, make sure:

- You have wireless Internet access (2.4 GHz Wi-Fi).
- You have a good Wi-Fi signal.

Note: If you use a Wi-Fi extender, make sure that your router and your Wi-Fi extender have the same SSID (the network name) and that you use the same password for the router and the extender. Also make sure the Wi-Fi extender supports 2.4 GHz Wi-Fi.

- You have the password of your Wi-Fi network at hand. Always connect the baby monitor to a secure network (see 'Security and privacy').



- 1 Download the app. Scan the QR code or search the keywords "Philips Avent Baby Monitor+" in the App Store or Google Play Store.
- 2 Launch the app.

Tip: Connect your phone to the Internet via Wi-Fi. Use of data connection may involve extra charges from your provider, depending on your subscription.



- 3 Create your account by following the on-screen instructions.
 - a Make sure that you use a working email address on which you can always be reached.

b Use a strong password (see the "Strong passwords" section).

c When you receive the verification email, follow the instructions in the email to continue creating your account.

4 Set up your baby monitor by following the instructions in the app.

Security and privacy

Network security

Do not use the app on an unsecured Wi-Fi network. We advise you to use the baby monitor only on a Wi-Fi network protected with WPA2 or higher encryption. With the app, you can also use your phone's data network (often referred to as 4G or 5G).

Wi-Fi hotspots in public places, such as airports and hotels, are convenient, but they are often not secure.

We advise you to use the baby monitor only on a Wi-Fi network protected with WPA2 or higher encryption.

We advise you not to use the baby monitor on a network that uses WEP encryption.

Note: Wi-Fi networks that do not require a password are not secure.

Strong passwords

Passwords are essential to protect your Wi-Fi network and your account against unauthorised access. The stronger your password, the better protected your Wi-Fi network and your account is.

The rules for a strong password are:

- 1 Has at least 8 characters.
- 2 Does not contain your name, your baby's name, another real name or a brand name.
- 3 Does not contain a complete word.
- 4 Is very different from passwords that you have used before.
- 5 Contains at least 3 out of 4 types of the following characters:
 - a Uppercase characters (A - Z)
 - b Lowercase characters (a - z)
 - c Numeric characters (0 - 9)
 - d Special characters (e.g., # \$ % &).

Personal data security

To delete and therefore protect your personal data, factory-reset your Baby Unit by long pressing the On/Off button for 10 seconds when the Baby Unit is on, before discarding the device. It is strongly advised to disconnect the Baby Unit from the Philips Avent Baby Monitor+ app by selecting "Disconnect Baby Monitor" option in the Baby Unit settings of the app.

If you are a second-hand owner, we advise you to perform the following steps to factory-reset your Baby Unit to secure your device:

- 1 Turn on your Baby Unit.
- 2 Once the LED has changed from orange to green or white, press the On/Off button for more than 10 seconds until the LED flashes between green and orange, and the Baby Unit will factory-reset.

In case you do not perform the factory-reset, Philips will not be responsible for the performance and functionalities of the device, and your privacy might be compromised.

Account management

There are different access rights for the Admin user and Guest users. You can invite relatives or friends as guest users and allow them to monitor your baby on their smart devices.

	Admin User	Guest Users
Monitoring	Video Audio SenseIQ Cry Translation Temperature Background monitoring	Video Audio Background monitoring
Alerts notification	Sound detection Movement detection SenseIQ associated notification Cry detection Cry Translation Temperature range detection	N/A
Soothing features	Nightlight, soothing sounds, lullabies, true talk-back Voice recording	N/A
Account management	Admin user invitation Guest user invitation	N/A

Note: The Baby Monitor+ app supports two admin accounts, you can invite your partner to sign up as the other admin and share the same access rights. Do not share admin credentials with anyone outside of your immediate household.

Provision of security updates

We continuously monitor the security of the software used in the product. If necessary, security updates will be provided through software updates. Software updates may also be provided to offer bug-fixes and performance improvements, or to introduce new product features. Updates may be provided to the Baby Unit and Parent Unit firmware, or in the mobile app. Updates are wirelessly delivered to the product without the usage of special cables or equipment.

Philips will provide the necessary updates for a period of at least two years after the delivery of the product.

Compatibility

iOS system: Requires iOS 13.0 or later

Android system: Requires Android 6.0 or later

Note: The compatibility is subject to change over time.

Mount your Baby Unit

Whether you have the 2-in-1 mount or the wall-only mount, this user manual has provided detailed instructions on how to safely and reliably mount your baby monitor, allowing you to monitor your baby's sleep and breathing patterns with ease and efficiency.

Dos and Don'ts

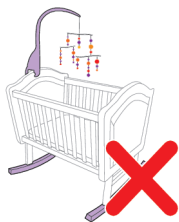

Try and keep your baby's crib and sleeping area free from hanging mobiles, toys, or moving lights. The fewer objects cluttering the view, the better your baby monitor will work.

The monitor is sensitive to movement, avoid using a rocking crib or bassinet.



Avoid mounting your Baby Unit over the short side of the crib. This will limit how well you will see your baby.

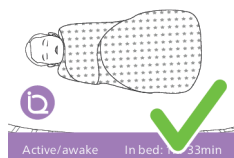

Sleep-sacks, bedding and patterned clothes are great to use with this baby monitor.



Try to avoid thick clothes and bedding that are all the same color, as the Baby Unit uses contrast to detect motion.

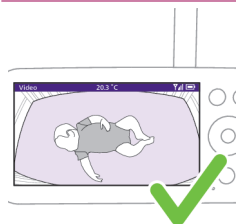

The mattress should appear as a straight horizontal rectangle on your screen. The straighter the mattress is on screen, the better.

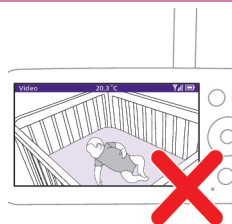

The Baby Unit or mattress should not be placed at an angle.

How are you mounting?

Mounting considerations for the 2-in-1 mount

If your baby monitor is equipped with the 2-in-1 mount, you have added flexibility in placing the Baby Unit over your the crib, such as when adjusting the mattress height as your baby grows.



The highest mattress position is typically used for newborns and smaller babies. We recommend using the crib mount when the mattress is in this position.



It is advised to move the mattress down when your baby can push themselves up onto their knees and show signs of sitting up. In this case using the crib mount is still preferred.

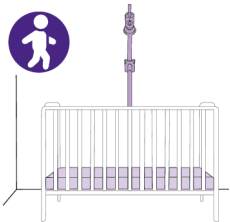

When your baby can start to pull themselves up on their own and show signs of standing, it is best to lower the mattress to the lowest position. We recommend using the wall mount for mattresses at lower positions.

Mounting considerations for the wall-only mount

The wall-only mount is designed to be securely mounted onto the wall and monitor a baby of all ages. Because the Baby Unit will be in a fixed position on the wall, there are some considerations to make when adjusting the mattress.

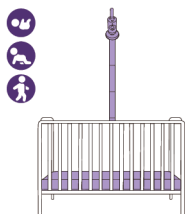

You may need to lower the mattress to accommodate for your growing baby. Whenever this occurs, the Baby Unit's position on the wall can remain the same without the need for re-installing. We recommend checking the angle of the camera to ensure the best view of your baby on the Parent Unit.

Instructions: 2-in-1 mount, crib option



Note: For cribs with round bars, please use the wall mount.

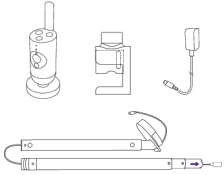

- 1 Take out the 2-in-1 mount, clamp, power adapter, and Baby Unit.

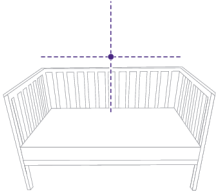

- 2 For the best results, mount the Baby Unit centered and over the long side of the crib.

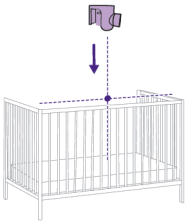

- 3 Attach the clamp to the middle of the long side of the crib by lowering it onto the railing.

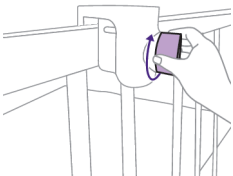

- 4 Turn the knob clockwise to secure it onto the bar.

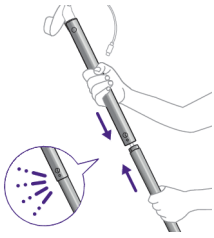

- 5 Take the two poles and push them together to make one longer pole.

Note: You will hear a small click when they are secured.

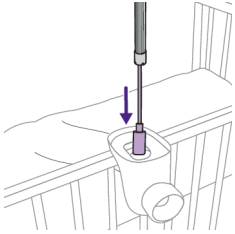

- 6 Then, with the power cord first, insert the pole through the opening of the clamp.

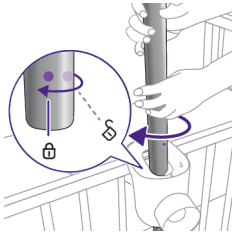

- 7 Align the pole into position by using the dots on the pole and clamp, and rotate it 45° clockwise to lock it into place.

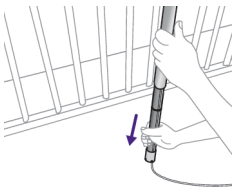

- 8 The bottom of the pole is telescopic, so you can extend it down to the floor. Make sure to place the power cord in one of the slots provided at the end of the tube towards a power outlet.

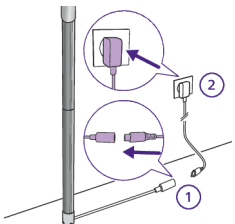

- 9** Run the cord where the floor and wall meet. Using the provided power adapter, attach the cord from the pole and plug it into a power outlet.

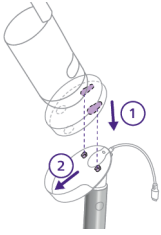

- 10** Attach the Baby Unit to its cradle by aligning the pegs to the holes at the bottom of the Baby Unit and pushing down.



- 11** Slide the Baby Unit forward to lock it into place and connect the USB-C power cable into the back of the Baby Unit.



- 12** Tilt your Baby Unit slightly up, down, right, or left to ensure the mattress becomes entirely visible with your baby in the center. Use your Parent Unit or Baby Monitor+ app to ensure the Baby Unit is in the best position. Adjust the Baby Unit to see your baby's mattress is centered and level on the screen.

Instructions: 2-in-1 mount, wall option

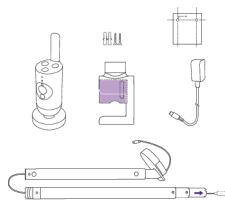

- 1 Take out the 2-in-1 mount, clamp, power adapter, screws and anchors, wall mount template, and the Baby Unit.

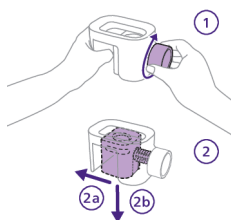

- 2 Remove the wall mount bracket from the clamp by turning the knob counterclockwise with one hand while guiding the bracket out with the other hand.

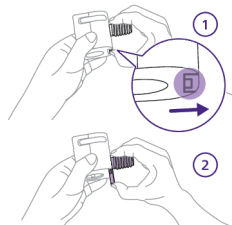

- 3 Remove the screw section by unlocking it with your thumb and sliding it down and off. You are now left with the piece that will be used as the wall mount.

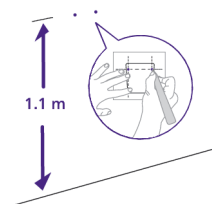

- 4 Find the wall mount template and use a ruler to measure 1.1 meters up from the floor and mark where the two screws should go. Drill small holes into the wall and push in the anchors provided.

Tip: The wall mount template (see the "Wall mount template" chapter) can be found at the end of this user manual.

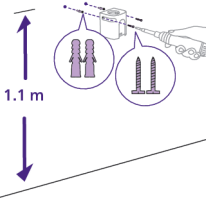

- 5 Take the wall mount bracket and align the holes with the anchors. Attach the wall mount bracket to the wall securely by using the screws provided.

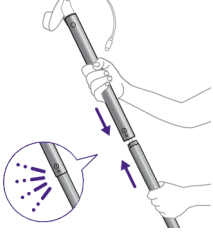

- 6 Take the two poles and push them together to make one longer pole.

Note: You will hear a small click when they are secured.

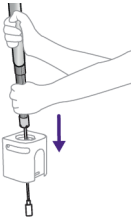

- 7 Then, with the power cord first, insert the pole through the opening of the wall mount bracket.

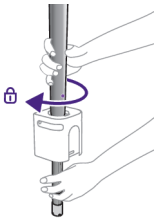

- 8 At about the half-way point, the pole will no longer slide down and needs to be locked into position. Using the dots on the pole and wall mount bracket, align the pole into position, and rotate it 45° clockwise to lock it into place.

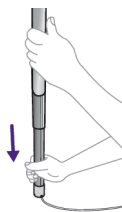

- 9** The bottom of the pole is telescopic, so you can extend it down to the floor. Make sure to place the power cord in one of the slots provided at the end of the tube towards a power outlet.

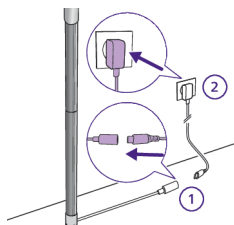

- 10** Run the cord where the floor and wall meet. Using the provided power adapter, attach the cord from the pole and plug it into a power outlet.

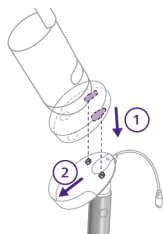

- 11** Attach the Baby Unit to its cradle by aligning the pegs to the holes at the bottom of the Baby Unit and pushing down.



- 12** Slide the Baby Unit forward to lock it into place and connect the USB-C power cable into the back of the Baby Unit.

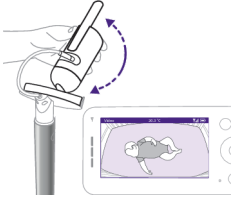

- 13** Tilt your Baby Unit slightly up, down, right, or left to ensure the mattress becomes entirely visible with your baby in the center. Use your Parent Unit or Baby Monitor+ app to ensure the Baby Unit is in the best position. Adjust the Baby Unit to see your baby's mattress is centered and level on the screen.

Instructions: wall-only mount

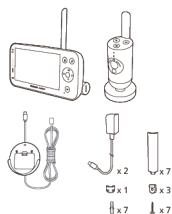

- 1 Take out the pieces provided for mounting to your wall – a wall mount bracket, 7 cable covers, exit cover, 3 cable clamps, power adapter, screws, anchors, wall mount template, and the Baby Unit.

Note: You will also need a few tools not included – a tape measure, power drill, and 6 mm (15/64 in) drill bit.

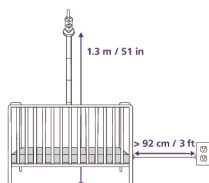

- 1 The middle of the crib should be placed under the spot you will mark. Measure 1.3 m / 51 in from the floor and mark this height on the wall. The edge of the crib should be at least 92 cm / 3 ft from the wall outlet you will use.

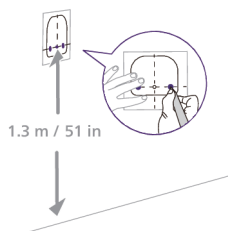

- 2 Take out the wall mount template and align its center with the 1.3 m / 51 in mark. Mark the two screw hole positions indicated on the template.

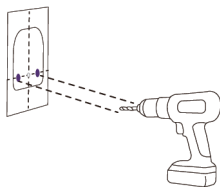

- 3 Drill holes at the marked spots and insert two wall anchors.

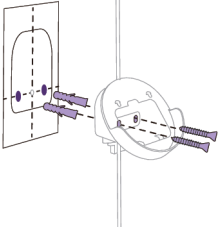

- 4 Remove the cover from the wall mount bracket.
Align the bracket with the anchors and secure to the wall using two screws.
Reattach the cover.

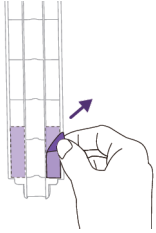

- 5 Peel the adhesive backing from one cable cover and align with the bottom of the wall mount bracket, then snap into place.

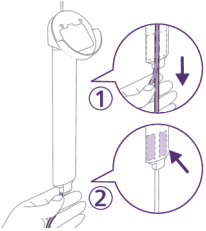

- 6 Gently pull the cable while keeping it behind the cover. When the cover is aligned straight, press it firmly to the wall.

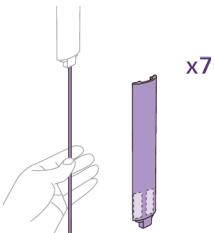

- 7 Repeat this method for the remaining cable covers.

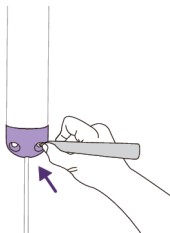

- 8** Position the exit cover to connect with the bottom cable cover.
Mark the two screw hole positions on the wall, then remove the exit cover.

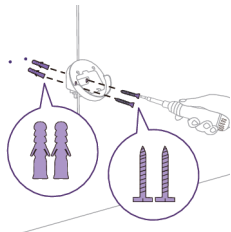

- 9** Drill holes and insert two wall anchors.
Reposition the exit cover and secure to the wall with two screws.

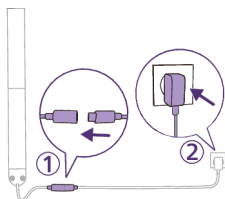

- 10** Connect the power cord and plug into the wall outlet.

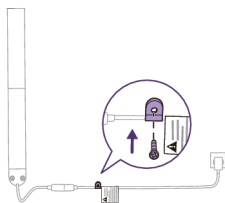

- 11** Use the cable clamps and screws to secure the cable along the wall.
Place the first clamp between the connector and warning label.

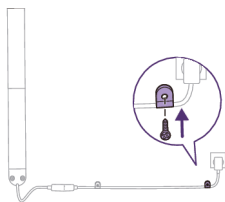

12 Place the second cable clamp near the wall outlet.

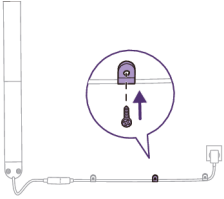

13 Place the third cable clamp at any point between the first and second clamps.

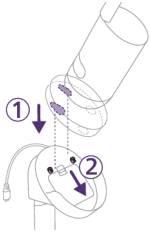

14 Align the holes at the bottom of the Baby Unit with the hooks of the wall mount bracket. Slide the Baby Unit forward and lock into place.



15 Connect the USB-C power cable to the Baby Unit.

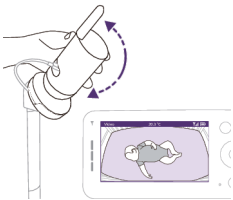

16 Use the Parent Unit to ensure the Baby Unit is in the best position.

Adjust the Baby Unit so that your baby's crib is centered and level on the screen.

Note: Tilt your Baby Unit slightly up, down, right, or left to ensure the mattress becomes entirely visible with your baby in the center. Use your Parent Unit or Baby Monitor+ app to ensure the Baby Unit is in the best position. Adjust the Baby Unit to see your baby's mattress is centered and level on the screen.

Parent Unit

Display overview

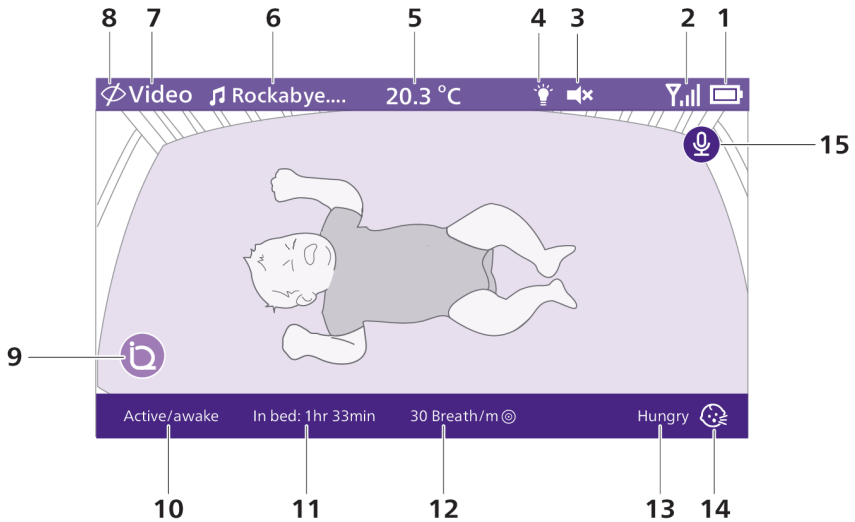

1	Battery level indicator	9	SenseIQ (Active)
2	Signal strength indicator	10	Sleep stage indicator
3	Mute (On)	11	In bed duration
4	Nightlight (On)	12	Average breathing rate
5	Room temperature	13	Cry Translation result
6	Selected soothing sound (On)	14	Cry Translation (Active)
7	Selected Parent Unit monitoring mode	15	True talk-back feature (On)
8	Privacy mode (On)		

Charging the Parent Unit

The Parent Unit runs on a built-in rechargeable Lithium-ion battery.

Follow the steps below to charge the Parent Unit:

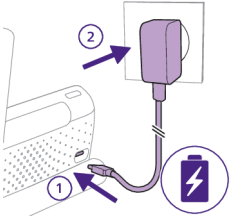

1 Plug the power adapter into the Parent Unit and the wall socket.

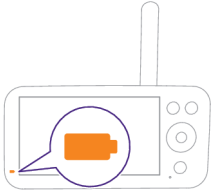

2 The battery status light turns solid orange to indicate that the Parent Unit is charging.

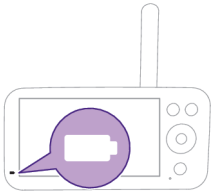

3 When the battery is fully charged, the battery status light turns to solid white.

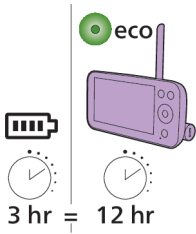

When you charge the Parent Unit for 3 hours, it can be used cordlessly for up to 12 hours in Eco mode. If the Parent Unit is switched on during charging, charging takes approximately twice as long.

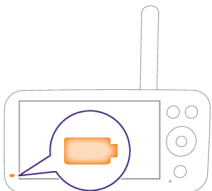

When the Parent Unit is not connected to the mains power and battery is almost empty (lower than 10%), the battery status light flashes orange and the low battery alert will sound.

If the Parent Unit battery is empty and is not connected to the mains power, the Parent Unit will switch off and connection to the Baby Unit will be lost.

Tip: Keep the Parent Unit connected to the mains power during the night as if the battery runs low, the low battery alert sound may wake you up.

Tip: To save battery, switch off the Parent Unit when not in use.

Note: The battery gradually and very slowly discharges, even when the Parent Unit is switched off.

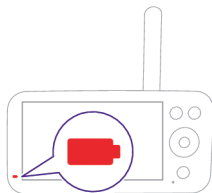

If the battery status light on the Parent Unit is showing a solid red color when it is connected to the mains power, it means there is an issue with the battery and you should contact the Consumer Care Centre in your country.

Using the baby monitor

How to pair your Baby and Parent Unit

For the best connection possible, keep the Baby Unit and Wi-Fi router in the same room. Solid walls or other electronics can disrupt the signal.

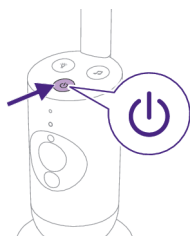

- 1 Press the On/Off button for 1.5 seconds to turn on the Baby Unit.

Note: The Baby Unit will automatically turn on once you plug it into the power outlet.

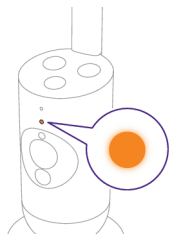

- 2 When the Baby Unit is powered on, the status light turns orange momentarily during the boot-up process.

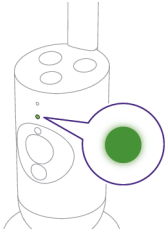

3 The status light will change to green when the Baby Unit is ready to pair.

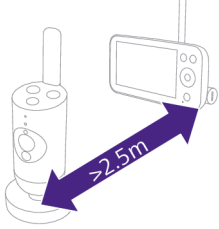

4 Make sure that the Parent Unit and the Baby Unit are at least 2.5 meters away from each other to avoid acoustic feedback.

Note: If you use a cordless phone, wireless video, Wi-Fi network, microwave oven or Bluetooth device on 2.4 GHz and you might experience interference on either the Parent Unit or Baby Unit, move the Parent Unit until there is no more interference.

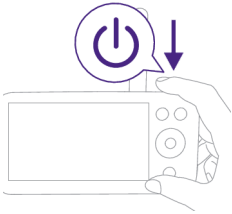

5 Press the On/Off button for 1.5 seconds to turn on the Parent Unit.

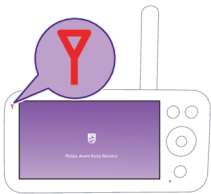

The display turns on, the Philips shield appears on the display and the link light turns red. The Parent Unit starts to search for the Baby Unit.

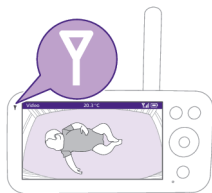

When the Parent Unit and Baby Unit are linked, the link light turns white on the Parent Unit and one or more signal strength bars appear on the display.

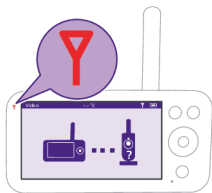

Note: It takes about 15 seconds to establish the link between the Parent Unit and the Baby Unit.

Make sure that the Baby Unit is switched on. When the Baby Unit is switched off, the display of the Parent Unit will show the out of range image.

If no connection has been established, the link light turns red, the Parent Unit alert will sound about every 25 seconds and the out of range image appears on the display.

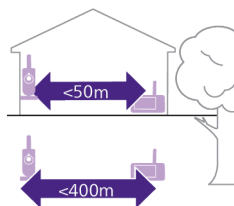

The operating range is up to 50 meters indoors and 400 meters outdoors. The operating range of the baby monitor varies depending on the surroundings and factors that cause interference. Wet and moist materials cause so much interference that the range loss is up to 100%.

Dry materials	Material thickness	Loss of range
Wood, plaster, cardboard, glass (without metal, wires or lead)	< 30 cm	0-10 %
Brick, plywood	< 30 cm	5-35 %
Reinforced concrete	< 30 cm	30-100 %
Metal grills or bars	< 1 cm	90-100 %
Metal or aluminium sheets	< 1 cm	100 %

Features and settings

Menu features

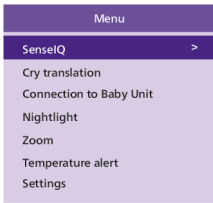

The Philips Avent Premium Connected Baby Monitor equipped with six excellent features to help parents monitor their baby with ease. These features include:

SenseIQ - uses AI technology to detect your baby's sleep and breaths.

Cry Translation - gives you translations of your baby's cries, so you can better understand their needs.

Connection to the Baby Unit - allows for two connection options (Auto and Direct) between the Baby Unit and the Parent Unit to ensure you are always connected to your little one.

Nightlight - provides soft, gentle lighting to soothe your baby and create a calming sleep environment.

Zoom - enables you to zoom in on your baby's crib, providing you with a closer look at your little one.

Temperature alert - informs you if the baby's room temperature is too high or too low.

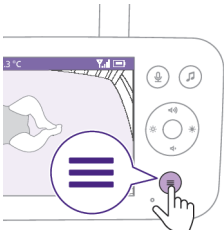

All features described in the following sections can be operated through the menu of the Parent Unit or app.

1 Press the menu button on the bottom right of the Parent Unit to enter the menu list.

Note: You will leave the menu when pressing the menu button again.



2 Use the control button to navigate through the menu. The selected menu item is highlighted purple.

Note: If you are already in one of the sub menus and you want to switch between menu features, press the menu button again to navigate back to the main menu.

Note: If you are in the menu but do not press a button for 8 seconds, the menu will exit without saving changed settings.

SenseIQ

Philips Avent Premium Connected Baby Monitor with SenseIQ technology analyzes every movement and breath to give parents the clearest picture into their baby's wellbeing. Intuitive and wearable-free, SenseIQ technology produces real-time breath and sleep status updates, so parents can rest easy knowing they'll always be connected, and their baby is safe and sound.

To activate SenseIQ, please download the Baby Monitor+ app (see the "Download the Baby Monitor+ app" chapter) and follow the steps in the app to turn it on.

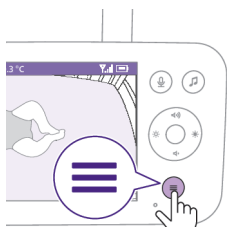

- 1 Press the menu button on the bottom right of the Parent Unit.

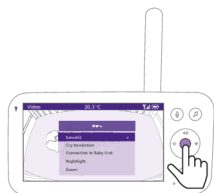

- 2 Select "SenseIQ" and press the confirm button to access the SenseIQ feature.

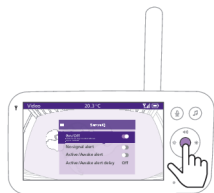

- 3 Press the confirm button to set the SenseIQ feature on or off.

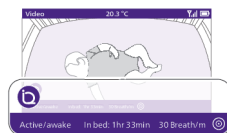

The display shows the sleep stage, in bed duration, and average breathing rate in the bottom bar.

Cry Translation

zoundream

The Cry Translation service, powered by Zoundream™, offers a useful tool to help you understand your baby's different cries and tells you what they might mean. However, it is important to remember that this tool is not meant to replace parental judgment. Philips is not liable for the translation results. It is recommended to seek the advice of a medical professional when necessary.

To activate Cry Translation, please download the Baby Monitor+ app (see the "Download the Baby Monitor+ app" chapter) and follow the steps in the app to turn it on.

Cry Translation service is available for a 90-day free trial period. Afterwards you can continue using it by signing up for a subscription service with Zoundream™. Terms and conditions apply. Usage will be measured in days, and any activity within a day will be considered as a full day of usage.

Note: Cry Translation only works when your Baby Unit is connected to the internet.

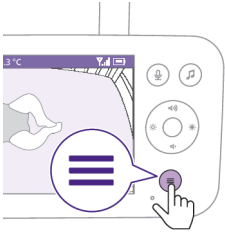

- 1 Press the menu button on the bottom right of the Parent Unit.



- 2 Select "Cry Translation" and press the confirm button to access the Cry Translation feature.

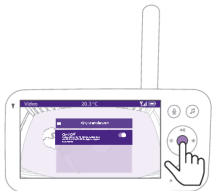

- 3 Press the confirm button to set the Cry Translation feature on or off.



The display shows the Cry Translation result in the bottom bar.

Tip: Keep any sounds emitting devices, such as fans or white noise machines, away from the Baby Unit to avoid interfering with the microphone and disrupting the feature's accuracy.

Connection to the Baby Unit

You can choose different connection options with this menu feature.

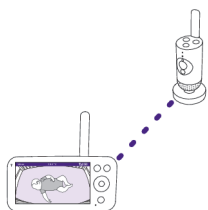

Direct: The Parent Unit and the Baby Unit are pre-paired and will connect to each other directly.

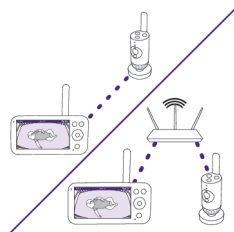

Auto: Direct or Wi-Fi: This setting optimizes the connection between the Baby Unit and Parent Unit by automatically choosing the best connection using either direct mode or Wi-Fi network.

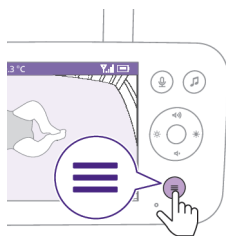

1 Press the menu button on the bottom right of the Parent Unit.

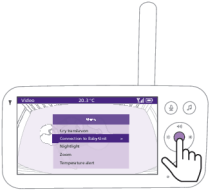

- 2 Select "Connection to the Baby Unit" and press the confirm button to access the Connection to the Baby Unit menu.



- 3 Press the top or bottom part of the control button and the confirm button to choose the desired connection.

Nightlight

To activate the Nightlight function from the Parent Unit, follow the instructions below:

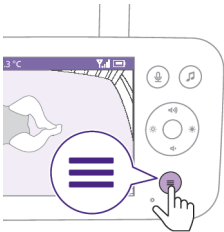

- 1 Press the menu button on the bottom right of the Parent Unit.



- 2 Select "Nightlight" and press the confirm button to enter the Nightlight feature.

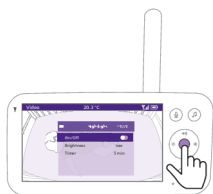

3 Press the confirm button to switch on and off the Nightlight feature.

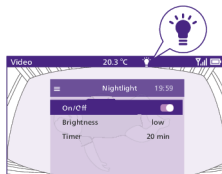

The display shows a light icon in the status bar when the Nightlight is on.

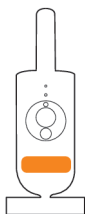

The Nightlight of the Baby Unit turns on.

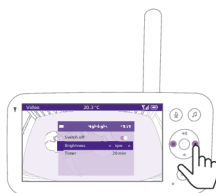

You can set the brightness level of the Nightlight from the Parent Unit.
Press the left or right part of the control button to choose low, medium or high.

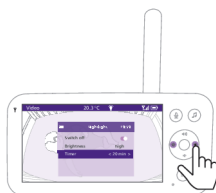

You can set the timer of the Nightlight from the Parent Unit.
Press the left or right part of the control button to choose the time you prefer.

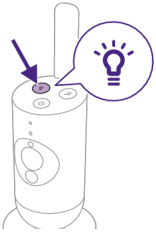

You can also control the Nightlight from the Baby Unit.

- 1 Press the Nightlight button on the Baby Unit to turn on the function.

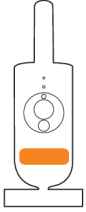

The Nightlight turns on.

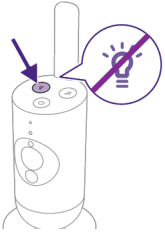

- 2 Press the Nightlight button again to switch off.

Zoom

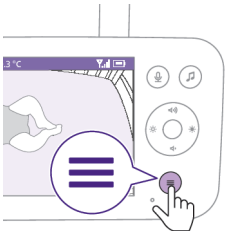

- 1 Press the menu button on the bottom right of the Parent Unit.

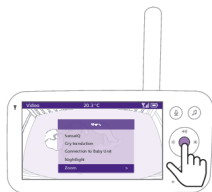

- 2 Select "Zoom" and press the confirm button to access the zoom feature.



- 3 Press the confirm button to adjust the video image. You can use the top/bottom/right/left part of the control button to choose what part of the image will be shown on the Parent Unit.
- 4 Press the menu button to save the new setting and exit.
- 5 If you want to zoom out the image on the Parent Unit, go to the zoom menu and turn off the zoom function.

Tip: Long-press the confirm button for two seconds to get a quick access to the Zoom function.

Temperature alert

The temperature sensor enables you to monitor the temperature in your baby's room.

Note: The current temperature in your baby's room is shown in the status bar of the Parent Unit.

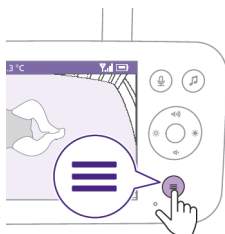

- 1 Press the menu button on the bottom right of the Parent Unit.

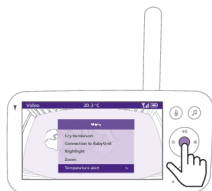

- 2 Select "Temperature alert" and press the confirm button to access the temperature alert feature.



- 3 The temperature alert can be set on or off, press the confirm button to turn it on or off.



- 4 To change the maximum and minimum temperatures for the temperature alert, select the desired temperatures in the temperature menu.

Tip: You can switch the temperature unit between C (Celsius) and F (Fahrenheit) by selecting the unit option.

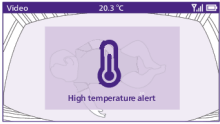

- 5 Press the left part of the control button to save the new setting and return to the main menu. The Parent Unit shows this alert when the measured temperature goes outside the range between the minimum and the maximum values.

Settings

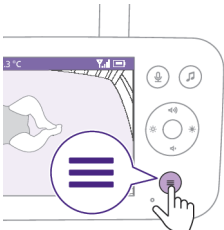

- 1 Press the menu button on the bottom right of the Parent Unit.



- 2 Select "Settings" and press the confirm button to access the settings menu.

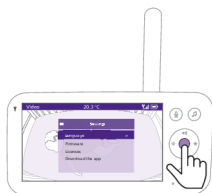

You can change the language setting of the Parent Unit.

- 1 Press the confirm button to access the list of languages.
- 2 Press the top or bottom part of the control button to scroll through all the languages and then press the confirm button to select the desired language.

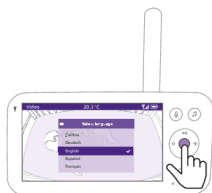

- 3 Press the confirm button to save the new setting and return to the main menu.

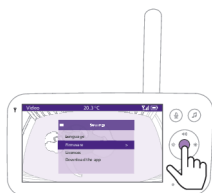

You can check the current firmware version of the baby monitor.

- 1 Press the confirm button to enter the firmware menu.

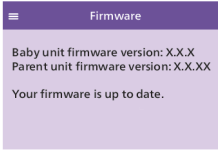

2 The display shows the latest firmware version of the Parent Unit and the Baby Unit.

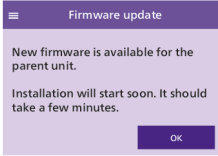

Note: In case a firmware update is available, it will be installed automatically, and you will receive a notification.

Status light

Orange

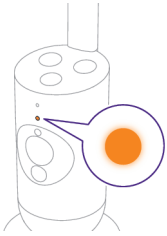

Solid orange: the Baby Unit is booting up.

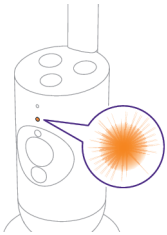

Flashes orange: the Baby Unit is upgrading its firmware. Do not switch it off during the upgrade.

Note: The Baby Unit might reboot briefly during the firmware upgrade

Green

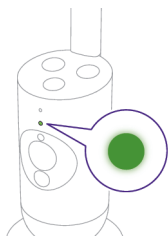

Solid green: the Baby Unit is ready to connect to the Parent Unit.

White

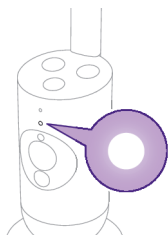

Solid white: the Baby Unit is ready to connect to the Parent Unit and app.

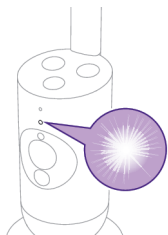

Flashes white: the Baby Unit is searching for the home network.

Red (Set up only)

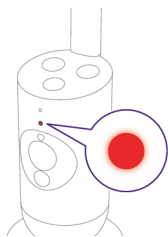

Solid red: the baby monitor failed to connect to internet.

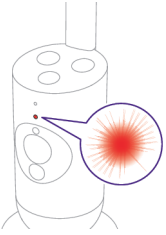

Flashes red: you have entered a wrong SSID or password.

Purple

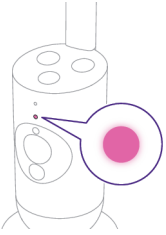

Solid purple: video live streaming is turned on for one or more app users.

Blue

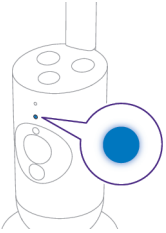

Solid blue: Privacy mode is activated.

Volume

You can adjust the speaker volume of the Parent Unit to the level you prefer.

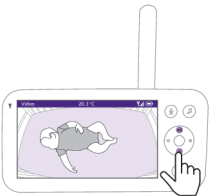

- 1 Press the top or bottom part of the control button to adjust the volume.



- The volume bar appears on the display to show the selected volume level.

Note: If the volume is set to a high level, the Parent Unit consumes more power.

Note: When the volume bar is at its minimum, the volume is muted. The Parent Unit shows a mute icon in the status bar and you will only receive alerts and video from the Parent Unit.

Display brightness

You can adjust the display brightness of the Parent Unit to the level you prefer.

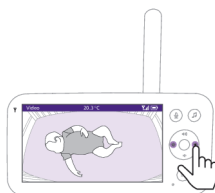

- Press the left or right part of the control button to adjust the brightness of the display on the Parent Unit.



- The brightness bar appears on the display to show the selected brightness level.

Note: The Parent Unit consumes more power with a higher brightness.

Sound level lights

The Parent Unit continuously monitors the sound level in your baby's room. The sound level lights on the Parent Unit let you know if there is any sound picked up in the baby's room.

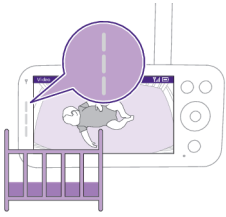

As long as no sound is detected, the sound level lights are off.

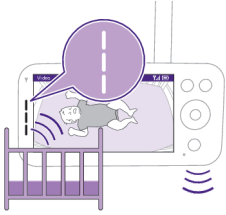

When the Baby Unit picks up a sound, one or more sound level lights on the Parent Unit turn white. The number of lights depends on the loudness of the sound picked up.

Modes and sensitivity

This baby monitor has three different modes that allow you to choose how you want to monitor your baby: Video, Audio, Eco.

The sensitivity level of the Baby Unit defines what you hear through the Parent Unit. When the level is set to high, you will hear many sounds, including soft background sounds. When the sensitivity level is set low, you will hear only the louder sounds.

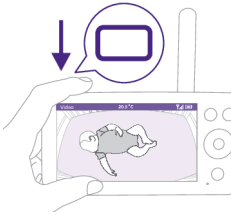

With the baby monitor on, press the mode button on the top left of the Parent Unit, press the top or bottom part of the control button to switch between these different modes, and then press the confirm button to select the desired mode.



You can choose different sensitivity levels for different modes by pressing the left or right part of the control button.

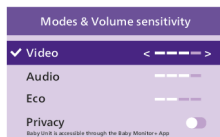

The display shows the selected mode.

The selected mode is also indicated in the status bar.

When turning on the device, the mode that was last used will be active.



If your baby only makes soft sounds, the sensitivity of the Baby Unit needs to be set to a high level on the Parent Unit.

The louder your baby sounds, the lower the sensitivity can be set on the Parent Unit.

Note: In Audio and Video mode, you will have continuous sound when the sensitivity level is set to the highest. Otherwise, low sounds will be muted.

Tip: The sensitivity level can be adjusted so you will always hear your baby without the disruption of other sounds. When there is a lot of background noise, turn down the sensitivity so that you will not hear these sounds through the Parent Unit.

Press the confirm button to save the new setting.

Video mode



- 1 Press the mode button on the top left of the Parent Unit.
- 2 Press the confirm button to select the Video mode.

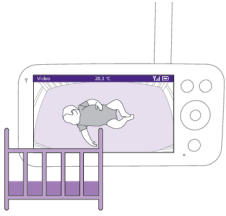

When the Video mode is activated, the display is always on.



Note: Set the sensitivity level to the highest to have continuous sound on the Parent Unit.

Audio mode



- 1 Press the mode button on the top left of the Parent Unit.
- 2 Press the bottom part of the control button to switch to Audio mode.
- 3 Press the confirm button to select the Audio mode.

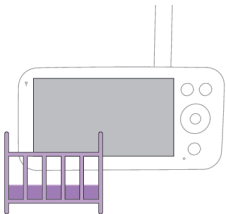

When the Audio mode is activated, the display of the Parent Unit will switch off.

Note: The status bar is not visible when the display is off.



Note: The white link light shows that the Parent Unit is still on and connected to the Baby Unit.

Note: When sensitivity is not set to the highest level, low sounds will be muted.

Note: Set the sensitivity level to the highest to have continuous sound on the Parent Unit. Please see the "Modes and sensitivity" chapter for more information.

If your baby makes any sound, the sound level lights turn on and the sounds detected by the Baby Unit are transmitted to the Parent Unit. As long as no sound is detected, the sound level lights are off.

Eco mode

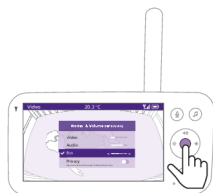

- 1 Press the mode button on the top left of the Parent Unit.
- 2 Press the bottom part of the control button to switch to Eco mode.
- 3 Press the confirm button to select the Eco mode.

Note: When the display is on, the selected mode will be visible in the status bar. The status bar is not visible when the display is off.

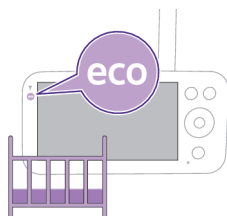

The display and sound level lights switch off when there is no sound detected for 20 seconds. The Eco-mode light turns white to indicate that the Parent Unit is still on and Eco mode is active.

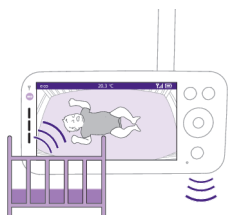

When sound is picked up by the Baby Unit, the display and sound level light of the Parent Unit turn on immediately. The video and sounds are transmitted to the Parent Unit and the sound level lights turn white. As long as no sound is detected, the sound level lights are off.

Note: The minimum sound level to activate sound and display is defined by the sensitivity setting.

Privacy mode



- 1 Press the mode button on the top left of the Parent Unit.
- 2 Press the bottom part of the control button to switch to Privacy mode.
- 3 Press the confirm button to activate the Privacy mode.

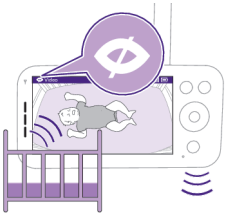

When the Privacy mode is activated:

- 1 You can still monitor your baby from the Parent Unit.

Note: When the display is on, the privacy mode indicator is shown in the status bar. The status bar is not visible when the display is off.



- 2 You cannot monitor your baby from the app.

Note: The status light of the Baby Unit turns blue. You will receive a push notification from the app.

Note: When you try to monitor via the app it will display that the Baby Unit is in Privacy mode.

Soothing sounds

To activate it from the Parent Unit, follow the instructions below:

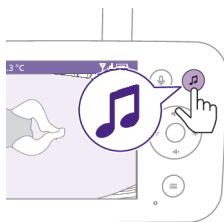

- 1 Press the soothing sounds button on the Parent Unit to open the menu.

Note: Pressing the button while the menu is already open, will close the menu.

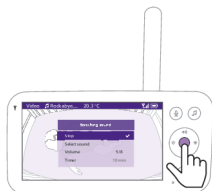

- 2 Press the bottom part of the control button to scroll down to "Select sound" menu item, press the confirm button to enter the soothing sounds list.



- 3 Press the top or bottom part of the control button to scroll through the list.
- 4 Press the confirm button to select or deselect the one you want to play. You can also select "All lullabies" to playback the first 5 lullabies.

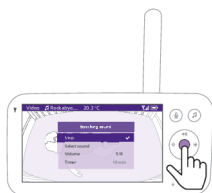

- 5 Navigate to "Play" and press the confirm button to start playing the selected sound. If you want to stop, press the confirm button again.

The status bar of the Parent Unit shows the name of sound that is being played.

Tip: Long-press the soothing sounds button to start or stop playing the selected sound.



You can set the volume level of the sound or lullaby from the Parent Unit. Press the left or right part of the control button to choose the volume level.



You can set a timer for the soothing sound to stop. Do this from the Parent Unit. Press the left or right part of the control button to choose the time you prefer.

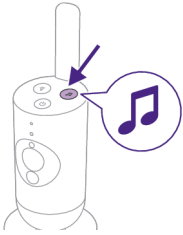

To activate the soothing sounds feature from the Baby Unit, press the soothing sounds button on the Baby Unit.



The latest sound selected on the Parent Unit starts to play continuously according to the last timer setting. To stop the soothing sounds on the Baby Unit, press the soothing sounds button again.

True talk-back

You can use the true talk-back button on the Parent Unit to talk to your baby.



- 1 Press the true talk-back button on the Parent Unit.



- 2 The display of the Parent Unit shows the true talk-back icon, indicating the active connection. Talk clearly into the microphone at the front of the Parent Unit from a distance between 15-30 cm.



The baby can hear you talking into the Parent Unit. At the same time, you will hear any sounds your baby makes.

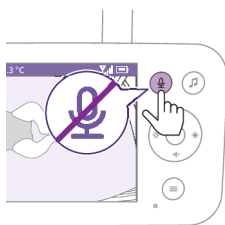

- 3 Press the true talk-back button again to turn off when you have finished talking.

Note: It is important to turn off talk-back when you're finished using it in order to avoid any unexpected sounds coming from the Baby Unit.

Cleaning and maintenance

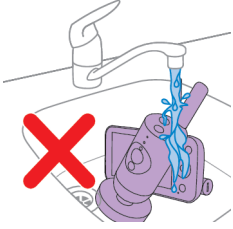

Warning: Do not immerse the Parent Unit, Baby Unit and power adapters in water and do not clean them under the tap.



Warning: Do not use cleaning sprays or liquid cleaners.

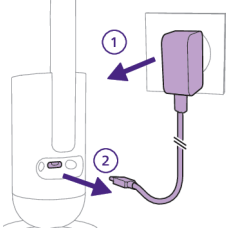

- 1 Switch off the Baby Unit, remove the power adapter from the Baby Unit and remove the power adapter from the wall socket.

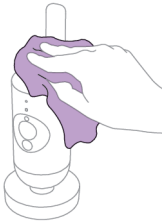

- 2 Clean the Baby Unit with a dry cloth.

Note: Fingerprints or dirt on the lens of the Baby Unit may affect the camera's performance. Avoid touching the lens with your fingers.

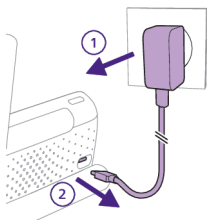

- 3 Switch off the Parent Unit, remove the power adapter from the Parent Unit and wall socket.

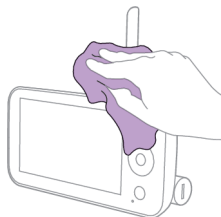

- 4 Clean the Parent Unit with a dry cloth.

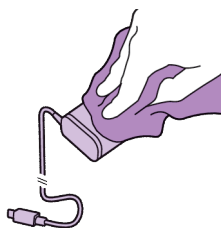

- 5 Clean the adapters with a dry cloth.

Storage

When you are not going to use the baby monitor for a long time, store the Parent Unit, the Baby Unit and adapters in a cool and dry place.

To optimize battery lifespan during long periods of inactivity or storage, it is recommended that you charge your Parent Unit to 50% before turning it off.

Ordering accessories

To buy accessories or spare parts, visit www.philips.com/parts-and-accessories or go to your Philips dealer. You can also contact the Philips Consumer Care Center in your country (see the international warranty leaflet for contact details).

Recycling



- This symbol means that electrical products and batteries shall not be disposed of with normal household waste.
- Follow your country's rules for the separate collection of electrical products and batteries.

Support

Warranty and support

For all product support, power consumption details and the EU Declaration of Conformity, please visit www.philips.com/support.

Philips offers a 2-year warranty. Warranty exceptions apply. This warranty does not affect your rights as a consumer under law. For more information, visit www.philips.com/support or call us.

Removal of built-in rechargeable battery

The built-in rechargeable battery must only be removed by a qualified professional when the appliance is discarded. Before removing the battery, make sure that the appliance is disconnected from the wall socket and that the battery is completely empty.

Take any necessary safety precautions when you handle tools to open the appliance and when you dispose of the rechargeable battery.

When you handle batteries, make sure that your hands, the product and the batteries are dry.

To avoid accidental short-circuiting of batteries after removal, do not let battery terminals come into contact with metal objects (e.g. coins, hairpins, rings). Do not wrap batteries in aluminum foil. Tape battery terminals or put batteries in a plastic bag before you discard them.

Procedure:

- 1 Use a coin to unlock the openings of the battery compartment on the back of the Parent Unit.
- 2 Remove the 2 rubber feet at the bottom of the Parent Unit.
- 3 Remove the 2 screws that are now visible at the bottom of the Parent Unit.
- 4 Pull apart the battery compartment from the Parent Unit.
- 5 Remove the battery.

If there is no collection/recycling system for electronic products in your country, you can protect the environment by removing and recycling the battery before disposing the product.

Wall mount

Printing instructions

Print this page at 100 % scale and use the template to accurately mark the position of the holes for the screws on the wall.

Template for the 2-in-1 mount

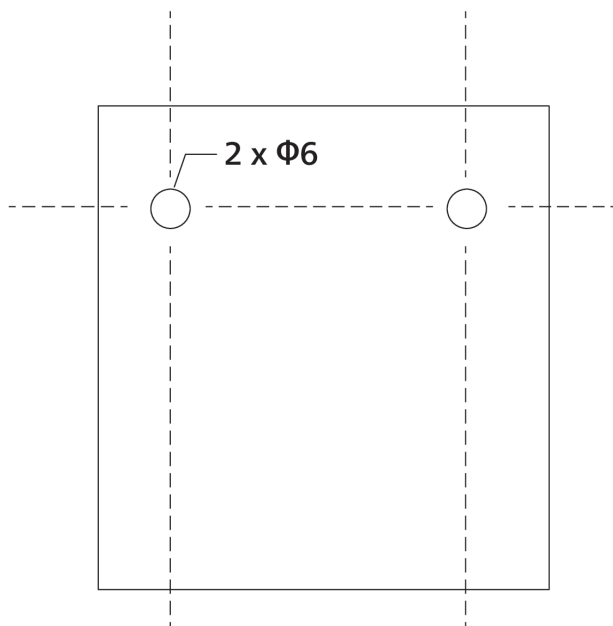

Template for the wall-only mount

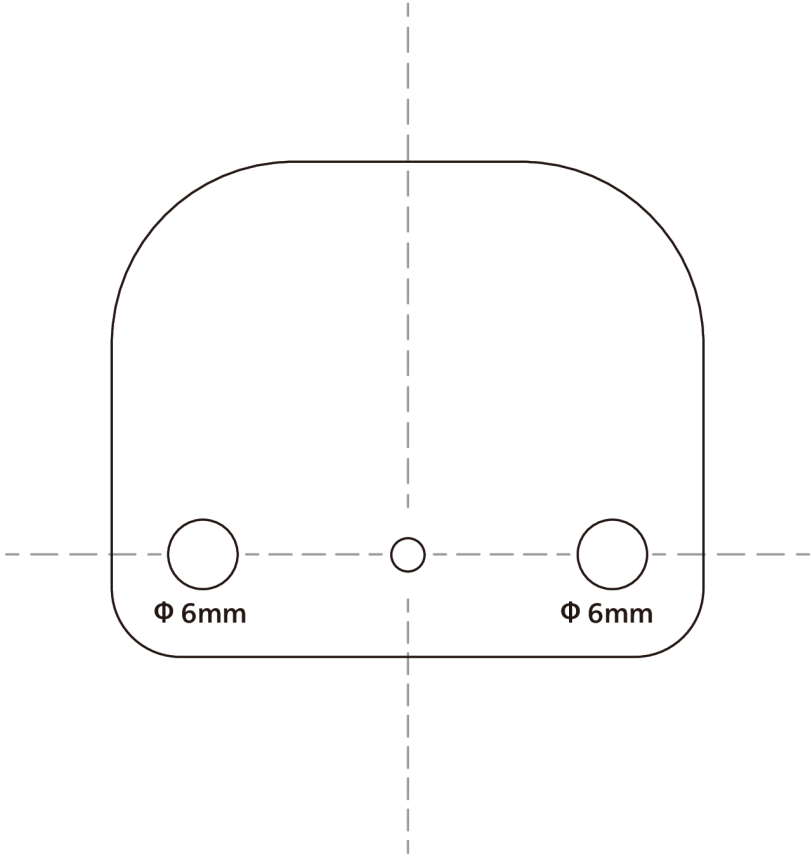

www.philips.com/avent

Philips Consumer Lifestyle B.V.

Tussendiepen 4, 9206 AD Drachten, The Netherlands

Trademarks are the property of Koninklijke Philips N.V.

© 2026 Koninklijke Philips N.V.

All rights reserved.

3000.180.1652.1 (29/5/2026)



>75 % recycled paper
>75 % papier recyclé