

PHILIPS

Digital Projector

NeoPix 160 Smart

User Manual



Register your product and get support at
www.philips.com/support

Contents

| | |
|--|----|
| Important Safeguards..... | 1 |
| Accessories List..... | 1 |
| Projector Knowledge..... | 2 |
| Specifications..... | 6 |
| Multimedia Format Supported..... | 6 |
| Remote Control..... | 7 |
| Projector installation..... | 8 |
| Standard Setting..... | 8 |
| Installation Method..... | 9 |
| Turn the Projector Operation On/Off..... | 10 |
| Use of the Projector..... | 10 |
| Image focusing..... | 10 |
| How to Use Projection Settings..... | 11 |
| Auto Trapezoid Displace..... | 11 |
| Manual Trapezoid..... | 12 |
| Auto Focus Displace..... | 12 |
| Screen Zoom..... | 13 |
| How to Select the Source..... | 14 |
| How to Play Files in USB Disk..... | 15 |

Important Safeguards

Installation

- To get a better watching, please use this projector while drawing the curtain or in a dark room.
- Please use the projector carefully, dropping or crashing may damage parts or result in blurred images and abnormal display.

Power

- Be careful while using the power cord, avoid excessive bending; the damage of power cable may cause electric shock and fire.
- It is better to unplug the power cord after power off.

Cleaning

- Unplug the power cable firstly.
- Clean the shell regularly with a damp cloth, neutral detergent can be used.
- Please use a glasses cloth or lens paper, not to scratch the lens.
- Please clean projector's vents and speakers regularly by banister brush, or the ventilation will be blocked.

High Temperature Attention

- While projection or just finishing, the exhaust port nearby will be very hot, if touch it, would get scald.
- While projection, please do not look the lens directly, or may hurt eyes.

*Warm Tips

- Do not disassemble the projector, if not, there will be a risk of electric shock, and the disassembling affect the normal warranty.
- Please do not put any liquid or heavy stuff on the projector.
- To ensure the stability of heat dissipation, please open the height bracket at the bottom of the projector before you begin.

Accessories List

Remote Control x1

Power Cable x1

User Manual x1

Projector knowledge

Projector can input high-definition video signal and composite video signal, and support stereo audio signal input and output. Please refer to the following figure to connect the projector and other audio equipment according to your own needs.

With Stand

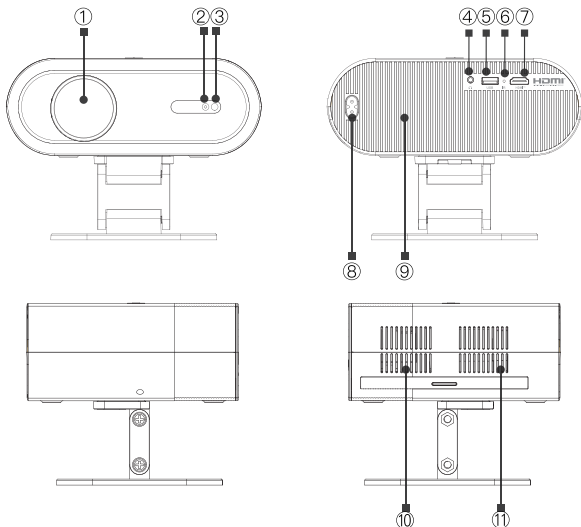

1. Lens

2. Camera

(Only available in auto focus version)

3. IR Receiver

4. 3.5mm Port for the Audio Output

5. USB Port

6. IR for the Remote Control

7. HDMI Port

8. Power Socket

9. Heat dissipation outlet

10. Speaker

11. Heat dissipation inlet

Projector knowledge

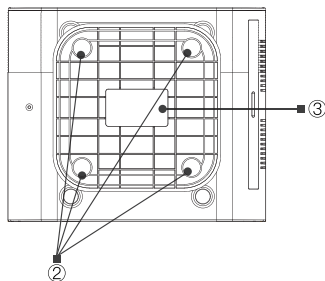
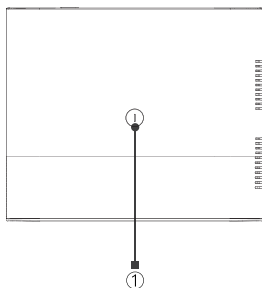

1. Power Key
2. Machine Feet
3. Bottom Label

Projector knowledge

Without Stand

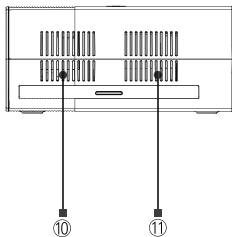
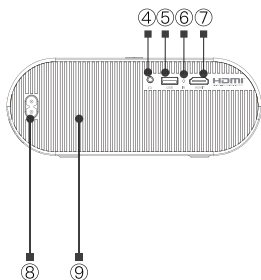
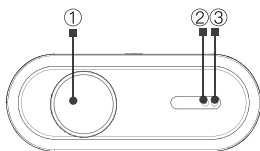

1. Lens

2. Camera
(Only available in auto focus version)

3. IR Receiver

4. 3.5mm Port for the Audio Output

5. USB Port

6. IR for the Remote Control

7. HDMI Port

8. Power Socket

9. Heat dissipation outlet

10. Speaker

11. Heat dissipation inlet

Projector knowledge

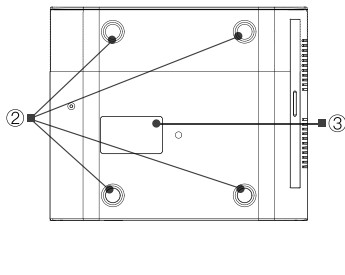
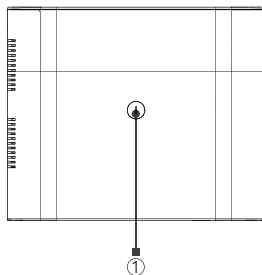

1. Power Key
2. Machine Feet
3. Bottom Label

Specifications

| | |
|-----------------------|-----------------------|
| Model | NeoPix 160 Smart |
| Lamp | LED |
| Image System | LCD |
| Resolution | 1920X1080 |
| Input Voltage | AC100-240V 50/60Hz 1A |
| Weight | 1.23 KG |
| Working Temp | 0-35°C |
| Input Port | HDMIx1 / USBx1 |
| Output Port | Headphone |
| Aspect Ratio | 16:9 / 4:3 |
| Size | 171 x207.1 x147.7mm |
| Operation Mode | Manual/Remote Control |

Multimedia Format Supported

| | |
|---------------------|-------------------------------|
| Image Format | JPG/PNG/BMP/JPEG |
| Audio Format | MP3/M4A/MP2/WAV/FLAC |
| Video Format | MP4/VOB/3GP/TP/TS/F4V/DAT/MOV |



This model does not support any Dolby audio decoding due to the copyright of Dolby patent.

Remote Control



1. Power on/ off
2. Menu
3. Navigation
4. Return
5. Home
6. Volume+
7. Volume-
8. APP
9. Source
10. Google Assistant
11. Projector Setup
12. Enter
13. Google Settings
14. Mute
15. Focus+
16. Focus-
17. Auto focus /Auto keystone

Projector Installation

Standard Setting

Please refer to the following table to adjust your picture size and distance.
(from the lens to the screen).

| Aspect ratio | 16:9 |
|---------------------|-------------------------|
| Picture size (inch) | Projection distance (m) |
| 50 | 1.30 |
| 70 | 1.82 |
| 100 | 2.61 |
| 120 | 3.13 |

Please allow + 3% to the image sizes in the table above. If the distance is less than min data and more than max data, the image could be blurry.

Warning:

Please check the diagram below for the trapezoid adjustment.

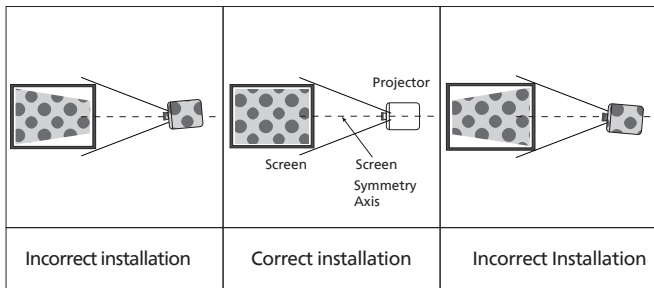

Projector Installation

Installation Method

Contact a professional installer to mount this projector to a ceiling.
(The lifting device should be able to withstand 4 times the weight of the product)
Follow the instructions below for the correct projector positions.

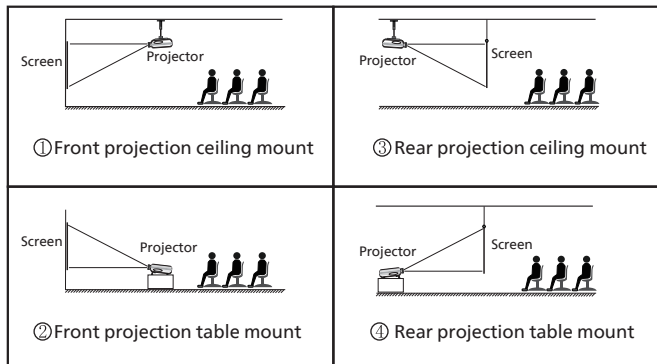

Warning:

1. The projector may be damaged beyond repair if it is incorrectly mounted on a Ceiling or on a surface. (The lifting device should be able to withstand 4 times the weight of the product)
2. The projector should only be used in an environment where the temperature does not exceed the range of 5 °C-35 °C. Projector malfunction may occur if this is not adhered to.
3. Malfunction may occur if the projector is subjected to dusty, wet, moist or smoky conditions.
4. Poor ventilation could cause overheating which could lead to damage to the projector as well as a life threatening situation.

Turn the Projector Operation On/Off

When the projector is connected to a power source, the projector enters standby and the cover signal indicator is red.

Operation on: Press the power key on the body or the power key on the remote control, the indicator will turn blue and enter the working state.

Operation off: In the working state, press the power key of the body or the power key on the remote control, the indicator changes from blue to red, and the projector is turned off.

Image focusing

When the newly installed projector is used for the first time, the image will be blurred, and it is necessary to focus the picture;

Manual Focus

When the picture is blurred, press the focus keys "F+" and "F-" on the remote control to adjust the focal length of the lens. Tap or long press the focus button until the picture is clear. (As shown below)



(Before the focus)



(After the focus)

Use of the Projector

How to Use Projection Settings

Select the settings icon in the main interface, and then press the "OK" key on the remote control to enter the settings interface and select "Projection Image Setting".

After entering the interface, select the mode you want in the projection settings.

Projection mode: Front / Rear / Front Ceiling / Rear Ceiling

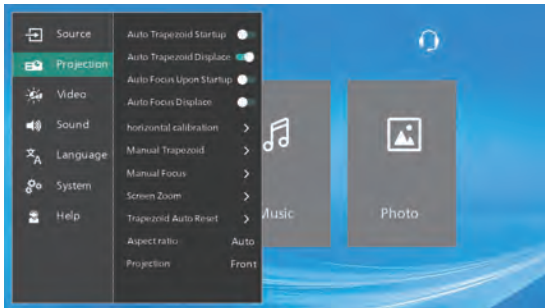

Auto Trapezoid Displace (Enable this function, when the device moves up and down can also keep the picture square.)

(※ Auto keystone function is only available in autofocus version. Please do not block the camera while autofocusing.)

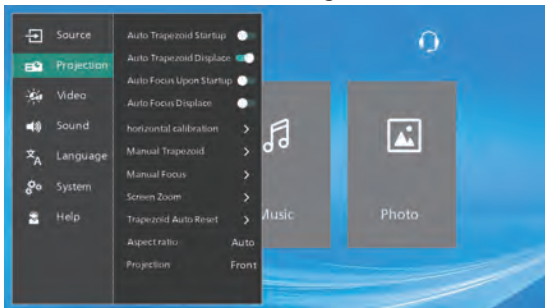

Note: As the product system is updated from time to time, the specific operation content is based on the actual situation.

Use of the Projector

Manual Trapezoid (Manually adjust the four corners through the arrow keys until the screen can be corrected)



Auto Focus Displace (This function is turned on by default, and the screen can be kept square even after the device is displaced.)

(※ Auto Focus function is only available in autofocus version. Please do not block the camera while autofocusing.)

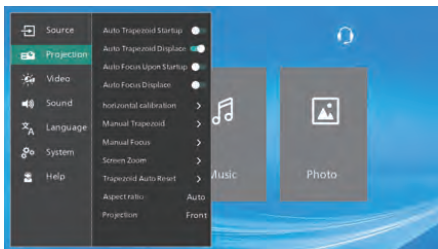

Note: As the product system is updated from time to time, the specific operation content is based on the actual situation.

Use of the Projector

Screen Zoom

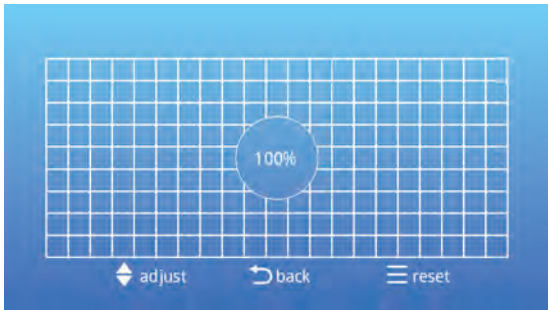
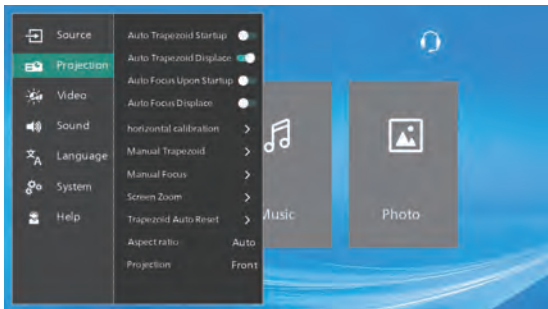

Note: As the product system is updated from time to time, the specific operation content is based on the actual situation.

Use of the Projector

How to Select the Source

Click the source key on the remote control and select the desired source on the popup, such as HDMI/USB/Android TV ,then press the "OK" key on the remote control to enter the corresponding source interface.



Note: As the product system is updated from time to time, the specific operation content is based on the actual situation.

Use of the Projector

How to Play Files in USB Disk

Click the source key on the remote control and select the USB on the popup, then press the "OK" key on the remote control to enter the corresponding source interface.

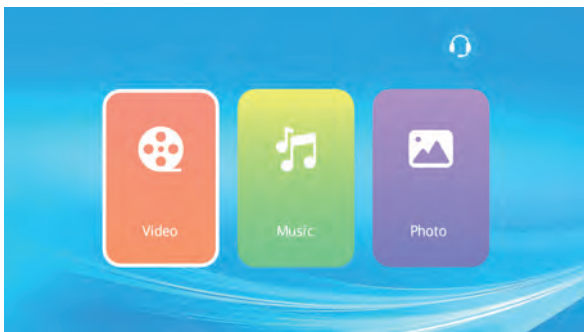

Note: As the product system is updated from time to time, the specific operation content is based on the actual situation.

FCC Warning

This device complies with part 15 of the FCC Rules. Operation is subject to the following two conditions:

(1) This device may not cause harmful interference, and (2) this device must accept any interference received, including interference that may cause undesired operation.

Any Changes or modifications not expressly approved by the party responsible for compliance could void the user's authority to operate the equipment.

Note: This equipment has been tested and found to comply with the limits for a Class B digital device, pursuant to part 15 of the FCC Rules. These limits are designed to provide reasonable protection against harmful interference in a residential installation. This equipment generates uses and can radiate radio frequency energy and, if not installed and used in accordance with the instructions, may cause harmful interference to radio communications. However, there is no guarantee that interference will not occur in a particular installation. If this equipment does cause harmful interference to radio or television reception, which can be determined by turning the equipment off and on, the user is encouraged to try to correct the interference by one or more of the following measures:

- Reorient or relocate the receiving antenna.
- Increase the separation between the equipment and receiver.
- Connect the equipment into an outlet on a circuit different from that to which the receiver is connected.
- Consult the dealer or an experienced radio/TV technician for help.

This equipment complies with FCC radiation exposure limits set forth for an uncontrolled environment. This equipment should be installed and operated with minimum distance 20cm between the radiator & your body.



The terms HDMI, HDMI High-Definition Multimedia Interface, HDMI Trade dress and the HDMI Logos are trademarks or registered trademarks of HDMI Licensing Administrator, Inc.



Screeneo Innovation SA
8A route de Suisse 1163 Etoy - Switzerland

Philips and the Philips Shield Emblem are registered trademarks of Koninklijke Philips N.V. and are used under license. Screeneo Innovation SA is the warrantor in relation to the product with which this booklet was packaged.