

PHILIPS sonicare

7100



— |

| —

— |

| —

1

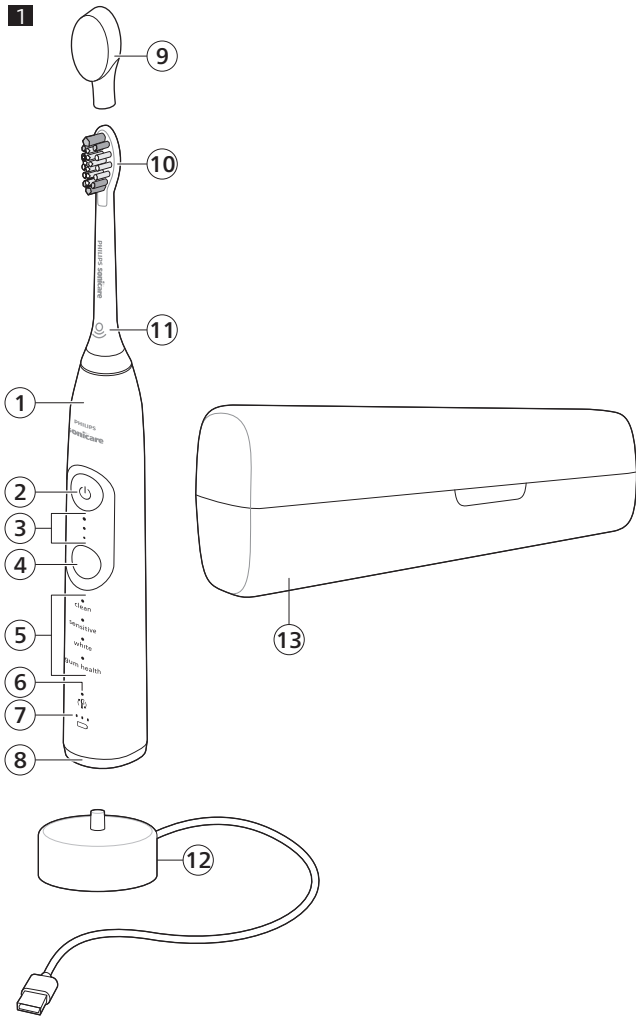

English 5
简体中文 25

Introduction

Welcome to the Philips Sonicare family! This toothbrush enables you to obtain superior plaque removal, whiter teeth and healthier gums. Using Sonicare's combination of gentle sonic technology and clinically developed and proven features, you can be confident that you're getting the very best clean, every time.

Further support and product registration are available to you at:

www.philips.com/support

Important safety information

Only use the product for its intended purpose. Read this information carefully before you use the product and its batteries and accessories, and save it for future reference. Misuse can lead to hazards or serious injuries. Accessories supplied may vary for different products.

Warnings

- This appliance is not intended for use by persons (including children) with reduced physical, sensory or mental capabilities, or lack of experience and knowledge, unless they have been given supervision or instruction concerning use of the appliance by a person responsible for their safety.
- Children should be supervised to ensure that they do not play with the appliance.
- Only connect the appliance to a Safety Extra-Low Voltage (SELV) power source that matches the voltage marking on the appliance. Only charge the appliance with the original Philips USB cable provided. Only use a certified SELV supply unit with output rating 5 V .
- The maximum altitude of use is 4500 meters.
- This appliance contains batteries that are non-replaceable. When the battery is at end of life, it shall be properly disposed of, see section on Recycling and Removal of built-in rechargeable battery.
- Disconnect the power supply when leaving the appliance unattended.
- Stop using the appliance immediately if abnormal noise, odor, overheating, or malfunction occurs. Turn off the switch and disconnect the power supply.
- Do not use the appliance near flammable or explosive materials or in similar hazardous environments.
- Do not disassemble the appliance or modify its internal wiring, components, or protective devices.
- Do not replace fuses in the appliance or power supplies with ordinary conductors or fuses that exceed the specified current rating.

6 English

- Do not change the settings of low-voltage circuit breakers or residual current protective device.
- This appliance does not contain user-serviceable parts. If the appliance or USB cable is damaged, stop using it immediately and contact the Consumer Care Center in your country (see 'Warranty and support').
- Keep the charger away from water.
- Do not use the charger outdoors or near heated surfaces.
- After cleaning, make sure the charger is completely dry before you connect it to the wall socket.
- Make sure brush head and toothbrush are dry before storing in travel case.
- Do not clean any part of the product in the dishwasher unless otherwise instructed in the Cleaning section.
- This appliance has only been designed for cleaning teeth and gums.
- Replace the brush head every 3 months or sooner if signs of wear appear. Stop using a brush head with crushed or bent bristles.
- Rinse the handle, especially the brush head connection. Gently clean around the rubber seal.
- Avoid direct contact with products that contain essential oils or coconut oil. Contact may result in bristles dislodging.
- If your toothpaste contains peroxide, baking soda or bicarbonate (common in whitening toothpastes), thoroughly clean the brush head with soap and water after each use. This prevents possible cracking of the plastic.

Medical warnings

- This appliance is a personal care device and is not intended to be shared by multiple users.
- Stop using the appliance and consult your dentist/doctor if excessive or prolonged bleeding occurs after use, or if you experience discomfort or pain during use.
- If you have a pacemaker or other implanted device, contact your doctor or the manufacturer of the implanted device prior to use.

Battery safety instructions

- Keep product and batteries away from fire and do not expose them to direct sunlight or high temperatures.
- If the product becomes abnormally hot or smelly, changes color or if charging takes longer than usual, stop using and charging the product and contact Philips.
- Do not place products and their batteries in microwave ovens or on induction cookers.

- Do not open, modify, pierce, damage or dismantle the product or battery to prevent batteries from heating up or releasing toxic or hazardous substances. Do not short-circuit, overcharge or reverse charge batteries.
- Charge and use the product at a temperature between 0 °C and 40 °C (32 °F and 104 °F).

Storage and transportation conditions

Temperature -20 °C to +60 °C (-4 °F to 140 °F).

Electromagnetic fields (EMF)

This Philips appliance complies with all applicable standards and regulations regarding exposure to electromagnetic fields.

Your Philips Sonicare (Fig 1.)

- 1 Handle
- 2 Power on/off button
- 3 Intensity indicator
- 4 Mode/intensity button
- 5 Mode indicator
- 6 Brush head replacement reminder
- 7 Battery indicator
- 8 Light ring

Accessories:

- 9 Brush head cap
- 10 Smart brush head(s)
- 11 BrushSync symbol
- 12 Charger
- 13 Travel case

Note: Appearance may slightly differ, depending on the model.

Sonicare app - Getting started

The Sonicare app pairs with your toothbrush to provide you a connected experience. By connecting your toothbrush to your Sonicare app account, you will be able to:

- Track your brushing progress
- Receive personalized tips and actionable recommendations to improve your oral health
- Access the full range of benefits and receive ongoing upgrades

8 English

The app is compatible with a wide range of mobile phones.

To start using the Sonicare app:

- 1 Download the Sonicare app to your phone.
- 2 Ensure that Bluetooth for your phone is turned on.
- 3 Pick up your toothbrush to ensure it is active (lights on).
- 4 Open the app and follow the steps.
- 5 Pair your toothbrush with the app.
- 6 Create your account via the app. Complete firmware update, if prompted, to access the latest improvements and features.
- 7 Brush regularly with your toothbrush connected to the app. When you regularly sync the toothbrush with the app, you will receive updates to help improve your oral healthcare.
- 8 Sync regularly.
- 9 Keep your phone close to your toothbrush for optimal data transfer.

To sync manually: Connect your toothbrush with the app every two weeks to benefit from the app features/capabilities.

To sync automatically: Allow location permission while setting up the app. By allowing location permission, your phone knows when it is in the connection range of your toothbrush and can refresh your brushing data in the app to provide the latest insights and recommendations.

Note: Make sure your phone's Bluetooth is switched on when using the app so that your toothbrush can transfer and update your brushing data in the app. If you have questions about why your brushing data is collected, be sure to review the Sonicare Privacy Statement, available throughout the app setup process.

App features

Your Sonicare power toothbrush is equipped with smart sensors to provide you with feedback about your brushing habits, including:

- Daily brushing sessions
- Time spent during each brushing session
- Applied brushing pressure
- Personalized tips and actionable recommendations
- Brush head replacement reminder (based on actual use)

The Sonicare app collects the data provided by the smart sensors and tracks your brushing habits over time.

Getting started

Attaching the brush head



- 1 Align the brush head so the bristles point in the same direction as the front of the handle.



- 2 Firmly press the brush head down onto the metal shaft until it will not go any further.

Note: It is normal to see a slight gap between the brush head and the handle.

Using your Philips Sonicare toothbrush

If you are using your Sonicare toothbrush for the first time, it is normal to feel more vibration than when using a non-electric toothbrush. It is common for first-time users to apply too much pressure. Only apply gentle pressure and let the toothbrush do the brushing for you. Please follow the brushing instructions below for the best experience.

To help you transition to your new Sonicare power toothbrush, use a lower setting for the first 1-2 weeks, then transition to a higher setting.

Brushing instructions

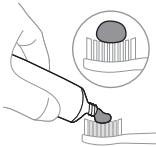

- 1 Wet the bristles and apply a small amount of toothpaste.

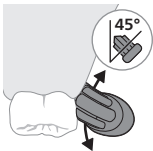

- 2 Place the toothbrush bristles against the teeth at a slight angle (45 degrees), pressing firmly to make the bristles reach the gumline or slightly beneath the gumline.

Note: Keep the center of the brush in contact with the teeth at all times.

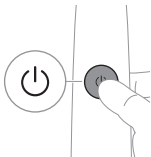

- 3 Press the power on/off button to switch on the Philips Sonicare.

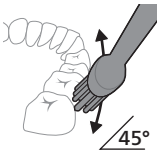

- 4 Gently keep the bristles placed on the teeth and in the gumline. Brush your teeth with small back and forth motion so the bristles reach between the teeth. Continue this motion throughout your brushing cycle.

Note: The bristles should slightly flare. It is not recommended to scrub as you would with a manual toothbrush.

Note: If you apply too much pressure, you will be alerted by a change in vibration of the handle and a flashing purple light ring.

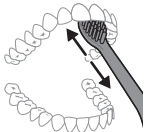

- 5 To clean the inside surfaces of the front teeth, tilt the brush handle semi-upright and make several vertical overlapping brushing strokes on each tooth.
- 6 After you have completed the brushing cycle, you can spend additional time brushing the chewing surfaces of your teeth and areas where staining occurs. You can also brush your tongue, with the toothbrush switched on or off, as you prefer.

Note: Your Philips Sonicare toothbrush is safe to use on braces (brush heads wear out sooner when used on braces) and dental restorations (fillings, crowns, veneers) if they are properly adhered and not compromised.

BrushPacer

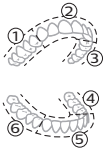

To make sure you brush evenly throughout the mouth, divide your mouth into 6 sections using the BrushPacer feature. The BrushPacer divides the brushing time into 6 equal segments and indicates when you should move to the next area. The segments are indicated with a brief pause in vibration. The toothbrush automatically stops at the end of the brushing session.

Note: Additional time is added when you use the White or Gum Health modes.

Modes

Your power toothbrush is equipped with up to 4 different modes: Clean, Sensitive, White, and Gum Health.

Based on the smart brush head you use, the optimal mode and intensity will be selected automatically by the BrushSync technology.

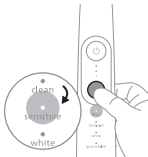

To manually change the mode, press the mode/intensity button when the toothbrush is off. All brush heads work with each mode.

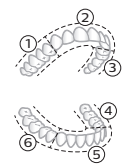
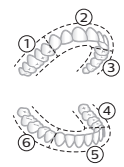
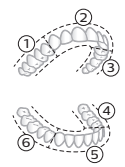
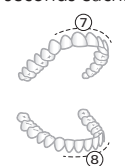
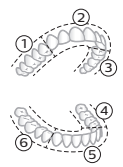
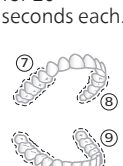
	Clean	Sensitive	White	Gum Health
Benefit	Plaque removal	Extra gentle mode for sensitive teeth and gums	Plaque and surface stains removal	Plaque removal and gum massage
Recommended intensity level	High	Low*	High	High
Total brushing time	2 minutes	2 minutes	2 minutes and 40 seconds	3 minutes and 20 seconds
How to brush	Brush each segment for 20 seconds. 	Brush each segment for 20 seconds. 	Brush each segment for 20 seconds,  then brush segments 7 and 8 for 20 seconds each. 	Brush each segment for 20 seconds,  then brush segments 7,8,9 and 10 for 20 seconds each. 

Note: *Disclaimer is in the EasyStart section.

Intensity settings



Your power toothbrush comes with 3 different intensity settings:

- High intensity (three lights)
- Medium intensity (two lights)
- Low intensity (one light)

Note: High intensity is recommended for best cleaning results.

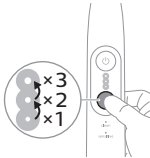

To manually select your desired intensity, press the mode/intensity button when the toothbrush is on to cycle through the options. The intensity setting can only be changed when the toothbrush is on.

BrushSync technology



BrushSync technology enables your brush head to communicate with your handle using a microchip. The  symbol at the bottom of the brush head indicates that the brush head is equipped with this technology.

BrushSync technology enables:

- Brush head replacement reminder
- BrushSync mode pairing

Philips Sonicare offers a wide range of smart brush heads, equipped with BrushSync technology. To explore our full range of toothbrush brush heads, and find the brush head that is best for you, go to

www.philips.com/toothbrush-heads for more information.

Features

- Pressure Sensor Feedback
- BrushPacer
- SmarTimer
- EasyStart
- Brush Head Replacement Reminder
- Brush Head Mode Pairing

Pressure Sensor Feedback

Your Sonicare toothbrush measures the pressure you apply while brushing, to protect your gums and teeth from damage.



If you apply excess pressure, the handle changes its sound and vibration while the light ring flashes purple at the bottom of the handle until you reduce the pressure.

Note: Your product comes with the Pressure Sensor Feedback activated. To deactivate this feature (see 'Activating or deactivating features').

BrushPacer

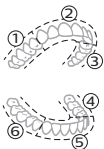

The BrushPacer is an interval timer that helps you to brush evenly through the mouth by dividing your mouth into 6 sections.

SmarTimer

The SmarTimer indicates that your brushing cycle is complete by automatically switching off the toothbrush at the end of the brushing cycle.

Dental professionals recommend brushing no less than 2 minutes twice a day.

Note: If you press the power on/off button after you started the brushing cycle, the toothbrush pauses. If you press the on/off button within 30 seconds,

the timer resumes to allow you to finish your brushing cycle. After a pause of 30 seconds, the SmarTimer resets.

EasyStart

This Philips Sonicare model comes with the EasyStart feature deactivated. The EasyStart feature gently increases the power over the first 14 brushings to help you get used to brushing with the Philips Sonicare. The EasyStart feature works with all modes.

*Disclaimer

When the Philips Sonicare toothbrush is used in clinical studies, it must be used at high intensity with the handle fully charged and the EasyStart feature deactivated.

To activate EasyStart (see 'Activating or deactivating features').

Brush Head Replacement Reminder

Your Philips Sonicare is equipped with BrushSync technology that tracks the wear of your brush head.

Note: This feature only works with Philips Sonicare smart brush heads with BrushSync technology.

- 1 When you attach a new smart brush head for the first time, the handle recognizes that you have a Philips brush head with BrushSync technology and begins tracking brush head wear.
- 2 Over time, based on the pressure you apply and the total time the brush head has been used, the handle tracks brush head wear in order to determine the optimal time to replace your brush head. This feature guarantees the best cleaning and care of your teeth.

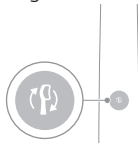

- 3 When the Brush Head Replacement Reminder indicator lights up amber, you should replace your brush head.

Note: All smart brush heads come with the brush head replacement reminder feature activated. To deactivate the brush head replacement reminder see 'Activating or deactivating features'.

Brush head mode pairing

Brush heads with BrushSync technology are equipped with a microchip which communicates with the handle and automatically pairs it with the recommended mode and intensity. Most brush heads with BrushSync technology will auto pair to Clean Mode. Brush heads with specific benefits will pair with the corresponding mode (when available), examples include:

- S2 Sensitive: Sensitive Mode
- W2 Optimal White: White Mode
- G3 Premium Gum Care: Gum Health Mode

Note: If you choose to change mode/intensity from the recommended setting, the brush head will remember the chosen setting for future brushing sessions.

Activating or deactivating features

You can activate or deactivate the following features of your toothbrush:

- EasyStart
- Brush Head replacement reminder
- Pressure Sensor Feedback

Note: The brush head replacement reminder is only compatible with Sonicare smart brush heads. The smart brush head must be attached to the toothbrush in order to activate or deactivate the replacement reminder.

From handle:

Step 1: Place the handle on a plugged in charger.



Step 2: Press and hold power on/off button for:

EasyStart

Brush Head
Replacement
Reminder

Pressure Sensor
Feedback

Up to 3 seconds

Up to 5 seconds

Up to 7 seconds



Step 3: Let go of the power on/off button when you hear:

1 beep

1 beep and then
2 beeps1 beep, 2 beeps and
then 3 beeps

Together with:

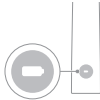

If you see the left LED for the battery indicator flash green 2 times and hear 3 tones low to high, then the feature has been activated.

OR

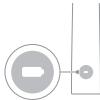

If you see the left LED for the battery indicator flash amber 1 time and hear 3 tones high to low, then the feature has been deactivated.

Charging and battery status

This Philips Sonicare toothbrush is designed to provide on average 42 brushing sessions, each session lasting 2 minutes (21 days if used twice per day) on a fully charged battery. The battery indicator shows the battery status when you complete the 2-minute brushing session, when you pause the toothbrush, or while it is charging.

Note: It can take up to 24 hours to fully charge the battery before first use, but you can use the Philips Sonicare toothbrush before it is fully charged.

Charging

- 1 Attach the USB charging cord to a wall adapter, plug the wall adapter into an electrical wall outlet.

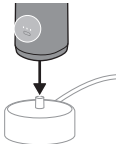

- 2 Place the handle on the charger.
- 3 The battery indicator and light ring illuminate, the handle beeps twice, and all lights on the handle illuminate upward from the bottom of the handle.

- 4 The flashing light of the battery indicator shows that the toothbrush is charging.
- 5 When the handle is on the charger and the battery is fully charged, the LED lights of the battery indicator start flashing green. Once the battery is full, the green light remains solid for 30 seconds and then turns off.

Note: Do not cover the brush head with the brush head cap when charging.

Battery status

Battery status (handle on plugged-in charger)

When the handle is placed on the charger, the battery indicator shows the battery level.

Battery status	Number of flashing LEDs	LED color
Low	1	Flashing green
Partially full	2	Flashing green
Full	3	Flashing green until full, then green for 30 seconds and then switches off

Battery status (when handle is not on plugged-in charger)

When the toothbrush is awake, the battery indicator at the bottom of the handle shows the battery level.

Battery status	Number of LEDs	LED color
Full	3	Solid green
Partially full	2	Solid green
Medium low	1	Solid green
Low	1 with 3 beeps after brushing	Flashes amber
Empty	1 with 2 sets of 5 beeps	Flashes amber

Note: To save energy, the battery indicator will switch off when not in use.

Note: When the battery is completely empty, the toothbrush switches off. Place the toothbrush on the charger to charge it.

Note: To keep the battery fully charged at all times, you may keep your toothbrush on the charger when not in use.

Cleaning

Toothbrush handle

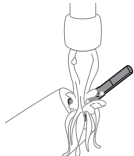

- 1 Remove the brush head and rinse the metal shaft area and buttons with warm water. Make sure you remove any residual toothpaste on the handle and around the buttons at least once a week, but preferably after each use.

Caution: Do not push on the rubber seal on the metal shaft or around buttons with sharp objects, as this may cause damage.

- 2 Wipe the entire surface of the handle with a damp cloth.

Caution: Do not tap the handle on the sink or counter to remove excess water.

- 3 Dry the handle with a soft cloth or towel.

Brush head

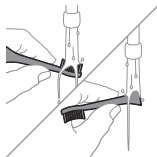

- 1 Rinse the brush head and bristles after each use and allow to air dry.
- 2 Remove the brush head from the handle and rinse the brush head connection with warm water at least once a week. Rinse the travel cap as often as needed and air dry. Use only on a dry brush head.

Note: The brush head cap is used for shipping purposes and is not intended for continued use.

Charger

- 1 Unplug the charger before you clean it.
- 2 Wipe the surface of the charger with a damp cloth.
- 3 Dry the charger with a soft cloth or towel.

Travel case

Rinse with warm water and use a damp cloth to clean the travel case and allow to air dry.

Storage

If you are not going to use the product for an extended period of time, unplug it from the electrical outlet, clean it and store it in a cool and dry place away from direct sunlight.

Brush head replacement

Replace Philips Sonicare brush heads every 3 months to achieve optimal results. Use only Philips Sonicare replacement brush heads.

Locating the model number

Look on the bottom of the Philips Sonicare toothbrush handle for the model number (e.g.HX123A).

Warranty and support

If you need information or support, please visit www.philips.com/support or read the international warranty leaflet.

Warranty restrictions

The terms of the international warranty do not cover the following:

- Brush heads.
- Damage caused by use of unauthorized replacement parts.
- Damage caused by misuse, abuse, neglect, alterations or unauthorized repair.
- Normal wear and tear, including chips, scratches, abrasions, discoloration or fading.

Troubleshooting

This chapter summarizes the most common problems you could encounter with the appliance. If you are unable to solve the problem with the information below, visit www.philips.com/support for a list of frequently asked questions or contact the Consumer Care Center in your country.

Problem	Possible Cause	Solution
I cannot fully attach the brush head. There is a gap between the brush head and handle.		This gap is normal and is needed for the brush head to vibrate appropriately. The brush head must be able to move to create the right amount of vibrations.
My Philips Sonicare toothbrush vibration is less powerful than before.	The brush head is too close to the body of the toothbrush.	Remove the brush head from the handle and re-set it on the metal shaft leaving a small gap. (1-2 mm).
	The toothbrush needs to be charged.	When charging, make sure the charger is plugged into a power supply and placed on a flat surface before placing the toothbrush on the charger. Allow the toothbrush to charge for 24 hours.
I charged my toothbrush, but it only works for a short time.	The base of the toothbrush is not placed flat on the charger when attempting to charge.	Make sure the charger is plugged into a power supply and placed on a flat surface before placing the toothbrush on the charger. Allow the toothbrush to charge for 24 hours.

Recycling



- This symbol means that electrical products and batteries shall not be disposed of with normal household waste.
- Follow your country's rules for the separate collection of electrical products and batteries.

Removal of built-in rechargeable battery

CONTAINS LITHIUM-ION RECHARGEABLE CELL. MUST BE RECYCLED OR DISPOSED OF PROPERLY.

The built-in rechargeable battery must be removed by a qualified professional when the product is discarded. Before removing the battery, make sure that the battery is completely empty.

Take any necessary safety precautions when you handle tools to open the appliance and when you dispose of the rechargeable battery.

When you handle batteries, make sure that your hands, the product and the batteries are dry.

If batteries are damaged or leaking, avoid contact with the skin or eyes. If this occurs, immediately rinse well with water and seek medical care.

To avoid accidental short-circuiting of batteries after removal, do not let battery terminals come into contact with metal objects (e.g. coins, hairpins, rings). Do not wrap batteries in aluminum foil. Tape battery terminals or put batteries in a plastic bag before you discard them.

Do not reinstall battery once it has been removed for recycling. Consumer installation of battery may increase risk of fire or other potential safety hazards.

- Tools: T8 TORX screwdriver, #2 Phillips-head screwdriver, and plastic pry tool (or guitar pick).

- 1 When possible, deplete the rechargeable battery of any charge. To do this, remove the toothbrush from the charger, turn on the toothbrush and let it run until it stops. Repeat this step until you can no longer turn on the Philips Sonicare toothbrush.
- 2 Remove the brush head from the toothbrush.

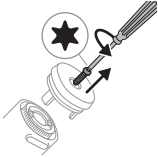

- 3 Using a T8 TORX screwdriver, unscrew and remove (counterclockwise) the screw from the base of the toothbrush handle.

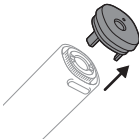

- 4 Remove the endcap from the base of the toothbrush. If the endcap is tight and does not release easily from the housing tube, use a plastic pry tool to help separate the endcap from the housing tube.



- 5 Use a Phillips screwdriver to rotate the metal locking tab inside the bottom center of the toothbrush. Turn counterclockwise until rotation stops (less than a 1/4 of a turn).

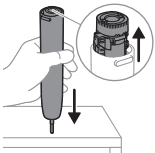

24 English

- 6 To release the internal components from the housing tube, firmly press the metal shaft onto a solid surface (do not slam the handle down with force). If the internal components do not easily release from the housing tube, double check that you have completed step 5 above.
- 7 Gently pull the internal assembly to remove it from the base of the housing tube.

Caution: To avoid injury or damage to the product, be aware of the sharp edges and exposed electronic components.

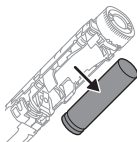

- 8 Pinch the battery and pull it away from the battery tray.

Caution: Do not use screwdriver or metal object to pry the battery out of the battery tray.

- 9 For battery disposal, cover the battery contacts with tape to prevent any electrical short from residual battery charge. The used rechargeable battery can now be recycled through your community battery or electronics disposal process.



简介

欢迎使用 Philips Sonicare 声波振动牙刷系列产品！本款牙刷出色地清除牙菌斑，让牙齿更洁白，牙龈更健康。

Sonicare 声波振动牙刷融合了轻柔声波技术与专业验证功能，确保您每次使用均可获得良好的清洁效果。

有关更多支持和产品注册信息，请访问以下网

站：www.philips.com/support

重要安全信息

仅可将本产品用于预期用途。使用本产品及其电池和附件之前，请仔细阅读本信息，并妥善保管以供日后参考。误用可能会导致危害或严重伤害。附件可能因产品而异。

警告

- 器具不打算由存在肢体、感官或精神能力缺陷或缺少使用经验和知识的人（包括儿童）使用，除非有负责他们安全的人对他们进行与器具使用有关的监督或指导。
- 应照看好儿童，确保他们不玩耍本器具。
- 本使用说明所述的供电电源都必须满足以下要求：应仅使用标记在器具上的安全特低电压供电；请仅使用随附的Philips原装充电线对产品进行充电；与充电线连接的供电电源，其额定输出电压为5V $\overline{\text{---}}$ ，且同时满足安全特低电压要求。
- 该器具使用的最高海拔是 4500 米。
- 本器具包含不可更换的电池。弃置电池时，请参阅“回收”和“取出内置充电电池”章节，采取正确的方式处理本产品。
- 人员离开现场时，请将电源断开。

- 产品出现异常噪声、异常气味、异常高温或故障时，请立即停止使用，关闭开关，断开电源。
- 本产品不应在易燃易爆物品附近或类似环境中使用。
- 使用者不应自行拆卸家用电器，不应变更内部接线、部件和保护装置。
- 使用者不应以普通导体或超出规定电流容量的熔断体替换家用电器和电源的熔断体。
- 使用者不应自行改变低压断路器或剩余电流动作保护器的设定值。
- 本产品中不包含用户可维修的部件。如果本产品或 USB 线缆损坏，立即请停止使用，并联系您所在国家/地区的客户服务中心（请参见“保修和支持”）。
- 请将充电座远离水源。
- 切勿在户外或高温表面附近使用充电座。
- 清洁后，务必确保充电座完全干燥，再将其连接到本使用说明所述的供电电源。
- 在将刷头和牙刷存放在旅行收纳盒中之前，请确保其干燥。
- 请勿使用洗碗机清洗产品的任何配件，除非“清洁”章节里另有说明。
- 本产品设计仅用于清洁牙齿和牙龈。
- 请每 3 个月更换一次牙刷头，如果出现磨损迹象，应提前更换。请停止使用变形或刷毛弯曲的牙刷头。
- 每次刷完牙后冲洗手柄，特别是刷头连接处。在橡胶密封圈周围轻轻擦拭。
- 避免直接接触含有精油或椰子油的产品。否则可能导致刷毛脱落。

- 如果您所用的牙膏中含有过氧化物、碳酸氢钠或其它重碳酸盐（增白牙膏中的常见成份），则请务必在每次使用后用肥皂和水彻底清洗牙刷头。这可以预防可能出现的塑料破裂。

医疗警告

- 本产品是个人护理设备，不适合多用户共用。
- 如果使用本产品后牙龈大量出血或持续性出血，或者在使用过程中感觉不适或疼痛，请停止使用本产品并咨询您的牙医/医生。
- 如果您体内有心脏起搏器或其他植入设备，请在使用之前咨询医生或相关植入装置的制造商。

电池安全说明

- 请将产品和电池远离火源，切勿将其暴露于阳光直射处或高温下。
- 如果产品异常发热或发出异味、变色或充电时间比平时长，请停止使用并停止为其充电，并联系 Philips。
- 切勿将产品及其电池放置在微波炉中或电磁炉上。
- 为防止电池发热或释放有毒有害物质，切勿打开、改装、刺穿、损坏或拆卸产品或电池。切勿使电池短路、过度充电或反向充电。
- 充电和使用本产品的温度应介于 0 ° C 至 40 ° C 之间。

存放和运输条件

温度：-20 ° C 至 +60 ° C。

电磁场 (EMF)

本Philips产品符合所有有关暴露于电磁场的适用标准和法规。

您的 Philips Sonicare (图 1)

- 1 手柄
 - 2 电源开/关按钮
 - 3 强度指示灯
 - 4 模式/强度按钮
 - 5 模式指示灯
 - 6 刷头更换提醒
 - 7 电池指示灯
 - 8 灯环
- 配件：**
- 9 刷头保护盖
 - 10 智能牙刷头
 - 11 BrushSync 指示灯
 - 12 充电座
 - 13 旅行收纳盒

注意：外观或随附的配件可能略有不同，具体取决于型号。

Sonicare 应用程序 – 使用入门

Sonicare 应用程序与您的牙刷配对后可提供互联体验。

将牙刷连接到 Sonicare 应用程序帐户，您将能够：

- 跟踪刷牙进度
- 接收个性化提示和可行建议，改善您的口腔健康
- 享受全部益处以及持续优化的升级

该应用程序与多种手机兼容。

要开始使用 Sonicare 应用程序，请执行以下操作：

- 1 将 Sonicare 应用程序下载到您的手机。
- 2 请确保手机的蓝牙已开启。
- 3 拿起牙刷以确保其处于启用状态（灯亮）。
- 4 打开应用程序并按步骤操作。
- 5 将牙刷与应用程序配对。
- 6 通过应用程序创建您的帐户。如果提示您完成固件更新，请完成以使用最新的改进和功能。
- 7 定期使用与应用程序连接的牙刷刷牙。如果您定期将牙刷与应用程序同步，就可以接收更新，帮助您改善口腔护理。
- 8 定期同步。
- 9 为获得较好的数据传输效果，请将牙刷靠近手机。

如要手动进行同步：每两周将牙刷与应用程序进行一次连接，以便充分使用应用程序的功能/性能。

如要自动进行同步：设置应用程序时允许使用位置权限。通过允许使用位置权限，您的手机可以了解其何时处于牙刷的连接范围内，并可以在应用程序中更新刷牙数据，以提供最新的见解和建议。

注意：使用应用程序时，请确保手机的蓝牙已打开，这样牙刷就可以在应用程序中传输和更新刷牙数据。如果您对于为什么要收集您的刷牙数据有疑问，请务必查看“Sonicare 隐私声明”，该声明会在应用程序的整个安装过程中提供。

应用程序功能

您的 Sonicare 电动牙刷配有智能传感器，可为您提供有关刷牙习惯的反馈，包括：

- 每天的刷牙次数
- 每次刷牙花费的时间
- 施加的压力
- 个性化提示和可行建议
- 刷头更换提醒（根据实际使用情况）

Sonicare 应用程序收集智能传感器提供的数据，并跟踪您的刷牙习惯。

开始使用

安装刷头



- 1 对刷牙刷头，使刷毛方向与牙刷手柄正面的方向一致。



- 2 用力将刷头向下按到金属轴上，直到按不动为止。

注意：刷头与手柄之间会有小间隙，这是正常的。

使用您的 Philips Sonicare 声波振动牙刷

如果您是首次使用 Sonicare 声波振动牙刷，通常会感觉其振动幅度比非电动牙刷更强烈。用户首次使用时通常会用力过度。您只需轻轻按压牙刷，将刷牙的工作交给牙刷即可。请按照下方的刷牙说明操作以获得最佳体验。

为了帮助您顺利过渡到使用新 Sonicare 电动牙刷，请在前 1-2 周使用较低的强度设置，适应之后再切换到较高的强度设置。

刷牙说明



- 1 浸湿刷毛并挤上少量牙膏。

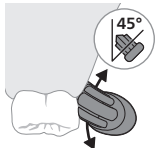

- 2 将牙刷的刷毛以小角度（45 度）放在牙齿上，有力地按压以使刷毛接触牙龈或牙龈略下方。

注意：始终将牙刷中间与牙齿接触。

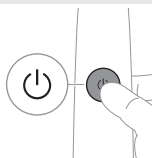

- 3 按开/关按钮打开飞利浦 Sonicare 声波振动牙刷。

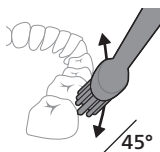

- 4** 将刷毛轻轻放置于牙齿和牙龈上，来回小幅度缓慢移动，这样可以让刷毛能够刷到牙缝。在整个刷牙周期中连续这样移动即可。

注意：刷毛应稍微呈喇叭形。建议不要像使用手动牙刷一样用力摩擦齿面。

注意：如果刷牙力度过大，您会感受到手柄振动的变化，并看到闪烁的紫色光环。

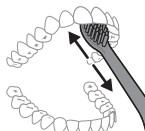

- 5** 要清洁门牙内表面，请将牙刷手柄呈半直立状倾斜，在每颗牙齿上反复垂直振动。
- 6** 在完成刷牙周期之后，您可以多花一些时间刷洗牙齿的咀嚼面以及齿垢容易出现的区域。您还可以使用该牙刷清洁舌头，牙刷电源打开或关闭均可。

注意： Philips Sonicare 声波振动牙刷可安全用于正确固定且未损坏的牙齿矫正器（在牙齿矫正器上使用时，刷头磨损较快）和修复牙体（补牙、齿冠、烤瓷牙）。

分区计时器

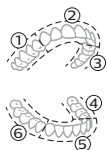

为确保均匀地清洁牙齿，请使用分区计时器功能将口腔分为6个区域。分区计时器功能将刷牙时间平均分为6个时段，并提醒您将牙刷移到下一个刷牙区域。两个刷牙时段中间会有一次短暂的停顿。刷牙周期结束时，牙刷会自动停止。

注意：当您使用亮白或牙龈健康模式时，牙刷会自动延长刷牙时间。



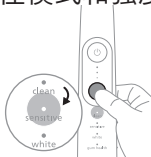

模式

您的电动牙刷具有 4 种不同的模式：清洁、敏感、亮白和牙龈健康。

根据您使用的智能刷头，BrushSync 技术将自动选择最佳模式和强度。

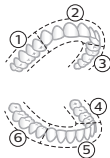
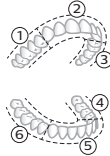
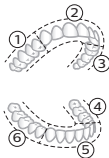

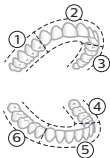
要手动更改模式，请在牙刷关闭时按下模式/强度按钮。所有刷头都可以使用每种模式。

	清洁	敏感	亮白	牙龈保健
作用	去除牙菌斑	针对敏感牙齿和牙龈的极柔模式	去除牙菌斑和污渍	去除牙菌斑和按摩牙龈
建议的强度级别	高	低*	高	高
总刷牙时间	2 分钟	2 分钟	2 分 40 秒	3 分 20 秒
如何刷牙	每个区域刷 20 秒。 	每个区域刷 20 秒。 	每个区域刷 20 秒，  然后区域 7 和 8 各刷 20 秒。 	每个区域刷 20 秒，  然后区域 7,8,9 和 10 各刷 20 秒。 

注意：*免责声明详见 EasyStart 新手适应程序部分。

强度设置

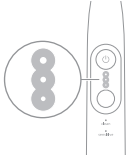

您的电动牙刷提供 3 种不同的强度设置：

- 高强度（三个灯）
- 中等强度（两个灯）
- 低强度（一个灯）

注意：为达到最佳清洁效果，建议使用高强度。

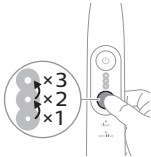

如要手动选择所需强度，请在牙刷打开时按下模式/强度按钮，以在不同强度中循环切换。只有当牙刷打开时，才能更改强度设置。

BrushSync 技术



BrushSync 技术使刷头能够使用微芯片与手柄进行通信。刷头底部的 ☺ 符号表示刷头采用了此项技术。

BrushSync 技术支持：

- 刷头更换指示灯
- BrushSync 模式配对

Philips Sonicare 声波振动牙刷提供一系列智能刷头，配备了 BrushSync 技术。要了解我们的全系列刷头，并寻找最适合您的刷头，请访问

www.philips.com/toothbrush-heads 了解更多信息。

功能

- 压力传感器反馈
- BrushPacer 分区计时器
- SmarTimer 智能计时器
- EasyStart 新手适应程序
- 刷头更换提醒
- 刷头模式配对

压力传感器反馈

Sonicare 牙刷可测量您刷牙时施加的压力，从而防止损伤牙龈和牙齿。



如果用力过大，手柄的声音和振动会发生变化，同时手柄底部的灯环会闪烁紫色，直到您减轻力度。

注意：本产品出厂时已启用压力传感器反馈。要禁用此功能（请参见“启用或禁用功能”）。

BrushPacer 分区计时器

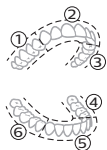

分区计时器帮助您均匀彻底地刷净口腔的6个区域。

SmarTimer 智能计时器

智能计时器在刷牙周期结束时会自动关闭牙刷，指示您的设定刷牙周期已完成。

牙科专家建议每天刷牙两次，每次不少于 2 分钟。

注意：如果在开始刷牙周期后按下电源开/关按钮，牙刷将暂停。如果您在 30 秒内按下开/关按钮，则计时器将继续运行以让您完成刷牙周期。暂停 30 秒后，智能计时器将重置。

EasyStart 新手适应程序

本型号的 Philips Sonicare 声波振动牙刷出厂时未启用 EasyStart 新手适应程序功能。EasyStart 新手适应程序在前 14 次刷牙时会缓慢增加动力，以帮助您适应使用 Philips Sonicare 声波振动牙刷刷牙。EasyStart 新手适应程序适用于所有模式。

*免责声明

Philips Sonicare 声波振动牙刷用于临床研究时，必须处于高强度模式，手柄必须充满电且应禁用 EasyStart 新手适应程序功能。

要启用 EasyStart 新手适应程序功能 (请参见“启用或禁用功能”)。

刷头更换指示灯

这款 Philips Sonicare 声波振动牙刷采用 BrushSync 技术，可跟踪刷头的磨损情况。

注意：此功能仅适用于采用 BrushSync 技术的 Philips Sonicare 声波振动牙刷的智能刷头。

- 1 首次安装新的智能刷头时，手柄会识别出您使用的是采用 BrushSync 技术的 Philips 刷头，并开始跟踪刷头的使用情况。
- 2 随着时间的推移，根据您施加的力度和刷头的使用总时间，手柄将跟踪刷头使用情况，以确定更换刷头的最佳时间。此功能可确保您的牙齿获得更好的清洁与护理。

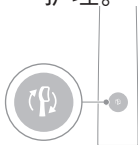

- 3 当刷头更换指示灯呈琥珀色亮起时，应当更换刷头。

注意：对于所有智能刷头，刷头更换指示灯功能已启用。要禁用刷头更换指示灯，请参见“启用或禁用功能”。

刷头模式配对

采用 BrushSync 技术的刷头配有微芯片，可与手柄通信并自动将其与推荐的模式和强度配对。大多数采用了 BrushSync 技术的刷头都将自动与清洁模式配对。具有特定优点的刷头将与相应的模式（当可用时）配对，示例包括：

- S2 智能护敏刷头：敏感模式

- W2 智能亮白刷头：亮白模式
- G3 智能超效护龈刷头：牙龈健康模式

注意：如果您选择更改推荐的模式/强度设置，则刷头将记住您选择的设置以便在将来的刷牙阶段使用。

启用或禁用功能

您可以激活或停用牙刷的以下功能：

- EasyStart 新手适应程序
- 刷头更换提醒
- 压力传感器反馈

注意：刷头更换提醒仅与 Sonicare 智能刷头兼容。必须将智能刷头安装到牙刷上才能激活或停用更换提醒功能。

手柄的操作：

第 1 步：将手柄放在连接到供电电源的充电座上。



第 2 步：按住电源开/关按钮：

EasyStart 新手适应程序	刷头更换提醒	压力传感器反馈
最多 3 秒钟	最多 5 秒钟	最多 7 秒钟
↓	↓	↓



第 3 步：当您听到以下声音时松开电源开/关按钮：

1 声蜂鸣音	1 声蜂鸣音，然后 2 声蜂鸣音	1 声蜂鸣音，然后 2 声蜂鸣音，最后 3 声蜂鸣音
--------	------------------	----------------------------

↓	↓	↓
---	---	---

以及：

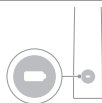

如果您看到左侧电量 LED 指示灯呈绿色闪烁 2 次，并听到 3 声从低到高的音调，则表明已激活该功能。

或者

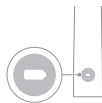

如果您看到左侧电量 LED 指示灯呈琥珀色闪烁 1 次，并听到 3 声从高到低的音调，则表明已停用该功能。

充电与电池状态

这款 Philips Sonicare 声波振动牙刷在电池充满电后，平均可提供 42 个刷牙阶段，每个阶段持续 2 分钟（如果每天刷牙两次，可用 21 天）。当您完成 2 分钟的刷牙阶段、暂停牙刷或进行充电时，电池电量指示灯会显示电池状态。

注意：首次使用前，电池充满电需要 24 小时，但 Philips Sonicare 声波振动牙刷在未完全充满时亦可使用。

充电

- 1 将充电座连接到供电电源。

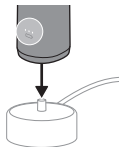

- 2 将牙刷手柄放在充电座上。
- 3 电池指示灯和光环亮起，手柄发出两声蜂鸣音，并且手柄上的所有灯会从手柄底部向上亮起。
- 4 电池指示灯闪烁表示牙刷正在充电。
- 5 将手柄放在充电座上且电池充满电时，电量 LED 指示灯开始闪烁绿色。电池充满电后，绿灯将持续亮起 30 秒，然后熄灭。

注意：充电时请勿盖上刷头保护盖。

电池状态

电池状态（手柄置于连接供电电源的充电座上时）

将手柄放在充电座上时，电池指示灯将显示电池电量。

电池状态	闪烁的 LED 灯数	LED 灯的颜色
低	1	呈绿色闪烁
半满	2	呈绿色闪烁
已满	3	闪烁绿色直至充满，再闪烁绿色 30 秒，然后熄灭

电池状态（手柄未置于连接供电电源的充电座上时）
牙刷开启后，手柄底部的电池指示灯将显示电池电量。

电池状态	亮起的 LED 灯的数量	LED 灯的颜色
已满	3	绿色常亮
半满	2	绿色常亮
中低	1	绿色常亮
低	1 个，刷牙后发出 3 声蜂鸣音	呈琥珀色闪烁
耗尽	1 个，2 组 5 声蜂鸣音	呈琥珀色闪烁

注意：为了节能，在不使用时，电池指示灯会熄灭。

注意：电池电量完全耗尽时，牙刷会关闭。请将牙刷放在充电座上进行充电。

注意：为确保电池始终电量充沛，您可在不使用时将牙刷置于充电座上。

清洁

牙刷手柄

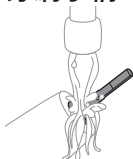

- 1 卸下刷头并用温水冲洗金属轴区域和按钮。确保每周至少清除一次手柄上和按钮周围的任何残留牙膏，最好在每次使用后清除。

警告：请勿使用尖锐物品按压金属轴上或按钮周围的橡胶密封圈，否则可能造成损坏。

- 2 使用湿布擦拭牙刷柄的整个表面。

警告：请勿在水槽或台面上轻敲手柄以去除多余的水分。

- 3 用软布或毛巾擦干手柄。

刷头

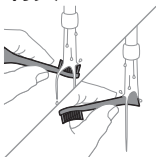

- 1 每次使用后，请冲洗刷头和刷毛，并让其风干。
- 2 从手柄上卸下刷头，每周至少用温水冲洗一次刷头连接处。请根据需要经常冲洗旅行保护盖并晾干。请仅在干刷头上使用。

注意：刷头盖用于运输目的，不适合继续使用。

充电座

- 1 清洁产品前，请先将充电座的供电电源拔掉。
- 2 使用湿布擦拭充电座的表面。
- 3 用软布或毛巾擦干充电座。

旅行收纳盒

用温水冲洗并用湿布清洁旅行收纳盒并自然晾干。

存放

如果打算较长时间不使用产品，请断开充电座的供电电源，对产品和充电座进行清洁并且储藏于凉爽、干燥且远离阳光直射的地方。

刷头更换

每 3 个月更换一次 Philips Sonicare 刷头，以获得最佳效果。仅使用 Philips Sonicare 声波振动牙刷替换刷头。

查找型号

查看 Philips Sonicare 声波振动牙刷手柄的底部，即可了解具体型号（例如 HX123A）。

保修和支持

如需信息或支持，请访问 www.philips.com/support 或阅读保修卡。

保修限制

国际保修条款中不包括以下各项：

- 刷头。
- 因使用未授权的备件而造成的损坏。
- 由于误用、滥用、疏忽、改装或擅自修理造成的损坏。
- 正常磨损，包括裂口、擦痕、磨损、变色或褪色等。

故障处理方法

本章归纳了使用本产品时最常见的一些问题。如果您无法根据以下信息解决问题，请访问

www.philips.com/support 查阅常见问题列表，或联系您所在国家/地区的客户服务中心。

问题	可能的原因	解决方法
我无法将刷头安装到位。刷头和手柄之间有间隙。		此间隙是正常的，牙刷头需要此间隙进行适当地振动。刷头需要能够移动，才能产生适当的振动效果。
我的 Philips Sonicare 牙刷振动强度不如以前。	刷头与牙刷的主体距离过近。	从手柄上拆下刷头，然后将其重新安装到金属轴上，留出一点间隙。（1-2 毫米）。
	牙刷需要充电。	充电时，请确认充电座已连接到供电电源，并放置在平坦的表面上，然后再将牙刷放在充电座上。让牙刷充电 24 小时。
我给牙刷充过电，但很快就没电了。	牙刷在充电时，其底座没有平放在充电座上。	请确认充电座已连接到供电电源，并放置在平坦的表面上，然后再将牙刷放在充电座上。让牙刷充电 24 小时。

回收



- 此符号表示电器产品和电池不能与一般的生活垃圾一同弃置。
- 请遵守您所在国家/地区有关分类回收电器产品和电池的规定。

产品中有害物质的名称及含有的信息表										
部件名称	有害物质									
	铅 (Pb)	汞 (Hg)	镉 (Cd)	六价铬 (Cr ⁶⁺)	多溴联苯 (PBBs)	多溴二苯醚 (PBDEs)	邻苯二甲酸 二正丁酯 (DBP)	邻苯二甲酸 二异丁酯 (DIBP)	邻苯二甲酸 丁苄酯 (BBP)	邻苯二甲酸二 (2-乙基) 己酯 (DEHP)
牙刷手柄	X	○	○	○	○	○	○	○	○	○
牙刷头	○	○	○	○	○	○	○	○	○	○
充电底座	X	○	○	○	○	○	○	○	○	○

注 1: 表示该有害物质在该部件所有均质材料中的含量均不超出电器电子产品有害物质限制使用国家标准要求。
 X: 表示该有害物质至少在该部件的某一均质材料中的含量超出电器电子产品有害物质限制使用国家标准要求。
 注 2: 以上未列出的部件, 表明其有害物质含量均不超出电器电子产品有害物质限制使用国家标准要求。

取出内置充电电池

内含可充电锂电池。请务必妥善回收或处置。

在废弃器具前, 必须将电池从器具中取出; 取出电池之前, 请确保电池电量已完全耗尽。

当您使用工具打开产品时以及在您弃置充电电池时, 请采取必要的安全保护措施。

处理电池时, 请确保您的双手、产品和电池都是干燥的。

如果电池损坏或出现泄漏, 请避免与皮肤或眼睛接触。如果不慎接触, 请立即用清水冲洗并就医。

为避免电池拆卸后发生意外短路，切勿让电池端子接触金属物体（例如硬币、发夹、戒指）。切勿用铝箔包裹电池。在丢弃之前，请用胶带将电池端子粘住或将电池放在塑料袋中。

电池一旦拆卸回收，请勿重新装回。消费者安装电池可能会增加火灾或其他潜在安全隐患的风险。

- 工具：T8 TORX 螺丝刀、#2 十字螺丝刀和塑料撬挖工具（或吉他拨片）。
- 1 尽可能耗尽充电电池的电量 从充电座上取下牙刷，启动牙刷并让其运行直到停止。重复这一步骤，直至 Philips Sonicare 声波振动牙刷无法再打开。
- 2 从牙刷上取下刷头。

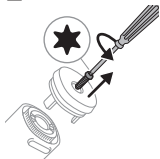

- 3 使用 T8 TORX 螺丝刀，逆时针转动，取下牙刷手柄底部的螺丝。

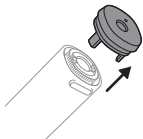

- 4 从牙刷底部取下端盖。如果端盖过紧，不易从套管中取出，请使用塑料撬挖工具，将端盖与套管分离。

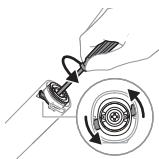

- 5 使用十字螺丝刀旋转牙刷底部中央的金属锁扣。逆时针旋转直至停止（不超过 1/4 圈）。

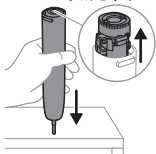

- 6 为了将内部组件从套管中拆下，请将金属轴牢牢压在硬表面上（请勿用力撞击手柄）。如果难以从套管中取出内部组件，请再次确认您已完成上述步骤 5。
- 7 轻轻拉动内部组件，将其从套管的底部取出。

警告：为避免受伤或损坏产品，请注意锋利边缘和外露的电子元件。

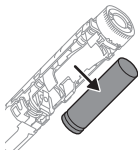

- 8 拿起电池，将其从电池托盘中拉出。

警告：请勿使用螺丝刀或金属物品将电池从电池托盘中取出。

- 9 弃置电池时，用胶带封住旧电池的触点，以防止因电池中的剩余电量而造成任何电气短路。现在，使用过的充电电池可以通过您的社区电池或电子元件处理流程进行回收。



NFC 使用说明：

1、本设备所使用的 NFC 功能符合“微功率短距离无线电发射设备目录和技术要求”第一条通用微功率设备第 3 款 C 类设备的规定，使用频率为 13553-13567kHz，内置环绕形天线，用户不能设置此功能。

2、承诺不擅自改变使用场景或使用条件、扩大发射频率范围、加大发射功率（包括额外加装射频功率放大器），不擅自更改发射天线；

3、承诺不对其他合法的无线电台（站）产生有害干扰，也不提出免受有害干扰保护；

4、承诺可承受辐射射频能量的工业、科学及医疗（ISM）应用设备的干扰或其他合法的无线电台（站）干扰；

5、承诺如对其他合法的无线电台（站）产生有害干扰时，将立即停止使用，并采取措施消除干扰后才继续使用；

6、在航空器内和依据法律法规、国家有关规定、标准划设的射电天文台、气象雷达站、卫星地球站（含测控、测距、接收、导航站）等军民用无线电台（站）、机场等的电磁环境保护区域内使用微功率设备，应当遵守电磁环境保护及相关行业主管部门的规定；

7、禁止在以机场跑道中心点为圆心、半径 5000 米的区域内使用各类模型遥控器；

8、本设备使用环境温度范围为 0℃ 至 40℃，NFC 功能由电池供电。

无线充电设备使用说明：

(一)产品名称：飞利浦电动牙刷充电座。型号：HX6110；

(二)设备采用的无线充电机理是电磁感应，额定传输功率是 0.378W，额定工作频率范围是 120-140kHz；

(三)设备符合国家《无线充电（电力传输）设备无线电管理暂行规定》以及产品质量、电磁辐射和电气安全等法律法规、国家标准等有关规定；

(四)不得擅自改变使用场景或使用条件、扩大工作频率范围、加大传输功率（包括额外加装功率放大器）；

(五)不得对其他合法的无线电业务及台（站）产生有害干扰，也不得提出免受无线电干扰和辐射无线电波干扰的保护要求，如对其他合法的无线电业务及台（站）产生有害干扰时，应立即停止使用，并在采取措施消除有害干扰后方可继续使用；

(六)无线充电设备禁用区域，禁止使用无线充电功能；

(七)使用无线充电设备如对广播业务的接收造成影响，应立即停止使用无线充电设备；

(八)在船舶、航空器和铁路机车（含动车组列车）内使用无线充电设备应当遵守本规定及相关行业主管部门的规定；

(九)其他需要说明的事项：无。

PHILIPS

产品：飞利浦可充电声波电动牙刷
型号：HX7481
额定电压：5V **===** IPX7
额定输入功率：1.5W
生产日期：请见产品底部
整机产地：中国广东珠海
本产品包含以下部件：
刷头数量：2件
手柄型号/数量：HX742A/1件
充电座型号/数量：HX6110/1件

本产品的型号核准代码标识在产品标牌上

珠海经济特区飞利浦家庭电器有限公司
珠海市金湾区三灶镇定湾二路365号
全国顾客服务热线：4008 800 008

本产品根据国标 GB39669-2020，工信部
无【2021】129号制造

PHILIPS

产品：飞利浦可充电声波电动牙刷
型号：HX7481
额定电压：5V **===** IPX7
额定输入功率：1.5W
生产日期：请见产品底部
整机产地：中国广东珠海
本产品包含以下部件：
刷头数量：2件
手柄型号/数量：HX742B/1件
充电座型号/数量：HX6110/1件

本产品的型号核准代码标识在产品标牌上

珠海经济特区飞利浦家庭电器有限公司
珠海市金湾区三灶镇定湾二路365号
全国顾客服务热线：4008 800 008

本产品根据国标 GB39669-2020，工信部
无【2021】129号制造

保留备用 发行日期：2025/10/22

— |

| —

— |

| —

— |

| —

— |

| —

— |

| —

— |

| —

www.philips.com/Sonicare

©2025 Koninklijke Philips N.V. (KPNV). All rights reserved. Philips and the Philips shield are trademarks of KPNV. Sonicare and the Sonicare logo are trademarks of Philips Oral Healthcare, LLC and/or KPNV.

©2025 Koninklijke Philips N.V. (KPNV)。保留所有权利。飞利浦及飞利浦盾牌标志是 KPNV 的商标。Sonicare 和 Sonicare 徽标是 Philips Oral Healthcare, LLC 和/或 KPNV 的商标。

©2025 Koninklijke Philips N.V. (KPNV)。版權所有。飛利浦及飛利浦盾牌標誌為 KPNV 的商標。Sonicare 及 Sonicare 標誌為飛利浦口腔保健公司和/或 KPNV 的商標。

300014630341 (2025/10/22)

