

# PHILIPS

## Television Quick Start Guide 8100 series

  
N080105-004477-003  
The actual accessories may vary from the illustrations, which are for reference only.



Tool needed  
for assembly

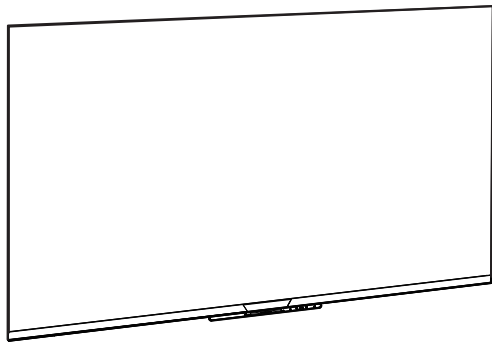

- 43" 50" 55" (Q4xL18) x 4
- 65" (Q4xL25) x 4
- 75" (M5xL15) x 4

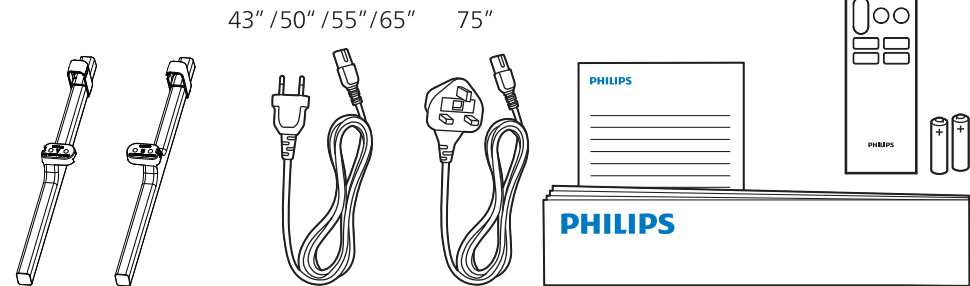

1 43"/50"/55"

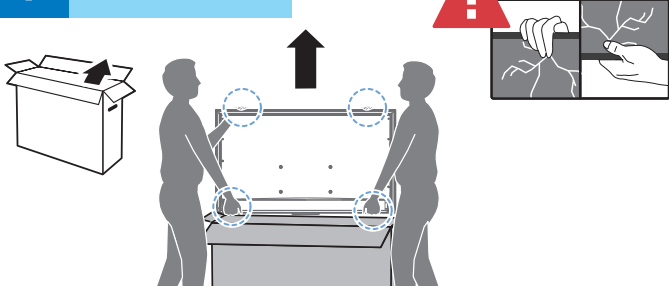

65"/75"

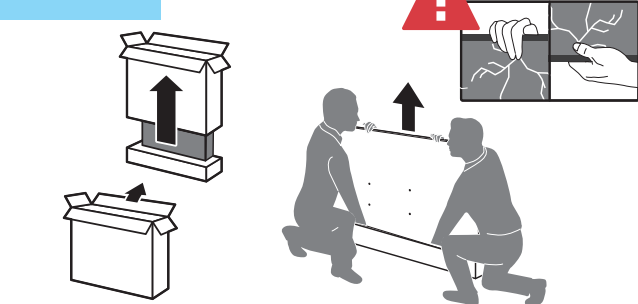

2

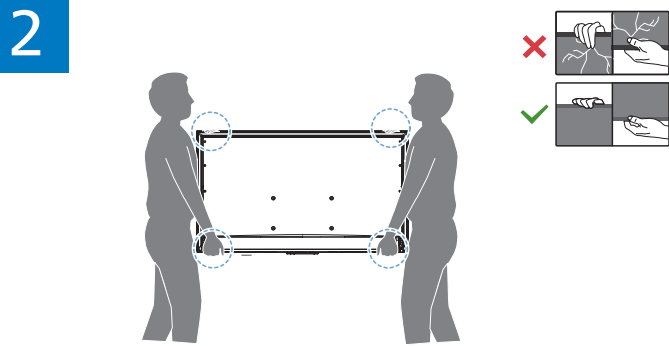

3

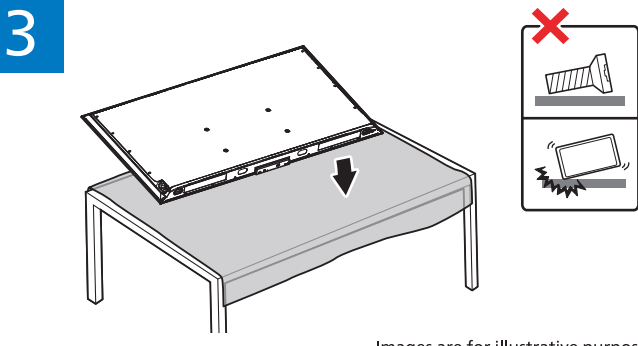

Images are for illustrative purpose.

A

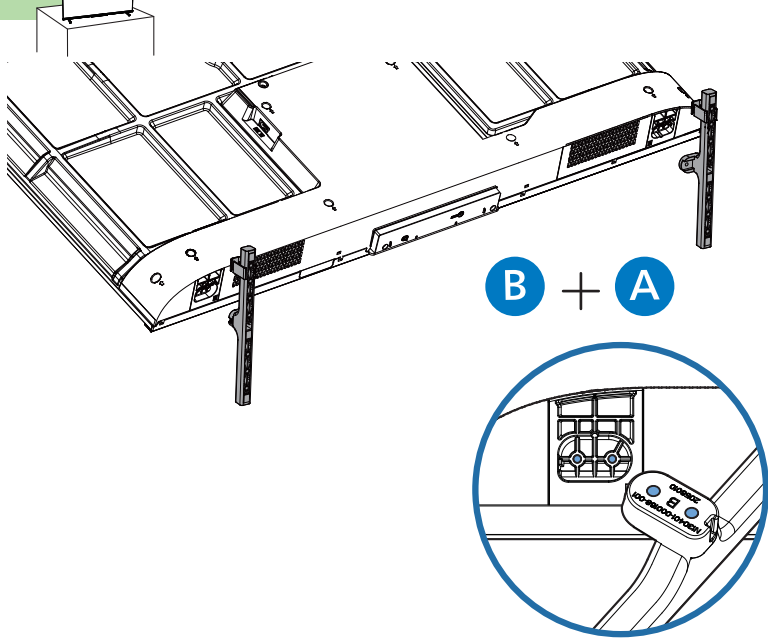

B + A

A Desk Placement

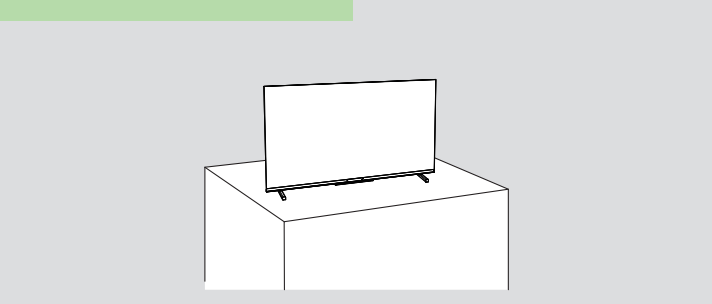

B Wall Placement

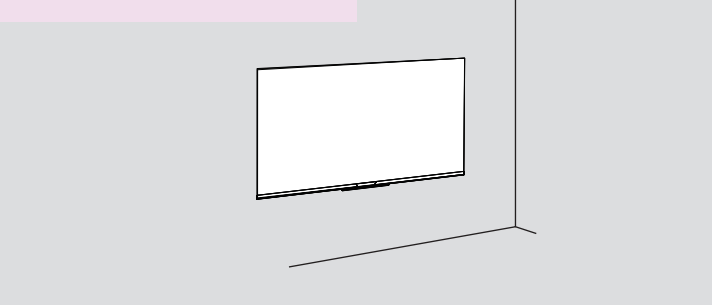

Desk Placement (using table stand)

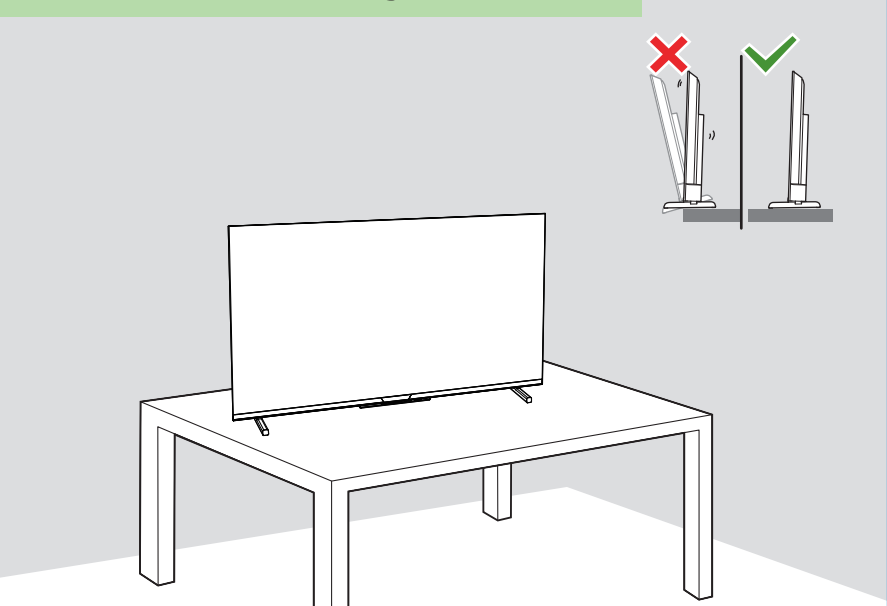

3

Register and Support



[www.philips.com/TVsupport](http://www.philips.com/TVsupport)  
Register your TV, find out more,  
download the user manual and  
get support

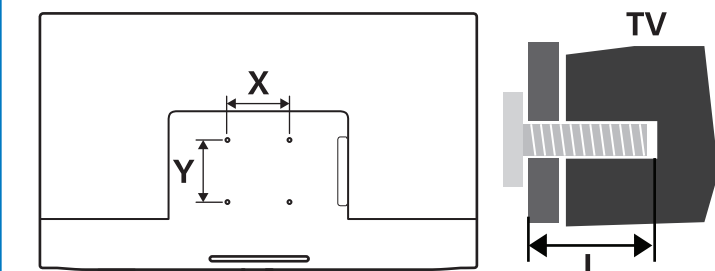
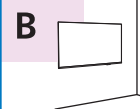

Diagonal (inch/cm)	X (mm)	Y (mm)	Screw Size	Screw Length (mm)
43" / 108	200	100	M6	Top: 23-25 Down: 8-15
50" / 126	200	200	M6	Top: 23-25 Down: 8-15
55" / 138	200	200	M6	Top: 23-25 Down: 8-15
65" / 164	400	200	M6	22-25
75" / 189	500	200	M6	22-25

### Recommended Wall Distance

**i**  
7-10 cm

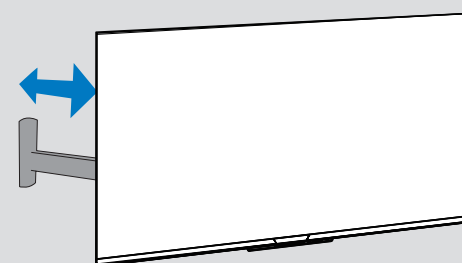

English

Read the safety instructions.

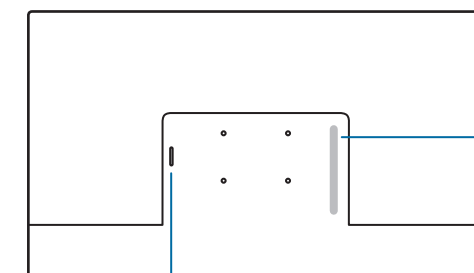

POWER  
(43" 50" 55" 65")

POWER  
(75")

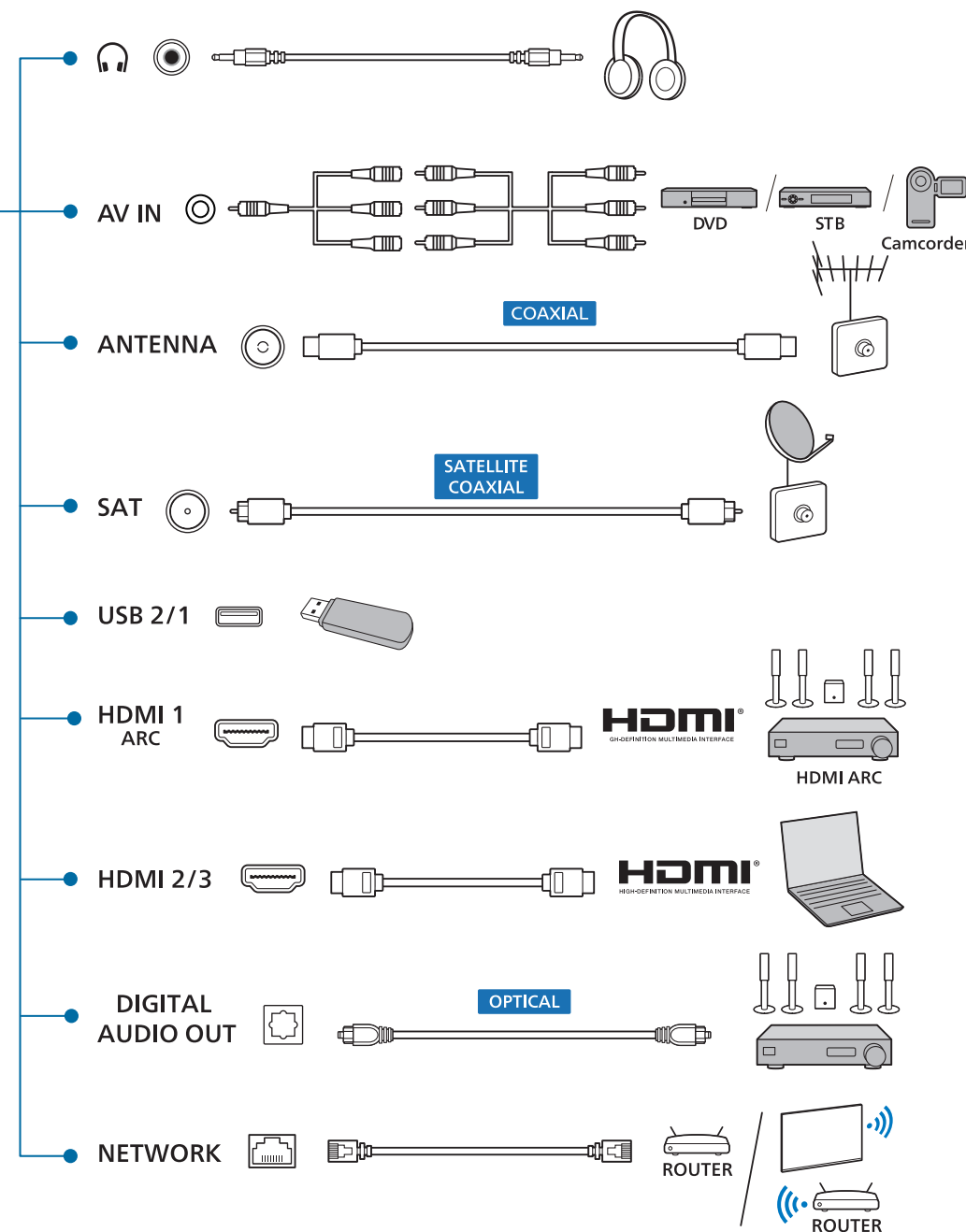
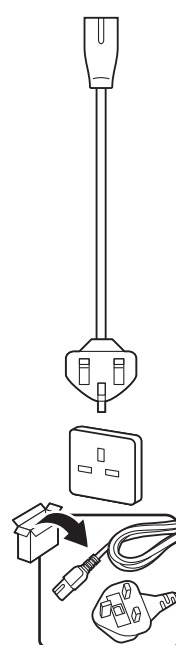
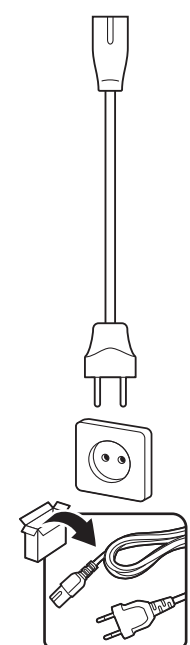

1



To install the battery,  
slide the battery  
cover downwards.

2



Use 2x AAA  
LR03 1.5V (included)

3

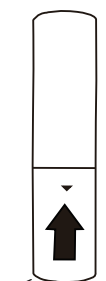

Slide battery door  
back in place.

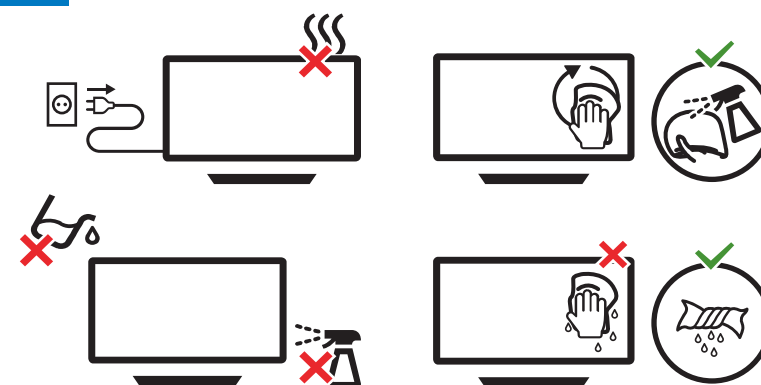

All registered and unregistered trademarks are property of their respective owners.  
Specifications are subject to change without notice.  
Philips and the Philips Shield Emblem are registered trademarks of Koninklijke Philips N.V.  
and are used under license.  
This product has been manufactured by and is sold under the responsibility of TP Vision  
Europe B.V., and TP Vision Europe B.V. is the warrantor in relation to this product.  
2025 © TP Vision Europe B.V. All rights reserved.  
[www.philips.com/welcome](http://www.philips.com/welcome)

先送样

QSG 放在EPS的上方：

CTN range	43"/50"/55"/65"/75"8100 Series
Description	Quick Start Guide
Pages	2 pages
Paper spec	white (not 'grey') - 80gr/m² (minimum) matt/uncoated - recycled, 80g双胶纸
Paper weight cover	–
Paper weight inside	–
Format	420 x 297 mm
Format (closed)	420 x 99 mm
Print	CMYK
Print on spine	–
Binding	–
Folding	See drawing

