

PHILIPS

Television Quick Start Guide 6290 series



The actual accessories may vary from the illustrations, which are for reference only.



Tool needed
for assembly



32" (Q4xL18) x 2
43" (Q4xL18) x 4

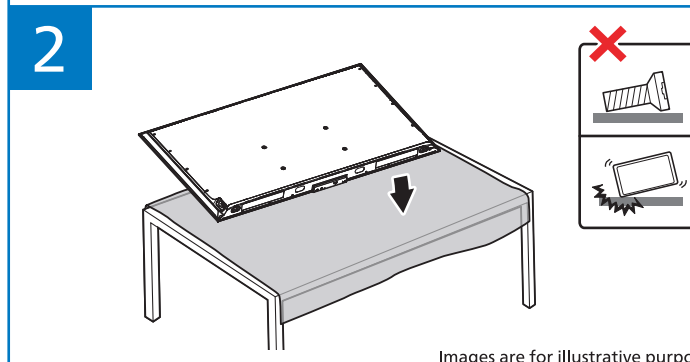
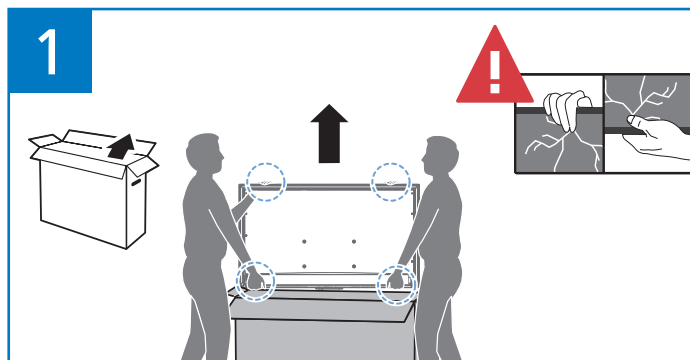
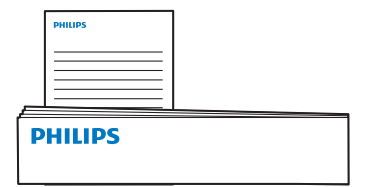
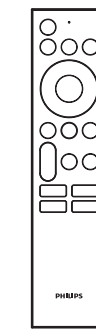
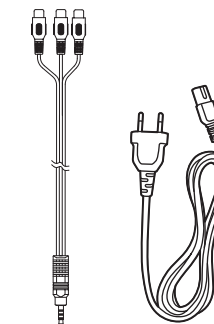
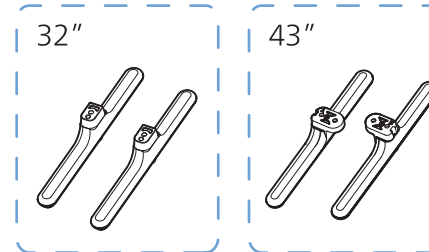

Images are for illustrative purpose.

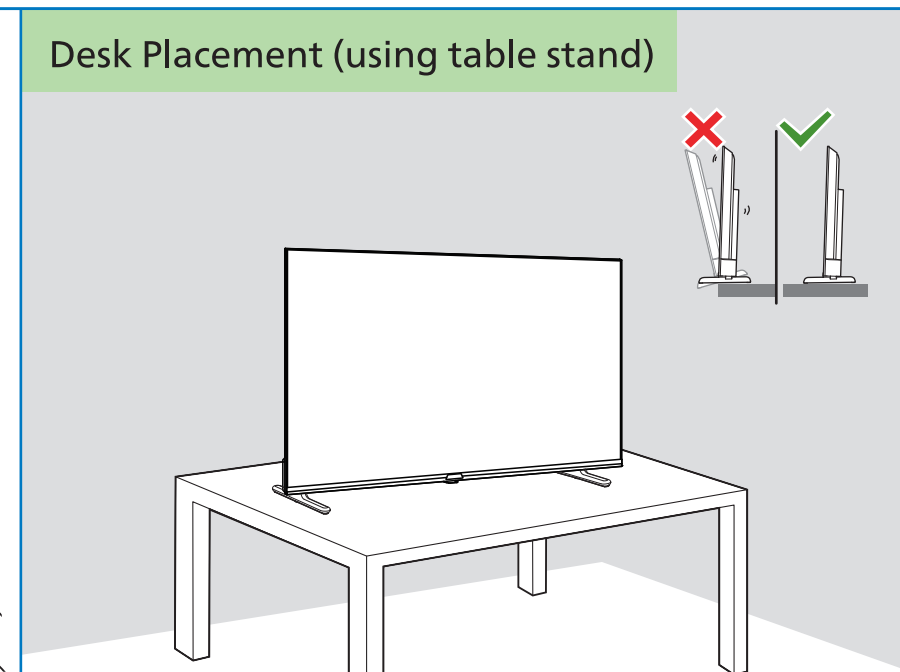
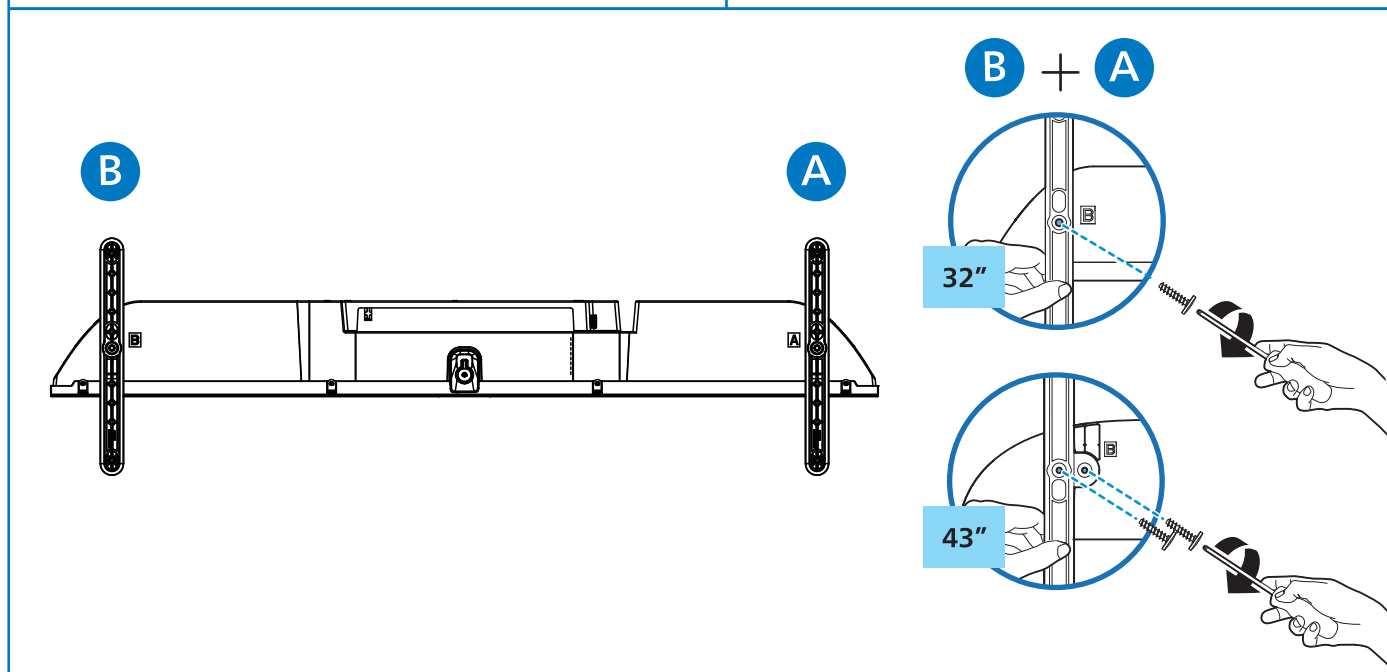
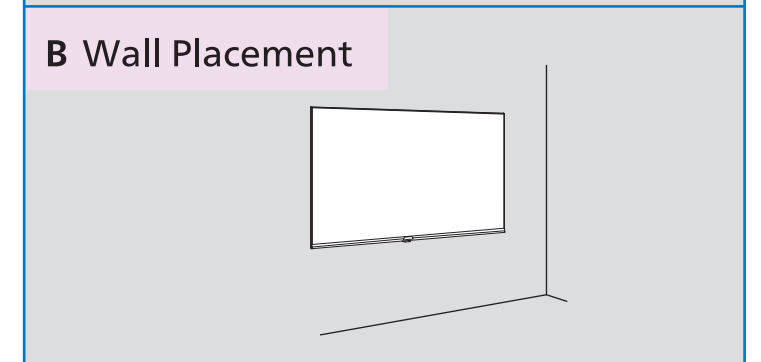
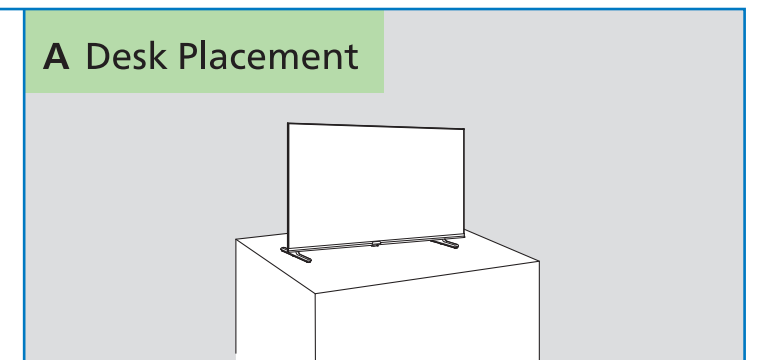
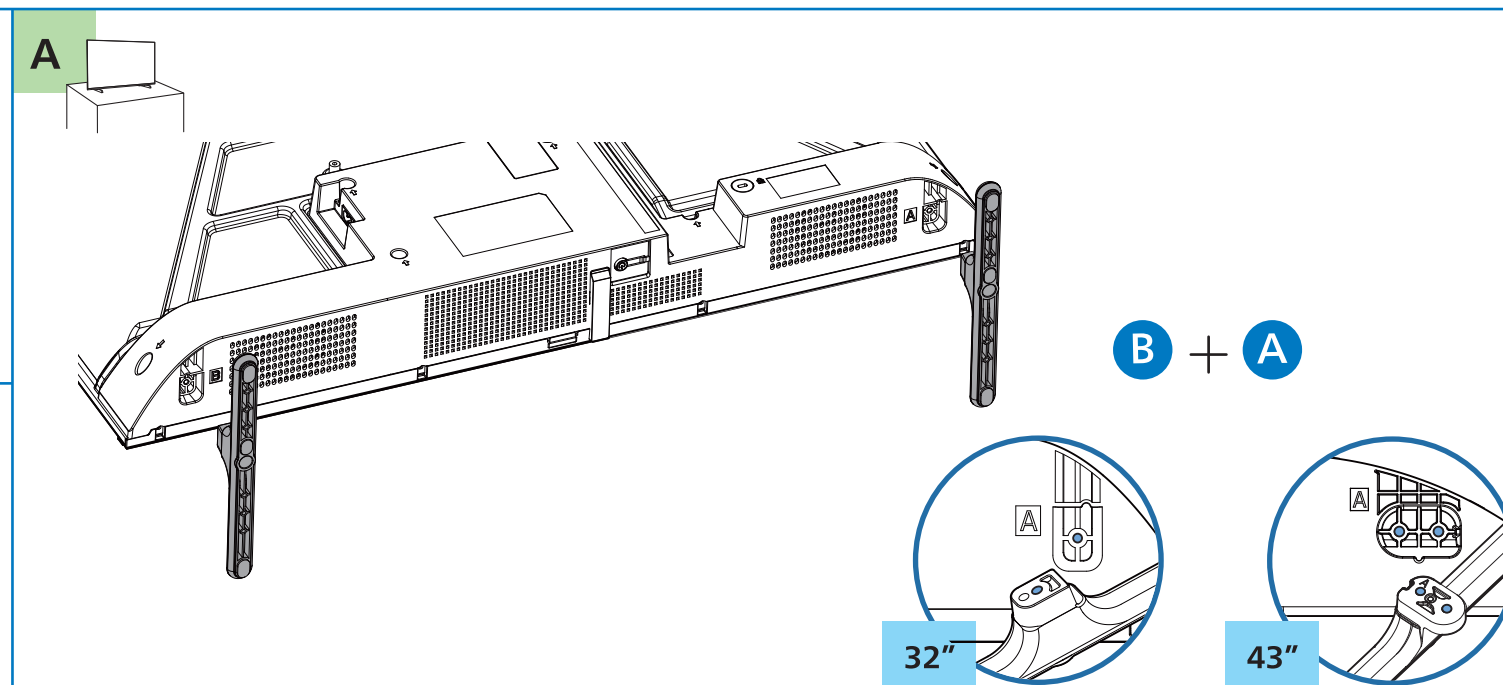

B

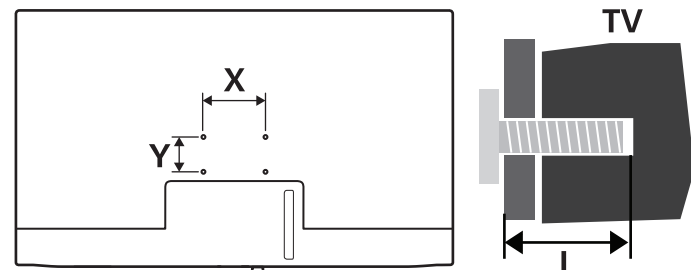

Diagonal (inch/cm)	X (mm)	Y (mm)	Screw Size	Screw Length (mm)
32" / 80	200	100	M4	28-30
43" / 108	200	100	M6	38-40

Recommended Wall Distance

i
7-10 cm

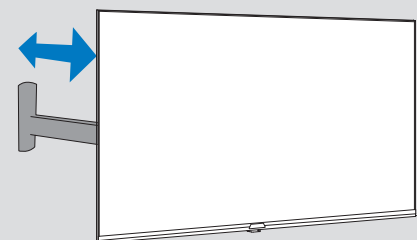

English

Read the safety instructions.

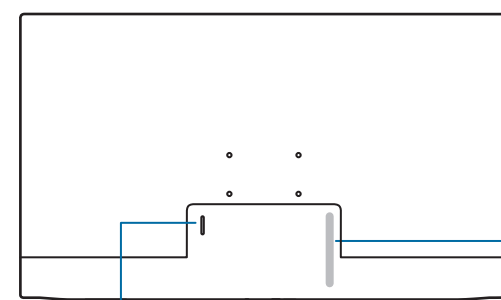

POWER

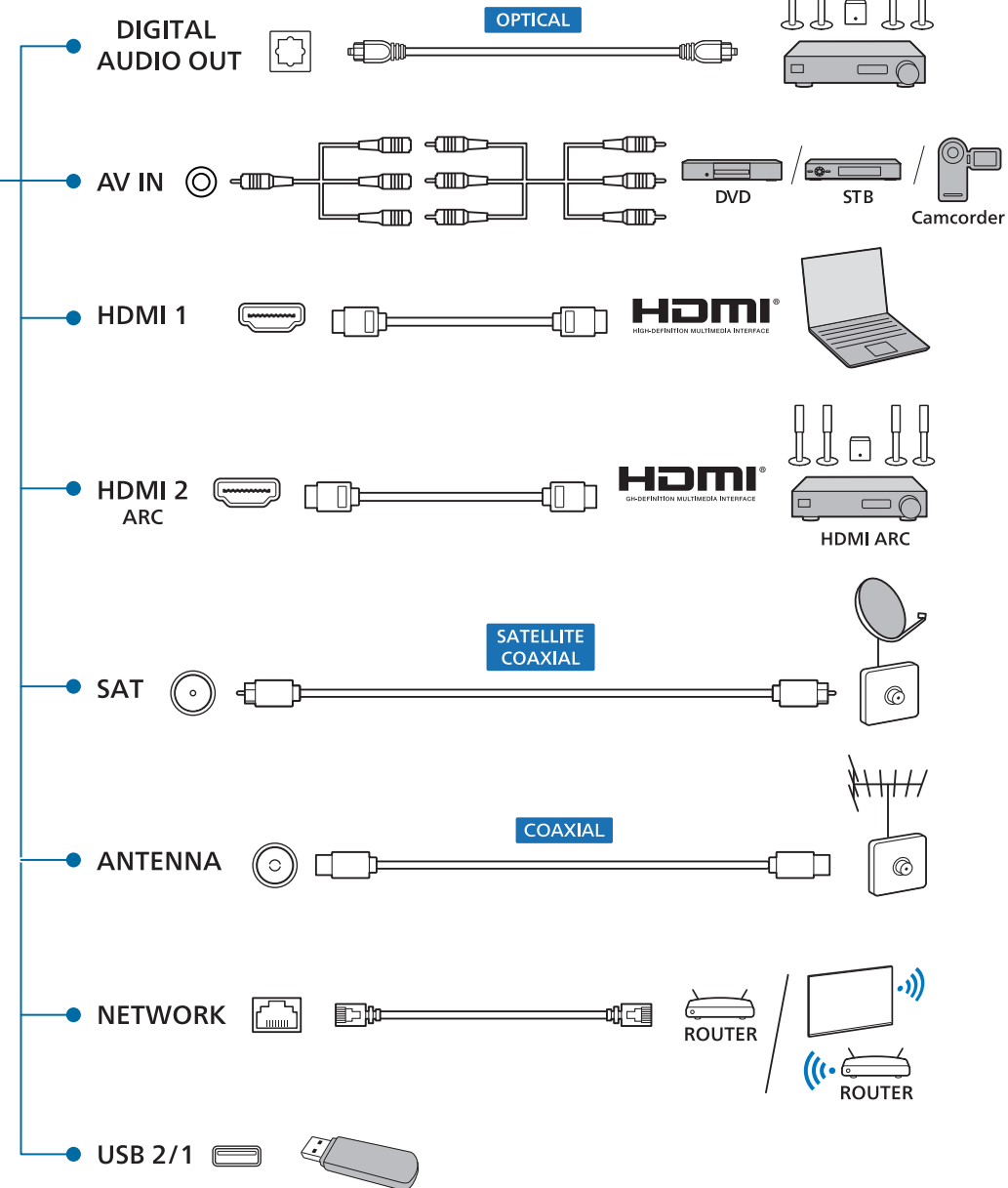
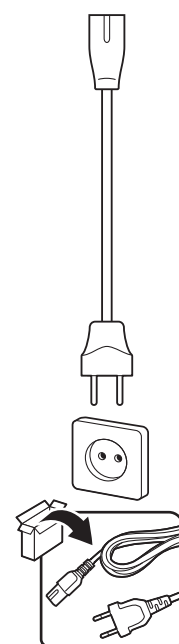

1



To install the battery, slide the battery cover downwards.

2



Use 2x AAA LR03 1.5V (included)

3



Click
Slide battery door back in place.

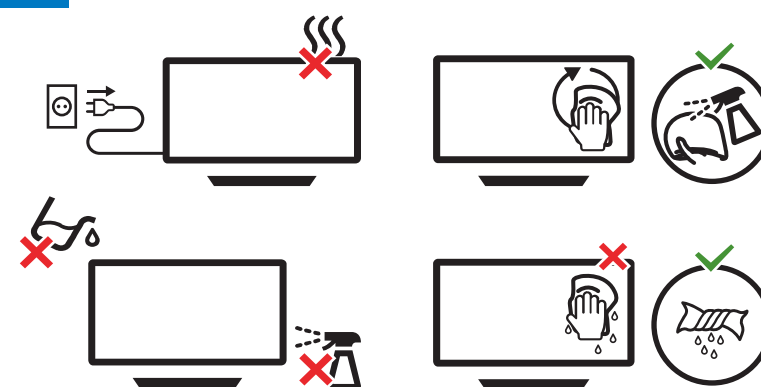

All registered and unregistered trademarks are property of their respective owners. Specifications are subject to change without notice. Philips and the Philips Shield Emblem are registered trademarks of Koninklijke Philips N.V. and are used under license. This product has been manufactured by and is sold under the responsibility of TP Vision Europe B.V., and TP Vision Europe B.V. is the warrantor in relation to this product. 2025 © TP Vision Europe B.V. All rights reserved. www.philips.com/welcome

先送样

QSG 放在EPS的上方：

CTN range	32"/43"6290 Series
Description	Quick Start Guide
Pages	2 pages
Paper spec	white (not 'grey') - 80gr/m² (minimum) matt/uncoated - recycled, 80g双胶纸
Paper weight cover	–
Paper weight inside	–
Format	420 x 297 mm
Format (closed)	420 x 99 mm
Print	CMYK
Print on spine	–
Binding	–
Folding	See drawing

