

PHILIPS

Turntable TAFT1



User manual

Register your product and get support at:
www.philips.com/support

Contents

1 Important	2
Safety	2
Notice	3
Trademarks	3
2 Your turntable	4
Introduction	4
What's in the box	4
Overview of the turntable	5
3 Get started	8
Assemble the turntable	8
Connect via the RCA audio cable	10
Connect the headphone	11
Connect power	11
Turn on and off	11
4 Phono operation	11
Play from vinyl records	11
Stop playing vinyl records	11
Replace the stylus	12
Remove the dust cover	12
5 Play from disc	13
6 Listen to Bluetooth® music	14
Connect Bluetooth®	14
Disconnect Bluetooth®	14
Clear Bluetooth® pairing records	14
7 Auracast™ operation	15
Auracast™ broadcast	15
Disconnect Auracast™ broadcast	15
8 Bluetooth-Out operation (BT-OUT)	16
Connect to Bluetooth enabled device	16
Disconnect BT-OUT	16

9 Connect Philips Fidelio FT1 turntable and FA3 speakers	17
Auracast™ connection	17
Bluetooth® in & out connection	19
Wired connection (via RCA audio cable)	21
10 Philips Entertainment App	22
App download	22
Pair the App with your turntable	22
Select source	23
Select CD/MP3 programming	23
Select Playback mode	23
Select Clock Setting	24
Select Display brightness	25
Select Auracast™ broadcast	25
Select Bluetooth Out (BT OUT)	26
Remote control	27
User guide	27
Firmware upgrade	28
11 Product specifications	29
12 Troubleshooting	30

1 Important

Safety

Read and understand all instructions before you use this turntable.
If damage is caused by failure to follow the instructions, the warranty does not apply.

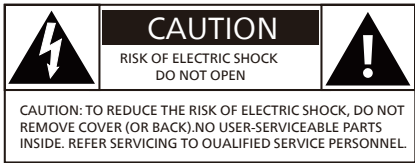

This 'bolt of lightning' indicates uninsulated material within the device may cause an electrical shock. For the safety of everyone in your household, please do not remove the covering. The 'exclamation mark' calls attention to features for which you should read the enclosed literature closely to prevent operating and maintenance problems. **WARNING:** To reduce the risk of fire or electric shock, the device should not be exposed to rain or moisture and objects filled with liquids, such as vases, should not be placed on the device.
CAUTION: To prevent electric shock, fully insert the plug. (For regions with polarized plugs: To prevent electric shock, match wide blade to wide slot.)

Warning

- Never remove the casing of this apparatus.
- Never lubricate any part of this apparatus.
- Never look into the laser beam inside this apparatus.
- Never place this apparatus on other electrical equipment.
- Keep this apparatus away from direct sunlight, naked flames or heat.
- Ensure that you always have easy access to the power cord, plug or adaptor to disconnect the apparatus from the power.

- Make sure that there is enough free space around the product for ventilation.
 - Only use attachments/accessories specified by the manufacturer.
 - The product shall not be exposed to dripping or splashing.
 - Do not place any source of danger on the product (e.g. liquid filled objects, lit candles).
 - Where the MAINS plug or an appliance coupler is used as the disconnect device, the disconnect device shall remain readily operable.
 - Please use the product safely in an environment with temperature between 0°C and 40°C.
-  This is CLASS II apparatus with double insulation, and no protective earth provided.



CLASS I LASER PRODUCT

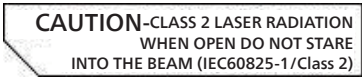

Class 2 Laser radiation when open.
Do not stare into the beam.
(Inside of the product)
(Class type vary by products. Please refer to the actual product received.)

Note

- The type plate is located on the bottom of the product.

Notice

Compliance

Any changes or modifications made to this device that are not expressly approved by MMD Hong Kong Holding Limited may void the user's authority to operate the product. Hereby, TP Vision Europe B.V. declares that this product is in compliance with the essential requirements and other relevant provisions of RED Directive 2014/53/EU and UK Radio Equipment Regulations SI 2017 No 1206. You can find the Declaration of Conformity on www.philips.com/support.



This product complies with the radio interference requirements of the European Community.



This product is designed and manufactured with high-quality materials and components, which can be recycled and reused.



This symbol means the product must not be discarded as household waste and should be delivered to an appropriate collection facility for recycling. Follow local rules and never dispose of the product with normal household waste.

Correct disposal of old products helps prevent negative consequences for the environment and human health.



This symbol means that the product contains covered by European Regulation 2023/1542 which cannot be disposed of with normal household waste. Inform yourself about the the local separate collection system for electrical and electronic collection system for electrical and electronic products. Follow local rules and never dispose of the product with normal household waste. Correct disposal of old products helps prevent negative consequences for the environment and human health.

Trademarks

AURACAST

The Auracast™ word mark and logos are trademarks owned by Bluetooth SIG, Inc. and any use of such marks by MMD Hong Kong Holding Limited is under license. Other trademarks and trs.

Bluetooth®

The Bluetooth® word mark and logos are registered trademarks owned by Bluetooth SIG, Inc. and any use of such marks by MMD Hong Kong Holding Limited is under license.



**Be responsible
Respect copyrights**

The making of unauthorized copies of copy-protected material, including computer programs, files, broadcasts and sound recordings, may be an infringement of copyrights and constitute a criminal offence. This equipment should not be used for such purposes.

2 Your turntable

Congratulations on your purchase, and welcome to Philips! To fully benefit from the support that Philips offers, register your product at www.philips.com/support.

Introduction

With this turntable, you can

- Play from vinyl records;
- Listen to music via Bluetooth;
- Play music from Disc;
- Enjoy music through headphone;
- Support Bluetooth out and Aux out;
- Support Auracast™ broadcast;
- Use App to control the unit.

What's in the box

Check and identify the contents of your package:

- Main unit
- Platter (include belt)
- Slipmat
- Dust cover
- Power cords x2
- Counterweight
- 45 rpm adaptor
- Hinges x2
- Quick start guide
- Safety sheet
- Warranty card

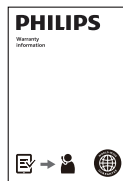
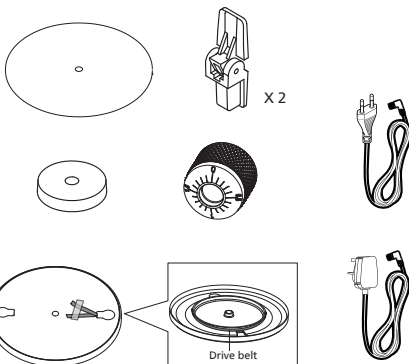
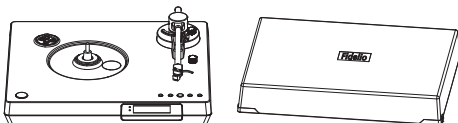

Note

- Power cord quantity and plug type vary by regions.
- Images, illustrations and drawings shown on this user manual are for reference only. Actual product may vary in appearance.

Overview of the turntable

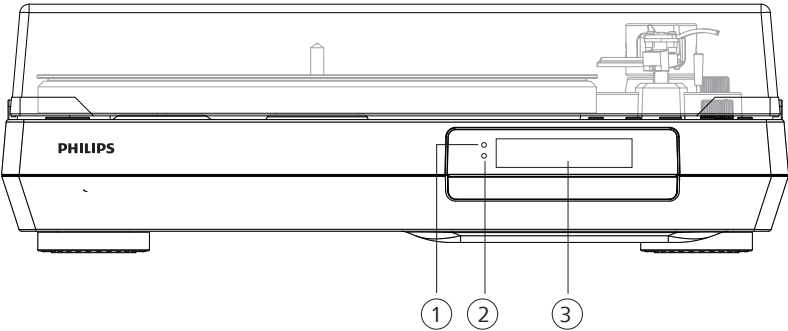

- ①

LED 1 indicator
 - Source led indicator.
- ②

LED 2 indicator
 - Auracast / Bluetooth out led indicator.
- ③

LED DISPLAY

LED function status (see below table).

Function status		Pattern	LED
Power	Standby	● Solid Red	LED 1
	Power off	– Off	
Bluetooth	Pairing	◐◑ Blink Blue (fast)	LED 1
	Connected	● Solid Blue	LED 1
	Disconnected	◐◑ Blink Blue (slowly)	LED 1
Phono	Connected	● Solid Light brown	LED 1
Auracast™	Encrypted Auracast™ broadcast	● Solid Amber	LED 2
	Deactivated encrypted Auracast™ broadcast	◐◑ Blink Amber (fast)	LED 2
	Unencrypted Auracast™ broadcast	● Solid Purple	LED 2
	Deactivated unencrypted Auracast™ broadcast	◐◑ Blink Purple (fast)	LED 2
Bluetooth out	Pairing	◐◑ Blink White (slow)	LED 2
	Connected	○ Solid White	LED 2
	Disconnected	◐◑ Blink White (fast)	LED 2

- ⑭ **HEADSHELL AND CARTRIDGE**
- The cartridge (AT3600LA) is attached to the headshell.

⑮ **FINGER LIFT**

- ⑯ **PAIRING/↻**
- Press to switch source (Phono/Bluetooth/CD).
 - Press and hold (>3 seconds) for Bluetooth pairing.
 - Press and hold (>8 seconds) to clear Bluetooth pairing history.

⑰ **BT OUT**

- Press to enable to BT Out.
- Press and hold to disable to BT Out.

- ⑱ **▶||**
- Press to play/pause.
 - Press twice to go to next track.
 - Press and hold to go fast forward.

- ⑲ **⏮**
- Press and hold (>3 seconds): Activate/Deactivate Auracast™ broadcast
 - Press and hold (>8 seconds): Deactivate and exit Auracast™ broadcast private mode (if it's current selected mode).

- ⑳ **▲**
- Open/close CD tray.

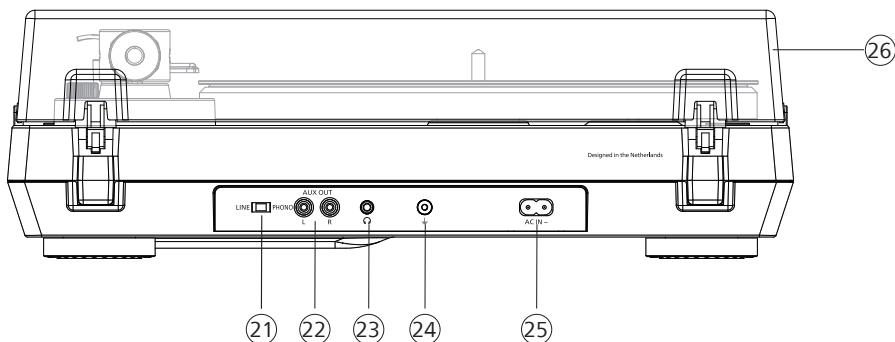

- ⑳ **PRE-AMPLIFIER SELECTOR SWITCH**
- This switch is used to change the mode of phono output or line output.

- ㉑ **AUX OUT JACK**
- Connect to external speaker using an RCA cable (not included).

- ㉒ **🎧 HEADPHONE JACK**
- Connect the headphone.

- ㉓ **⏏ GROUND CONNECTOR**

- ㉔ **🔌 AC IN~**
- Power input jack.

- ㉕ **DUST COVER**

3 Get started

! Caution

- Use of controls or adjustments or performance of procedures other than herein may result in hazardous radiation exposure or other unsafe operation.
- Always follow the instructions in this chapter in sequence.

Assemble the turntable

- 1 Assemble the platter on the unit.

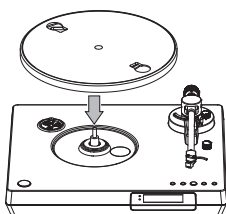

- 2 The belt is pre-installed under the platter.

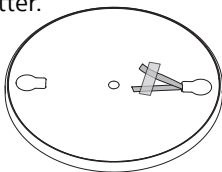

- 3 Turn the platter upside down, pull the belt over the motor pulley. Release your hand from the belt once the belt on the motor pulley.

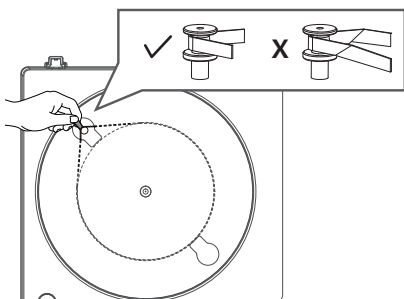

- Slowly rotate the platter about ten times by hand in the direction of the arrow. Get rid of any twists in the belt and make sure the belt rides smoothly.

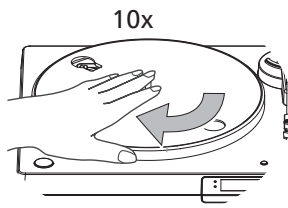

- 4 Place the slip mat on the platter.

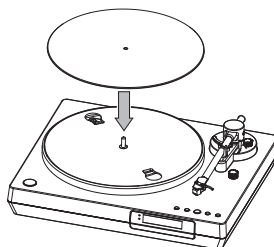

- Gently parallelly pull the stylus cover forward to remove.

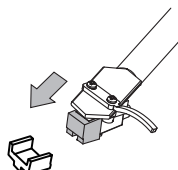

- 5 Insert the counterweight into the tone arm in the direction of the arrow. Unlock the tone arm clip.

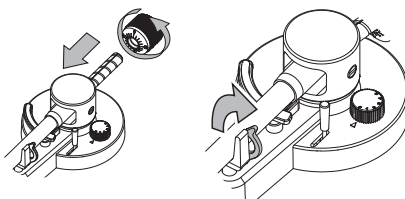

- Use the lift lever to raise the tone arm.

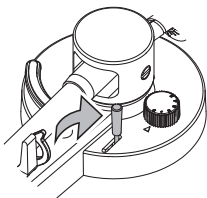

- 6 Use the finger lift to align the stylus over the record.

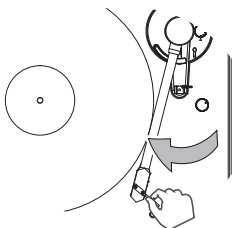

- Use the lift lever to lower the tone arm on the record to begin playing.

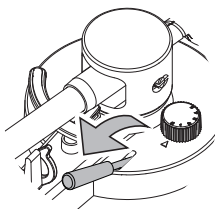

- 7 Turn the counterweight on the back of tone arm until the tone arm is flat and balanced.

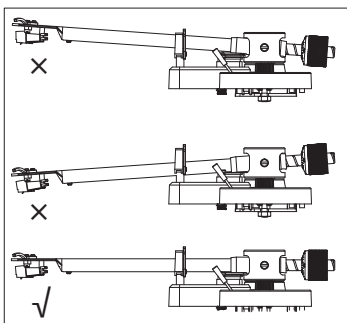
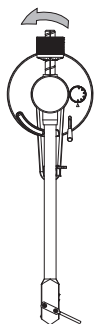

- 8 Move the tone arm back to the tone arm rest. **ONLY** turn the number ring in the direction of the arrow, until the number '0' is in the top most position.



Tip

- The number ring and counterweight move separately from each other. Do not turn the counterweight in this step.

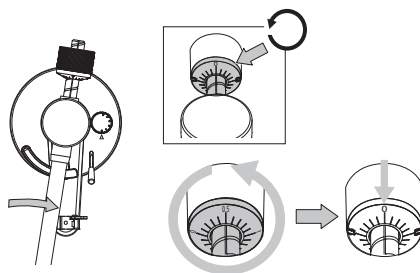

- Hold and rotate both the number ring and the counterweight in the direction of the arrow 1 1/2 rotations until the number '1' is in the top most position.

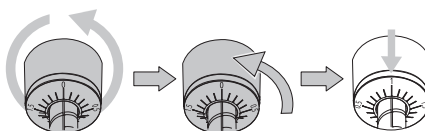
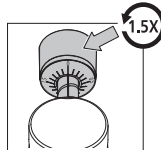

- 9 Insert the dust cover hinges into the hinge pockets at two sides of the dust cover.

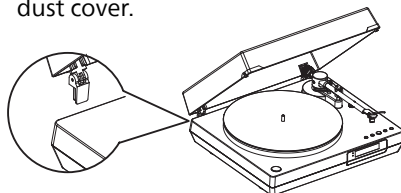

Insert the hinges completely into the hinge bases located at the back of the turntable.

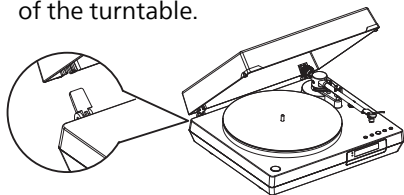

Note

To remove the dust cover, grasp the two sides of the dust cover and slowly lift upward to remove the cover together with its hinges.

Connect via the RCA audio cable

Connect the RCA cable (not included) to the external speaker.

- ↳ RED plug - Plug into the R-channel output.
- ↳ WHITE plug - Plug into the L-channel output.

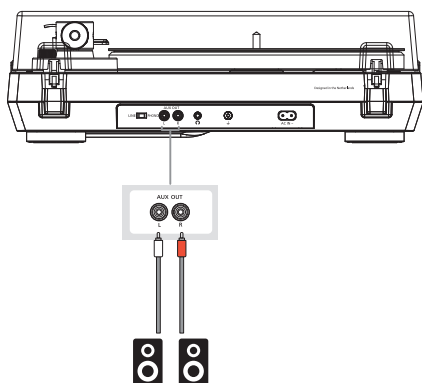

This product has a built-in phono equalizer feature. You can use the product even if you do not have a built-in phono amplifier. Use the pre-amplifier selector switch on the back of the turntable to set the output as below.

If the audio device has a PHONO input jack, set the switch to PHONO. An audio signal from the MM cartridge is output from the audio cable without passing through the phono preamp from the turntable. The phono preamp for the audio device is used.

If the audio device does not have a PHONO input jack, set the switch to LINE. The audio signal that passes through the phono preamp from the turntable is output from the audio cable.

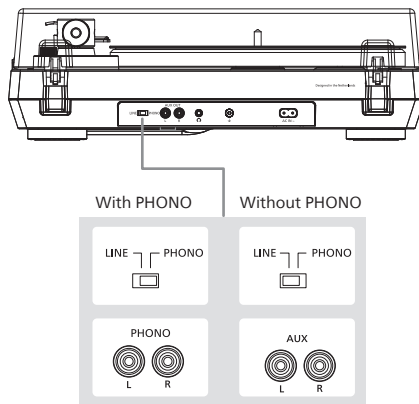

Tip

- In BT/CD mode, using the pre-amplifier selector switch is not necessary.

Connect the headphone

Connect the headphone/ earphone through the headphone jack on the back of your turntable.

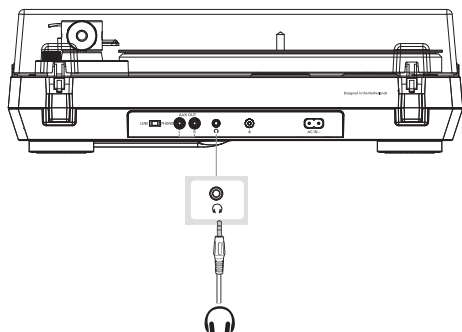

Connect power

Connect the power adapter to the wall outlet.

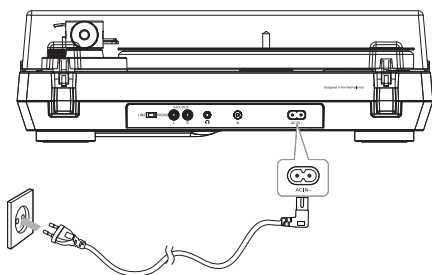

Caution

- Risk of product damage! Ensure that the power supply voltage corresponds to the voltage printed on the back or the underside of the unit.
- Risk of electric shock! Before you plug the adaptor, make sure that the plug is fixed securely, when you unplug the adaptor, always pull the plug, never pull the cord.
- Before you connect the adaptor, make sure that you have completed all the other connections.

Turn On and Off

Press the  button to switch the unit on.

- ➔ Press to power on, and go to last source.

Press the  button to switch the unit off.

- ➔ The unit switches to standby.

Press the **PAIRING/**  button to switch the source.

- ➔ Phono/Bluetooth /Disc.



Note

- The turntable switches to standby mode after 15 minutes inactive.

4 Phono operation

Play from vinyl records

- 1 Place the unit on a flat and level surface.
- 2 Place the slipmat on the platter before placing the vinyl record.
- 3 Use the speed switch next to tone arm to adjust the speed (33-1/3, 45 RPM) to match the record.

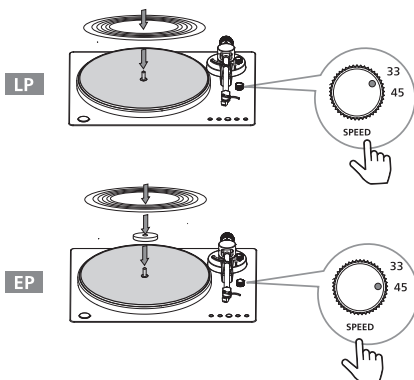

- 4 Press **PAIRING**/ button to Phono source.

↳ LED 1 turns solid light.

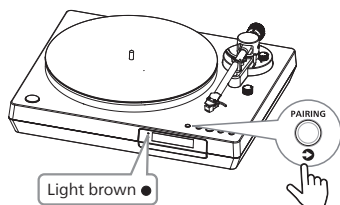

- 5 Gently parallelly pull the stylus cover forward to remove before playing. Unlock the tone arm clip, and use the lift lever to raise the tone arm.

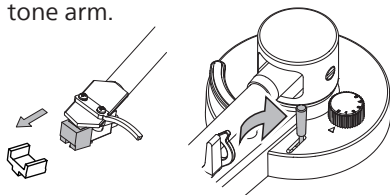

- 6 Use the finger lift to align the stylus over the record.

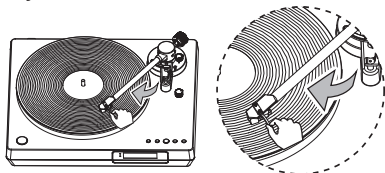

- 8 Use the lift lever to lower the tone arm on the record to begin playing.

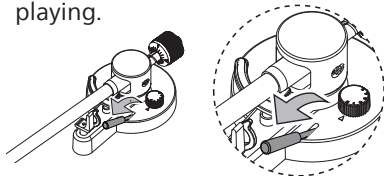

Caution

- Do not bend or force the stylus into the cartridge.
- Do not touch the stylus tip to avoid injury to your hand.
- Turn off the unit's power before you replace the stylus.

Stop playing vinyl records

- 1 Use the lift lever to raise the tone arm, and use the finger lift to move the tone arm back on the tone arm rest.

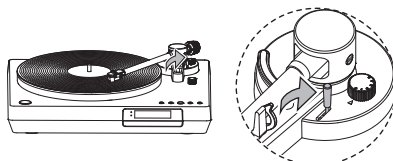

- 2 Lower the lift lever, and lock the tone arm clip to fix it.

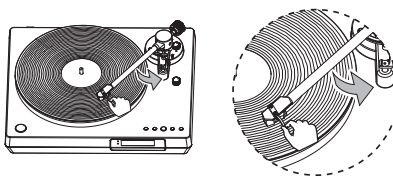

- 3 Install the stylus cover to protect the stylus tip.

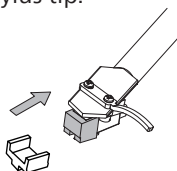
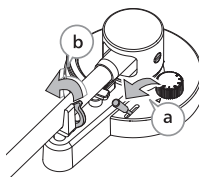

Replace the stylus

Removing the stylus from the tone arm:

- 1 Place your fingers at the tip of the stylus and push down to the direction 'A'.

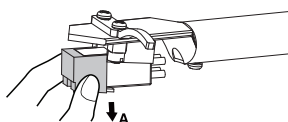

- 2 Pull the stylus out toward the direction 'B'.

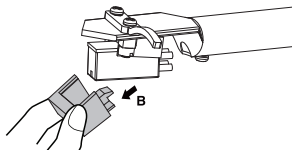

- 3 Hold the tip of the stylus and insert the other edge by pressing toward direction 'C', and push the stylus up toward direction 'D' until it locks at the tip.

Stylus model: AT3600 (not included).

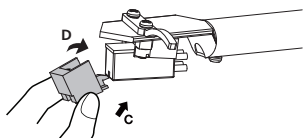

5 Play from disc

- 1 Press the **PAIRING/** button to CD source.

↳ [DISC] is displayed.

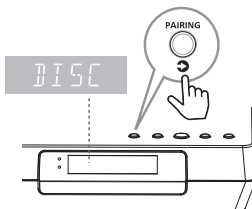

- 2 Press the **▲** button to open the disc compartment.

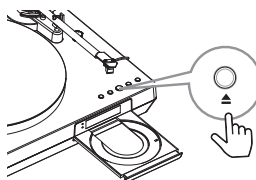

- 3 Insert a disc with the label side up.



Remove the dust cover

- 1 Open the dust cover.

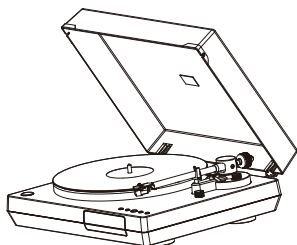

- 2 Lift up the dust cover from the hinge base.

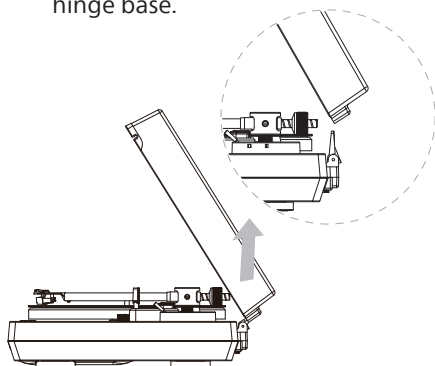

- 4 Press the **▲** button to close the disc compartment to start the playback.

- ↳ Press the **▶||** button twice on the product to the skip to next track.
- ↳ Press the **▶||** button on the product to play/pause the track.
- ↳ Press and hold **▶||** button on the product to go fast forward.

6 Listen to Bluetooth® music

Connect Bluetooth®

- 1 Press the **PAIRING/**  button to switch to Bluetooth source.
↳ LED 1 blinks blue.
- 2 Select [**Philips Fidelio FT1**] on your Bluetooth enabled device.
↳ After successful pairing and connection, the Bluetooth indicator turns solid blue, and you will hear the prompt sound from the unit.

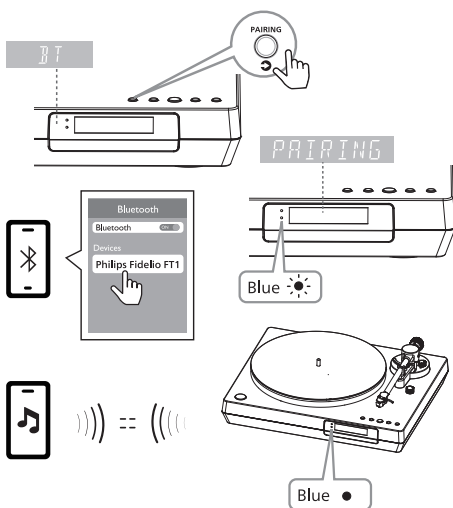

- 3 Play the audio from your device.
 - Press the **▶||** buttons on the product or your device to play/pause the track.
 - Press the **▶||** button on the product twice on the product to skip to next track.

Disconnect Bluetooth®

- Deactivate Bluetooth on your device.
- Press and hold the **PAIRING/**  button on the unit for 3 seconds to enter pairing mode.
↳ LED 1 blinks blue.

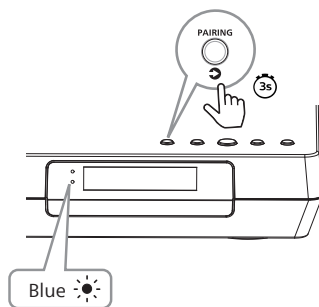

Clear Bluetooth® pairing records

- Press and hold the **PAIRING/**  button on the unit for 8 seconds in disconnect mode.

Note

- Compatibility with all Bluetooth devices is not guaranteed.
- Any obstacle between the unit and the device can reduce the operational range.
- The effective operation range between this unit and your Bluetooth enabled device is approximately 10 meters (free space).

7 Auracast™ operation

You can broadcast your music from this turntable to any other Auracast™ compatible products.

Auracast™ broadcast

- 1 Press the **PAIRING/** button to switch to Phono/Bluetooth/Disc source.

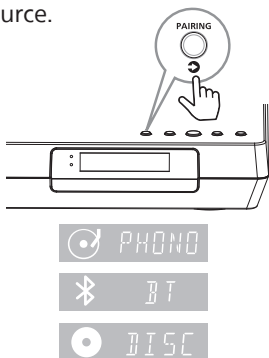

- 2 In Phono/Bluetooth/Disc source, press and hold the button on your turntable for 3 seconds or select **Source Control** on Philips Entertainment App (/Auracast™ broadcast) to enter into Auracast™ broadcast.

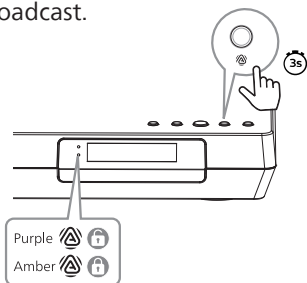

On Philips Entertainment App, enter General Settings, select **Public** (unencrypted broadcast) or **Personal** (encrypted broadcast) from Auracast™ broadcaster.

- When unencrypted broadcast is selected, LED 2 turns solid purple and you will hear the prompt sound from your turntable.
 - When encrypted broadcast is selected, LED 2 turns solid amber and you will hear the prompt sound from your turntable.
- 3 You can broadcast to any number of Auracast™ enabled products. Follow the instruction to enable Auracast™ connection.
 - 4 If Auracast broadcast channel is encrypted, Auracast receiver products are required to enter the password in order to listen to it.

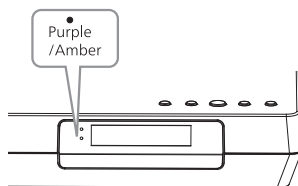

Disconnect Auracast™ broadcast

- Press and hold the button on your turntable for 3 seconds to exit Auracast broadcast from your turntable.
 - ↳ LED 2 blinks purple or amber.

8 Bluetooth-Out operation (BT-OUT)

Connect to Bluetooth enabled device

- 1 Press the **PAIRING**/ button to switch to Phono/Disc source.

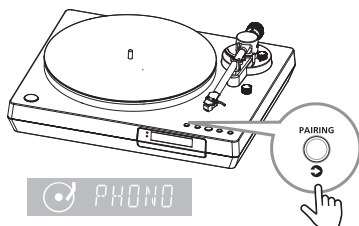

- 2 In Phono/Disc source, press BT OUT button to enter Bluetooth out pairing mode.

↳ LED 1 blinks white.

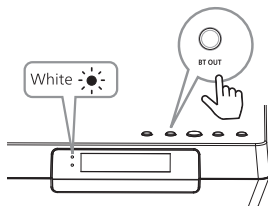

- 3 Ensure your Bluetooth enabled device is in pairing mode.
- 4 The turntable starts to scan and pair to the nearest Bluetooth enabled device or device with the strongest signal automatically.
- 5 Once connected, you will hear the prompt sound from the turntable.
↳ LED 2 turns solid white.

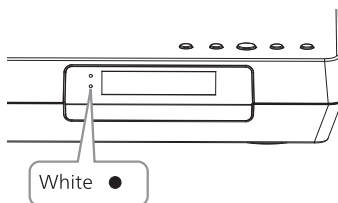

Disconnect BT-OUT

Press and hold **BT OUT** button on the turntable for 3 seconds.

- ↳ LED 2 turns from solid white to blinking white.

Note

- If the pairing fails, press **BT OUT** button again to perform the scanning of Bluetooth enabled devices.

9 Connect Philips Fidelio FT1 turntable and FA3 speakers

This section helps you connect Fidelio FT1 turntable and FA3 speakers.

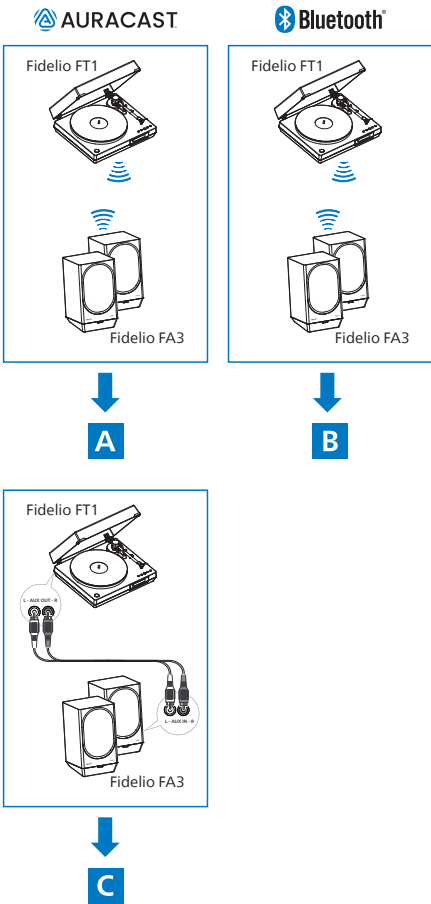

A

Auracast™ connection

FT1

1 Press the **PAIRING/** button to switch to Phono/Bluetooth/Disc source.

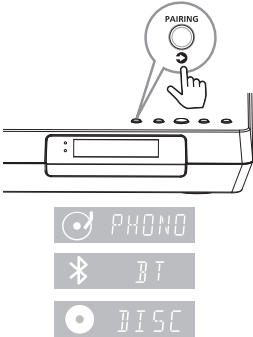

2 In Phono/Bluetooth/Disc source, press and hold the button on your turntable for 3 seconds or select **Source Control** on Philips Entertainment App (/Auracast™ broadcast) to enter into Auracast™ broadcast.

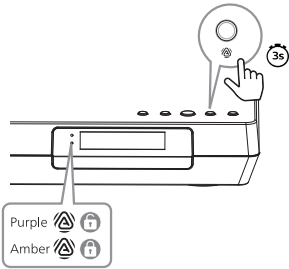

On Philips Entertainment App, enter **General Settings**, select **Public** (unencrypted broadcast) or **Personal** (encrypted broadcast) from Auracast™ broadcaster.

- When unencrypted broadcast is selected, LED 2 turns solid purple and you will hear the prompt sound from your turntable.

Connection	Go to page
A Auracast™ connection	17
B Bluetooth In & out connection	19
C Wired connection	21

- When encrypted broadcast is selected, LED 2 turns solid amber and you will hear the prompt sound from your turntable.
- 3 You can broadcast to any number of Auracast™ enabled products. Follow the instruction to enable Auracast™ connection.
 - 4 If Auracast broadcast channel is encrypted, Auracast receiver products are required to enter the password in order to listen to it.
 - Once connected, LED on Auracast™ enabled products (Fidelio FA3) will turn solid Cyan.

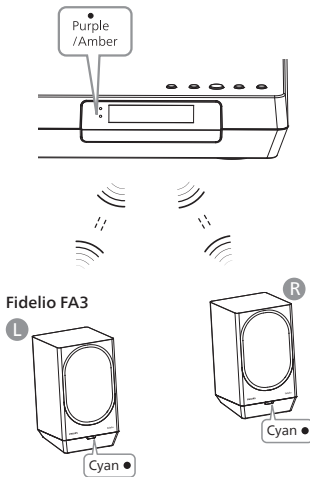

- 5 Press the **PAIRING/** button to switch between Phono/Disc/Bluetooth to play different audio sources.

Disconnect Auracast™ broadcast

- Press and hold the button on your turntable for 3 seconds to exit Auracast broadcast from your turntable.
 - ↳ LED 2 blinks purple or amber.

- 1 On your device that supports Auracast™ broadcast, follow the instructions to enable Auracast™ broadcast.
- 2 Press **BT/** on the remote control or **SOURCE** at the back of the primary speaker to select Auracast™ receiver mode.
 - ↳ You will hear a prompt sound.
 - ↳ LED blinks cyan.

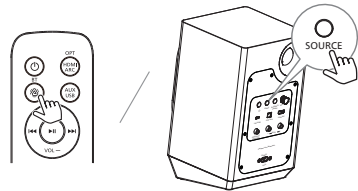

- 3 If the speaker is switched on to Auracast™ receiver mode for the first time or the station list is empty, the speaker will automatically start scanning, then the unencrypted broadcast with the strongest signal is broadcast automatically.
 - ↳ LED turns solid cyan.

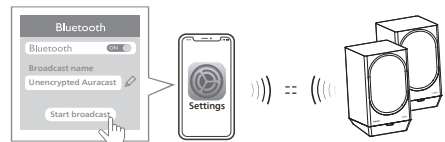

- 4 If you want to receive encrypted broadcasts on your Auracast™ broadcast device, follow the instructions for your Auracast™ broadcast device and enter the password for your Auracast™ broadcast device.

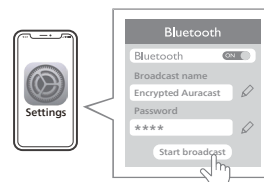

- 5 Use the supplied remote control to control play.
 - To increase or decrease the volume, press **VOL+/-**.

Note

- When Auracast™ receiver is connected, press **SOURCE** at the back of the primary speaker for 3 seconds to rescan Auracast™ broadcast channels.
- When Auracast™ receiver is connected to multiple Auracast™ receiver channels, press **SECONDARY PAIRING** button at the back of the primary speaker to switch to the next unencrypted Auracast™ broadcast channel.

Disconnect Auracast™ receiver

- Switch to another source on the unit.
 - Deactivate Auracast™ broadcast on your Auracast™ broadcast device.
- If the disconnection is successful,
 ↳ LED 1 blinks cyan.

B Bluetooth In & out connection

FT1

- 1 Press the **PAIRING/**  button to switch to Phono/Disc source.



- 2 In Phono/Disc source, press **BT OUT** button to enter Bluetooth out pairing mode.
 - ↳ LED 1 blinks white.

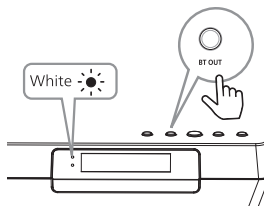

- 3 Ensure your Bluetooth enabled device is in pairing mode.
- 4 The turntable starts to scan and pair to the nearest Bluetooth enabled device or device with the strongest signal automatically.
- 5 Once connected, you will hear the prompt sound from the turntable.
 - ↳ LED 2 turns solid white.

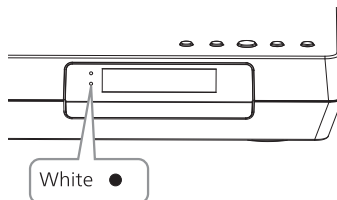

Disconnect BT-OUT

Press and hold **BT OUT** button on the turntable for 3 seconds.

↳ LED 2 turns from solid white to blinking white.



Note

- If the pairing fails, press **BT OUT** button again to perform the scanning of Bluetooth enabled devices.

FA3

- 1 Press **BT** /  on the remote control or **SOURCE** at the back of the primary speaker to select Bluetooth mode and enter pairing mode.

↳ LED blinks blue.

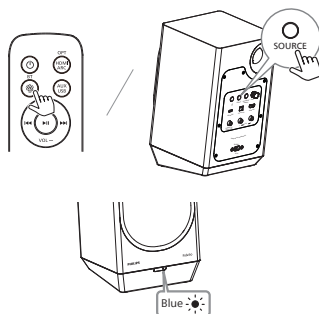

- 2 If connected successfully:
 - ↳ You will hear a prompt sound.
 - ↳ LED turns solid blue.

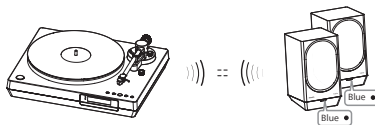

- 3 Play music via your device.

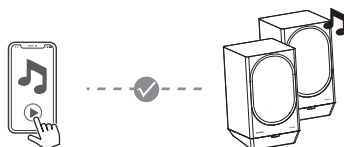

Use the supplied remote control to control play.

- To increase or decrease the volume, press **VOL+/-**.
- To pause/resume playback, press **▶||**.
- To skip to a track, press **▶|◀**.

C Wired connection (via RCA audio cable)

FT1

- 1 Connect the RCA cable (not included) to the external speaker.

RED plug - Plug into the R-channel

↳ output.

WHITE plug - Plug into the L-channel

↳ output.

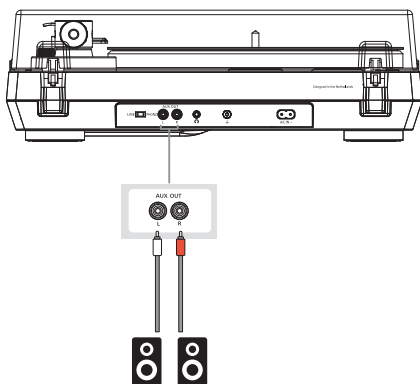

- 2 Set the switch to LINE output at the back of Fidelio FT1 as below.

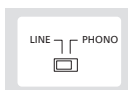

FA3

- 1 Connect **L-AUX IN-R** sockets at the back of the primary speaker to AUX OUT sockets on Fidelio FT1 with an RCA cable (not provided).

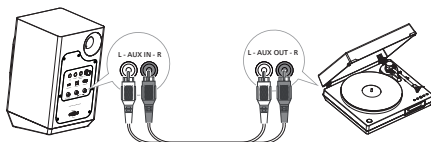

- 2 Press **AUX** on the remote control or **SOURCE** at the back of the primary speaker to select AUX in mode.
↳ LED turns solid pink.

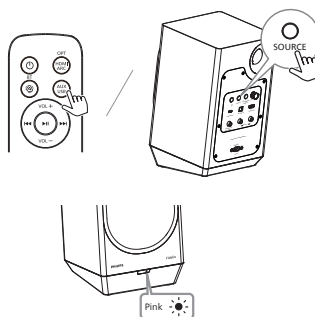

Note

- Please use RCA cable with a length not exceeding 3M.

- 3 Use the supplied remote control to perform basic controls of the speakers.
 - To increase or decrease the volume, press **VOL+/-**.

10 Philips Entertainment App

App download

Scan the QR code and press “Download” button, or search “Philips Entertainment” in the Apple App Store or Google Play to download the app.

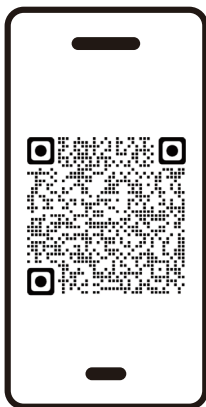

philips.to/entapp

The Philips Entertainment App puts you in charge of the music you are listening to. You can use your smart device to easily choose the sound style you want, switch between sources, and more.

Pair the App with your turntable

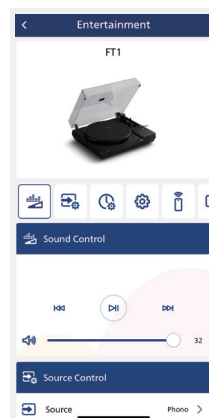
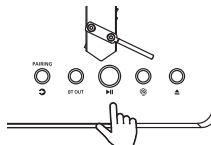
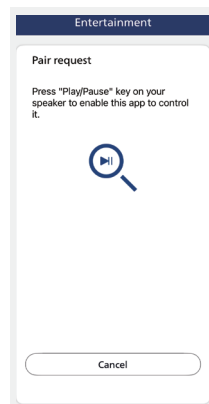

- 1 Launch the Philips Entertainment App on your mobile device.
- 2 Make sure your mobile device is enabled the Bluetooth setting.
- 3 If you connect the Philips Entertainment App with your turntable for the first time, you are asked to pair the App with your turntable.
- 4 Press the ►► button on your turntable to enable the App to discover and control it.

Select source

Press  icon on the App to select **Phono/CD/Bluetooth**.

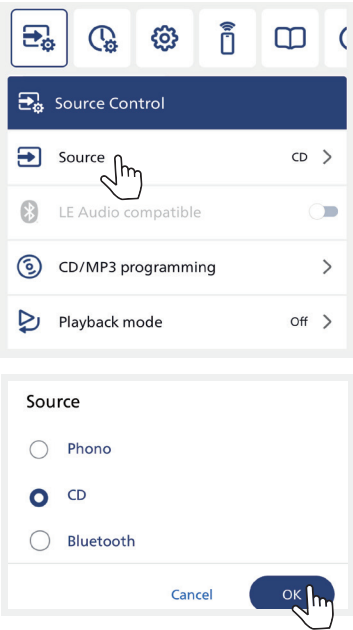

Select CD/MP3 programming

Select **[CD/MP3 programming]** to enter CD/MP3 programming setting.

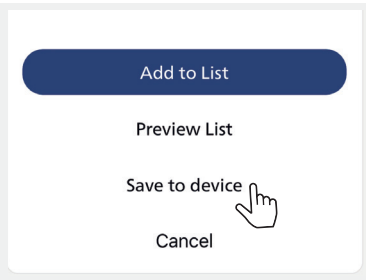
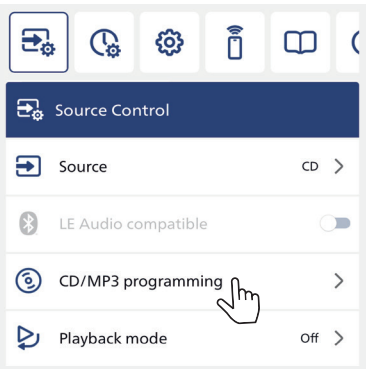

Select Playback mode

Select **[Playback mode]** to enter Playback mode setting.

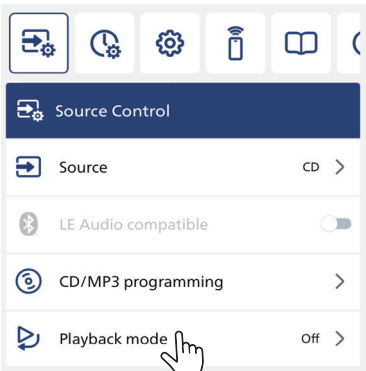

Playback mode

☒ Off

☐ Repeat One

☐ Repeat Album

☐ Repeat All







☐ Shuffle

Cancel

OK

Select Clock Setting

Press  icon on the App to select **Clock Setting**.

Clock Setting

 24-Hr Time

☐

 Sync Clock

☐

 Clock



>

 Sleep Timer

Off

>

Clock

↶ ↷

08

09

10

00

AM

11

01

PM

12

02

↶ ↷

Cancel

OK

Sleep Timer

☐ Off

☐ 15 min

☒ 30 min

☐ 60 min

☐ 90 min

☐ 120 min

Cancel

OK

- **[24-Hr Time]**: Set 12 or 24-hour time mode.
 - ↳ 24Hr Time is set by default.
- **[Sync Clock]**: When Sync clock is enabled, the App will synchronize the mobile clock to the turntable upon their connection.
 - ↳ Turn off **[Sync Clock]** so that users can customize the time for their micro systems.
- **[Clock]** : Option to swipe and select the time on the clock page.

Select Display brightness

Press  icon on the App to to enter General Settings list.

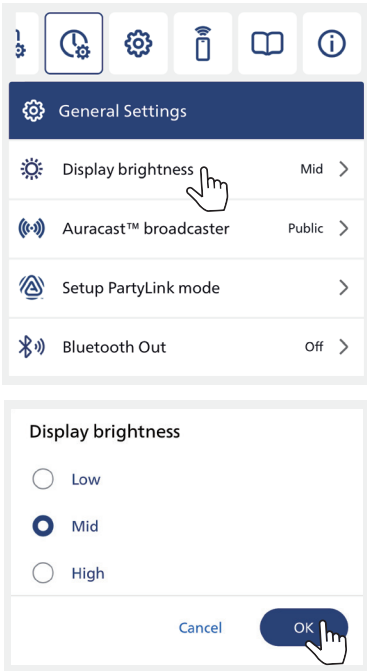

Select Auracast™ broadcast

- 1 Press  icon on the App to enter General Settings list.

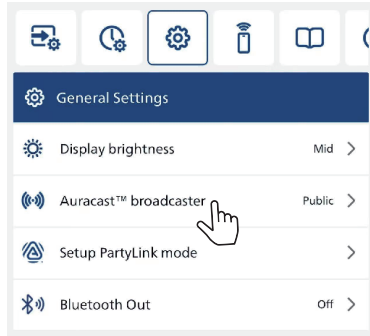

- 2 Select **Public** or **Personal** broadcasts.

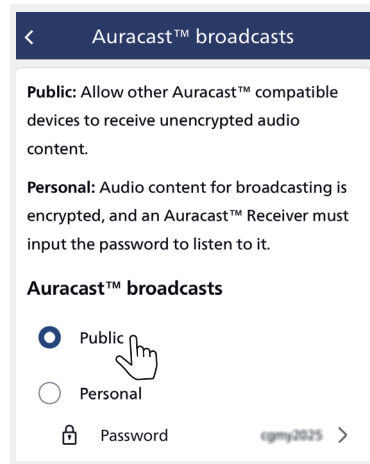

- 3 Enter password when **Personal** (encrypted broadcast) is selected.

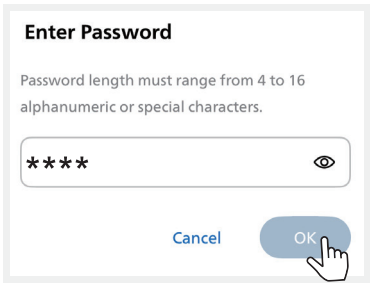
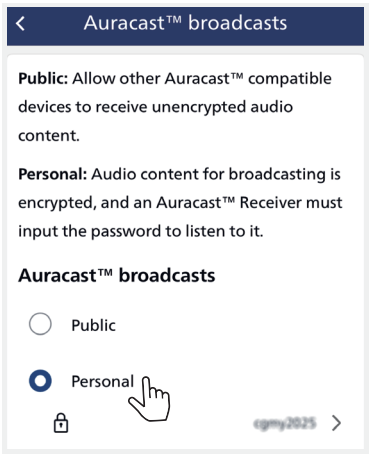

- 4 Press and hold  button from the turnable to enter Auracast™ pairing mode.

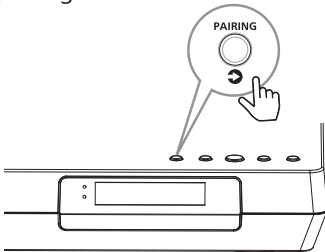

Select Bluetooth Out (BT Out)

- 1 Press  icon on the App to enter General Settings list.

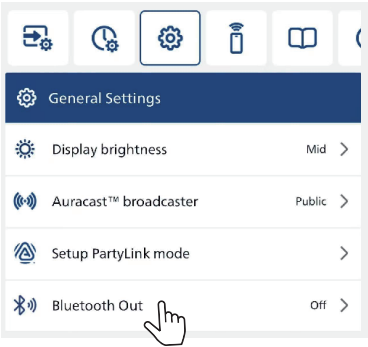

- 2 Enable **[Bluetooth Out]** and start to scan.

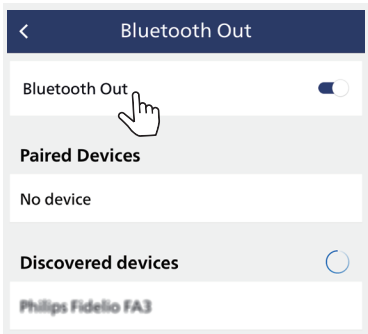

- 3 Devices that are paired previously will be shown in Paired devices and not paired devices will be shown in Discovered devices.

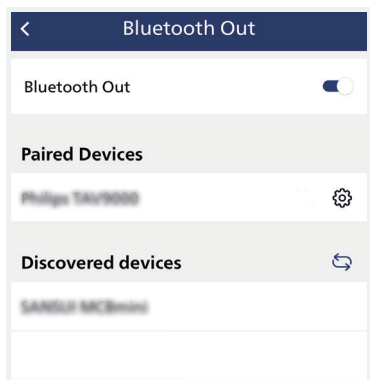

- 4 Select the device to connect Bluetooth Out.

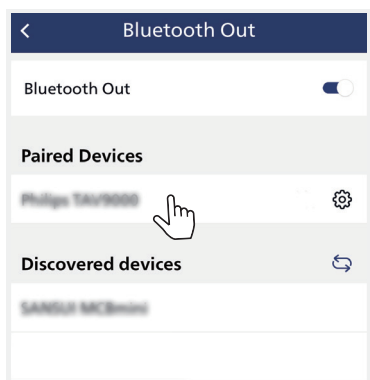

User guide

For more information about using this unit, press  icon on the App you can find **[User Manual]** and **[Quick Start Guide]**.



Remote control

Press  icon to enter and use your mobile device via Philips Entertainment App as a remote control to operate the turntable.

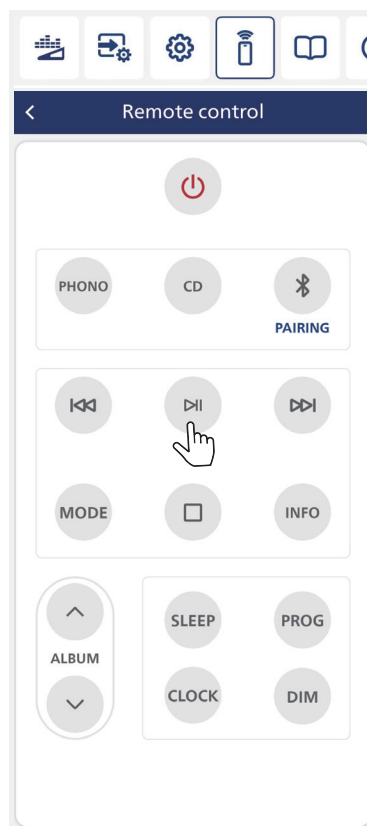

Firmware Upgrade

To get the best features and support, update your unit with the latest firmware version.

The firmware for MCU can be upgraded to the latest version via Philips Entertainment app.

Please go to **Firmware Update** and press **Download & Update**. If the upgrade is released, the **Download & Upgrade** icon can be pressed to proceed automatically.

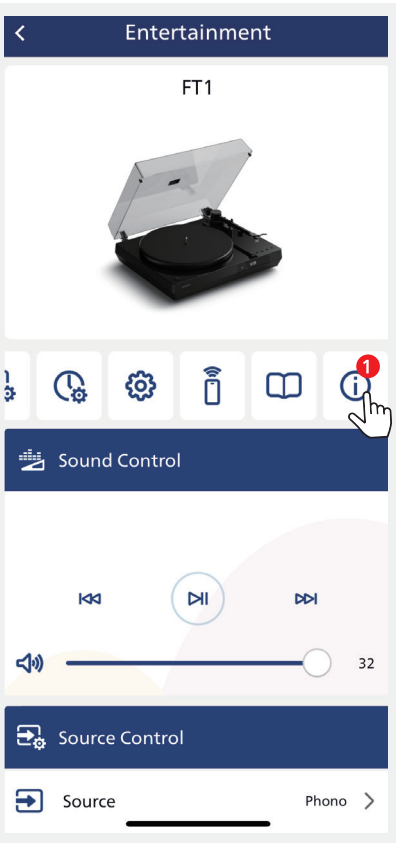

Once this product is connected to Philips Entertainment app, it can receive over-the-air firmware update. Always upgrade with the latest firmware version to improve the performance of this unit.



10 Product specifications



Note

- Product information is subject to change without prior notice.

General information

Power supply	100-240V~ 50/60Hz
Power consumption	5 W
ECO power consumption	<0.8 W
Dimensions (W x H x D)	420x130x370 mm
Weight (Main unit)	3.7 Kg
Operating temperature	0-40°C

Turntable

Turntable speeds	33-1/3 RPM, 45 RPM
Stylus model	AT3600LA

Bluetooth*

Bluetooth* version	V5.4
Bluetooth* profiles	A2DP, AVRCP
Bluetooth* frequency band	2402-2480 MHz
Maximum transition power	≤9 dBm
Bluetooth* range	approx.10m
Supported audio format	SBC, AAC, LC3

Disc

Support disc type	CD-DA, CD-R, CD-RW, MP3-CD (8/12 cm)
-------------------	---

Supported MP3 disc format

Max. title number	128 (depending on file name length)
Max. album number	99
Supported sampling frequencies	32 kHz, 44.1 kHz, 48kHz
Supported Bit-rates	32~320 (kbps) variable bit rates

Aux out

Frequency response	20Hz-20KHz
Output power	1000 mV

11 Troubleshooting



Warning

- Never remove the casing of this device.

To keep the warranty valid, never try to repair the system yourself. If you encounter problems when using this device, check the following points before requesting service. If the problem remains unsolved, go to the Philips web page (www.philips.com/support). When you contact Philips, make sure that the device is nearby and the model number and serial number are available.

No power

- Check if power adaptor of the unit is connected improperly.
- Check if there is power at the AC outlet.

No sound

- Check the volume.
- Check if the source is selected properly.
- Check if connecting cable is connected properly.

No response from the unit

- Disconnect and reconnect the power adaptor, then turn on the unit again.
- As a power-saving feature, the system switches off automatically 15 minutes after track play reaches the end and no control is operated.

Record sounds too fast or too slow

- Check if the speed is selected properly to match the vinyl record.

Turntable is spinning, but no sound

- Check the volume.
- Check if the source is switched to the Phono properly.
- Check if the stylus cover is removed properly.
- Check if the tone arm lift lever is already pushed down to make it fall on the record.

The audio quality is poor after connection with a Bluetooth-enabled device.

- The Bluetooth reception is poor.
Move the device closer to this unit or remove any obstacle between them.

Decline in turntable audio performance

- Check if the turntable stylus is worn out. Replace the stylus.

Bluetooth device cannot be connected with this unit.

- Check if the device does not support the profiles required for this unit.
- Check if Bluetooth function of the device is not enabled. Refer to the user manual of the device to find out how to enable the function.
- Check if this unit is not in pairing mode.
- Check if this unit is already connected with another Bluetooth-enabled device. Disconnect that device and then try again.



MMD Hong Kong Holding Limited. All rights reserved. Specifications are subject to change without notice. Philips and the Philips Shield Emblem are registered trademarks of Koninklijke Philips N.V. and are used under license. This product has been manufactured by and is sold under the responsibility of MMD Hong Kong Holding Limited or one of its affiliates, and MMD Hong Kong Holding Limited is the warrantor in relation to this product.