

PHILIPS

NeoPix 150

Home Projector

User Manual



Register your product and get support at
www.philips.com/support

Table of contents

Introduction.....	3	6 Wireless projection	14
Dear customer	3	Wireless projection with Android devices/ Windows computers	14
About this user manual	3	Wireless projection with iOS devices/Mac computers	15
What's in the box	3	Stream media using DLNA	16
Customer service center	3	7 Access a Wi-Fi network	17
1 General safety information	4	Connect to a Wi-Fi network	17
Setting up the product	4	Disconnect from a Wi-Fi network	17
Repairs	4	Reconnect to a Wi-Fi network	17
Power supply	5	Turn Wi-Fi on or off	17
2 Overview	5	8 Change projector settings	18
Rear view	5	9 Maintenance.....	20
Front view	6	Cleaning.....	20
Top view	6	Update software	20
Side view	6	10 Troubleshooting	21
Bottom view	6	11 Appendixes.....	23
Remote control	6	Technical data	23
3 Initial setup.....	7	CE statement	24
Install the projector.....	7	FCC statement	24
Connect to power supply	8	Canada regulatory compliance	24
Prepare the remote control	8	Other notice.....	25
Power on and set up the projector	9		
4 Connect to other devices	10		
Connect to a playback device through HDMI™	10		
Connect to a dongle.....	10		
Connect to a Bluetooth device.....	11		
Connect to wired speakers or headphones.....	12		
5 Play/view media from USB storage devices.....	13		
Connect a USB storage device	13		
Play videos.....	13		
Play audios	13		
View images	13		
View text files.....	14		

Introduction

Dear customer

Thank you for purchasing this projector.

We hope you enjoy this product and the many functions it offers!

About this user manual

The quick start guide supplied with this product allows you to start using this product quickly and easily. Detailed descriptions can be found in the following sections of this user manual.

Read the entire user manual carefully. Follow all safety instructions in order to ensure proper operation of this product (see **General safety information, page 4**). The manufacturer accepts no liability if these instructions are not followed.

Symbols used

Notice

i This symbol indicates tips that will help you use this product more effectively and easily.

DANGER!



Danger of personal injury!

This symbol gives warning of danger of personal injury. Physical injury or damage can result from improper handling.

CAUTION!



Damage to the product or loss of data!

This symbol gives warning of damage to the product and possible loss of data. Damage can result from improper handling.

What's in the box

- ① NeoPix 150 projector (NPX150/INT)
- ② Remote control
- ③ AAA batteries x 2
- ④ USB-C to HDMI™ cable
- ⑤ Quick Start Guide with Warranty Card
- ⑥ AC power cables with plugs x 4

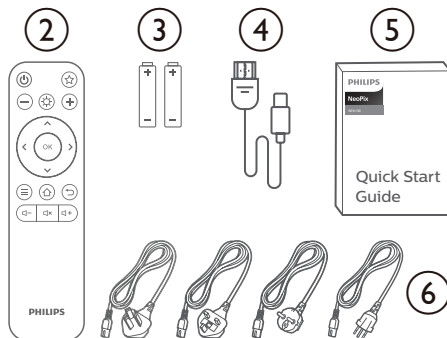
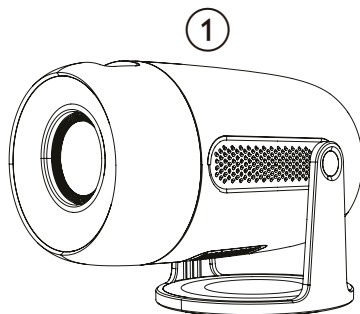

Customer service center

The Support page, warranty card, and user manuals can be found here:

Web: www.philips.com/support

Support Contacts:

International Phone: +41 215 391 665

Please ask your provider for international call costs!

Mail: support@philipsprojection.com

Access our FAQ websites:

<https://support.philipsprojection.com>

<https://community.philipsprojection.com>

1 General safety information

Take note of all warning and safety notes indicated. Do not make any changes or settings that are not described in this user manual. Incorrect operation, and improper handling can lead to physical injury, damage to the product or loss of data.

Setting up the product

This product is for indoor use only. Place the product securely on a stable, flat surface. To help avoid possible injuries to persons or damage to the product itself, position all cables in such a way that no one will trip over them.

Do not operate the product in damp rooms. Never touch the mains cable or the mains connection with wet hands.

Never operate the product immediately after moving it from a cold location to a hot location. When the product is exposed to such a change in temperature, moisture may condense on the crucial internal parts.

The product must have sufficient ventilation and must not be covered. Do not put the product in closed cabinets, boxes, or other enclosures when in use.

Protect the product from direct sunlight, heat, intense temperature fluctuations and moisture. Do not place the product in the vicinity of heaters or air conditioners. Observe the information on temperature listed in the technical data (see **Technical data, page 23**).

Prolonged operation of the product causes the surface to become hot. In case of overheating, the product automatically switches to standby mode.

Do not allow liquids to leak into the product. Turn off the product and disconnect it from the mains supply if liquids or foreign substances leaked into the product. Have the product inspected by an authorised service center.

Always handle the product with care. Avoid touching the lens. Never place heavy or sharp objects on the product or on the power cable.

If the product gets too hot or emits smoke, shut it down immediately and unplug the power cable. Have your product checked by an authorised service center. Keep the product away from open flames (e.g. candles).

DANGER!



Risk of explosion with incorrect type of batteries!

There is a risk of explosion if the wrong battery type is used.

Do not expose the batteries (battery pack or embedded batteries) to excessive heat such as sunshine, or open fire.

Under the following conditions, a layer of moisture can appear inside the product which can lead to malfunctions:

- if the product is moved from a cold to a warm area;
- after a cold room is heated;
- when the product is placed in a damp room.

Proceed as follows to avoid any moisture buildup:

- 1 Seal the product in a plastic bag before moving it to another room, in order for it to adapt to room conditions.
- 2 Wait one to two hours before you take the product out of the plastic bag.

Do not use or store the device in a dusty environment. Dust particles and other foreign objects can damage the device, which will void the product warranty.

Do not expose the product to extreme vibrations. This may damage the internal components.

Do not allow children to handle the product without supervision. The packing materials should be kept out of the hands of children.

For your own safety, do not use the product during thunderstorms with lightning.

Repairs

Do not repair the product yourself. Improper maintenance can result in injuries or damage to the product. The product must be repaired by an authorised service center.

Please find the details of authorised service centers on the warranty card supplied with this product.

Do not remove the type label from this product, as this will void the warranty.

Power supply

Use only a power adapter which is certified for this product (see **Technical data, page 23**). Check whether the mains voltage of the power supply matches the mains voltage available at the setup location. This product complies with the voltage type specified on the product.

The power outlet shall be installed near the product and shall be easily accessible.

CAUTION!



Always use the  button to turn the projector off.

Turn off the product and unplug from the power outlet before cleaning the surface (see **Cleaning, page 20**). Use a soft, lint-free cloth. Never use liquid, gaseous or easily flammable cleaners (sprays, abrasives, polishes, alcohol). Do not allow any moisture to reach the interior of the product.

DANGER!





Risk of eye irritation!

This product is equipped with a high power LED (Light Emitting Diode), which emits very bright light. Do not look directly into the projector lens during operation. This could cause eye irritation or damage.

2 Overview

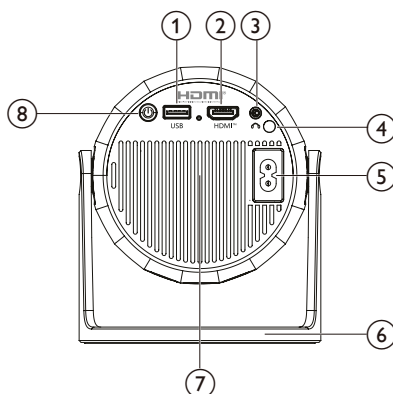
Rear view



- ① **USB**
Connect to a USB storage device or dongle.
- ② **HDMI™**
Connect to an HDMI™ output port on a playback device.
- ③ 
3.5 mm audio output; connect to external speakers or headphones.
- ④ **Rear IR sensor**
- ⑤ **AC power jack**
Connect to a supplied power cable.
- ⑥ **Ceiling hanging system**
- ⑦ **Air vent**
- ⑧ 
 - Switch the projector on or to standby mode.
 - When the projector is on, the LED lights up in white.
 - When the projector is in standby mode, the LED lights up in red.

Front view

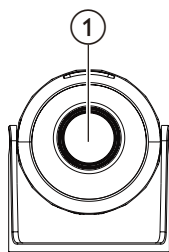

- ① Projection lens

Top view

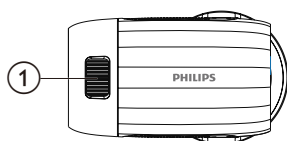

- ① Focus adjustment knob
Adjust image sharpness.

Side view

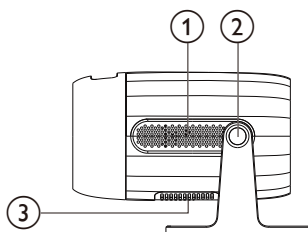

- ① Speaker
② Rotating stand
③ Air filter

Bottom view

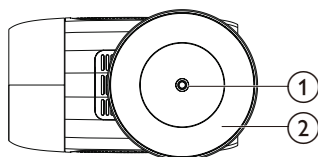

- ① Screw hole for ceiling mount
② Foot pad

Remote control

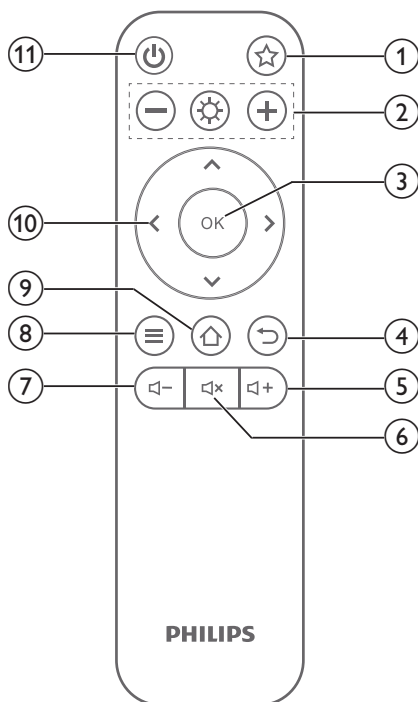

- ① ☆
Display star sky effect.
- ② − ⊙ +
Adjust the screen brightness.
- ③ OK
Confirm a selection or change the value for the current setting.
- ④ ↶
Return to the previous screen.
- ⑤ 🔊+
Increase the volume.
- ⑥ 🔊x
Mute or unmute the speaker.
- ⑦ 🔊−
Decrease the volume.
- ⑧ ≡
Open or close the projector's settings menu.
- ⑨ 🏠
Access the home screen
- ⑩ Navigation buttons (Up, Down, Left, Right)
• Navigate items on the screen.

- Press **▲/▼** or **◀/▶** to change the value for the current setting.



Switch the projector on or to standby mode.

3 Initial setup

Notice

 Make sure all devices are disconnected from their power supplies before establishing or changing any connections.

Install the projector

You can install the projector in four different ways. Follow the guidelines below to correctly install the projector.

Notice

 For overhead mounting on ceiling, purchase a projector mount recommended by an installation professional and follow the instructions that come with the mount.

Before mounting on the ceiling, make sure the ceiling can support the weight of the projector and mounting kit.

For ceiling installation, this product must be securely attached to the ceiling in accordance with the installation instructions. An improper ceiling installation may result in accident, injury or damage.

Front Table

- 1 Place the projector on a flat surface such as a table in front of the projection surface. This is the most common way to position the projector for quick setup and portability.

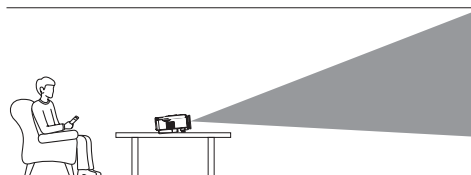

- 2 If the projection direction is incorrect, press **≡** on the remote control to open the settings menu, go to *Option > Flip*, and press the **OK** button to select *Front Table*.

Front Ceiling

- 1 Mount the projector on the ceiling with upside up in front of the projection screen. A projector mount is required to mount the projector on ceiling.

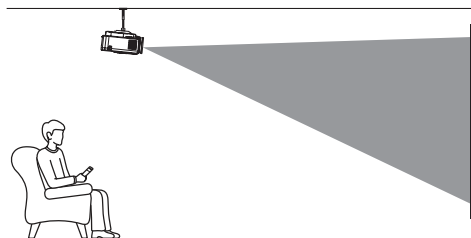

- 2 If the projection direction is incorrect, press **≡** on the remote control to open the settings menu, go to *Option > Flip*, and press the **OK** button to select *Front Ceiling*.

Back Table

- 1 Place the projector on a table behind the projection screen. A special rear projection screen is required.

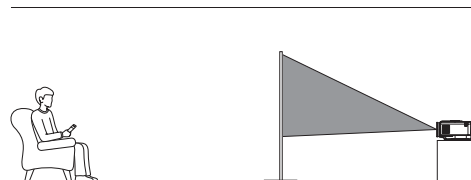

- 2 If the projection direction is incorrect, press **≡** on the remote control to open the settings menu, go to *Option > Flip*, and press the **OK** button to select *Back Table*.

Back Ceiling

- 1 Mount the projector on ceiling with upside up behind the projection screen. To mount the projector on ceiling behind the screen, a projector mount and a special rear projection screen are required.

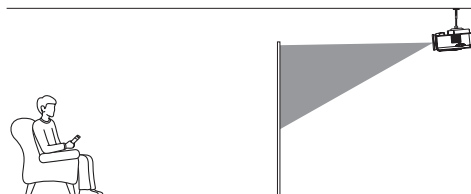

- 2 If the projection direction is incorrect, press **≡** on the remote control to open the settings menu, go to *Option > Flip*, and press the **OK** button to select *Back Ceiling*.

Connect to power supply

CAUTION!

- i** Always use the  button to turn the projector on and off.

- 1 Select a supplied power cable with the correct plug (AUS/EU/UK/US).
- 2 Connect the power cable to the power jack on the back of the projector.
- 3 Connect the power cable to an electrical socket.
 - The power LED on the projector lights up in red.

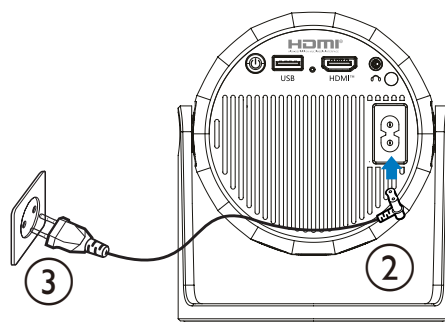

Prepare the remote control

CAUTION!

- i** The improper use of batteries can lead to overheating, explosion, risk of fire and injury. Leaking batteries can possibly damage the remote control. Never expose the remote control to direct sunlight.
- Avoid deforming, dismantling or charging the batteries.
- Avoid exposure to open fire and water.
- Replace empty batteries immediately.
- Remove the batteries from the remote control if not in use for long periods of time.

- 1 Open the battery compartment.
- 2 Insert the supplied batteries (type AAA) with correct polarity (+/-) indicated.
- 3 Close the battery compartment.

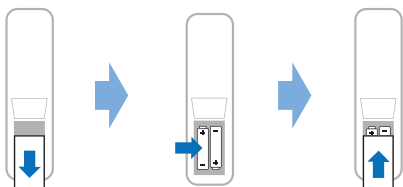

- When using a remote control with infrared signals, point the remote control at the IR sensor on the projector, and make sure there is no obstacle between the remote control and the IR sensor.

Power on and set up the projector

Power on/off the projector

- Before turning on the projector, make sure you have removed the lens cover.
- To turn on the projector, press on the projector/remote control. The power LED on the projector turns from red to white.

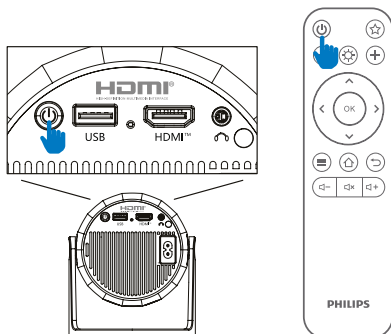

- To turn off the projector, press on the projector/remote control. The projector enters standby mode and its power LED turns from white to red.
- To fully shut down the projector, disconnect the power cable from the electrical socket.

Image focus adjustment

To adjust the image focus (sharpness), turn the focus adjustment knob above the projection lens.

Tip: If you change the projection distance later, you'll need to adjust the image focus again.

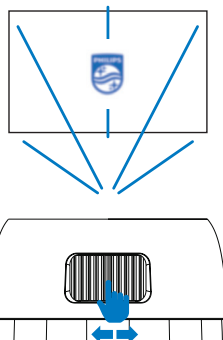

Screen size adjustment

The projection screen size (or size of images) is determined by the distance between the lens of the projector and the projection surface.

This projector has a recommended projection distance of 213 cm (83.9"), and thus creates a maximum screen size of 80" (203 cm). The minimum distance from the projection surface is 85 cm (33.5").

Projection direction adjustment

You can adjust the projection direction by rotating the main body around the pivot of the stand. The main body can rotate by up to 180°.

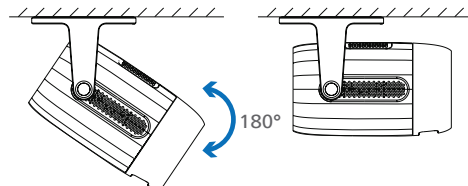

Image shape adjustment

You can let the projector automatically adjust the image shape (keystone) for you or adjust it manually.

To let the projector automatically adjust the image shape:

- 1 Press **≡** on the remote control to open the settings menu, go to *Keystone > Keystone Model*, and press the **OK** button to select *Auto*. The option named *Correction* then appears on the screen.
- 2 To start the automatic image shape adjustment, highlight *Correction* and then press the **OK** button. The adjustment is complete when the number next to *Correction* stops changing.

To manually adjust the image shape:

- 1 Press **≡** on the remote control to open the settings menu, go to *Keystone > Keystone Model*, and press the **OK** button to select *Manual*. Three options (+, *Reset* and -) then appears on the screen.
- 2 To adjust the image shape, highlight + or - from the option list and then press the **OK** button. To reset the image shape, highlight *Reset* and then press the **OK** button.

4 Connect to other devices

Connect to a playback device through HDMI™

You can connect a playback device (e.g. a Blu-ray player, gaming console, camcorder, digital camera or PC) to the projector through HDMI™ connection. With this connection, images are shown on the projection screen, and audio is played on the projector.

- 1 Using an HDMI™ cable, connect the **HDMI™** port on the projector to an HDMI™ output port on a playback device.

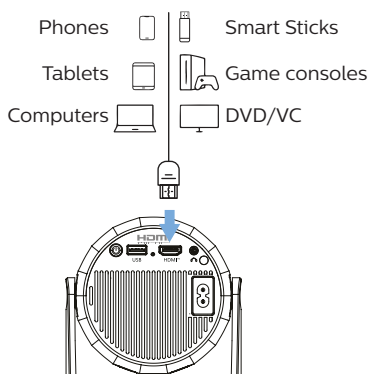

- 2 If the projector doesn't automatically switch to the correct input source, select **HDMI** from the home screen.

Connect to a dongle

You can connect a dongle (e.g. Amazon Fire Stick, Roku Stick and Chromecast) to the projector to easily watch videos over the internet. With this connection, images are shown on the projection screen, and audio is played on the projector.

- 1 Connect the dongle to the projector's **HDMI™** port directly or using an HDMI™ cable.
- 2 Connect the dongle to the projector's **USB** port using a USB cable. **Note:** The maximum current supplied by this port is 5V1A.

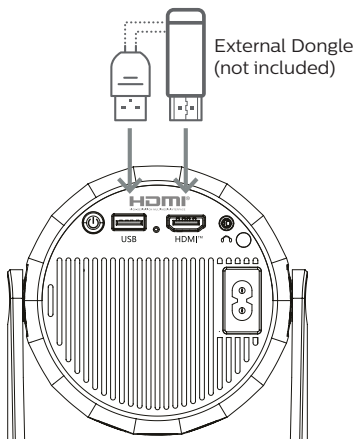

- 3 If the projector doesn't automatically switch to the correct input source, select **HDMI** from the home screen.

Connect to a Bluetooth device

The projector is equipped with Bluetooth technology, allowing you to connect it to Bluetooth devices such as Bluetooth speakers. Before you can use the projector with a Bluetooth device for the first time, you must pair the projector with it. The projector will automatically connect to a device as soon as they are paired.

Notice

- i** Be sure that the Bluetooth device is no farther than 10 m (33 ft) from the projector when connecting the two. Even when connecting within the specified communication distance, connections can be lost due to the signal status. You can pair the projector with multiple Bluetooth devices, but can only connect the projector to one of them at a time.

Enable/Disable Bluetooth on the projector

Bluetooth is enabled on the projector by default. You can manually enable or disable it.

- 1 Select **BT** from the home screen. The Bluetooth setting screen appears.
- 2 Highlight *BT Model* and then press the **OK**

button to enable or disable Bluetooth on the projector.

Pair a Bluetooth device

- 1 Turn on your Bluetooth device and make sure it is in pairing mode. Press the pairing button on the device, if needed. See the documentation supplied with the device for more information.
- 2 Select **BT** from the home screen. The Bluetooth setting screen appears.
- 3 If Bluetooth is disabled on the projector, highlight *BT Model* and then press the **OK** button to enable it.
- 4 Highlight *Search Bluetooth* and then press the **OK** button. The projector will scan for the available Bluetooth devices and display them on under *Other device*.
- 5 After the scanning stops, select your Bluetooth device from the list of available devices and press the **OK** button to start the pairing.

When the pairing is complete, your Bluetooth device moves to the list under *My device* and its status becomes *Connected*.

Tip: When the projector is connected to a Bluetooth device, a white Bluetooth icon appears near the upper-right corner of the home screen.

Disconnect a Bluetooth device

Use one of the following methods to disconnect a Bluetooth device from the projector but leave it paired.

- Highlight the Bluetooth device on the Bluetooth setting screen, press the **OK** button and select *Disconnect*.
- Terminate the Bluetooth connection from the Bluetooth device, or turn off the Bluetooth device.
- Disable Bluetooth on the projector.
- Turn off the projector.

Reconnect a Bluetooth device

Once you pair and connect a Bluetooth device to the projector using the steps above, the projector will automatically try to reconnect unless the Bluetooth device gets unpaired or its Bluetooth is off.

You can manually reconnect a paired Bluetooth device on the Bluetooth setting screen.

- 1 Highlight the Bluetooth device.
- 2 Press the **OK** button and then select *Connect*.

Delete a Bluetooth device

You can delete a Bluetooth device on the Bluetooth setting screen.

- 1 Highlight the Bluetooth device.
- 2 Press the **OK** button and then select *Delete*.

Tips for connecting audio output devices

The following are the tips for connecting Bluetooth audio output devices such as Bluetooth speakers and headphones.

- After connecting a Bluetooth audio output device, the projector will automatically set that device as its audio output device.
- After disconnecting a Bluetooth audio output device, the projector will automatically set its internal speaker as its audio output device.
- You can pair the projector with multiple audio output devices, but can only connect the projector to one of them at a time.

Connect to wired speakers or headphones

You can connect wired speakers or headphones to the projector. With this connection, audio from the projector is played through the external speakers or headphones.

- The internal speakers of the projector are deactivated automatically when external speakers or headphones are connected to the projector.



DANGER!



Danger of hearing damage!

Before connecting the headphones, turn down the volume on the projector.

Do not use the projector over a longer time at high volume – especially when using headphones. This could lead to hearing damage.

- 1 Using a 3.5 mm audio cable, connect the  jack on the projector to the analogue audio input (3.5 mm jack, or red and white jacks) on external speakers. Or connect the  jack on the projector to headphones.

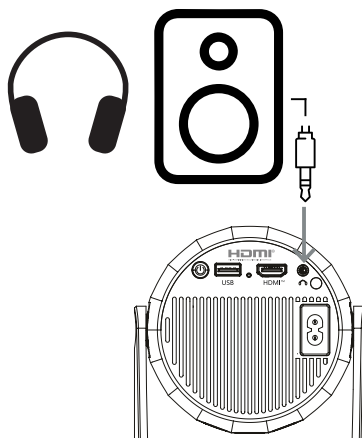

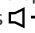
- 2 After connecting the speakers or headphones, press  **+/–** on the remote control to adjust the volume to the desired level.

5 Play/view media from USB storage devices

The projector has an integrated media player. Using this media player, you can play/view videos, audios, images or text files stored on a USB storage device.

Supported file formats

The integrated media player supports the following file formats.

- Video formats: MP4, RMVB, AVI, RM, MKV
- Audio formats: MP3, WMA, OGG, FLAC, WAV
- Image formats: BMP, PNG, JPEG

Connect a USB storage device

Notice

i The projector supports a USB storage device that is formatted for FAT16 or FAT32 file system.

- 1 Make sure your USB storage device contains media or text files supported by the integrated media player.
- 2 Connect your USB storage device to the **USB** port on the projector.

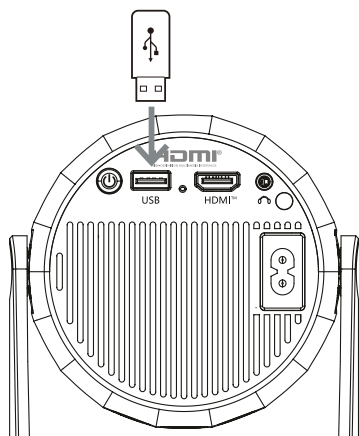

Play videos

- 1 From the projector's home screen, select **Movie**.
- 2 Press the **OK** button to open the USB storage device. **Note:** Only supported video files are displayed on the screen. All folders and files are ordered alphabetically by name.
- 3 Press the navigation buttons on the remote control to select a video file or a folder. To open a selected folder, press the **OK** button. To return to the parent folder, press **↶** or select **Back** on the screen.
- 4 Press the **OK** button to start playing the selected video file.
- 5 While a video file is playing, you can press the **OK** button or any of the navigation buttons to bring up the control bar at the bottom of the screen. The control bar will automatically disappear in 5 seconds. To instantly hide the control bar, press **↶**.
While the control bar is visible, press **▲** to select the progress bar and then press **↶/↷** to quickly rewind or fast-forward the video.
While the control bar is visible, press **↶/↷** to select an option and then press **OK** to confirm the action or change the value. To close the dialog box of an option, press **↶**.
- 6 To stop playing a video file and return to the list of files in the current folder, press **↶** on the remote control.

Play audios

You can play audios in a similar way as you play videos. The major differences are:

- In Step 1, you need to select **MUSIC** instead of **Movie**.
- When an audio is playing, you will always see the changing sound wave on the screen.

View images

You can view images in a similar way as you play videos. The major differences are:

- In Step 1, you need to select **Photo** instead of **Movie**.
- In Step 4, after you press the **OK** button, the projector starts the slide show of all supported images in the current folder from the selected image.
- You cannot change the speed of the slide

show.

View text files

You can view text files in a similar way as you view images. The major differences are:

- In Step 1, you need to select **Ebook** instead of **Photo**.
- In Step 4, after you press the **OK** button, the projector opens the selected text file and displays the first page of it. The projector doesn't automatically scroll down or open the next file.
- When viewing a text file, you can press the **OK** button or **</>** to bring up the control bar at the bottom of the screen.
- Press **▲/▼** to view the previous or next page of the text file.

6 Wireless projection

This projector can wirelessly mirror the screens of the following devices to the projection screen.

- Android devices
- Windows computers
- iOS devices (iPhone, iPad and iPod touch)
- Mac computers

Notice

 For better streaming performance, use a 5 GHz Wi-Fi network.

Copyright-protected content from Netflix, Amazon Prime Video, Hulu, etc. cannot be streamed.

The steps below might vary slightly depending on the version of your operating system and your device.

Wireless projection with Android devices/Windows computers

What you need

- An Android device or Windows computer that supports Miracast. **Note:** This feature is also called Screen Cast, Screen Sharing, Wireless Display, Wireless projection, etc. Not all devices have this feature. Refer to your device user manual for details.
- 1 Make sure the projector's Wi-Fi is on. To learn how to turn on Wi-Fi, see **Turn Wi-Fi on or off, page 17**. **Tip:** You do not need to connect the projector to a Wi-Fi network to use screen mirroring.
 - 2 Make sure you have turned on Wi-Fi on your Android device or Windows computer. **Tip:** You do not need to connect your device to a Wi-Fi network to use screen mirroring. But, connecting it to a Wi-Fi network will allow it to access the internet via Wi-Fi while its screen is being mirrored.
 - 3 From the projector's home screen, select **Wireless screen mirroring**, then select **ANDROID** to activate the screen mirroring function.
 - The projector displays its device name

and the status of the connection with your device on the screen.

- 4 On your Android device, access the “Settings” menu and then select the setting for wireless display or projection.

Or on your Windows 10 computer, select the **action center** icon in the lower-right corner of the screen and then select **Connect**.

Your device will automatically scan for and display the available display devices.

- 5 On your Android device or Windows computer, select the projector to make a connection and start mirroring your device's screen. **Note:** You may need to wait a few seconds for the screen mirroring to start.

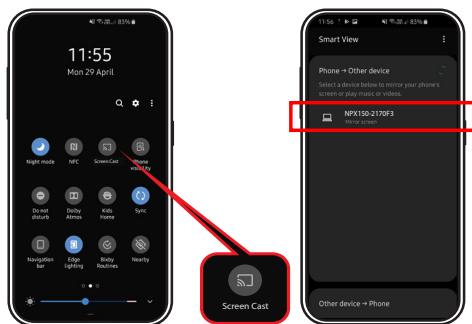

Wireless projection with iOS devices/Mac computers

Method 1

With this method, your iOS device cannot access the internet via Wi-Fi while its screen is being wirelessly mirrored.

What you need

- An iOS device such as an iPhone or a Mac computer.
- 1 Make sure the projector's Wi-Fi is on and the projector is not connected to any Wi-Fi network. To learn how to turn on Wi-Fi and disconnect from a Wi-Fi network, see **Access a Wi-Fi network, page 17**.
 - 2 From the projector's home screen, select **Wireless screen mirroring**, then select **IOS** to activate the screen mirroring function.
 - The projector displays the device name and password for connecting to its Wi-Fi network (hotspot), as well as the status of the connection with your device.

- 3 On your iOS device, go to **Settings > Wi-Fi** and turn on Wi-Fi if it's off. Or on your Mac computer, click the Wi-Fi icon  in the menu bar and turn on Wi-Fi if it's off. The list of available Wi-Fi networks is displayed.
- 4 On your iOS device or Mac computer, select the name of the projector's Wi-Fi network, enter the password displayed on the projector screen, and select **Join**.

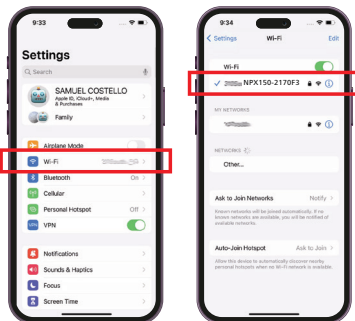

- 5 On your iOS device, open Control Center.
 - On iPhone X or later or iPad with iPadOS 13 or later: Swipe down from the upper-right corner of the screen.
 - On iPhone 8 or earlier or iOS 11 or earlier: Swipe up from the bottom edge of the screen.

Or on your Mac computer, select the AirPlay status icon  in the menu bar, which is near the upper-right corner of the screen.

- 6 On your iOS device, tap Screen Mirroring  in Control Center and select the projector to start mirroring your iOS device's screen.

Or on your Mac computer, select the projector to start mirroring your Mac computer's screen.

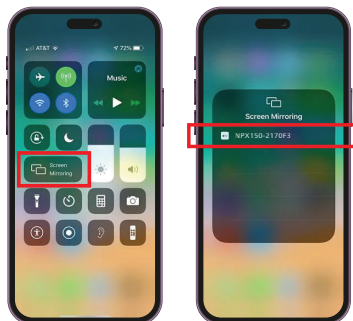

Note: You may need to wait a few seconds for the screen mirroring to start.



Method 2

With this method, your iOS device can access the internet via Wi-Fi while its screen is being wirelessly mirrored.

What you need

- An iOS device such as an iPhone or a Mac computer.
- 1 Make sure you have connected the projector and your iOS device or Mac computer to the same Wi-Fi network. To learn how to connect the projector to a Wi-Fi network, see **Connect to a Wi-Fi network, page 17**.
 - 2 From the projector's home screen, select **Wireless screen mirroring**, then select **IOS** to activate the screen mirroring function.
 - The projector displays its device name and the status of the connection with your device on the screen.
 - 3 On your iOS device, open Control Center.
 - On iPhone X or later or iPad with iPadOS 13 or later: Swipe down from the upper-right corner of the screen.
 - On iPhone 8 or earlier or iOS 11 or earlier: Swipe up from the bottom edge of the screen.
- Or on your Mac computer, select the AirPlay status icon  in the menu bar, which is near the upper-right corner of the screen.
- 4 On your iOS device, tap Screen Mirroring  in Control Center and select the projector to start mirroring your iOS device's screen.
- Or on your Mac computer, select the projector to start mirroring your Mac computer's screen.

Note: You may need to wait a few seconds for the screen mirroring to start.

Stream media using DLNA

What you need

- A smart device (e.g. a smartphone or tablet) with DLNA-supported media apps installed.
- 1 Make sure you have connected the projector and your smart device to the same Wi-Fi network. To learn how to connect the projector to a Wi-Fi network, see **Connect to a Wi-Fi network, page 17**.
 - 2 From the projector's home screen, select **DLNA** to activate the screen mirroring function.
 - The projector displays its device name and the status of its Wi-Fi connection on the screen.
 - 3 On your smart device, while playing a video/audio or viewing a picture in a DLNA-supported media app, tap or click the screen to show the controls if they are invisible.
 - 4 On your smart device, select the TV icon.
 - 5 On your smart device, select the projector to start streaming the video, audio or picture. **Note:** You may need to wait a few seconds for the streaming to start.

7 Access a Wi-Fi network

Connect to a Wi-Fi network

You can connect the projector to the same Wi-Fi network as your iOS device. With this connection, your iOS device can access the internet via Wi-Fi while its screen is being wirelessly mirrored. In addition, you can update the projector software online with this connection.

Note: An Android device can access the internet via Wi-Fi while its screen is being wirelessly mirrored, even when the projector is not connected to a Wi-Fi network.

What you need

- A wireless router connected to the internet. For best wireless performance and coverage, use an 802.11n router ("Wi-Fi 4").
- 1 Select **Wi-Fi** from the home screen to open the Wi-Fi settings screen. The projector will scan for and display the available Wi-Fi networks. The network with the strongest signal appears at the top of the list.
Note: If Wi-Fi is off, highlight the toggle on the left of the screen and press the **OK** button to turn it on.
- 2 Press the navigation buttons to highlight a network from the list of available Wi-Fi networks and press the **OK** button. You are prompted to enter the password for connecting to the network using the on-screen keyboard.
- 3 Enter the correct password using the navigation buttons and **OK** buttons.
- 4 Highlight the check mark on the keyboard and press the **OK** button.
- 5 Wait a few seconds for the connection to be established. After the connection is established, the projector displays the list of available Wi-Fi networks again. The connected Wi-Fi network appears at the top of the screen and its status is *Connected*.

Tip: When the projector is connected to a Wi-Fi network, a white Wi-Fi icon appears near the upper-right corner of the home screen.

Disconnect from a Wi-Fi network

- 1 Select **Wi-Fi** from the home screen to open the Wi-Fi settings screen. The projector will scan for and display the available Wi-Fi networks.
- 2 Press the navigation buttons to highlight the connected Wi-Fi network and press the **OK** button. A dialog box appears.
- 3 Highlight the **Disconnect** button and press the **OK** button to disconnect the projector from the connected Wi-Fi network and close the dialog box. This network will move to the list under **Saved Wi-Fi**.

Note: After you disconnect a Wi-Fi network, the projector will remember its password, unless you factory reset the projector.

Reconnect to a Wi-Fi network

When you turn on the projector again, the projector will automatically try to reconnect to the last connected Wi-Fi network, unless you factory reset the projector.

To manually reconnect to other previously connected Wi-Fi networks, follow these steps:

- 1 Select **Wi-Fi** from the home screen to open the Wi-Fi settings screen. The projector will scan for and display the available Wi-Fi networks.
- 2 Press the navigation buttons to highlight a Wi-Fi network in the list under **Saved Wi-Fi** and press the **OK** button. A dialog box appears.
- 3 Highlight the **Connect** button and press the **OK** button. Another dialog box appears.
- 4 To use the saved password for the reconnection, highlight the **No** button and press the **OK** button. To reenter the password, highlight the **Yes** button, press the **OK** button, and do Steps 3 and 4 in **Connect to a Wi-Fi network, page 17**.
- 5 Wait a few seconds for the connection to be established.

Turn Wi-Fi on or off

Wi-Fi is on by default. To turn it on or off, highlight the toggle on the left of the Wi-Fi settings screen and press the **OK** button.

8 Change projector settings

This section helps you change the projector settings using the settings menu.

- 1 Press **≡** on the remote control or select **Set** from the home screen to open the settings menu.
- 2 Use the navigation buttons and the **OK** button to select a menu item. Press **↶** to return to the previous level of the menu tree.
- 3 Press **▲/▼**, **↶/↷** or the **OK** button to select a value for the menu item.
- 4 Press the **OK** button to make the change.
Note: For some menu items such as *Contrast*, the change takes effect once you select a different value.
- 5 Press **≡** or **⬆**, or press **↶** one or more times to exit the settings menu.

Picture settings

You can view and change the following picture settings.

- *Image Mode:* Select predefined color settings for picture or video display. Select *User* to customize the following settings:
 - *Contrast:* Adjust the contrast of the projected image.
 - *Brightness:* Adjust the overall brightness of the projected image.
 - *Color:* Adjust the color saturation of the projected image.
 - *Sharpness:* Adjust the clarity of detail in the projected image.
- *Color Temperature:* You can set the projector to use the following color temperature types.
 - *Cold:* Make the picture more bluish.
 - *Standard:* Use a moderate color temperature.
 - *Warm:* Make the picture more reddish.

Sound settings

You can view and change the following sound settings.

- *Sound Mode:* You can set the projector to use the following sound modes, depending on your environment, audio type or preferences.
 - *Standard:* Optimize the bass and treble levels for general audio.
 - *Music:* Optimize the bass and treble levels for music.
 - *Movie:* Optimize the bass and treble levels for movies.
 - *Sports:* Optimize the bass and treble levels for sports.
 - *User:* Define your own bass and treble levels.
- *Treble:* Set the treble level. This menu item is enabled only when the sound mode is *User*.
- *Bass:* Set the bass level. This menu item is enabled only when the sound mode is *User*.
- *Balance:* Adjust the stereo balance to compensate for volume differences between the left and right speakers at the listening position.

Bluetooth settings

You can view and change the following Bluetooth settings.

- *BT Model:* Select this to enable or disable Bluetooth on the projector.
- *Search Bluetooth:* Select this to scan for the available Bluetooth devices.
- *My device:* The Bluetooth devices paired with the projector are displayed under this menu item.
- *Other device:* The available Bluetooth devices found by the projector are displayed under this menu item.

Keystone settings

You can view and change the following keystone settings.

- *Keystone Model:* Choose to toggle between automatic and manual keystone corrections.

Other settings

You can view and change the following additional settings.

- *OSD Language*: Select your preferred display language.
- *Flip*: Adjust the projection to the correct direction based on how the projector is installed.
- *Factory Reset*: Restore the projector's settings to the factory default settings. After the factory reset, the projector will shut down.
- *Software Upgrade*: Update the projector's software offline.
- *Auto Sleep*: Select a period of time after which the projector turns off automatically. The default value is *Off*.
- *OSD Timer*: Select a period of time after which the settings menu automatically closes. The default value is *15s*.
- *Video Delay*: Select the video delay. The default value is *500*.
- *Version Info*: View the software version of this product.
- *Net Upgrade*: Update the projector's software online.

9 Maintenance

Cleaning

DANGER!



Follow the following instructions when cleaning the projector:

Use a soft, lint-free cloth. Never use liquid or easily flammable cleansers (sprays, abrasives, polishes, alcohol, etc.). Do not allow any moisture to reach the interior of the projector. Do not spray the projector with any cleaning fluids.

Wipe over the surfaces gently. Be careful that you do not scratch the surfaces.

Cleaning the lens

Use a soft brush or lens cleaning paper for cleaning the lens of the projector.

DANGER!



Do not use any liquid cleaning agents!

Do not use any liquid cleaning agents for cleaning the lens, to avoid damaging the coating film on the lens.

Update software

You can update the projector software online or offline to get the best features and support from the projector.

CAUTION!



Do not turn off the projector or remove the USB flash drive during a software update.

Update software online

Updating the projector software online is quick and easy.

- 1 Make sure the projector can access the internet via a Wi-Fi network. To learn how to connect the projector to a Wi-Fi network, see **Connect to a Wi-Fi network, page 17**.
- 2 Press  on the remote control to open the settings menu and then select *Option > Net Upgrade*. The projector will automatically check for a new version of projector software. If a new version is found, the projector will prompt you to start the update.
- 3 If a new version is found, follow the on-screen instructions to complete the update.

Update software offline

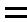
- 1 Visit www.philips.com/support, find your product (model number: **NPX150/INT**), open its support page and locate "**Software & drivers**".
- 2 From the support page you opened in step 1, download the software installation file to a USB flash drive. Unzip the downloaded file and save the resulting file in the root directory of the USB flash drive.
- 3 Connect the USB flash drive to the projector.
- 4 Press  on the remote control to open the settings menu and then select *Option > Software Upgrade*.
- 5 Follow the on-screen instructions to complete the update.

10 Troubleshooting

Power cycling

If a problem occurs and you cannot resolve it using the instructions in this user manual, try the following steps to resolve the problem.

- 1 Turn the projector off by pressing \odot .
- 2 Wait at least 10 seconds.
- 3 Turn the projector on by pressing \odot .
- 4 If the problem persists, contact one of our customer service centers or your dealer.

Problem	Solution
The projector cannot be turned on.	<ul style="list-style-type: none">• Disconnect and reconnect the power cable, and try to turn the projector on again.
The projector cannot be turned off.	<ul style="list-style-type: none">• Press and hold \odot longer than ten seconds. If this does not work, disconnect the power cable.
No image from the external HDMI™ device.	<ol style="list-style-type: none">1. Check if you have switched the input source to <i>HDMI</i>.2. Disconnect the HDMI™ cable or switch off the HDMI™ device.3. Wait three seconds.4. Reconnect the HDMI™ cable or switch on the HDMI™ device again.
No sound from the external connected device.	<ul style="list-style-type: none">• Check the cables to the external device.• Check that the sound is activated on the external device.• Only the original cables from the device manufacturer may function.
No sound from external HDMI™ output device.	<ul style="list-style-type: none">• On the HDMI™ output device, set the audio setting to Multichannel (Raw data) & Stereo (PCM).
No sound when you connect your computer using an HDMI™ cable.	<ul style="list-style-type: none">• Check that the sound is activated on the computer.
Only the home menu appears and not the image from the external device.	<ul style="list-style-type: none">• Check if the cables are connected to the correct sockets.• Check that the external device is turned on.• Check if the video output of the external device is turned on.
Only the home menu appears and not the image from the connected computer.	<ul style="list-style-type: none">• Check that the HDMI™ output of the computer is turned on.• Check if the resolution of the computer is set to 1920*1080.
The projector turns itself off.	<ul style="list-style-type: none">• When the projector is running for a long period of time, the surface becomes hot.• Check that the power cable is connected correctly.
The projector cannot read the USB storage device.	<ul style="list-style-type: none">• The projector does not support the exFAT file system.• Format the USB storage device in FAT32 or NTFS format, then use it.

Problem	Solution
The projector does not react to remote control commands.	<ul style="list-style-type: none"> • Check the batteries of the remote control.
The temperature of the projector's surface is warm.	<ul style="list-style-type: none"> • For this projector it is normal to generate moderate heat during operation.
The projector does not work after I connect it to a laptop.	<ul style="list-style-type: none"> • Check that the HDMI™ cable is plugged in correctly. • Make sure that the laptop has been switched to projector display.
I cannot pair the projector with a Bluetooth device.	<ul style="list-style-type: none"> • Turn on the Bluetooth device and make sure it is in pairing mode. • Position the Bluetooth device so that it is less than 10 m (33 ft) from the projector. • To connect a Bluetooth device to the projector, follow the instructions in Connect to a Bluetooth device, page 11. • If another Bluetooth device is already connected to the projector, disconnect it. • Move the projector farther away from other devices (microwave oven, wireless router, etc.) that are emitting radio frequency signals.
After a Bluetooth device is connected, there is no sound from the projector or the Bluetooth device.	<ul style="list-style-type: none"> • Check if the Bluetooth device's volume is at the minimum. • Check if projector's volume is at the minimum. • Check if the playback has started. • Try playing another video/audio file. • Try reconnecting the two devices.
Black / White Pixels	<p>An LCD display may contain a small number of pixels that do not function normally (also known as “dead pixels” or “black pixels”). Your display has been inspected and is in compliance with the manufacturer's specifications, meaning that any pixel defects do not affect the operation or use of your display. Without prejudice to generality of the foregoing, dead pixels or black pixels not exceeding 5 dots meet the factory specifications and are not considered a defect under this warranty.</p> <p>Dust Deposit – Warranty Exclusion:</p> <p>Dust may accumulate inside the projector over time. This can affect the image quality and even disrupt the functioning of the device. However, this phenomenon is not considered a defect under this warranty.</p> <p>We recommend regularly cleaning the lens with a soft cloth suitable for glass cleaning. You can also push dry air through the air vents to remove dust from the optical engine inside the device.</p>

11 Appendixes

Technical data

Technology/optical

Display technology	LCD
Light source	single LED W
Brightness	250 ANSI Lumens
Resolution	1920 x 1080 pixels
LED lifetime	over 30,000 hours
Contrast ratio	1000:1
Aspect ratio	16:9
Throw ratio	1.2:1
Screen size (diagonal)	from 40" to 80"
Screen distance....	213 cm / 83.9" for 80" screen
Projection modes	4
Focus adjustment	manual
Keystone correction	automatic
Sleep timer	yes

Sound

Built-in speakers	2 x 3 W
Speaker type	stereo

Connection

HDMI™ in	x1
USB-A (5 V/1 A out + external drive)	x1
3.5 mm audio out	x1
Wi-Fi	802.11a/b/g/n/ac, 2.4 + 5 GHz
Wi-Fi screen mirroring	yes
Bluetooth	To connect speaker, etc.

Power source

Power consumption	operating: 52 W
.....	standby: 0.5 W
Input: AC 100–240 V, 50/60 Hz, 1.0 A (Max)	

Multimedia player

Supported video formats: MP4, RMVB, AVI, RM, MKV

Supported audio formats: MP3, WMA, OGG, FLAC, WAV

Supported photo formats: BMP, PNG, JPEG

Dimensions and weight

Unpacked (W x D x H)	126 x 208 x 144 mm
Packed (W x D x H)	273 x 210 x 132 mm
Net weight	0.85 kg / 1.87 lb
Gross weight	1.88 kg / 4.14 lb

Temperature requirements

Operating temperature	5 °C – 35 °C
Storage temperature	< 60 °C

Package contents

1. NeoPix 150 projector
2. Remote control
3. Power cables (AUS, EU, UK, US)
4. AAA batteries for remote control
5. USB–C to HDMI™ cable
6. Quick Start Guide with Warranty Card

Model

NPX150/INT
EAN (INT): 7640186962827
UPC: 667619993156

CE statement

- The product shall only be connected to a USB interface of version USB 2.0 or higher.
- Adapter shall be installed near the equipment and shall be easily accessible.
- The operating temperature of the EUT can't exceed 35°C and shouldn't be lower than 5°C.
- The plug is considered as disconnect device of adapter.
- The UNII Band 5150-5250 MHz is for indoor use only.
- The device complies with RF specifications when the device is used at 20 cm from your body.

Hereby, Screeneo Innovation SA declares that this product is in compliance with essential requirements and other relevant provisions of Directive 2014/53/EU.



The Declaration of Compliance can be consulted on the site www.philips.com.

Frequency bands	Maximum output power
BT EDR (EIRP)	9.09 dBm
BT BLE (EIRP)	4.85 dBm
Wi-Fi 2.4GHz (EIRP)	17.88 dBm
Wi-Fi 5GHZ (EIRP)	17.89 dBm

FCC statement

15.19 Labeling requirements.

This device complies with part 15 of the FCC Rules. Operation is subject to the following two conditions: (1) This device may not cause harmful interference, and (2) this device must accept any interference received, including interference that may cause undesired operation.

15.21 Information to the user.

Any changes or modifications not expressly approved by the party responsible for compliance could void the user's authority to operate the equipment.

15.105 Information to user.

This equipment has been tested and found to comply with the limits for a Class B digital device, pursuant to Part 15 of the FCC Rules. These limits are designed to provide reasonable protection against harmful interference in a residential installation. This equipment generates, uses and can radiate radio frequency energy and, if not installed and used in accordance with the instructions, may cause harmful interference to radio communications. However, there is no guarantee that interference will not occur in a particular installation. If this equipment does cause harmful interference to radio or television reception, which can be determined by turning the equipment off and on, the user is encouraged to try to correct the interference by one or more of the following measures:

- Reorient or relocate the receiving antenna.
- Increase the separation between the equipment and receiver.
- Connect the equipment into an outlet on a circuit different from that to which the receiver is connected.
- Consult the dealer or an experienced radio/TV technician for help.

During operation, the separation distance between the user and the antenna shall be at least 20 cm. This separation distance will ensure that there is sufficient distance from a properly installed externally-mounted antenna to satisfy the RF exposure requirements.

FCC ID: 2ASRT-NPX150

Canada regulatory compliance

This device complies with Industry Canada CAN ICES-3 (B)/NMB-3(B)

RSS-Gen & RSS-247 statement: This device complies with Industry Canada RSS standard(s).

Operation is subject to the following two conditions:

- 1 This device may not cause interference, and
- 2 This device must accept any interference, including interference that may cause undesired operation of the device.

RF Radiation Exposure statement: The device meets the exemption from the routine evaluation limits in section 2.5 of RSS102 and users can obtain Canadian information on RF exposure and compliance.

This device should be installed and operated with a minimum distance of 7.8 inches (20 centimetres) between the device and your body.

Other notice

Preservation of the environment as part of a sustainable development plan is an essential concern of Screeneo Innovation SA. The desire of Screeneo Innovation SA is to operate systems respecting the environment and consequently it has decided to integrate environmental performances in the life cycle of these products, from manufacturing to commissioning use and elimination.

Batteries: If your product contains batteries, they must be disposed of at an appropriate collection point.



Product: The crossed-out waste bin symbol on the product means that the product belongs to the family of electrical and electronic equipment. In this respect, the European regulations ask you to dispose of it selectively:

- At sales points in the event of the purchase of similar equipment.
- At the collection points made available to you locally (drop-off center, selective collection, etc.).

In this way you can participate in the reuse and upgrading of Electrical and Electronic Equipment Waste, which can have an effect on the environment and human health.

The paper and cardboard packaging used can be disposed of as recyclable paper. Have the plastic wrapping recycled or dispose of it in the non-recyclable waste, depending on the requirements in your country.

Trademarks: The mentioned references in this manual are trademarks of the respective companies. The lack of the trademarks ® and ™ does not justify the assumption that these dedicated terminologies are free trademarks. Other product names used herein are for identification purposes only and may

be trademarks of their respective owners.

Screeneo Innovation SA disclaims any and all rights in those marks.

Neither Screeneo Innovation SA nor its affiliates shall be liable to the purchaser of this product or third parties for damages, losses, costs, or expenses incurred by the purchaser or third parties as a result of accident, misuse, or abuse of this product or unauthorised modifications, repairs, or alterations to this product, or failure to strictly comply with Screeneo Innovation SA operating and maintenance instructions.

Screeneo Innovation SA shall not be liable for any damages or problems arising from the use of any options or any consumable materials other than those designated as original Screeneo Innovation SA/PHILIPS products or Screeneo Innovation SA/PHILIPS approved products.

Screeneo Innovation SA shall not be held liable for any damage resulting from electromagnetic interference that occurs from the use of any interface cables other than those designated as Screeneo Innovation SA/PHILIPS products.

All rights reserved. No part of this publication may be reproduced, stored in a retrieval system or transmitted in any form or by any means, electronic, mechanical, photocopying, recording, or otherwise, without the prior written permission of Screeneo Innovation SA. The information contained herein is designed only for use with this product. Screeneo Innovation SA is not responsible for any use of this information as applied to other devices.

This user manual is a document that does not represent a contract.

Errors, printing errors and changes are reserved.

HDMI™
HIGH-DEFINITION MULTIMEDIA INTERFACE

The terms HDMI, HDMI High-Definition Multimedia Interface, HDMI Trade Dress and the HDMI Logos are trademarks or registered trademarks of HDMI Licensing Administrator, Inc.



Screeneo Innovation SA

Route de Lully 5c - 1131 Tolochenaz - Switzerland

Philips and the Philips Shield Emblem are registered trademarks of Koninklijke Philips N.V. and are used under license. Screeneo Innovation SA is the warrantor in relation to the product with which this booklet was packaged.