

# PHILIPS

## Soundbar

4000 Series

TAB4000



# User manual

Register your product and get support at

[www.philips.com/support](http://www.philips.com/support)

# Contents

<b>1</b>	<b>Important safety instructions</b>	<b>3</b>
	Safety	3
	Care for your product	4
	Care of the environment	4
	Declaration of conformity	5
	Help and support	5
<b>2</b>	<b>Your soundbar</b>	<b>5</b>
	What's in the box	5
	Main unit	6
	Connectors	6
	Remote control	7
	Prepare the remote control	7
	Placement	8
	Wall mount	9
<b>3</b>	<b>Connect</b>	<b>10</b>
	Connect to HDMI ARC	10
	Connect to power	10
<b>4</b>	<b>Use your soundbar</b>	<b>11</b>
	Turn ON and OFF	11
	Select equalizer (EQ) effect	11
	Adjust the volume	12
	Factory reset	13
	Bluetooth operation	13
	USB operation	14
	HDMI ARC operation	15
<b>5</b>	<b>Product specifications</b>	<b>15</b>
<b>6</b>	<b>Troubleshooting</b>	<b>16</b>
<b>7</b>	<b>Trademarks</b>	<b>18</b>

# 1 Important safety instructions

Read and understand all instructions before you use your product. If damage is caused by failure to follow instructions, the warranty does not apply.

---

## Safety



The symbol indicates DC voltage.



Follow the instructions in the user manual!

### Risk of electric shock or fire!

- Before you make or change any connections, make sure that all devices are disconnected from the power outlet.
- Never expose the product and accessories to rain or water. Never place liquid containers, such as vases, near the product. If liquids are spilt on or into the product, disconnect it from the power outlet immediately. Contact Consumer Care to have the product checked before use.
- Never place the product and accessories near naked flames or other heat sources, including direct sunlight.
- Never insert objects into the ventilation slots or other openings on the product.
- Where the mains plug or an appliance coupler is used as the disconnect device, the disconnect device shall remain readily operable.

- Battery (battery pack or batteries installed) shall not be exposed to excessive heat such as sunshine, fire or the like.
- Disconnect the product from the power outlet before lightning storms.
- When you disconnect the power cord, always pull the plug, never the cable.
- Use the product in tropical and/or moderate climates.

### Risk of short circuit or fire!

- For identification and supply ratings, see the type plate at the back or bottom of the product.
- Before you connect the product to the power outlet, ensure that the power voltage matches the value printed on the back or bottom of the product. Never connect the product to the power outlet if the voltage is different.

### Risk of injury or damage to this product!

- For wall mounting, this product must be securely attached to the wall in accordance with the installation instructions. Use only the supplied wall mount bracket (if available). Improper wall mounting may result in accident, injury or damage. If you have any query, contact Consumer Care in your country.
- Never place the product or any objects on power cords or on other electrical equipment.
- If the product is transported in temperatures below 5°C, unpack the product and wait until its temperature matches room temperature before connecting it to the power outlet.
- Parts of this product can be made of glass. Handle with care to avoid injury and damage.

## Risk of overheating!

- Never install this product in a confined space. Always leave a space of at least four inches around the product for ventilation. Ensure curtains or other objects never cover the ventilation slots on the product.

## Battery usage CAUTION

- CAUTION: Danger of explosion if batteries are incorrectly replaced. Replace only with the same or equivalent type.
- Remove batteries if they are exhausted or if the remote control is not to be used for a long time.
- Batteries contain chemical substances, they should be recycled or disposed of as per state and local guidelines.
- Install all batteries correctly, + and - as marked on the apparatus.
- Do not mix old and new batteries.
- Do not mix alkaline, standard (Carbon-Zinc) or rechargeable (Ni-Cd, Ni-MH, etc.) batteries.
- The battery (batteries or battery pack) shall not be exposed to excessive heat such as sunshine, fire or the like.
- Don't disposal of a battery into fire or a hot oven, or mechanically crushing or cutting of a Battery.
- To avoid battery subjected to extremely low air pressure.

## Care for your product

Use only microfiber cloth to clean the product.

## Care of the environment

### Disposal of your old product and battery



Your product is designed and manufactured with high quality materials and components, which can be recycled and reused.



This symbol on a product means that the product is covered by European Directive 2012/19/EU.



This symbol means that the product contains batteries covered by European Directive 2013/56/EU which cannot be disposed of with normal household waste.

Inform yourself about the local separate collection system for electrical and electronic products and batteries. Follow local rules and never dispose of the product and batteries with normal household waste. Correct disposal of old products and batteries helps prevent negative consequences for the environment and human health.

### Removing the disposable batteries

To remove the disposable batteries, see battery installation section.

### Note

- The rating label is pasted on the bottom or back of the equipment.

# Declaration of conformity

This product complies with the radio interference requirements of the European community.

Hereby, TP Vision Europe B.V. declares that the product is in compliance with the essential requirements and other relevant provisions of RED Directive 2014/53/EU and UK Radio Equipment Regulations SI 2017 No 1206. You can find the Declaration of Conformity on [www.philips.com/support](http://www.philips.com/support).

# Help and support

For extensive online support, visit [www.philips.com/support](http://www.philips.com/support) to:

- download the user manual and the quick start guide
- watch video tutorials (available only for selected models)
- find answers to frequently answered questions (FAQs)
- email us a question
- chat with our support representative.

Follow the instructions on the website to select your language, and then enter your product model number.

Alternatively, you can contact Consumer Care in your country. Before you contact, note down the model number and serial number of your product. You can find this information on the back or bottom of your product.

# 2 Your soundbar

Congratulations on your purchase, and welcome to Philips! To fully benefit from the support that Philips offers, register your soundbar at [www.philips.com/support](http://www.philips.com/support).

# What's in the box

Check and identify the items in the package:

- |                       |     |
|-----------------------|-----|
| • Soundbar            | x 1 |
| • Remote control      | x 1 |
| • Wall mount kit      | x 1 |
| • Wall mount template | x 1 |
| • Adapter             | x 1 |
| • Quick start guide   | x 1 |
| • Warranty card       | x 1 |
| • Safety sheet        | x 1 |

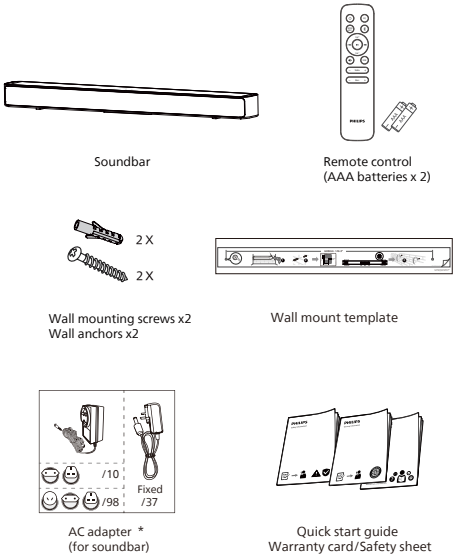

- Images, illustrations and drawings shown on this User Manual are for reference only, actual product may vary in appearance.

# Power

Adapter and plug type vary by regions.

- Adapter model: PG241-1501600U  
PG241-1501600I
- Manufacturer: Shenzhen Perect Gallant  
Tec Co.,Ltd.

Note

- For applicable power supplies see user instructions.

# Main unit

This section includes an overview of the main unit.

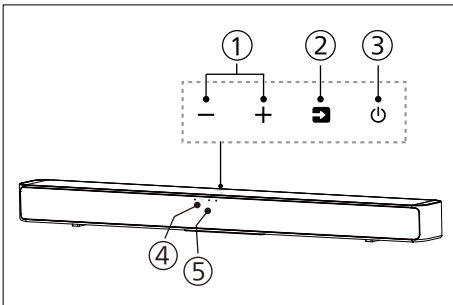

- ① **+/- (Volume)**  
Increase or decrease volume.
- ② **[Source]**  
Select an input source for the soundbar. Default source is HDMI ARC.
- ③ **[Standby-On]**
  - Switch the soundbar On or toStandby.
  - Long press for 8 seconds in power on state to enable or disable Auto-Standy (15 minutes Auto-Standy).

Status	LED state
Enable Auto Power Down	Standby LED fast blink
Disable Auto Power Down	Standby LED slow blink

Status	LED state
<b>USB</b>	[USB] Solid white
<b>Standby</b>	[Standby] Solid red
<b>BT(Bluetooth)</b> <ul style="list-style-type: none"><li>• Connected</li><li>• disconnected</li></ul>	[BT] Solid white [BT] Blinking white
<b>HDMI ARC</b> <ul style="list-style-type: none"><li>• Supported</li><li>• Unsupported</li></ul>	[HDMI ARC] Solid white [HDMI ARC] Blinking white

- ⑤ **Remote control sensor**

# Connectors

This section includes an overview of the connectors available on your soundbar.

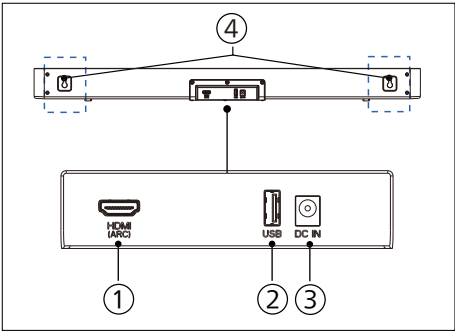

- ① **HDMI out (ARC)**  
Connect to the HDMI (ARC) input on the TV.
- ② **USB**
  - Connect to a USB storage device for audio media play.
  - Upgrade software of this product.
- ③ **DC in**  
Connect to the adapter.
- ④ **Wall bracket slot.**

## Remote control

This section includes an overview of the remote control.

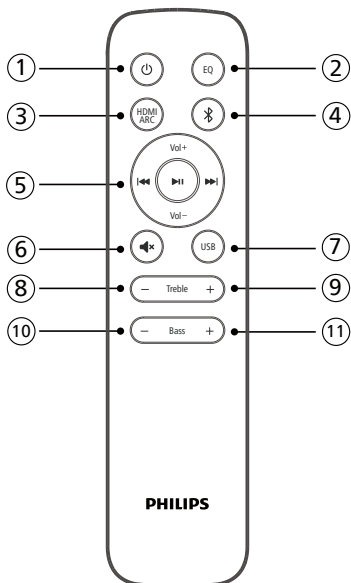

- ① **⏻** (Standby-On) button
  - Switch the soundbar On or to standby.
- ② **EQ** (Mode)  
Select from the four EQ modes: Movie/Music/Voice/Stadium.
- ③ **HDMI ARC**  
Switch your source to HDMI ARC connection.
- ④ **📶**  
Short press to switch to Bluetooth source. The soundbar will reconnect to the last paired device if it's available. Press and hold for 3 seconds to disconnect from all Bluetooth devices and enter pairing mode.

- ⑤ **⏮ / ⏭** (Previous / Next)  
Skip to the previous or next track in USB/ BT mode.  
**⏮** (Play / Pause)  
Start, pause or resume play in USB/ BT mode.  
**VOL+ / VOL-** (System volume)  
Increase / decrease system volume level.
- ⑥ **🔇**  
Mute or restore volume.
- ⑦ **USB :**  
Switch your audio source to the USB connection.
- ⑧ **- Treble**  
Decrease the soundbar's treble volume.
- ⑨ **+ Treble**  
Increase the soundbar's treble volume.
- ⑩ **-Bass**  
Decrease the soundbar's bass volume.
- ⑪ **+Bass**  
Increase the soundbar's bass volume.

## Prepare the remote control

- The provided remote control allows the unit to be operated from a distance.
- Even if the remote control is operated within the effective range 19.7 feet (6m), remote control operation may be impossible if there are any obstacles between the unit and the remote control.
- If the remote control is operated near other products which generate infrared rays, or if other remote control devices using infra-red rays are used near the unit, it may operate incorrectly. Conversely, the other products may operate incorrectly.

---

## Replace the remote control battery

Slide to remove the battery compartment cover, insert 2 AAA batteries (1.5V) with correct polarity, then slide the battery compartment cover back into position.

- Make sure the (+) and (–) ends of the batteries match the (+) and (–) ends indicated in the battery compartment.

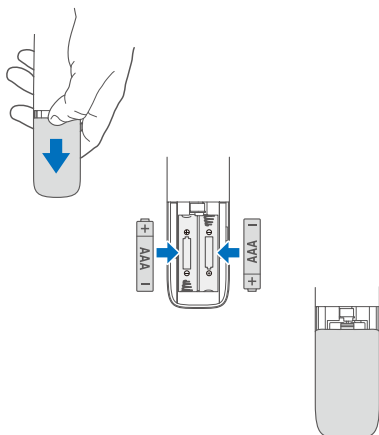

---

## Precautions concerning batteries

- Be sure to insert the batteries with correct positive “ $\oplus$ ” and negative “ $\ominus$ ” polarities.
- Use batteries of the same type. Never use different types of batteries together.
- Either rechargeable or non-rechargeable batteries can be used. Refer to the precautions on their labels.
- Be aware of your fingernails when removing the battery cover and the battery.
- Do not drop the remote control.
- Do not allow anything to impact the remote control.
- Do not spill water or any liquid on the remote control.

- Do not place the remote control on a wet object.
- Do not place the remote control under direct sunlight or near sources of excessive heat.
- Remove the battery from the remote control when not in use for a long period of time, as corrosion or battery leakage may occur and result in physical injury, and/or property damage, and/or fire.
- Do not use any batteries other than those specified
- Do not mix new batteries with old ones.
- Never recharge a battery unless it is confirmed to be a rechargeable type.

---

## Placement

Place your soundbar as shown below.

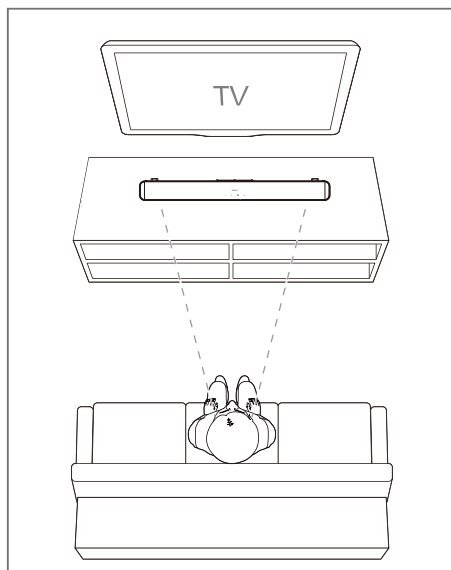



# Wall mount

## Note

- Improper wall mounting may result in accident, injury or damage. If you have any query, contact Consumer Care in your country.
- Before wall mounting, make sure the wall can support the weight of your soundbar.
- Before wall mounting, you need not remove the rubber feet at the bottom of the soundbar, otherwise the rubber feet cannot be fixed back.
- Depending on the type of wall mounting, make sure that you use screws of a suitable length and diameter.
- Please check whether the USB port on the back of the soundbar is connected to a USB device. If it is found that the connected USB device affects the wall-mount, you need to use another USB device of the appropriate size.

## Screw length/diameter

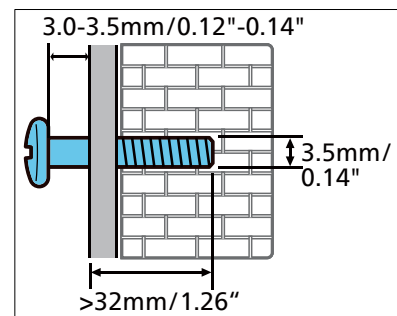

## Suggested wall mounting height

You are recommended to install the TV first before wall mounting the soundbar. With a TV preinstalled, wall mount the soundbar 50mm/2.0" in distance from the bottom of the TV.

## WARNING !

- To prevent injury, this apparatus must be securely attached to the floor/wall in accordance with the installation instructions.
- Suggested wall mounting height: ≤ 1.5 meters.

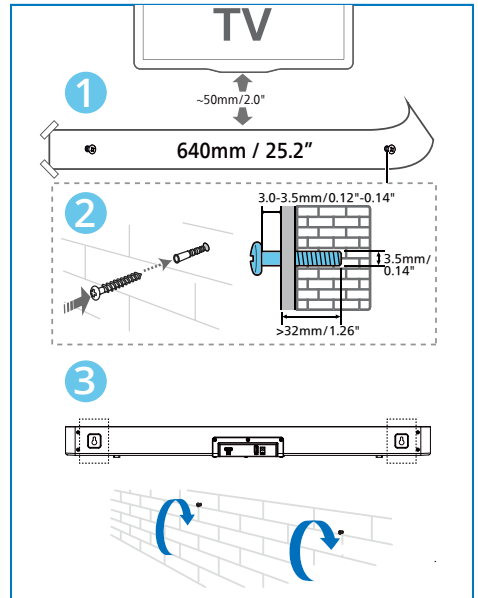

- 1 Drill 2 parallel holes (diameter 3-8mm each ) on the wall.
  - ↳ The distance between the holes are: **640mm**.
  - ↳ You can refer to the size for helping the drilling holes position on the wall.
- 2 Secure the dowels and screws in the holes.
  - ↳ Be sure to leave a **3.0-3.5mm** gap between the wall and the screw's head.
- 3 Hang the soundbar on the fastening screws.

## 3 Connect

This section helps you connect your soundbar to a TV and other devices, and then set it up.

For information about the basic connections of your soundbar and accessories, see the quick start guide.

### Note

- For identification and supply ratings, see the type plate at the back or bottom of the product.
- Before you make or change any connections, make sure that all devices are disconnected from the power outlet.

- 2 Using a High Speed HDMI cable, connect the **HDMI ARC** connector on your soundbar to the **HDMI ARC** connector on the TV.

### Note

- Your TV must support the HDMI-CEC and ARC function. HDMI-CEC and ARC must be set to On.
- The setting method of HDMI-CEC and ARC may differ depending on the TV. For details about ARC function, please refer to your TV user manual.
- Make sure to use the HDMI cables that can support the ARC function.

## Connect to HDMI ARC

Your soundbar supports HDMI with audio return channel (ARC). If your TV is HDMI ARC compliant, you can hear the TV audio through your soundbar by using a single HDMI cable.

- 1 On your TV, turn on HDMI-CEC operations. For details, see the TV user manual

The **HDMI ARC** connector on the TV might be labeled differently. For details, see the TV user manual.

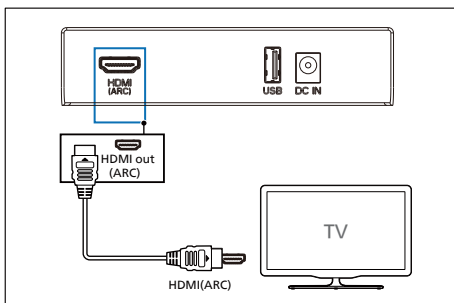

## Connect to power

- Before connecting the AC power cord, ensure you have completed all other connections.
  - Risk of product damage! Ensure that the power supply voltage corresponds to the voltage printed on the back or the underside of the unit.
- 1 Connect the mains cable to the **DC~** socket of the unit and then into a mains socket.

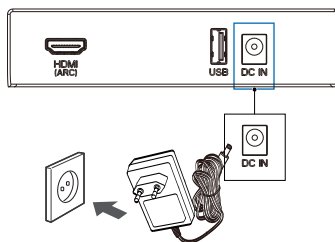

\* Adapter and plug type vary by regions.

# 4 Use your soundbar

This section helps you use the soundbar to play audio from connected devices.

## Before you start

- Make the necessary connections described in the quick start guide and the user manual.
- Switch the soundbar to the correct source for other devices.

## Turn ON and OFF

- When you first connect the unit to the main socket, the unit will be in STANDBY mode. The [Standby] indicator will light up.
- Press the  button on the remote control or on the main unit to switch the main unit ON or OFF.
- Disconnect the main plug from the main socket if you want to switch the unit off completely.

## Auto standby

The unit automatically turns to standby mode after about 15 minutes if the TV or the external unit is disconnected or switched off.

- To switch the unit off completely, remove the mains plug from the mains socket.
- Please turn the unit off completely to save energy when not in use.

## Select source

- 1 Press the  button repeatedly on the unit or press the **USB,HDMI ARC, Pair/BT**, buttons on the remote control to select the desired mode.

The indicator light on the soundbar will show which mode is currently in use.

Status	LED state
<b>USB</b>	[USB] Solid white
<b>Standby</b>	[Standby] Solid red
<b>Pair/BT</b> <ul style="list-style-type: none"><li>• Connected</li><li>• disconnected</li></ul>	[BT] Solid white [BT] Blinking white
<b>HDMI ARC</b> <ul style="list-style-type: none"><li>• Supported</li><li>• Unsupported</li></ul>	[HDMI ARC] Solid white [HDMI ARC] Blinking white

## Select equalizer (EQ) effect

Select predefined sound modes to suit you video or music.

- 1 Press the **EQ** button on the remote control to select your desired preset equalizer effects. Default mode is Movie
- **Movie** (4 LEDs ON ): Create a surround listening experience. Ideal for watching movies.
  - **Music** (3 LEDs ON ): Create two-channel or multichannel stereo sound. Ideal for listening to music.
  - **Voice** (3 LEDs ON): Create sound effect which makes human voice more clear and outstanding for listening.

- **Stadium (2 LEDs ON):** Create an atmosphere as if watching a sports game in a stadium.

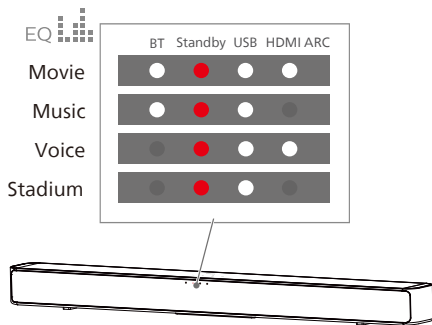

## Adjust the volume

When adjusting the volume of the soundbar, the status indicator will increase / decrease the amount of light. According to the corresponding light display / blinking, determine the current volume level of the soundbar .

### Adjust the volume

- 1 Press **+/-** on the soundbar or press **Vol+ / Vol-** on the remote control to increase / decrease the volume level.

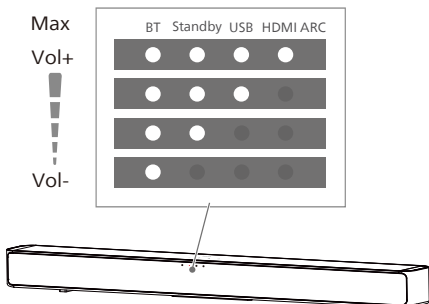

### Adjust the treble and bass volume

- 2 Press **-Bass +**  
Press **-Bass +** on the remote control to increase/decrease Bass's volume.

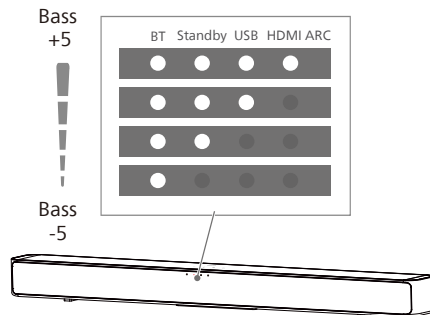

- 3 Press **-Treble +**  
Press **-Treble +** on the remote control to increase/decrease Treble's volume.

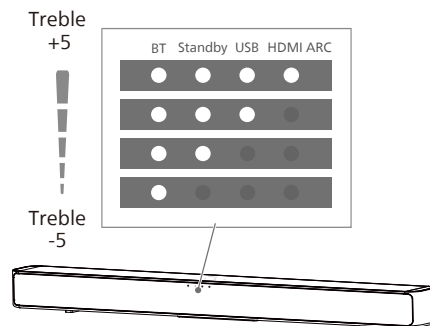

By default, the Bass/Treble is set to 0.

---

## Factory reset

Reset device to default setting.

- 1 Turn on the soundbar.
- 2 Press and hold local keys + and - for 8 secs. After all LEDs light up for 5 seconds, the [Standby] LED is in solid red.
- 3 The soundbar enters into ARC status after the reboot.

---

## Bluetooth operation

Through Bluetooth, connect the soundbar with your Bluetooth device (such as an iPad, iPhone, iPod touch, Android phone, or laptop), and then you can listen to the audio files stored on the device through your soundbar.

### What you need

- A Bluetooth device which supports Bluetooth profile A2DP, AVRCP and is with Bluetooth version 5.0 + EDR.
- The maximum operational range between the soundbar and a Bluetooth device is approximately 10 meters (30 feet).

- 1 Press the  button on the unit or press **Pair/BT** button on the remote control to switch the soundbar to Bluetooth mode.  
→ The [BT] indicator will blink.
- 2 On the Bluetooth device, switch on Bluetooth, search for and select **Philips TAB4000** to start connection (see the user manual of the Bluetooth device on how to enable Bluetooth).  
→ During connection, the [BT] indicator will blink.
- 3 Wait until you hear the voice prompt from the soundbar.  
→ If successfully connected, the [BT] indicator will light up solidly.
- 4 Select and play audio files or music on your Bluetooth device.

- During play, if a call comes in, music play pauses. Play resumes when the call ends.
- If your Bluetooth device supports AVRCP profile, on the remote control you can press **⏮ / ⏭** to skip to a track, or press **⏸** to pause/resume play.

## 5 To disconnect Bluetooth connection and pair a new Bluetooth device:

- Long press the **Pair/BT** button on the remote control to disconnect Bluetooth connection and enter pairing mode.

## USB operation

Enjoy audio on a USB storage device, such as an MP3 player and USB flash memory, etc.

### 1 Insert the USB device.

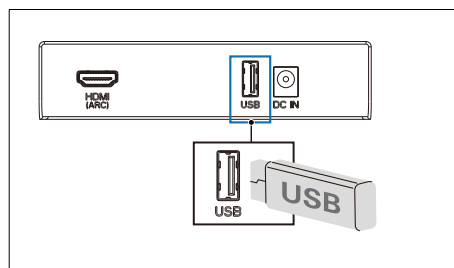

### 2 Press the **⏮** button repeatedly on the unit or press the **USB** button on the remote control to select **USB** mode.

↳ [USB] LED indicator solid white.

### 3 During playback:

Button	Action
<b>⏮</b>	Start, pause or resume play
<b>⏮</b>	Skip to the previous track
<b>⏭</b>	Skip to the next track

## Tips

- This product may not be compatible with certain types of USB storage devices.
- If you use a USB extension cable, USB hub, or USB Multifunctional card reader, the USB storage device may not be recognized.
- Do not remove the USB storage device during file reading.
- This product can support USB devices with up to 128 GB of memory.
- This product can play MP3, WAV, FLAC.
- Support a USB port: 5V ---500mA.
- In USB mode, the unit will automatically go to standby mode after about 15 minutes, if it has no audio playback.

## Note

- In an open space without obstructions, the maximum operational range between the soundbar and a Bluetooth device is approximately 10 meters (30 feet).
- Compatibility with all Bluetooth devices is not guaranteed.
- The music streaming may be interrupted by obstacles between the device and soundbar, such as wall, metallic casing that covers the device, or other devices nearby that operate in the same frequency.
- In Bluetooth mode, the unit will automatically go to standby mode after about 15 minutes, if it has no audio playback.
- How to deactivate wireless network port: Press the source button switch to other modes.

# HDMI ARC operation

Ensure that the unit is connected to the TV or audio device.

- 1 Press the  button repeatedly on the unit or press **HDMI ARC** buttons on the remote to select the desired mode.
  - ↳ The indicator light on the soundbar will show which mode is currently in use.

Status	LED State
HDMI ARC	[HDMI ARC] Solid white or blinking

- 2 Operate your audio device directly for playback features.
- 3 Press the +/- (volume) buttons to adjust the volume to your desired level.

## Tip

- While in **HDMI ARC** mode, if there's no sound output from the unit and the status indicator flashes, you may need to activate PCM signal output on your source device (e.g.TV, DVD or Blu-ray player).
- Networked standby mode power consumption < 2.0 W
- In HDMI (ARC) mode will enter network standby mode after about 15 minutes, if it has no audio playback.

# 5 Product specifications

## Note

- Specifications and design are subject to change without notice.

## Bluetooth

Bluetooth profiles	A2DP, AVRCP
Bluetooth version	V 5.4
Bluetooth frequency band	2402-2480 MHz
Transmitter power	≤ 4dBm

## Amplifier section

Output power	15W × 2 @THD+N≤10%;
--------------	------------------------

## Soundbar

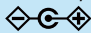
Adapter	Input:	100-240V~ 50/60Hz, 0.8A
	Output:	15.0V $\approx$ 1.6A, 24W 
Power consumption		15 W
Standby consumption		< 0.5 W
Networked consumption		< 2.0 W
USB	5V $\approx$ 500mA	
Frequency response	50Hz - 18KHz	
Impedance	4Ω	
Dimension (W x H x D)	760x64x87 mm	
Weight	1.45kg	
Operating temperature	0°C - 40°C	

---

## Remote control

---

Distance/Angle	6m/30°
Battery type	AAA (1.5V X 2)

---

---

## Supported Audio formats

---

HDMI ARC

- PCM 2ch

BLUETOOTH

- SBC

USB

- MP3, WAV, FLAC
- 

# 6 Troubleshooting



### Warning

- Risk of electric shock. Never remove the casing of the product.

To keep the warranty valid, never try to repair the product yourself.

If you have problems using this product, check the following points before you request service. If you still have a problem, get support at [www.philips.com/support](http://www.philips.com/support).

---

### Main unit

**The buttons on the main unit do not work.**

- Disconnect from the power supply for a few minutes, and then connect again.

### No power

- Ensure that the AC cord is properly connected.
- Ensure that there is power at the AC outlet.
- Press  button on the remote control or soundbar to turn the soundbar on.

---

### Sound

**No sound from the soundbar speaker.**

- Connect the audio cable from your soundbar to your TV or other devices. However, you do not need a separate audio connection when:
  - the soundbar and TV are connected through HDMI ARC connection, or
  - a device is connected to the HDMI in connector on your soundbar.
- On the remote control, select the correct audio input.
- Make sure that the soundbar is not muted.



- Reset this product to its factory settings (see "Factory reset")

#### **Distorted sound or echo.**

- If you play audio from TV through this product, make sure that the TV is muted.

---

### **Bluetooth**

#### **A device cannot connect with the soundbar.**

- The device does not support the compatible profiles required for the soundbar.
- You have not enabled the Bluetooth function of the device. See the user manual of the device on how to enable the function.
- The device is not correctly connected. Connect the device correctly.
- The soundbar is already connected with another Bluetooth device. Disconnect the connected device, and then try again.

#### **Quality of audio play from a connected Bluetooth device is poor.**

- The Bluetooth reception is poor. Move the device closer to the soundbar, or remove any obstacle between the device and the soundbar.

#### **I can't find the Bluetooth name of this unit on my Bluetooth device.**

- Ensure the Bluetooth function is activated on your Bluetooth device.
- Re-pair the unit with your Bluetooth device.

---

#### **Remote control does not work.**

- Before you press any playback control button, first select the correct source.
- Reduce the distance between the remote control and the unit.
- Insert the battery with its polarities (+/-) aligned as indicated.
- Replace the battery.
- Aim the remote control directly at the sensor on the front of the unit.

---

#### **The soundbar turns off.**

- When the unit's external input signal level is too low, the unit will turn off automatically in 15 minutes. Please increase the volume level of your external device.

## 7 Trademarks



The terms HDMI, HDMI High-Definition Multimedia Interface, HDMI Trade dress and the HDMI Logos are trademarks or registered trademarks of HDMI Licensing Administrator, Inc.



The Bluetooth® word mark and logos are registered trademarks owned by Bluetooth SIG, Inc. and any use of such marks by MMD Hong Kong Holding Limited is under license. Other trademarks and trade names are those of their respective owners.



Specifications are subject to change without notice. Please visit [www.Philips.com/support](http://www.Philips.com/support) for the latest updates and documents.

Philips and the Philips Shield Emblem are registered trademarks of Koninklijke Philips N.V. and are used under license.

This product has been manufactured by and is sold under the responsibility of MMD Hong Kong Holding Limited, or one of its affiliates, and MMD Hong Kong Holding Limited, is the warrantor in relation to this product.