

PHILIPS

LED Inspection lamp

Penlight Premium color+



EN	LED Inspection lamp
DE	LED-Inspektionslampe
FR	Lampe baladeuse à LED
NL	LED-inspectielamp
ES	Lámpara de inspección LED
IT	Lampada di ispezione a LED
PT	Lâmpada de inspeção LED
RU	Светодиодный инспекционный фонарь
PL	Lampa inspekcyjna LED
SV	Inspektionslampe med LED
NO	LED-inspeksjonslampe
DA	LED inspektionslampe
SU	LED-tarkastuslamppu
AR	المصباح أو مصباح LED



User manual

Before you start

Thank you for buying the Philips LED Inspection lamp. Its high-quality LED lighting offers a powerful wide-angle light output that will let you work in your workshop, garage or any other professional environment under the best lighting conditions.



The Philips LED Inspection lamp bears the official Philips Automotive Grade Quality seal. Philips Automotive Grade Quality products are designed and developed following strict quality-control processes (including applicable ISO norms), leading to consistently high production standards.

Important

Please read this user guide carefully before using your LED inspection lamp. This guide contains important health and safety information.

If you need further assistance, please dial the Philips consumer care **toll-free number** in your region

www.philips.com/support

Or visit your local Philips Dealer

For more information visit
<http://www.philips.com/led-work-lights>

1

1x



User manual

2

User manual

3



i

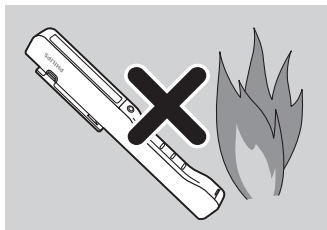
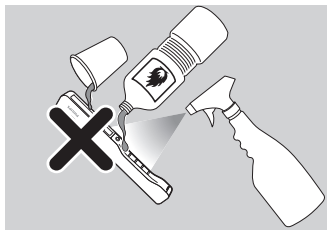
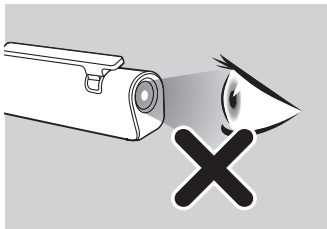
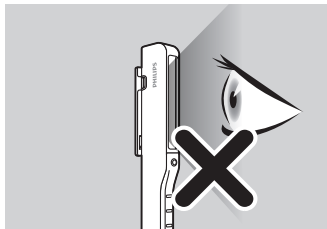

CE

UK
CA

4



USB

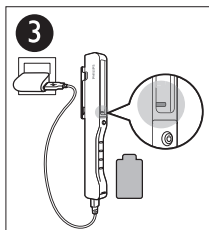
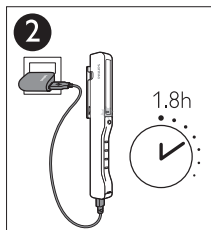
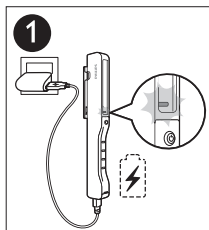
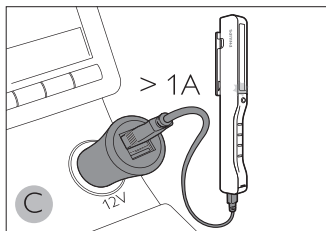
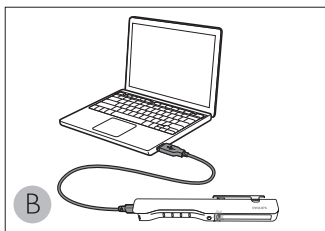
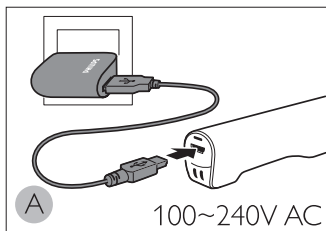

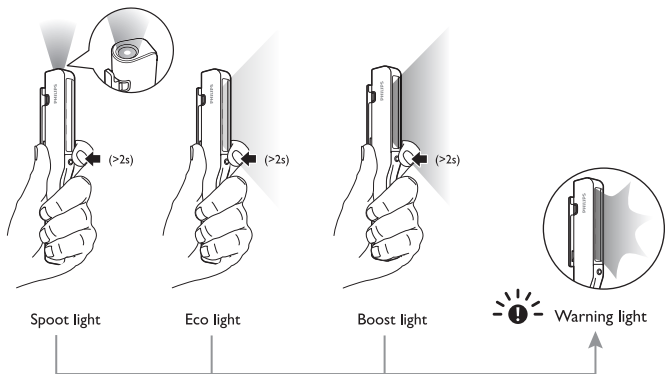
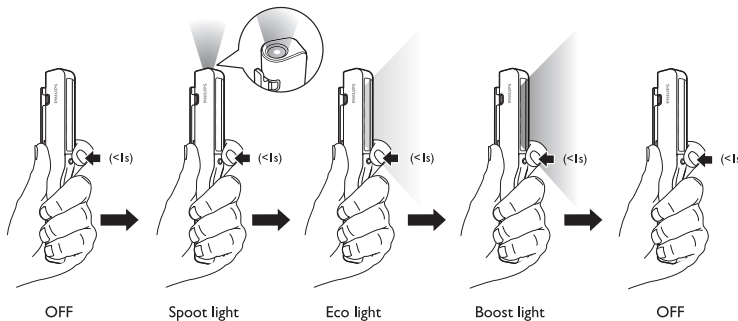



Description



Operating line voltage 100~240V / Output 5V 1A



Charging time 1.8 hours



Battery 3.2V, 1200mAh



Battery performance Boost:2h, Eco :4h, spot light: 3h



Light output (flux) spot light: 180lm, Eco/Boost: 120/200lm



Impact protection rating IK07



Ingress protection rating IP54



Operating temperature -10°C to 50°C



Adaptor operating temperature 0°C to 40°C



Storage temperature -20°C to 60°C



Lamp dimensions 183 x 21 mm



Product weight 107g



Magnet Yes



Connection Type C USB cable

Discover our LED Professional work lights range



PEN20S



Penlight
Professional



Penlight
premium color+



RCH10S



RCH5S



HL22M



RCH21S



RCH2S



RCH31UV



PJH10



CBL10



CBH52



MDLS CRI



Ultinon Motion is the warrantor of this product.
Philips and the Philips Shield Emblem are registered trademarks of
Koninklijke Philips N.V. and are used under license.
2021-2025© Ultinon Motion Holding B.V. All rights reserved.