

# PHILIPS

## WelcomeEye Lite 2

Video Doorphone



# User Manual

Register your product on [www.philips.com/register](http://www.philips.com/register)



Fig. 1

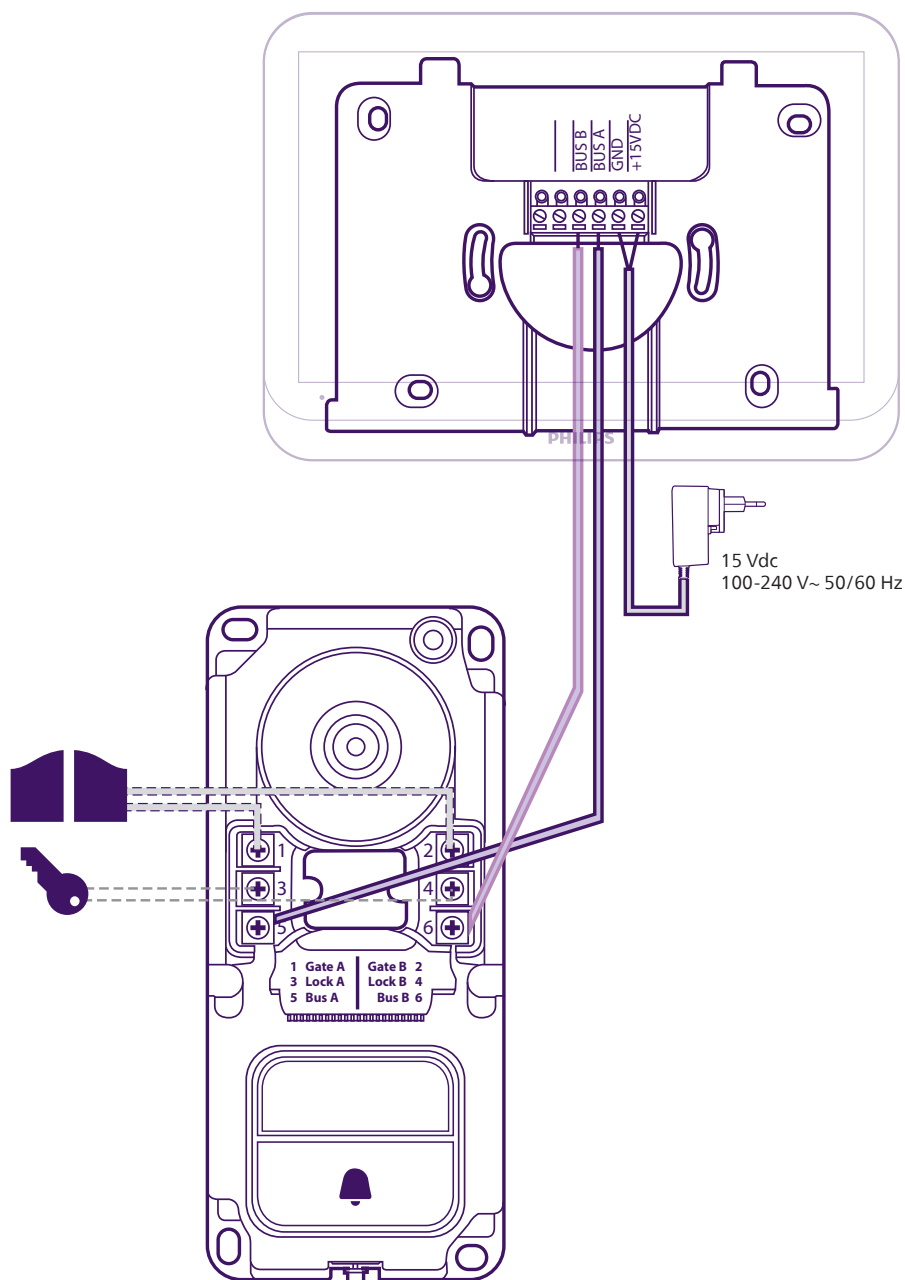



# Contents

- 1 SAFETY INSTRUCTIONS..... p.2
- 2 KIT CONTENTS..... p.2
- 3 OVERVIEW ..... p.3
- 4 DETAILED DESCRIPTION ..... p.3
- 5 PRODUCT INSTALLATION ..... p.6
  - 5.1. Wiring
  - 5.2. Installing the monitor
  - 5.3. Installing the intercom panel
- 6 MONITOR INTERFACE..... p.11
- 7 TECHNICAL SPECIFICATIONS..... p.14
- 8 FAQ..... p.15
- 9 TECHNICAL SUPPORT - WARRANTY ..... p.17
- 10 SAFETY MEASURES..... p.18
- 11 FCC/CE WARNING..... p.19
- 12 DECLARATION OF CONFORMITY ..... p.19

# 1. SAFETY INSTRUCTIONS

**⚠ Important!**

- Please carefully read the user manual before installing or using this product.
- If you are installing this product for someone else, remember to leave the manual or a copy of it with the end user.

**Warning:**

- The various items should be dismantled by an authorised technician only.

**Safety measures:**

- To operate this system in complete safety, it is essential that installers, users and technicians follow all the safety procedures described in this manual.
- Specific warnings and warning symbols are given for items where necessary.

# 2. KIT CONTENTS



1. 7" monitor

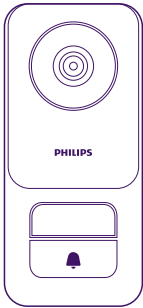

2. Intercom panel

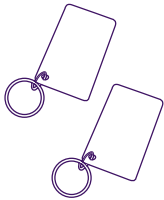

3. RFID badges x2

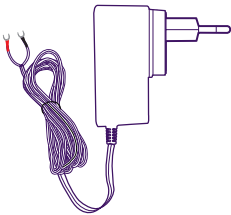

4. Plug-in power supply



5. Intercom panel unlocking tool

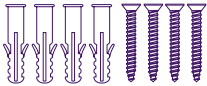

6. Screws and wall plugs for the monitor

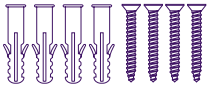

7. Screws and wall plugs for the intercom panel

### 3. OVERVIEW

The **Philips WelcomeEye Lite 2** videophone consists of an indoor touchscreen monitor and an outdoor unit with one call button and a microphone, loudspeaker and camera for viewing and communicating with the visitor who rings. The intercom panel also features a control output for controlling the opening of a gate motor drive and another powered output for controlling the opening of a side gate.

For effective use, please carefully read this instruction manual.

### 4. DETAILED DESCRIPTION

Monitor:

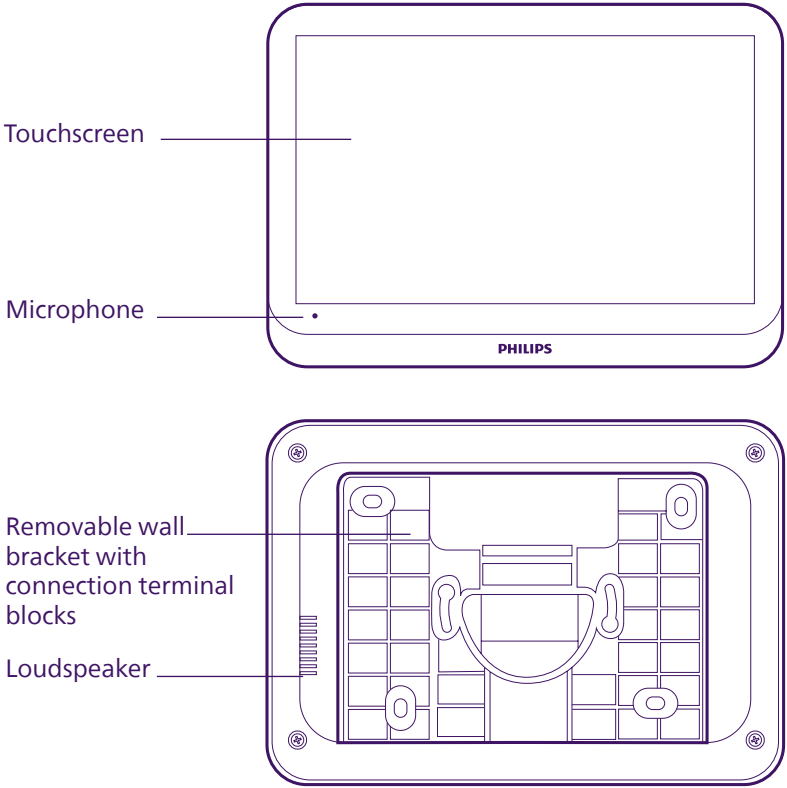

Location of wall  
bracket retaining  
lugs

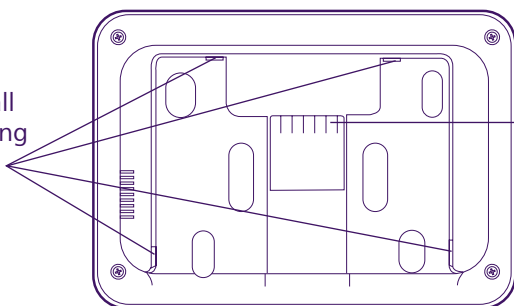

Wall bracket  
connection pins

Bus A and Bus B: Connections  
to the intercom panel

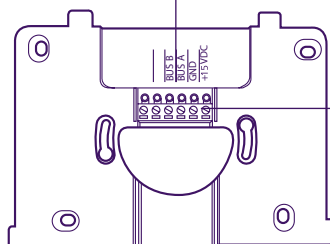

GND and +15Vdc:  
Connections for  
the mains power  
supply supplied

#### Intercom panel:

Protective  
shield

Lens

Loudspeaker

Screw for locking  
the front pane  
to the intercom  
panel

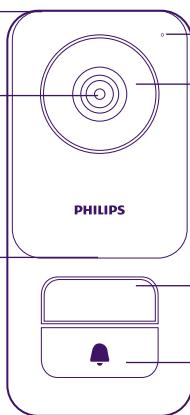

Microphone

Brightness  
sensor

Name holder

RFID scan area

Call button



**Important:**

The locking screw must not be removed. To remove the front of the intercom panel, unscrew the screw using the tool provided. The screw will go in instead of out when you unscrew it: this is normal. Do not force the screw once it has been retracted: risk of damage.

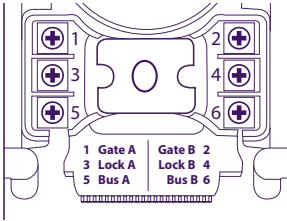
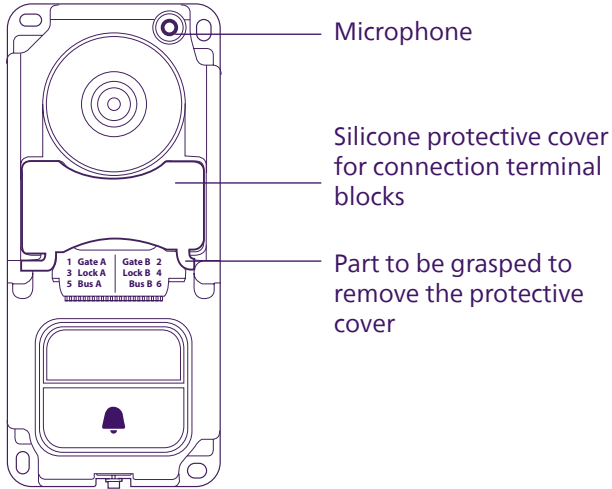

**Gate A and Gate B:** Connection to gate motor drive control contact (optional, not supplied)

**Lock A and Lock B:** Connection to an electric lock or strike plate (optional, not supplied)

**Bus A and Bus B:** Connection to the monitor

**Notes:**

- When the call button or name holder is pressed, the monitor rings and the image is displayed.
- To change the label in the name holder, remove the front of the intercom panel and unclip from the top or bottom by gently prying with a flat-head screwdriver.

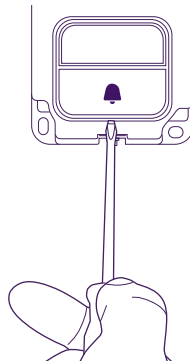

## 5. PRODUCT INSTALLATION

### Important notes and advice:

- If you test your product before installing it, make sure you do not test it with the intercom panel and the monitor nearby or the videophone may emit a shrill noise (feedback).
- Do not expose the camera lens to direct sunlight or a reflective surface.
- Do not expose the intercom panel to a light source at night, as this may inhibit the activation of the backlighting on the call button and name holder.
- We recommend running the cables through a protective sheath to protect them against breakage and bad weather.
- Remember to remove the protective film from the intercom panel lens. This film can be damaged by sunlight and alter the quality of the video.

### 5.1. Wiring

In order to avoid the risk of interference and malfunction, do not pass the wire for your video doorphone through the same sheath as the electrical wires.

 **Warning:** Do not under any circumstances double wires to increase the wire size.

#### a. Connecting the videophone (monitor and intercom panel)

Wires to be used: **2 x 0.75 mm<sup>2</sup> wires up to 60 m long** or **2 x 1.5 mm<sup>2</sup> wires up to 120 m long**. Telephone cables of up to 30 m can be used. The wires must be in one piece. There must be no terminal strips or similar connections to avoid altering the signal.

- Be sure to connect the wires in accordance with the wiring diagram.
- Be sure to refer to the labelling on the back of the monitor and the back of the intercom panel.

#### b. Connecting a gate motor drive

 **Please note:** the type of command (complete opening, partial opening for a pedestrian) that the motor drive will perform on request from the monitor cannot be selected from the monitor. The function triggered by the motor drive depends on the input on the motor drive electronic card to which the cables are routed.

- The gate output does not provide feedback as to whether the motor drive has taken the command into account or whether it has executed the command correctly.
- The intercom provides a dry contact (without power) to be connected to the push button control of the automatic opener.
- Connect the motor drive control directly to the Gate A and Gate B terminals on the intercom panel (no polarity required).

#### c. Connecting an electric strike plate or lock

 **Warning:** The output of the intercom panel is designed to control a fail-secure electric strike plate or lock.

Important: the current of the electric strike plate or lock you are controlling must not exceed 1.1 A.

- Connect the electric lock or strike plate directly to the Lock A and Lock B terminals.

#### **d. RFID badges**

RFID badges can be associated with the intercom panel using the monitor. Please refer to the corresponding section in the manual. RFID badges can also be removed from the monitor if lost. Once linked via the mobile application, RFID badges can be used to open the electric strike plate or gate motor drive connected to the intercom panel.

To open your electric strike plate with an associated badge, quickly swipe your badge over the RFID read zone on the intercom panel, at the bottom right-hand edge of the intercom panel. One short beep confirms the opening of the electric strike plate.

To open your gate motor drive with an associated badge, hold your badge in front of the RFID reader for at least 3 seconds. Two short beeps indicate that the gate is opening.

## 5.2. Installing the monitor

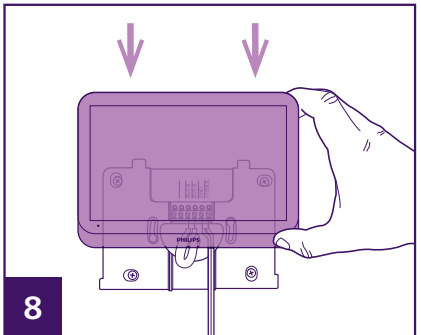
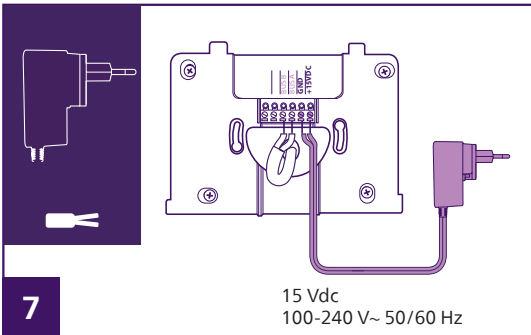
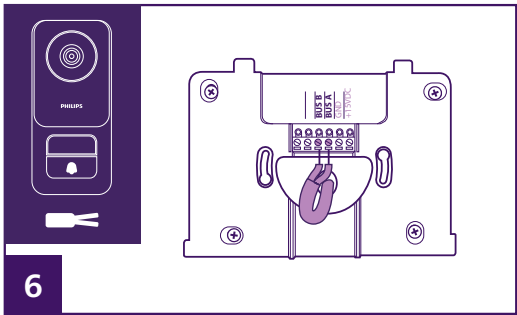
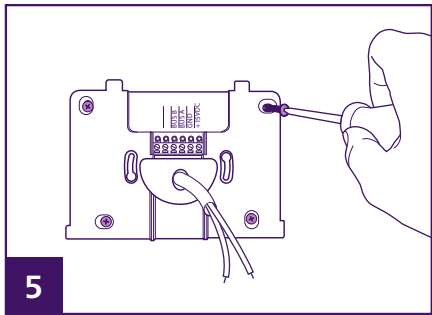
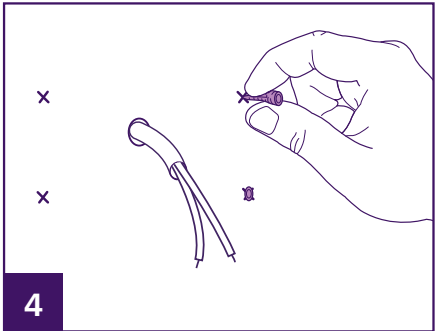
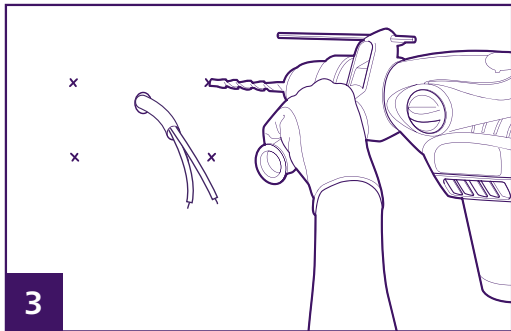
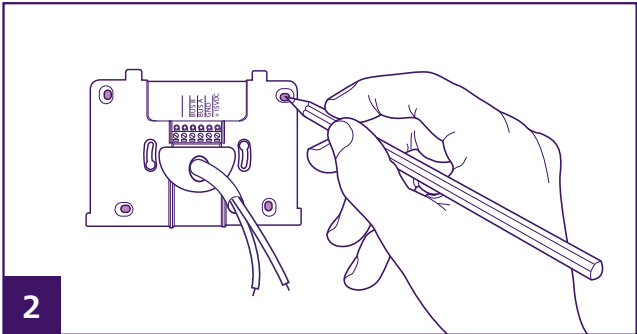
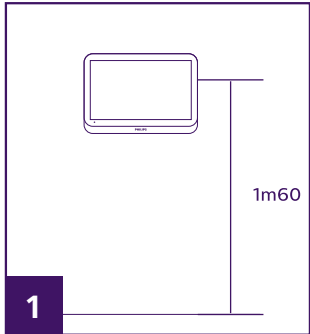

- 1- Position the wall bracket so that the screen of the monitor is approximately 1.60 m above the floor.
- 2- Mark the location of the holes by placing the bracket on the wall.  
**Note:** if you prefer, you can use the 2 holes in the centre of the bracket, which are designed to match a 68 mm wall recess-mount housing.
- 3- Drill.
- 4- Use pegs adapted to the type of bracket (those supplied are suitable for solid walls).
- 5- Attach the wall bracket.
- 6- Connect the two intercom panel wires and the two power supply wires following the wiring diagram.
- 7- Position the monitor on the wall bracket.

 **Warning:** during this step, do not connect the power supply to the 230 VAC.

### 5.3. Installing the intercom panel

 **Warning:**

- The product must not be connected to the power supply before wiring has been completed.
- The locking screw must not be removed. To remove the front of the intercom panel, unscrew the screw using the tool provided. The screw will go in instead of out when you unscrew it: this is normal.

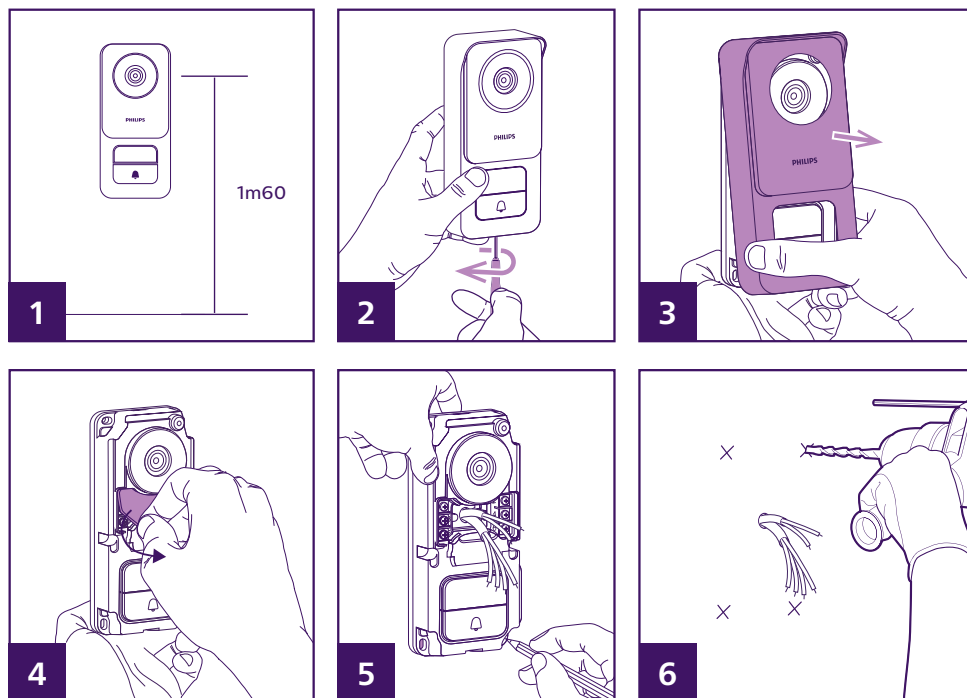

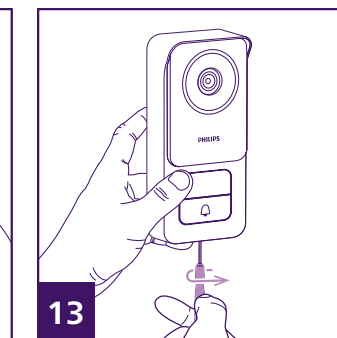
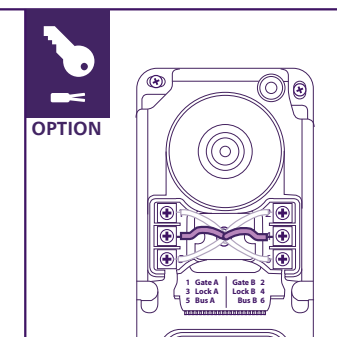
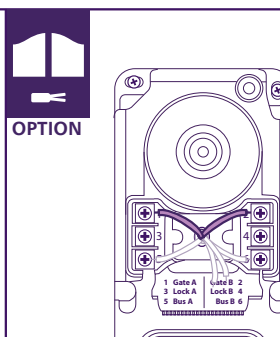
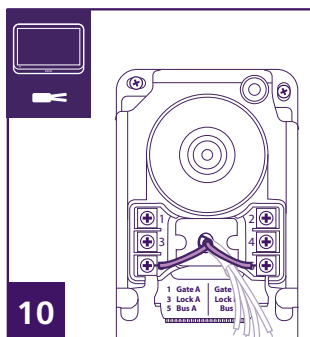
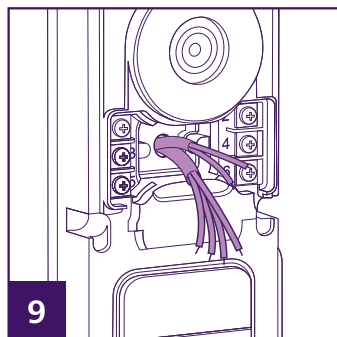
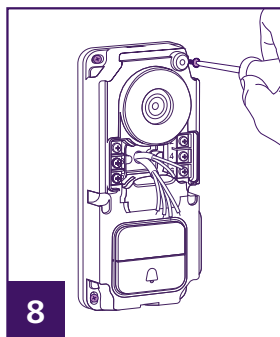
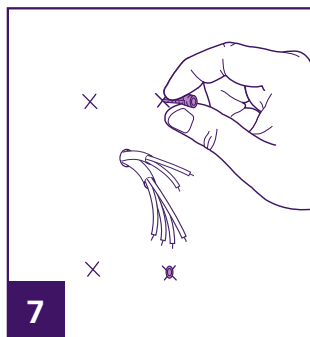

- 1- The lens of the panel must be placed at a height of around 1.60 m.
- 2- Remove the tamper-resistant screw from underneath the intercom panel, using the tool provided. When unscrewed, the screw retracts into the intercom panel and releases the front panel. Do not force the screw, as this could damage the screw head.
- 3- Tilt the front of the panel to remove it.
- 4- Remove the protective silicone cover.
- 5- Mark the position of the 4 holes on the wall.
- 6- Drill.
- 7- Use pegs adapted to the type of bracket (the screws provided are suitable for solid walls)
- 8- Secure the panel with appropriate screws.
- 9- The connection cables must run through the central hole in the intercom panel and exit through the front.

10 - Connect the two wires from the monitor and, if necessary, connect the electric strike plate and the gate (see section 1. Wiring).

11- Reposition the silicone cover on the connection terminal blocks.

12- Put the front of the intercom panel back on. Make sure you put the top of the front panel on first so that it hooks onto the top lug of the intercom panel.

13- Tighten the tamper-resistant screw underneath the intercom panel, using the tool provided. When screwed in, the screw comes out and locks the front panel. Do not force the screw, as this could damage the screw head.

14- You can now power on the system monitor. When the power is switched on, the Philips logo appears on the monitor.

15- Press the intercom panel call button to initiate a call and complete the configuration of your installation.

## 6. MONITOR INTERFACE

### Main menu

Lightly touch the screen to turn it on and access the home screen.  
Then click on the screen to display the main menu.

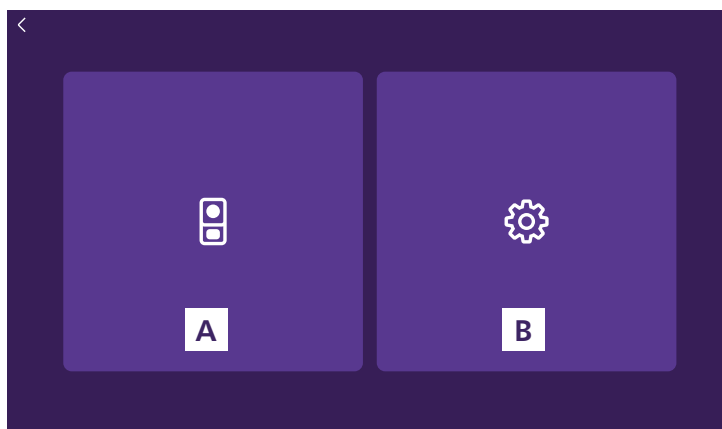

### A. Monitoring function



 1: Used to open the electric strike plate of the intercom panel.

 2: Used to open the gate of the intercom panel.

 3: Activates the microphones on the intercom panel and the monitor to allow you to talk or call out to your visitor.

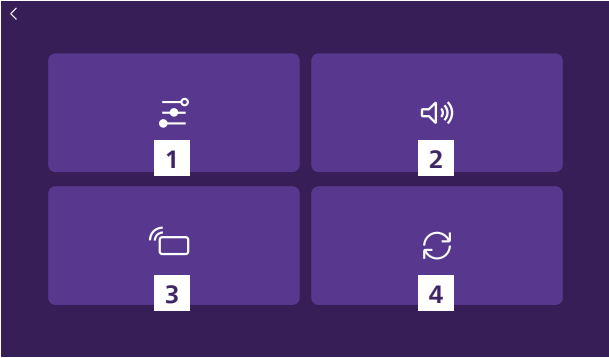

1

Image adjustments

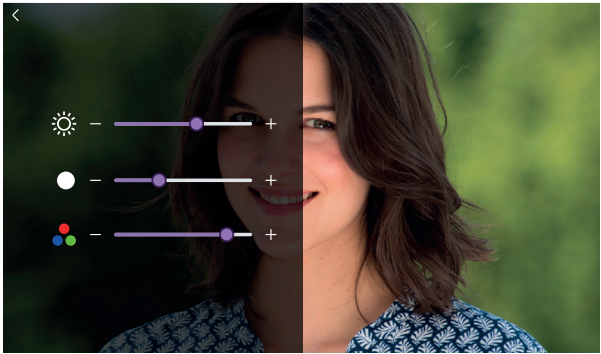

Here you can change the brightness, contrast and colour of the image. In this menu, the image of the intercom panel is displayed so that you can immediately see the effect of the settings on screen.

2

Volume

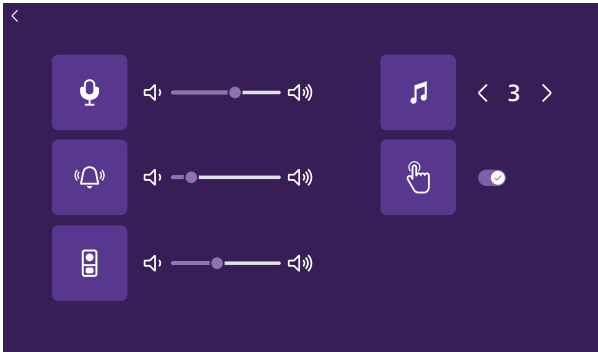





: sound volume on the monitor during discussion with visitors



: Volume of chimes emitted by the monitor



: Sound volume on the intercom panel during discussion with visitors



: Chime assigned to intercom panel



: Allows you to activate or deactivate the sound emitted by the monitor when you click on the screen

### 3 RFID badges

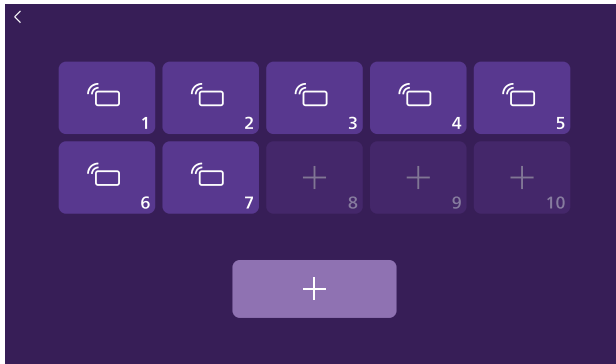

Here you can combine the two badges supplied, remove them or add extra badges up to a limit of 10 per installation.



: Click on this button to add a new badge. Then hold the badge you wish to add in front of the reader at the right-hand edge of the intercom panel.

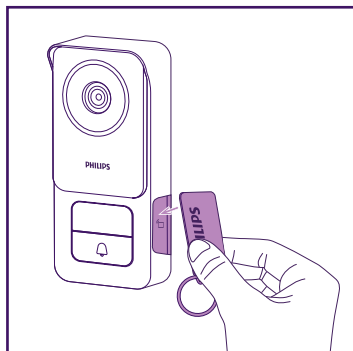

1: Each associated badge appears in one of the boxes on screen. Click on one of them to remove a badge if necessary and render it inoperative. Once the badge has been programmed, press + again to exit the programming menu.

## 4 **Reset**

Here you can reset your monitor. This deletes all personalised settings and all badges stored in the monitor.

## 7. TECHNICAL SPECIFICATIONS

### Monitor:

- 2 wires
- 7" touchscreen
- Resolution: 1024 x 600
- Radio power emitted: 20 dBm maximum
- Power supply: 100-240Vac / 15Vdc 1.5A mains adapter supplied
- Current consumption: 500 mA max
- Power consumption: 6 W max (0.5 W max on standby)
- 6 melodies (85dB)
- Dimensions: 132 (h.) x 190 (w.) x 18 (d.) mm anchor plate included
- Weight: 330g

### Intercom panel:

- C-MOS colour sensor 2MP
- Viewing angle 128° diagonal, 110° horizontal
- Infrared night vision, 2 m range
- Strike plate control 12V 1.1A, compatible with fail-secure strike plates with mechanical memory, control time 1 s
- Gate control: breaking capacity 12 V 2 A
- RFID 13.56 MHz
- IP55 IK08
- Operating temperature -20°C to +50°C
- Dimensions: 152 (H) x 70 (W) x 37 (D) mm
- Weight: 270 g

## 8. FAQ

Failure	Cause	Solution
The monitor will not turn on.	The monitor is not receiving power.	Verify that the power supply is properly connected and turned on. Check the polarity on the monitor or at the power supply output.
	Poor connection or short circuit on the line	Solve the connection problem.
Does not work when installed for the first time.	Connection error	The device is equipped with major protections. Disconnect the power supply for at least 1 mn, correct the installation error and reconnect. Please note that the protections will not be able to help if the product is directly connected to 230 VAC and that this error is not covered by the warranty.
Poor picture and/or sound Delay between the sound coming from the intercom panel and the monitor sound	Environment	Check that the wires used have the right gauge and that the connection wires for the videophone are not in the same sheath as the 230 VAC wires.
Distorted colour	Connection	Check that the connection cable is not wrapped around itself.
Image too bright	Camera position	Do not expose the camera lens to direct sunlight or a reflective surface.
	Image adjustments	Check the settings of the monitor.
The volume at the intercom panel is too low	Sound adjustment	Check that the volume at the intercom panel is correctly set in the monitor sound settings.
	The microphone hole on the intercom panel is blocked.	Check and clean.
The strike plate and gate motor drive are controlled via the monitor, but not with the badges.	Programming error	Reset and resume the badge programming procedure. Remember: short badge swipe in front of the reader = electric strike plate opens; long badge swipe in front of the reader = gate opens.

<b>Electric strike plate or lock does not work</b>	Unsuitable strike plate or lock	The electric strike plate or lock to be controlled must preferably be equipped with a mechanical memory. The strike plate current cannot exceed 1.1A. The strike plate or lock to be controlled must be fail-secure, not fail-safe: it must open when the power is on and close when the power is off.
<b>How to add an intercom panel / a monitor</b>		It is not possible to add a monitor or intercom panel to this model.

# 9. TECHNICAL SUPPORT - WARRANTY

This product is guaranteed for parts and labour in our workshops.  
The warranty does not cover: consumables (batteries, etc.) and damage caused by misuse, improper use, improper installation, external intervention, damage due to physical or electrical shocks, dropping or atmospheric phenomena.

- Do not open the device, as this will void the warranty.
- If returning the product for after-sales service, protect the screen to prevent scratches.
- Clean with a soft cloth only, no solvents. The warranty is void if parts have been dismantled. Before cleaning, disconnect the equipment or switch it off at the mains.

 **Warning:** Do not use any carboxylic acid, alcohol, or similar chemicals on the product. In addition to damaging your device, the fumes are also hazardous to your health and are explosive. Do not use any tool that can conduct voltage (wire brush, sharp tools, etc.) for cleaning.

The receipt or invoice is proof of purchase date.

Contacts and opening hours of our technical support centres are available if necessary on the website [www.philips.com](http://www.philips.com)

CARTE DE GARANTIE

M/Mme : \_\_\_\_\_

Numéro de téléphone : \_\_\_\_\_

Adresse : \_\_\_\_\_  
\_\_\_\_\_

E-mail : \_\_\_\_\_

Date d'achat : \_\_\_\_/\_\_\_\_/\_\_\_\_(JJ/MM/AAAA)

Revendeur : \_\_\_\_\_

Téléphone du revendeur : \_\_\_\_\_

Adresse du revendeur : \_\_\_\_\_

Numéro de série 

PHI/1031/

**Important :** veuillez conserver précieusement cette carte de garantie, ainsi que votre preuve d'achat.

Philips and the Philips shield emblem are registered trademarks of Koninklijke Philips N.V. and are used under licence. This product was manufactured and is sold by Avidsen SAS, the sole guarantor of the product.

## 10. SAFETY PRECAUTIONS

Damage caused by failing to adhere to the manual nullifies the warranty. We will not accept liability for damage resulting from non-compliance!

We will not accept liability for any harm to goods or people caused by improper handling or failure to adhere to safety instructions.

This product was manufactured in total compliance with safety guidelines. In order to maintain this status and provide for the best possible conditions of use, the user must adhere to the safety instructions and warnings in this manual.



This symbol indicates a risk of electrical shock or short-circuiting.

- Only use this product with electrical current in the following ranges: 100-240 Volts and 50-60 Hertz. Never attempt to use this device at a different voltage.
- Ensure that all the system's electrical connections conform to the instructions for use.
- In commercial establishments, ensure that you adhere to the electrical installation accident prevention regulations.
- In schools, training facilities, workshops, etc., qualified personnel must be on hand to monitor electronic equipment operation.
- You must follow the instructions for use of any other devices connected to the system.
- Please contact an experienced person if you have any doubts regarding equipment operation or safety.
- Never plug in or unplug electrical equipment with wet hands.
- When installing this product, check that the power supply cables are not at risk of being damaged.
- Never replace damaged electrical cables yourself! In this case, remove them and call an expert.
- The mains supply should be located close to the device and must be easily accessible.
- An easily accessible cut-off system (switch disconnecter, circuit breaker, equivalent system) must be integrated into the building's wiring system for equipment connected to the power grid.
- Keep a minimum distance around the device to guarantee sufficient ventilation.
- Ventilation should not be blocked by covering the ventilation opening with an object such as a newspaper, tablecloth or curtain, etc.
- No open flame source such as a burning candle must be placed on the device.
- Respect the product's operating temperature.
- The device must not be exposed to liquid flow or splashing. Do not place any objects filled with liquid, such as vases, on the device.

## 11. FCC/CE WARNING

**Note:** This equipment has been tested and found to be compliant with the limits of a Class B device, according to European standards in force. These limits are designed to provide reasonable

protection against interference in a residential installation. This equipment uses and may emit radio frequency energy and, if not fitted and used according to the instructions, may cause interference to radio communication.

There is no guarantee, however, that interference will not occur in a particular system. If this equipment causes interference to radio or TV reception, which can be established by starting and stopping it, users are encouraged to try to correct the interference using one of the following methods:

- Increase the distance between the equipment and the receptor.
- Connect the equipment to a socket belonging to a different circuit from the one to which the receptor is connected.

## 12. DECLARATION OF CONFORMITY

AVIDSEN, undersigned, states that radio equipment such as the **WelcomeEye Lite 2** is compliant with directive 2014/53/EU. The full text of the EU declaration of conformity is available on the following website: [www.avidsen.com](http://www.avidsen.com)

FR. La marque commerciale Philips est une marque déposée par Koninklijke Philips N.V.

EN. The Philips trademarks are registered trademarks of Koninklijke Philips N.V.

NL. De handelsmerken van Philips zijn gedeponeerde handelsmerken van Koninklijke Philips N.V.

DE. Die Philips Warenzeichen sind eingetragene Warenzeichen der Koninklijke Philips N.V.

ES. Las marcas registradas de Philips son marcas registradas de Koninklijke Philips N.V.

PT. As marcas registadas da Philips são marcas registadas da Koninklijke Philips N.V.

IT. I marchi Philips sono marchi registrati di proprietà di Koninklijke Philips N.V.

PL. Znaki handlowe Philips są zarejestrowanymi znakami handlowymi Koninklijke Philips N.V.



Philips and the Philips shield emblem are registered trademarks of Koninklijke Philips N.V. and are used under licence.

This product was manufactured and is sold by Avidsen SAS, the sole guarantor of the product.