

PHILIPS

32:9 SuperWide curved
monitor with USB-C

Curved Business
Monitor

5000 series

49 (48.8" / 124 cm diag.)

5120 x 1440 (Dual QHD)

49B2U5900AM



Redefining workflow productivity

Welcome to a more efficient workspace. To facilitate everyday workflow, this monitor's large 32:9 SuperWide screen is equipped with a new busy light and tilting webcam feature that helps you flow between tasks with ease.

Superb Picture Quality

- VA display delivers awesome images with wide viewing angles
- DisplayHDR 400 for more lifelike and outstanding visuals

Single cable USB-C connection

- RJ-45 to USB-C gives easy network connection with security
- USB 3.2 high-speed data transfer

Designed for the way you work

- Tilt, swivel and height-adjust for an ideal viewing position
- Secure sign-in with pop-up webcam
- Eyesafe-certified blue light protection and colour accuracy
- 32:9 SuperWide screen designed to replace multiscreen setups
- Curved display design for a more immersive experience
- Adjustable webcam: for comfortable video conferencing.
- Busylight: for setting your work status
- Earphone hook: for customisable storage

Curved Business Monitor

32:9 SuperWide curved monitor with USB-C

49B2U5900AM/00

Highlights

Curved display design

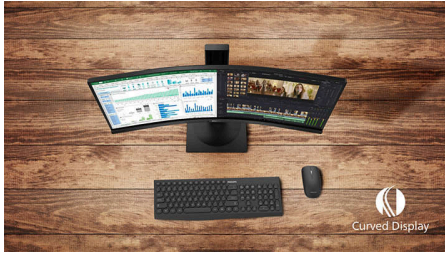

Desktop monitors offer a personal user experience, which suits a curved design very well. The curved screen provides a pleasant yet subtle immersion effect, which focuses on you at the centre of your desk.

32:9 SuperWide

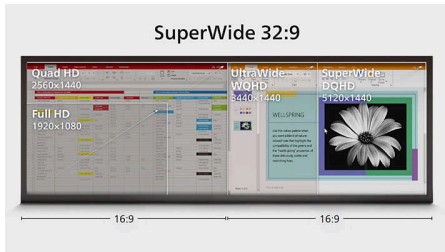

32:9 SuperWide 49" screen with 5120 x 1440 resolution is designed to replace multiscreen setups for a massive wide view. It's like having two 27" 16:9 Quad HD displays side by side. SuperWide monitors offer the screen area of dual monitors without the complicated setup.

DisplayHDR 400



VESA-certified DisplayHDR 400 delivers a significant step up from normal SDR displays. Unlike other 'HDR-compatible' screens, true

DisplayHDR 400 produces astonishing brightness, contrast and colours. With global dimming and minimum 400 nits of brightness, images come to life with notable highlights while featuring deeper, more nuanced blacks. It renders a fuller palette of rich new colours, delivering a visual experience that engages your senses.

USB-C Docking with RJ45



Simplify all peripherals from monitor to PC using one-cable docking USB Type-C connector, including networking, high-resolution video output from PC to monitor, and surfing on the Internet without an additional network cable, even without a LAN port on your notebook. RJ45 connection through USB-C offers a fast and secure connection when needed. Getting the fastest data speeds allows you to transfer data from a HDD to your PC faster than ever. Additionally, USB-C with power delivery can even enable you to power and charge your notebook from the monitor, eliminating the need for extra power cables.

SmartKVM



Unlike traditional built-in KVM monitor buttons, the smart KVM allows for switching between sources with the click of a button on your

keyboard. When all devices are properly connected, users can easily switch between sources by clicking the "Ctrl" key three times.

VA display

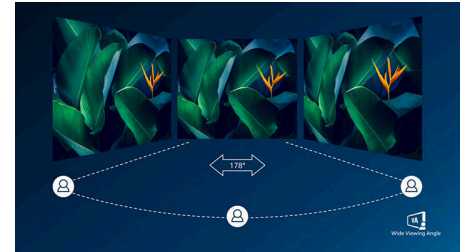

The Philips VA LED display uses an advanced multi-domain vertical alignment technology that gives you super-high static contrast ratios for extra-vidid and bright images. While standard office applications are handled with ease, it is especially suitable for photos, web browsing, films, gaming and demanding graphical applications. Its optimised pixel management technology gives you a 178/178 degree extra-wide viewing angle, resulting in crisp images.

Busylight

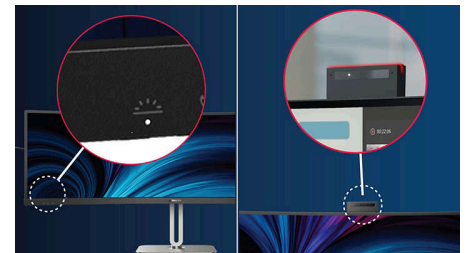

This feature allows for privacy and optimal collaboration when working in a busy office setting. To transmit to others that they are busy, users can simply press the Busylight hotkey located on the bottom left menu of the monitor bezel, and the light located on the webcam will turn red. In addition to this, the Busylight feature can also sync with users' Microsoft Teams status.



Curved Business Monitor

32:9 SuperWide curved monitor with USB-C

49B2U5900AM/00

Highlights

Compact Ergo Base

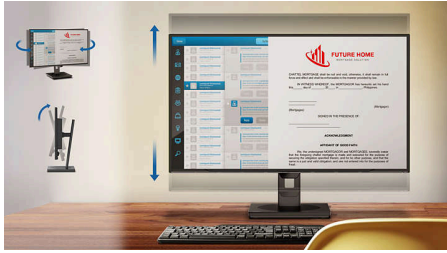

The Compact Ergo Base is a people-friendly Philips monitor base that tilts, swivels and height-adjusts so each user can position the monitor for maximum viewing comfort and efficiency.

Adjustable webcam



Level up the comfort of video conferencing with this feature. By adjusting the webcam back by 30 degrees, users can now comfortably call and attend meetings from any position that best suits them.

Earphone Hook



Earphone storage is unmatched with this feature. Carefully pull down the hook located on the side of the monitor. This feature makes for a tidy desktop and provides a handy cable management solution for your workspace.



Specifications

Picture/Display

Panel Size: 48.8" / 124 cm
Aspect ratio: 32:9
LCD panel type: VA LCD
Backlight type: W-LED system
Pixel pitch: 0.2328 x 0.2328 mm
Brightness: 450 cd/m²
Display colours: 1.07 B (8-bit + FRC)
Colour gamut (typical): NTSC 97%*, sRGB 119%*
Contrast ratio (typical): 3000:1
SmartContrast: 80,000,000:1
Response time (typical): 4 ms (Grey to Grey)*
Viewing angle: 178° (H) / 178° (V), @ C/R > 10
Picture enhancement: SmartImage
Maximum resolution: 5120 x 1440 @ 75 Hz
Effective viewing area: 1191.936 (H) x 335.232 (V) - at a 1800R curvature*
Scanning Frequency: HDMI: 30 - 140 kHz (H) / 48-75 Hz (V); DP: 30 - 114 kHz (H) / 48-75 Hz (V); USB-C: 30 - 114 kHz (H) / 30 - 75 Hz (V)
sRGB
Delta E: < 2
Flicker-free
Pixel Density: 109 PPI
LowBlue Mode
Display Screen Coating: Anti-Glare, 3H, Haze 25%
SmartUniformity: 93 ~ 105%
EasyRead
Adaptive sync
HDR: DisplayHDR 400 certified

Connectivity

Signal Input: HDMI 2.0 x 2, DisplayPort 1.4 x 1, USB-C x 1 (upstream, DP Alt mode, Data, PD up to 100 W)
Sync Input: Separate Sync
Audio (In/Out): Audio out/Microphone in combo jack
RJ45: Ethernet LAN up to 1 G*, Wake on LAN
HDCP: HDCP 1.4 (HDMI/DisplayPort/USB-C), HDCP 2.2 (HDMI/DisplayPort/USB-C)
HBR3: HBR3 (USB-C/DisplayPort)
USB Hub: USB 3.2 Gen 1/5 Gbps, USB-B upstream x 1, USB-A downstream x 2 (with 1 for fast-charge B.C 1.2), USB-C downstream x 1 (Data, PD 15 W)

Power Delivery

Max power delivery: Up to 100 W* (5 V/3 A, 7 V/3 A, 9 V/3 A, 10 V/3 A, 12 V/3 A, 15 V/3 A, 20 V/4.8 A)
Version: USB PD version 3.0

Convenience

Built-in Speakers: 3 W x 2
Plug and Play Compatibility: DDC/CI, Mac OS X, sRGB, Windows 11/10/8.1/8
User convenience: Mic, SmartImage, Input, User, Menu, Power On/Off
OSD Languages: Brazil Portuguese, Czech, Dutch, English, French, Finnish, German, Greek, Hungarian, Italian, Japanese, Korean, Portuguese, Polish, Russian, Simplified Chinese, Spanish, Swedish, Traditional Chinese, Turkish, Ukrainian
Other convenience: Kensington lock, Earphone hook, VESA mount (100 x 100 mm)
Control software: SmartControl
MultiView: PIP/PBP mode, 2 x devices
Built-in webcam: Pop-up 5.0 megapixel camera with a microphone and LED indicator (for Windows Hello)
Busylight
KVM: Yes (USB-C/USB-B)

Stand

Height adjustment: 150 mm
Swivel: -/+30 degree
Tilt: -5/15 degree

Power

ECO mode: 39 W (typ.)
Power supply: Built-in, 100–240 VAC, 50–60 Hz
Off mode: 0.3 W (typ.)
On mode: 46.1 W (typ.) (Energy Star test method)
Standby mode: 0.3 W (typ.)
Power LED indicator: Operation - White, Standby mode - White (flashing)
Energy Label Class: F

Dimensions

Packaging in mm (W x H x D): 1290 x 300 x 475 mm
Product without stand (mm): 1193 x 373 x 164 mm
Product with stand (max height): 1193 x 583 x 268 mm

Weight

Product with packaging (kg): 19.38 kg kg
Product with stand (kg): 15.21 kg kg
Product without stand (kg): 11.58 kg kg

Operating conditions

Altitude: Operation: +12,000 ft (3658 m), Non-operation: +40,000 ft (12,192 m)
Temperature range (operation): 0°C to 40 °C
Relative humidity: 20%-80 %
Temperature range (storage): -20°C to 60 °C
MTBF (demonstrated): 70,000 hrs (excluded backlight)

Sustainability

Environmental and energy: PowerSensor, LightSensor, Energy Star, EPEAT*, RoHS
Post-consumer recycled plastic: 85%
Recyclable packaging material: 100 %
Specific Substances: Mercury free, PVC/BFR free housing

Compliance and standards

Regulatory Approvals: CB, CE Mark, TUV/GS, TUV Ergo, TCO Certified, EAC, EAEU RoHS, CEL, CCC, UKCA, EMF, FCC, ICES-003

Cabinet

Finish: Texture
Foot: Silver
Front bezel: Charcoal
Rear cover: Charcoal

What's in the box?

Cables: HDMI cable, DisplayPort cable, USB-C to C/A Y cable, Power cable
Monitor with stand
User Documentation

- * Radius of the arc of the display curvature in mm
- * Response time value equal to SmartResponse
- * NTSC Area based on CIE 1976
- * sRGB Area based on CIE1931
- * Activities such as screen sharing and online streaming over the Internet can impact your network performance. Your hardware and network bandwidth will determine the overall audio and video quality.
- * For USB-C power and charging function, your Notebook/device must support USB-C standard Power Delivery specifications. Please check with your Notebook user manual or manufacturer for more details.
- * If your Ethernet connection seems slow, please enter the OSD menu and select USB 3.0 or a higher version that can support the LAN speed up to 1G.
- * For Video transmission via USB-C, your Notebook/device must support USB-C DP Alt mode
- * The USB-C power delivery of this display is up to 100 W (96 W in typical). The maximum power delivery will depend on your device.
- * EPEAT rating is valid only where Philips registers the product. Please visit <https://www.epeat.net/> for registration status in your country.
- * When calculating energy costs saving from PowerSensor, both USB and Power delivery are excluded.
- * The monitor may look different from feature images.
- * The products and accessories listed on this leaflet may differ by country and region.

