

Contents

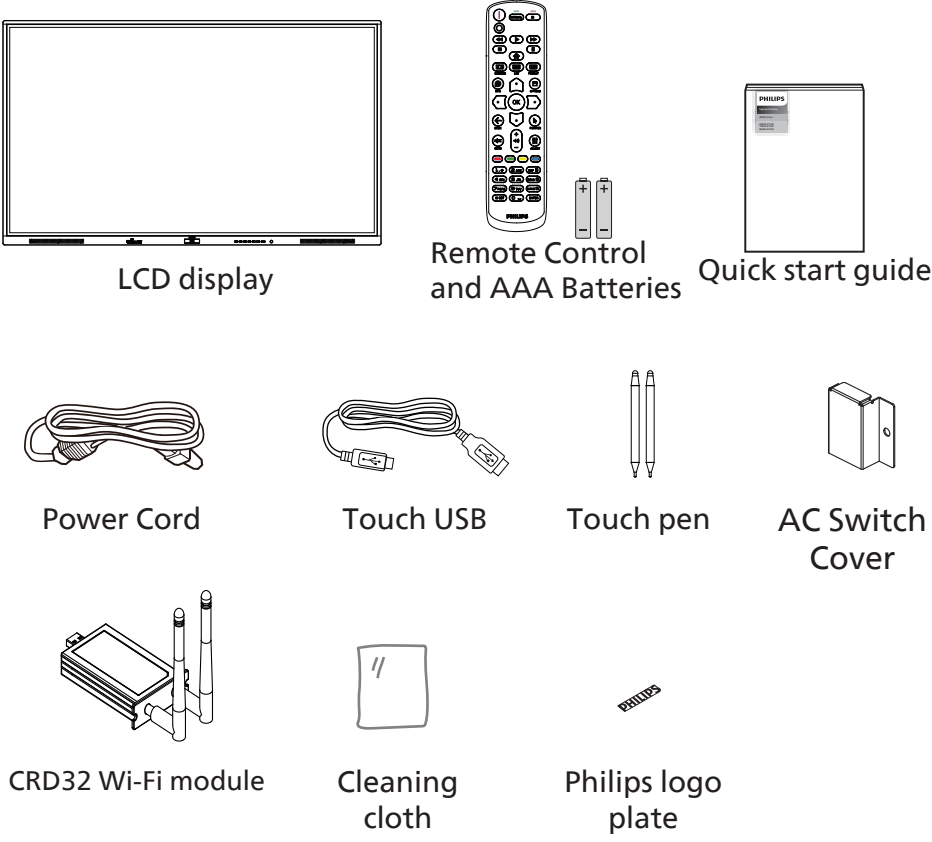

* Differences according to regions.
Display design and accessories may differ from those illustrated above.



1 Unboxing

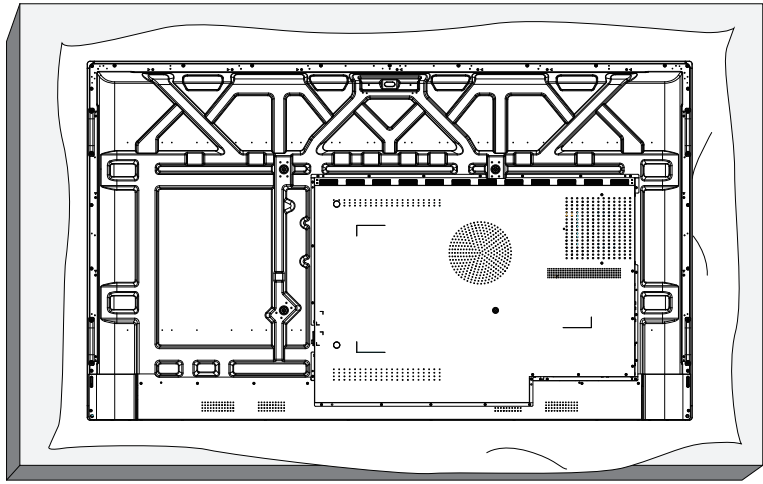

2 Input/Output Terminals

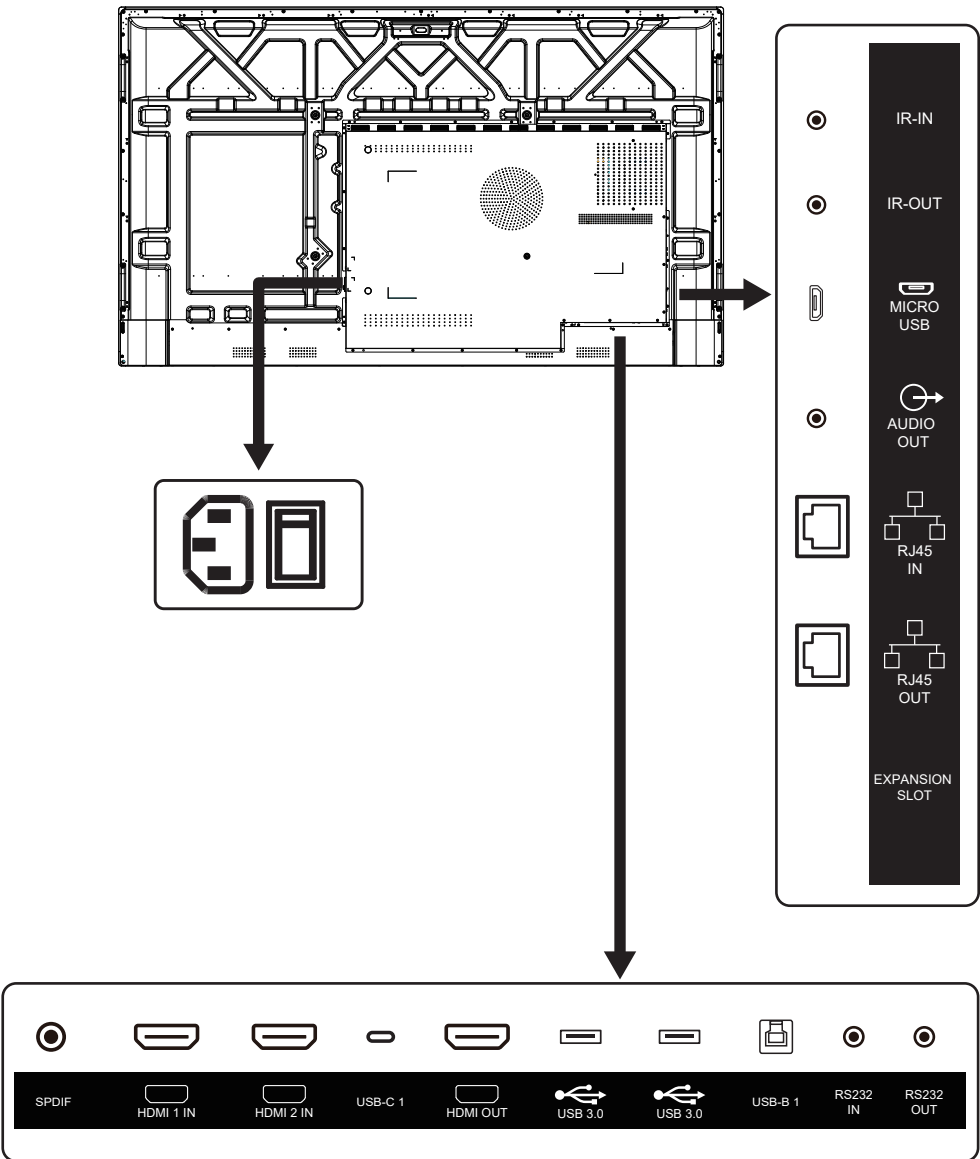

3 Connection

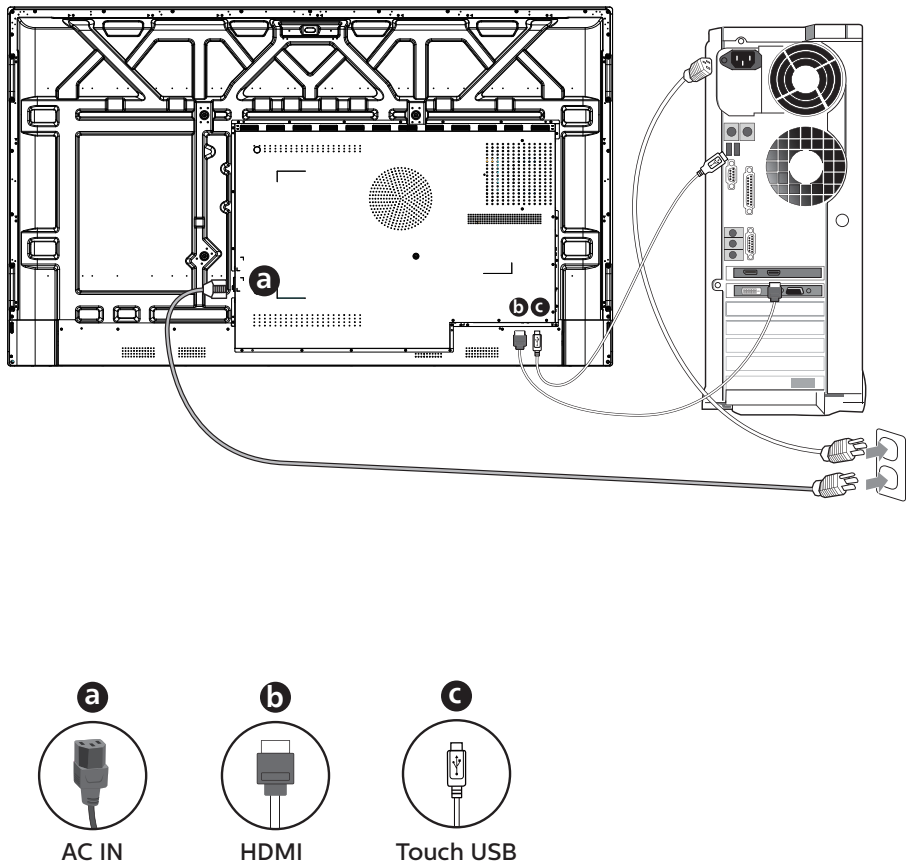

4 Control Panel

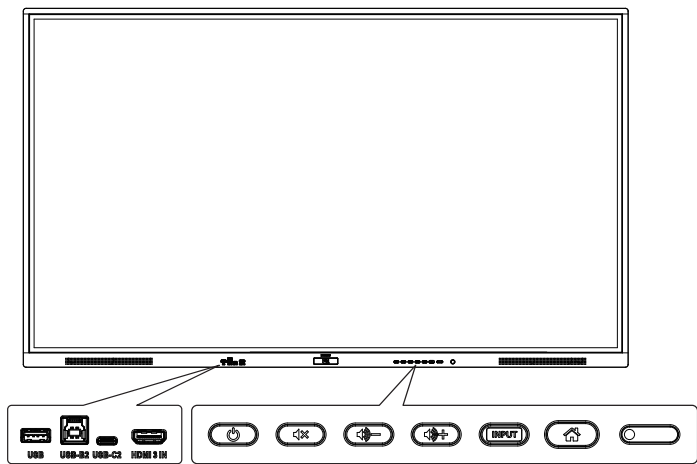

PHILIPS

Signage Display

4000 Series

65BDL4152E
75BDL4152E
86BDL4152E

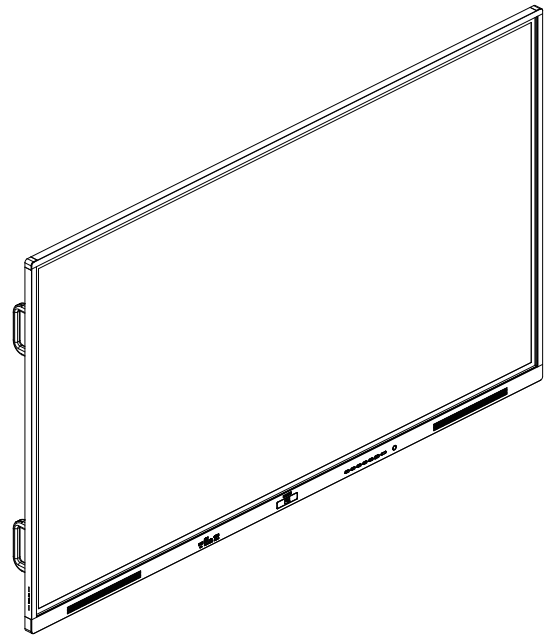



Quick start

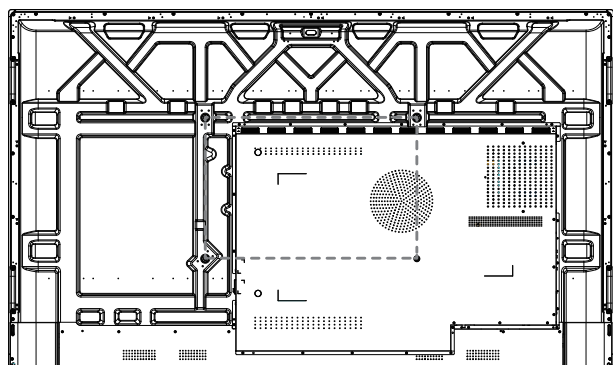
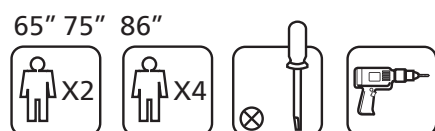

For more information, please visit:
<https://www.philips.com/ppds>

5 Installation



 M8 * (15+X) mm
(X=Thickness of Wall mount BKT)

65BDL4152E: 500mm x 400mm

75BDL4152E: 600mm x 400mm

86BDL4152E: 800mm x 400mm



Version: V1.00 2024-02-05

TPV USA Corp
6525 Carnegie Blvd #200
Charlotte, NC 28211
USA

2024 © TOP Victory Investments Ltd. All rights reserved.

This product has been manufactured by and is sold under the responsibility of Top Victory Investments Ltd., and Top Victory Investments Ltd. is the warrantor in relation to this product. Philips and the Philips Shield Emblem are registered trademarks of Koninklijke Philips N.V. and are used under license.

Specifications are subject to change without notice.



Q41G75M181343A