

# PHILIPS

32:9 SuperWide  
Thunderbolt™ 4 monitor

Curved Business monitor

6000 series

49 (48.8" / 124 cm diag.)

5120 x 1440 (Dual QHD)

49B2U6903CH



## Redefining workflow productivity

with a pop-up webcam

This Philips Thunderbolt™ 4 monitor is designed with everything you need for a collaborative remote workspace. Its webcam sports features such as auto-framing and a busy light for an unmatched video conferencing experience.

### **Thunderbolt™ 4 for flexibility and performance**

- Thunderbolt™ 4 Connection: for lightning-fast connectivity

### **Superb Picture Quality**

- VA display delivers awesome images with wide viewing angles
- DisplayHDR 400 for more lifelike and outstanding visuals

### **Designed for the way you work**

- PowerSensor 2: for optimised energy efficiency
- 32:9 SuperWide screen designed to replace multiscreen setups
- Collaboration-ready webcam with noise-cancelling mic.
- Curved display design for a more immersive experience
- Busylight: for setting your work status
- Earphone hook: for customisable storage
- SmartKVM: for easily switching between sources.
- Webcam Autoframing: for dynamic video calls
- Adjustable Webcam: for video conferencing in comfort.

# Curved Business monitor

32:9 SuperWide Thunderbolt™ 4 monitor

49B2U6903CH/00

## Highlights

### VA display

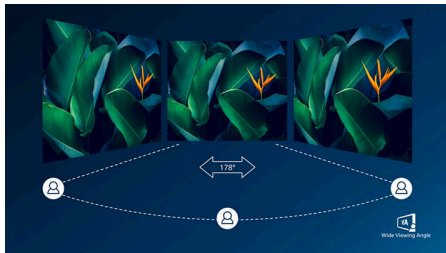

The Philips VA LED display uses an advanced multi-domain vertical alignment technology that gives you super-high static contrast ratios for extra-vivid and bright images. While standard office applications are handled with ease, it is especially suitable for photos, web browsing, films, gaming and demanding graphical applications. Its optimised pixel management technology gives you a 178/178 degree extra-wide viewing angle, resulting in crisp images.

### DisplayHDR 400



VESA-certified DisplayHDR 400 delivers a significant step up from normal SDR displays. Unlike other 'HDR-compatible' screens, true DisplayHDR 400 produces astonishing brightness, contrast and colours. With global dimming and minimum 400 nits of brightness, images come to life with notable highlights while featuring deeper, more nuanced blacks. It renders a fuller palette of rich new colours, delivering a visual experience that engages your senses.

### Curved display design

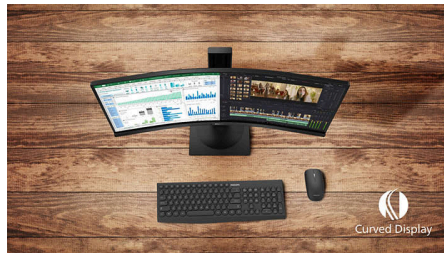

Desktop monitors offer a personal user experience, which suits a curved design very well. The curved screen provides a pleasant yet subtle immersion effect, which focuses on you at the centre of your desk.

### SmartKVM



Unlike traditional built-in KVM monitor buttons, the smart KVM allows for switching between sources with the click of a button on your keyboard. When all devices are properly connected, users can easily switch between sources by clicking the "Ctrl" key three times.

### 32:9 SuperWide

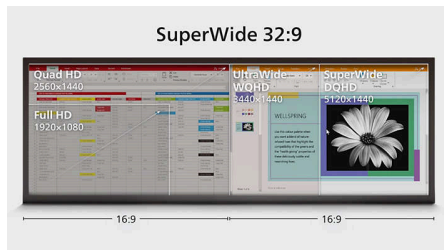

32:9 SuperWide 49" screen with 5120 x 1440 resolution is designed to replace multiscreen setups for a massive wide view. It's like having two 27" 16:9 Quad HD displays side by side. SuperWide monitors offer the screen area of dual monitors without the complicated setup.

### Adjustable webcam



Level up the comfort of video conferencing with this feature. By adjusting the webcam back and forth by 30 degrees, users can now comfortably call and attend meetings from any position that best suits them.

### Webcam Autoframing



This feature is perfect for multi-person video conferencing. When one or more people join the webcam view, the frame will automatically adjust and zoom to fit all team members. Likewise, when participants leave the webcam view, the frame will adjust accordingly, thereby making it ideal for long meetings as well as team calls.

### Earphone Hook



Earphone storage is unmatched with this feature. Carefully pull down the hook located on the side of the monitor: This feature makes for a tidy desktop and provides a handy cable management solution for your workspace.



## Highlights

### Busylight

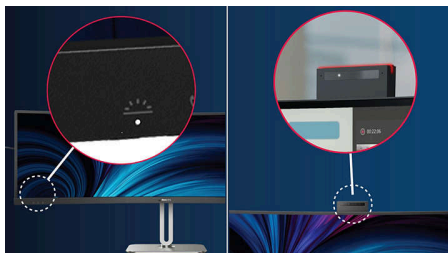

This feature allows for privacy and optimal collaboration when working in a busy office setting. To transmit to others that they are busy, users can simply press the Busylight hotkey located on the bottom left menu of the monitor bezel, and the light located on the webcam will turn red. In addition to this, the Busylight feature can also sync with users' Microsoft Teams status.

### PowerSensor 2

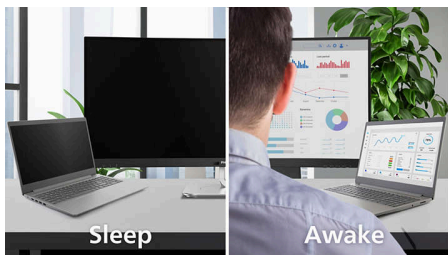

This monitor's PowerSensor 2 feature reduces energy consumption by detecting when users move closer and further away from the screen.

After switching the OSD setting to "User", you then need to adjust the settings in Windows 11 for this feature to function properly. When these adjustments are made, the monitor and connected PC/laptop will wake when someone approaches it and sleep when someone walks away, effectively reducing the amount of wake time. The distance for detection can be set to 50, 75 or 120 cm from the user's laptop. Please note that Windows 11 must be installed.

### Webcam and noise-cancelling mic



This Philips monitor comes with a built-in 5 MP webcam, noise-cancelling microphone and speakers, making it perfect for working from home and collaborating remotely. It is equipped with advanced sensors that work seamlessly with Windows Hello facial recognition, allowing you to log into your Windows devices in less than 2 seconds. For added privacy, a physical camera switch lets you disable the webcam when not in

use. The noise-cancelling microphone and dual 5 watt integrated speakers ensure clear communication.

### Thunderbolt™ 4 for flexibility and performance



This Philips docking monitor is equipped with Thunderbolt 4 connection. Compared with conventional USB-C monitors, Thunderbolt 4 technology provides lightning-fast data transfer speeds, supports high-resolution video, offers multi-stream transport for daisy chaining and has a capacity of up to 100 W of power delivery to external devices.



# Curved Business monitor

32:9 SuperWide Thunderbolt™ 4 monitor

49B2U6903CH/00

## Specifications

### Picture/Display

**Panel Size:** 48.8 inch/124 cm

**Aspect ratio:** 32:9

**LCD panel type:** VA LCD

**Backlight type:** W-LED system

**Pixel pitch:** 0.2328 x 0.2328 mm

**Brightness:** 450(SDR) cd/m<sup>2</sup>, 500(HDR) cd/m<sup>2</sup>

**Display colours:** 1.07 B

**Colour gamut (typical):** NTSC: 97%\*, RGB: 119%\*

**Contrast ratio (typical):** 3000:1

**SmartContrast:** 80,000,000:1

**Response time (typical):** 4 ms (Grey to Grey)\*

**Viewing angle:** 178° (H)/178° (V), @ C/R > 10

**Picture enhancement:** SmartImage

**Maximum resolution:** 5120 x 1440 @ 60 Hz

(HDMI2.0)\*, 5120 x 1440 @ 100 Hz(DP1.4)\*,

5120 x 1440 @ 75 Hz (Thunderbolt)\*

**Effective viewing area:** 1191.936 (H) x 335.232 (V) mm, 1800 R curvature\*

**Scanning Frequency:** HDMI: 30–140 kHz (H)/30–75 Hz (V); DP/Thunderbolt: 30–200 kHz (H)/48–120 Hz (V)

**sRGB**

**Delta E:** < 2 (sRGB)

**SoftBlue**

**Flicker-free**

**Pixel Density:** 109 PPI

**Display Screen Coating:** Anti-Glare, 3H, Haze 25%

**SmartUniformity:** 93 ~ 105%

**EasyRead**

### Adaptive sync

**HDR:** Display HDR 400 certified

**EyeSafe**

### Connectivity

**Signal Input:** HDMI 2.0 x 2, DisplayPort 1.4 x 1, Thunderbolt 4 input x 1 (upstream, Data, Video, PD to 100 W)

**Sync Input:** Separate Sync, Sync on Green

**Audio (In/Out):** Audio out/Microphone in combo jack

**RJ45:** Ethernet LAN up to 2.5G\*, Wake on LAN

**Signal Output:** Thunderbolt 4 output x 1 (downstream, Data, Video, PD 15 W)

**HDCP:** HDCP 1.4 (HDMI/DisplayPort/Thunderbolt 4), HDCP 2.2 (HDMI/DisplayPort/Thunderbolt 4)

**HBR3:** HBR 3 (Thunderbolt 4)

**USB Hub:** USB 3.2 Gen 2/10 G, upstream: 1 x

Thunderbolt 4, 1 x USB-C1 (data); downstream:

1 x Thunderbolt 4, USB-A x4 (with x 1 fast charge

B.C 1.2), USB-C2 x 1 (data, 45 W)

### Power Delivery

**Max power delivery:** Up to 100 W (5 V/3 A, 7 V/3 A, 9 V/3 A, 10 V/3 A, 12 V/3 A, 15 V/3 A, 20 V/4.8 A)

**Version:** USB PD version 3.0

### Convenience

**Built-in Speakers:** 5 W x 2

**Plug and Play Compatibility:** DDC/CI, Mac OS, sRGB, Windows 11/10

**User convenience:** SmartImage, Input, User, Menu, Power On/Off, Mute, Handup, Busylight

**OSD Languages:** Brazil Portuguese, Czech, Dutch, English, French, Finnish, German, Greek, Hungarian, Italian, Japanese, Korean, Portuguese, Polish, Russian, Simplified Chinese, Spanish, Swedish, Traditional Chinese, Turkish, Ukrainian

**Other convenience:** Kensington lock, Earphone hook, VESA mount (100 x 100 mm)

**Control software:** SmartControl

**MultiView:** PIP/PBP mode, 2 x devices

**Built-in webcam:** Pop-up 5.0 megapixel camera with microphone and LED indicator

**Webcam with auto-framing**

**Webcam tilt function:** Yes, -/+30 degree

**Busylight**

**Noise cancellation**

**SmartKVM:** Yes (Thunderbolt 4/USB-C1)

### Stand

**Height adjustment:** 150 mm

**Swivel:** -/+30 degree

**Tilt:** -5/15 degree

### Power

**ECO mode:** 37.5 W (typ.)

**Power supply:** Built-in, 100–240 VAC, 50–60 Hz

**Off mode:** 0.5 W (typ.)

**On mode:** 41.85 W (typ.) (Energy Star test method)

**Standby mode:** 0.5 W (typ.)

**Power LED indicator:** Operation - White, Standby mode - White (flashing)

**Energy Label Class:** F

## Specifications

### Dimensions

Packaging in mm (W x H x D):

1290 x 300 x 475 mm

Product without stand (mm): 1193 x 373 x 164 mm

Product with stand (max height): 1193 x 586 x 268 mm

### Weight

Product with packaging (kg): 19.54 kg

Product with stand (kg): 15.45 kg

Product without stand (kg): 11.82 kg

### Operating conditions

Altitude: Operation: +12,000 ft (3658 m), Non-operation: +40,000 ft (12,192 m)

Temperature range (operation): 0°C to 40 °C

Relative humidity: 20%-80 %

Temperature range (storage): -20°C to 60 °C

MTBF (demonstrated): 70,000 hrs (excluded backlight)

### Sustainability

Environmental and energy: Energy Star, EPEAT\*, RoHS, TCO Certified Edge, LightSensor, PowerSensor 2\*

Post-consumer recycled plastic: 85%+OBP 5%

Recyclable packaging material: 100 %

Specific Substances: Mercury free, PVC/BFR free housing

### Compliance and standards

Regulatory Approvals: CB, CE Mark, TUV/GS, TUV Ergo, TCO Certified, MEPS, EAC, UKCA, EMF, FCC, ICES-003, eyesafe® CERTIFIED 2.0, TÜV Rheinland Low Blue Light (Hardware Solution)

### Cabinet

Finish: Texture

Foot: Silver

Front bezel: Charcoal

Rear cover: Charcoal

### What's in the box?

Cables: HDMI cable, DisplayPort cable, TBT4 cable, Power cable

Monitor with stand

User Documentation



- \* Radius of the arc of the display curvature in mm
- \* Response time value equal to SmartResponse
- \* NTSC Area based on CIE 1976
- \* sRGB Area based on CIE1931
- \* For Video transmission via USB-C, your Notebook/device must support USB-C DP Alt mode
- \* Activities such as screen sharing and online streaming over the Internet can impact your network performance. Your hardware and network bandwidth will determine the overall audio and video quality.
- \* For USB-C power and charging function, your Notebook/device must support USB-C standard Power Delivery specifications. Please check with your Notebook user manual or manufacturer for more details.
- \* If your Ethernet connection seems slow, please enter the OSD menu and select USB 3.0 or a higher version that can support the LAN speed up to 1G.
- \* EPEAT rating is valid only where Philips registers the product. Please visit <https://www.epeat.net/> for registration status in your country.
- \* The display colours reduce to 8 bits, the max resolution of HDMI can be 5120 x 1440 @ 75 Hz, and DisplayPort can be 5120 x 1440 @ 120 Hz
- \* It's for laptops with DSC; if you don't have DSC, the max resolution of Thunderbolt 4 input and output can be 5120 x 1440 @ 60 Hz, 8 bits display colour and with USB 3.2 Gen1.
- \* Please note that the PowerSensor 2 is only functional with Windows 11 installed. When PowerSensor 2 is activated, WAL means Walk Away Lock and WOA means Wake On.
- \* The monitor may look different from feature images.
- \* The products and accessories listed on this leaflet may differ by country and region.