



Visit us

www.philips.com

There may be certain differences between the content of this manual and your product. Please refer to the actual product. We reserve the right to update the product at any time without prior notice.

© 2023 AquaShield

All rights reserved

Philips and the Philips Shield Emblem are registered trademarks of Koninklijke Philips N.V. and are used under license.

This product has been manufactured by and is sold under the responsibility of Guangdong Deerma Technology Company Limited and Guangdong Deerma Technology Company Limited is the warrantor in relation to this product.

Rev A MAR 23



PHILIPS

Back and Waist Massager

Waist Massager

PPM4325



Quick Start Guide

1. Push the belt inside out through the clasp of the massager and secure it with a Velcro.

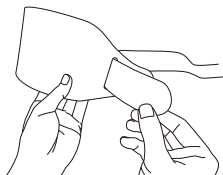

2. Mount the battery compartment (controller) into the slideway of the massager from right to left so that the battery compartment is firmly mounted on the massager.



3. Put the massager on the waist, push the belt through the clasp and secure it with a Velcro.



4. Press and hold the power button for 2 seconds to turn on/off the product, the buzzer keeps beeping for 2 seconds, and the power indicator turns orange. After power-on, the heating temperature by default is 45°C and the level 1 heating indicator is turns orange.

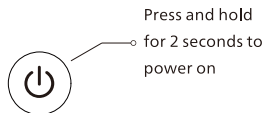

5. Press the temperature adjustment button to switch the heating levels circularly, which is in the order as follows: level 1 (45°C) – level 2 (50°C) – level 3 (55°C) – level 1 (45°C), and the corresponding level indicator turns orange, and the buzzer will give a beep for each operation.

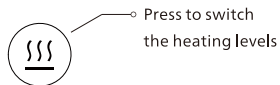

6. The massager is set to shut off automatically after 30 minutes of operation, and the buzzer keeps beeping for 2 seconds and then the product enters the standby state.



- 1.The abdominal skin is sensitive, so it is recommended to use the massager with clothes on for fear of scalding if choosing 50℃ and above;
- 2.The fabric area should not be washed. Sterilize the fabric and remove sweat stains with alcohol or wipe it with a clean wet towel.
- 3.When the battery remaining capacity is less than 10%, the power indicator quickly flashes for 2 seconds and then the product will shut off.
- 4.Make sure to power off before charging. Do not use the product while charging.

1. 将绑带由内向外穿过按摩器的扣子, 通过魔术贴固定好。

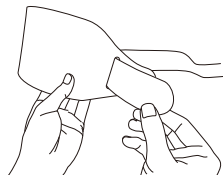

2. 将电池仓（控制器）从右往左装入到机身滑道上, 使电池仓稳固安装于机身上。

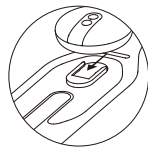

2. 将电池仓（控制器）从右往左装入到机身滑道上, 使电池仓稳固安装于机身上。



4. 长按电源键2秒开机/关机，蜂鸣器长鸣2秒“滴~”，电源指示灯亮橙色，开机默认加热45°C，加热指示灯一挡亮橙色。

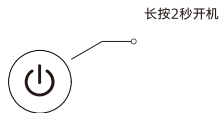

5. 短按温度调节按键循环切换加热挡位，依次为：一挡 (45°C)- 二挡 (50°C)- 三挡 (55°C)- 一挡 (45°C)，对应档位指示灯亮橙色，每次操作蜂鸣器均发出“滴”一声提示。

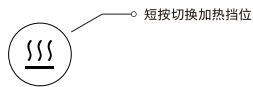

6. 按摩器运行30分钟后自动关机，蜂鸣器长鸣25“滴~”，进入待机状态。



- ❗ 1. 因腹部皮肤较为敏感，50°C及以上建议隔着衣服使用，谨防烫伤；
- 2. 布料区域不可水洗，请用酒精杀菌除汗渍或用洁净湿毛巾擦拭。
- 3. 当电量少于10%时，电源指示灯频闪2秒并关机。
- 4. 请关机后再充电，请勿边充电边使用。

1. Letakkan tali melalui gesper pada perangkat pengurut dari dalam ke luar dan benarkan dengan tali Velcro.

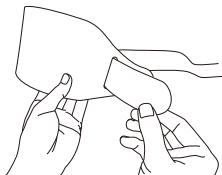

2. Pasangkan kotak bateri (Kawalan) ke dalam saluran gelongsor pada fiuslaj dari kanan ke kiri, demi kotak bateri dipasang dengan kukuh pada fiuslaj.



3. Letakkan pengurut di pinggang, ikatkan tali dan melepasi butang, kemudian selesaikannya melalui tali velcro.



4. Tekan lama pada butang kuasa selama 2 saat untuk menghidupkan/mematikan, kemudian suara pengumuman bunyi "Bipp", lampu penunjuk berwarna oren, selepas menyalakan pemanasan suhu 45°C dengan lalai, maka lampu penunjuk akan berwarna oren.

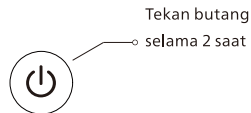

5. Tekan sejenak butang untuk mengedarkan pemanas sesuai dengan urutan berikut: Level 1(45°C) – Level 2(50°C) – Level 3(55°C) – Level 1(45°C), penunjuk pada level yang sepadan akan menyala dan berwarna oren, setiap kali perangkat dinyalakan, maka akan ada suara "Bipp".

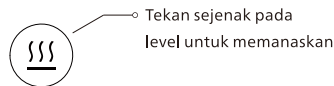

6. Selepas perangkat berjalan selama 30 minit, maka perangkat secara automatik akan dimatikan, suara pengumuman akan bunyi "Bipp" selama 2 saat dan memasuki kondisi siap sedia.



1. Oleh kerana kulit pada bahagian perut sangat sensitif, maka disyorkan untuk menggunakannya melalui pakaian apabila suhu melebihi 50°C untuk mengelakkan kulit Anda melecur;
2. Bahagian kain tidak dapat dibasuh dengan air. Sila gunakan alkohol untuk mensterilkan dan menghilangkan kesan peluh atau lap dengan tuala basah yang bersih.
3. Apabila kuasa kurang daripada 10%, maka lampu penunjuk kuasa akan berkelip selama 2 saat dan dimatikan.
4. Sila mengemas selepas mematikan perangkai, dilarang untuk menggunakannya dan mengemasnya pada semasa.