

PHILIPS

NORELCO

AquaTouch



Manufactured for:
Philips Personal Health
a division of Philips North America LLC
P.O. Box 10313, Stamford, CT 06904



This symbol on the product's nameplate means it is listed
by Underwriters' Laboratories, Inc.

Norelco and Tripleheader are registered trademarks of Philips
North America LLC.

PHILIPS and Philips shield are registered trademarks of
Koninklijke Philips N.V.

©2021 Philips North America LLC. All rights reserved.

3000.071.4591.2 (6/30/2021)



>75 % recycled paper
>75 % papier recyclé

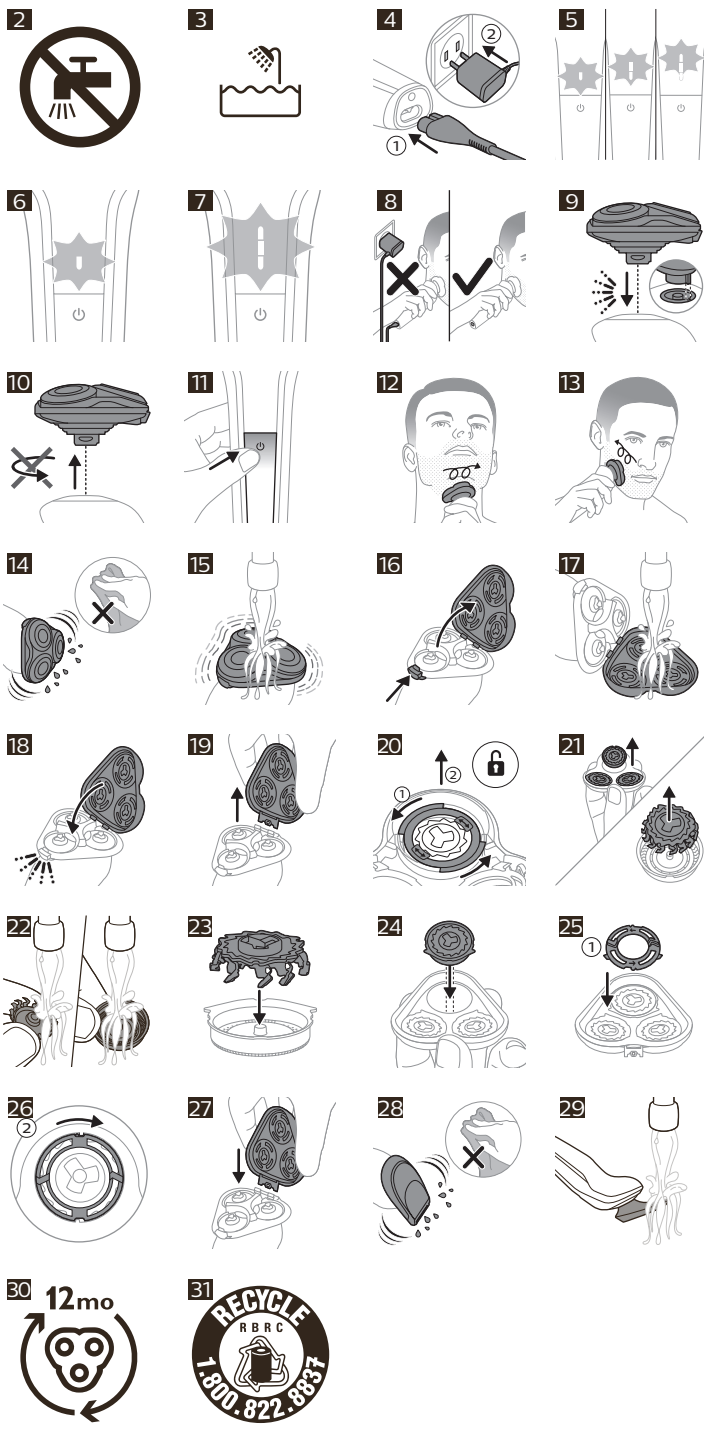

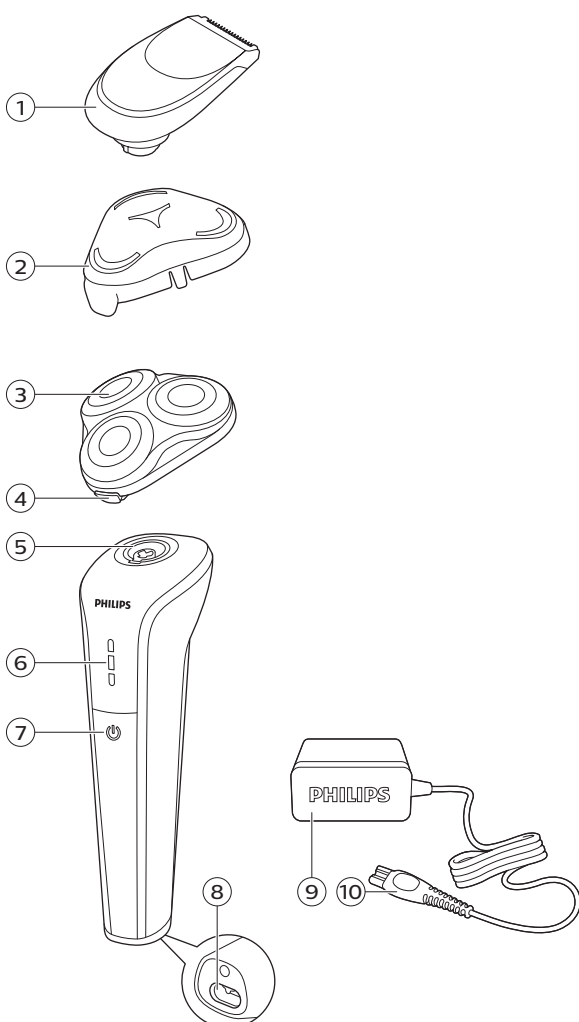

English

IMPORTANT SAFETY INSTRUCTIONS

When using an electric product, basic precautions should always be followed, including the following:

Read all instructions before using this product.

DANGER

To reduce the risk of electric shock:

- Do not reach for a corded product that has fallen into water. Unplug immediately from the power outlet.
- Keep the power cord dry (Fig. 2).
- Do not place or store the product where it can fall or be pulled into a tub or sink. Do not place or drop the product into water or other liquid.
- This product does not work while it is connected to the power outlet. Except when charging, always unplug this product from the power outlet.
- Remove power cord from power outlet and product before cleaning.

WARNING

To reduce the risk of burns, fire, electric shock, or injury to persons:

- This appliance is not intended for use by persons (including children) with reduced physical, sensory or mental capabilities, or lack of experience and knowledge, unless they have been given supervision or instruction concerning use of the appliance by a person responsible for their safety. Children should be supervised to ensure that they do not play with the appliance.
- Use this product only for its intended household use as described in this manual. Misuse can lead to hazards or serious injuries. Do not use attachments not recommended by Philips North America LLC. Accessories supplied may vary for different products.
- Never operate this product if it has a damaged power cord, if it is not working properly, after it has been dropped or damaged, or after the product or power cord has been dropped into water. For assistance call 1-800-243-3050.
- Keep the power cord away from heated surfaces.
- Never drop or insert any object into any opening.
- Do not use the power cord in or near a power outlet that contains an electric air freshener to prevent damage to the power cord.
- Do not use product outdoors or operate where aerosol (spray) products are being used or where oxygen is being administered.
- Always check shaving heads (guards and cutters) before using the product. Do not use the product if cutters or guards are damaged, as injury may occur.
- Always attach power cord to product first, then to power outlet.
- Plug power cord directly into power outlet. Do not use an extension cord.
- Unplug power cord before plugging in or unplugging the product.
- Only use original Philips accessories or consumables. Only use detachable power cord HQ8505.
- Charge, use and store the product at a temperature between 41 °F / 5 °C and 95 °F / 35 °C.
- Keep product and batteries away from fire and do not expose them to direct sunlight or high temperatures.
- If the product becomes abnormally hot or smelly, changes color or if charging takes longer than usual, stop using and charging the product and contact Philips.
- Do not place products and their batteries in microwave ovens or on induction cookers.
- Do not open, modify, pierce, damage or dismantle the product or battery to prevent batteries from heating up or releasing toxic or hazardous substances. Do not short-circuit, overcharge or reverse charge batteries.
- If batteries are damaged or leaking, avoid contact with the skin or eyes. If this occurs, immediately rinse well with water and seek medical care.
- When you handle batteries, make sure that your hands, the product and the batteries are dry.
- To avoid accidental short-circuiting of batteries after removal, do not let battery terminals come into contact with metal objects (e.g. coins, hairpins, rings). Do not wrap batteries in aluminum foil. Tape battery terminals or put batteries in a plastic bag before you discard them.

SAVE THESE INSTRUCTIONS

Important

- This product is waterproof (Fig. 3). It is suitable for use in the bath or shower and for cleaning under the tap with water. For safety reasons, this product can only be used without cord.
- Do not modify the power cord.
- Because of hygiene, only one person should use the appliance.
- Do not use a damaged appliance. Replace damaged parts with new Philips parts.
- Before cleaning and storing the product, switch the product off and remove power cord from power outlet and product.
- Clean the product and the attachments after each use for optimal performance.

- Never use compressed air, scouring pads, abrasive cleaning agents or aggressive liquids to clean the appliance.
- Let the product and its attachments dry completely before storing.
- Do not wrap cord around the product when storing.
- Store cord and other accessories in a safe location where these will not be cut or damaged.

General description (Fig. 1)

- 1 Trimmer
- 2 Protective cap
- 3 Shaving unit
- 4 Shaving unit release button
- 5 Shaving unit connector
- 6 Battery charge indicator
- 7 On/off button
- 8 Socket for small plug
- 9 Power plug
- 10 Small plug

Introduction

Congratulations on your purchase and welcome to Philips Norelco! To fully benefit from the support that Philips offers, register your product at **www.philips.com/welcome**.

Charging

Fully charge the product before first use and when the display indicates that the battery is almost empty.

Charging takes approx. 1 hour. A fully charged shaver provides up to 45 minutes of shaving time.

Charging with the power cord

- 1 Make sure the shaver is switched off.
- 2 Put the small plug in the shaver and put the power plug in the power outlet (Fig. 4). The display of the shaver indicates that the shaver is charging (Fig. 5).
- 3 After charging, remove the power plug from the power outlet and pull the small plug out of the product.

Charge indications

Battery low

When the battery is almost empty, the bottom light of the battery charge indicator flashes orange (Fig. 6).

Battery charging

While the product charges, first the bottom light of the battery charge indicator flashes and then lights up continuously. Next the second light flashes and then lights up continuously, and so on until the product is fully charged (Fig. 5).

Battery full

When the product is fully charged, all three lights of the battery charge indicator light up continuously (Fig. 7). After approx. 30 minutes, the lights go out automatically.

Note: This product can only be used without cord (Fig. 8).

'Unplug before use' reminder

All lights of the battery charge indicator flash 3 times to remind you to unplug the shaver first.

Using the product

Removing or attaching the click-on attachments

- 1 Make sure the product is switched off.
- 2 Insert the lug of the attachment into the slot in the top of the product. Then press down the attachment to attach it to the product ('click') (Fig. 9).
- 3 Pull the attachment straight off the product (Fig. 10).

Note: Do not twist the attachment while you pull it off the product.

Switching the product on and off

To switch the product on or off, press the on/off button once (Fig. 11).

Note: This product can only be used without cord (Fig. 8).

Shaving

Dry shaving

- 1 Switch on the product.
- 2 Move the shaving heads over your skin in circular movements (Fig. 12) to catch all hairs growing in different directions (Fig. 13). Make sure each shaving head is fully in contact with the skin. Exert gentle pressure for a close, comfortable shave.

Note: Do not press too hard, as this can cause skin irritation.

- 3 Clean the product after use (see 'Cleaning and maintenance').

Wet shaving

For a more comfortable shave, you can also use this product on a wet face with shaving foam or shaving gel.

To shave with shaving foam or shaving gel, follow the steps below:

- 1 Apply some water to your skin.
- 2 Apply shaving foam or shaving gel to your skin.
- 3 Rinse the shaving unit under the tap to ensure that the shaving unit glides smoothly over your skin.
- 4 Switch on the product.
- 5 Move the shaving heads over your skin in circular movements to catch all hairs growing in different directions. Make sure each shaving head is fully in contact with the skin. Exert gentle pressure for a close, comfortable shave.

Note: Do not press too hard, as this can cause skin irritation.

Note: Rinse the shaving unit regularly to ensure that it continues to glide smoothly over your skin.

- 6 Dry your face.
- 7 Switch off and clean the product after each use.

Note: Make sure you rinse all foam or shaving gel off the product.

21-Day adaptation process

- 21 Day Trial and Conversion Process. It is a fact that your skin and beard need time to adjust to a new grooming system.
- Use your new shaver exclusively for 3 weeks to fully enjoy the closeness of a Philips Norelco shave.
- At first you may not get as close a shave as you expect, or your face may even become slightly irritated. This is normal since your beard and skin will need time to adjust. Invest 3 weeks and you'll soon experience the full joy of your new shaver.
- Stick with it! If you alternate shaving methods during the adjustment period, it may make it more difficult to adapt to the Philips Norelco shaving system.
- If you are still not convinced after 21 days, Philips Norelco will refund you the full purchase price as long as the request is received within 45 days of purchase.

Cleaning and maintenance

Clean the product and the attachments after each use for optimal performance.

Cleaning the shaver under the tap

Clean the shaver after every shave for optimal performance.

Always check if the water is too hot, to prevent burning your hands.

Never dry the shaving unit with a towel or tissue, as this may damage the shaving heads (Fig. 14).

While rinsing shaving heads, water may drip out of the base of shaver. This is a normal occurrence.

- 1 Switch on the product.
- 2 Rinse the shaving unit under a warm tap (Fig. 15).
- 3 Switch off the product. Press the release button to open the shaving unit (Fig. 16).
- 4 Rinse the shaving head holder under the tap (Fig. 17).

- 5 Carefully shake off excess water and let the shaving head holder air-dry completely.
- 6 Close the shaving unit (Fig. 18).

Thorough cleaning

We advise you to clean the shaving heads thoroughly once a month or when the shaver does not shave as well as it used to.

- 1 Switch off the product.
- 2 Press the release button on the shaving unit (Fig. 16) and pull the shaving head holder off the shaving unit (Fig. 19).
- 3 Turn the retaining rings counterclockwise and remove them (Fig. 20).
- 4 Remove the shaving heads from the shaving head holder. Each shaving head consists of a cutter and guard (Fig. 21).

Note: Do not clean more than one cutter and guard at a time, since they are all matching sets. If you accidentally put a cutter in the wrong shaving guard, it may take several weeks before optimal shaving performance is restored.

- 5 Clean the cutter and guard under the tap (Fig. 22).
- 6 Put the cutter back into the guard (Fig. 23).
- 7 Place the shaving heads in the shaving head holder (Fig. 24).

Note: Make sure that the projections of the shaving heads fit exactly into the recesses of the shaving head holder.

- 8 Place the retaining rings back onto the shaving head holder (Fig. 25) and turn them clockwise ('click') (Fig. 26).
- Each retaining ring has two recesses and two projections that fit exactly in the projections and recesses of the shaving head holder.

Reinsert the hinge of the shaving head holder into the slot of the shaving unit (Fig. 27). Close the shaving unit (Fig. 18).

Cleaning click-on attachments

Cleaning the precision trimmer attachment

Never dry the trimmer with a towel or tissue, as this may damage the trimming teeth (Fig. 28).

Clean the trimmer after each use.

- 1 Switch on the product.
- 2 Rinse the trimmer under a warm tap (Fig. 29).
- 3 After cleaning, switch off the product.
- 4 Carefully shake off excess water and let the trimmer air-dry completely.
- 5 For optimal performance, lubricate the teeth of the trimmer with a drop of mineral oil every six months.

Storage

Put the protection cap on the product to protect it from dirt accumulation. We advise you to let the product dry before you store it.

Replacement

For maximum shaving performance, replace the shaving heads once a year (Fig. 30).

Replacement parts and accessories may be purchased at a store near you or on our website **www.philips.com/store**.

The following accessories and spare parts are available:

- SH71 Philips Norelco replacement shaving heads

Assistance

For assistance, visit our website: **www.philips.com/support** or call toll free 1-800-243-3050.

Disposal

- This product contains a rechargeable NiMH battery which must be disposed of properly.
- Contact your local town or city officials for battery disposal information. You can also call 1-800-822-8837 or visit **www.call2recycle.org** for battery drop-off locations (Fig. 31).
- For assistance, visit our website **www.philips.com/support** or call 1-800-243-3050 toll free.
- Your product is designed and manufactured with high quality materials and components, which can be recycled and reused. For recycling information, please contact your local waste management facilities or visit **www.recycle.philips.com**.

Full Two-Year Warranty

Philips North America LLC warrants this new product (except shaving heads) against defects in materials or workmanship for a period of two years from the date of purchase, and agrees to repair or replace any defective product without charge.

IMPORTANT: This warranty does not cover damage resulting from accident, misuse or abuse, lack of reasonable care, the affixing of any attachment not provided with the product or loss of parts or subjecting the product to any but the specified voltage or batteries.*

NO RESPONSIBILITY IS ASSUMED FOR ANY SPECIAL, INCIDENTAL OR CONSEQUENTIAL DAMAGES.

In order to obtain warranty service, simply go to **www.philips.com/support**. It is suggested that for your protection you return shipments of product by insured mail, insurance prepaid. Damage occurring during shipment is not covered by this warranty.

NOTE: No other warranty, written or oral, is authorized by Philips North America LLC.

This warranty gives you specific legal rights, and you may also have other rights which vary from state to state. Some states do not allow the exclusion or limitation of incidental or consequential damages, so the above exclusion and limitations may not apply to you.

*Read enclosed instructions carefully.

45-DAY MONEY-BACK GUARANTEE

To enjoy the closest and most comfortable shave from your new Philips Norelco Men's Shaver, the shaver should be used exclusively for 3 weeks. This allows your hair and skin enough time to adapt to the Philips Norelco Shaving System. If, after that period of time, you are not fully satisfied with your Philips Norelco Men's Shaver, send the product back along with dated sales receipt and we'll refund you the full purchase price.

The product must be shipped prepaid by insured mail, insurance prepaid, have the original sales receipt, indicating purchase price and date of purchase, and the money-back guarantee return authorization form enclosed.

We cannot be responsible for lost mail.

The product must be postmarked no later than 45 days after the date of purchase. Philips reserves the right to verify the purchase price of the product and limit refunds not to exceed suggested retail price.

To obtain money-back guarantee service, please go to www.PhilipsMoneyBack.com.

Delivery of refund check will occur 6–8 weeks after receipt of returned product.