

PHILIPS



4K QD MiniLED TV

8600 series

139 cm (55") 4K QD MiniLED TV

Dolby Vision and Dolby Atmos

Google TV™



55PML8669

Big on feeling. Big on detail.

4K QD MiniLED Google TV

Deep blacks. Vibrant colors. From gaming to movies, feel more with this Philips MiniLED TV. You get a picture so lifelike you'll want to reach out and touch it. Add richly atmospheric Dolby Atmos sound.

Smooth motion. True color. Incredible depth.

- MiniLED. Intelligent backlight zones. Incredible contrast
- Cinematic vision and sound. Dolby Vision and Dolby Atmos.
- Ultra-sharp picture. Vibrant viewing.

Ready for the content you love

- Entertainment you love, with a little help from Google.
- AI voice control - Google Assistant
- Loves gaming

Ready for the content you love

- Philips 4K QLED TV with a vibrant HDR picture.

Highlights

MiniLED technology

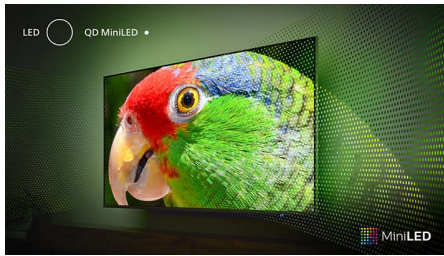

Bolder colours. Crisper whites. Deeper blacks. The Quantum Dot MiniLED technology gives you bright, detailed picture with pin-sharp contrast. You'll see more colours than ever before and compatible with all major HDR formats, so you get more detail in dark and bright areas too.

Google TV™

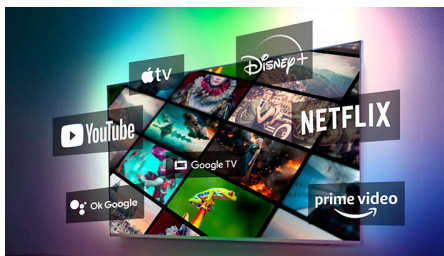

What do you want to watch? Google TV brings together movies, shows, and more from across your apps and subscriptions and organizes them just for you. You'll get suggestions based on what you like, and you can even use the Google TV app on your phone to curate your watchlist on the go.

Google Assistant. Control the TV with your voice.

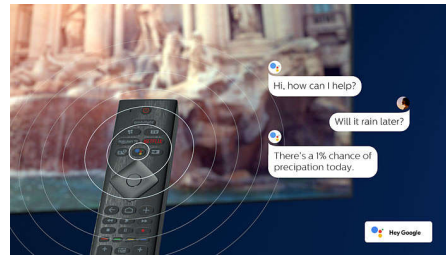

You get a choice of voice assistants! Push the Google Assistant button on your remote and you can use your voice to find movies and shows, get recommendations, control compatible smart home devices.

Ready for gaming. 120Hz, VRR.

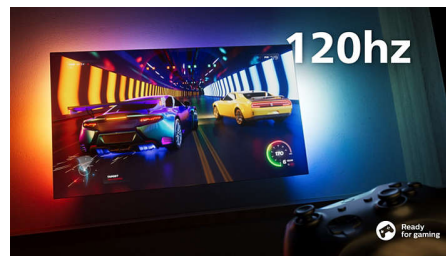

Play without limits and immerse in QLEDs incredible realism! HDMI 2.1, a blazing-fast 120 Hz native refresh rate gets the best out of next-gen gaming gear with fluid, responsive gameplay, super-smooth natural motion, and great-looking graphics.

Ultra-sharp picture



No matter what you watch, this 4K LED TV gives you a bright, ultra-sharp picture with vivid colors. Plus, the TV is compatible with all major HDR formats so you'll see more detail-even in dark and bright areas-when you're streaming HDR content.

Dolby Vision and Dolby Atmos



With Dolby Vision and Dolby Atmos on board, your films, shows and games look and sound incredible. See the picture the director wanted you to see. No more disappointing scenes that are too dark to make out! Hear every word clearly. Experience sound effects like they're really happening around you.

Compatible with HDR formats

Want to experience a perfect picture for every scene? Your Philips 4K QLED TV is compatible with major HDR formats, which means you get brilliant, sharp images. You'll see every detail, even in dark and bright areas.

Specifications

Picture/Display

Aspect ratio: 16:9
Display: 4K UHD MiniLED, 4K Ultra HD QLED
Panel resolution: 3840 x 2160
Picture enhancement: HDR10, HLG (Hybrid Log Gamma), Dolby Vision

Display input resolution

Resolution-Refresh rate: 640 x 480 - 60Hz 576p -50Hz 720p -50/60Hz 1920 x 1080p -24/25/30/50/ 60/100/120Hz 2560 x 1440 - 60/120Hz 3840x2160p - 24/25/30/50/60/100/120Hz

Supported Display Resolution

Computer inputs on all HDMI: HDR supported, HDR10/ HLG
Video inputs on all HDMI: HDR supported, HDR10/HLG (Hybrid Log Gamma)

Tuner/Reception/Transmission

Digital TV: DVB-T/T2
MPEG Support: MPEG2, MPEG4
Teletext: 1000 page Hypertext
HEVC support

Smart TV

OS: Google TV™
Memory size (Flash)*: 32GB

Smart TV Features

SmartTV apps*: Youtube, Amazon Prime Video, Google Search, YouTube Music, Netflix
Ease of Use: One-stop smart menu button
Firmware upgradeable: Online firmware upgrade, Firmware upgradeable via USB, Firmware auto upgrade wizard

Remote Control: with Voice
Voice assistant*: Google Assistant built-in, RC with Mic.

Multimedia Applications

Video Playback Formats: MPEG1, MPEG2, MPEG4, H.264,HEVC/H.265,VP8,VP9,AV1
Music Playback Formats: MPEG1/2 Layer1,MPEG1/2 Layer2,AMR,MPEG1/2 Layer3,AC3,EAC3(DDP),LPCM,AAC, HEAAC
Subtitles Formats Support: .SMI, .SRT, .SUB, .TXT, .ASS, .SSA
Picture Playback Formats: JPEG, GIF, PNG, BMP, HEIF

User Interaction

Remote Control: Voice*
Signal strength indication

Sound

Output power (RMS): 16W
Speaker configuration: 8Wx2
Sound Enhancement: Dolby Atmos

Connectivity

Number of HDMI connections: 3
Number of USBs: 2
Wireless connection: Bluetooth 5.1, Wi-Fi 802 11ac 2x2 Dual band
Other connections: Antenna IEC75, Ethernet-LAN RJ-45, Digital audio out (optical), AV+R/L audio input (Mini), Audio Out (3.5mm)
HDCP 2.2
HDMI eARC: Yes on HDMI1
HDMI 2.1 features: eARC on HDMI 1

Supported HDMI video features

HDR: Dolby Vision, HDR10, HLG

Power

Mains power: AC 100 -240 V 50/60Hz
Ambient temperature: 5 °C to 35 °C
Standby power consumption: <0.5W
Power Saving Features: Auto switch-off timer, Picture mute (for radio), Eco mode

Accessories

Included accessories: 2 x AAA Batteries, Power cord, Quick start guide, Legal and safety brochure, Table top stand, Remote Control, User Manual

Dimensions

Set Width: 1226 mm
Set Height: 719 mm
Set Depth: 83 mm
Product weight: 14 kg
Set width (with stand): 1226 mm
Set height (with stand): 769 mm
Set depth (with stand): 305 mm
Product weight (+stand): 14.6 kg
Box width: 1340 mm
Box height: 812 mm
Box depth: 134 mm
Weight incl. Packaging: 18 kg
Wall mount dimensions: 400 x 200 mm



* EPG and actual visibility (up to 8 days) is country and operator dependent.
* Philips TV does not gaurantee 100% interoperability with all HDMI CEC devices
* Its functionality is subject to ChromeCast built-in apps and smart devises. For more details, please visit ChromeCast built-in product pages.
* Image depicted on the website are non-contractual pictures. Please always refer to the actual TV that are sold in the retail or stores.
* Amazon Prime is available in selected languages and countries.
* Disney+ subscription required. Subject to terms at <https://www.disneyplus.com> (c) 2020 Disney and its related entities. Disney+ is available in selected languages and countries.
* Netflix subscription required. Subject to terms at <https://www.netflix.com>
* Google TV is the name of this device's software experience and a trademark of Google LLC.
* Google TV is the name of this device's software experience and a trademark of Google LLC. YouTube,Ok Google and other marks are trademarks of Google LLC.
* Smart TV app offerings vary per TV model and country. For more details please visit: www.philips.com/smarttv.
* Due to the transmission limitations of Bluetooth wireless technology, a slight sound delay might occur when you hear audio from your bluetooth headphone or bluetooth speakers. When this occur, you might see the character moving his or her mouth but there is a slight delay in spoken dialog accompany
* Philips TV Remote app and related functionalities vary per TV model, operator, and country, as well as smart device model and OS. For more details please visit: www.philips.com/TVRemoteapp.
* Google Assistant is available on Philips Android TVs running on Android O (8) or higher OS version. Google Assistant is available in selected languages and countries.
* Memory size (Flash) : 32GB, the actual available disc space may differ (dependant on e.g. (pre-)installed apps, installed operating system, etc.)
* Images are for illustrative purpose

