

Philips  
Professional LCD TV

22" Pro  
LCD  
integrated digital

22HFL3330D



## Advanced design at outstanding value

### Philips Digital Hospitality LCD TV

With this modern and energy efficient Hospitality TV, you will enjoy the benefits of digital television and be fully prepared for the future. Your guests will enjoy a warm welcome and great viewing experience.

#### Best total cost of ownership

- USB cloning of all settings for quick installation
- Installation menu locking
- VESA mounting compatible

#### Sustainable and safe

- Eco-friendly design and flame-retardant housing

#### Differentiating guest experience

- Volume limitation
- One combined channel list for Analogue and Digital channels
- Easy-to-use Hospitality Remote Control
- PC input lets you also use your TV as a PC monitor

#### Advanced hotel features and future proof

- Switch On Channel Programming
- Welcome message on screen display
- HD Ready with integrated DVB-T tuner

# PHILIPS

# Highlights

## Welcome message

A welcome greeting is displayed each time the TV set is switched on.

## Switch On Channel Programming

Perfect for in-house advertising or information channels as it allows a predefined channel to be shown when the TV is turned on.

## HD Ready with DVB-T tuner

Have guests enjoy the exceptional picture quality of High Definition pictures and be fully prepared for HD sources like HDTV set-top boxes. The TV is able to accept analogue YPbPr signals, as well as the highest quality uncompressed Digital signals via DVI or HDMI. The Digital signals will support HDCP copy protection. With the integrated DVB-T tuner the TV can offer Digital Terrestrial TV channels alongside the existing analogue channels. It also allows guests to listen to digital radio stations in high-quality sound without the extra investment in radio receivers.

## One combined channel list

One integrated channel list for digital and analogue channels. This allows the guest to flick seamlessly between Analogue and Digital channels.

## Hospitality Remote Control

This stylish remote control is especially designed for hospitality usage. For an easy-to-use experience for the guest, the most

important buttons and functions are conveniently placed on the remote. In addition, most Hospitality remote controls come with an anti-theft battery provision, a feature that contributes to efficient hotel operations.

## Volume limitation

This feature predefines the volume range within which the TV set is allowed to operate, preventing excessive volume adjustments and disturbance of neighbouring guests.

## PC input

With PC input you can connect your TV to a computer and use the TV as a PC monitor.

## USB Cloning

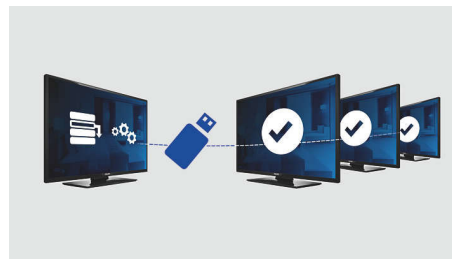

Provides the ability to easily copy all programming and channel programming settings from one TV into other TV sets in less than a minute. The feature ensures uniformity between TV sets and significantly reduces installation time and costs.

## Installation menu locking

Prevents unauthorised access to installation and configuration settings, to ensure maximum guest convenience and avoid unnecessary reprogramming costs.

## VESA mounting

A unified industry standard for wall/ceiling mounting equipment set by the Video Electronics Standards Association. This offers a great flexibility in mounting possibilities and a wide choice of mounting brackets.

## Eco-friendly design

Sustainability is integral to the way Philips does business. Philips TVs are designed and produced according to our EcoDesign principles aimed at minimising overall environmental impact, through lower power consumption, removal of hazardous substances, lower weight, more efficient packaging and better recyclability. Philips TVs also have a special housing of flame-retardant material. Independent tests carried out by emergency fire services have shown that whereas TVs can sometimes intensify fires caused by external sources, Philips TVs will not contribute to a fire.

# Specifications

## Picture/Display

- Aspect ratio: Widescreen
- Diagonal screen size (inch): 22 inch
- Diagonal screen size (metric): 56 cm
- Panel resolution: 1680 x 1050p
- Brightness: 300 cd/m<sup>2</sup>
- Picture enhancement: 3/2 - 2/2 motion pull down, Progressive scan, Crystal Clear III, Smart Picture, White stretch, 2D Combfilter
- Contrast ratio (typical): 1000:1
- Display screen type: LCD WSXGA Active Matrix TFT
- Response time (typical): 5 ms
- Viewing angle: 170° (H)/160° (V)
- Screen enhancement: Anti-Reflection coated screen

## Supported Display Resolution

- Computer formats: 640 x 480, 60 Hz, 800 x 600, 60 Hz, 1024 x 768, 60 Hz
- Video formats: 480i, 60 Hz, 480p, 60 Hz, 576i, 50 Hz, 576p, 50 Hz, 720p, 50, 60 Hz, 1080i, 50, 60 Hz

## Tuner/Reception/Transmission

- Aerial Input: 75 ohm coaxial (IEC75)
- Tuner bands: Hyperband, S-Channel, UHF, VHF
- TV system: PAL I, PAL B/G, PAL D/K, SECAM B/G, SECAM D/K, SECAM L/L'
- Digital TV: DVB Terrestrial\*, MHEG
- Number of Pre-set Channels: 1000
- Video Playback: PAL, SECAM, NTSC

## Convenience

- Ease of Installation: PLL Digital Tuning, Fine Tuning, Automatic Channel Install (ACI), Automatic Tuning System (ATS), Programme Name, Auto Programme Naming, Autostore, Keyboard lock-out, Security menu access, Installation menu locking, Advanced Hotel Mode, Cloning of TV settings via USB, Plug and Play
- Ease of Use: Auto Volume Leveller (AVL), On-Screen Display, Programme List, 1 channel list analogue/digital, Side Control
- Clock: Sleep Timer
- Comfort: Hotel Guest features, Switch on channel, Welcome message, Volume limitation, Sleep timer
- Screen Format Adjustments: 4:3, Movie expand 14:9, Movie expand 16:9, Super Zoom, Subtitle Zoom, Widescreen
- Electronic Programme Guide: 8-day Electronic Programme Guide, Now + Next EPG
- Remote Control: battery anti-theft protection, low battery detection
- Remote control type: 22AV1104 (RC6)
- Teletext: 100-page Smart Text
- Firmware upgradeable: Firmware upgradeable via

- USB
- Picture in Picture: Text dual screen

## Healthcare

- Safety: Earthed power cord
- Convenience: Headphone out

## Sound

- Output power (RMS): 2 x 3 W
- Sound System: Stereo, Mono
- Sound Enhancement: Auto Volume Leveller, Incredible Surround, Smart Sound

## Loudspeakers

- Built-in speakers: 2

## Connectivity

- EasyLink (HDMI-CEC): One touch play, System standby
- Front/Side connections: Audio L/R in, CVBS in, HDMI v1.3
- Ext 1 Scart: Audio L/R, CVBS in/out, RGB
- HDMI 1: HDMI v1.3
- Other connections: Common Interface, Headphone out, PC Audio in, PC-In VGA, Digital audio coaxial out
- Ext 3: Audio L/R in, YPbPr

## Power

- Mains power: 100-240 V, 50/60 Hz
- Ambient temperature: 5°C to 35°C
- Power consumption: 55 W
- Standby power consumption: <0.3 W

## Green Specifications

- Safety: Flame-retardant housing

## Accessories

- Included accessories: Power cord, Tabletop tilt stand, Remote Control, Batteries for remote control, Warranty Leaflet
- Optional accessories: Set up Remote RC2573GR

## Dimensions

- Set Width: 534 mm
- Set Height: 397 mm
- Set Depth: 71 mm
- Product weight: 5.5 kg
- Set width (with stand): 534 mm
- Set height (with stand): 442 mm
- Set depth (with stand): 181 mm
- Product weight (+stand): 6 kg
- Box width: 580 mm
- Box height: 510 mm
- Box depth: 137 mm
- Weight incl. Packaging: 7.77 kg
- Wall-mount compatible: 100 x 100 mm



Issue date 2024-03-24

Version: 5.0.4

EAN: 87 12581 43381 9

© 2024 Koninklijke Philips N.V.  
All Rights reserved.

Specifications are subject to change without notice.  
Trademarks are the property of Koninklijke Philips N.V.  
or their respective owners.

[www.philips.com](http://www.philips.com)

\* For information on DVB-T enrolled countries, please ask your Philips contact.