



Philips  
Professional LCD TV

22" System  
LCD  
integrated digital



22HFL5550D

## For delighted guests

### Philips Digital Interactive Hospitality TV

This modern and energy efficient Hospitality TV is fully prepared for interactivity. Your guests can connect their own devices, enjoy music in the bathroom and have a personalised welcome message.

#### Best total cost of ownership

- USB cloning of all settings for quick installation
- External loudspeaker connector

#### System ready and future-proof

- SmartCard Xpress Box compatible for interactive systems
- Remote software upgrading
- HD Ready with integrated DVB-T tuner

#### Sustainable and safe

- SmartPower for energy saving
- Eco-friendly design and flame-retardant housing

#### Differentiating guest experience

- Integrated clock display with wake-up and message alarm
- USB Connector for easy, instant multimedia playing
- Philips Connectivity Panel compatible to enjoy guest devices
- PC input lets you also use your TV as a PC monitor

# PHILIPS

# Highlights

## SmartCard Xpress Box

The optional SmartCard Xpress Box can be mounted at the back of the TV set and allows third-party decoders and application cards to interface with the TV, adding new functionality to the TV. The TV can also be connected to external decoders and set-top boxes of all major interactive system providers through the Serial Xpress Control Interface (supporting UART and RS232 protocols) and the SmartPlug Control interface.

## USB Cloning

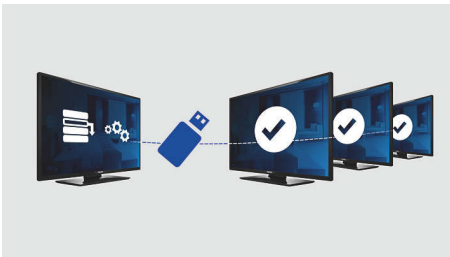

Provides the ability to easily copy all programming and channel programming settings from one TV into other TV sets in less than a minute. The feature ensures uniformity between TV sets and significantly reduces installation time and costs.

## Remote software upgrading

The TV software that controls hotel-specific features can be upgraded remotely through a certified system provider.

## Integrated clock display

The built-in clock display, which is also a wake-up alarm, eliminates the need to invest in an

additional clock with cables and connections in the room.

## HD Ready with DVB-T tuner

Have guests enjoy the exceptional picture quality of High Definition pictures and be fully prepared for HD sources like HDTV set-top boxes. The TV is able to accept analogue YPbPr signals, as well as the highest quality uncompressed Digital signals via DVI or HDMI. The Digital signals will support HDCP copy protection. With the integrated DVB-T tuner the TV can offer Digital Terrestrial TV channels alongside the existing analogue channels. It also allows guests to listen to digital radio stations in high-quality sound without the extra investment in radio receivers.

## USB multimedia playing

This Philips TV allows the guest to connect a USB stick for easy and instant playing of multimedia content. Playback formats supported are MP3, Slideshow files (.alb) and JPEG Still pictures.

## PC input

With PC input you can connect your TV to a computer and use the TV as a PC monitor.

## External loudspeaker connector

Amplified audio connector for easy installation of external speakers (for bathrooms, for example), eliminating the need for investments in external equipment

## Connectivity Panel compatible

This TV works seamlessly with Philips Connectivity Panels. The guest can easily connect and enjoy media from a PC, MP3 player, DVD player, camcorder and various other devices. With autosensing, the Connectivity Panel and the TV will automatically switch to display the content from the connected guest device.

## SmartPower



The backlight intensity can be controlled and pre-set by the system to reduce the power consumption by up to 50%, which saves substantially on energy costs.

## Eco-friendly design

Sustainability is integral to the way Philips does business. Philips TVs are designed and produced according to our EcoDesign principles aimed at minimising overall environmental impact, through lower power consumption, removal of hazardous substances, lower weight, more efficient packaging and better recyclability. Philips TVs also have a special housing of flame-retardant material. Independent tests carried out by emergency fire services have shown that whereas TVs can sometimes intensify fires caused by external sources, Philips TVs will not contribute to a fire.

# Specifications

## Picture/Display

- Aspect ratio: Widescreen
- Diagonal screen size (inch): 22 inch
- Diagonal screen size (metric): 56 cm
- Panel resolution: 1680 x 1050p
- Brightness: 300 cd/m<sup>2</sup>
- Picture enhancement: 3/2 - 2/2 motion pull down, 3D Combfilter, Active Control, Black stretch, Blue stretch, Colour Enhancement, Colour Transient

- Improvement, Digital Noise Reduction, Luminance Transient Improver, Motion adaptive de-interlacing, Progressive scan, Automatic skin tone correction, Dynamic contrast enhancement, White stretch, Green stretch, Pixel Plus HD
- Contrast ratio (typical): 1000:1
- Display screen type: LCD WXGA Active Matrix TFT
- Dynamic screen contrast: 30000:1

- Response time (typical): 5 ms
- Viewing angle (horizontal): 170 degree
- Viewing angle (vertical): 160 degree
- Screen enhancement: Anti-Reflection coated screen

## Supported Display Resolution

- Computer formats: 640 x 480, 60 Hz, 800 x 600,

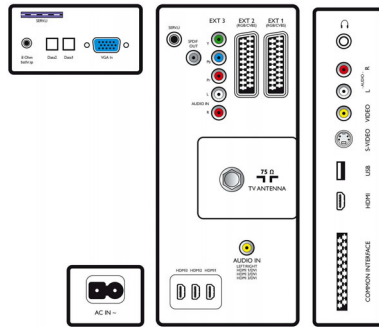

# Specifications

- 60 Hz, 1024 x 768, 60 Hz, 1280 x 1024, 60 Hz
- Video formats: 480i, 60 Hz, 480p, 60 Hz, 576i, 50 Hz, 576p, 50 Hz, 1080i, 50, 60 Hz, 720p, 50, 60 Hz

## Tuner/Reception/Transmission

- Aerial Input: 75 ohm coaxial (IEC75)
- Tuner bands: Hyperband, S-Channel, UHF, VHF
- TV system: PAL I, PAL B/G, PAL D/K, SECAM B/G, SECAM D/K, SECAM L/L', DVB COFDM 2K/8K
- Digital TV: DVB Terrestrial\*
- Number of Pre-set Channels: 250
- Video Playback: PAL, SECAM, NTSC
- Tuner Display: PLL

## Multimedia Applications

- Multimedia connections: USB
- Playback Formats: MP3, JPEG Still pictures, Slideshow files (.alb)

## Convenience

- Ease of Installation: Advanced Hotel Mode, Fine Tuning, PLL Digital Tuning, Programme Name, Cloning of TV settings via USB, Installation menu locking, Security menu access, Keyboard lock-out
- Ease of Use: Auto Volume Leveller (AVL), 1 channel list analogue/digital, Smart Picture, Smart Sound
- Clock: Integrated LCD Clock Display, Sleep Timer, Wake-up Clock
- Clock Enhancements: Synchro Time via TXT/DVB
- Comfort: Hotel Guest features, Auto power on, Welcome message, Message indicator, Switch on channel, Volume limitation, Fast start-up
- Screen Format Adjustments: 4:3, Full screen, Movie expand 14:9, Movie expand 16:9, Widescreen, Subtitle Zoom, Super Zoom, Auto Format
- Electronic Programme Guide: Now + Next EPG
- Interactive hotel features: Connectivity panel compatible
- Prison mode: Teletext and MHEG disable
- Teletext: 1000-page Smart Text
- Other convenience: Kensington lock
- Firmware upgradeable: Local upgrade total TV softw., Remote upgrade hotel TV softw, Firmware upgradeable via USB
- Teletext languages: Western European, Eastern European, Cyrillic

## Healthcare

- Control: Multi remote control
- Safety: Double isolation Class II
- Convenience: Headphone out, Independent main speaker mute

## Sound

- Equalizer: 5-bands
- Output power (RMS): 2 x 5 W
- Sound System: Mono, Stereo, Nicam Stereo, BBE,

- Dolby Digital (AC-3), Virtual Dolby Digital
- Sound Enhancement: Auto Volume Leveller, Incredible Surround, Smart Sound

## Loudspeakers

- Built-in speakers: 2

## Connectivity

- Connectivity Enhancements: Serial Xpress interface, SmartPlug Xpress Interface, RJ12 connector, RJ45 connector, SmartCard Xpress box ready, Fast Infrared loop through, HM-Link, External Loudspeaker connector, Power on scart, USB2.0
- Number of Scarts: 2
- Front/Side connections: Audio L/R in, CVBS in, S-video in, USB 2.0, HDMI v1.3
- Ext 1 Scart: Audio L/R, CVBS in/out, RGB
- Ext 2 Scart: Audio L/R, CVBS in/out
- Other connections: Analogue audio Left/Right out, S/PDIF out (coaxial), Headphone out, PC-In VGA, Common Interface
- Ext 3: Audio L/R in, YPbPr
- Ext 4: HDMI v1.3
- Ext 5: HDMI v1.3
- Ext 6: HDMI v1.3

## Power

- Mains power: 220-240 V, 50/60 Hz
- Ambient temperature: 5°C to 35°C
- Power consumption: 55 W
- Standby power consumption: <math>\leq 2</math> W (w. clock)
- Active stand-by consumption: 20 W
- Passive stand-by consumption: 1.2 W

## Green Specifications

- Safety: Flame-retardant housing
- SmartPower

## Accessories

- Included accessories: Power cord, Tabletop swivel stand, Warranty Leaflet
- Optional accessories: Set up Remote RC2573GR, Guest remote control 22AV1105, Wall mount (tilt) 22AV3100/10, Smart-card XP Box SBB103U/10, XP Box Power Supply SBP103A

## Dimensions

- Set Width: 534 mm
- Set Height: 397 mm
- Set Depth: 92 mm
- Product weight: 6 kg
- Set width (with stand): 534 mm
- Set height (with stand): 442 mm
- Set depth (with stand): 181 mm
- Product weight (+stand): 6.5 kg
- Box width: 580 mm
- Box height: 510 mm
- Box depth: 137 mm
- Weight incl. Packaging: 7.77 kg
- Wall-mount compatible: 100 x 100 mm



Issue date 2024-03-24

Version: 3.2.12

EAN: 87 12581 43716 9

© 2024 Koninklijke Philips N.V.  
All Rights reserved.

Specifications are subject to change without notice.  
Trademarks are the property of Koninklijke Philips N.V.  
or their respective owners.

[www.philips.com](http://www.philips.com)



\* For information on DVB-T enrolled countries, please ask your Philips contact.