

PHILIPS

4K UHD monitor

Monitor

5000 series

27" (68.6 cm)

3840 x 2160 (4K UHD)

27E1N5800E



Striking design, vibrant colors

Elevate your viewing experience for work and play. UltraClear 4K IPS display delivers accurate color and image reproduction from any angle. Ergonomic slim-frame monitor with cable management offers a stylish enhancement to your workspace.

Features designed for you

- EasySelect menu toggle key for quick on-screen menu access
- EasyRead mode for a paper-like reading experience
- MultiView enables simultaneous dual connection and view
- Cable management reduces cable clutter for neat workspace
- LowBlue mode and Flicker-free easy-on-the eyes viewing
- Tilt, pivot and height-adjust for an ideal viewing position

Good for Gaming

- SmartImage game mode optimized for gamers

Superb Picture Quality

- SmartContrast for rich black details
- IPS LED wide view technology for image and color accuracy
- UltraClear 4K UHD (3840x2160) resolution for precision
- 1.07 billion colors for stunning color and finest gradations

Monitor

4K UHD monitor

27E1N5800E/75

Highlights

UltraClear 4K UHD Resolution

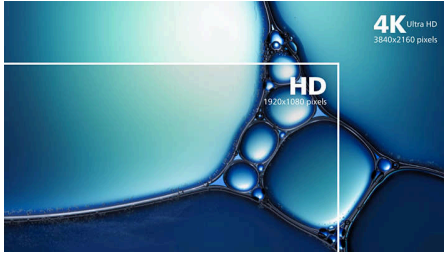

These Philips displays utilize high performance panels to deliver UltraClear, 4K UHD (3840 x 2160) resolution images. Whether you are demanding professional requiring extremely detailed images for CAD solutions, using 3D graphics applications or a financial wizard working on huge spreadsheets, Philips displays will make your images and graphics come alive.

IPS technology

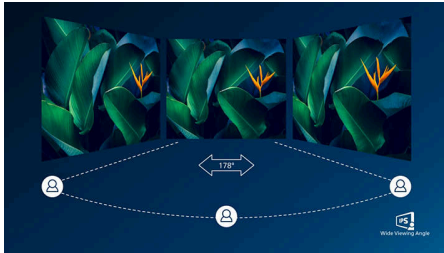

IPS displays use an advanced technology which gives you extra wide viewing angles of 178/178 degree, making it possible to view the display from almost any angle. Unlike standard TN panels, IPS displays gives you remarkably crisp images with vivid colors, making it ideal not only for Photos, movies and web browsing, but also for professional applications which demand color accuracy and consistent brightness at all times.

SmartImage Game mode

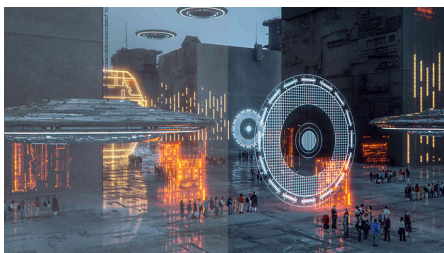

The new Philips gaming display has quick access OSD fine tuned for gamers, offering you multiple options. "FPS" mode (First person shooting)

improves dark themes in games, allowing you to see hidden objects in dark areas. "Racing" mode adapts display with fastest response time, high color, along with image adjustments. "RTS" mode (Real time strategy) has a special SmartFrame mode which enables highlighting of specific area and allows for size and image adjustments. Gamer 1 and Gamer 2 enable you to save personal customized settings based on different games, ensuring best performance.

LowBlue Mode & Flicker-free



Our LowBlue Mode and Flicker-free technology have been developed to reduce eye strain and fatigue often caused by long hours in front of a monitor.

EasyRead mode

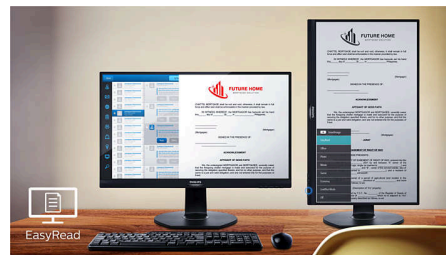

EasyRead mode for a paper-like reading experience

MultiView technology

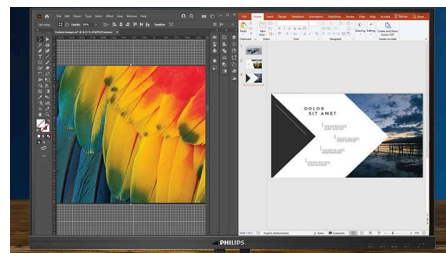

With the ultra-high resolution Philips MultiView display you can now experience a world of connectivity. MultiView enables active dual

connect and view so that you can work with multiple devices like a PC and notebook simultaneously, for complex multi-tasking.

Compact Ergo Base

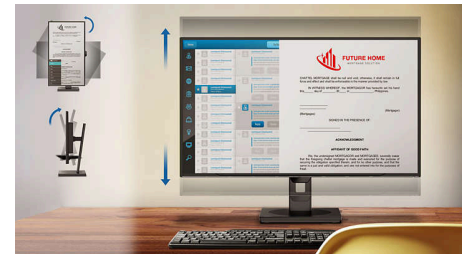

The Compact Ergo Base is a people-friendly Philips monitor base that tilts, pivot and height-adjusts so each user can position the monitor for maximum viewing comfort and efficiency.

Cable management



Cable management is an intimate design that maintains tidy workspace by organizing cables and wires required for the operation of a display device.

4K
Ultra HD

IPS
Wide Viewing Angle

SmartImage™
Game

LowBlue Mode

EasyRead

Multiview

CompactErgo
Base

EasySelect

Monitor

4K UHD monitor

27E1N5800E/75

Highlights

EasySelect Menu Toggle Key



The discreetly placed EasySelect Menu Toggle Key allows you to make quick and easy adjustments to monitor settings in the On-Screen Display menu.

SmartContrast



SmartContrast is a Philips technology that analyzes the contents you are displaying, automatically adjusting colors and controlling backlight intensity to dynamically enhance contrast for the best digital images and videos or when playing games where dark hues are displayed. When Economy mode is selected, contrast is adjusted and backlighting fine-tuned for just-right display of everyday office applications and lower power consumption.

1.07 billion colors

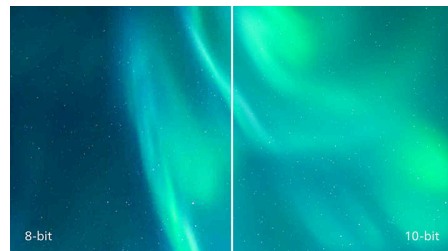

This display delivers outstanding color depth with 1.07 billion colors, and the finest gradation, for re-creating smooth, precise, and vivid image. Enjoy accurate and true-to-life visuals whether gaming, watching videos, or working on color critical work with graphics applications.

4K
Ultra HD

IPS
Wide Viewing Angle

SmartImage™
Game

LowBlue Mode

EasyRead

Multiview

Monitor

4K UHD monitor

27E1N5800E/75

Specifications

Picture/Display

Panel Size: 27 inch / 68.6 cm
Aspect ratio: 16:9
LCD panel type: IPS technology
Backlight type: W-LED system
Pixel pitch: 0.1554 x 0.1554 mm
Brightness: 350 cd/m²
Display colors: Color support 1.07 billion colors
Color gamut (typical): NTSC 106.4%*, sRGB 125.7%*
Contrast ratio (typical): 1000:1
SmartContrast: Mega Infinity DCR
Response time (typical): 4 ms (Gray to Gray)*
Viewing angle: 178° (H) / 178° (V), @ C/R > 10
Picture enhancement: SmartImage game
Maximum resolution: 3840 x 2160 @ 60 Hz*
Effective viewing area: 596.736 (H) x 335.664 (V)
Scanning Frequency: 30 - 114 kHz (H) / 48 - 75 Hz (V)
sRGB
Delta E: < 2 (sRGB)
Flicker-free
Pixel Density: 163.18 PPI
LowBlue Mode
Display Screen Coating: Anti-Glare, 3H, Haze 25%
SmartUniformity: 97 ~ 102%
EasyRead

Connectivity

Signal Input: HDMI 2.0 x 2, DisplayPort 1.2 x 1
Sync Input: Separate Sync
Audio (In/Out): Audio out

Convenience

Plug & Play Compatibility: DDC/CI, Mac OS X, sRGB, Windows 10 / 8.1 / 8 / 7
User convenience: Power On/Off, Menu, Brightness, Input, SmartImage Game
OSD Languages: Brazil Portuguese, Czech, Dutch, English, Finnish, French, German, Greek, Hungarian, Italian, Japanese, Korean, Polish, Portuguese, Russian, Simplified Chinese, Spanish, Swedish, Traditional Chinese, Turkish, Ukrainian
Other convenience: Kensington lock, VESA mount (100x100mm)
MultiView: PIP/PBP mode, 2x devices

Stand

Height adjustment: 130 mm
Pivot: -/+ 90 degree
Tilt: -5/20 degree

Power

Power supply: Internal, 100-240VAC, 50-60Hz
Off mode: 0.3 W (typ.)
On mode: 37 W (typ.)
Standby mode: 0.5 W (typ.)
Power LED indicator: Operation - White, Standby mode- White (blinking)

Dimensions

Packaging in mm (WxHxD): 780 x 525 x 186 mm
Product without stand (mm): 613 x 365 x 53 mm
Product with stand(max height): 613 x 510 x 212 mm

Weight

Product with packaging (kg): 10.38 kg
Product with stand (kg): 6.30 kg
Product without stand (kg): 4.40 kg

Operating conditions

Altitude: Operation: +12,000ft (3,658m), Non-operation: +40,000ft (12,192m)
Temperature range (operation): 0 to 40 °C
MTBF: 50,000 hrs (excluding backlight) hour(s)
Relative humidity: 20%-80 %
Temperature range (storage): -20 to 60 °C

Sustainability

Environmental and energy: RoHS, Mercury Free
Recyclable packaging material: 100 %

Compliance and standards

Regulatory Approvals: CB, CE Mark, FCC Class B, ICES-003, KC, KCC

Cabinet

Color: Black
Finish: Textured



* "IPS" word mark / trademark and related patents on technologies belong to their respective owners.

* The maximum resolution works for either HDMI input or DP input.

* For best output performance, please always ensure that your graphic card is capable of achieving the maximum resolution and refresh rate of this Philips display.

* Response time value equal to SmartResponse

* NTSC Area based on CIE1976

* sRGB Area based on CIE1931

* The monitor may look different from feature images.