

Philips 6500 series  
Philips Smart LED TV

**HD LED TV**  
80 cm (32") Smart TV  
Google TV™.



**32PHD6509**

## Fits anywhere. Fine-looking it is.

### Smart LED TV

Looking for the best TV for a smaller apartment or room? This Philips TV looks great wherever you place it. The picture is sharp, the sound is clear, and that's simply smart, Philips GoogleTV.

**Philips picture precision and clear sound.**

- Lively viewing. Philips HD LED TV.

**Google TV-content at your command**

- Great TV. No fuss. Google TV smart platform

**Google TV-content at your command**

- Google Assistant. Control the TV with your voice.
- Google Play store. More to love.

**Philips picture precision and clear sound.**

- Dolby audio for a true life audio experience

# PHILIPS

Philips Smart LED TV  
HD LED TV 80 cm (32") Smart TV, Google TV™.

32PHD6509/71

# Highlights

## Google TV™



Philips Google TV delivers the content you want, when you want it. You can customize your home screen to display your favorite apps, making it easy to stream the movies and shows you love. Or pick up where you left off.

## Google Assistant

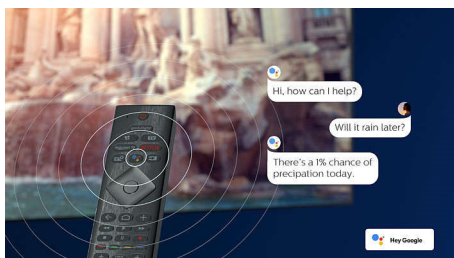

Control your Philips Google TV with your voice. Want to play a game, watch Netflix, or

find content and apps in the Google Play store? Just tell your TV. You can even command all Google Assistant-compatible smart home devices-like dimming the lights and setting the thermostat on movie night. Without leaving the sofa.

## TV content

Go beyond traditional TV programming with Google Play Store . Experience endless movies, TV, music, apps and games online. More to love.

## LED TV



Delight in everything you watch with a Philips HD LED TV. The TV's processing engine optimizes picture quality to deliver sharp

images, rich colors, and smooth motion. You get lively viewing experience every time.

## Dolby Audio



Dolby Audio technology works intelligently to optimize audio for the TV equipment , you can experience better audio quality from all the content you enjoy, whether it's a broadcast, a stream or download. Enhances better sound for movies, music, and broadcast programs.

# Specifications

## Picture/Display

- Aspect ratio: 16:9
- Display: LED HD TV
- Panel resolution: 1366 x 768
- Picture enhancement: HDR10, HLG (Hybrid Log Gamma), Game, Movie, Natural, Standard, Vivid, Sport

## Tuner/Reception/Transmission

- Digital TV: ISDB-T
- MPEG Support: MPEG2, MPEG4
- HEVC support

## Smart TV

- OS: Google TV™

## Smart TV Features

- SmartTV apps\*: Youtube, Amazon Prime Video, Google Search, YouTube Music, Netflix
- Ease of Use: One-stop smart menu button, Onscreen usermanual
- Firmware upgradeable: Online firmware upgrade, Firmware auto upgrade wizard
- Screen Format Adjustments
- Remote Control: with Voice
- Voice assistant\*: Google Assistant built-in, RC with Mic.

## Multimedia Applications

- Video Playback Formats: MPEG-1, MPEG-2, MPEG-4, HEVC, AV1, HEVC (H.265), VP9, H.264
- Music Playback Formats: MPEG1/2 Layer 1/2/3, AC3, HE-AAC, FLAC
- Subtitles Formats Support: .SML, .SUB, .TXT, .ASS, .SSA, .SRT
- Picture Playback Formats: JPEG, GIF, PNG, BMP

## User Interaction

- Remote Control: Voice\*

## Sound

- Output power (RMS): 12W
- Speaker configuration: 6Wx2 speaker

## Connectivity

- Number of HDMI connections: 2
- EasyLink (HDMI-CEC): One touch play, Remote control pass-through, System audio control, System standby
- Number of USBs: 2
- Wireless connection: Bluetooth 5.0, Wi-Fi 802.11ac, 2x2, Dual band
- Other connections: Headphone out, Antenna F-type, Digital audio out (optical), Ethernet-LAN RJ-45, AV+R/L audio input (Mini)
- HEVC support
- HDMI eARC: HDMI1

## Supported HDMI video features

- HDR: HDR10, HLG

## Power

- Mains power: AC 100 -240 V 50/60Hz
- Ambient temperature: 5 °C to 35 °C
- Standby power consumption: <0.5W
- Power Saving Features: Auto switch-off timer, Picture mute (for radio)

## Accessories

- Included accessories: 2 x AAA Batteries, Power cord, Quick start guide, Legal and safety brochure, Table top stand, Remote Control, User Manual

## Dimensions

- Set Width: 717 mm
- Set Height: 435 mm
- Set Depth: 82 mm
- Product weight: 3.9 kg
- Set width (with stand): 717 mm
- Set height (with stand): 476 mm
- Set depth (with stand): 223 mm
- Product weight (+stand): 4 kg
- Box width: 778 mm
- Box height: 468 mm
- Box depth: 109 mm
- Weight incl. Packaging: 5 kg
- Wall mount compatible: 200 x 200 mm
- Wall mount dimensions: 200 x 200 mm

## Connections

### Side



- \* EPG and actual visibility (up to 8 days) is country and operator dependent.
- \* Philips TV Remote app and related functionalities vary per TV model, operator, and country, as well as smart device model and OS. For more details please visit: [www.philips.com/TVRemoteapp](http://www.philips.com/TVRemoteapp).
- \* Smart TV app offerings vary per TV model and country. For more details please visit: [www.philips.com/smarttv](http://www.philips.com/smarttv).
- \* Philips TV does not guarantee 100% interoperability with all HDMI CEC devices
- \* Its functionality is subject to ChromeCast built-in apps and smart devices. For more details, please visit ChromeCast built-in product pages.
- \* Amazon Prime is available in selected languages and countries.
- \* Disney+ subscription required. Subject to terms at <https://www.disneyplus.com> (c) 2020 Disney and its related entities. Disney+ is available in selected languages and countries.
- \* Netflix subscription required. Subject to terms at <https://www.netflix.com>
- \* Image depicted on the website are non-contractual pictures. Please always refer to the actual TV that are sold in the retail or stores.
- \* Google TV is the name of this device's software experience and a trademark of Google LLC.
- \* Google TV is the name of this device's software experience and a trademark of Google LLC. YouTube, Ok Google and other marks are trademarks of Google LLC.



Issue date 2024-04-29

Version: 5.5.1

EAN: 87 18863 04401 8

© 2024 Koninklijke Philips N.V.  
All Rights reserved.

Specifications are subject to change without notice.  
Trademarks are the property of Koninklijke Philips N.V. or their respective owners.

[www.philips.com](http://www.philips.com)