

Set event time and date

Note

- Ensure that you set the current time and date of the PhotoFrame before you set time and date for all events reminder.
- In the main menu, select [Setup] and then press OK to confirm.
 - Select [Event Reminder], and then press OK to confirm.
 - Select [Set time] / [Set date], and then press OK to confirm.
 - Select [Set time] / [Set date], and then press OK to confirm.
 - Press **▲▼** and OK to set the time/date, and then press OK to confirm.

Tip

- When the reminder alerts, you can press any button once to stop the reminder. If you want to stop the function, press the same button twice.

Set on/off a reminder

- In the main menu, select [Setup] and then press OK to confirm, and then press **▲▼** and then press OK to confirm.
- Select a reminder, and then press OK to confirm.
- Select [Set], and then press OK to confirm.
- Select [On] to set the reminder on, and then press OK to confirm.
- To set the reminder off, select [Off] and then press OK to confirm.

Tip

- Weekday: Monday 00:00 to Friday 23:59
- Weekend: Saturday 00:00 to Sunday 23:59
- Any time that is not listed here can press any control button to a correct it.

Set display auto on/off by time

You can configure the time for the PhotoFrame to turn on or off the display automatically.

Note

- Ensure that you set the current time and date of the PhotoFrame before you set the auto on/off function.
- In the main menu, select [Setup] and then press OK to confirm.
 - Select [Event Reminder], and then press OK to confirm.
 - Select [Smart power], and then press OK to confirm.
 - Select [Set time] / [Set date], and then press OK to confirm.
 - Select [Weekday] / [Weekend], and then press OK to confirm.

Tip

- When the reminder alerts, you can press any button once to stop the reminder. If you want to stop the function, press the same button twice.

Frequently asked questions

Is the LCD screen touch-enabled?

The LCD screen is not touch-enabled. You can touch the screen on the back to control the PhotoFrame.

Will the LCD be damaged if I keep showing the same photo for a long time?
No. The PhotoFrame will rotate the same photo continuously for 72 hours without any damage to the LCD screen.

Why does my PhotoFrame not show photos?

The PhotoFrame supports only JPEG photos. Ensure that these JPEG photos are not damaged.

Why does the PhotoFrame not go into auto-off status after I set it?

Ensure that you set the current time, auto-off time, and auto-on time correctly. The PhotoFrame automatically turns off the display when the auto-off time if the time has already passed for the day. It starts to enter auto-off status at the specified time from the next day.



© Royal Philips Electronics NV 2009

All rights reserved.

Specifications are subject to change without notice. Trademarks are the property of Koninklijke Philips Electronics NV or their respective owners.

QSG_V110

Printed in China



100% recycled paper
100% paper recyclable

PhotoFrame

SFP72017
SFP72027



Quick start guide

- 1 Get started
- 2 Play
- 3 Setup

What's in the box

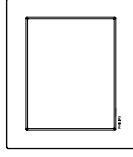

PhotoFrame



Stand



AC-DC power adaptor



CD-ROM (Digital User Manual)



Quick Start Guide

PHILIPS
ENG

Register your product and get support at
www.philips.com/welcome

Overview of your PhotoFrame

1 Get started

Install the stand
To place the PhotoFrame on a flat surface, attach the supplied stand to the back of the PhotoFrame.



- 1 Turn on/off the PhotoFrame
- 2 Play slideshow
• Toggle between slideshow mode, browse mode, and calendar mode
- 3 Select the previous/next/right/left option
- 4 Confirm a selection
- 5 Enter the main menu
• Enter/Exit photo menu
- 6 Slot for a USB flash drive
- 7 Kensington lock
- 8 Slot for a USB cable to PC
- 9 SD/MMC/AD/MS/MS Pro (SD/TF/HC/AD/MS/MS Pro) card
- 10 DC socket for the AC-DC power adapter
- 11 Stand hole
- 12 Wall mounting hole

Connect power

Note
• When you position the PhotoFrame, ensure that the power Plug and outlet are easily accessible.

- 1 Connect the power cord to the DC socket of the PhotoFrame.



Turn on the PhotoFrame

Note
• You can only turn off the PhotoFrame after all copy and save actions are complete.

→ Photos are displayed in slideshow

- To turn off the PhotoFrame, press and hold **○**.

Connect a storage device

Caution

- Do not remove a storage device from the PhotoFrame as contents are being transferred to the storage device.

You can play JPEG photos in one of the following storage devices which is connected to the PhotoFrame:

- Secure Digital (SD/HC)
 - MultiMedia Card
 - AD card
 - Stick
 - Memory Stick Pro (with adapter)
 - USB memory drive
- However, we do not guarantee the operation for all types of memory card media.

- 1 Insert a storage device firmly.



Photos in the storage device are displayed in slideshow mode.

- To remove a storage device, pull it out from the PhotoFrame.

For the first time use:

- 1 Press and hold **○** for more than 1 second.
- The language setting menu is displayed.

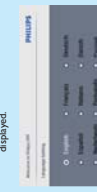

- 2 Select a language, and press **OK** to confirm.
- Help message for control keys is displayed.

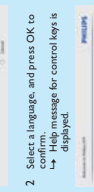

- 3 Press any button to exit the help message.
- Photos are displayed in slideshow mode.



For other times:

- 1 Press and hold **○** for more than 1 second.
- Help message for control keys is displayed.
- 2 Press any button to exit the help message.

2 Play

Display photos

Note
• You can play only JPEG photos on the PhotoFrame.

- 1 In the main menu, select [Photo] and then press **OK** to confirm.



Display collage photos

- 1 In slideshow mode, the PhotoFrame displays all photos automatically.
- In browse mode, the PhotoFrame can press **◀▶** to display the next/previous photo.
- In slideshow mode, the PhotoFrame displays photos with the calendar.

→ Available photo sources are displayed.

- 2 Select a photo source, and then press **OK** to confirm.



- 3 Select [Multi], and then press **OK** to confirm.
- 4 Select a layout.

- 5 Press **◀** (Left) to select [Photo 1].
- 6 Press **▶** (Right) again to access the photo source options.
- 7 Select a photo from a photo source.

8 Repeat steps 5 to 7 until all photos are selected for the format.

- 9 Press **○** to start collage display.
- In slideshow mode, press **○** to toggle between slideshow, browse, calendar mode.

Tip

- If you select a collage layout, the PhotoFrame displays a static collage. In the slideshow mode is deactivated.
- If you select [Random] format, the PhotoFrame displays a random collage based on the optimal layout of photos and displays the collage in slideshow mode.

3 Setup

Select on-screen language

- 1 In the main menu, select [Setup] and then press **OK** to confirm.
- 2 Select [Language], and then press **OK** to confirm.

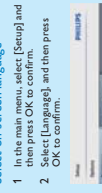

- 3 Select [Language Setting], and then press **OK** to confirm.
- 4 Select a language, and then press **OK** to confirm.

→ If you select [BudgetColor], the PhotoFrame extends the color on the edges of a photo that is displayed. However, there is no black bar or aspect ratio distortion.

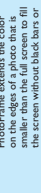

Tip

- Ensure that you set the current time and date of the PhotoFrame before you set an event reminder.

Create an event reminder

- 1 In the main menu, select [Setup] and then press **OK** to confirm.
- 2 Select [Event Reminder], and then press **OK** to confirm.



Set time and date

- 1 In the main menu, select [Setup] and then press **OK** to confirm.
- 2 Select [Time and Date], and then press **OK** to confirm.
- 3 Select [Time] / [Set time], and then press **OK** to confirm.
- 4 Press **▲▼** and **OK** to enter the current time/date, and then press **OK** to confirm.



- 3 Select [New reminder], and then press **OK** to confirm.
- A keypad is displayed.
- 4 To enter the new name (up to 24 characters), select an upper/lower character and then press **OK** to confirm.
- To switch between uppercase and lowercase characters, select the displayed keypad and then press **OK** to confirm.
- 5 When the name is complete, select [Enter] and then press **OK** to confirm.

