

Register your product and get support at  
[www.philips.com/welcome](http://www.philips.com/welcome)

**Immersive**  
5000 series



# Quick start guide

**PHILIPS**



**EN** Before using your product, read all accompanying safety information

**MS** Sebelum menggunakan produk anda, baca semua maklumat keselamatan yang disertakan

**ZH** 使用产品前，请阅读所有随附的安全信息  
**CN**

**ZH** 使用您的產品前，請先閱讀所有附隨的安全資訊  
**TW**

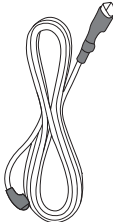
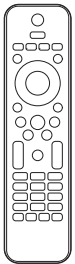

FM Antenna

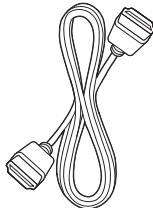

HDMI

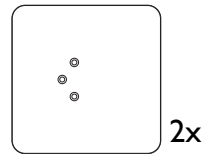
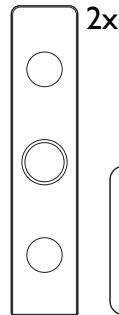
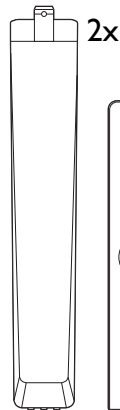
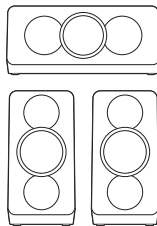
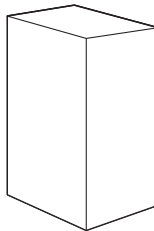
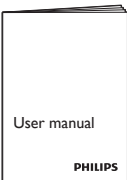
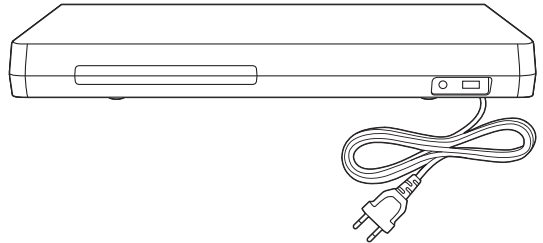

1

**EN** Stand mount the speakers  
**MS** Dirikan dirian pembesar suara

**ZH** 使用扬声器支架  
**CN**  
**ZH** 将喇叭安装到立架上  
**TW**

1

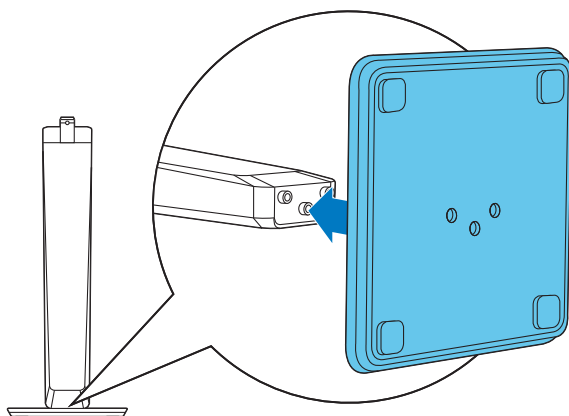

2

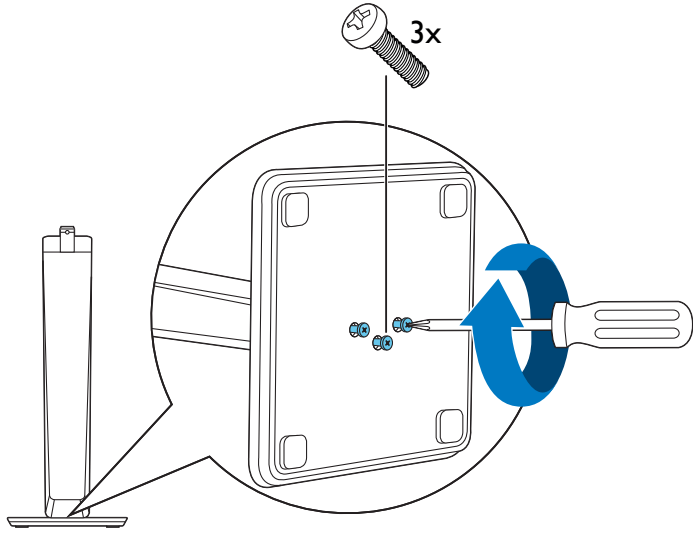

3

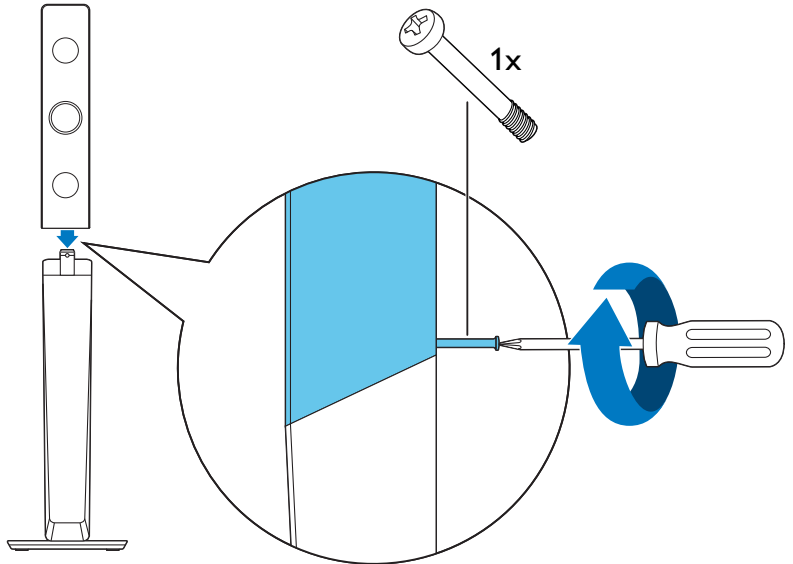

# 2

EN Connect the home theater  
MS Sambungkan teater rumah

ZH 连接家庭影院

ZH 連線至家庭劇院  
TW

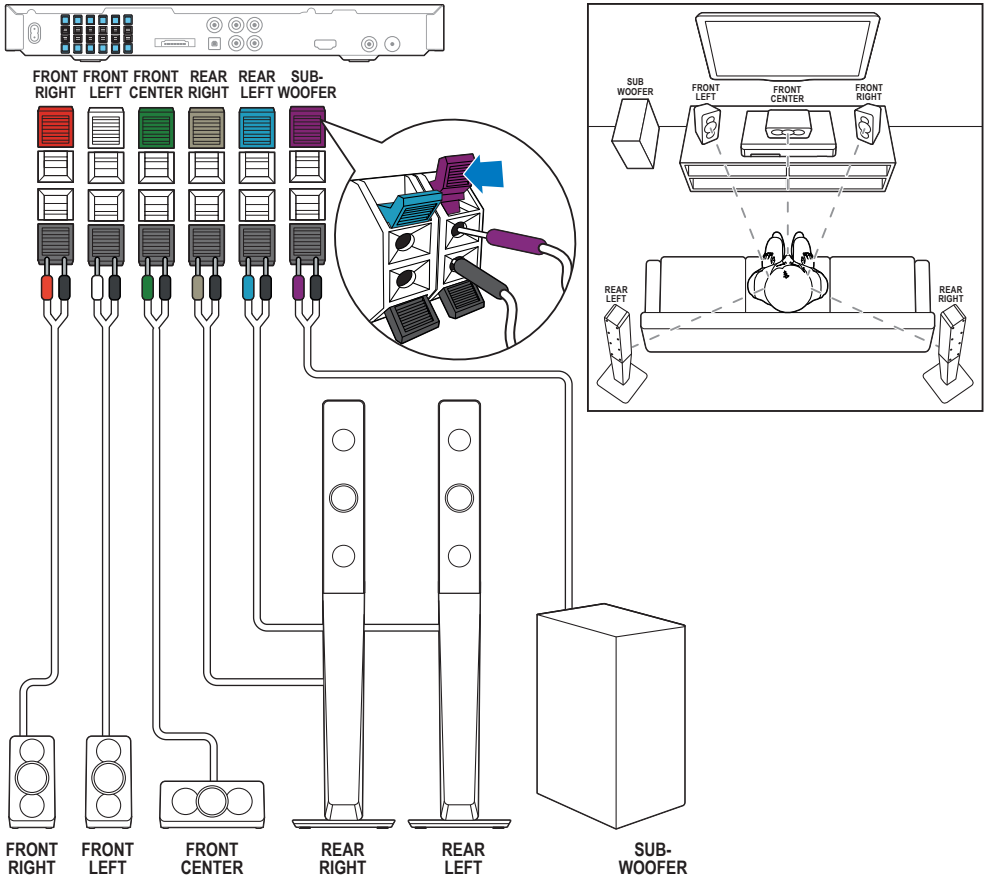

# 3

**EN** Connect to TV in one of these ways  
**MS** Sambung kepada TV dalam salah satu cara berikut

**ZH** 通过这些方式连接至电视  
**CN**  
**ZH** 用這些方式之一連接到電視  
**TW**

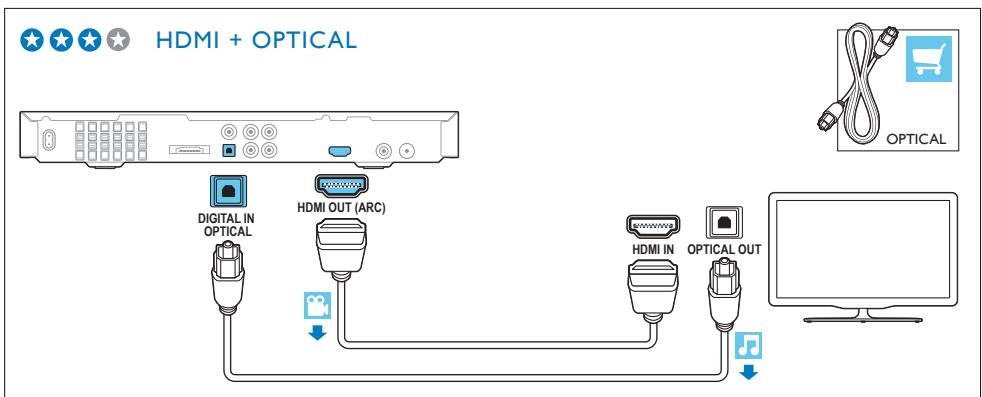
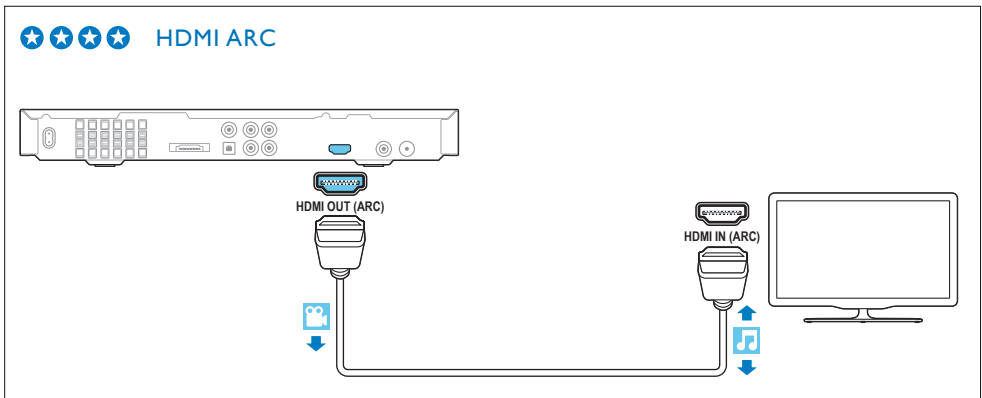

☆☆☆☆ HDMI + COAXIAL

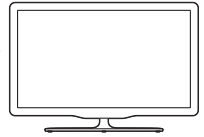
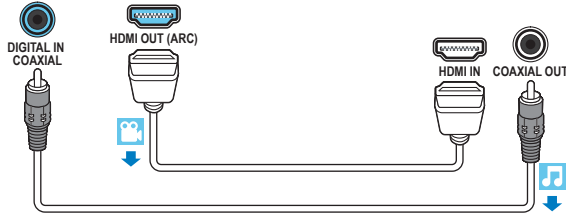
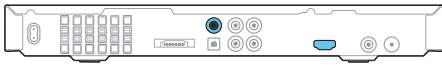

☆☆☆☆ HDMI + AUDIO L/R

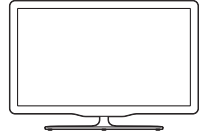
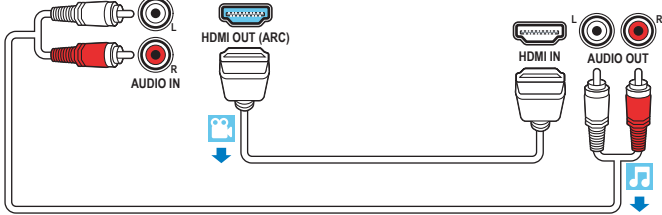

# 4

**EN** Switch on the home theater  
**MS** Hidupkan teater rumah

**ZH** 打开家庭影院  
**CN**

**ZH** 開啟家庭劇院  
**TW**

1

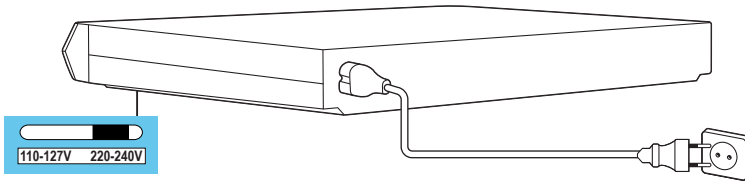

2

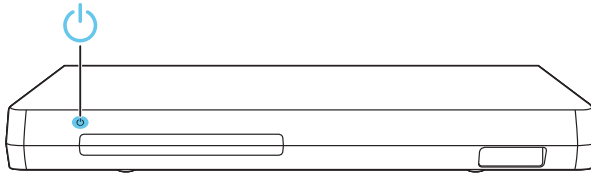

3

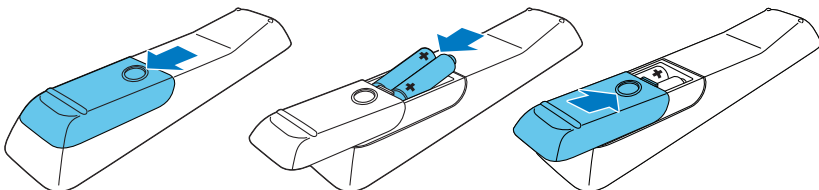



# 5

**EN** Complete the first time setup  
**MS** Lengkapi persediaan kali pertama

**ZH** 完成首次设置  
**CN**

**ZH** 完成首次設定  
**TW**

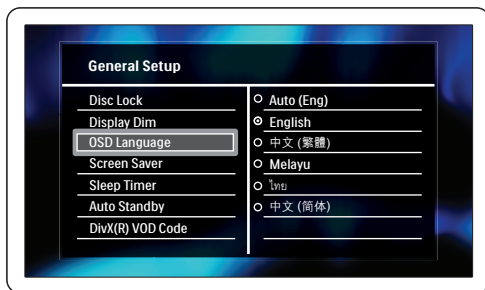
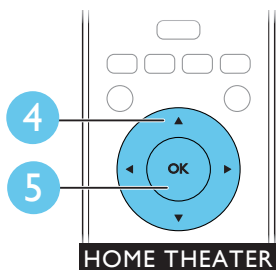
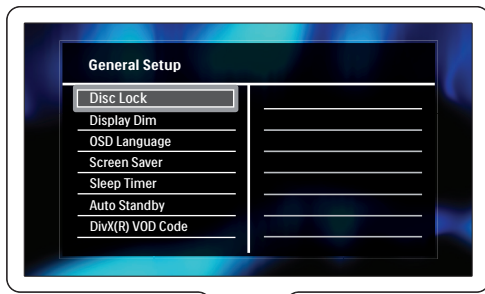
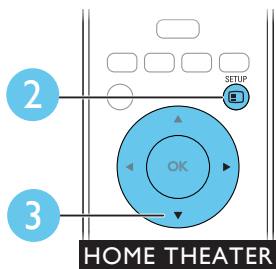
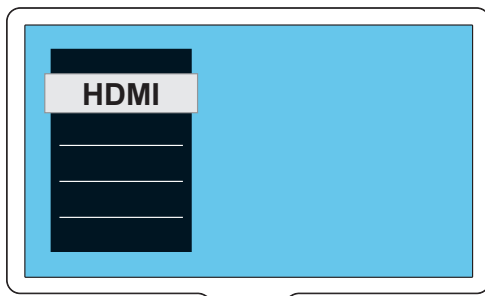
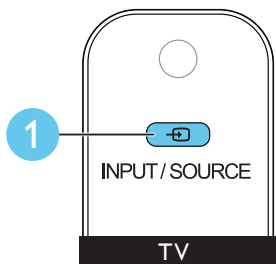

# 6

EN Use your home theater  
MS Gunakan teater rumah anda

ZH 使用家庭影院  
CN 使用您的家庭劇院  
ZH 使用您的家庭劇院  
TW

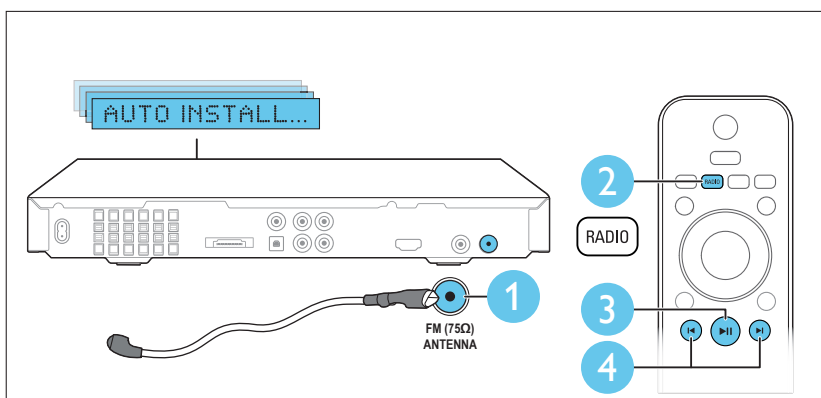
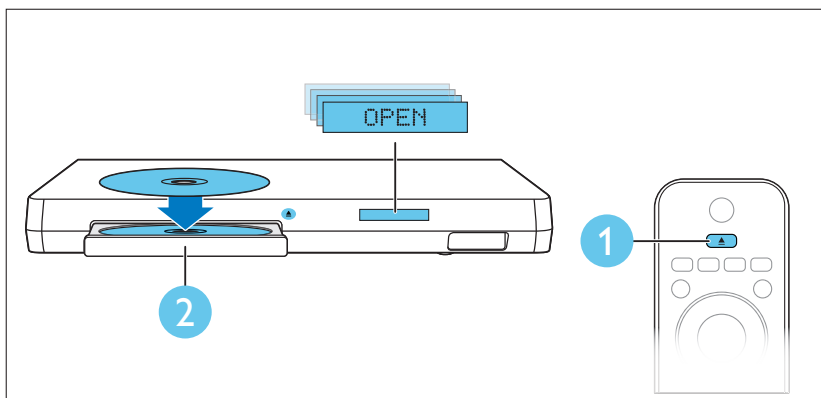

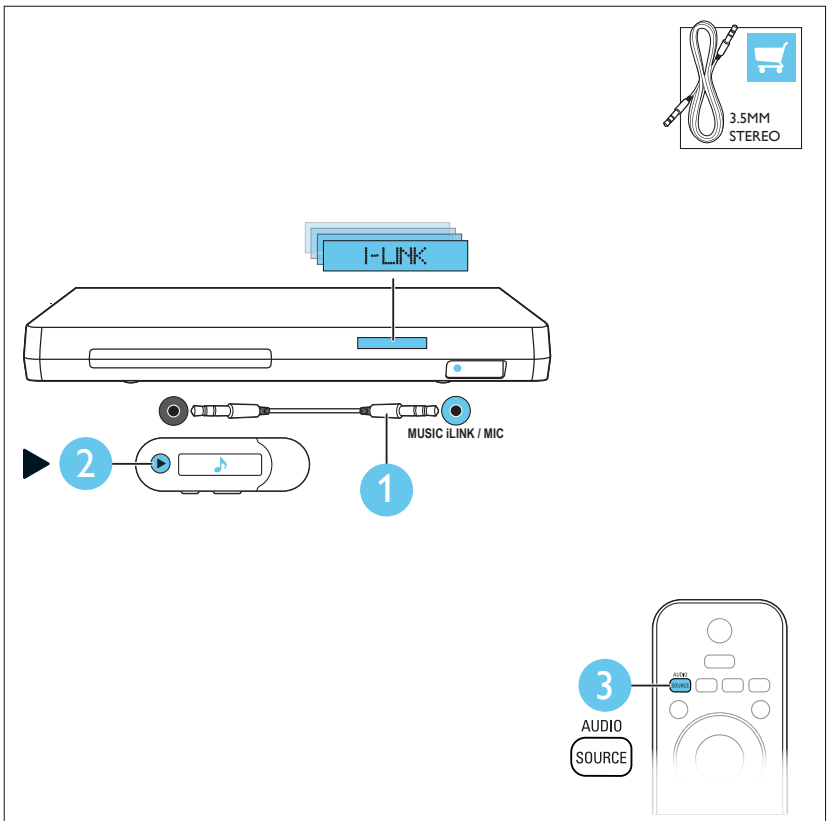
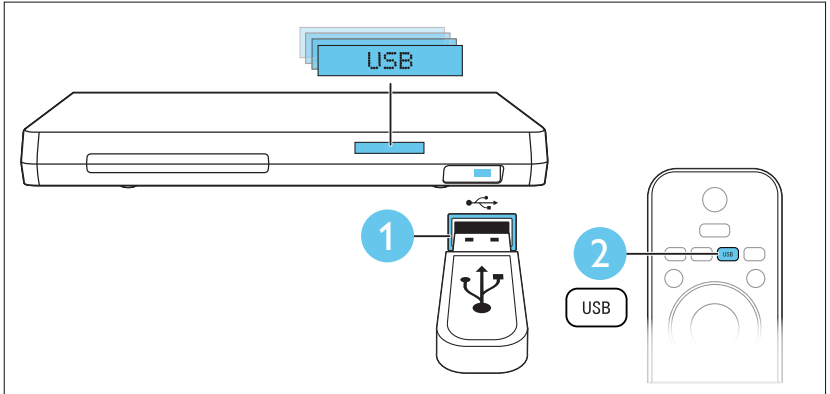



**EN** For more information about using this product visit [www.philips.com/support](http://www.philips.com/support)

**MS** Untuk mendapatkan maklumat lanjut dalam menggunakan produk ini, lawati [www.philips.com/support](http://www.philips.com/support)

**ZH** 有关使用本产品的更多信息，  
**CN** 请访问 [www.philips.com/support](http://www.philips.com/support)

**ZH** 有關此產品的更多資訊，請瀏覽 [www.philips.com/support](http://www.philips.com/support)  
**TW** support



[www.philips.com/support](http://www.philips.com/support)



Non-contractual images. / Images non contractuelles. /  
Außervertragliche Bilder.

All registered and unregistered trademarks are property  
of their respective owners.

Specifications are subject to change without notice  
Trademarks are the property of Koninklijke Philips Electronics  
N.V. or their respective owners

2012 © Koninklijke Philips Electronics N.V. All rights reserved  
[www.philips.com](http://www.philips.com)  
sgsn\_1151/98\_v1

