

Register your product and get support at

www.philips.com/welcome

CID2280



ENG

Quick Start Guide

简体中文

快速使用指南

1

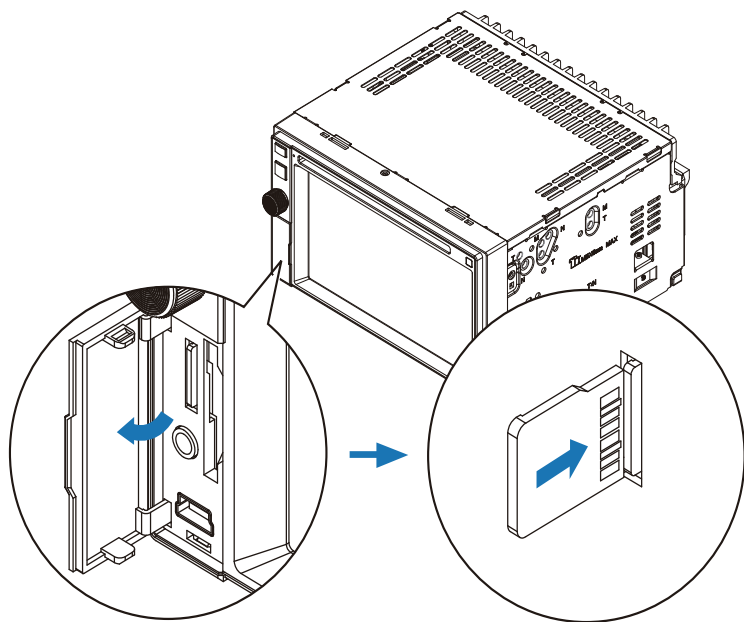

2

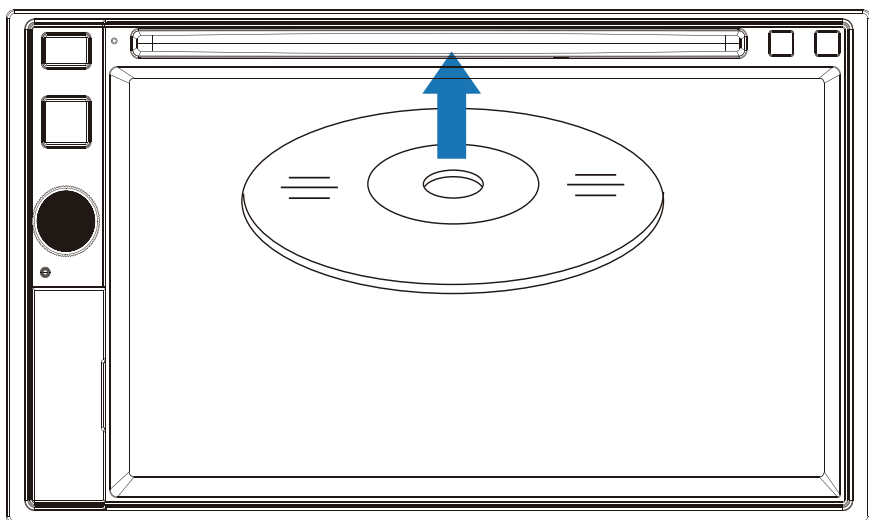

3

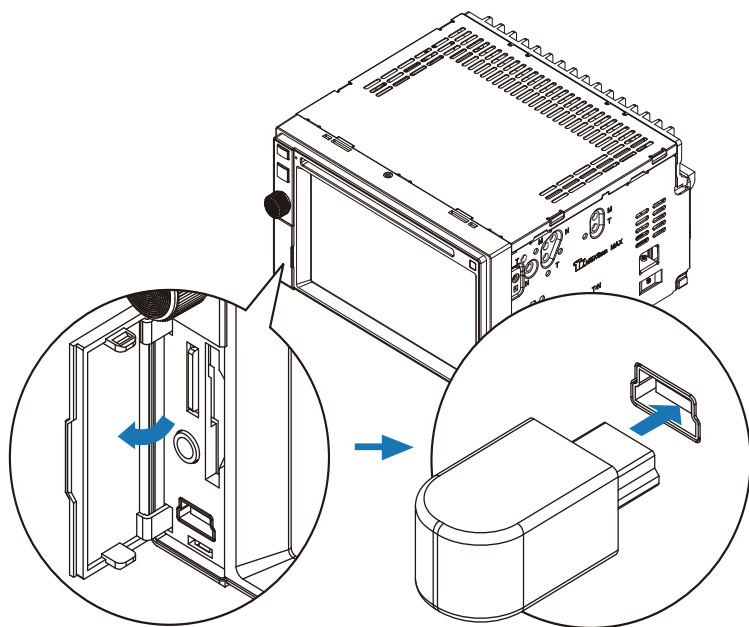

4

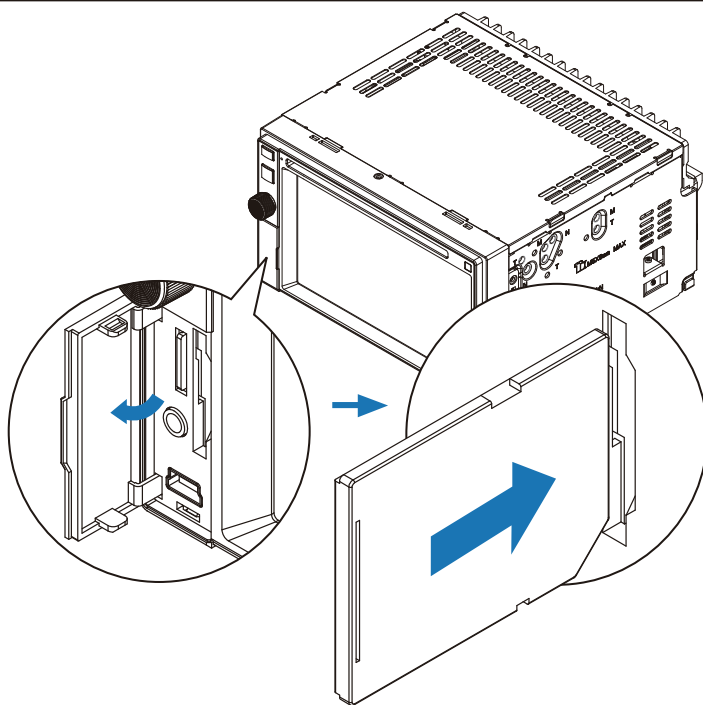

Turn on

! Caution

- Risk of road accidents! Never watch video or adjust settings while you drive.

- 1 Press **⏻** to turn on the unit.
 - ↳ The available OSD (On-Screen Display) languages are displayed.

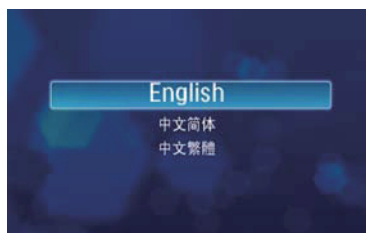

- 2 Tap a language.
 - ↳ The OSD language is changed to the selected language immediately.
- To turn off the unit, press **⏻** for 3 seconds.

Turn the screen on/off

- 1 Press **SRC** for over 2 seconds
 - ↳ The screen is turned off.
 - ↳ To turn on the screen, press **SRC**.

* Tip

- To adjust screen brightness, see "Adjust settings" section.

Set date and time

- 1 Tap **⏻**.
 - ↳ The main menu is displayed.



- 2 Tap **[Settings]**.
- 3 Tap **[Time]**.
 - ↳ The date/time setup menu is displayed.



Set date

- 1 Tap **[Date]**.
- 2 Tap the displayed date information.
 - ↳ A submenu is displayed.
- 3 Tap **▲** or **▼** to set year, month and day.

Set time mode

- 1 Tap **[Time mode]**.
- 2 Tap **[12H]** or **[24H]** to select clock mode.

Set time

- 1 Tap **[Time]**.
- 2 Tap the displayed time.
 - ↳ A submenu is displayed.
- 3 Tap **▲** or **▼** to set hour and minute.

Use navigation system

Note

- Navigation map card is not included in the packaging of the car entertainment system.

- 1 Open the card door.
- 2 Insert the map card into the map card slot.
 - 1
- 3 Close the card door.
- 4 Tap the upper left corner to display main menu.
- 5 Tap **[Navigation]**.
 - ↳ The navigation menu is displayed in a few seconds.
- 6 Refer to the user manual of the navigation map to operate the navigation tool.

Listen to radio

- 1 Tap **⬆** to display home menu.
- 2 Tap **[Radio]**.
 - ↳ Band and frequency information is displayed.



- 3 Tap on **FM** or **AM** to select band:
 - FM band options: **FM1**, **FM2**, **FM3**
 - AM band options: **AM1**, **AM2**
- 4 Briefly tap **◀** or **▶** to tune to a radio station by step.
 - Tap **◀** or **▶** for over 1 seconds to tune to a radio station automatically.

Store stations automatically

You can search for a station with intro search, which broadcasts a 10-second preview of each detected radio station.

- 1 Select band.
- 2 Tap **🔍**.
- 3 Tap **[Search]**.
 - ↳ Auto search starts. The six strongest stations of the selected band are saved in preset channels 1-6 automatically.

Tune to a preset station

- 1 Tap **[Radio]**.
- 2 Select band.
- 3 Tap one of the preset channels (**01** to **06**) to select a preset station.

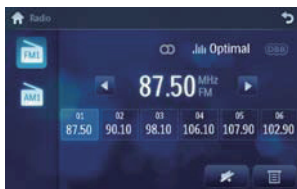

Play

Load discs

You can play video, audio or images stored on the following discs:

- DVD video, DVD-R, DVD-RW
- VCD
- Audio CD, CD-R, CD-RW

Note

- Ensure that the disc contains playable content.

- 1 Insert the disc into the disc slot with label side facing up.
 - ↳ Play starts automatically. **2**

Connect USB device

Note

- Ensure that the device contains playable content.

- 1 Open the USB door.
- 2 Insert the USB device to the USB socket.
↳ Play starts automatically. **3**

Note

- To remove the USB device, switch to disc, radio or other source first.

Insert SD/MMC card

Note

- Ensure that the device contains playable content.
- The unit supports SDHC card.

- 1 Open the USB/SD card door.
- 2 Insert the SD/MMC card into the SD/MMC card slot.
↳ Play starts automatically. **4**

Play with Bluetooth device

You can make or receive phone calls with Bluetooth-enabled phones through the unit. You can also listen to music from a Bluetooth-enabled device.

Pair Bluetooth devices

You can connect up to eight Bluetooth devices to the car entertainment system.

Note

- The effective operation range between the car entertainment system and the paired Bluetooth device is approximately 10 meters (30 feet). Any obstacle between the system and the Bluetooth device can decrease the operational range.
- Compatibility with all Bluetooth devices is not guaranteed.

On the Bluetooth device:

- 1 Turn on the Bluetooth function.
- 2 Search for Bluetooth device.
- 3 Select "CID2280" in the pairing list.
- 4 Enter default password "0000".
↳ if pairing succeeds, phone call record is displayed on the screen of the car entertainment system.



Make a call

- 1 Pair the phone with the unit.
- 2 Tap to display the home menu.
- 3 Tap **[Bluetooth]**.
↳ The Bluetooth menu is displayed.
- 4 Tap or to select the paired phone, then tap .
- 5 Tap or to search for phone number from the following list:
Or tap to dial number directly, then tap to dial.

Receive call

By default, all incoming calls are received automatically.

- 1 If there is incoming call, **[Incoming call...]** flashes on the screen. Speak into the Bluetooth microphone.

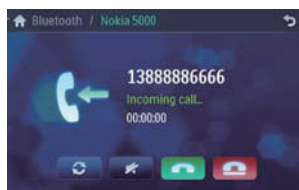

- 2 When conversation ends, tap  (red) to terminate the call.



Tip



- You can select to receive calls manually by set **[Auto answer]** to **[Off]** status.

Adjust sound

Adjust volume

- 1 Turn **VOL** clockwise to increase volume.
- Turn **VOL** anti-clockwise to reduce volume.

Mute

- 1 During play, press .
 - To turn the sound back on, press  again.



Tip





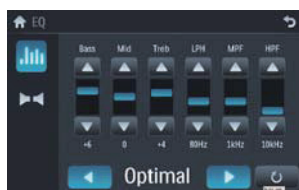

- You can also turn off sound by tapping  on the screen.

Select preset equalizer

You can select preset equalizer:

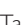
- 1 Tap anywhere except for the upper left corner to display menu on the screen, if necessary.
- 2 Tap .
 - The current Equalizer setting is displayed.

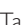

- 3 Tap  or  to select an EQ.
- 4 Tap  or  to adjust below settings:
- 5 Tap  to restore the above settings into default settings.
- 6 Tap  to exit.

Adjust settings

- 1 Tap  to display main menu.

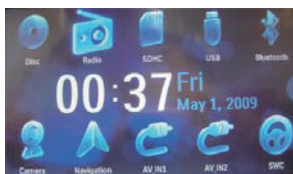

- 2 Tap **[Settings]**.

↳ The settings menu is displayed.



