

Always there to help you

Register your product and get support at
www.philips.com/welcome



AJ7245D



User manual

PHILIPS

Contents

1	Important	2
	Safety	2

2	Your Docking Entertainment System	3
	Introduction	3
	What's in the box	3
	Overview of the main unit	3

3	Get started	5
	Install battery	5
	Connect power	5
	Turn on	6
	Set time and date	6

4	Play	7
	Play from iPod/iPhone	7
	Listen to radio	10
	Play from an external device	11
	Adjust volume	11

5	Other features	12
	Set alarm timer	12
	Set sleep timer	12
	Adjust display brightness	12

6	Product information	13
	Specifications	13

7	Troubleshooting	14
----------	------------------------	-----------

8	Notice	15
----------	---------------	-----------

1 Important

Safety



Warning

- Never remove the casing of this apparatus.
- Never lubricate any part of this apparatus.
- Never place this apparatus on other electrical equipment.
- Keep this apparatus away from direct sunlight, naked flames or heat.
- Make sure that you always have easy access to the power cord, plug, or adaptor to disconnect the apparatus from the power.

Important Safety Instructions

- Heed all warnings and follow all instructions.
- Do not block any ventilation openings. Install in accordance with the manufacturer's instructions.
- Do not install near any heat sources such as radiators, heat registers, stoves, or other apparatus (including amplifiers) that produce heat.
- Protect the power cord from being walked on or pinched, particularly at plugs, convenience receptacles, and the point where they exit from the apparatus.
- Only use attachments/accessories specified by the manufacturer.
- Unplug this apparatus during lightning storms or when unused for long periods of time.
- Refer all servicing to qualified service personnel. Servicing is required when the apparatus has been damaged in any way, such as power-supply cord or plug is damaged, liquid has been spilled or objects have fallen into the apparatus, the

apparatus has been exposed to rain or moisture, does not operate normally, or has been dropped.

- Battery usage CAUTION – To prevent battery leakage which may result in bodily injury, property damage, or damage to the unit:
 - Install the battery correctly, + and - as marked on the unit.
 - The battery (battery pack or installed) shall not be exposed to excessive heat such as sunshine, fire or the like.
 - Remove the battery when the unit is not used for a long time.
- Apparatus shall not be exposed to dripping or splashing.
- Do not place any sources of danger on the apparatus (e.g. liquid filled objects, lighted candles).
- Where the plug of the Direct Plug-in Adapter is used as the disconnect device, the disconnect device shall remain readily operable.
- Use only power supplies listed in the user manual.

Risk of swallowing batteries

- The product or remote control may contain a button cell battery, which is possible to be swallowed. Keep the battery out of reach of children at all times! If swallowed, the battery can cause serious injury or death. Severe internal burns can occur within two hours of ingestion.
- If you suspect that a battery has been swallowed or placed inside any part of the body, seek immediate medical attention.
- When you change the batteries, always keep all new and used batteries out of reach of children. Ensure that the battery compartment is completely secure after you replace the battery.
- If the battery compartment cannot be completely secured, discontinue use of the product. Keep out of reach of children and contact the manufacturer.

2 Your Docking Entertainment System

Congratulations on your purchase, and welcome to Philips! To fully benefit from the support that Philips offers, register your product at www.philips.com/welcome.

Introduction

With this clock radio, you can

- listen to FM radio;
- enjoy audio from iPod/iPhone or an external device;
- set alarms to ring at different time;
- choose buzzer, radio, or music in iPod/iPhone as your alarm source;
- experience various features brought by **HomeStudio** app.

What's in the box

Check and identify the contents of your package:

- Main unit (with battery)
- User manual

Overview of the main unit

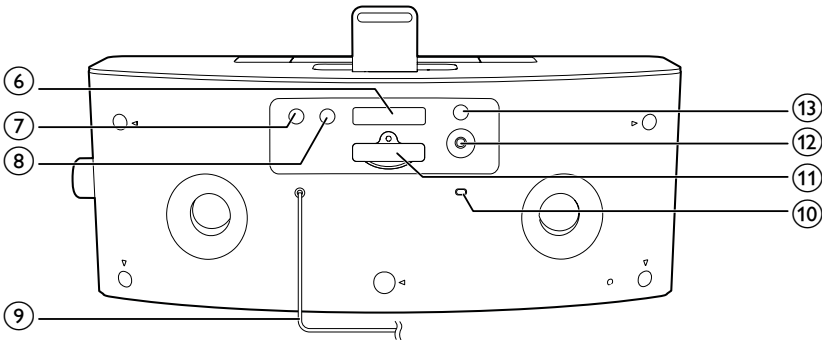
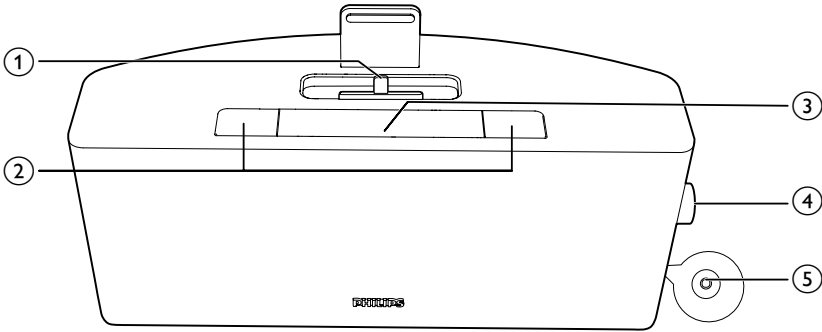

- ① **DOCK**
 - Dock for iPod/iPhone.
- ② **AL1/AL2**
 - Set alarm.
 - View alarm settings.
 - Activate/deactivate alarm timer.
- ③ **SNOOZE/BRIGHTNESS**
 - Snooze alarm.
 - Adjust display brightness.
- ④ **VOL**
 - Rotate to adjust volume or time.
 - Press to confirm a selection.
- ⑤ **⏻**
 - Turn the device on or off.
- ⑥ **⏮ / ⏭**
 - Tune to an FM radio station.
- ⑦ **SOURCE**
 - Select source.
- ⑧ **SLEEP**
 - Set sleep timer.
- ⑨ **Power cord**
- ⑩ **FM ANTENNA**
 - Improve FM reception.
- ⑪ **Battery tray**
- ⑫ **AUDIO IN**
 - Connect an external audio device.
- ⑬ **SET TIME**
 - Set time.

3 Get started

Always follow the instructions in this chapter in sequence.

If you contact Philips, you will be asked for the model and serial number of this apparatus. The model number and serial number are on the bottom of the apparatus. Write the numbers here:

Model No. _____

Serial No. _____

Install battery

! Caution

- Risk of explosion! Keep batteries away from heat, sunshine, or fire. Never discard batteries in fire.
- Danger of explosion if battery is incorrectly replaced. Replace only with the same or equivalent type.
- The battery contains chemical substances, so it should be disposed of properly.
- Keep children away from the battery.
- Perchlorate Material - special handling may apply. See www.dtsc.ca.gov/hazardouswaste/perchlorate.

☰ Note

- You can only use AC power as power supply. The pre-installed lithium CR2032 battery can only back up time and alarm.

For first-time use:

Remove the protective tab to activate the battery.

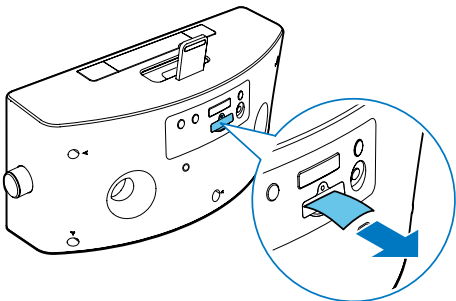

To replace the battery:

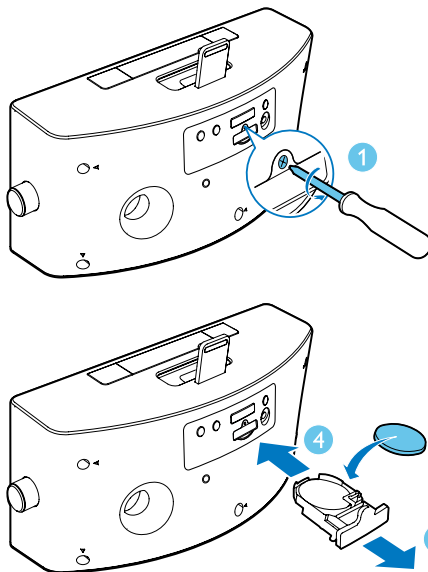

Connect power

! Caution

- Risk of product damage! Make sure that the power voltage corresponds to the voltage printed on the back or underside of the unit.
- Risk of electric shock! When you unplug the power adapter, always pull the plug from the socket. Never pull the cord.
- Before connecting the power adapter, make sure that you have completed all other connections.

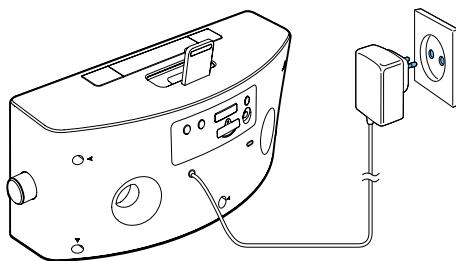

Turn on

Press .

- ↳ The device switches to the last selected source.

Switch to standby mode

Press  to switch the device to standby mode.

- ↳ The clock (if set) is displayed.

Set time and date

- 1 Press and hold **SET TIME** on the back of the device for more than two seconds.
 - ↳ **[12H]** or **[24H]** begins to blink.
- 2 Rotate the knob to select 12/24 hour format.
- 3 Press the knob to confirm.
 - ↳ The hour digits begin to blink.
- 4 Repeat steps 2-3 to set hour and minute.



Note

- If clock is not manually set, when iPod/iPhone is connected, the unit synchronizes time from the iPod/iPhone automatically.



Tip

- The accuracy of the transmitted time depends on the docked iPod/iPhone that transmits the time signal.

4 Play

Play from iPod/iPhone

You can enjoy audio from iPod/iPhone through this device.

Compatible iPod/iPhone

The unit supports following iPod/iPhone models.

Made for:

- iPhone 5
- iPod nano (7th generation)
- iPod touch (5th generation)

Install HomeStudio App

Philips **HomeStudio** app brings a suite of new features to your clock radio, including FM radio programming and a multi-function alarm clock. To enjoy more features, you are recommended to install this free **HomeStudio** app.

Note

- Make sure that your iPod/iPhone is connected to the Internet.

1 Press **SOURCE** to select the **DOCK** mode.

2 Insert your iPod/iPhone into the dock.

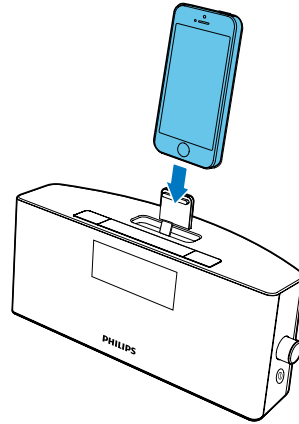

3 For the first-time use, you will be asked to install **HomeStudio** app on your iPod/iPhone.

4 Tap **[Yes]** (yes) to accept the installation request.

5 Follow the on-screen instructions to complete the installation.

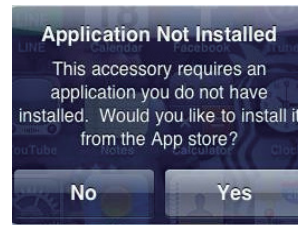

Philips **HomeStudio** app only can be installed in the following iPod, iPhone models:

- iPhone 5
- iPod touch (5th generation)

Register an account

For the first-time use of the HomeStudio App, you must register an account.

- 1 Tap **HomeStudio** icon on your iPod/iPhone.

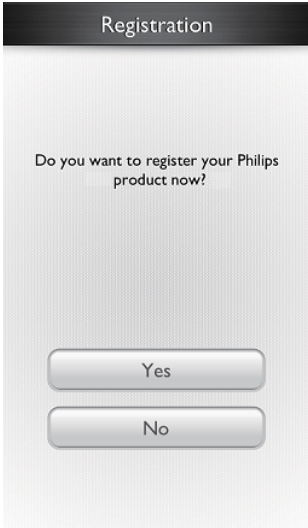

- 2 Follow on-screen instructions to finish the registration.

Play music in the iPod/iPhone

Note

- Make sure that you have installed the **HomeStudio** app on your iPod/iPhone.

- 1 Tap **HomeStudio** icon on your iPod/iPhone.

- 2 Tap  to select **Music library** source.

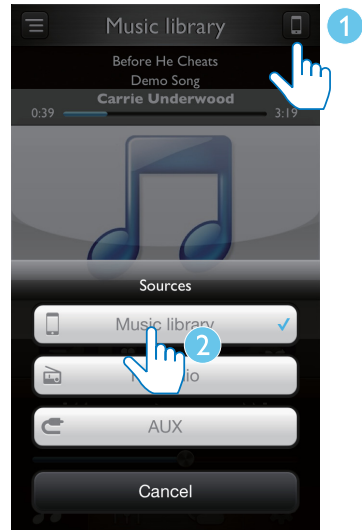

- 3 Select a track from the playlist, and then press .
↳ Music streams from your iPod/iPhone to the clock radio.

Use more features with "HomeStudio App"

Note

- Make sure that your iPod/iPhone is inserted into the clock radio.

Set alarm clock:



- 1 Launch the **HomeStudio** app.

- 2 Tap the  on the screen.





- 3 You can choose to turn the alarm 1/alarm 2 on or off.

Set sleep timer:

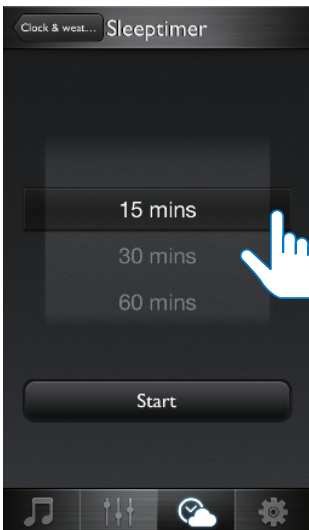
- 1 Tap  and then tap .
- 2 Choose a period of time and tap **Start**.



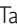

Store FM radio stations automatically

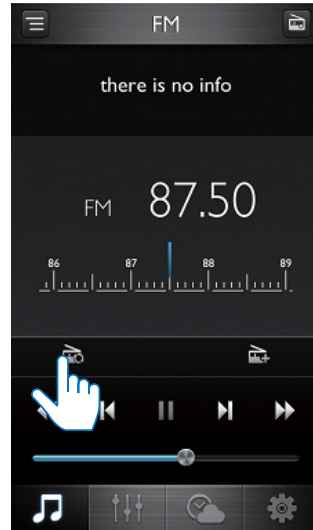
- 1 Tap  and then tap the icon on right top the screen to select FM Radio source.
- 2 Tap  to search the radio station with strong reception automatically.
- ↳ All available stations are stored.
 - ↳ The first stored radio station is broadcast automatically.

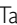

Store FM radio stations manually

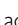
- 1 Select FM Radio source.
- 2 Tap  /  to tune to a radio station.
- 3 Tap  to add the current station to a preset list.

- 4 Select a preset number; enter the station title, then **[Done]** (done).

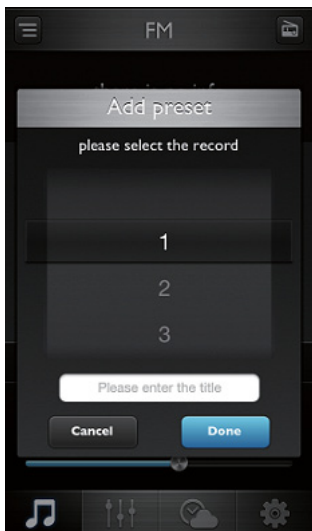

- 5 Repeat above steps to store more stations.

Use more features

Tap **⚙** (Settings), you can:

- Set virtual skin;
- Set location for weather report;
- Choose temperature unit;
- Set clock;
- See App information;
- Register an account;
- Upgrade firmware;
- Share the information to Twitter;
- Send feedback.

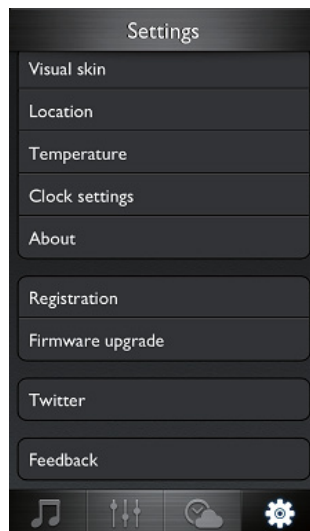

Charge the iPod/iPhone

When your device is connected to power, the docked iPod/iPhone begins to charge automatically.

Remove the iPod/iPhone

Pull the iPod/iPhone out of the dock.

Listen to radio

≡ Note

- Keep the unit away from other electronic devices to avoid radio interference.
- For better reception, do not place iPod/iPhone into the dock when you listen to the radio. Fully extend and adjust the position of the FM antenna.

You can listen to radio through this device.

- 1 Press **SOURCE** repeatedly to select FM source.

- 2 Press and hold **⏮** / **⏭** on the back of the device for more than two seconds.
↳ The radio tunes to a station with strong reception automatically.

- 3 Repeat step 2 to tune to more stations.

To tune to a station manually:

Press **⏮** / **⏭** repeatedly until you find optimal reception.

Play from an external device

You can also listen to an external audio device through this clock radio.

- 1 Press **SOURCE** to select the **AUX** source.
- 2 Connect the MP3 link cable (not supplied) to:
 - the **AUDIO IN** socket (3.5mm) at the back of your clock radio.
 - the headphone socket of an external device.
- 3 Start to play the device (see the user manual of the device).

Adjust volume

During play, you can rotate the knob to adjust volume.

5 Other features

Set alarm timer

Set alarm

You can set two alarms to ring at different time. Buzzer, FM radio, or your last listened music in the iPod/iPhone can be selected as alarm sound.

 **Note**

- Make sure that you have set the clock correctly.

- 1 Press and hold **AL1/AL2** for more than two seconds to activate alarm setting mode.
↳ The hour digits and alarm icon begin to blink.
- 2 Rotate the knob to set the hour.
- 3 press the knob to confirm.
↳ The minute digits begin to blink.
- 4 Repeat steps 2-3 to set the minute, select an alarm source (buzzer, radio, or dock), and adjust volume.

 **Note**

- If iPod/iPhone is selected as alarm source, but no iPod/iPhone is connected, the clock radio switches to buzzer source instead.
- For the alarm(s) set through the clock radio, you can also select the nature sounds stored in the **HomeStudio** app as alarm sound.

Activate/deactivate alarm timer

- 1 Press **AL1/AL2** to view alarm settings.
- 2 Press **AL1/AL2** again to activate or deactivate the alarm timer.
↳ 1 or 2 is displayed if alarm timer is on and disappears if it is off.
 - To stop the ringing alarm, press the corresponding **AL1/AL2**.
↳ The alarm repeats ringing for the next day.

Snooze alarm

When alarm sounds, press **SNOOZE**.

- ↳ The alarm snoozes and repeats ringing nine minutes later.

Set sleep timer

This clock radio can switch to standby mode automatically after a preset period.

Press **SLEEP** repeatedly to select the sleep timer period (in minutes).

- ↳ When the sleep timer is activated, **zZ** is displayed.

To deactivate the sleep timer, press **SLEEP** repeatedly until clock time is displayed.

Adjust display brightness

Press **BRIGHTNESS** repeatedly to select different brightness levels.

6 Product information

Note

- Product information is subject to change without prior notice.

Specifications

Amplifier

Rated Output Power	2 x 5 W RMS
Frequency Response	63 Hz - 16 kHz
Signal to Noise Ratio	>50 dB
Total Harmonic Distortion	<15%
Aux Input (Audio In)	0.6 V RMS 10 k ohm

Speakers

Speaker Impedance	4 ohm
Sensitivity	>82 dB/m/W

Tuner (FM)

Tuning range	87.5-108 MHz
Tuning grid	100 KHz

General information

AC/DC power adapter	Brand name: Philips; Model:YJS03-1001800G; Input: 100-240V~, 47-63 Hz, 500 mA Output: 10.0V = 1800 mA
Operation Power Consumption	<20 W
Standby Power Consumption	<1 W
Dimensions: Main Unit (W x H x D)	283 x 135 x 112 mm
Weight: Main Unit	1.4 kg

7 Troubleshooting



Warning

- Never remove the casing of this device.

To keep the warranty valid, never try to repair the system yourself.

If you encounter problems when using this device, check the following points before requesting service. If the problem remains unsolved, go to the Philips Web page (www.philips.com/support). When you contact Philips, make sure that the device is nearby and the model number and serial number are available.

No power

- Make sure that the AC power cord of the device is connected properly.
- Make sure that there is power at the AC outlet.
- As a power-saving feature, the system switches off automatically 15 minutes after track play reaches the end and no control is operated.

No sound

- Adjust volume.

No response from the unit

- Disconnect and reconnect the AC power plug, then turn on the unit again.

Poor radio reception

- Increase the distance between the unit and your TV or VCR.
- Fully extend the FM aerial.

Alarm does not work

- Set the clock/alarm correctly.

Clock/alarm setting erased

- Power has been interrupted or the power plug has been disconnected.
- Reset the clock/alarm.

8 Notice

Any changes or modifications made to this device that are not expressly approved by Philips Consumer Lifestyle may void the user's authority to operate the equipment.



This product complies with the radio interference requirements of the European Community.



Your product is designed and manufactured with high quality materials and components, which can be recycled and reused.



When this crossed-out wheeled bin symbol is attached to a product it means that the product is covered by the European Directive 2002/96/EC.

Please inform yourself about the local separate collection system for electrical and electronic products.

Please act according to your local rules and do not dispose of your old products with your normal household waste. Correct disposal of your old product helps to prevent potential negative consequences for the environment and human health.



Your product contains batteries covered by the European Directive 2006/66/EC, which cannot be disposed with normal household waste. Please inform yourself about the local rules on separate collection of batteries

because correct disposal helps to prevent negative consequences for the environmental and human health.

Environmental information

All unnecessary packaging has been omitted. We have tried to make the packaging easy to separate into three materials: cardboard (box), polystyrene foam (buffer) and polyethylene (bags, protective foam sheet.)

Your system consists of materials which can be recycled and reused if disassembled by a specialized company. Please observe the local regulations regarding the disposal of packaging materials, exhausted batteries and old equipment.



The making of unauthorized copies of copy-protected material, including computer programs, files, broadcasts and sound recordings, may be an infringement of copyrights and constitute a criminal offence. This equipment should not be used for such purposes.



"Made for iPod" and "Made for iPhone" mean that an electronic accessory has been designed to connect specifically to iPod or iPhone respectively, and has been certified by the developer to meet Apple performance standards. Apple is not responsible for the operation of this device or its compliance with safety and regulatory standards. Please note that the use of this accessory with iPod or iPhone may affect wireless performance. iPod and iPhone are trademarks of Apple Inc., registered in the U.S. and other countries.

Note

- The type plate is located on the bottom of the apparatus.



Specifications are subject to change without notice
© 2013 Koninklijke Philips Electronics N.V.
All rights reserved.

AJ7245D_12_UM_V1.0

