

# Always there to help you

Register your product and get support at  
[www.philips.com/support](http://www.philips.com/support)



SBM150



## User Manual

# PHILIPS

# Contents

---

<b>1</b>	<b>Important</b>	<b>3</b>
----------	------------------	----------

---

<b>2</b>	<b>Your Portable Speaker</b>	<b>4</b>
	Introduction	4
	What's in the box	4
	Overview of the speaker	5

---

<b>3</b>	<b>Get started</b>	<b>6</b>
	Power supply	6
	Turn on/off	6
	Select a source	7
	Use the numeric buttons	7

---

<b>4</b>	<b>Play</b>	<b>7</b>
	Play from Micro SD card	7
	Play from USB device	7
	Control play	8
	Play from an external device	8

---

<b>5</b>	<b>Listen to FM radio</b>	<b>9</b>
	Tune to FM radio stations	9
	Store FM radio stations automatically	9
	Store FM radio stations manually	9
	Select a preset FM radio station	9

---

<b>6</b>	<b>Other features</b>	<b>10</b>
	Amplify your sound	10
	Record your voice	10
	Adjust volume	10

---

<b>7</b>	<b>Product information</b>	<b>11</b>
	Specifications	11
	USB playability information	11

---

<b>8</b>	<b>Troubleshooting</b>	<b>12</b>
----------	------------------------	-----------

---

<b>9</b>	<b>Notice</b>	<b>12</b>
	Disposal of your old product and batteries	12

# 1 Important

- Read these instructions.
- Heed all warnings.
- Follow all instructions.
- Do not use this apparatus near water.
- Do not install near any heat sources such as radiators, heat registers, stoves, or other apparatus (including amplifiers) that produce heat.
- Only use attachments/accessories specified by the manufacturer.
- Refer all servicing to qualified service personnel. Servicing is required when the apparatus has been damaged in any way, such as liquid has been spilled or objects have fallen into the apparatus, the apparatus has been exposed to rain or moisture, does not operate normally, or has been dropped.
- The battery shall not be exposed to excessive heat such as sunshine, fire or the like.
- Apparatus shall not be exposed to dripping or splashing.
- Do not place any sources of danger on the apparatus (e.g. liquid filled objects, lighted candles).

Always bring your product to a professional to remove the built-in battery.

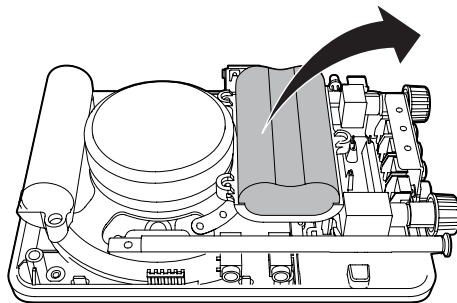

## Caution

- Removal of the built-in battery invalidates the warranty and may destroy the product.

## 2 Your Portable Speaker

Congratulations on your purchase, and welcome to Philips! To fully benefit from the support that Philips offers, register your product at [www.philips.com/support](http://www.philips.com/support).

---

### Introduction

With this speaker, you can:

- listen to FM radio;
- enjoy audio from Micro SD card, USB devices, and other external devices;
- record your voice to the Micro SD card or USB device; and
- amplify your sound when speaking in front of a large group or in a noisy place.

---

### What's in the box

Check and identify the contents of your package:

- Main unit X 1
- USB cable X 1
- Aux-in cable X 1
- Headset microphone X 1
- Short user manual X 1

## Overview of the speaker

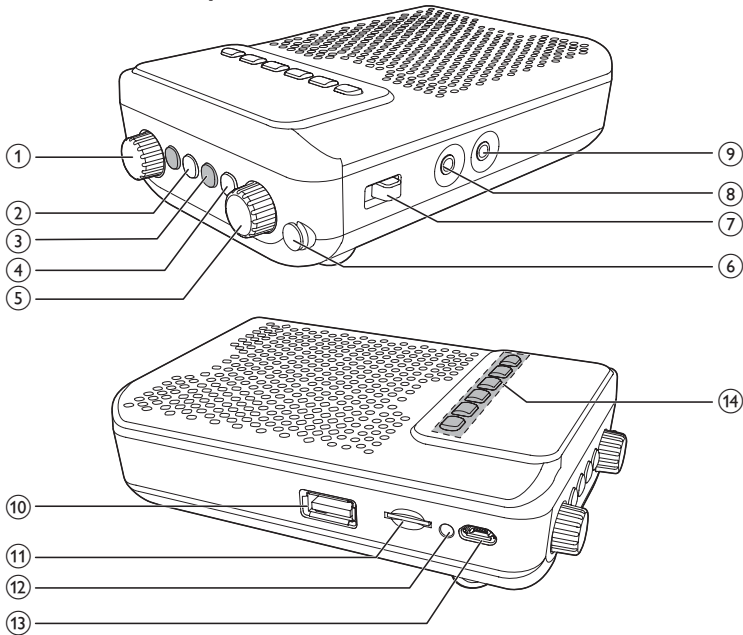

### ① MIC

- Adjust the sound effect of the microphone.

### ② ►||

- Start or pause play.
- Store FM radio stations.
- Enable folder selection.

### ③ ◀◀ / ▶▶

- Select a track or folder.
- Search within play.
- Tune to FM radio stations.

### ④ REC

- Start or stop recording.
- Listen to the recorded sound.

### ⑤ VOL

- Turn the speaker on or off.
- Adjust volume.

### ⑥ FM antenna

- Improve FM radio reception.

### ⑦ Source selector

- Select an audio source.

### ⑧ 🎧

- Connect the headset microphone.

### ⑨ AUX

- Connect an external audio device.

### ⑩ 🗑️

- Connect a USB storage device. (Note: The USB input (as a music source) is meant for data transfer, not for battery charging purpose)

### ⑪ MICRO SD

- Micro SD card slot.

### ⑫ Battery indicator

### ⑬ DC 5V

- Recharge the built-in battery.

### ⑭ 1 - 5+

- Numeric buttons: select a track or preset radio station.

# 3 Get started

Always follow the instructions in this chapter in sequence.

If you contact Philips, you will be asked for the model and serial number of this apparatus. The model number and serial number are on the bottom of the apparatus. Write the numbers here:

Model No. \_\_\_\_\_

Serial No. \_\_\_\_\_

## Power supply



### Caution

- Danger of explosion if battery is incorrectly replaced. Replace only with the same or equivalent type.
- Risk of damage to the speaker. Charge through the USB socket of a computer only.

The speaker is powered by the built-in rechargeable battery.

### To recharge the built-in battery:

Connect the supplied USB cable to:

- the **DC 5V** socket on the speaker.
- the USB socket on a computer.

↳ The battery indicator lights up.

↳ When the battery is fully charged, the battery indicator light turns off.



### Note

- It is recommended to turn off the speaker while charging.

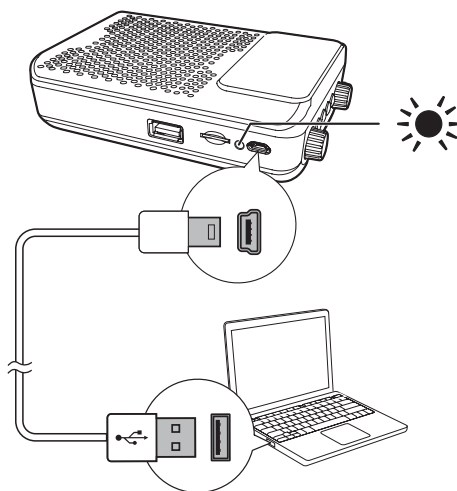

## Turn on/off

- 1 Rotate the **VOL** knob clockwise to turn on the speaker.  
↳ The speaker switches to the last selected source.
- 2 Rotate the **VOL** knob anticlockwise to turn off the speaker.

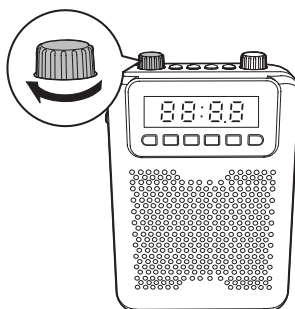

## Select a source

Adjust the source slider to select a source:  
**AUX, FM, SD** or **USB**.

## Use the numeric buttons

You can use the numeric buttons **1 - 5+** to select a track or preset FM radio station.

 **Note**

- Only 30 tracks or stations can be selected.

Track/Station Number	Action
Track/Station 1 - 5	Press the numeric button <b>1 - 5</b> directly.
Track/Station 6 - 10	Press <b>5+</b> once, then press the corresponding numeric button.
Track/Station 11 - 15	Press <b>5+</b> twice, then press the corresponding numeric button.
Track/Station 16 - 20	Press <b>5+</b> for three times, then press the corresponding numeric button.
Track/Station 21 - 25	Press <b>5+</b> for four times, then press the corresponding numeric button.
Track/Station 26 - 30	Press <b>5+</b> for five times, then press the corresponding numeric button.

# 4 Play

## Play from Micro SD card

 **Note**

- Make sure that the Micro SD card contains playable audio content.

**1** Insert a Micro SD card into the card slot.

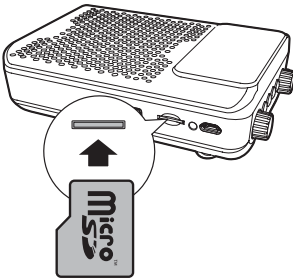

**2** Adjust the source slider to select the **SD/USB** source.  
↳ **[SD]** is displayed.  
↳ Play starts automatically.

 **Note**

- Due to different materials and product techniques, it cannot be guaranteed that all Micro SD cards will work with this speaker.

## Play from USB device

 **Note**

- Make sure that the USB storage device contains playable audio content.
- The USB input (as a music source) is meant for data transfer, not for battery charging purpose.

- 1 Insert the USB device into the  socket.

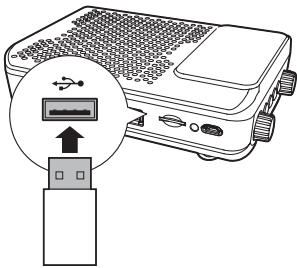



- 2 Adjust the source slider to select the **SD/USB** source.
  - ↳ **[USB]** is displayed.
  - ↳ Play starts automatically.



---

## Control play

In USB or Micro SD mode, you can control play through the following operations.

- 
-  Select an audio file;  
Press and hold to fast-forward or fast-reverse the track during playback, then release to resume play.
- 
-  Start or pause play.
- 

If the USB device or Micro SD card contains several folders, you can select a folder to play music.

- 1 Press and hold  for 2 seconds.
  - ↳ The current folder **[F X]** (X stands for the folder number) is displayed.
- 2 Press  repeatedly to select a folder.
  - ↳ The first track in the folder is played automatically.

### Note

- All the root directories and sub-folders can be selected to play music.

---

## Play from an external device

With this speaker, you can also enjoy audio from an external device such as an MP3 player.

- 1 Adjust the source slider to select the **AUX** source.
- 2 Connect the supplied Aux-in cable to:
  - the **AUX** socket on the speaker.
  - the headphone socket on an external device.
- 3 Play audio on the device (see the user manual of the device).

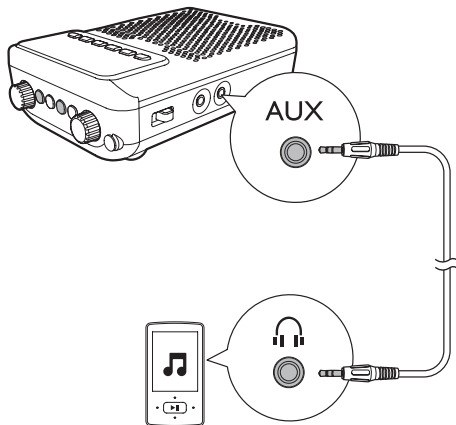

# 5 Listen to FM radio

---

## Tune to FM radio stations



### Note

- Keep the portable speaker away from other electronic devices to avoid radio interference.

- 1 Pull out the FM antenna.
- 2 Adjust the source slider to select the **FM** source.
- 3 Press and hold **◀◀ / ▶▶** for two seconds.  
↳ The speaker tunes to a station with strong reception automatically.
- 4 Repeat step 3 to tune to more radio stations.

### To tune to a station manually:

Press **◀◀ / ▶▶** repeatedly until you find better reception.

---

## Store FM radio stations automatically

In FM tuner mode, press and hold **▶▶** for two seconds.

- ↳ The speaker stores all the FM radio stations automatically and then broadcasts the first preset radio station.

---

## Store FM radio stations manually

You can store up to 30 FM radio stations.

- 1 Tune to an FM radio station.
- 2 Press **▶▶** to activate storing.
- 3 Press **◀◀ / ▶▶** or the numeric button to select a preset number.
- 4 Press **▶▶** to confirm.  
↳ The station is stored in the selected channel.
- 5 Repeat steps 1 - 4 to store more FM stations.



### Tip

- To overwrite a preset station, store another station in its place.

---

## Select a preset FM radio station

In FM tuner mode, press **◀◀ / ▶▶** or the numeric button to select a preset radio station.

## 6 Other features

### Amplify your sound

This speaker can be used as an amplifier. People such as tour guides, teachers, and entertainers can benefit from using this amplifier when talking to a large group or in a noisy place.

#### Note

- Make sure that the microphone is close to the sound source.

- 1 Connect the headset microphone to the  socket.

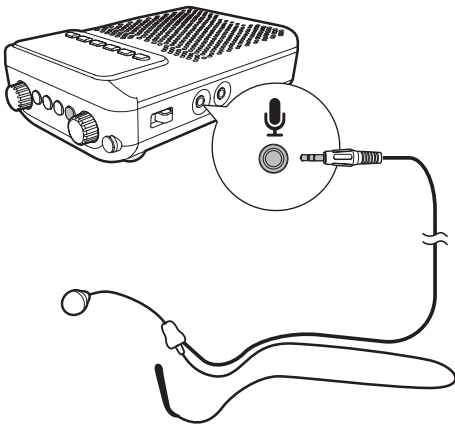

- 2 Speak through the microphone.
  - To adjust the volume of the sound, rotate the **VOL** knob.
  - To adjust the sound effect of the microphone, rotate the **MIC** knob.

### Record your voice

#### Note

- Make sure that a Micro SD card or USB device is connected to the speaker.

- 1 Connect the headset microphone to the  socket.
- 2 Press **REC** to start recording.  
↳ **[REC]** is displayed.
- 3 Speak or sing to the microphone.
- 4 Press **REC** again to stop recording.  
↳ The recorded sound is saved as WAV format file in the connected USB device or Micro SD card.
- 5 Press and hold **REC** for 2 seconds to listen to the recorded sound.

### Adjust volume

During play, rotate **VOL** to adjust volume.

# 7 Product information

## Note

- Product information is subject to change without prior notice.

## Specifications

### Amplifier

Max Output Power	3 W
Signal to Noise Ratio	50 dBA
Aux Input	600mV RMS, 22 kohm

### Tuner (FM)

Tuning Range	87.5-108 MHz
--------------	--------------

### General information

Power Supply	5V --- 0.6A
Built-in Battery	Ni-MH battery
Dimensions - Main Unit (W × H × D)	131 × 90 × 52 mm
Weight - Main Unit	0.34 kg

## USB playability information

Note: The USB input (as a music source) is meant for data transfer; not for battery charging purpose.

### Compatible USB devices:

- USB flash memory (USB1.1)
- USB flash players (USB1.1)

- memory cards (requires an additional card reader to work with this unit; Some multi-card USB reader may not be supported.)

### Supported formats:

- USB or memory file format: FAT12, FAT16, FAT32 (sector size: 512 bytes)
- MP3 bit rate (data rate): 32-320 Kbps and variable bit rate
- WMA v9 or earlier
- Directory nesting up to a maximum of 8 levels
- Number of albums/ folders: maximum 99
- Number of tracks/titles: maximum 999
- ID3 tag v2.0 or later
- File name in Unicode UTF8 (maximum length: 16 bytes)

### Unsupported formats:

- Empty albums: an empty album is an album that does not contain MP3/WMA files, and is not be shown in the display.
- Unsupported file formats are skipped. For example, Word documents (.doc) or MP3 files with extension .dlf are ignored and not played.
- AAC, WAV, PCM audio files
- DRM protected WMA files (.wav, .m4a, .m4p, .mp4, .aac)
- WMA files in Lossless format

## 8 Troubleshooting



### Warning

- Never remove the casing of this device.

To keep the warranty valid, never try to repair the system yourself.

If you encounter problems when using this device, check the following points before requesting service. If the problem remains unsolved, go to the Philips Web page ([www.philips.com/support](http://www.philips.com/support)). When you contact Philips, make sure that the device is nearby and the model number and serial number are available.

### No power

- Recharge the battery.

### No sound

- Adjust volume.
- Check if you have selected the correct audio source.

### No response from the speaker

- Turn on the speaker.
- Recharge the battery.

### Poor radio reception

- Increase the distance between the unit and your TV or VCR.
- Fully extend the FM antenna.

### USB device not supported

- The USB device is incompatible with the unit. Try another one.

## 9 Notice

Any changes or modifications made to this device that are not expressly approved by Gibson may void the user's authority to operate the equipment.

## Disposal of your old product and batteries

Your product is designed and manufactured with high quality materials and components, which can be recycled and reused.

Never dispose of your product with other household waste. Please inform yourself about the local rules on the separate collection of electrical and electronic products and batteries. The correct disposal of these products helps prevent potentially negative consequences on the environment and human health. Your product contains batteries, which cannot be disposed of with normal household waste.

Please inform yourself about the local rules on separate collection of batteries. The correct disposal of batteries helps prevent potentially negative consequences on the environment and human health. Please visit [www.recycle.philips.com](http://www.recycle.philips.com) for additional information on a recycling center in your area.

### Environmental information

All unnecessary packaging has been omitted. We have tried to make the packaging easy to separate into three materials: cardboard (box), polystyrene foam (buffer) and polyethylene (bags, protective foam sheet.)

Your system consists of materials which can be recycled and reused if disassembled by a specialized company. Please observe the local regulations regarding the disposal of packaging materials, exhausted batteries and old equipment.



### Note

- The type plate is located on the back of the apparatus.



2016 © Gibson Innovations Limited. All rights reserved.  
This product has been manufactured by, and is sold under the responsibility of WOOX Innovations (Shanghai) Commercial Company Ltd., and WOOX Innovations (Shanghai) Commercial Company Ltd., is the warrantor in relation to this product.  
Philips and the Philips Shield Emblem are registered trademarks of Koninklijke Philips N.V. and are used under license.

SBM150\_93\_UM\_V3.0

