

Always there to help you

Register your product and get support at

www.philips.com/welcome

PD9015



User manual	3
-------------	---

Benutzerhandbuch	79
------------------	----

Mode d'emploi	157
---------------	-----

Manual del usuario	235
--------------------	-----

Brugervejledning	41
------------------	----

Gebruiksaanwijzing	119
--------------------	-----

Manuale utente	197
----------------	-----

Användarhandbok	273
-----------------	-----

PHILIPS

Contents

1 Important	5
Safety and notice	5
Safety	5
Compliance	7
Care of the environment	7
Copyright	9
Warranty	9
2 Your new player	10
What's in the box	10
Overview	11
3 Get started	16
Charge power	16
Install remote control battery	18
Switch on/off	18
Select OSD language	19
4 Play discs	21
Play options	21
Parental control	24
Screen saver	25
Connect additional equipment	25
DVD Settings	26

5	Watch digital TV and listen to the radio	28
	Connect TV antenna	28
	First-time setup	29
	Turn in to TV/ radio stations	30
	Setup	33
6	Play from USB	37
7	Product information	38
8	Troubleshooting	39

1 Important

Safety and notice

Read and understand all instructions before you use this product. If damage is caused by failure to follow the instructions, the warranty does not apply.

Safety

Only use attachments/accessories specified by the manufacturer.

The product shall not be exposed to dripping or splashing.

Do not place any sources of danger on the product (e.g. liquid filled objects, lighted candles).

Batteries (battery pack or batteries installed) shall not be exposed to excessive heat such as sunshine, fire or the like.

Danger of explosion if battery is incorrectly replaced. Replace only with the same or equivalent type.

Risk of swallowing batteries!

- The product or remote control may contain a button cell battery, which is possible to be swallowed. Keep the battery out of reach of children at all times! If swallowed, the battery can cause serious injury or death. Severe internal burns can occur within two hours of ingestion.
- If you suspect that a battery has been swallowed or placed inside any part of the body, seek immediate medical attention.
- When you change the batteries, always keep all new and used batteries out of reach of children. Ensure that the battery compartment is completely secure after you replace the battery.
- If the battery compartment cannot be completely secured, discontinue use of the product. Keep out of reach of children and contact the manufacturer.

Modification of the product could result in hazardous radiation of EMC or other unsafe operation.



Warning

- Where the MAINS plug or an appliance coupler is used as the disconnect device, the disconnect device shall remain readily operable.



Warning

- Never remove the casing of this product.
- Never lubricate any part of this product.
- Never place this product on other electrical equipment.
- Keep this product away from direct sunlight, naked flames or heat.
- Never look into the laser beam inside this product.
- Ensure that you always have easy access to the power cord, plug or adaptor to disconnect the product from the power.

Hearing safety



A pleine puissance, l'écoute prolongée du baladeur peut endommager l'oreille de l'utilisateur.



Warning

- To prevent possible hearing damage, do not listen at high volume levels for long periods.

The maximum output voltage of the player is not greater than 150 mV.

Compliance



This product complies with the radio interference requirements of the European Community.

This apparatus includes this label:



Note

- The type plate is located on the bottom of the product.

Care of the environment

Environmental information

All unnecessary packaging has been omitted. We have tried to make the packaging easy to separate into three materials: cardboard (box), polystyrene foam (buffer) and polyethylene (bags, protective foam sheet.)

Your system consists of materials which can be recycled and reused if disassembled by a specialized company. Please observe the local regulations regarding the disposal of packaging materials, and old equipment.



Your product is designed and manufactured with high quality materials and components, which can be recycled and reused.



When this crossed-out wheeled bin symbol is attached to a product it means that the product is covered by the European Directive 2002/96/EC.

Please inform yourself about the local separate collection system for electrical and electronic products.

Please act according to your local rules and do not dispose of your old products with your normal household waste. Correct disposal of your old product helps to prevent potential negative consequences for the environment and human health.



Your product contains batteries covered by the European Directive 2006/66/EC, which cannot be disposed with normal household waste. Please inform yourself about the local rules on separate collection of batteries because correct disposal helps to prevent negative consequences for the environmental and human health. Always bring your product to a professional to remove the built-in battery.

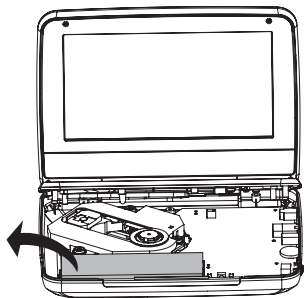

Copyright



This item incorporates copy protection technology that is protected by U.S. patents and other intellectual property rights of Rovi Corporation. Reverse engineering and disassembly are prohibited.

Specifications are subject to change without notice. Trademarks are the property of Koninklijke Philips Electronics N.V. or their respective owners. Philips reserves the right to change products at any time without being obliged to adjust earlier supplies accordingly.



Manufactured under license from Dolby Laboratories.
Dolby and the double-D symbol are trademarks of Dolby Laboratories.

Warranty

- Never attempt to repair the product, this could lead to the risk of injury, damage to the product and will void your warranty.
- Use the product and accessories only as intended by the manufacturer. The caution sign printed on the back of the product indicates risk of electric shock.
- Never remove the cover of the product. Always contact Philips Customer Support for service or repairs.
- Any operation expressly prohibited in this manual, or any adjustments and assembly procedures not recommended or authorized in this manual shall void the warranty.

2 Your new player

On PD9015, you can do the following:

- You can play the following discs (including CD-R, CD-RW, DVD±R and DVD±RW):
- DVD-Video, Video CD, Audio CD, MP3 CD, Discs with JPEG files;
- Receive digital TV/ radio programs from the the Digital Video Broadcasting (DVB-T) services;
- Play media that you store on the USB mass storage device.

What's in the box

Check and identify the contents of your package:

- Portable DVD player
- Remote control
- AC power adaptor, DC120150110 (Philips)
- Car adaptor
- AV cable
- Mounting bag
- Antenna
- User manual

Overview

Main unit

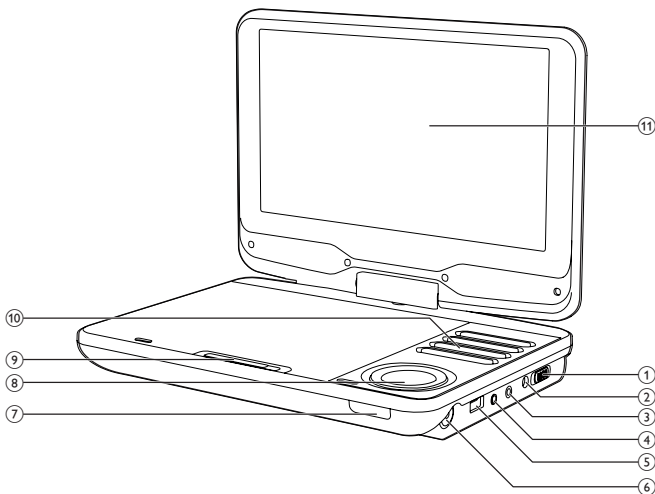

- ① **•ON OFF•**
 - Slide to switch the player on/ off.
- ② **DC IN 12V**
 - Power supply socket
- ③ **PHONE**
 - Headphone jack
- ④ **AV OUT**
 - Audio/video output jack
- ⑤ **USB**
 - Connector for USB devices

- ⑥ **Antenna jack**
- ⑦ **CHR/IR**
- Charging indicator/Remote control sensor
- ⑧ **▲ (CH+), ▼ (CH-), ◀ ▶**
- Navigates menus.
- ▲ (CH+), ▼ (CH-)**
- **DVB-T:** Switches to the next or previous channel.
- ◀▶**
- **DVD/USB:** Searches backward/forward at different speeds.
- OK/ ▶||**
- Confirms an entry or selection.
 - **DVD/USB:** Starts, pauses or resumes play.
- ⑨ **OPEN**
- Opens the disc compartment.
- ⑩ **SETUP**
- Accesses or exits the setup menu.
- SOURCE**
- Switches between DVD, DVB-T and USB.
- DVD MENU**
- For DVD, accesses or exits disc menu.
 - For VCD, turns on or off PBC (Playback Control) mode.
- EXIT/ ■**
- **DVD/USB:** Stops play.
 - **DVB-T:** Goes to the previous menu.
- VOL +/-**
- Adjusts volume.
- ◀◀ / ▶▶**
- **DVD/USB:** Skips to the previous or next title, chapter, or track.
- ⑪ **Display panel**

Remote control

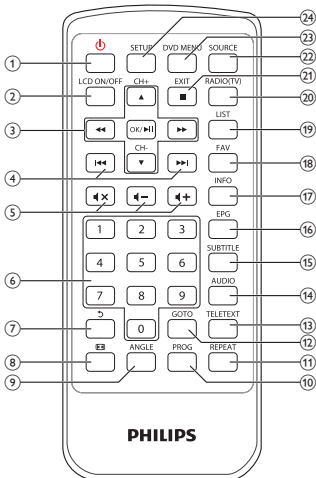

- ①
 - Switches the player on from standby or back to standby.
- ② **LCD ON/OFF**
 - Switches on/off the screen.
- ③ **▲ (CH+), ▼ (CH-), ◀, ▶**
 - Navigates menus.**▲ (CH+), ▼ (CH-)**
 - **DVB-T:** Switches to the next or previous channel.**◀◀, ▶▶**
 - **DVD/USB:** Searches backward/forward at different speeds.**OK/▶||**
 - Confirms an entry or selection.
 - **DVD/USB:** Starts, pauses, or resumes play.
- ④ **◀◀/▶▶**
 - **DVD/USB:** Skips to the previous or next title, chapter, or track.

- ⑤ **⏮ / ⏭**
- Increases or decreases volume.
- ⏮ ×**
- Mutes or restores volume.
- ⑥ **0-9**
- Numeric keypad
- ⑦ **↶**
- DVD:** (For VCD, PBC on) Return to the PBC menu.
 - DVB-T:** Returns to the previous channel; renames channels in Program Edit menu.
 - USB:** Returns to the previous folder.
- ⑧ **⏮ ⏭**
- DVD/USB:** Zooms in or out a picture/video image.
 - DVB-T:** Adjusts screen aspect ratio.
- ⑨ **ANGLE**
- DVD:** Selects a different viewing angle of a DVD.
- ⑩ **PROG**
- DVD:** Program tracks.
- ⑪ **REPEAT**
- DVD/USB:** Repeats a chapter/track/title.
- ⑫ **GO TO**
- DVD/USB:** Skip to a chapter/track/title or a play time.
- ⑬ **TELETEXT**
- DVB-T:** Toggles teletext on or off.
- ⑭ **AUDIO**
- DVD:** For DVD, selects an audio language; for VCD, selects an audio mode.
 - DVB-T:** Selects an audio language of present service.
 - USB:** For movie, selects an audio mode.
- ⑮ **SUBTITLE**
- DVD:** Selects DVD subtitle language.
 - DVB-T:** Selects subtitle language of present service.
 - USB:** Accesses the subtitle menu.

- ⑩ **EPG**
 - **DVB-T:** Toggles the Electronic Program Guide (EPG) on or off. Enabled on digital channels only.
- ⑪ **INFO**
 - **DVD/USB:** Displays play information, if available.
 - **DVB-T:** Displays program information, if available.
- ⑫ **FAV**
 - **DVB-T:** Accesses or exits the favorite channel list.
- ⑬ **LIST**
 - **DVB-T:** Displays the list of channels.
- ⑭ **RADIO (TV)**
 - **DVB-T:** Switches between radio and TV.
- ⑮ **EXIT/ ■**
 - **DVD/USB:** Stops play.
 - **DVB-T:** Goes to the previous menu.
- ⑯ **SOURCE**
 - Switches between DVD, DVB-T and USB.
- ⑰ **DVD MENU**
 - For DVD, accesses or exits disc menu.
 - For VCD, turns on or off PBC (Playback Control) mode.
- ⑱ **SETUP**
 - **DVD/DVB-T:** Selects or exits the setup menu.

3 Get started



Caution

- Use the controls only as stated in this user manual.
- Always follow the instructions in this chapter in sequence.

If you contact Philips, you will be asked for the model and serial number of your player. The model number and serial number are on the bottom of your player. Write the numbers here:

Model No. _____

Serial No. _____

Charge power

Charge through the AC adaptor





Caution

- Risk of product damage. Ensure that the power supply voltage corresponds to the voltage printed on the bottom of the player.

You can only charge the player when it is powered off or in standby mode.

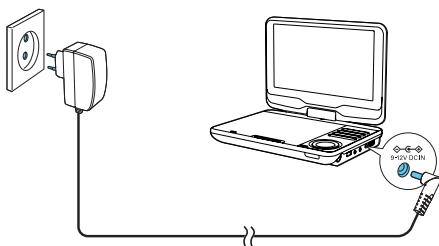
- 1 Make sure that you have connect the player to power.



- 2 On the main unit, slide the **•ON OFF•** switch to the **OFF** position.
- Alternatively, press  on the remote control to switch to standby mode.
 - ↳ The **CHR** indicator turns on (red).
 - ↳ When the battery is fully charged, the **CHR** indicator turns off.



Tip

- To maximize battery life, recharge the battery immediately once the battery is fully discharged. If you do not use the player for a long time, fully recharge the battery once every two months.

Charge through the car adaptor

Connect the supplied car adaptor to the player and car cigarette lighter.

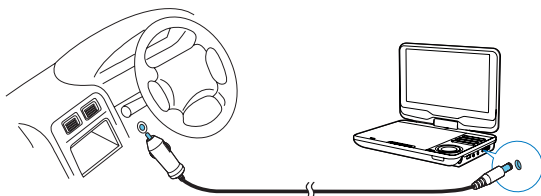

Install remote control battery



Caution

- Risk of explosion! Keep batteries away from heat, sunshine or fire. Never discard batteries in fire.
- Danger of explosion if battery is incorrectly replaced. Replace only with the same or equivalent type.
- Batteries contain chemical substances, they should be disposed of properly.
- Perchlorate Material - special handling may apply. See www.dtsc.ca.gov/hazardouswaste/perchlorate.

For first-time use:

- 1 Remove the protective tab to activate the remote control battery.

To replace the remote control battery:

- 1 Open the battery compartment.
- 2 Insert one CR2025 battery with correct polarity (+/-) as indicated.
- 3 Close the battery compartment.

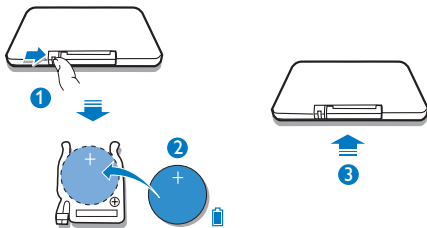

Switch on/off

- 1 To switch on, slide •ON OFF• to the ON position on the main unit.

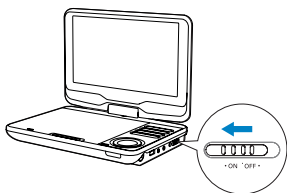

↳ The **CHR** indicator turns on (green).

- 2 To switch off, slide **•ON OFF•** to the **OFF** position on the main unit.
 - Alternatively, press  on the remote control to switch to standby mode.
 - ↳ The **CHR** indicator turns on (red).The battery charging starts.
 - ↳ When the battery is fully charged, the **CHR** indicator turns off.

Auto standby

In DVB-T mode or USB mode, if there is no button press or media play on the player for three hours, the player switches to standby mode to save power.

In the DVB-T mode, press **SETUP**. Go to **[Time] > [Auto Standby]**. Press **◀◀ / ▶▶** to select **[On]**.

Select OSD language

You can select a different language for the onscreen menus.

In DVD mode

- 1 Press **SETUP**.
 - ↳ The setup menu is displayed.
- 2 Go to **[Language] > [Language]**, then press **OK/▶▶**.
- 3 Press **▲ / ▼** to select a language.
- 4 Press **OK/▶▶** to confirm.
- 5 Press **SETUP** to exit.

In DVB-T mode

- 1** Press **SETUP**.
↳ The setup menu is displayed.
- 2** Go to **[Option] > [OSD Language]**.
- 3** Press **◀◀ / ▶▶** to select a language.
- 4** Press **SETUP** to exit.

4 Play discs

- 1 Slide **OPEN** on the player.
↳ Remove the protective card, if you use the player for the first time.
- 2 Insert the disc with label side facing up.
- 3 Push down to close the disc compartment.
↳ Play starts automatically. If not, press **OK/▶||**.
 - If a menu is displayed, select an item, then press **OK/▶||** to start play.
 - To pause, press **OK/▶||**. Press again to resume play.
 - To stop, press **EXIT/■**.
 - To select the previous/next item, press **◀◀** or **▶▶**.
 - To start search within video/audio, press **◀◀** or **▶▶** once or more.

Play options

Use the disc menu

For VCDs with play Control (PBC) feature (version 2.0 only) and SVCDs,

- 1 Press **DVD MENU** repeatedly to select PBC off or PBC on.
↳ If PBC off, the play starts automatically.

During play,

- If PBC on, press **U** to return to the menu screen.



Tip

- If PBC is on, the numeric keypad (0-9) is disabled.

Program

For VCD/SVCD/DVD discs,

- 1 During play, press **PROG** on the remote control.
↳ The program menu is displayed.
- 2 Enter the corresponding number of the title/chapter/track with the numerical keys (0-9).
- 3 Select **Add to Program** and press **OK** to confirm.
- 4 Repeat steps 2-3 to program other title/chapter/track.
- 5 To play the program, select **[Play]** and then press **OK** to confirm.
 - To exit the program menu, press **PROG** once.
 - To clear the program, select **[Clear Program]** and then press **OK** to confirm.

Repeat

- 1 During play, press **REPEAT** repeatedly to select the following repeat options:

For DVD

- **[Repeat Chapter]** (current chapter)
- **[Repeat Title]** (current title)
- **[Repeat off]**

For CD/VCD/SVCD

- **[Repeat Single]** (current track)
- **[Repeat All]** (entire disc)
- **[Repeat off]**

For JPEG/MP3

- **[Repeat Single]** (current file)
- **[Repeat Folder]** (current folder)
- **[Repeat off]**



Tip

- For VCD/SVCD, if PBC is on, you cannot repeat items.

Search by time or title/chapter/track number

- 1 During video/audio play, press **GO TO**.
- 2 Enter the selected time or number.
 - In the title/chapter/track field, enter the title/chapter/track number.
 - In the time field, enter the play position in sequence of hour, minute, and second.
- 3 Press **OK**.
 - ↳ Play starts automatically at the selected point.

To skip to any title/chapter/track directly,

- During play, enter the corresponding number of the title/chapter/track with the numerical keys (0-9).
- Press **OK** to confirm if needed.

Select audio language

For DVDs that contain two or more audio languages.

- During play, press **AUDIO** repeatedly until the language is selected.

Select subtitle language

For DVDs that contain two or more subtitle languages.

- During play, press **SUBTITLE** repeatedly until the language is selected.

Select an audio mode

For VCDs/MP3-CDs with two or more audio tracks,

- Press **AUDIO** repeatedly to select an audio channel: **[Left]**, **[Right]**, **[Mix]**, or **[Stereo]**.





Select a view angle

To select a view angle for DVD,

- During play, press **ANGLE** repeatedly on the remote control.





Zoom

For DVD,VCD and JPEG CDs, you can zoom into or out of an image.

- 1 Press  repeatedly to zoom into or out of an image.
- 2 When the image is enlarged, press  /  /  /  to pan through it.

Rotate pictures

For JPEG CDs only. While the JPEG is displayed:

- Press  to rotate counter-clockwise.
- Press  to rotate clockwise.
- Press  to flip up/down.
- Press  to flip left/right..

Parental control

Restrict access to discs that are unsuitable for children. These types of discs must be recorded with ratings.

- 1 Press **SETUP**.
- 2 Select **[Rating] > [Parental control]**. Press **OK**.
↳ Password menu is displayed.
- 3 Enter your current password (or '6666' by default). Press **OK**.
- 4 Press **OK**.
↳ A list of rating levels is displayed.
- 5 Select your level. Press **OK**.



Note

- To play a disc with the rating level higher than what you have set in **[Parental control]**, you need to enter the password.
- The ratings are country-dependent. To allow all discs to play, select **'8'** for DVD-video and BD-Video.
- Some discs have ratings printed on them but are not recorded with ratings. This function has no effect on such discs.

Change the password

- 1 Press **SETUP**.
- 2 Select **[Rating] > [Set Password]**, press **OK**.
↳ Password menu is displayed.
- 3 Enter your current password, and then press **OK** to confirm.
 - The default password is 6666.
- 4 Press **OK**.
- 5 Enter your new 4-digit password, and then press **OK** to confirm.
- 6 Enter the new password again, and then press **OK** to confirm.
- 7 Press **SETUP** to exit.

Screen saver

From the Home screen, go to **SETUP**. Select **[Misc] > [Screen saver]**. Press **◀◀ / ▶▶** to switch on screen saver.

- If there is no button press or media play on the player for 5 minutes, the screen saver is activated.
- To exit the screen saver, press any button.



Note

- Screen saver is only available for disc play.

Connect additional equipment

You can connect the player to a TV or an amplifier to enjoy DVDs.



Caution

- Turn off your player before you connect it to any additional equipment.

You can connect the player to a TV or an amplifier to enjoy the video/ audio play.

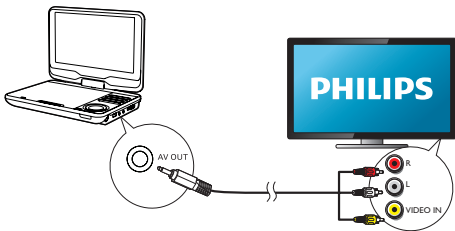

Match the color of the AV cables with the jacks:

- the yellow cable is for the yellow video jack
- the red/white cable is for the red/white audio jacks.

DVD Settings

To maximize your DVD play experience, use **SETUP** to fine tune your settings.

- 1 Press **SETUP**.
↳ The setup menu is displayed.
- 2 Use navigation keys to select an option and press **▶||/OK** to confirm.
 - [Language]
 - [Language]: Select onscreen display language.
 - [Subtitle]: Select a DVD subtitle language.
 - [MPEG4 subtitle]: Select a subtitle for a video disc.
 - [Audio]: Select a DVD audio language.
 - [DVD menu]: Select a DVD menu language.
 - [Video]
 - [Aspect Ratio]: Set screen display aspect ratio.
 - [TV System]: Set video output format to TV system.

[Audio]

- **[Night Mode]**: Select quiet or full dynamic sound.
- **[Smart Sound]**: Select a sound effect for music.

[Rating]

- **[Parental control]**: Select a parental level.
- **[Set Password]**: Change existing password (6666 by default).

[Misc]

- **[Use Default Settings]**: Restore default settings.
- **[Screen saver]**: Activate/deactivate screen saver.

3 Press ◀◀ to go back to the previous menu.

4 Press **SETUP** to exit.

5 Watch digital TV and listen to the radio



Note

- Before you start, make sure that you have connected the antenna to the player.
- Make sure that you are in an area with sufficient DVB-T signal coverage. You can check the signal coverage with the TV/radio broadcast authority of your country or visit www.philips.com/support.

Connect TV antenna

To watch HDTV programs on the player, connect one of the TV antennas to the player:

- the supplied antenna, or
- your home antenna.

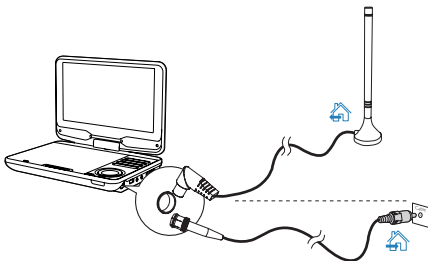

- Connect the antenna to the antenna jack.



Tip

- For better reception, connect the player to home antenna.

First-time setup

- 1 Press **SOURCE** to switch to DVB-T mode.
 ↳ An Installation Guide menu is displayed, when you use the player for the first time.



- 2 In **[OSD Language]**, press ◀▶ to select an OSD language.
- 3 In **[Country]**, press ◀▶ to select the county of your current location.
- 4 Select **[Channel Search]**, then press **OK** to confirm.
 ↳ Auto channel search starts.
 ↳ When the auto channel search is complete, the first TV service starts to play.

Auto search

When you move to a new place (such as a new city or country), restart auto search for better reception.

- 1 On the remote control, press **SETUP**.
- 2 Go to **[Channel Search] > [Auto Search]**.
 ↳ The player starts to search for available services.
 ↳ When the auto search is complete, the first TV service starts to play.

Manual search

You can search TV channels manually.

- 1 Press **SETUP**.
- 2 Select **[Channel Search] > [Manual Search]**.
- 3 Press **◀◀ / ▶▶** to select a channel number, or enter the channel number with the numerical keys.
- 4 Press **OK** to confirm.

Turn in to TV/ radio stations

- 1 Press **SOURCE** to switch to DVB-T mode.
- 2 Press **RADIO (TV)** to select radio or TV mode.
 - To change the volume, press **◀+ / ▶-**.To change channels,
 - press **CH+/CH-**.Or
 - Enter the channel numbers with the numeric keys.

Rearrange the channel list

- 1 Press **SETUP**.
 - ↳ The Setup menu is displayed.
- 2 Select **[Program] > [Program Edit]**, press **OK**.
 - Enter the current password (000000 by default).
 - ↳ A Program Edit menu is displayed.

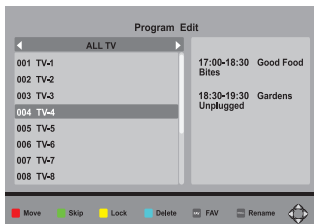

- 3 Select the channel, and press the red button.
- 4 Press **▲** / **▼** to move the channel up or down.
- 5 Press **OK** to confirm.

Manage channel

Select the channel, and then follow the onscreen instructions.

- To skip the channel, press the green button.
- To lock the channel, press the yellow button.
- To delete the channel, press the blue button. Press **OK** to confirm.
- Press **FAV** to add the channel to the favorite list. To delete from your favorite list, press **FAV** again.
- To rename the channel, press **↻**.

View program information (DTV)

To view brief information of the current program, press **INFO**; to view detail information, press **INFO** twice.

- To exit the program information page, press **EXIT** / **■**.

Access teletext

If the current channel has teletext, press **TELETEXT** to access.



Tip

- The program may request using color keys to access or control the viewing features. Follow the instructions on the teletext screen.

Set time

- 1 Press **SETUP**.
- 2 Select **[Time]**.

To select time setting mode:

- 1 Select **[Time offset]**.
- 2 Press **◀◀ / ▶▶** to select an option, then press **OK** to confirm.
 - **[Auto]**: The time zone is updated automatically according to the broadcasted TV channel.
 - **[Manual]**: Set your time zone manually.

To set time zone:

- 1 Select **[Time offset]**.
- 2 Press **▶▶** to select **[Manual]**.
- 3 Select **[Time Zone]**.
- 4 Press **◀◀ / ▶▶** to select a time zone.
 - Select GMT +1 for Germany and Central Europe (time difference with regard to the Greenwich mean time)

Use the electronic program guide

EPG is an onscreen guide available for TV programs. You can navigate, select, and view programs of the following 8 days by time or title.

- 1 Select a channel in the TV mode.
- 2 Press **EPG**.
➞ The Electronic Program Guide menu is displayed.



- 3 Press ◀◀ / ▶▶ to select a channel.
- 4 Press ▲ / ▼ to select a program.
- 5 Press **OK**.
 - ↳ The brief information of this program is displayed.
 Follow the onscreen instructions.
 - To switch programs to the previous/next day, press the red/yellow button.
 - To view the programs information in the previous/next page, press green/blue button.
- 6 To exit the EPG menu, press **EPG**.

Setup

You can change the setup options of the player.

- 1 On the remote control, press **SETUP**.
 - ↳ The setup menu is displayed.

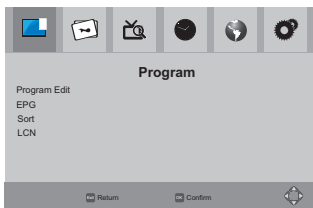

- 2 To select an option,
 - Press ◀◀ / ▶▶ to switch to a menu: **[Program]**, **[Picture]**, **[Channel Search]**, **[Time]**, **[Option]**, and **[System]**.
 - ① Press ▲ / ▼ to select a menu item.
 - ② Press ◀◀ / ▶▶ to select an option.
- 3 To exit, press **EXIT** / ■.

Program

[Program Edit]: Edit the list of services. You can change the sequence of the services, change the service names, and lock, skip, and delete some services.

[EPG]: Check the program information and schedules.

[Sort]: Sort the list of services in different ways.

[LCN]: Select whether to keep the logical channel numbers of the services.

To re-assign channel numbers to the services, switch off **[LCN]**.

Picture

[Aspect Ratio]: Select display aspect ratio.

[TV Format]: Select video output format to TV system.

Channel Search

[Auto Search]: Start the auto search of available DVB-T services.

[Manual Search]: Search a DVB-T service by service name or frequency.

[Country]: Select the country of your current location.

[Antenna Power]: Increase the power of the external antenna.

Time

[Time offset]: Select **[Auto]** to use the time of the DVB-T services. Select

[Manual] to select your time zone in **[Time Zone]**.

[Country Region]: Select the country of your current location.

[Time Zone]: To select your time zone, select **[Manual]** in **[Time offset]**.

[Auto Standby]: Switch the player off automatically when there is no button press or media play for three hours.

Option

[OSD Language]: Select languages for the onscreen menus.

[Subtitle Language]: Select languages for the subtitle.

[Audio Language]: Select languages for the audio.

System

[Parental Guidance]

you can set password to programs with age restrictions.

- Enter your password to select an age level (000000 by default).

[Set Password]

Set or change the password that you use in [Program Edit], [Parental Guidance] and [Restore Factory Default].



Tip

- If you forget your last saved password, you can enter 888888 to unlock. Then, you can enter a new password.

[Restore Factory Default]

You can reset your player settings to the original factory settings.

- Enter your password (000000 by default).

[Information]

check the information about your player. Before you upgrade the firmware, check current version information of your player.

[Software Update]

You can update the firmware through a storage device.

- 1 On your computer, do the following:
 - ① Go to www.philips.com/support to find the latest firmware.
 - ② Search for your model and click on "Software and drivers".
 - ③ Download the firmware update and save the file to the root directory of a USB storage device.
- 2 On the player, do the following:
 - ① Connect the USB storage device.
 - ② On the remote control, press **SETUP**, select [System]>[Software Update]>[USB Upgrade].
 - ➔ If a firmware update is detected, you are prompted to start the update.

- 3** Follow onscreen instructions to complete the update.
- ↳ When the update is complete, the player switches back to Installation Guide automatically.



Caution

- Keep the player powered on and the storage device mounted before the firmware update is complete.

6 Play from USB

You can play VOB, MP3, AVI or JPEG files that are stored on a USB storage device.

- 1 Connect the USB storage device to the player.

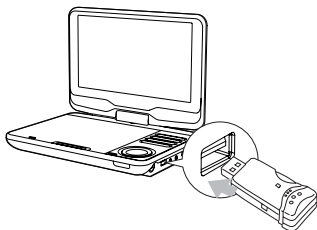

- 2 Press **SOURCE** to switch to the USB mode.
↳ The content browser is displayed.
- 3 Select a category (Music/Photo/Movie), then press **OK/▶||**.
- 4 Select a file/folder; then press **OK/▶||**.
↳ Play starts.
↳ Follow the onscreen instructions.
- 5 To stop play, press ■.

7 Product information



Note

- Product information is subject to change without prior notice.

Dimensions	239 x 39 x 178 mm
Weight	1.1 kg
AC power adaptor	DC120150110 (Philips)
Power supply	Input: 100-240V~ 50/60Hz 0.6A max Output: DC 12V \equiv 1.5A
Operating temperature range	0-35°C
Laser wavelength	650 nm
Video output	
Format	PAL & NTSC
Output level	1Vp - p \pm 20%
Load impedance	75 Ω
Audio line out	
Audio out (analog audio)	Output level: 2V \pm 10%
Load impedance	10 K Ω
Audio distortion + noise	\leq -80 (1KHz)
Frequency response	20Hz-20KHz \pm 1dB
Signal/noise ratio	\geq 80 dB
Channel separation	\geq 80 dB
Dynamic range	\geq 80 dB

8 Troubleshooting

No power

- Ensure that both plugs of the mains cord are properly connected.
- Ensure that there is power at the AC outlet.
- Check if the built-in battery is drained.

No sound

- Ensure that the AV cable is connected correctly.

No response to the remote control

- Ensure that the path between the remote control and the player is clear from obstacles.
- From a close distance, point the remote control directly at the player.
- Replace the remote control batteries.
- The function does not work for this disc. Refer to the disc instructions.

Distorted picture

- Clean the disc. With a clean, soft, lint-free cloth, wipe the disc outwards from the center.
- Make sure that the video output format of the disc is compatible with the TV.
- Change the video output format to match your TV or program.
- The LCD is manufactured using high precision technology. You may, however, see tiny black points and/or bright points (red, blue, green) that continuously appear on the LCD. This is a normal result of the manufacturing process and does not indicate a malfunction.

Cannot play disc

- Ensure the disc label is upwards.
- Clean the disc. With a clean, soft, lint-free cloth, wipe the disc outwards from the center.
- Check if the disc is defective by trying another disc.

No response to operating commands

- The operation is not permitted by the disc.

The player feels warm

- When the player is in use for a long period of time, its surface will be heated. This is normal.

No/weak signal displayed on the screen

- TV signal is too weak or out of TV signal covering area.
- Make sure you are in an area with sufficient coverage.
- Connect to your home TV antenna socket.
- Receiving TV in a driving car may cause signal problems.

TV reception with Black and White picture or no sound

- Ensure that you set the TV format correctly according to local TV broadcast specifications. If you do not know the information, contact local TV broadcast authorities for help.



Specifications are subject to change without notice
© 2012 Koninklijke Philips Electronics N.V.
All rights reserved.

PD9015_12_UM_V2.0

