

CSS7235Y

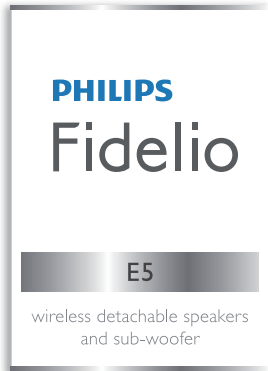

# Quick start guide

## Always there to help you

Register your product and get support at  
[www.philips.com/welcome](http://www.philips.com/welcome)



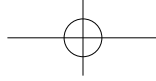

**EN** Before using your product, read all accompanying safety information

**ZH-TW** 使用您的產品前，請先閱讀所有附隨的安全資訊

**KO** 제품을 사용하기 전에 제공된 모든 안전 정보를 숙지하십시오

**TH** ก่อนใช้งานผลิตภัณฑ์ของคุณ โปรดอ่านข้อมูลด้านความปลอดภัยที่มีให้โดยละเอียด

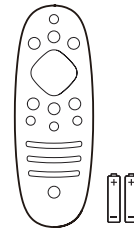
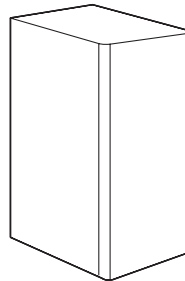
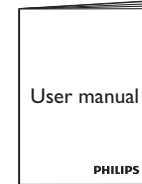
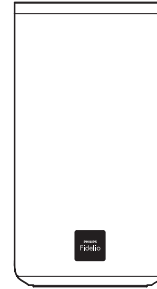
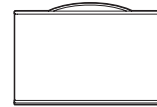

DIN Cable

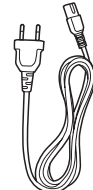

2 x Power Cord



# 1

**EN** Position your product

\* Charge the surround speakers before use (see the user manual for details)

**ZH-TW** 安置本產品

\* 使用前請為本產品揚聲器充電（參閱使用手冊瞭解詳細資料）

**KO** 제품 위치 설정

\* 사용하기 전에 서라운드 스피커 충전(자세한 내용은 사용 설명서 참조)

**TH** จัดวางผลิตภัณฑ์ของคุณ

\* ชาร์จไฟที่ลำโพงเซอร์ราวด์ก่อนการใช้งาน (โปรดดูคู่มือการใช้งานสำหรับรายละเอียด)

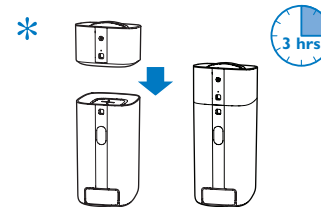
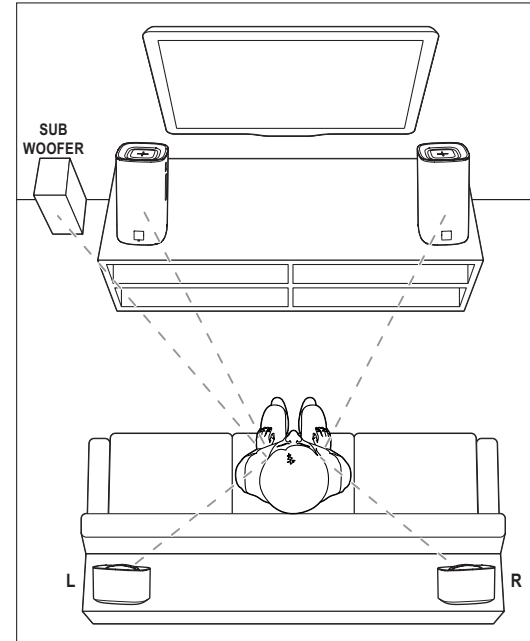



# 2

**EN** Connect your product

**ZH-TW** 連接本產品

**KO** 제품 연결

**TH** เชื่อมต่อผลิตภัณฑ์ของคุณ

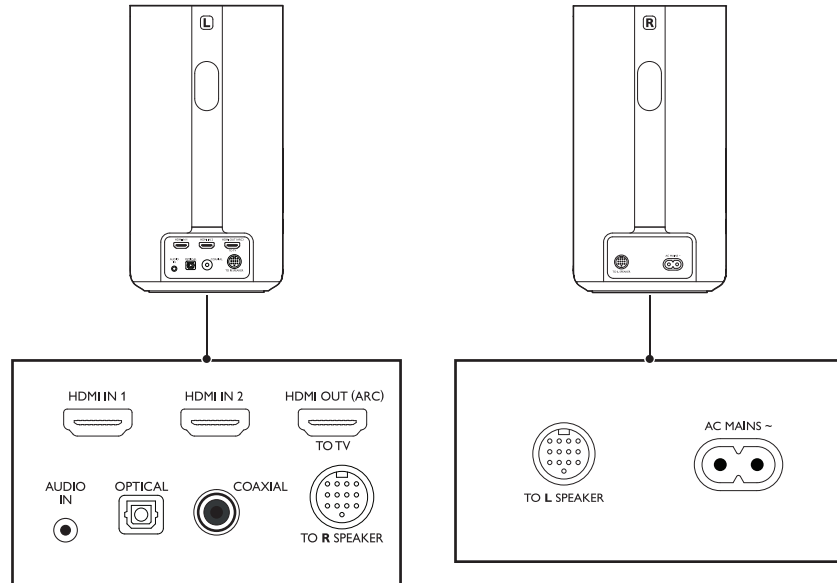

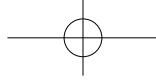

# 3

**EN** Hear audio from TV in one of the following ways

**ZH-TW** 用下列其中一種方式聆聽電視的音訊

**KO** 다음 중 한 가지 방법으로 TV 오디오 청취

**TH** ฟังเสียงจากทีวีด้วยวิธีใดวิธีหนึ่งต่อไปนี้

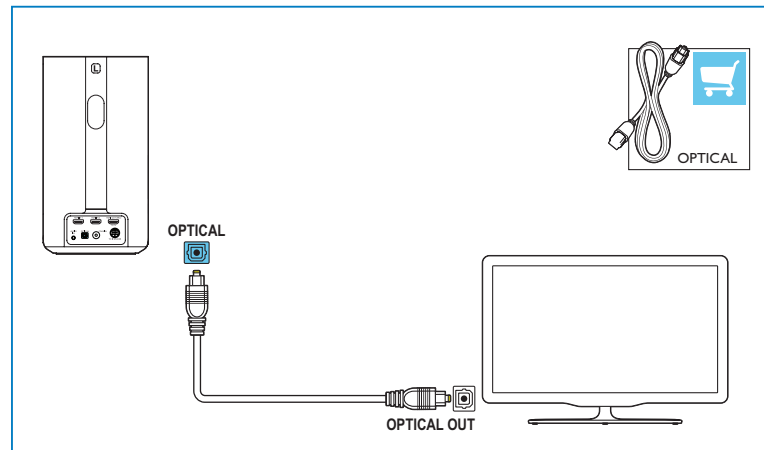
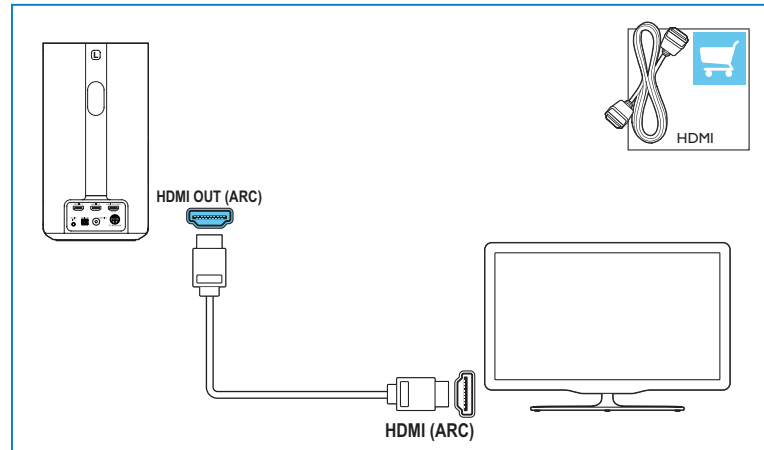

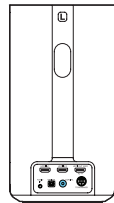

COAXIAL



COAXIAL OUT

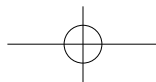
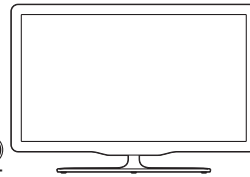

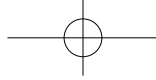

# 4

**EN** Enjoy audio and video from your devices

**ZH-TW** 享受裝置的音訊及視訊

**KO** 장치의 오디오 및 비디오 감상

**TH** เพลิดเพลินไปกับเสียงและวิดีโอจากอุปกรณ์ของคุณ

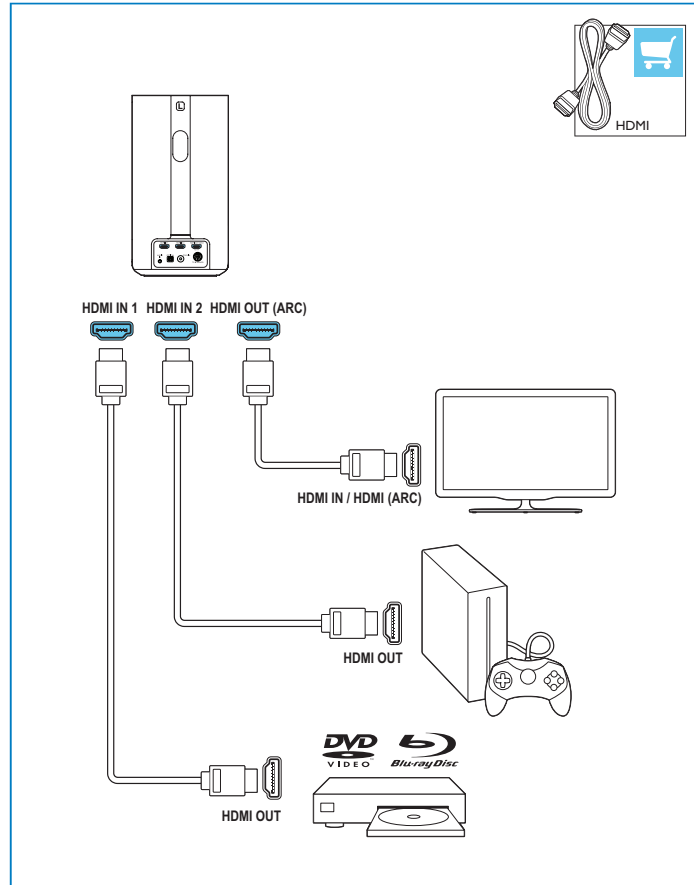

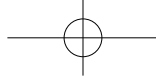

# 5<sub>a</sub>

**EN** Switch on your product

**ZH-TW** 啟動本產品

**KO** 제품의 전원 켜기

**TH** เปิดการทำงานผลิตภัณฑ์ของคุณ

1

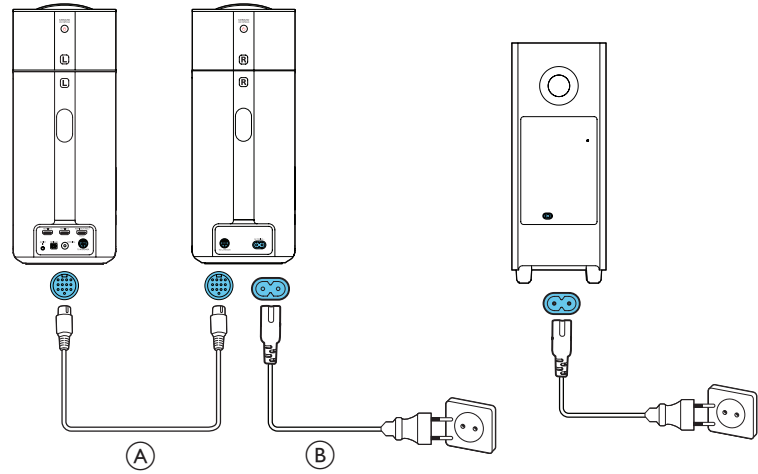

2

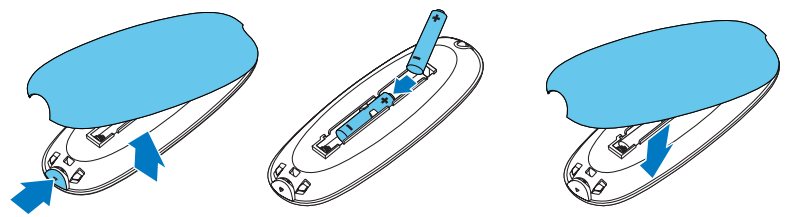



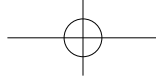

# 5<sub>b</sub>

**EN** Switch on your product + LED behavior explanation

**ZH-TW** 啟動本產品 + LED燈顯示說明

**KO** 제품의 전원 켜기+ LED 동작 설명

**TH** เปิดการทำงานผลิตภัณฑ์ของคุณ + การอธิบายการแสดงผลไฟ LED

3

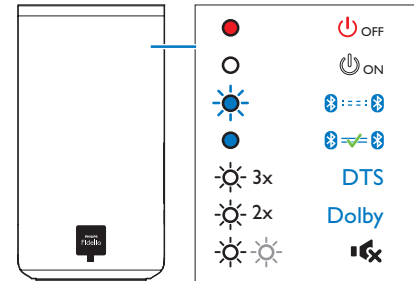
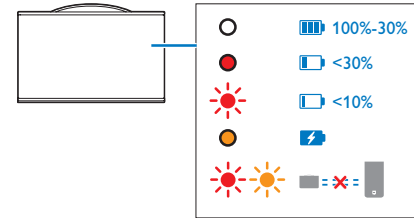
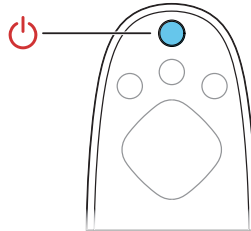

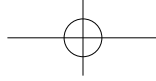

# 6

**EN** Select the correct audio source

**ZH-TW** 選取正確的音訊輸入

**KO** 정확한 음원 선택

**TH** เลือกแหล่งสัญญาณเสียงที่ถูกต้อง

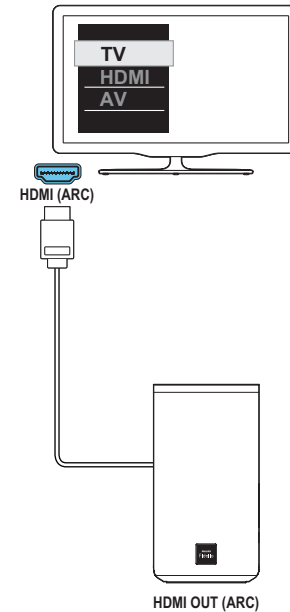
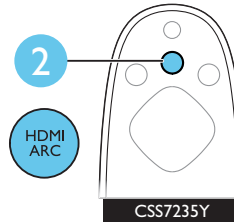
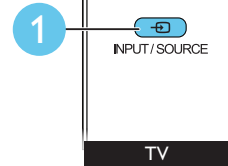

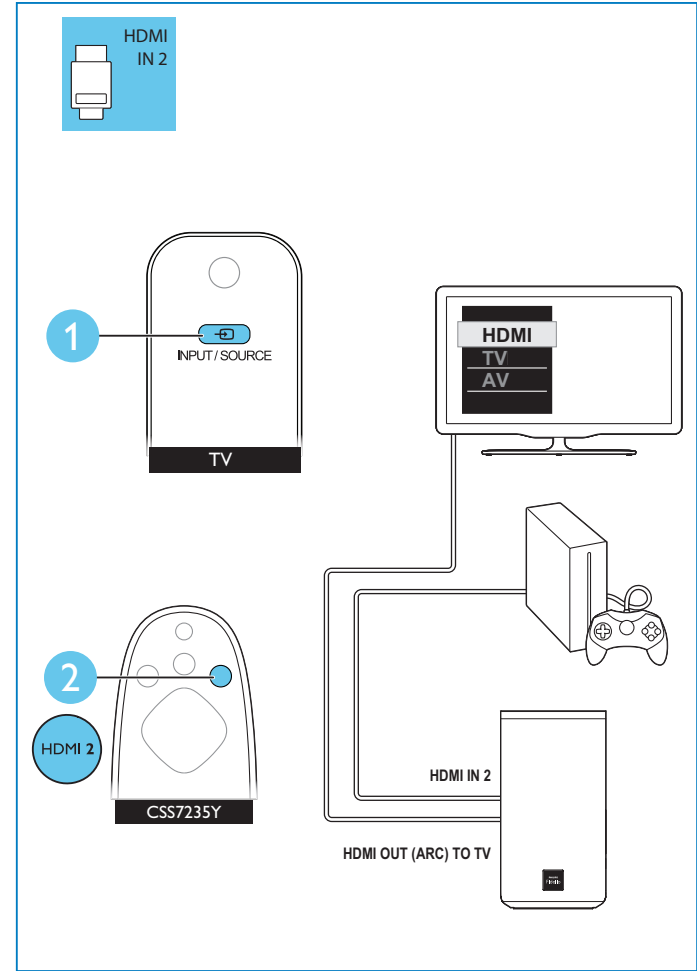
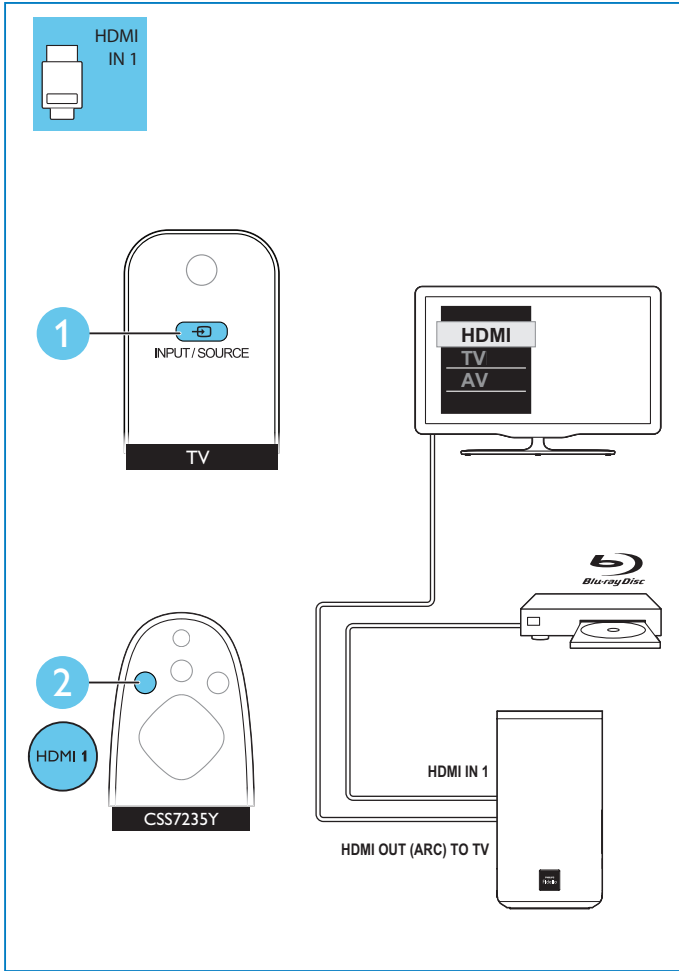
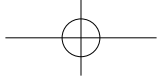

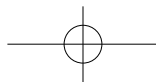
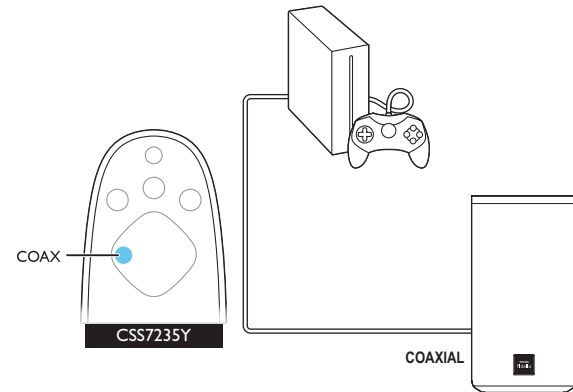
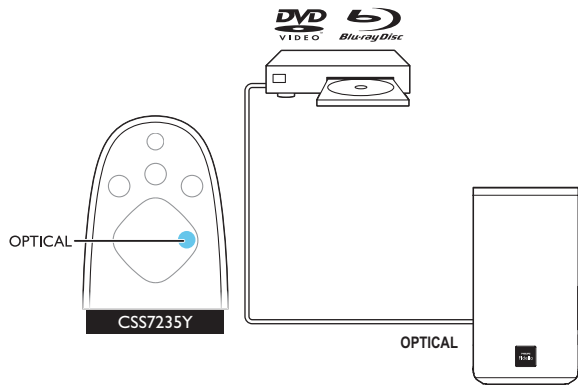
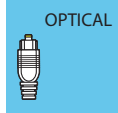

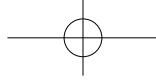

# 7

**EN** Play other devices

**ZH-TW** 播放其它装置

**KO** 기타 장치 재생

**TH** เล่นอุปกรณ์อื่น

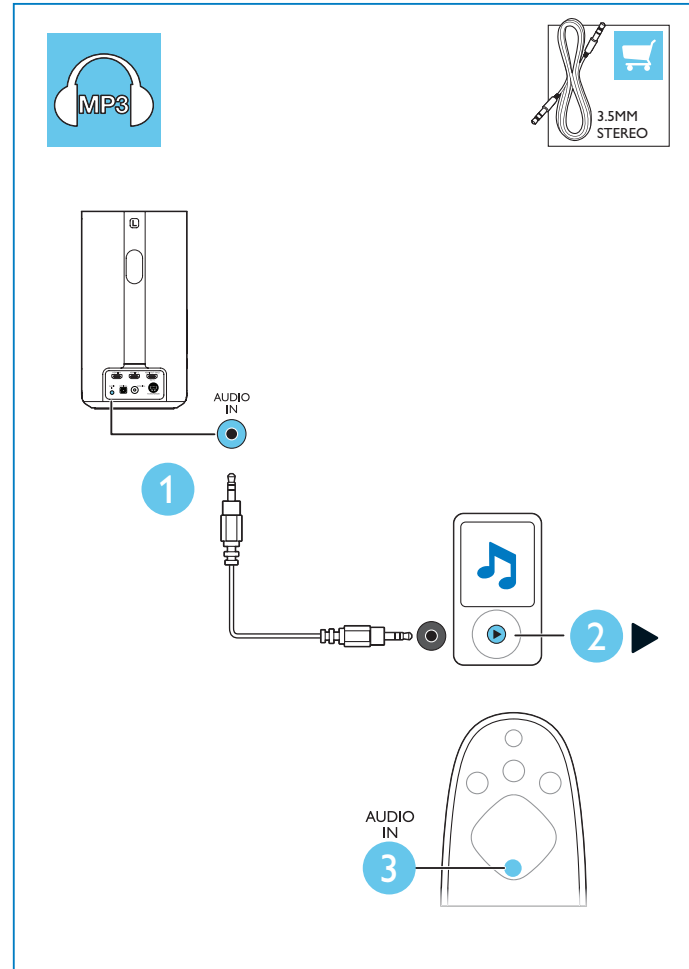



# 8

**EN** Play audio through Bluetooth  
(or NFC)

**ZH-TW** 透過藍牙播放音訊 (或NFC)

**KO** Bluetooth를 통한 오디오 재생  
(또는 NFC)

**TH** การเล่นเสียงผ่านทาง Bluetooth  
(หรือ NFC)

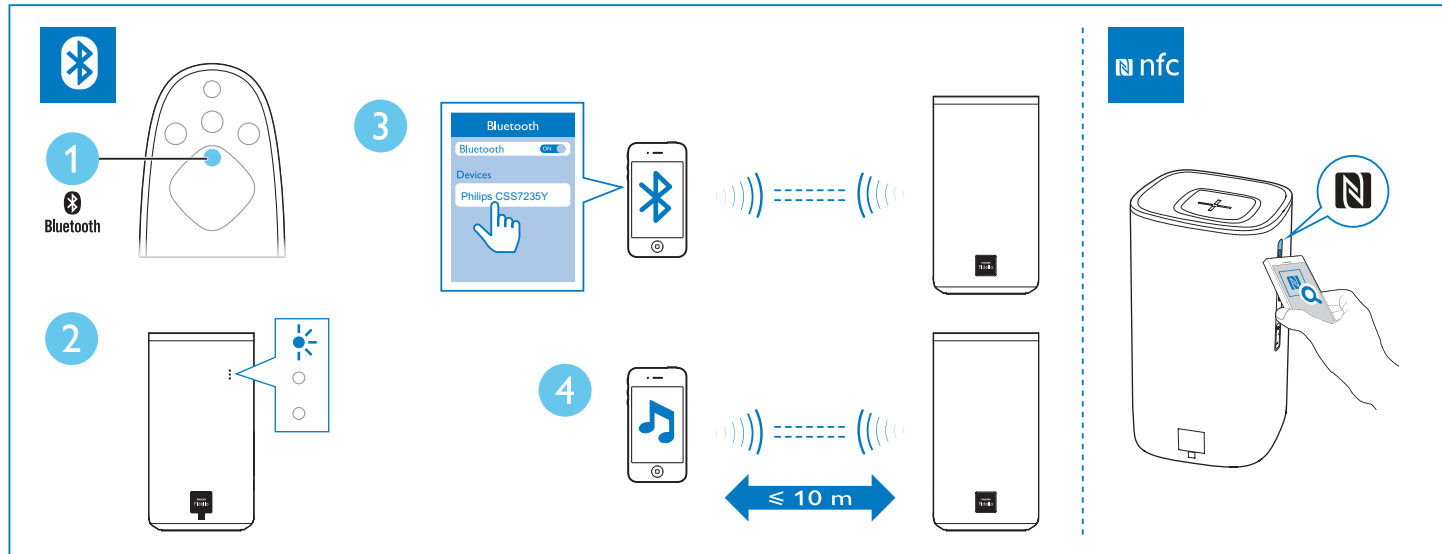



**EN** For more information about using this product, visit [www.philips.com/support](http://www.philips.com/support)

**ZH-TW** 如果要瞭解產品的更多資訊，請瀏覽 [www.philips.com/support](http://www.philips.com/support)。

**KO** 본 제품의 자세한 사용 방법을 확인하려면 [www.philips.com/support](http://www.philips.com/support) 를 방문하십시오.

**TH** สำหรับข้อมูลเพิ่มเติมเกี่ยวกับ การใช้ผลิตภัณฑ์นี้ โปรดเยี่ยมชม [www.philips.com/support](http://www.philips.com/support)



[www.philips.com/support](http://www.philips.com/support)

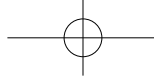

Specifications are subject to change without notice  
2014 © WOOX Innovations Limited. All rights reserved.  
Philips and the Philips' Shield Emblem are registered trademarks of Koninklijke Philips N.V. and are used by WOOX Innovations Limited under license from Koninklijke Philips N.V.

CSS7235Y\_98\_QSG\_V1.0

