

Register your product and get support at
www.philips.com/welcome

FWM200D/12



EN	User manual	3
DA	Brugervejledning	21
DE	Benutzerhandbuch	39
ES	Manual del usuario	57

FR	Mode d'emploi	75
IT	Manuale utente	93
NL	Gebruiksaanwijzing	113
SV	Användarhandbok	131

PHILIPS

Contents

1	Important	4
	Safety	4

2	Your Mini Hi-Fi System	5
	Introduction	5
	What's in the box	5
	Overview of the main unit	6
	Overview of the remote control	7

3	Get started	9
	Connect speaker	9
	Prepare the remote control	9
	Connect power	9
	Set clock	10
	Turn on	10

4	Play	11
	Basic play operations	11
	Play disc	11
	Play from iPod/iPhone	11
	Play from USB	12
	Play audio from an external device	12

5	Play options	13
	Adjust sound	13
	Repeat and shuffle play	13
	Program tracks	13
	Display different information	13

6	Listen to FM radio	14
	Tune to FM radio stations	14
	Store FM radio stations automatically	14
	Store FM radio stations manually	14
	Select a preset radio station	14

7	Other features	15
	Set alarm timer	15
	Set sleep timer	15

8	Product information	16
	Specifications	16
	USB playability information	17
	Supported MP3 disc formats	17
	Maintenance	17

9	Troubleshooting	18
----------	------------------------	-----------

10	Notice	19
-----------	---------------	-----------

1 Important

Safety

Know these safety symbols



This 'bolt of lightning' indicates uninsulated material within your unit may cause an electrical shock. For the safety of everyone in your household, please do not remove product covering.

The 'exclamation point' calls attention to features for which you should read the enclosed literature closely to prevent operating and maintenance problems. **WARNING:** To reduce the risk of fire or electric shock, this apparatus should not be exposed to rain or moisture and objects filled with liquids, such as vases, should not be placed on this apparatus.

CAUTION: To prevent electric shock, match wide blade of plug to wide slot, fully insert.

Important Safety Instructions

- Read these instructions.
- Heed all warnings.
- Follow all instructions.
- Do not block any ventilation openings. Install in accordance with the manufacturer's instructions.
- Do not install near any heat sources such as radiators, heat registers, stoves, or other unit (including amplifiers) that produce heat.

- Protect the power cord from being walked on or pinched, particularly at plugs, convenience receptacles, and the point where they exit from the clock radio.
- Only use attachments/accessories specified by the manufacturer.
- Use only with the cart, stand, tripod, bracket, or table specified by the manufacturer or sold with the Hi-Fi system. When a cart is used, use caution when moving the cart/unit combination to avoid injury from tip-over.



- Unplug this Hi-Fi system during lightning storms or when unused for long periods of time.
- Refer all servicing to qualified service personnel. Servicing is required when the Hi-Fi system has been damaged in any way, such as power-supply cord or plug is damaged, liquid has been spilled or objects have fallen into the Hi-Fi system, the Hi-Fi system has been exposed to rain or moisture, does not operate normally, or has been dropped.
- This Hi-Fi system shall not be exposed to dripping or splashing.
- Do not place any sources of danger on the Hi-Fi system (e.g. liquid filled objects, lighted candles).
- Battery usage **CAUTION** – To prevent battery leakage which may result in bodily injury, property damage, or damage to the remote control:
- Install all batteries correctly, + and - as marked on the remote control.
- Do not mix batteries (old and new or carbon and alkaline, etc.).
- Remove batteries when the remote control is not used for a long time.

- Where the MAINS plug or an appliance coupler is used as the disconnect device, the disconnect device shall remain readily operable.



Warning

- Never remove the casing of this apparatus.
- Never lubricate any part of this apparatus.
- Never place this apparatus on other electrical equipment.
- Keep this apparatus away from direct sunlight, naked flames or heat.
- Never look into the laser beam inside this apparatus.
- Ensure that you always have easy access to the power cord, plug or adaptor to disconnect this apparatus from the power.

2 Your Mini Hi-Fi System

Congratulations on your purchase, and welcome to Philips! To fully benefit from the support that Philips offers, register your product at www.philips.com/welcome.

Introduction

With this Hi-Fi system, you can:

- enjoy audio from discs, USB device, iPod/ iPhone and other external devices; and
- listen to radio stations

To enrich sound, this Hi-Fi system offers you these sound effects:

- Digital Sound Control (DSC)
- Dynamic Bass Boost (DBB)
- Max sound for instant power boost

The Hi-Fi system supports these media formats:



What's in the box

Check and identify the contents of your package:

- Main unit
- Remote control (with batteries)
- Speaker box (x 2)
- User manual
- Quick start guide

Overview of the main unit

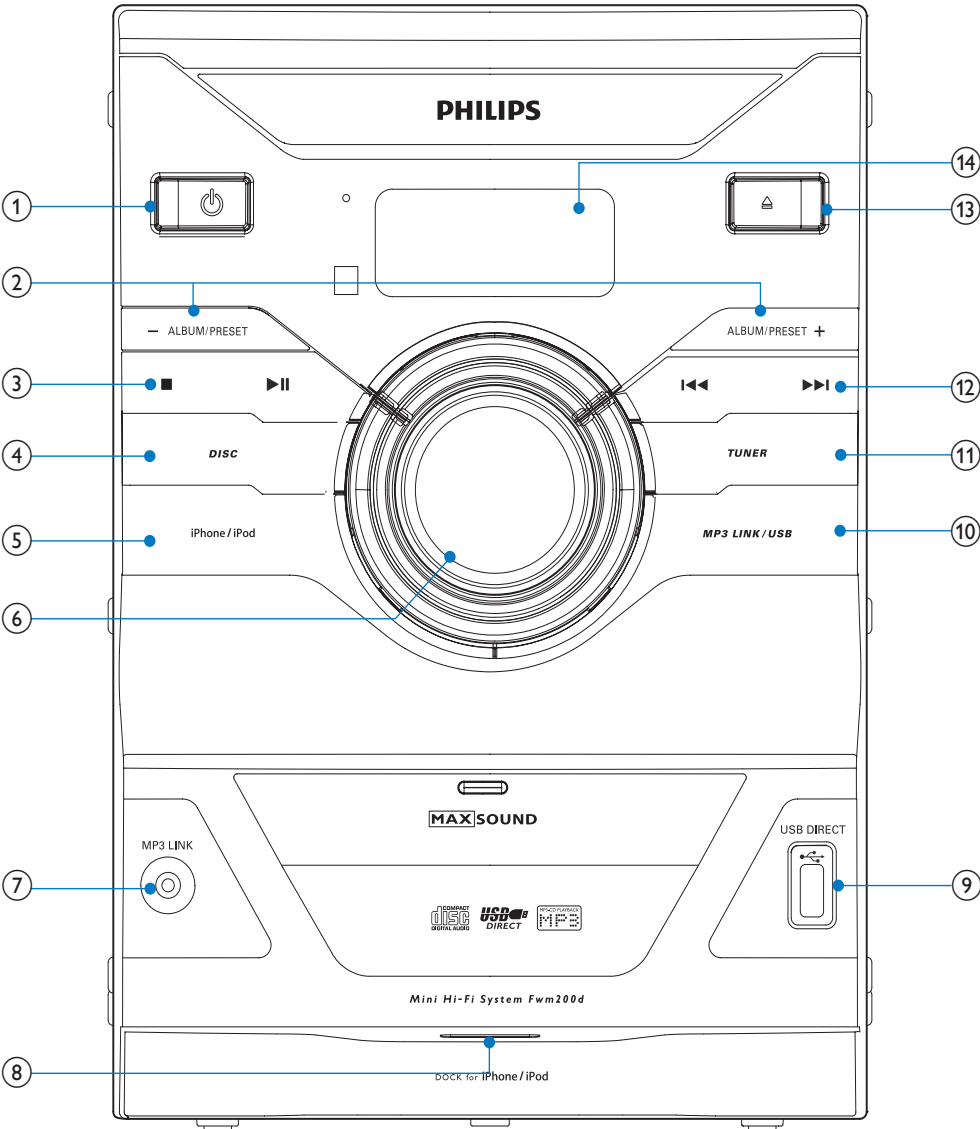

- ①
 - Turn on the Hi-Fi system.
 - Switch to standby or Eco power standby mode.
- ② **ALBUM/PRESET +/-**
 - Select a preset radio station.
 - Skip to previous/next album.
 - Navigate through iPod/iPhone menu.
- ③
 - Stop play or erase a program.
 - Start or pause play.
- ④ **DISC**
 - Select disc source.
- ⑤ **iPod/iPhone**
 - Select iPod/iPhone source.
- ⑥ **Volume controller**
 - Adjust volume.
- ⑦ **MP3 LINK**
 - Connect external audio device.
- ⑧ **Dock for iPod/iPhone**
- ⑨ **USB DIRECT**
 - USB socket.
- ⑩ **MP3 LINK/USB**
 - Select MP3 link/USB source.
- ⑪ **TUNER**
 - Select tuner source.
- ⑫
 - Skip to previous/next track.
 - Search within a track/disc.
 - Tune to a radio station.
 - Adjust time.
- ⑬
 - Open or close the disc tray.
- ⑭ **Display panel**
 - Show current status.

Overview of the remote control

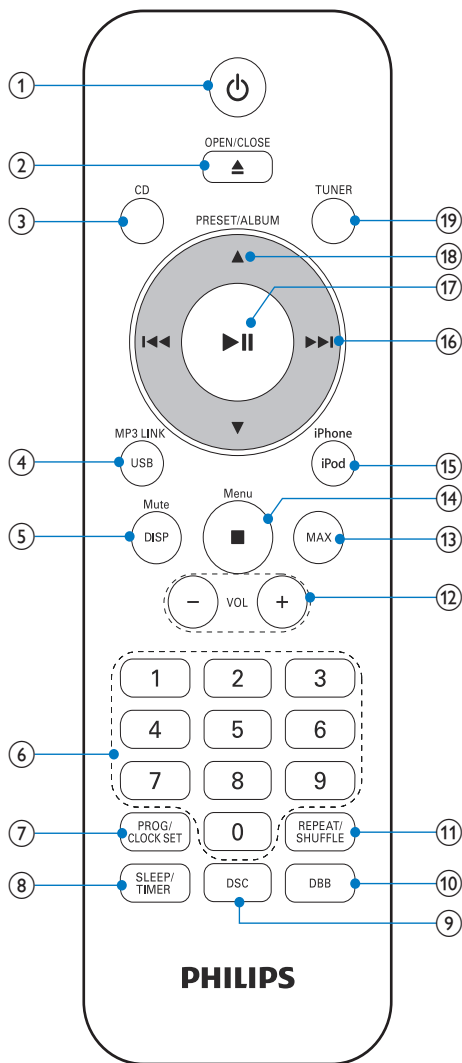

- ①
 - Turn on the Hi-Fi system.
 - Switch to standby or Eco power standby mode.

- ② **OPEN/CLOSE ▲**
 - Open or close the disc tray.
- ③ **CD**
 - Select disk source.
- ④ **MP3 LINK/USB**
 - Select MP3 link/USB source.
- ⑤ **DISP/MUTE**
 - Mute/unmute sound.
 - Show current information.
- ⑥ **Numeric keypad**
 - Select a track from a disc directly.
 - Select a preset radio station directly.
- ⑦ **PROG/CLOCK SET**
 - Set time.
 - Program tracks and radio stations.
- ⑧ **SLEEP/TIMER**
 - Set alarm/sleep timer.
- ⑨ **DSC**
 - Select a preset sound setting.
- ⑩ **DBB**
 - Turn on/off dynamic bass enhancement.
- ⑪ **REPEAT/SHUFFLE**
 - Play tracks repeatedly/randomly.
- ⑫ **VOL +/-**
 - Adjust volume.
- ⑬ **MAX**
 - Turn on/off instant power boost.
- ⑭ **■/MENU**
 - Stop play.
 - Erase a program.
 - Navigate through iPod/iPhone menu.
- ⑮ **iPod/iPhone**
 - Select iPod/iPhone source.
- ⑯ **◀◀/▶▶**
 - Search within a track/disc.
 - Tune to a radio station.
 - Skip to the previous/next track.
 - Adjust time.
- ⑰ **▶▶**
 - Start or pause play.
- ⑱ **PRESET/ALBUM ▲▼**
 - Select a preset radio station.
 - Skip to previous/next album.
 - Navigate through iPod/iPhone menu.
- ⑲ **TUNER**
 - Select tuner source.

3 Get started



Caution

- Use of controls or adjustments or performance of procedures other than herein may result in hazardous radiation exposure or other unsafe operation.

Always follow the instructions in this chapter in sequence.

Connect speaker

Insert speaker wires completely into the speaker sockets at the back of the Hi-Fi system.

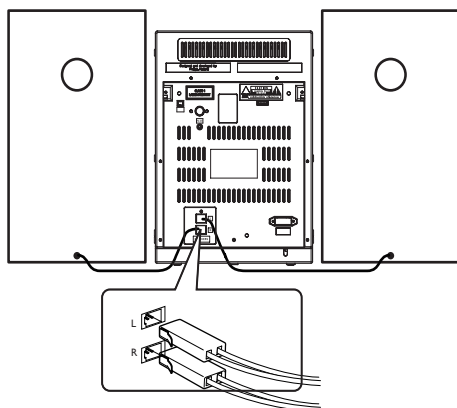

Prepare the remote control



Caution

- Risk of explosion! Keep batteries away from heat, sunshine or fire. Never discard batteries in fire.
- Risk of decreased battery life! Never mix different brands or types of batteries.

Before using the remote control, install two AAA batteries with correct polarity (+/-) as indicated.

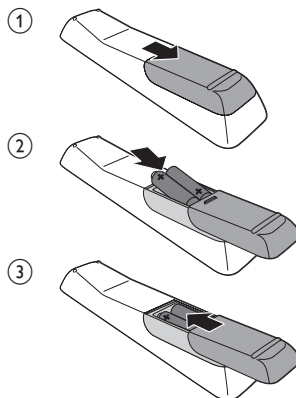

Connect power



Caution

- Risk of product damage! Make sure that the power supply voltage corresponds to the voltage printed on the head of the AC power cord.
- Risk of electric shock! When you unplug the power cord, always pull the plug from the socket. Never pull the cord.



Note

- Before connecting the AC power cord, make sure that you have completed all other connections.

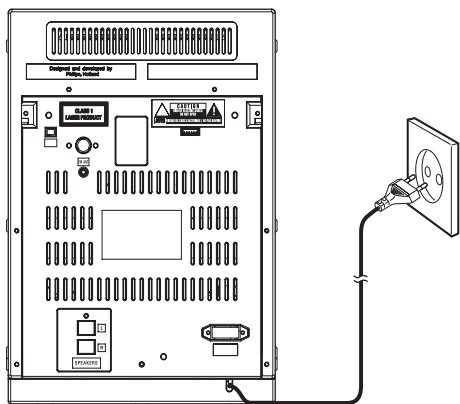

Switch to standby mode

Press **⏻** to switch the Hi-Fi system to standby mode.

- ↳ The clock (if set) appears on the display panel.

To switch the system to Eco Power Standby mode:

In standby mode, press and hold **⏻** for 2 seconds.

- ↳ **[ECO POWER]** (Eco power) scrolls on the display, then the backlight turns off.

Set clock

- 1 In standby mode, press and hold **CLOCK SET** for 2 seconds.
 - ↳ **[SET CLOCK]** (set clock) scrolls on the display, then **[24 HOUR]** or **[12 HOUR]** blinks.
- 2 Press **◀▶** to select 12/24 hour format.
- 3 Press **CLOCK SET** to confirm.
 - ↳ The hour digits begin to blink.
- 4 Repeat Steps 2 to 3 to set the hour and minute.

Note

- To exit clock setting mode, press **■**.
- If clock is not set yet, when iPod/iPhone is connected, the system synchronizes time from the iPod/iPhone automatically.

Turn on

Press **⏻**.

- ↳ The Hi-Fi system switches to the last selected source.

4 Play

Basic play operations

Function	Action
To stop play	press ■ .
To pause/resume play	press ▶ .
To skip to a track	press ◀◀▶▶ .
To search during play	press and hold ◀◀▶▶ , then release to resume normal play.
To select an album (for MP3/WMA)	press ▲/▼ .
To navigate the iPod/iPhone menu	press MENU , then press ▲/▼ to select, and press ▶ to confirm.
To select a track directly	press the numeric buttons.

Play disc

- 1 Press **CD** to select the disk source.
- 2 Press **▲**.
↳ The disc tray opens.
- 3 Insert a disc with the printed side facing up, then press **▲** to close the disc tray.
↳ **[Read]** (read) blinks for a moment, then play starts automatically.

Play from iPod/iPhone

You can enjoy audio from iPod/iPhone through this Hi-Fi system.

Compatible iPod/iPhone

The Hi-Fi system supports these iPod and iPhone models:

Made for:

- iPod touch (1st, 2nd, 3rd, and 4th generation)
- iPod classic
- iPod with video
- iPod nano (1st, 2nd, 3rd, 4th, 5th, and 6th generation)
- iPod with color display
- iPod mini
- iPhone 4
- iPhone 3GS
- iPhone 3G
- iPhone

Listen to audio from iPod/iPhone

- 1 Place the iPod/iPhone in the dock.

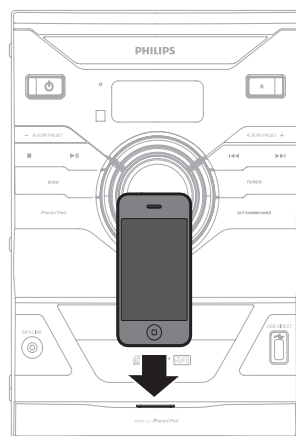

- 2 Press **iPod/iPhone** to select iPod/iPhone source.
- 3 Start to play audio from the iPod/iPhone.

To remove the iPod/iPhone:

Pull the iPod/iPhone out of the dock.

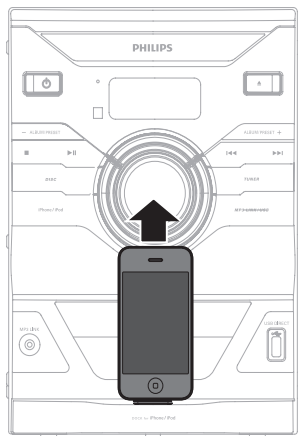

Charge the iPod/iPhone

When the system is connected to power, the docked iPod/iPhone starts charging.

Play from USB



Note

- Make sure that the USB device contains playable audio content.

- 1 Insert the USB device into the  socket.
- 2 Press **USB** to select the USB source.
↳ Play starts automatically.

Play audio from an external device

You can also listen to an external audio device through this system with an MP3 link cable (not supplied).

- 1 Connect the MP3 link cable to
 - the **MP3 LINK** socket.
 - the audio output socket of the external device.
- 2 Press **MP3 LINK** repeatedly to select MP3 link mode.
- 3 Start to play the external device (see the user manual of this device).

5 Play options

Adjust sound

During play, you can adjust volume and select sound effects:

Function	Action
To increase/decrease volume	Press VOL +/- .
To mute/unmute sound	Press and hold MUTE for two seconds.
To turn on/off instant power boost	Press MAX .
To turn on/off dynamic bass enhancement	Press DBB .
To select a preset sound effect (FLAT , OPTIMAL , JAZZ , ROCK , and TECHNO)	Press DSC repeatedly.

Repeat and shuffle play

- Press **REPEAT** repeatedly to select:
 - : play current track repeatedly.
 - (for MP3/WMA only): play current album repeatedly.
 - (repeat all): play all tracks repeatedly.
 - : play all tracks randomly.
- To return to normal play, press **REPEAT** repeatedly until **[TRK]** (track) is displayed.

Program tracks

You can program a maximum of 20 tracks.

- In CD/USB mode, press to stop playback, then press **PROG** to activate programming mode.
 - ↳ **[PROG]** (program) and the preset number blinks on the display panel.
- For MP3/WMA tracks, press to select an album.
- Press to select a track number, then press **PROG** to confirm.
- Repeat steps 2 to 3 to program more tracks.
- Press to play the programmed tracks.
 - ↳ During play, **[PROG]** (program) is displayed.
 - To erase the program, in the stop position, press .

Display different information

During play, press **DISPLAY** repeatedly to view time and different play information.

6 Listen to FM radio

Tune to FM radio stations



Note

- For better reception, fully extend and adjust the position of FM antenna.

- 1 Press **TUNER** to select FM tuner source.
 - 2 Press and hold **◀▶▶▶** for 2 seconds.
 - ↳ The Hi-Fi system tunes to a station with strong reception automatically.
 - 3 Repeat step 2 to tune to more stations.
- To tune to a station manually:
- 1 Press **◀▶▶▶** repeatedly until you find optimal reception.

Store FM radio stations automatically



Note

- You can store a maximum of 20 preset radio stations.

In FM tuner mode, press and hold **PROG** for 2 seconds.

- ↳ **[AUTO]**(auto) is displayed.
- ↳ The system stores all the available FM stations and broadcasts the first available station automatically.

Store FM radio stations manually

- 1 Tune to a FM radio station.
- 2 Press **PROG**.
 - ↳ The preset number begins to blink.
- 3 Press **▲/▼** repeatedly to select a number.
- 4 Press **PROG** again to confirm.
- 5 Repeat Steps 1 to 4 to store other stations.



Note

- To remove a pre-stored station, store another station in its place.

Select a preset radio station

In tuner mode, press **▲/▼** repeatedly to select a preset radio station.

7 Other features

Set alarm timer

This Hi-Fi system can be used as an alarm clock. For alarm source, you can select disc, tuner, USB or iPod/iPhone.



Note

- Make sure that you have set the clock correctly.

- 1 In standby mode, press and hold **TIMER** until **[SET TIMER]** (set timer) appears. Then **[SELECT SOURCE]** (select source) scrolls on the display.
- 2 Press source selection keys to select an alarm source: **DISC**, **TUNER**, **USB** or **iPod/iPhone**.
- 3 Press **TIMER** to confirm.
↳ The hour digits begin to blink.
- 4 Press **◀◀▶▶** to set hour.
- 5 Press **TIMER** to confirm.
↳ The minute digits begin to blink.
- 6 Repeat steps 4-5 to set minute.
↳ The alarm icon appears.



Note

- In standby mode, press **TIMER** repeatedly to activate/deactivate the alarm timer.
- When alarm sounds, you can adjust volume by pressing **VOL +/-**.
- If Disc/USB/iPod/iPhone is selected as alarm source, while no disc is inserted or no USB/iPod/iPhone connected, the system switches to tuner source instead.

Set sleep timer

This Hi-Fi system can switch to standby mode automatically after a preset time period. Press **SLEEP** repeatedly to select a preset period (in minutes).

- ↳ When sleep timer is activated, **zzz** appears.

To deactivate sleep timer, press **SLEEP** repeatedly until **[SLP OFF]** (sleep off) is displayed.

- ↳ **zzz** disappears.

8 Product information

Note

- Product information is subject to change without prior notice.

Specifications

Amplifier

Rated Output Power	50W per channel x 2
Frequency Response	63 - 16000 Hz, ± 3 dB
Signal to Noise Ratio	>55dB

Disc

Laser Type	Semiconductor
Disc Diameter	12cm/8cm
Support Disc	CD-DA, CD-R, CD-RW, MP3-CD, WMA-CD
Audio DAC	24Bits / 44.1kHz
Total Harmonic Distortion	<1%
Frequency Response	63Hz - 16kHz
S/N Ratio	>65dBA

Tuner

FM

Tuning Range	87.5 - 108 MHz
Tuning grid	50 KHz
Sensitivity	
- Mono, 26dB S/N Ratio	<22 dBu
- Stereo, 46dB S/N Ratio	<45 dBu
Search Selectivity	<28 dBu
Total Harmonic Distortion	<3%
Signal to Noise Ratio	>45 dB

Speakers

Speaker Impedance	4ohm
-------------------	------

General information

AC power	220 - 240V~, 50/60Hz
Operation power consumption	45W
Standby power consumption	<1W
Eco Standby power consumption	<0.5W
USB direct	Version 2.0/1.1
Dimensions	
- Main Unit (W x H x D)	220 x 312 x 270 mm
- Speaker Box (W x H x D)	195 x 310 x 207 mm
Weight	
- With Packing	9.0 kg
- Main Unit	3.0 kg
- Speaker Box	2 x 2.0 kg

USB playability information

Compatible USB devices:

- USB flash memory (USB 2.0 or USB1.1)
- USB flash players (USB 2.0 or USB1.1)
- memory cards (requires an additional card reader to work with this unit)

Supported formats:

- USB or memory file format FAT16, FAT32 (sector size: 512 bytes)
- MP3 bit rate (data rate): 32-320 Kbps and variable bit rate
- WMA v9 or earlier
- Directory nesting up to a maximum of 8 levels
- Number of albums/ folders: maximum 999
- Number of tracks/titles: maximum 999
- ID3 tag v2.0 or later
- File name in Unicode UTF8 (maximum length: 128 bytes)

Unsupported formats:

- Empty albums: an empty album is an album that does not contain MP3/WMA files, and will not be shown in the display.
- Unsupported file formats are skipped. For example, Word documents (.doc) or MP3 files with extension .dlf are ignored and not played.
- AAC, WAV, PCM audio files
- DRM protected WMA files (.wav, .m4a, .m4p, .mp4, .aac)
- WMA files in Lossless format

Supported MP3 disc formats

- ISO9660, Joliet
- Maximum title number: 511 (depending on file name length)
- Maximum album number: 511
- Supported sampling frequencies: 32 kHz, 44.1kHz, 48 kHz
- Supported Bit-rates: 32~320 (kbps), variable bit rates
- ID3 tag v2.0 or later

Maintenance

Clean the cabinet

- Use a soft cloth slightly moistened with a mild detergent solution. Do not use a solution containing alcohol, spirits, ammonia or abrasives.

Clean discs

- When a disc becomes dirty, clean it with a cleaning cloth. Wipe the disc from the centre out.



- Do not use solvents such as benzene, thinner, commercially available cleaners, or antistatic spray intended for analogue records.

Clean the disc lens

- After prolonged use, dirt or dust may accumulate at the disc lens. To ensure good play quality, clean the disc lens with Philips CD lens cleaner or any commercially available cleaner. Follow the instructions supplied with cleaner.

9 Troubleshooting



Warning

- Never remove the casing of this apparatus.

To keep the warranty valid, never try to repair the system yourself.

If you encounter problems when using this apparatus, check the following points before requesting service. If the problem remains unsolved, go to the Philips web site (www.philips.com/support). When you contact Philips, ensure that the apparatus is nearby and the model number and serial number are available.

No power

- Ensure that the AC power plug of the unit is connected properly.
- Ensure that there is power at the AC outlet.
- To save power, the system switches off automatically 15 minutes after track play reaches the end and no control is operated.

No sound or poor sound

- Adjust the volume.
- Check that the speakers are connected correctly.
- Check if the stripped speaker wires are clamped.

Left and right sound outputs reversed

- Check the speaker connections and location.

No response from the unit

- Disconnect and reconnect the AC power plug, then turn on the system again.
- As a power-saving feature, the unit switches off automatically 15 minutes after track play reaches the end and no control is operated.

Remote control does not work

- Before you press any function button, first select the correct source with the remote control instead of the main unit.
- Reduce the distance between the remote control and the unit.
- Insert the battery with its polarities (+/- signs) aligned as indicated.
- Replace the battery.
- Aim the remote control directly at the sensor on the front of the unit.

No disc detected

- Insert a disc.
- Check if the disc is inserted upside down.
- Wait until the moisture condensation at the lens has cleared.
- Replace or clean the disc.
- Use a finalized CD or correct format disc.

Poor radio reception

- Increase the distance between the unit and your TV or VCR.
- Fully extend the FM antenna.

Timer does not work

- Set the clock correctly.
- Switch on the timer.

Clock/timer setting erased

- Power has been interrupted or the power plug has been disconnected.
- Reset the clock/timer.

USB device not supported

- The USB device is incompatible with the unit. Try another one.

10 Notice



This product complies with the radio interference requirements of the European Community.

Any changes or modifications made to this device that are not expressly approved by WOOX Innovations may void the user's authority to operate the equipment.

Note

- The type plate is located on the bottom of the apparatus.

Made for



iPod



iPhone

"Made for iPod" and "Made for iPhone" mean that an electronic accessory has been designed to connect specifically to iPod or iPhone respectively, and has been certified by the developer to meet Apple performance standards. Apple is not responsible for the operation of this device or its compliance with safety and regulatory standards. Please note that the use of this accessory with iPod or iPhone may affect wireless performance. iPod and iPhone are trademarks of Apple Inc., registered in the U.S. and other countries.



**Be responsible
Respect copyrights**

The making of unauthorized copies of copy-protected material, including computer programs, files, broadcasts and sound recordings, may be an infringement of copyrights and constitute a criminal offence. This equipment should not be used for such purposes.



Your product is designed and manufactured with high quality materials and components, which can be recycled and reused.



When this crossed-out wheeled bin symbol is attached to a product it means that the product is covered by the European Directive 2002/96/EC. Please inform yourself about the local separate collection system for electrical and electronic products.

Please act according to your local rules and do not dispose of your old products with your normal household waste. Correct disposal of your old product helps to prevent potential negative consequences for the environment and human health.



Your product contains batteries covered by the European Directive 2006/66/EC, which cannot be disposed with normal household waste. Please inform yourself about the local rules on separate collection of batteries because correct disposal helps to prevent negative consequences for the environmental and human health.

Environmental information

All unnecessary packaging has been omitted. We have tried to make the packaging easy to separate into three materials: cardboard (box), polystyrene foam (buffer) and polyethylene (bags, protective foam sheet.)

Your system consists of materials which can be recycled and reused if disassembled by a specialized company. Please observe the local regulations regarding the disposal of packaging materials, exhausted batteries and old equipment.



Windows Media and the Windows logo are trademarks, or registered trademarks of Microsoft Corporation in the United States and/or other countries.

This apparatus includes this label:



Norge

Typeskilt finnes på apparatens underside.

Observer: Nettbryteren er sekundært innkoplet.

Den innebygde nettdelen er derfor ikke frakoplet nettet så lenge apparatet er tilsluttet nettkontakten.

For å redusere faren for brann eller elektrisk støt, skal apparatet ikke utsettes for regn eller fuktighet.



Specifications are subject to change without notice.

2013 © WOOX Innovations Limited. All rights reserved.

This product was brought to the market by WOOX Innovations Limited or one of its affiliates, further referred to in this document as WOOX Innovations, and is the manufacturer of the product. WOOX Innovations is the warrantor in relation to the product with which this booklet was packaged. Philips and the Philips Shield Emblem are registered trademarks of Koninklijke Philips N.V.

FWM200D_12_UM_V3.0

