

Quick Start Guide



Step A Connect

Step B Setup

Step C Enjoy

What's in the Box?

You should find these items upon opening the box.

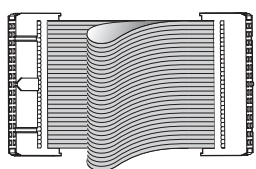

Control Cable

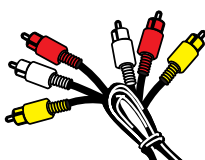

Composite video and audio cables
(yellow, white, red)

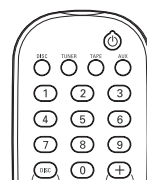

Remote control with two
AAA batteries

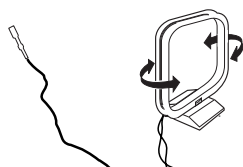
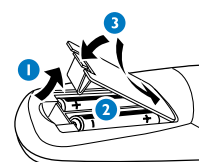

FM and MW antennas

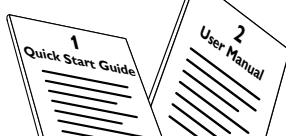

Quick start guide
User manual

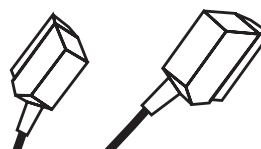

SCART Cable

PHILIPS

Step A *Connect*

Tips

- Refer to the User Manual for other TV connection options.
- For connecting to a Progressive Scan TV, refer to the user manual for proper connections and detailed setup.

- 1 Connect the speaker cables.
- 2 Connect the MW and FM antennas.
- 3 Connect the control cable.
- 4 Connect the SCART cable to the TV.
- 5 Connect the power cords of the system and TV.

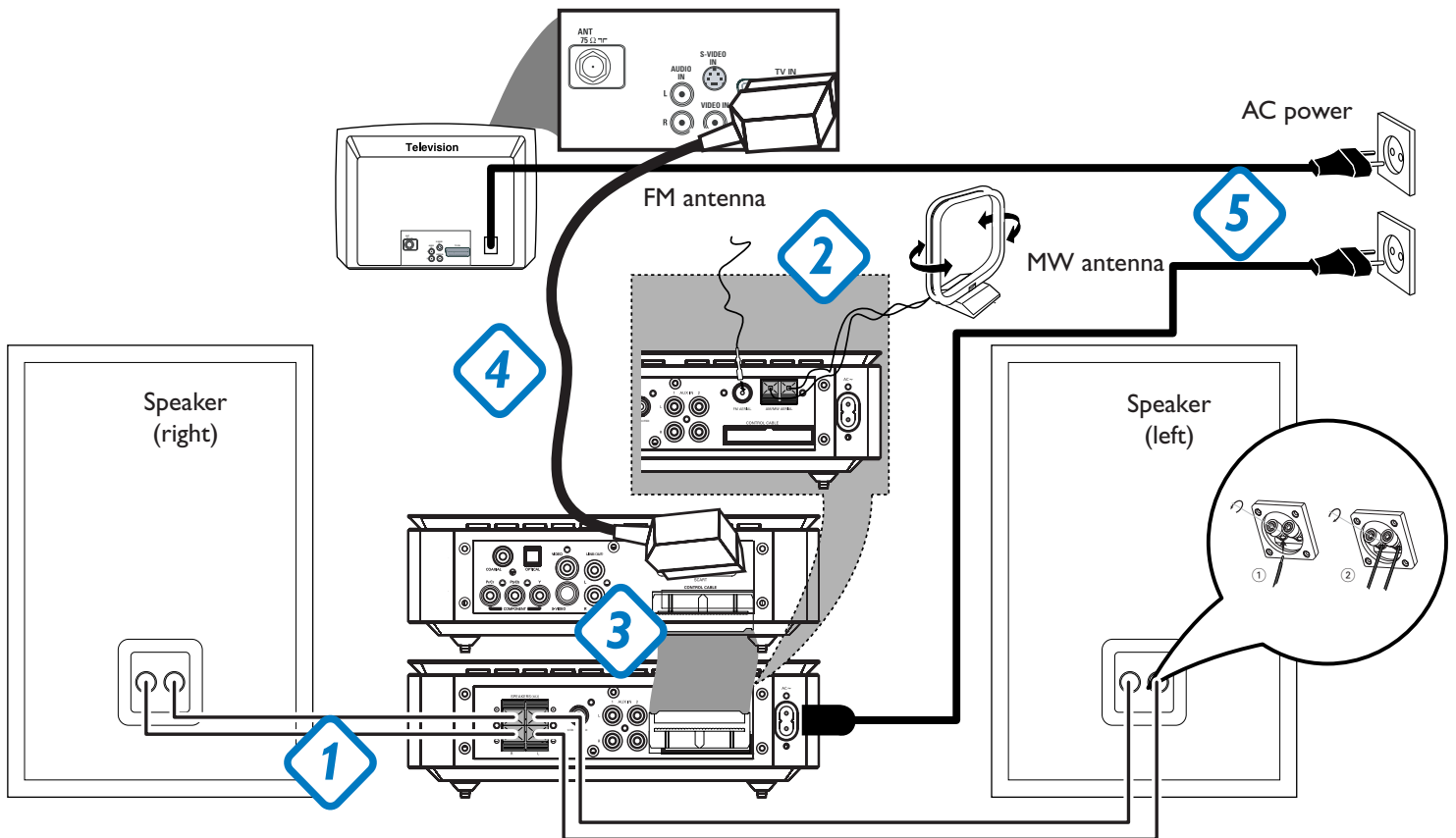

Step B *Setup*

Setting up the TV

- 1 Press **SOURCE** (or **DISC** on the remote control) to select disc source.
- 2 Switch on the TV and set it to the correct Video In channel.

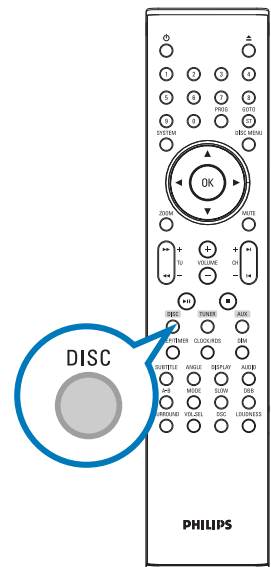

Step B Setup

Setting the clock

- 1 In standby mode, press and hold **CLOCK/RDS** on the remote control.
- 2 When the hour digits flash, turn **VOLUME-/+** on the system or press **VOLUME+/-** on the remote control to set the hours.
- 3 Press **CLOCK/RDS** again and the minute digits flash. Then turn **VOLUME-/+** on the system or press **VOLUME+/-** on the remote control to set the minutes.
- 4 Press **CLOCK/RDS** again to confirm the time settings.

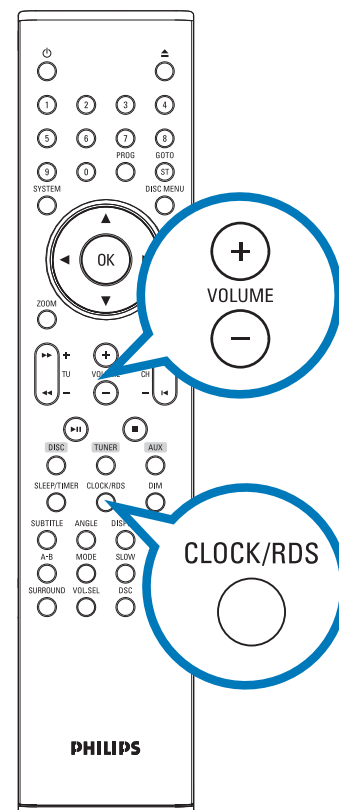

Setting DVD menu options

IMPORTANT!

For instances whereby the progressive scan feature is activated but the connected TV does not support progressive signals, or when the cables have not been appropriately connected, refer to the User Manual for proper progressive scan setup or deactivate the progressive scan feature as below:

- 1) Turn off the TV progressive scan mode or turn on the interlaced mode.
- 2) Press **SYSTEM** on the remote control to exit the system menu, then press **DISC** to exit progressive scan.

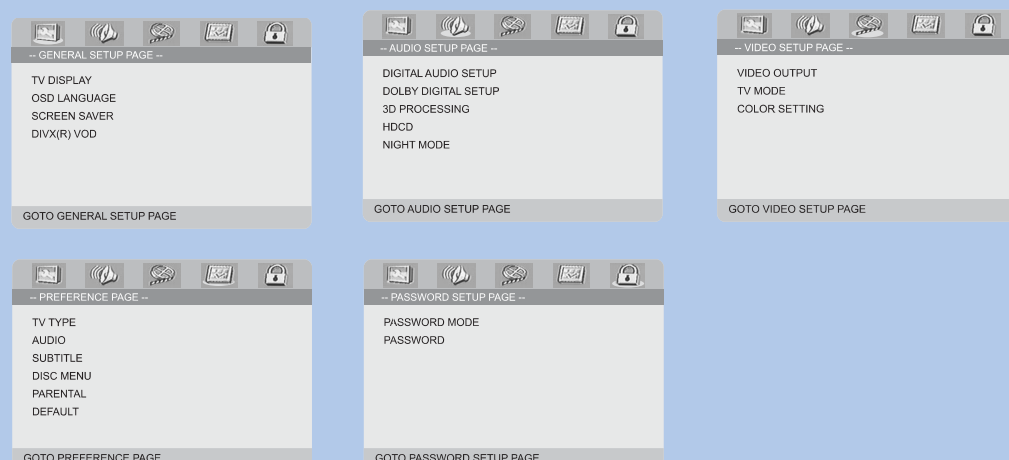

Tip

Refer to chapters "Getting Started" and "System Menu Options" in the User Manual for detailed descriptions.

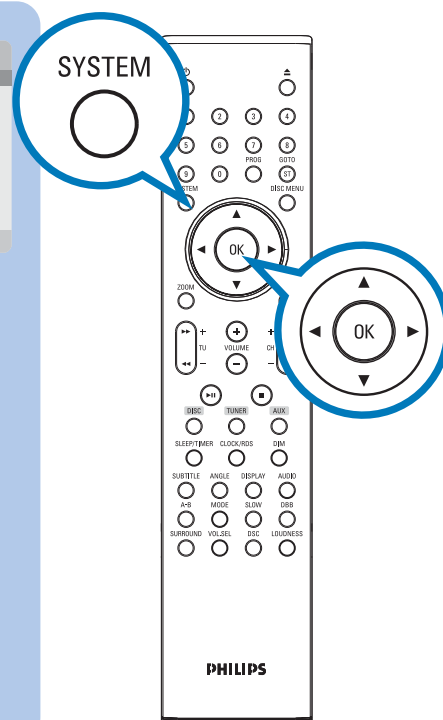

Playing a disc

- 1 Press **OPEN •CLOSE ▲** (or **▲** on the remote control) to open the disc tray and load disc, press the same button again to close the disc tray.
- 2 Load disc with the label side facing up.
- 3 Playback starts automatically. If not, press **▶ II**.
- 4 To stop playback, press **PRESET-■** (or **■** on the remote control).

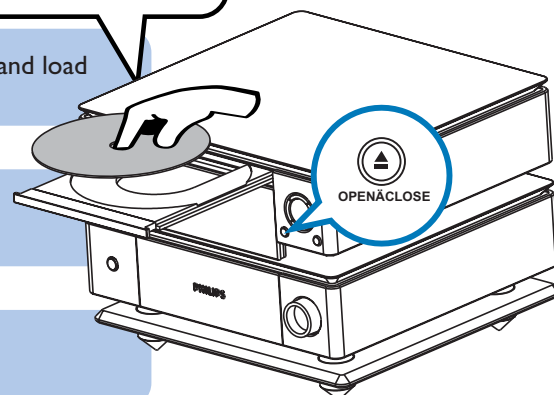
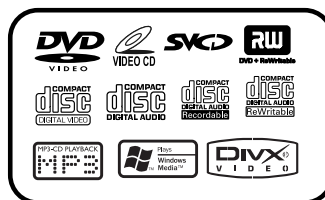

Programming and tuning to radio stations

- 1 Press **SOURCE** (or **TUNER** on the remote control) to select tuner source.
- 2 Press **PROG** on the remote control for more than two seconds to program all available stations in order of waveband.
- 3 Press **PRESET+/-** (or **CH +/- (◀ / ▶)** on the remote control) until the desired preset station is displayed.

Tip

Detailed playback features and additional functions are described in the User Manual.

Notes for remote control:

- Select the source you wish to control by pressing one of the source select keys on the remote control (DISC or TUNER, for example).
- Then select the desired function (**▶ II**, **◀**, **▶** for example).

