

PHILIPS

Wireless Speaker

JS30

Quick Start Guide

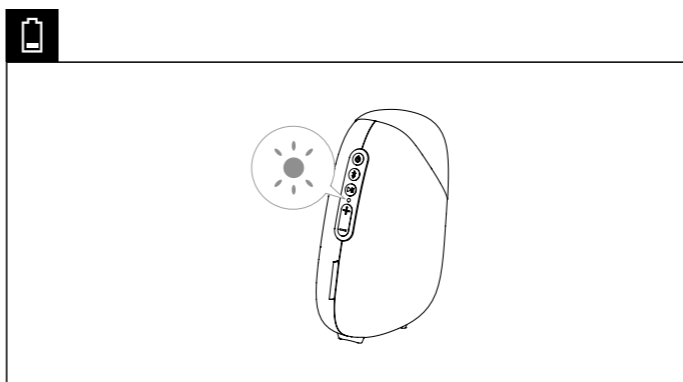
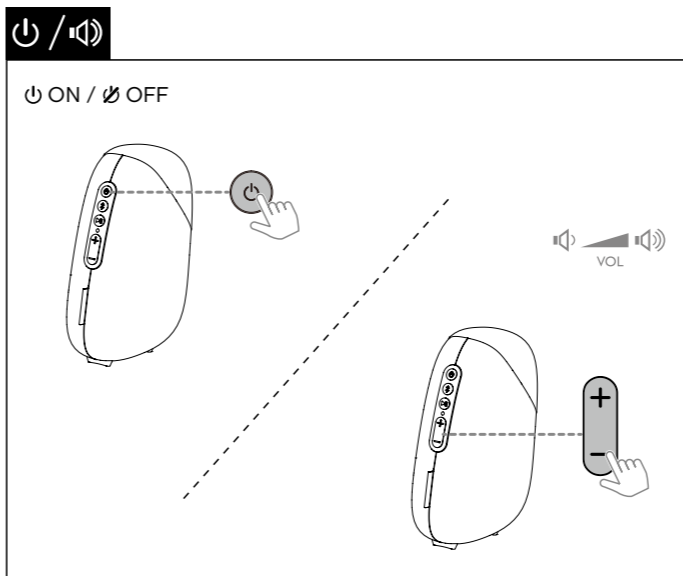
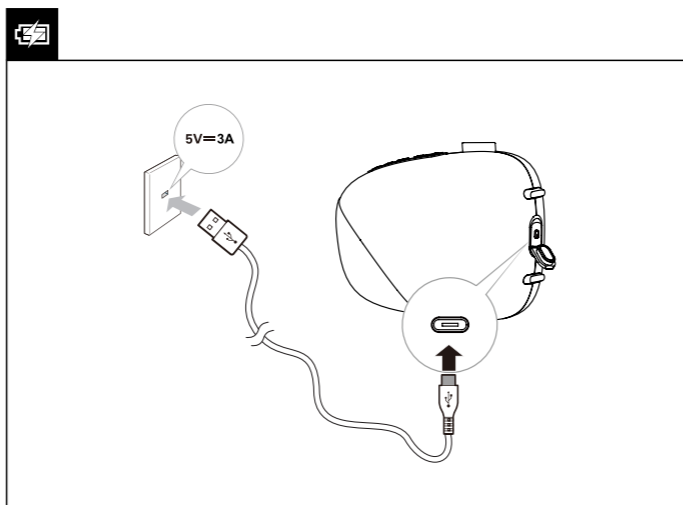
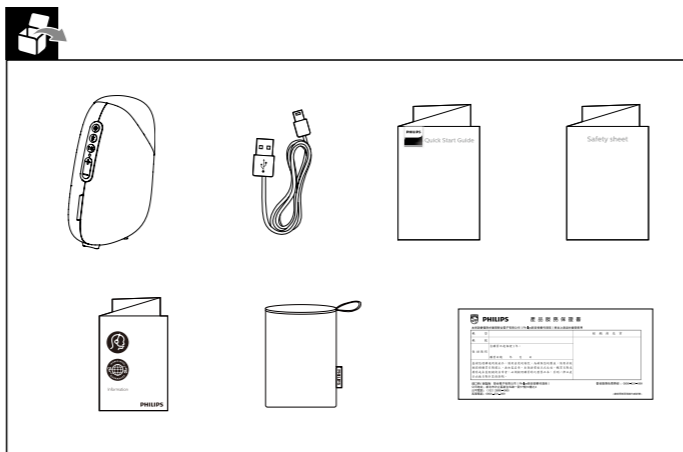

Register your product and get support at www.philips.com/welcome

Philips and the Philips Shield Emblem are registered trademarks of Koninklijke Philips N.V. and are used under license. This product has been manufactured by and is sold under the responsibility of TP Vision Europe B.V. or one of its affiliates, and TP Vision Europe B.V. is the warrantor in relation to this product.



TAJS30_00_QSG_V2.0

