



Quick start guide

EN

Guide de démarrage rapide

FR

Guía de configuración rápida

ES

PHILIPS

- EN Register your product and get support at
- FR Enregistrez votre produit et obtenez de l'assistance sur le site
- ES Registre su producto y obtenga asistencia en

www.philips.com/welcome

- EN **Please read and accept our Streamium terms & conditions as well as the Software End User License Agreement that are included in the User Manual on the supplied hard disk drive(HDD).**
- FR **Lisez attentivement et acceptez les conditions générales Streamium, ainsi que le contrat de licence utilisateur final, fournis avec le manuel d'utilisation sur le HDD.**
- ES **Lea y acepte los términos y condiciones de Streamium, así como el acuerdo de licencia del usuario final del software que se incluyen en el manual de usuario del disco duro suministrado.**



EN

What's in the Box

FR

Contenu de l'emballage

ES

Contenido del paquete

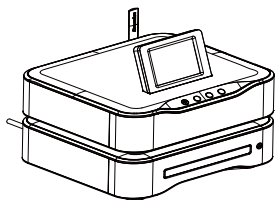

EN

MCi8080 main/DVD unit

FR

Unité principale/DVD MCi8080

ES

Unidad principal/DVD MCi8080

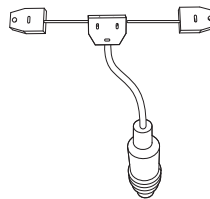

EN

FM antenna

FR

Antenne FM

ES

Antena FM

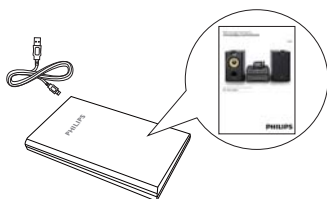

EN

Hard disk drive (HDD) with a USB cable

FR

Disque dur (HDD) avec câble USB

ES

Unidad de disco duro (HDD) con un cable USB

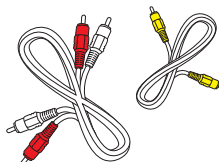

EN

Composite video cable/Audio cables

FR

Câble vidéo composite/Câbles audio

ES

Cable de vídeo compuesto/Cables de audio

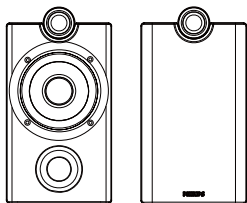

EN

2 x speakers for MCi8080

FR

2 x enceintes pour MCi8080

ES

2 altavoces para MCi8080

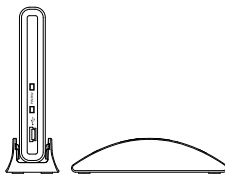

EN

Stand for the HDD

FR

Support pour le disque dur

ES

Soporte para la unidad HDD



EN

Quick start guide

FR

Guide de démarrage rapide

ES

Guía de configuración rápida



EN

Remote control (each with 2 x AAA batteries)

FR

Télécommandes (chacune avec 2 piles AAA)

ES

Mandos a distancia (cada uno con 2 pilas AAA)

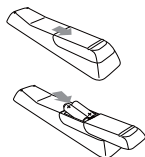

EN

AC power cord

FR

Cordons d'alimentation secteur

ES

Cables de alimentación de CA

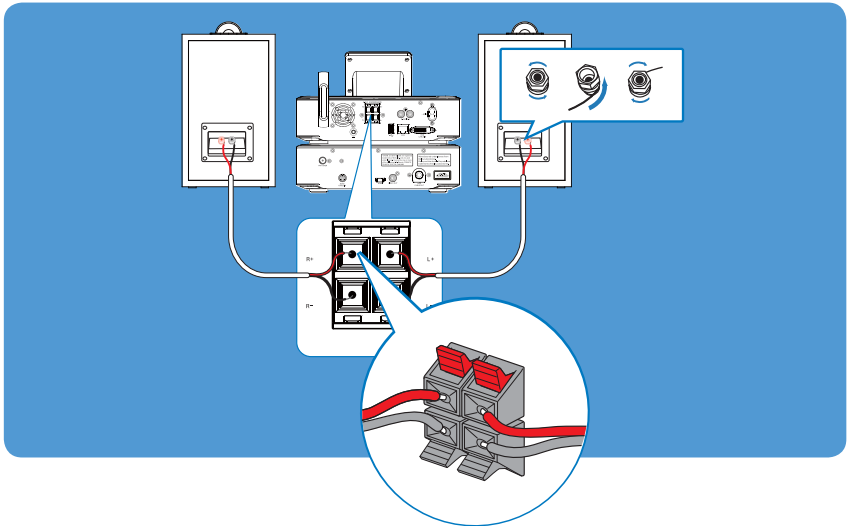
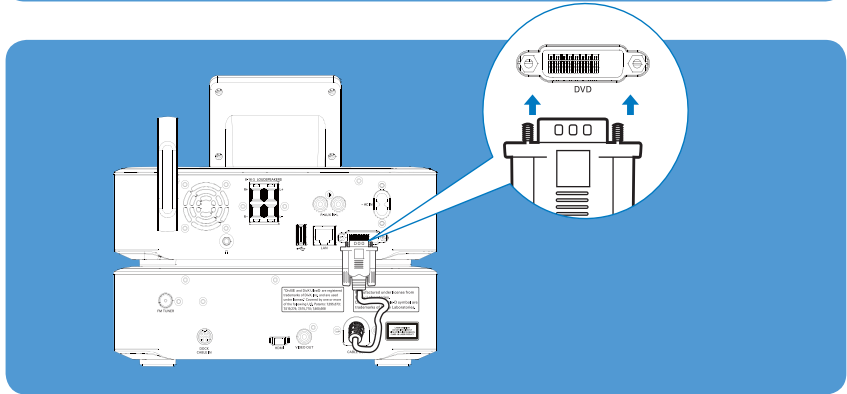
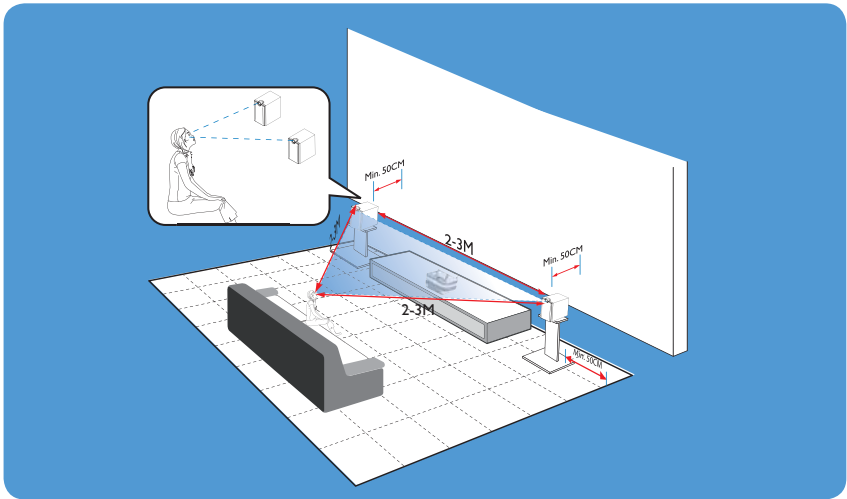



EN

Connect

FR

Connexion

ES

Conexión



EN Connect HDD to MCI8080

FR Connexion du disque dur au MCI8080

ES Conexión de la unidad HDD a la MCI8080

EN First-time use:

- 1 Copy MCI8080 folder (with the User Manual, and software suite included) to the computer;
- 2 Copy media files to the HDD, regardless of the folder structure.

FR Première utilisation:

- 1 Copiez le dossier MCI8080 (contenant le manuel d'utilisation et la suite logicielle) sur l'ordinateur ;
- 2 Copiez les fichiers multimédias sur le disque dur, quelle que soit la structure du dossier.

ES Uso por primera vez:

- 1 Copie la carpeta MCI8080 (con el manual del usuario y conjunto de software incluidos) al ordenador;
- 2 Copie los archivos multimedia en la unidad HDD, independientemente de la estructura de carpetas.

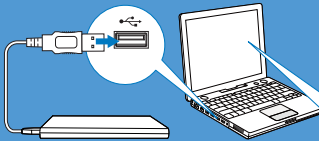

1

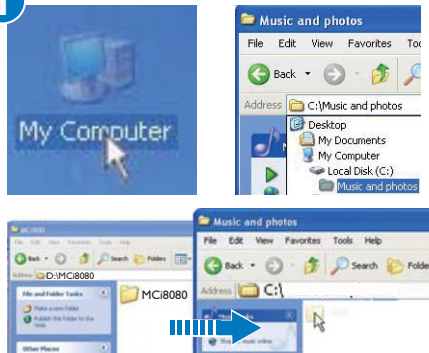

2



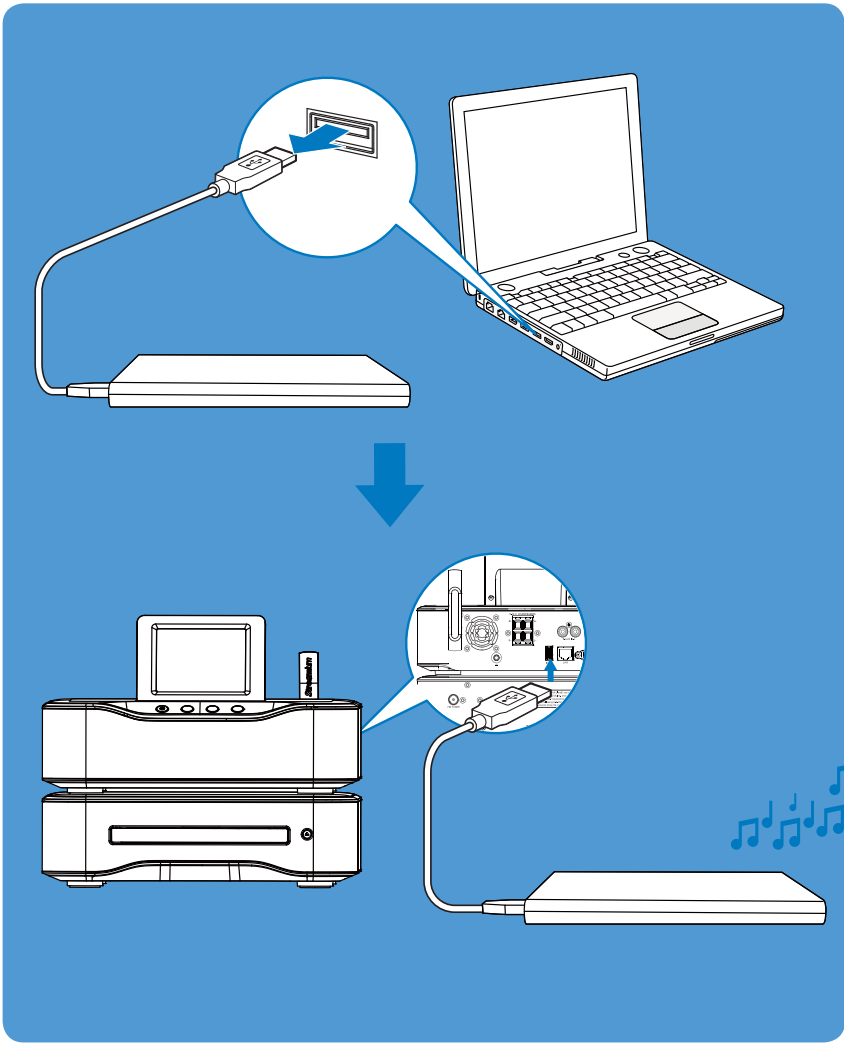



EN Remote control
FR Télécommande
ES Mando a distancia

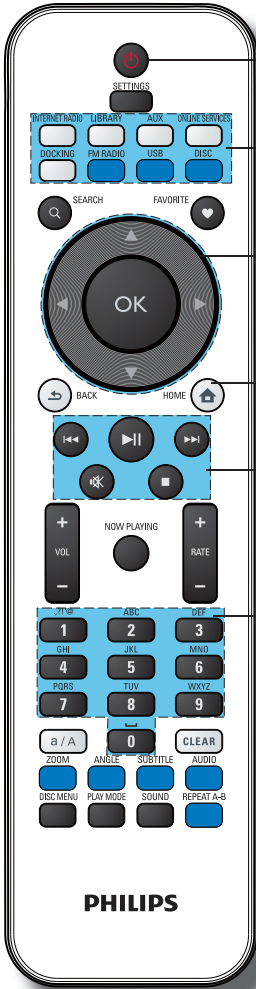

EN On/Off
FR ON/OFF
ES Encendido/Apagado

EN Source
FR Navigation
ES Navegación

EN Navigation
FR Source
ES Origen

EN Home
FR Accueil
ES Casa

EN Play control
FR Commande de lecture
ES Control de la reproducción

EN Key input
FR Saisie de touche
ES Botón de entrada



MCi8080

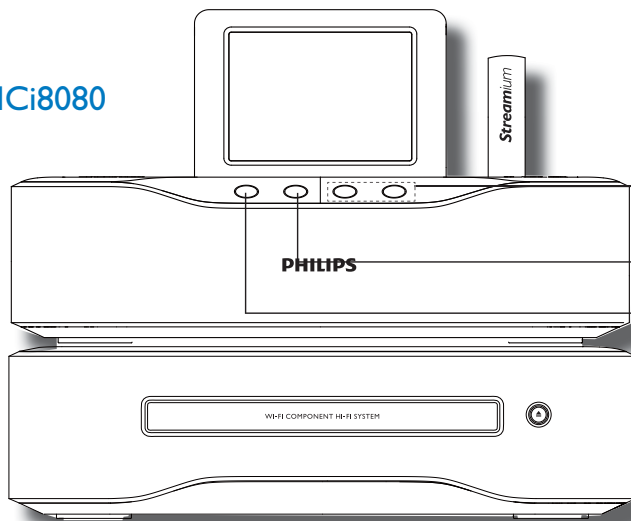

- EN Volume
- FR Volume
- ES Volumen
- EN Mute
- FR Silence
- ES Silenciar
- EN On/off
- FR Marche/arrêt
- ES Activado desactivado



EN

Turn on

FR

Mise sous tension

ES

Encendido

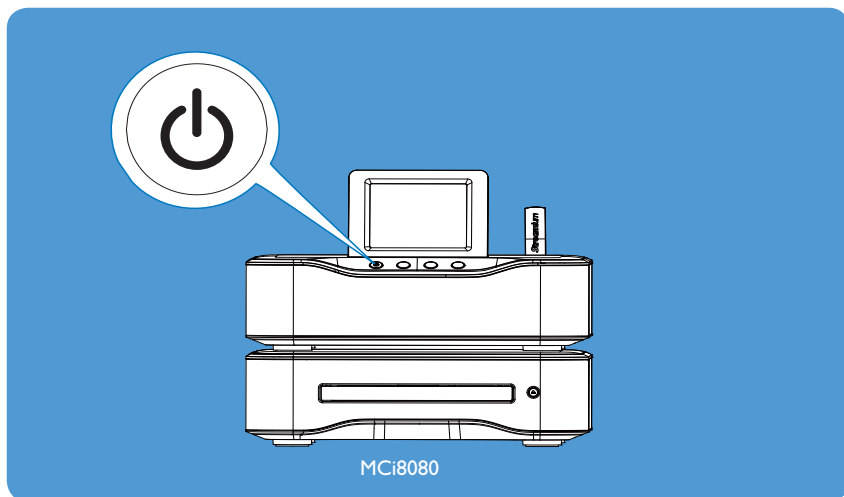
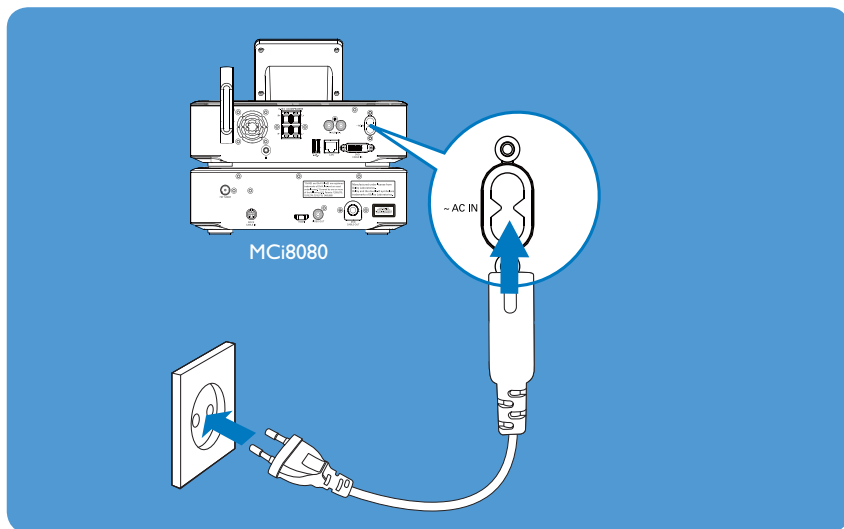

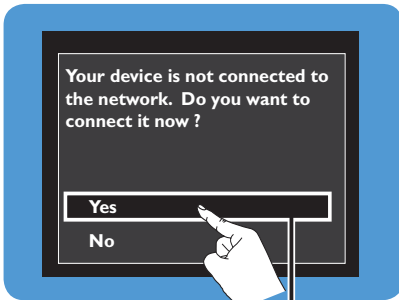
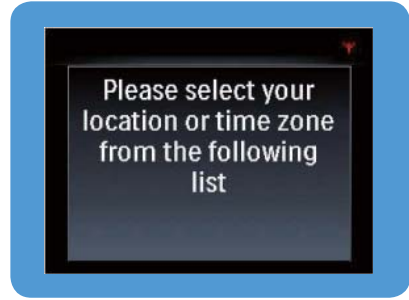

EN

* Tip

- To turn off the unit, press to switch to active standby. The power indicator lights up red.
- Or, press and hold to switch to Eco standby (power-saving mode).

FR

* Conseil

- Pour mettre l'unité hors tension, appuyez sur pour passer en Veille active. Le voyant d'alimentation devient rouge.
- Ou, maintenez la touche enfoncée pour passer en mode d'économie d'énergie.

ES

* Consejo

- Para apagar la unidad, pulse para cambiar al modo de espera activo. El indicador de encendido se ilumina en rojo.
- O, mantenga pulsado para cambiar al modo de espera de bajo consumo (modo de ahorro de energía).



EN Connect to network
FR Connexion au réseau
ES Conexión a la red

- EN Use method (A) or (B).
- FR Utilisez la méthode (A) ou (B).
- ES Utilice el método (A) o (B).

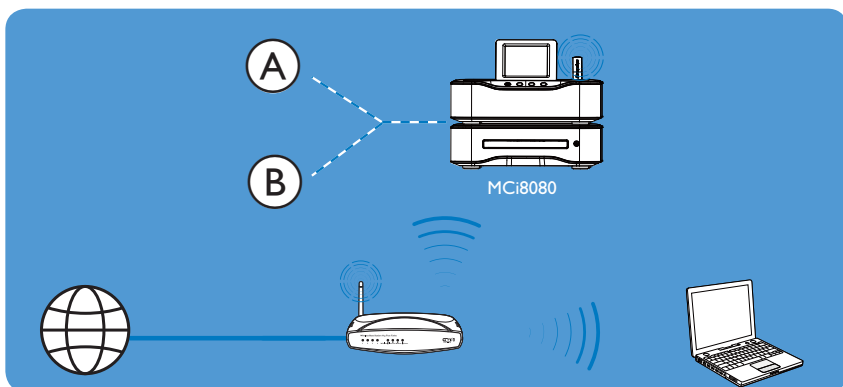

- EN (A) Wireless Protected Setup (WPS)
- FR (A) Fonction WPS (Wireless Protected Setup)
- ES (A) Configuración inalámbrica protegida (WPS)

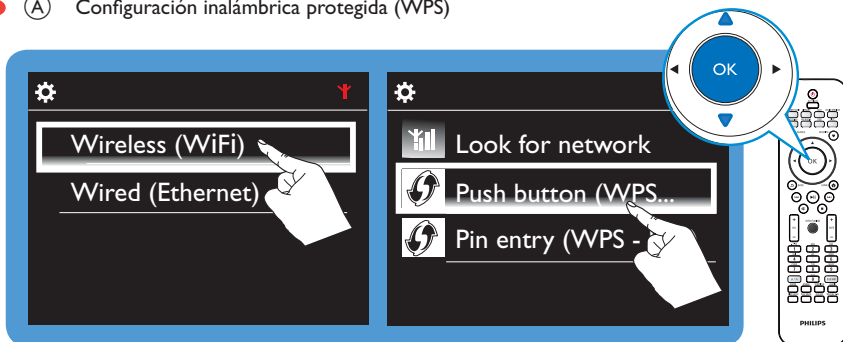



⚙️ 🔴

Activate WPS Push Button function on your access point. After that, press OK on the remote control of your Philips Streamium.

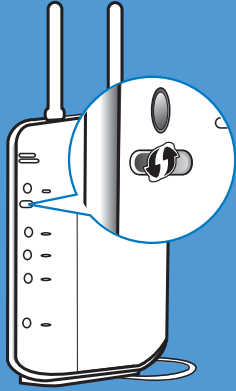

⚙️ 📶

Successfully connected to Network A

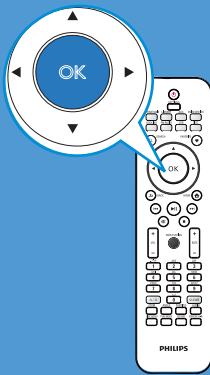

- EN (B) Use network key for wireless connection
- FR (B) Utilisez la clé réseau pour une connexion sans fil
- ES (B) Utilice la clave de red para la conexión inalámbrica

EN

Note

- Ensure that the router connects to the Internet.

FR

Remarque

- Assurez-vous que le routeur se connecte à Internet.

ES

Nota

- Asegúrese de que el router se conecta a Internet.

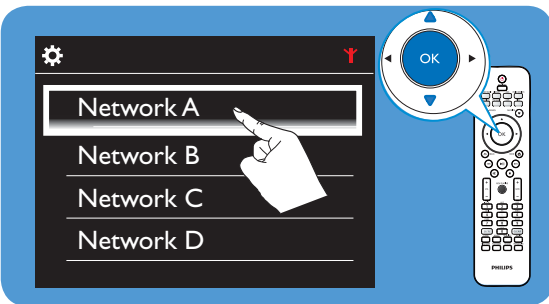
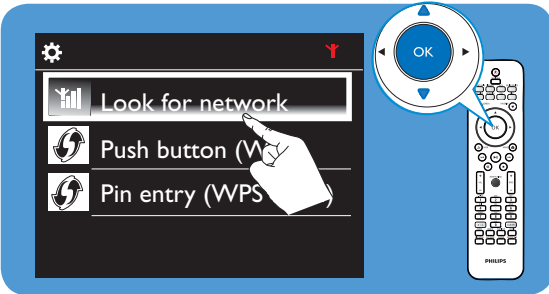
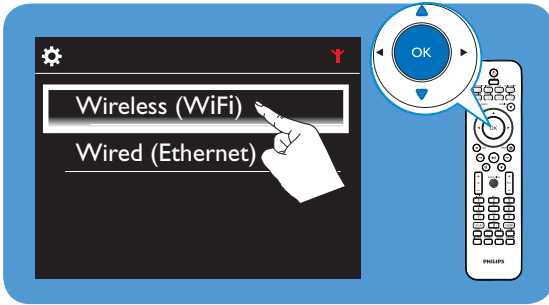

- EN Network key
- FR Clé réseau
- ES Clave de red

Acquiring IP address...
Press <Back> to enter IP address manually

Successfully connected to Network A

Setting

6/14

- Clock settings
- Network settings**
- Location and time zone
- Language

1/2

- Setup network**
- Device name



- EN Internet Radio
- FR Radio Internet
- ES Radio a través de Internet

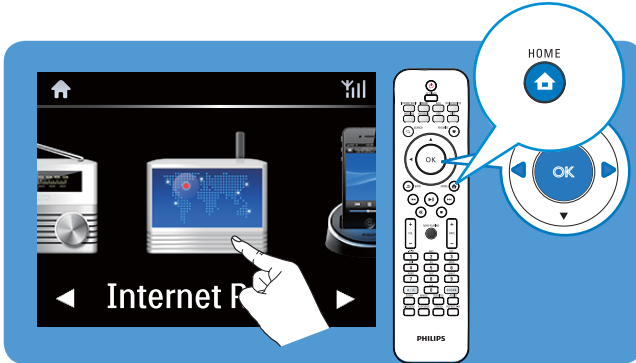

- EN Play preset stations
- FR Écoute de stations présélectionnées
- ES Reproducción de emisoras presintonizadas

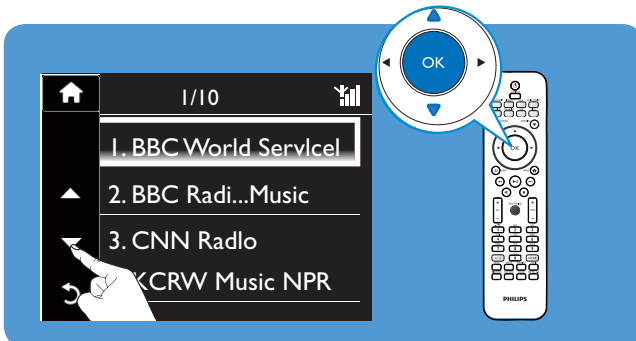
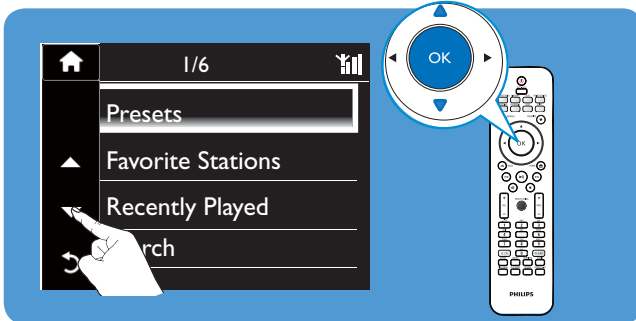



EN Play a preset station

- On the play screen, press the button (0-9) .

Store a preset station

- On the play screen, press and hold the button (0-9).

FR Écoute d'une station présélectionnée

- Sur l'écran de lecture, appuyez sur le bouton (0-9).

Mémorisation d'une station présélectionnée

- Sur l'écran de lecture, maintenez le bouton (0-9) enfoncé.

ES Reproducción de una emisora presintonizada

- En la pantalla de reproducción, pulse el botón (0-9).

Almacenamiento de una emisora presintonizada

- En la pantalla de reproducción, mantenga pulsado el botón (0-9).

EN Search for radio stations

FR Recherche de stations de radio

ES Búsqueda de emisoras de radio

EN By station name

FR Par nom de station

ES Por nombre de emisora

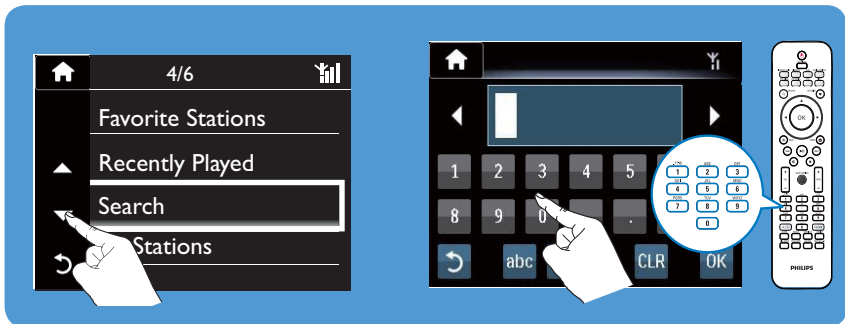



EN **Media Library**
 FR **Bibliothèque multimédia**
 ES **Biblioteca multimedia**

- EN Stream music from a computer
- FR Diffusion de musique à partir d'un ordinateur
- ES Transmisión de música desde un ordenador

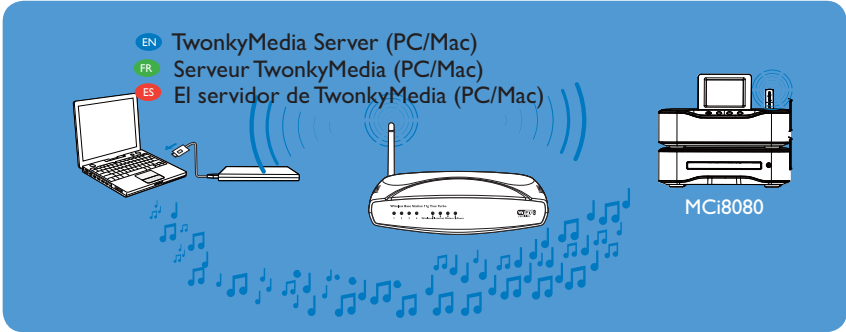

2 TwonkyMedia Server (PC/Mac)
 Key: [xxxx]-[xxxx]-[xxxx]-[xxxx]-[xxxx]-[xxxx]-[xxxx]-[xxxx]

1 [USB Drive]

3 [Settings Icon]

4 Server Settings

5 Browse...

6 Local Disk(C:) Music



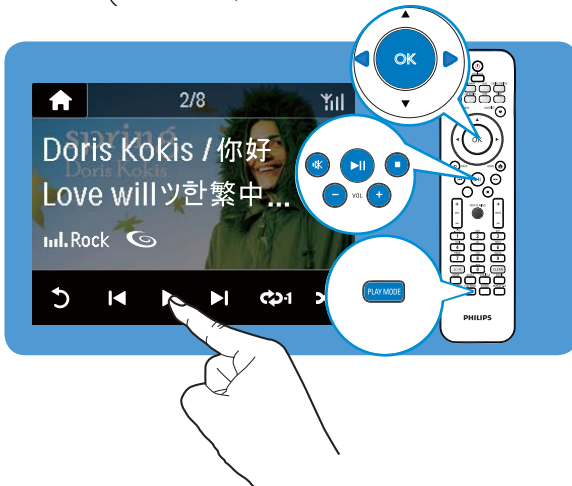
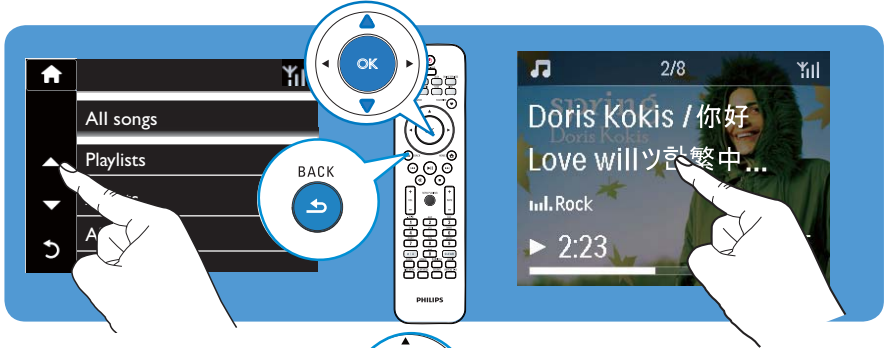
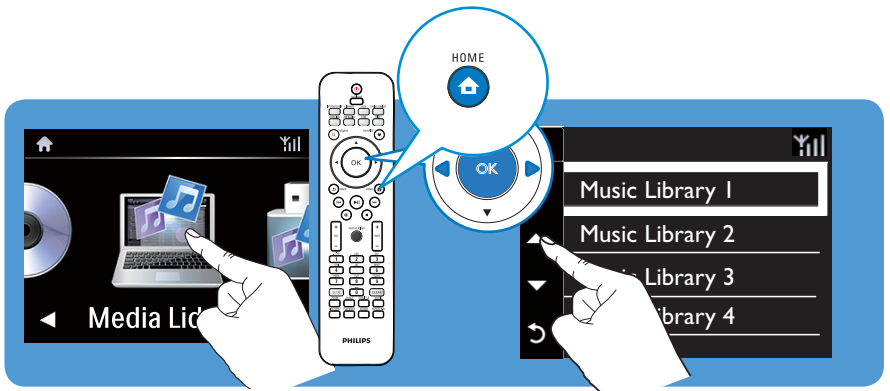



EN

HDD

FR

Disque dur

ES

HDD

- EN Transfer media files to the HDD wirelessly
- FR Transfert sans fil de fichiers multimédia vers le disque dur
- ES Transmisión de archivos multimedia a la unidad HDD de forma inalámbrica

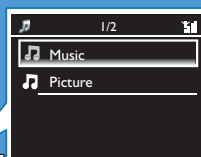
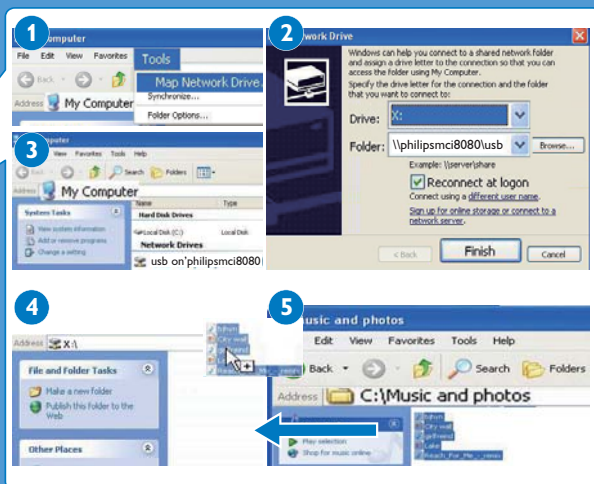

- EN Play from the HDD
- FR Lecture depuis le disque dur
- ES Reproducción desde la unidad HDD

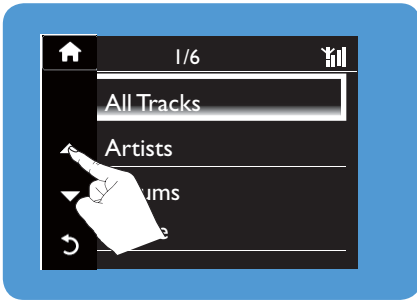
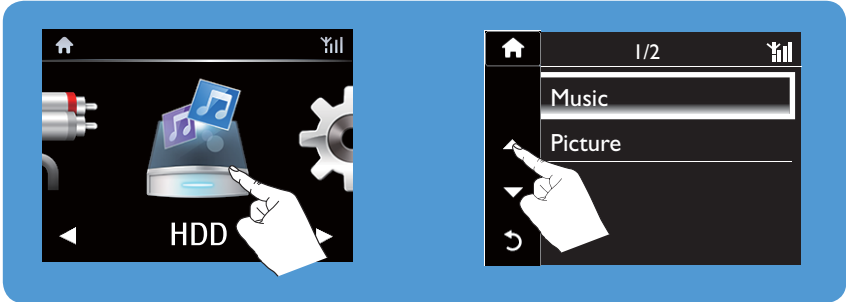



Multiroom Music

EN

Note

Before you enable the Multiroom Music feature, make sure that:

- both MCI8080 and NP3700 are connected to a home Wi-Fi network;
- you are playing a song from the HDD connected to MCI8080.

FR

Remarque

Avant d'activer la fonction Multiroom Music, assurez-vous que :

- Le MCI8080 et le NP3700 sont tous les deux connectés à un réseau domestique Wi-Fi ;
- Vous lisez une chanson à partir du disque dur connecté au MCI8080.

ES

Nota

Antes de que active la función de Multiroom Music, asegúrese de que:

- Tanto la MCI8080 como la NP3700 están conectadas a una red Wi-Fi de la casa;
- Está reproduciendo una canción de la unidad HDD conectada a la MCI8080.

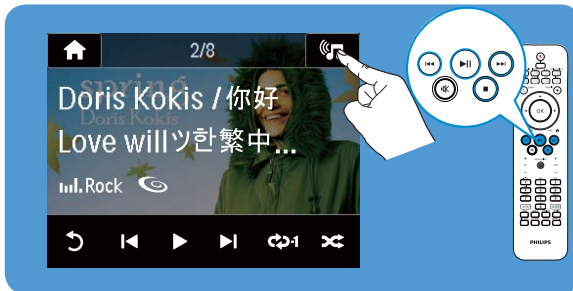

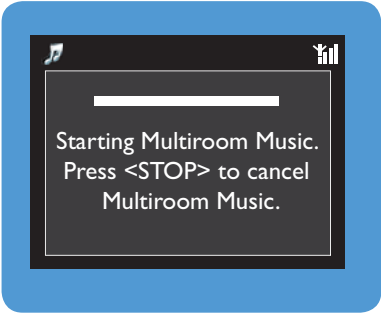

EN

FR

ES

Register Enregistrement Registro

EN Register your MCi8080 on www.philips.com/welcome. You can:

- Manage your own favorite radio stations;
- Receive Streamium newsletters.

FR Registra la tua unità MCi8080 su www.philips.com/welcome. È inoltre possibile:

- Gérer vos stations de radio favorites
- Recevoir le bulletin d'informations Streamium.

ES Regístrate su MCi8080 directamente en www.philips.com/welcome. Puede:

- Gestionar sus propias emisoras de radio favoritas;
- Recibir el boletín de Streamium.

The image shows a sequence of four screenshots from the Philips website registration process, numbered 1 to 4:

- Step 1:** The browser address bar shows <http://www.welcome.philips.com/>. The page title is "Welcome to Simplicity - Country Selection Page". A "Choose country / language" dropdown menu is visible.
- Step 2:** The page displays a "Welcome" message with a photo of a family. A "Please select the appropriate country and language:" prompt is shown above a "Choose Country/Language" dropdown menu.
- Step 3:** The page shows a "Welcome to simplicity" banner and a "Congratulations on your purchase and welcome to Philips!" message. A "Register my product" button is highlighted.
- Step 4:** The "Club Philips Login" page is shown. It has two sections: "Don't have an account?" with a "Create an account" button, and "Already have an account?" with fields for "Email address" and "Password", a "Remember me" checkbox, and a "Login" button.

philips.com

Please log in or register
[Login or register](#)

Step 1: Create your account

Club Philips
Registered Products
Account

Consumer Product
Categories

Personal Information Items marked with a blue asterisk * are required. Philips values and respects your privacy; please read our privacy policy for more information.

* First Name:

* Last Name:

* Substation: PT, SG, P, JPN

* Date of Birth: / /

Street name:

House number:

City:

State / Province:

Postcode:

Telephone: +64

* Country: United Kingdom

Login Information

* Email address: abc@

Your Communication Preferences

Club PHILIPS

You are here: Home > Consumer Products > Philips registration

Welcome, Shuai
[Logout](#)

Club Philips
Registered Products
Account

Consumer Product

Step 2: Your product
Please select the product you want to register

Find your product

Model number or keyword

[How to find the model number](#)

CE 0560

Model No.: MC i 8080/12
220-240V~
50/60Hz 50W

PC AE68

Serial No.: PT 1A1031000001

Made in China

Register your product
Please enter purchase information for your product.

Network music players – MCi 8080/12

Wireless audio products
Philips Streamium Network Music Player MCi 8080
Free Internet radio Full colour display with FullSound™

Date of purchase: 2009-11-25

Place of purchase:

You are about to register a Streamium device. To complete the registration and Stream configuration, please enter the Product Registration ID.

Product Registration ID:

[How to find Product Registration ID?](#)

HOME

Settings

14/16

Check for software ...

Demo mode

Device ID and infor...

Restore factory

philips.com

EN Get help

For more information, look at the user manual on the supplied hard disk drive (HDD). Also, you can find the video tutorials, frequently asked questions (FAQs) and other information at www.philips.com/support.

FR Aide

Pour obtenir de plus amples informations, reportez-vous au manuel d'utilisation disponible sur le disque dur fourni. Vous pouvez également trouver des didacticiels vidéo, des foires aux questions (FAQ) et d'autres informations à l'adresse suivante : www.philips.com/support.

ES Ayuda

Para obtener más información, consulte el manual de usuario suministrado con la unidad de disco duro (HDD). También, puede encontrar tutoriales de vídeo, preguntas más frecuentes (FAQ) y otra información en www.philips.com/support.

Get updates about Streamium

Visit www.streamiumtheblog.com.

Actualités Streamium

Consultez le site www.streamiumtheblog.com.

Cómo obtener actualizaciones de Streamium

Visite www.streamiumtheblog.com.

High Fidelity Wi-Fi Multiroom System



WMS8080



MCI8080



NP3500



NP3700



NP3900



Specifications are subject to change without notice.
Trademarks are the property of Koninklijke Philips Electronics N.V. or their respective owners
© 2011 Koninklijke Philips Electronics N.V.
All rights reserved.
www.philips.com



Printed in China
_WK1104.1