

1 Connect

A Placement

Proper speakers system placement is important to ensure optimum sound performance.

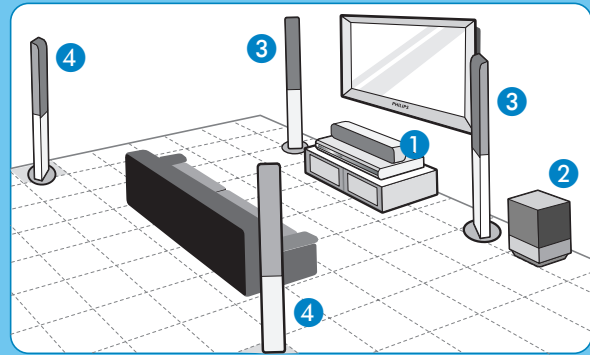

- 1 Place the center speaker above or close to the TV.
- 2 Place the subwoofer on the floor, at least one metre away from the TV.
- 3 Place the front speakers at equal distances from the TV.
- 4 Place the rear speakers at normal listening ear level.

B Connect the radio antennas

Keep the antennas away from the electronic devices to prevent unwanted interference.

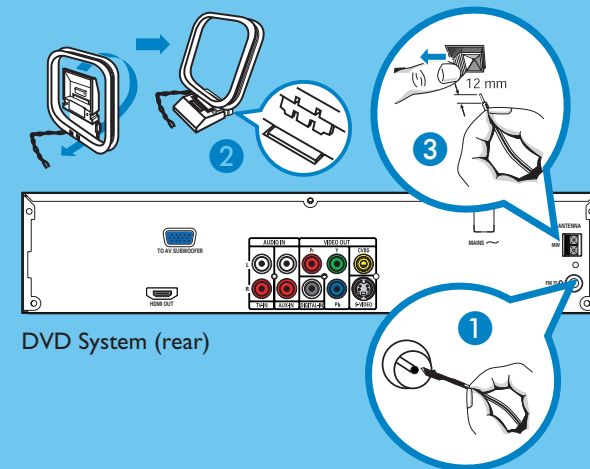

- 1 Connect the FM antenna to the FM jack. Extend the wire and fix its end to the wall.
- 2 Unfold the AM/MW loop antenna and fix the claw into the slot.
- 3 Push the tabs and insert the wires into the AM/MW jacks.

C Connect the speakers to AV subwoofer

Connect the various colored plugs from the speakers to the same colored jacks at the rear of the AV subwoofer.

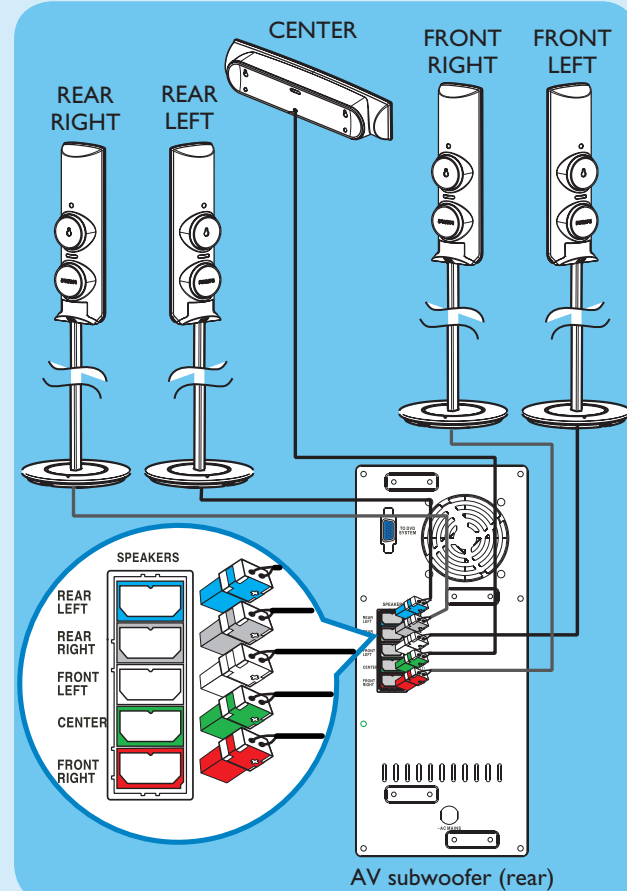

D Connect the AV subwoofer to DVD system

Use the supplied inter-connect cable to connect TO AV SUBWOOFER jack and TO DVD SYSTEM jack. Tighten the screws at the sides to secure the connection.

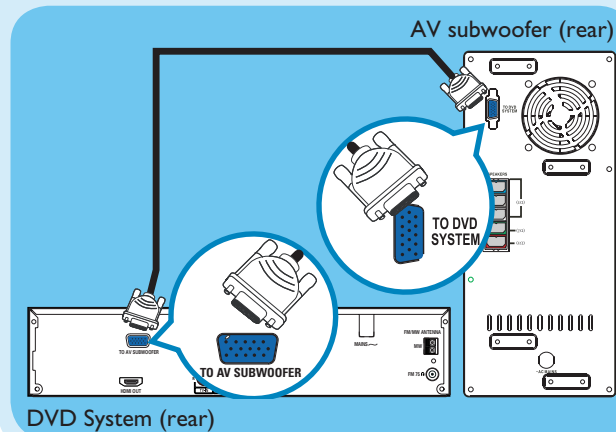

E Connect the DVD system to TV

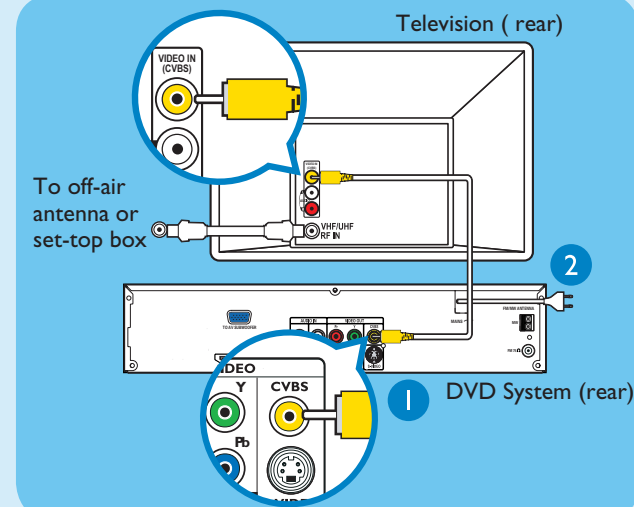

- 1 Use the supplied composite video cable to connect the CVBS jack on this DVD system to the VIDEO IN jack on your TV.
- 2 Plug in the power cables from the DVD system, AV subwoofer and TV to the AC power outlets.

Note It is important to connect the DVD system directly to your TV.

F Connect the audio from TV to DVD system (optional)

To hear the TV audio through this home theater system, use the red and white audio cables (not supplied) to connect the TV IN (R/L) jacks on this DVD system to the AUDIO output jacks on your TV.

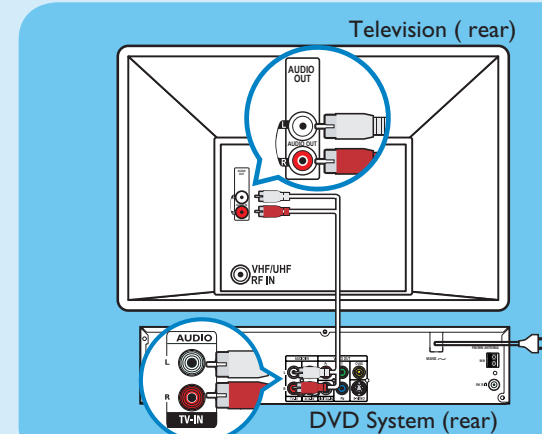

Note Press **TV** on the remote control to get the sound output from the speakers system when watching the TV program.

2 Set up

A Finding the viewing channel

- 1 Press **STANDBY ON** on the DVD system.
- 2 Press **SOURCE** on the DVD system until "DISC" appears on the display panel.

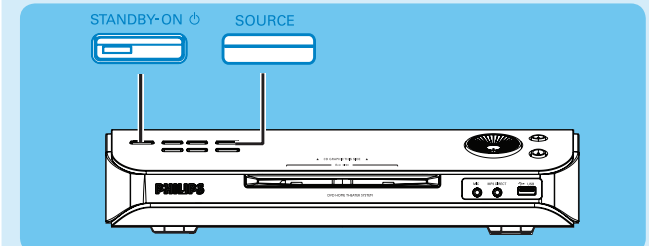

- 3 Turn on the TV. Use the TV's remote control to select the correct viewing channel for the DVD system. You should see the blue DVD background on the TV.

Note To search for the correct viewing channel, press the Channel Down button on the TV's remote control repeatedly (or AV, SELECT, button) until you see the blue DVD background.

B Select the display language on the screen

- 1 Press **SETUP**. The { General Setup Page } appears.

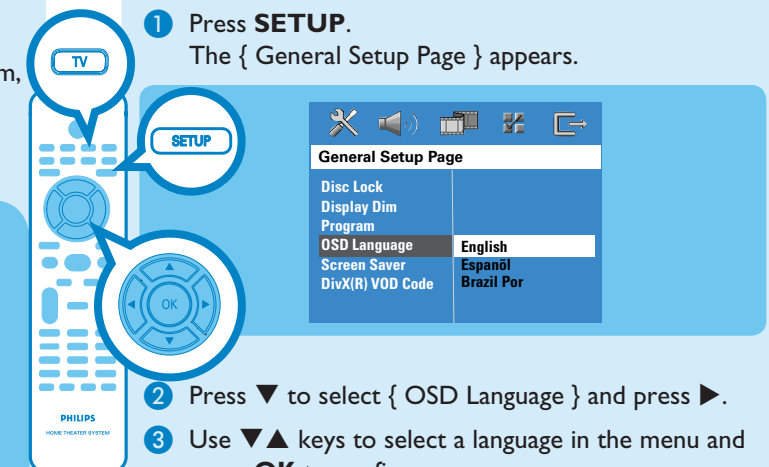

- 2 Press **▼** to select { OSD Language } and press **▶**.
- 3 Use **▼▲** keys to select a language in the menu and press **OK** to confirm.
- 4 Press **SETUP** to exit.

Note The language set here is only for the menus that are shown on the TV while operating this DVD system, not for the DVD disc menu.

There are various setup options (Audio Setup, Video Setup, Preference Setup) available on this DVD system. Refer to the user manual for more information.

3 Enjoy

Start disc playback

- 1 Insert a disc into the disc slot with the disc label facing up.

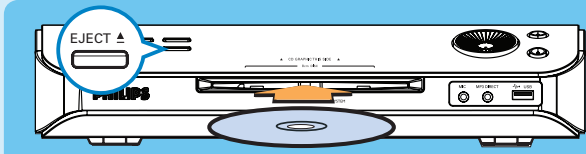

- 2 Playback will start automatically.
- 3 If the disc menu appears, use **▼▲** keys to select an option in the menu and press **PLAY ▶** to start playback.
- 4 Press **STOP ■** to stop playback.
- 5 Press **EJECT ▲** to remove the disc.

Note When you press PLAY button again, the playback will resume from its last stopped point. To start playback from the beginning, you have to press STOP button two times to cancel the resume mode, then press PLAY button.

Playback from the USB

- 1 Insert your USB device into the USB port and wait for the message to appear on the screen.
- 2 Press **DISC/USB** to access the contents on your USB device.
- 3 Press **OK** to start playback.
- 4 To stop playback, press **DISC/USB** again to switch to 'DISC' mode. You can unplug your USB device now.

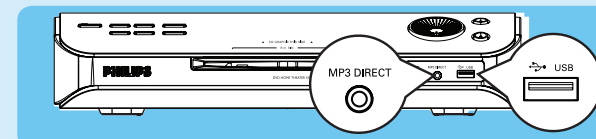

Playback from the portable audio/HDD player

- 1 Use the supplied MP3 direct cable to connect the headphone output jack on your portable audio/HDD player to the MP3 DIRECT jack.
- 2 Press **MP3 DIRECT** on the remote control.
- 3 Press **PLAY** on your portable audio/HDD player to start playback.

Note You can only control the playback features using your portable audio/HDD player.

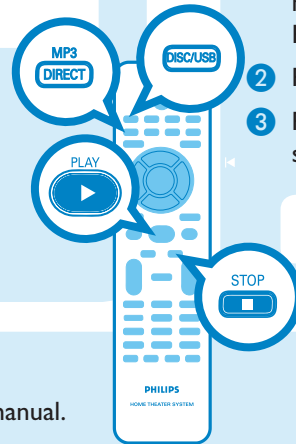

Troubleshooting

For more troubleshooting tips, see the user manual.

No picture.

- Press DISC/USB button on the remote control.
- Check the connection to the TV and ensure the plugs are firmly in place.

No sound.

- Check the speaker connections and settings.
- Check the audio connections and press **SOURCE** button to select the correct input source.
- The center and rear speakers operate only in multi-channel surround mode. Press **SURR** button to select multi-channel surround output.

The DVD system does not work.

- Disconnect the power cord from the power outlet for a few minutes. Reconnect the power cord and try again.

Need help?

User Manual

See the user manual that comes with your Philips DVD System

Online

Go to www.philips.com/support



2005 © Koninklijke Philips N.V.
All rights reserved.
12 NC 3139 246 21361
www.philips.com

Quick Start Guide



- 1 Connect
- 2 Set up
- 3 Enjoy

What's in the box?

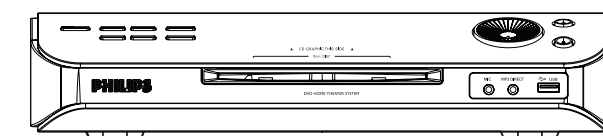

DVD system

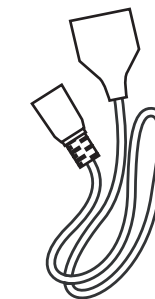

2 Power cables

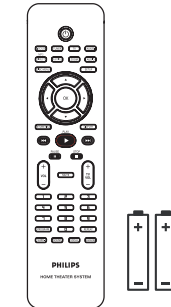

Remote Control and 2 batteries

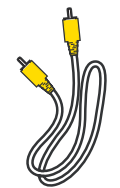

Composite video cable

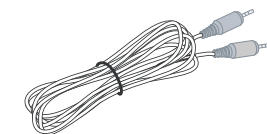

MP3 direct cable for portable audio player

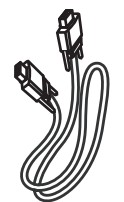

Inter-connect cable

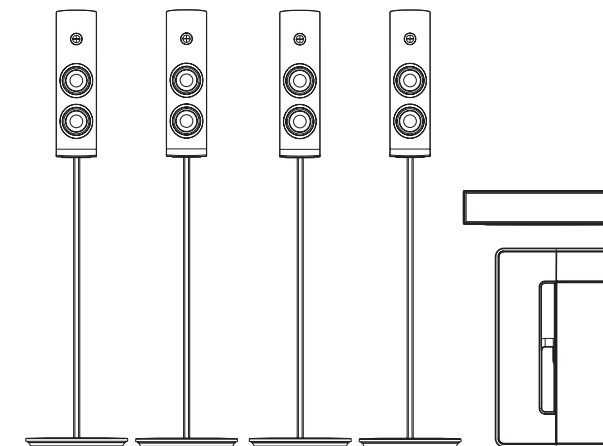

1 center, 2 front, 2 rear speakers and AV subwoofer



FM wire antenna

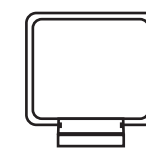

AM/MW loop antenna



User Manual

PHILIPS