

PHILIPS

Speaker

TAVS500



User manual

Register your product and get support at
www.philips.com/welcome

Contents

1 Important	2
Important safety instructions.....	2
Battery safety precaution.....	2
Notice	2

2 Your Bluetooth speaker	4
Introduction.....	4
What's in the box.....	4
Overview of the main unit.....	4

3 Get started	5
Built-in batteries.....	5
Turn on/off.....	5

4 Play	6
Play from a Bluetooth device.....	6
Play from an external device.....	6
Control playback.....	6

5 Product information	7
------------------------------------	----------

6 Troubleshooting	8
--------------------------------	----------

1 Important

Important safety instructions

- The speaker shall not be exposed to dripping or splashing.
- Do not place any source of danger on the speaker (e.g. liquid filled objects, lit candles).
- Make sure that there is enough free space around the speaker for ventilation.
- Please use the speaker safely in an environment with temperature between 0° and 45°.
- Only use attachments and accessories specified by the manufacturer.

Battery safety precaution

- Danger of explosion if a battery is incorrectly replaced. Replace only with the same or equivalent type.
- A battery (battery pack or battery installed) shall not be exposed to excessive heat such as sunshine, fire or the like.
- A battery in extreme high or low temperatures during use, storage or transportation, and low air pressure at high altitude can pose safety hazards.
- Do not replace a battery with an incorrect type that can defeat a safeguard (for example, some lithium battery types).
- Disposing a battery into fire or a hot oven mechanically crushing or cutting a battery can result in an explosion.
- Leaving a battery in an extremely high temperature surrounding, or an extremely low air pressure environment may result in an explosion or leakage of flammable liquid or gas.

Warning

- Never remove the casing of this speaker.
- Never lubricate any part of this speaker.
- Place this speaker on a flat, hard and stable surface.
- Never place this speaker on other electrical equipment.
- Only use this speaker indoors. Keep this speaker away from water, moisture and liquid-filled objects.
- Keep this speaker away from direct sunlight, naked flames or heat.
- Risk of explosion if a battery is replaced by an incorrect type

Notice



Hereby, TP Vision Europe B.V. declares that this speaker is in compliance with the essential requirements and other relevant provisions of Directive 2014/53/EU. You can find the Declaration of Conformity on www.philips.com/support.



This speaker is designed and manufactured with high quality materials and components, which can be recycled and reused.



When this crossed-out wheeled bin symbol is attached to a product it means that the product is covered by the European Directive 2012/19/EU.

Please be informed about the local separate collection system for electrical and electronic products.

Please act according to your local rules and do not dispose your old products with your normal household waste. Correct disposal of your old products will help prevent potential

negative consequences for the environment and human health.



Your speaker contains batteries covered by the European Directive 2013/56/EU, which cannot be disposed with normal household waste. Please be informed about the local rules on separate collection of batteries because correct disposal will help prevent negative consequences for the environmental and human health.

Note

- The type plate is located on the back of the speaker.

Caution

- Removal of the built-in batteries invalidate the warranty and may destroy the speaker.

Always bring your speaker to a professional to remove the built-in batteries.

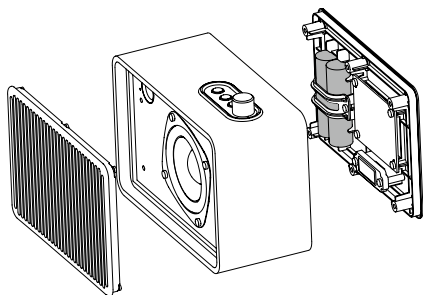

Environmental information

All unnecessary packaging has been omitted. We have tried to make the packaging easy to separate into three materials: cardboard (box), polystyrene foam (buffer) and polyethylene (bags and protective foam sheet).

Your speaker consists of materials which can be recycled and reused if disassembled by a specialized company. Please observe the local regulations regarding disposal of packaging materials, exhausted batteries and old equipment.

2 Your Bluetooth speaker

Congratulations on your purchase, and welcome to Philips! To fully benefit from the support that Philips offers, register your speaker at www.philips.com/welcome.

Introduction

With this speaker, you can enjoy audio from compatible Bluetooth devices or other audio devices.





What's in the box

Check and identify the contents of your package:

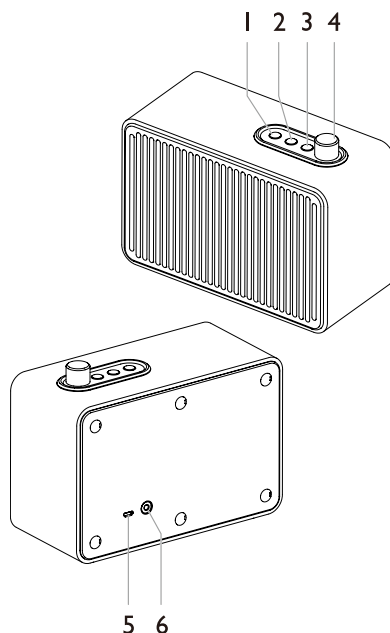
- Main unit
- USB cable
- Audio cable
- Quick start guide
- Worldwide Warranty

Overview of the main unit



1.  - Turn on/off the speaker
2.  - Select a function
- Connect/disconnect Bluetooth pairing
3.  - Start, pause, or resume play
- Skip to the next track
4. Increase/decrease volume
5.  **2A** - Connect a USB cable
6. AUX IN - Connect an external audio device

3 Get started

! Caution

- Use of controls or adjustments or performance of procedures other than those specified herein may result in hazardous radiation.

Always follow the instructions in this chapter in sequence.

If you contact Philips, you will be asked for the model and serial number of this speaker. The model number and serial number are on the back of the speaker. Write the numbers here:

Model No. _____

Serial No. _____

Built-in batteries

The speaker can operate on built-in rechargeable batteries.

- When the speaker is turned on, and the batteries are low, the "⏻" blinks.

Recharge the built-in batteries:

- 1 Connect one end of a USB cable to the **5V = 2A** socket on the speaker.
- 2 Connect the other end of the USB cable to an outlet (**5V = 2A**).

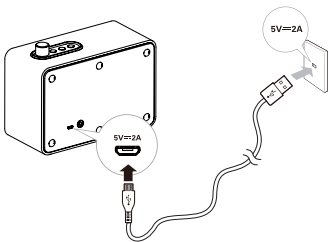

- When the speaker is charging, the "⏻" light is on.
- When the batteries are full, the "⏻" light is off.

! Caution

- Risk of speaker damage! Make sure the power supply voltage corresponds to the voltage printed on the back or the underside of the speaker.
- Risk of electric shock! When unplug a USB cable, always pull the plug from the socket. Never pull the cord.
- Use only a USB cable specified by the manufacturer or sold with this speaker.

Turn on/off

Press the ⏻ button to turn the speaker on or off.

- The speaker gives out the prompt sound when it is on.
- If nothing is plugged into the AUX IN socket, the "🔊" blinks.

Turn off the speaker automatically:

The speaker turn off automatically in the following situations:

- In Bluetooth mode: no audio signal from a Bluetooth device for over 15 minutes.
- In AUX IN mode: no audio device connected for over 15 minutes.

4 Play

Play from a Bluetooth device

You can stream audio from a device to this speaker using Bluetooth connection.

Note

- Make sure to turn Bluetooth on to make a device discoverable before pairing.
- The speaker and a device must be placed within 10 meters Bluetooth sensing distance.

- 1 Press the **⌘** button on the speaker.
 - the "⌘" blinks blue to allow wireless connection.
 - Bluetooth is automatically enabled on the speaker if nothing is plugged into the AUX IN socket.
- 2 On a Bluetooth device, turn Bluetooth on to make it discoverable.
- 3 Select "Philips VS500" on the device for pairing.
 - For an older device, input pairing password 0000.
 - The "⌘" light becomes solid blue when connection is successful.
- 4 Press the **▶** button on the Bluetooth device to start streaming music.

Disconnect Bluetooth pairing

- Press and hold the **⌘** button for 2 seconds or more, until the "⌘" blinks.

Play from an external device

You can listen to music from an external audio device on the speaker.

- 1 Connect an audio cable to the AUX IN socket on the speaker and the headphone jack on an external device.
 - The speaker is then switched to AUX IN mode.
 - The "⌘" lights off.

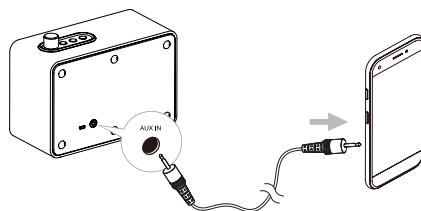

- 2 Press the **▶** button on the external device to start streaming music.

Control playback

During play



- Turn the volume knob to increase/decrease the volume.
- Press the **▶||** button to play/pause. Quickly press the **▶||** button twice to skip to the next track.
 - Works only in Bluetooth mode.

5 Product information

Note

- Product information is subject to change without prior notice.

General information

Power requirement	5V  2A
Lithium battery	7.4V  2200mAh
Dimensions (W x H x D)	180 x 140 x 84 mm
Weight (main unit)	0.99 kg

Amplifier

Output power	1 0W
Frequency response	100 - 20000 Hz
Signal to noise ratio	> 70 dB

Speakers

Speaker impedance	4Ω
Speaker maximum input power	10W
Speaker driver	3" full range

Bluetooth

Bluetooth version	5.0
Frequency range	2402 - 2480 MHz
Maximum power transmitted	5dBm
Maximum communication range	approx. 10m
Compatible Bluetooth profiles	A2DP

6

Troubleshooting

Warning

- Never remove the casing of this speaker.

To keep the warranty valid, never try to repair the speaker yourself.

If you encounter problems when using this speaker, check the following points before requesting service. If the problem remains unsolved, go to the Philips web site (www.philips.com/welcome). When you contact Philips, ensure that the speaker is nearby and the model number and serial number are available.

No power

- Make sure the speaker is fully charged.
- Make sure the USB socket of the speaker is connected properly.
- As a power-saving feature, the speaker turns off automatically 15 minutes after no audio signal is received or no audio device is connected.

No sound

- Adjust the volume.

No response from the speaker

- Restart the speaker.

Music playback is unavailable on this speaker even after successful Bluetooth connection

- The device cannot be used to play music through this speaker wirelessly.

The audio quality is poor after connection with a Bluetooth-enabled device

- The Bluetooth reception is poor. Move the device closer to this speaker or remove any

obstacle between them.

Cannot connect to this speaker

- The device does not support the profiles required for this speaker.
- The Bluetooth function of this speaker is not enabled. Refer to the user manual of the speaker to find out how to enable the function.
- This speaker is not in pairing mode.
- This speaker is already connected to another Bluetooth-enabled device. Disconnect that device then try again.



Philips and the Philips Shield Emblem are registered trademarks of Koninklijke Philips N.V. and are used under license.

This product has been manufactured by and is sold under the responsibility of MMD Hong Kong Holding Limited or one of its affiliates, and MMD Hong Kong Holding Limited is the warrantor in relation to this product.

