

Quick Start Guide



Step A *Connect*

Step B *Setup*

Step C *Enjoy*

What's in the Box?

You should find these items upon opening the box.

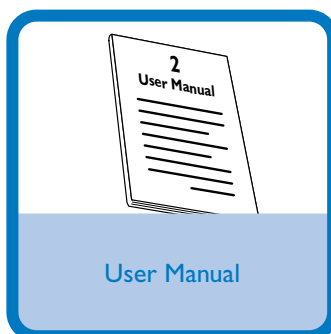
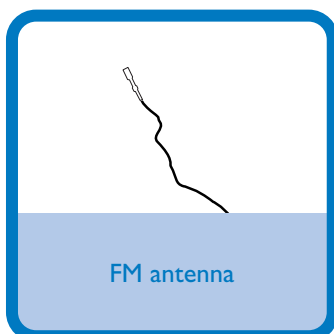
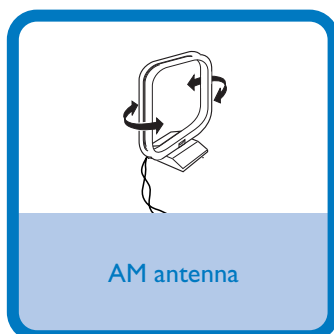
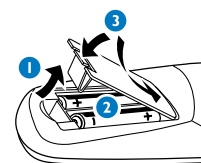
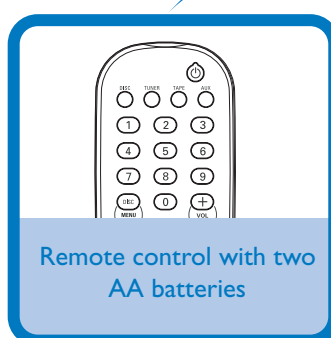
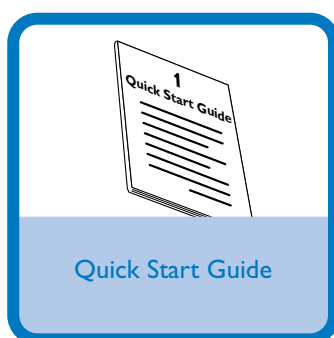
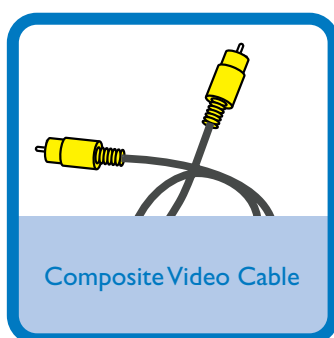

Step A *Connect*

Tip

See the User Manual for other TV connection options.

1

Connect the speaker cables.

2

Connect the AM antenna.

3

Connect the composite video cable to a TV.

4

Connect the power cords of the system and TV.

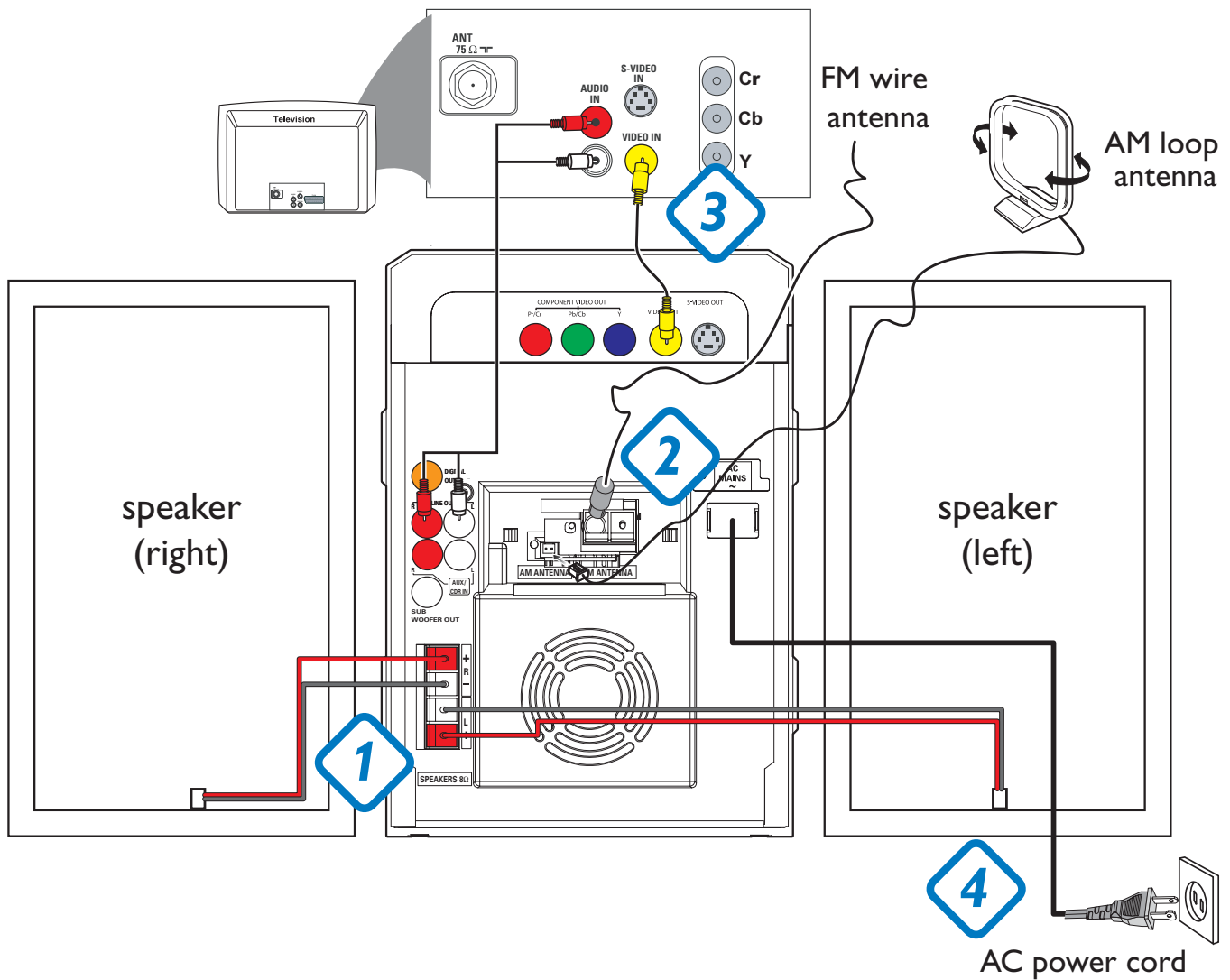

Step B *Setup*

Setting up the TV

1

Press **SOURCE** (**DISC** on the remote) to select disc source.

2

Turn on the TV and set it to the correct Video In channel.

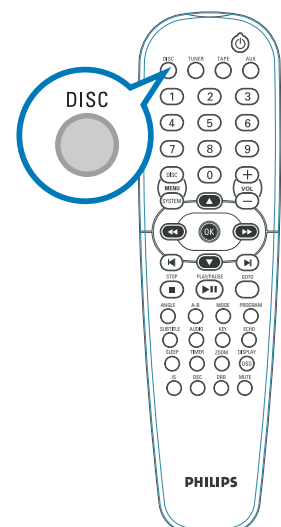

Step B Setup

Setting the clock

IMPORTANT!

– To set clock in the Eco Power mode, press and hold **ECO POWER/STANDBY-ON** on the set for 3 seconds or more to switch to normal standby mode first before proceeding with the procedures below.

1

In standby mode, press and hold **CLOCK SET** on the system.

2

When the hour digits flash, turn the **VOLUME** control on the front panel or press **VOL+/-** on the remote to set the hours.

3

Press **CLOCK SET** again and the minute digits flash. Then turn the **VOLUME** control on the front panel or press **VOL+/-** on the remote to set the minutes.

4

Press **CLOCK SET** again to confirm the time setting.

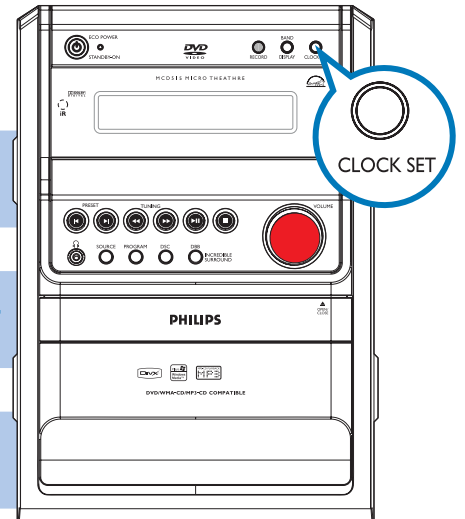

Setting system menu options

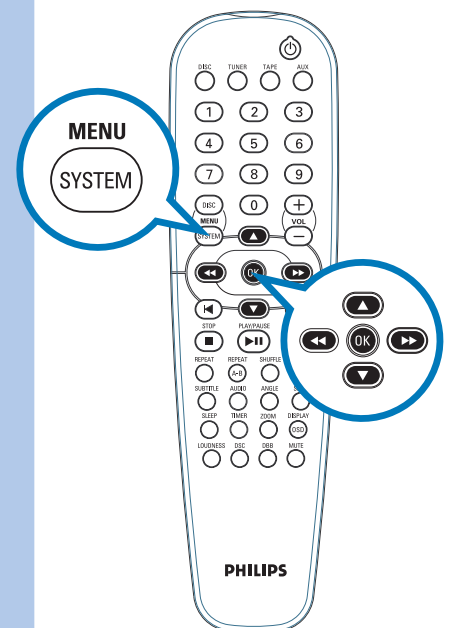
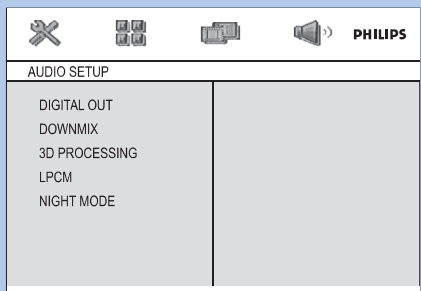
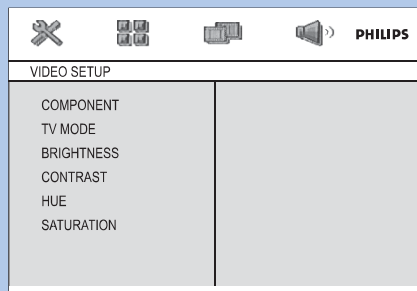
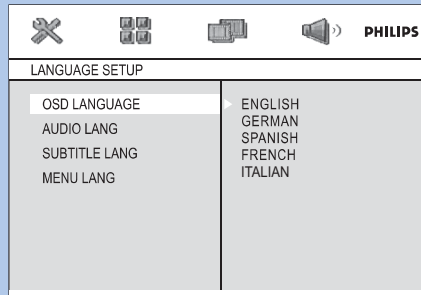
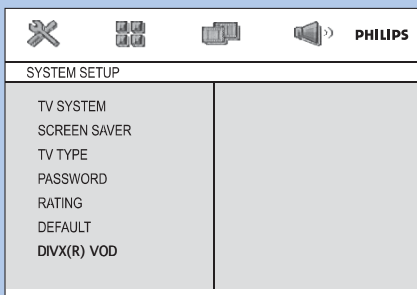

Tip

See chapters "Preparations" and "System Menu Options" in the User Manual for detailed descriptions.

Playing a disc

- 1 Press **OPEN-CLOSE** to open the disc tray and load in a disc, then press the same button again to close the disc tray.
→ Make sure the label side of the disc is facing up.
- 2 Playback will start automatically. If not press **PLAY/PAUSE** **▶ II**.
- 3 To stop playback, press **STOP** **■**.

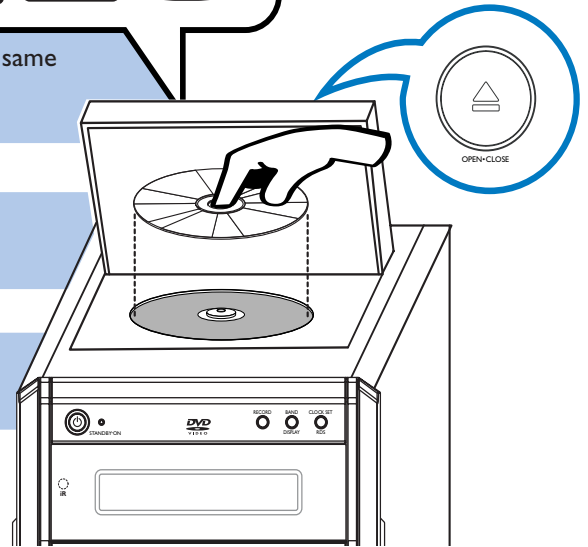
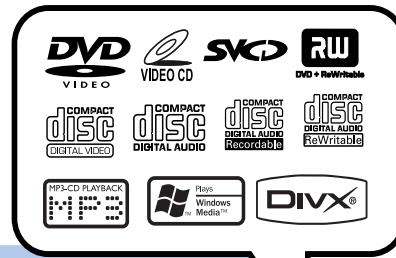

Programming and tuning to radio stations

- 1 Press **SOURCE** (**TUNER** on the remote) to select tuner source.
- 2 Press **PROGRAM** for more than three seconds to program all available stations in order of waveband.
- 3 Press **PRESET** **◀/▶** until the desired preset station is displayed.

Tip

Detailed playback features and additional functions are described in the accompany owner's manual.

