



Philips BeNear
Cordless phone

1000-series
Black



CD1911B

Bringing people closer

Talk handsfree

Our clever design gives you great sound reproduction without having to hold the phone to your ear – so you can talk completely handsfree. With simple installation and a user-friendly menu, a great chat has never been easier.

Crystal clear sound

- Advanced sound testing & tuning for superb voice quality
- Parametric Equalizer delivers pure and clear sound
- Acoustic echo cancellation keeps your conversation echo-free
- Handset speakerphone allows you to talk handsfree
- Optimized antenna layout for great reception in any room

Nice and simple

- Easy to read, 4.1cm (1.6") dot-matrix display
- Ultimate convenience through easy setup
- Save up to 50 favorite contacts in your phonebook
- Up to 16 hours of talk time

Eco-conscious product

- Low power consumption: < 0,6W in stand-by mode
- Up to 95% reduction of emitted radiation in charging mode

PHILIPS

Cordless phone
1000-series Black

CD1911B/FT

Highlights

4.1cm(1.6") dot-matrix display

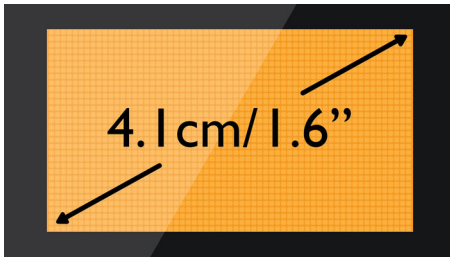

Easy to read, 4.1cm (1.6") dot-matrix display

50-name phone book



Always have the phone numbers of your loved ones available: Save up to 50 names in your phonebook.

Acoustic echo cancellation

No more of those annoying echoes when you are talking on the phone. With our acoustic echo cancellation, you always get a clear, undisturbed connection.

Advanced sound testing



We test the sound quality of our DECT phones the same way as high-end headphone manufacturers do. Using an advanced ear simulator, we can accurately re-create the way people actually hear. This helps our acoustic engineers to measure and fine-tune things like frequency response, distortion and overall hearing perception, to create perfect voice

reproduction for both handset and handsfree modes.

Easy setup

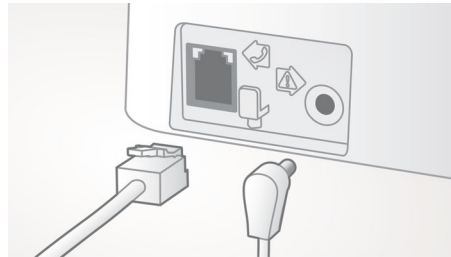

Ultimate convenience through easy set up. Simplified installation - Plug & Play product

Handset speakerphone



Handsfree mode uses a built-in loud speaker to amplify the voice of the caller, allowing you to speak and listen during a call without holding the phone to your ear. This is especially useful if you want to share the call with others or simply multitask.

Less radiation while charging



Up to 95% reduction of emitted radiation in charging mode

Low power consumption: < 0.6 W



Philips phones are energy efficient and are designed to be respectful to the environment. Now the power consumed in stand-by mode is less than < 0.6 W.

Optimized antenna layout



Our optimized antenna layout ensures strong and stable reception – even in areas of the house where cordless transmission is difficult. Now you can take a call wherever you are in the house, and enjoy a long, uninterrupted conversation even as you walk around.

Parametric Equalizer



Our telephones use parametric equalization in the digital sound processing to fine-tune the sound response back to the intended linear frequency response curve, delivering sound that is pure and clear, for each conversation.

Specifications

Sound

- Volume control on handset
- Ringtones on handset: 10 polyphonic

Picture/Display

- Display size: 4.1 cm / 1.6"
- Display type: 1-line dot matrix + 2 line icons
- Backlight: Yes
- Backlight color: Amber

Convenience

- Speakerphone - talk handsfree
- Menu structure in the handset: List Menu
- Signal strength indicator: 3- bar indicator
- Battery level indicator: 3- bar battery icon
- Date / Time display
- Base Station keys: Paging key
- Battery charge indication
- Signal strength indication
- Programmable hot keys: Key 1 and 2
- Auto hang up
- Key tone on/off
- Call Management: Call Waiting*, Caller ID*, Microphone mute, Missed Calls, Received Calls
- Multi base capability: 1
- Multi handset capability: Up to 4
- Intercom - multiple handsets
- Line cord length: 1.8m
- Power cord length: 1.8m
- Charge time: 8 hours
- Up to 16 hrs talk time
- Up to 250 hrs standby time
- Range: Open field <300m; in door <50m

Memory Capacity

- Phonebook: 50 names and numbers
- Redial List Capacity: 10 entries
- Call log entries: 20 entries
- Phonebook store in the base

Power

- Battery Capacity: 650 mAh
- Battery type: AAA NiMH Rechargeable
- Mains power: AC 100-240V ~50/60Hz
- Power Consumption: < 0.6 W

Security

- Transmission encryption : Yes

Network Features

- Compatible: GAP

SAR Value

- Philips handsets: <0.1 W/kg

Eco Design

- EcoMode: automatic

Packaging dimensions

- Packaging dimensions (W x H x D):
18,5 x 13,6 x 8,2 cm
- Nett weight: 0,324 kg
- Gross weight: 0,436 kg
- Tare weight: 0,112 kg
- EAN: 87 12581 65521 1
- Number of products included: 1
- Packaging type: Dummy
- Type of shelf placement: Dummy



Issue date 2019-05-31

Version: 1.1.6

12 NC: 8670 000 93505
EAN: 87 12581 65521 1

© 2019 Koninklijke Philips N.V.
All Rights reserved.

Specifications are subject to change without notice.
Trademarks are the property of Koninklijke Philips N.V.
or their respective owners.

www.philips.com