

Always there to help you  
Register your product and get support at  
[www.philips.com/support](http://www.philips.com/support)



## Quick Start Guide

PHILIPS



Specifications are subject to change without notice.  
This product has been manufactured by, and is sold under the responsibility of Gibson Innovations Ltd., and Gibson Innovations Ltd. is the warrantor in relation to this product.  
Philips and the Philips Shield Emblem are registered trademarks of Koninklijke Philips N.V. and are used under license.

AJ3200\_79\_QSG\_V5.0



## 1 Important

### Safety

Know these safety symbols



This 'bolt of lightning' indicates uninsulated material within your unit may cause an electrical shock. For the safety of everyone in your household, please do not remove product covering.  
The 'exclamation point' calls attention to features for which you should read the enclosed literature closely to prevent operating and maintenance problems.  
**WARNING:** To reduce the risk of fire or electric shock, this apparatus should not be exposed to rain or moisture and objects filled with liquids, such as vases, should not be placed on this apparatus.  
**CAUTION:** To prevent electric shock, match wide blade of plug to wide slot, fully insert.

### Warning

- Never remove the casing of this clock radio.
  - Never lubricate any part of this clock radio.
  - Never place this clock radio on other electrical equipment.
  - Keep this clock radio away from direct sunlight, naked flames or heat.
  - Make sure that you always have easy access to the power cord, plug or adaptor to disconnect the clock radio from the power.
- Make sure that there is enough free space around the product for ventilation.
  - Battery usage **CAUTION** – To prevent battery leakage which may result in bodily injury, property damage, or damage to the clock radio:
    - Install the batteries correctly, + and - as marked on the clock radio.
    - Do not mix batteries (old and new or carbon and alkaline, etc.).
    - Remove the batteries when the clock radio is not used for a long time.
    - The batteries shall not be exposed to excessive heat such as sunshine, fire or the like.
  - Use only power supplies listed in the user manual.
  - The clock radio shall not be exposed to dripping or splashing.
  - Do not place any sources of danger on the clock radio (e.g. liquid filled objects, lighted candles).
  - Where the plug of the Direct Plug-in Adapter is used as the disconnect device, the disconnect device shall remain readily operable.

## 2 Notice

Any changes or modifications made to this device that are not expressly approved by Gibson Innovations may void the user's authority to operate the equipment.

### Disposal of your old product and batteries

Your product is designed and manufactured with high quality materials and components, which can be recycled and reused. Never dispose of your product with other household waste. Please inform yourself about the local rules on the separate collection of electrical and electronic products and batteries. The correct disposal of these products helps prevent potentially negative consequences on the environment and human health.

Your product contains batteries, which cannot be disposed of with normal household waste. Please inform yourself about the local rules on separate collection of batteries. The correct disposal of batteries helps prevent potentially negative consequences on the environment and human health.

Please visit [www.recycle.philips.com](http://www.recycle.philips.com) for additional information on a recycling center in your area.

### Environmental information

All unnecessary packaging has been omitted. We have tried to make the packaging easy to separate into three materials: cardboard (box), polystyrene foam (buffer) and polyethylene (bags, protective foam sheet).  
Your system consists of materials which can be recycled and reused if disassembled by a specialized company. Please observe the local regulations regarding the disposal of packaging materials, exhausted batteries and old equipment.

### Note

- The type plate is located on the bottom of the apparatus.

### Class II equipment symbol:



CLASS II apparatus with double insulation, and no protective earth provided.

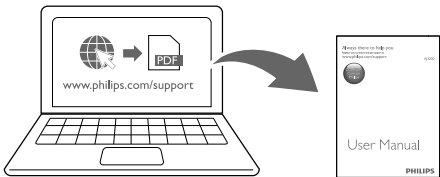

To download the full user manual, visit [www.philips.com/support](http://www.philips.com/support).

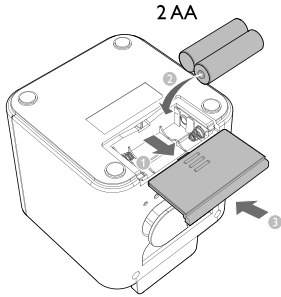
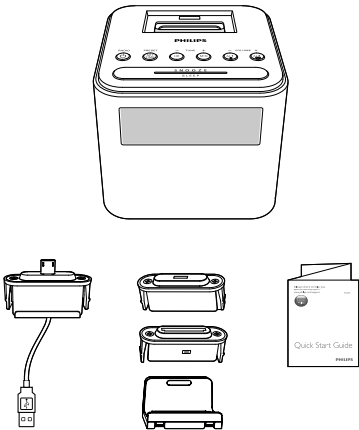

The batteries (not supplied) can only back up clock and alarm settings when AC power is disconnected.

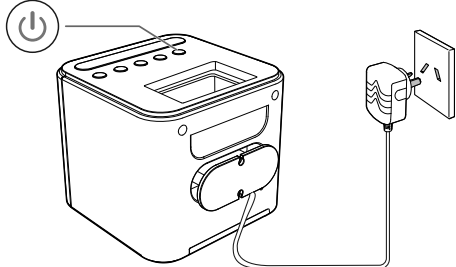

**RADIO**  
Power on ↔ standby

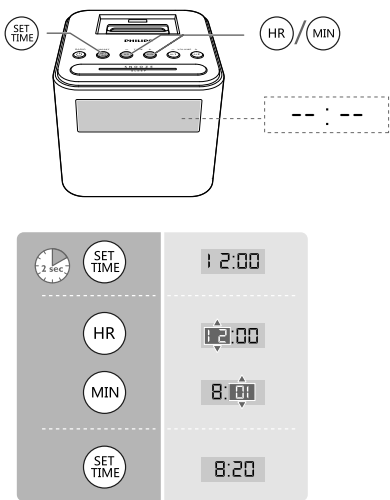

**Note:** You can only set time in standby mode.

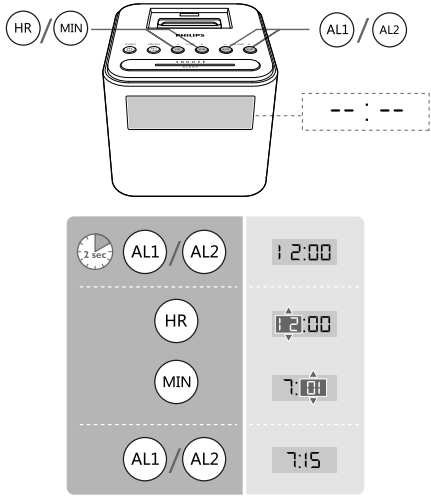

**Note:**  
Make sure that you have set the clock correctly.

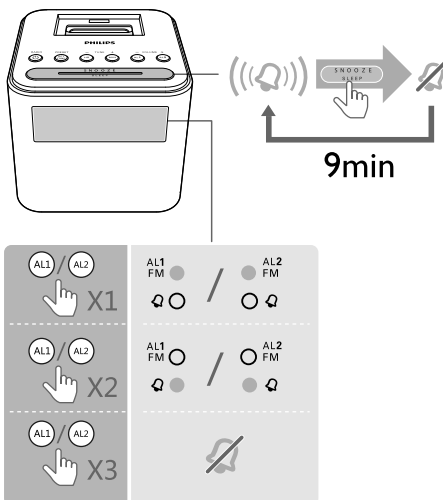

When alarm sounds, press **SNOOZE**.  
→ The alarm snoozes and repeats ringing nine minutes later.

Press **AL1** or **AL2** repeatedly to select an alarm source (FM radio or buzzer) or deactivate the alarm timer.

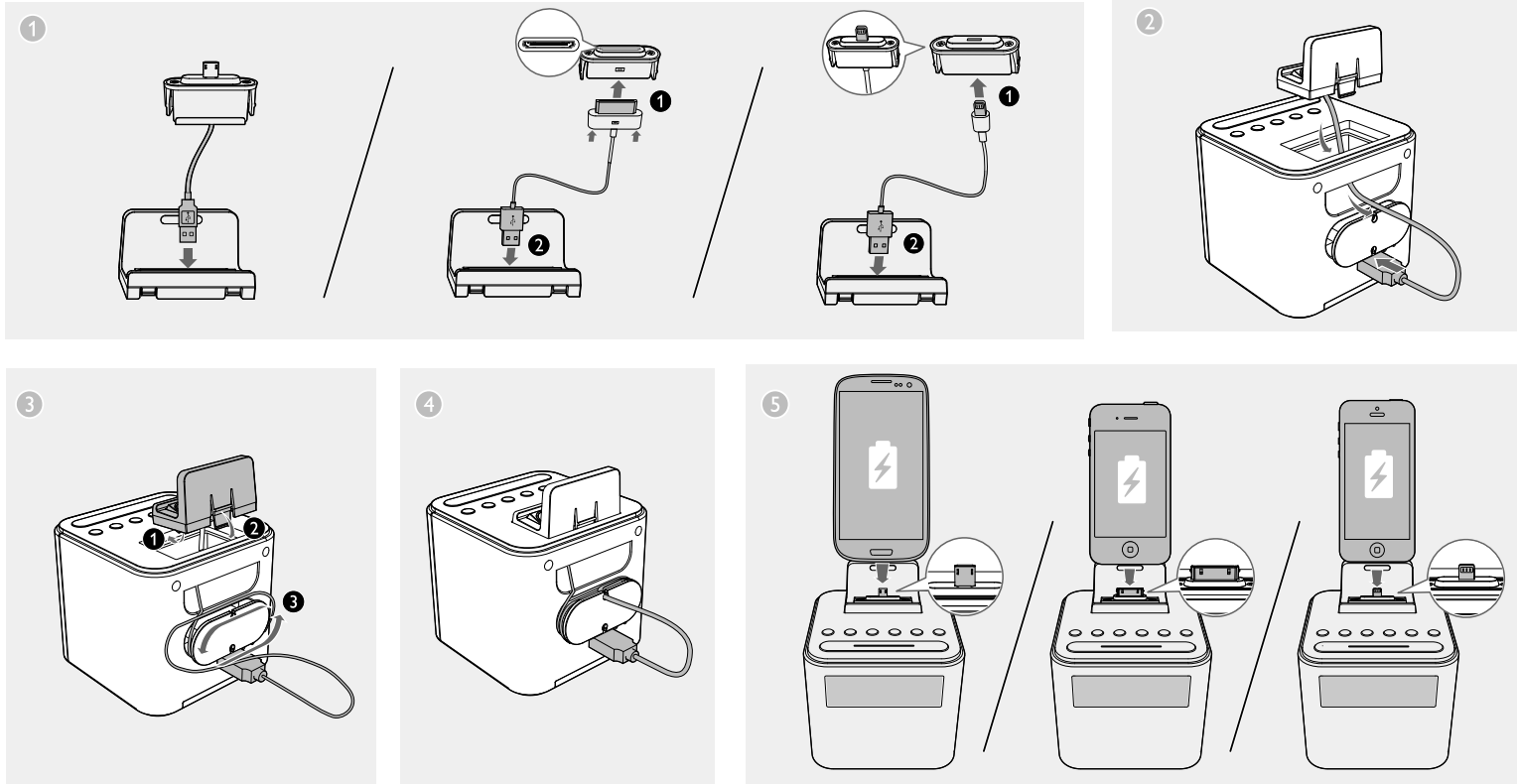

#### Charge your mobile devices

- 1 Connect the clock radio with your mobile device.
  - For **Android-powered mobile device with a micro USB socket**: use the supplied cable to connect the product with the mobile device;
  - For **Apple device with a lightning or 30-pin connector**: use the charging cable of the Apple device (not supplied) to connect the product with the mobile device.
- 2 Connect the clock radio to AC power:
  - The mobile device begins to charge.

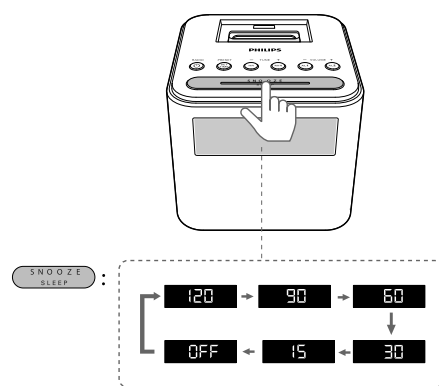

Press **SLEEP** repeatedly to select a period (in minutes). After the set period, the product switches to standby mode automatically.

- To deactivate the sleep timer, press **SLEEP** repeatedly until **[OFF]** is displayed.



#### Specifications

##### Amplifier

Total Output Power 500 mW

##### Tuner (FM)

Tuning Range 87.5-108 MHz

Tuning Grid 50 KHz

Sensitivity  
- Mono, 26 dB S/N Ratio <22 dBf

Total Harmonic Distortion <3%

Signal to Noise Ratio >50 dBA

##### General information

AC Power (power adapter) Brand name: Philips;  
Model: S012B0551500S;  
Input: 100-240V~ 50/60Hz  
max. 400mA;  
Output: 5.5V = 1500mA

USB Charging Voltage DC 5V

USB Charging Current ≤ 1000 mA

Operation Power Consumption 9 W

Standby Power Consumption <1 W

Dimensions:  
- Main Unit (W x H x D) 112 x 101 x 125 mm

Weight - Main Unit 0.4 kg

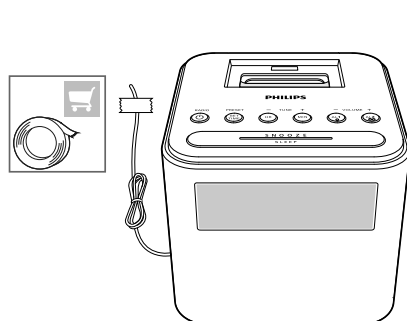

- 1 Fully extend and adjust the position of the pig-tail antenna until you find the best reception.
- 2 Fix the antenna as illustrated.

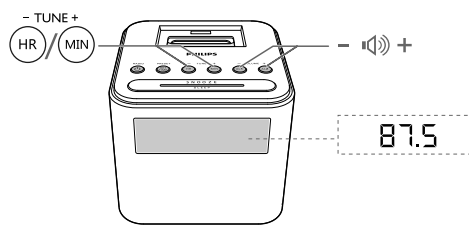

Tune to FM radio stations

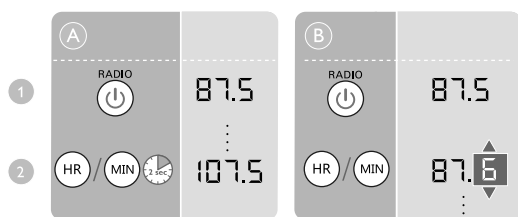

#### Store radio stations

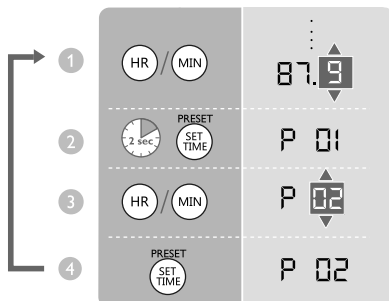

##### Note:

- You can store a maximum of 10 preset radio stations.
- To overwrite a pre-stored radio station, store another one with its sequence number.

#### Select a preset radio station



## PHILIPS

#### Warranty against Defects

In this warranty:

**We or us** means Gibson Innovations ABN 531 651 059 75, and our contact details are set out at the end of this warranty;

**You** means the purchaser or the original end-user of the Goods;

**Supplier** means the authorised distributor or retailer of the Goods that sold you the Goods in Australia or New Zealand; and

**Goods** means the product or equipment which was accompanied by this warranty and purchased in Australia or New Zealand.

If you require assistance with the operation of the product, its features or specifications please call the Philips Consumer Care Centre on 1300 850 633 in Australia or 0800 639 953 in New Zealand.

**Australia:** Our Goods come with guarantees that cannot be excluded under the Australian Consumer Law. You are entitled to a replacement or refund for a major failure and for compensation for any other reasonably foreseeable loss or damage. You are also entitled to have the Goods repaired or replaced if the goods fail to be of acceptable quality and the failure does not amount to a major failure. This is not a complete statement of your legal rights as a consumer.

**New Zealand:** Our Goods come with guarantees that cannot be excluded under the Consumer Guarantees Act 1993. This guarantee applies in addition to the conditions and guarantees implied by that legislation.

##### Additional Warranty:

In addition to the rights and remedies that you have under the Australian Consumer Law, Consumer Guarantees Act of New Zealand or any other applicable law, we provide the following warranty against defects:

1. If, during the first **12 months** from their date of purchase from the Supplier (**Warranty Period**), the Goods prove defective by reason of improper workmanship or materials and none of your statutory rights or remedies apply, we will repair or replace the Goods without charge.
2. We do not have to repair or replace the Goods under this Additional Warranty if the Goods have been used for a commercial purpose; misused, improperly or inappropriately installed, operated or repaired; abused; damaged; or not maintained in accordance with the manufacturer's instructions.
3. Even when we do not have to repair or replace the Goods, we may decide to do so anyway. In some cases, we may decide to substitute the Goods with a similar alternative product of our choosing. All such decisions are at our absolute discretion.
4. All such repaired, replaced or substituted Goods continue to receive the benefit of this Additional Warranty for the time remaining on the original Warranty Period.
5. This Additional Warranty is limited to repair, replacement or substitution only. As far as the law permits, we will not be liable for any loss or damage caused to property or persons arising from any cause whatsoever.
6. In order to claim under this Additional Warranty you must telephone us on 1300 850 633 in Australia or 0800 639 953 in New Zealand within the Warranty Period. You will be asked for details of the Goods, a description of the defect and your personal details. Upon accepting your claim, we shall assist you with either returning the Goods to the Supplier for replacement or to the most convenient Philips Authorised Service Centre for your Goods to be repaired. In some cases we may require that you return to the Goods to us (at the address below) for repair, replacement or substitution.
  - \* All returned Goods must be accompanied by satisfactory proof of purchase which clearly indicates the name and address of the Supplier, the date and place of purchase and identifies product. It is best to provide a legible and unmodified receipt or sales invoice.
  - \* You must bear any expense for return of the Goods or otherwise associated with making your claim under this Additional Warranty.
7. This warranty is only valid and enforceable in Australia and New Zealand.

Contact us or the place of purchase for further details.

Australia  
Gibson Innovations  
305/4 Columbia Court,  
Baulkham Hills, NSW, 2153  
**Consumer Care:** 1300 850 633  
**E-mail:** [PhilipsSound\\_APAC@qibson.com](mailto:PhilipsSound_APAC@qibson.com)  
**Website:** [www.philips.com/support](http://www.philips.com/support)

New Zealand

**Consumer Care:** 0800 639 953  
**Email:** [PhilipsSound\\_APAC@qibson.com](mailto:PhilipsSound_APAC@qibson.com)  
**Website:** [www.philips.com/support](http://www.philips.com/support)

May 2016