

Always there to help you

Register your product and get support at
www.philips.com/welcome



HTD3500



User manual

PHILIPS

Contents

1 Important	3	8 Troubleshooting	26
Safety	3		
Care for your product	4	9 Notice	28
Care of the environment	4	Copyright	28
		Trademarks	28

2 Your home theater	5	10 Language code	29
Main unit	5		
Connectors	5		
Remote control	6		

3 Connect and set up	8	11 Index	30
Connect speakers	8		
Connect to TV	9		
Connect audio from TV and other devices	10		
Set up speakers	11		
Set up EasyLink (HDMI-CEC control)	11		

4 Use your home theater	13		
Choose sound	13		
Discs	13		
USB storage devices	14		
DivX	15		
Audio, video, and picture options	16		
Radio	17		
MP3 player	17		
Create MP3 files	18		

5 Change settings	19		
Picture	19		
Sound	19		
Language	20		
Parental control	20		
Energy saving	21		
Apply factory settings	22		

6 Update software	23		
Check software version	23		
Update software through USB or CD-R	23		

7 Product specifications	24		
---------------------------------	----	--	--

1 Important

Read and understand all instructions before you use your home theater. If damage is caused by failure to follow instructions, the warranty does not apply.

Safety

Risk of electric shock or fire!

- Never expose the product and accessories to rain or water. Never place liquid containers, such as vases, near the product. If liquids are spilt on or into the product, disconnect it from the power outlet immediately. Contact Philips Consumer Care to have the product checked before use.
- Never place the product and accessories near naked flames or other heat sources, including direct sunlight.
- Never insert objects into the ventilation slots or other openings on the product.
- Where the mains plug or an appliance coupler is used as the disconnect device, the disconnect device shall remain readily operable.
- Batteries (battery pack or batteries installed) shall not be exposed to excessive heat such as sunshine, fire or the like.
- Disconnect the product from the power outlet before lightning storms.
- When you disconnect the power cord, always pull the plug, never the cable.

Risk of short circuit or fire!

- Before you connect the product to the power outlet, ensure that the power voltage matches the value printed on the back or bottom of the product. Never connect the product to the power outlet if the voltage is different.

Risk of injury or damage to the home theater!

- For wall-mountable products, use only the supplied wall mount bracket. Secure the

wall mount to a wall that can support the combined weight of the product and the wall mount. Koninklijke Philips Electronics N.V. bears no responsibility for improper wall mounting that results in accident, injury or damage.

- For speakers with stands, use only the supplied stands. Secure the stands to the speakers tightly. Place the assembled stands on flat, level surfaces that can support the combined weight of the speaker and stand.
- Never place the product or any objects on power cords or on other electrical equipment.
- If the product is transported in temperatures below 5°C, unpack the product and wait until its temperature matches room temperature before connecting it to the power outlet.
- Visible and invisible laser radiation when open. Avoid exposure to beam.
- Do not touch the disc optical lens inside the disc compartment.
- Parts of this product can be made of glass. Handle with care to avoid injury and damage.

Risk of overheating!

- Never install this product in a confined space. Always leave a space of at least four inches around the product for ventilation. Ensure curtains or other objects never cover the ventilation slots on the product.

Risk of contamination!

- Do not mix batteries (old and new or carbon and alkaline, etc.).
- Danger of explosion if batteries are incorrectly replaced. Replace only with the same or equivalent type.
- Remove batteries if they are exhausted or if the remote control is not to be used for a long time.
- Batteries contain chemical substances, they should be disposed of properly.

Risk of swallowing batteries!

- The product/remote control may contain a coin/button type battery, which can be swallowed. Keep the battery out of reach

of children at all times! If swallowed, the battery can cause serious injury or death. Severe internal burns can occur within two hours of ingestion.

- If you suspect that a battery has been swallowed or placed inside any part of the body, seek immediate medical attention.
- When you change the batteries, always keep all new and used batteries out of reach of children. Ensure that the battery compartment is completely secure after you replace the battery.
- If the battery compartment cannot be completely secured, discontinue use of the product. Keep out of reach of children and contact the manufacturer.



This is CLASS II apparatus with double insulation, and no protective earth provided.

Care for your product

- Do not insert any objects other than discs into the disc compartment.
- Do not insert warped or cracked discs into the disc compartment.
- Remove discs from the disc compartment if you are not using the product for an extended period of time.
- Use only microfiber cloth to clean the product.

Care of the environment



Your product is designed and manufactured with high quality materials and components, which can be recycled and reused.

Never dispose of your product with other household waste. Please inform yourself about the local rules on the separate collection of electrical and electronic products and batteries. The correct disposal of these products helps prevent potentially negative consequences on the environment and human health.

Your product contains batteries, which cannot be disposed of with normal household waste. Please inform yourself about the local rules on separate collection of batteries. The correct disposal of batteries helps prevent potentially negative consequences on the environment and human health.

Please visit www.recycle.philips.com for additional information on a recycling center in your area.

2 Your home theater

Congratulations on your purchase, and welcome to Philips! To fully benefit from the support that Philips offers, register your home theater at www.philips.com/welcome.

Main unit

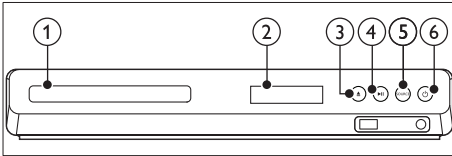

- ① **Disc compartment**
- ② **Display panel**
- ③ **▲ (Open/Close)**
Open or close the disc compartment, or eject the disc.
- ④ **▶|| (Play/Pause)**
Start, pause or resume play.
- ⑤ **SOURCE**
Select an audio or video source for the home theater.
- ⑥ **⏻ (Standby-On)**
Switch the home theater on or to standby.

Connectors

This section includes an overview of the connectors available on your home theater.

Front

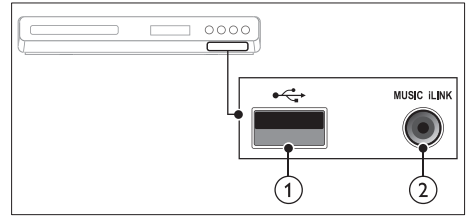

- ① **↔ (USB)**
Audio, video or picture input from a USB storage device.
- ② **MUSIC iLINK**
Audio input from an MP3 player.

Back connectors

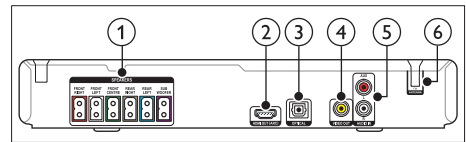

- ① **SPEAKERS**
Connect to the supplied speakers and subwoofer.
- ② **HDMI OUT (ARC)**
Connect to the HDMI input on the TV.
- ③ **OPTICAL**
Connect to an optical audio output on the TV or a digital device.
- ④ **VIDEO OUT**
Connect to the composite video input on the TV.
- ⑤ **AUDIO IN-AUX**
Connect to an analog audio output on the TV or an analog device.
- ⑥ **ANTENNA FM**
Fixed FM antenna.

Remote control

This section includes an overview of the remote control.

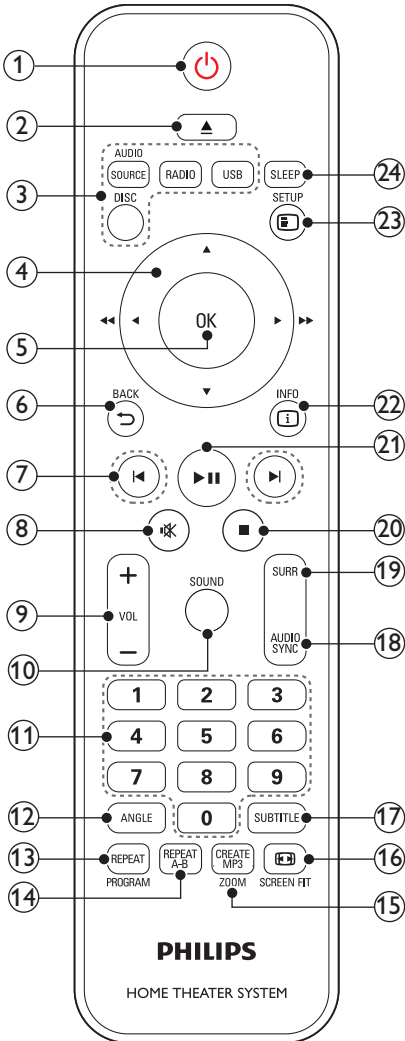

① ⏻ (Standby-On)

- Switch the home theater on or to standby.

- When EasyLink is enabled, press and hold for at least three seconds to switch all connected HDMI CEC compliant devices to standby.

② ▲ (Open/Close)

Open or close the disc compartment, or eject the disc.

③ Source buttons

- **DISC:** Switch to disc source. Access or exit the disc menu when you play a disc.
- **AUDIO SOURCE:** Select an audio input source.
- **RADIO:** Switch to FM radio.
- **USB:** Switch to USB storage device.

④ Navigation buttons

- Navigate menus.
- In video mode, press left or right to fast backward or fast forward; press up or down to slow forward or slow backward.
- In radio mode, press left or right to search a radio station; press up or down to fine tune a radio frequency.

⑤ OK

Confirm an entry or selection.

⑥ ↶ BACK

Return to a previous menu screen.

⑦ ◀▶ (Previous/Next)

- Skip to the previous or next track, chapter or file.
- In radio mode, select a preset radio station.

⑧ 🔇 (Mute)

Mute or restore volume.

⑨ VOL +/-



Increase or decrease volume.

⑩ SOUND

Select a sound mode.

⑪ Numeric buttons

Select an item to play.

- ⑫ **ANGLE**
Select video scenes recorded in different camera angels.
- ⑬ **REPEAT / PROGRAM**
- Select or turn off repeat mode.
 - In radio mode, set a radio station.
- ⑭ **REPEAT A-B**
Mark two points within a chapter or track to repeat play, or turn off the repeat mode.
- ⑮ **CREATE MP3/ZOOM**
- Access the create MP3 menu.
 - Zoom into a video scene or picture.
Press the **Navigation buttons** (left/right) to select a zoom factor.
- ⑯  **SCREEN FIT**
Fit the picture format to the TV screen.
- ⑰ **SUBTITLE**
Select subtitle language for video.
- ⑱ **AUDIO SYNC**
- Select an audio language or channel.
 - Press and hold to access audio delay setting, then press **+/-** to delay the audio to match the video.
- ⑲ **SURR**
Select surround sound or stereo sound.
- ⑳  **(Stop)**
Stop play.
- ㉑  **(Play/Pause)**
Start, pause or resume play.
- ㉒  **INFO**
Access more play options while playing a disc or a USB storage device.
- ㉓  **SETUP**
Access or exit the setup menu.
- ㉔ **SLEEP**
Switch the home theater to standby mode after the elapsed time.

3 Connect and set up

This section helps you connect your home theater to a TV and other devices, and then set it up.

For information about the basic connections of your home theater and accessories, see the quick start guide.

Note

- For identification and supply ratings, see the type plate at the back or bottom of the product.
- Before you make or change any connections, make sure that all devices are disconnected from the power outlet.

Connect speakers

The speaker cables are color-coded for easy connection. To connect a speaker to your home theater, match the color on the speaker cable to the color on the connector.

Speaker position plays a critical role in setting up a surround sound effect. For best effect, position all the speakers towards the seating position and place them close to your ear level (seated).

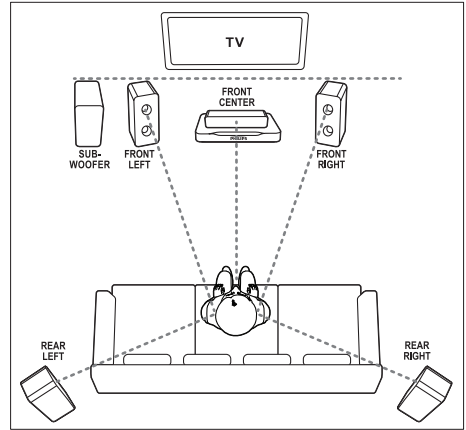

Note

- Surround sound depends on factors such as room shape and size, type of wall and ceiling, windows and reflective surfaces, and speaker acoustics. Experiment with the speaker positions to find the optimum setting for you.

Follow these general guidelines for speakers placement.

- 1 Seating position:**
This is the center of your listening area.
- 2 FRONT CENTER (front center) speaker:**
Place the center speaker directly in front of the seating position, either above or below your TV.
- 3 FRONT LEFT (front left) and FRONT RIGHT (front right) speakers:**
Place the left and right speakers in the front, and at equal distance from the center speaker. Make sure that the left, right, and the center speakers are at equal distance from your seating position.
- 4 REAR LEFT (rear left) and REAR RIGHT (rear right) speakers:**
Place the rear surround speakers to the left and right side of your seating position, either in line with it or slightly behind it.
- 5 SUBWOOFER (subwoofer):**

Place the subwoofer at least one meter to the left or right of the TV. Leave about 10-centimeter clearance from the wall.

Connect to TV

Connect your home theater to a TV to watch videos. You can listen to the TV audio through your home theater speakers. Use the best quality connection available on your home theater and TV.

Option 1: Connect to TV through HDMI (ARC)

Best quality video

Your home theater supports HDMI version with Audio Return Channel (ARC). If your TV is HDMI ARC compliant, you can hear the TV audio through your home theater by using a single HDMI cable.

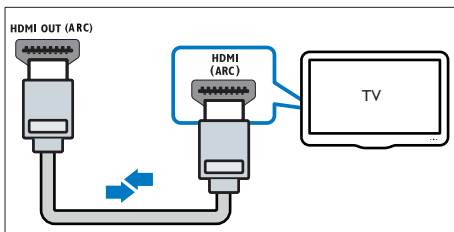

- 1 Using a High Speed HDMI cable, connect the **HDMI OUT (ARC)** connector on your home theater to the **HDMI ARC** connector on the TV.
 - The **HDMI ARC** connector on the TV might be labeled differently. For details, see the TV user manual.
- 2 On your TV, turn on HDMI-CEC operations. For details, see the TV user manual.
 - HDMI-CEC is a feature that enables CEC compliant devices that are connected through HDMI to be controlled by a single remote control, such as volume control for both the

TV and the home theater. (see 'Set up EasyLink (HDMI-CEC control)' on page 11)

- 3 If you cannot hear the TV audio through your home theater, set up the audio manually. (see 'Set up the audio' on page 12)

Option 2: Connect to TV through standard HDMI

Best quality video

If your TV is not HDMI ARC compliant, connect your home theater to the TV through a standard HDMI connection.

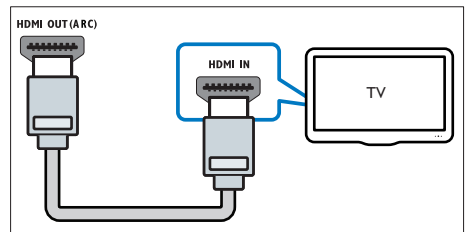

- 1 Using a High Speed HDMI cable, connect the **HDMI OUT (ARC)** connector on your home theater to the **HDMI** connector on the TV.
- 2 Connect an audio cable to hear the TV audio through your home theater (see 'Connect audio from TV and other devices' on page 10).
- 3 On your TV, turn on HDMI-CEC operations. For details, see the TV user manual.
 - HDMI-CEC is a feature that enables CEC compliant devices that are connected through HDMI to be controlled by a single remote control, such as volume control for both the TV and the home theater. (see 'Set up EasyLink (HDMI-CEC control)' on page 11)
- 4 If you cannot hear the TV audio through your home theater, set up the audio

manually. (see 'Set up the audio' on page 12)

Note

- If your TV has a DVI connector, you can use an HDMI/DVI adapter to connect to TV. However, some of the features may not be available.

Option 3: Connect to the TV through composite video

Basic quality video

If your TV does not have HDMI connectors, use a composite video connection. A composite connection does not support high-definition video.

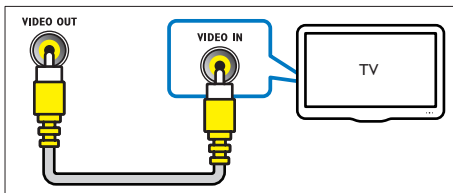

- 1 Using a composite video cable, connect the **VIDEO OUT** connector on your home theater to the **VIDEO IN** connector on the TV.
 - The composite video connector might be labeled **AV IN**, **COMPOSITE**, or **BASEBAND**.
- 2 Connect an audio cable to hear the TV audio through your home theater (see 'Connect audio from TV and other devices' on page 10).
- 3 When you watch TV programs, press **SOURCE** on your home theater repeatedly to select the correct audio input.
- 4 When you watch videos, switch your TV to the correct video input. For details, see the TV user manual.

Connect audio from TV and other devices

Play audio from TV or other devices through your home theater speakers. Use the best quality connection available on your TV, home theater, and other devices.

Note

- When your home theater and TV are connected through HDMI ARC, an audio connection is not required (see 'Option 1: Connect to TV through HDMI (ARC)' on page 9).

Option 1: Connect audio through a digital optical cable

Best quality audio

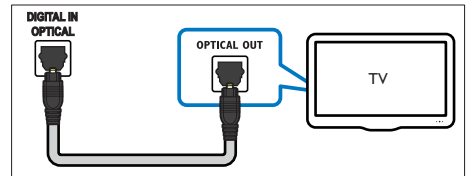

- 1 Using an optical cable, connect the **OPTICAL** connector on your home theater to the **OPTICAL OUT** connector on the TV or other device.
 - The digital optical connector might be labeled **SPDIF** or **SPDIF OUT**.

Option 2: Connect audio through analog audio cables

Basic quality audio

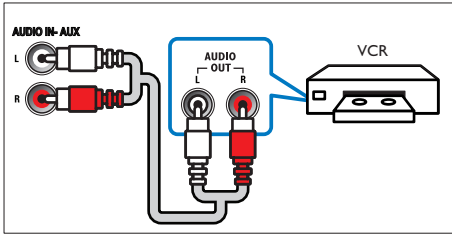

- 1 Using an analog cable, connect the **AUX** connectors on your home theater to the **AUDIO OUT** connectors on the TV or other device.

Set up speakers

Set up the speakers manually to experience customized surround sound.

Before you start

Make the necessary connections described in the quick start guide, and then switch the TV to the correct source for your home theater:

- 1 Press **⏸** **SETUP** on your home theater remote control.
- 2 Select **[Audio Setup]**, and then press **OK**.
- 3 Change the following settings, and then press **OK**.
 - **[Speakers Volume]**: Set the volume level of each speaker.
 - **[Speakers Delay]**: Set the delay time for speakers which are placed closer to the seating position in order to obtain equal audio transmission from all the speakers.

Set up EasyLink (HDMI-CEC control)

This home theater supports Philips EasyLink, which uses the HDMI-CEC (Consumer Electronics Control) protocol. EasyLink-compliant devices that are connected through

HDMI can be controlled by a single remote control.

Note

- Depending on the manufacturer, HDMI-CEC is known by many names. For information on your device, see the user manual of the device.
- Philips does not guarantee 100% interoperability with all HDMI-CEC devices.

Before you start

- Connect your home theater to the HDMI-CEC compliant device through HDMI connection.
- Make the necessary connections described in the quick start guide, and then switch the TV to the correct source for your home theater.

Enable EasyLink

- 1 Press **⏸** **SETUP**.
- 2 Select **[Video Setup]**, and then press **OK**.
- 3 Select **[HDMI Setup]** > **[EasyLink Setup]** > **[EasyLink]** > **[On]**.
- 4 On your TV and other connected devices, turn on HDMI-CEC control. For details, see the user manual of the TV or other devices.
 - On your TV, set the audio output to 'Amplifier' (instead of TV speakers). For details, see the TV user manual.

EasyLink controls

With EasyLink, you can control your home theater, TV, and other connected HDMI-CEC compliant devices with a single remote control.

- **[One Touch Play]** (One-touch play): When a video disc is in the disc compartment, press **▶** (**Play**) to wake up the TV from standby, and then play a disc.
- **[One Touch Standby]** (One-touch standby): If one-touch standby is enabled, your home theater can switch to standby

with the remote control of the TV or other HDMI-CEC devices.

- **[System Audio Control]** (System audio control): If system audio control is enabled, the audio of the connected device is output through your home theater speakers automatically when you play the device.
- **[Audio Input Mapping]** (Audio input mapping): If system audio control does not work, map the connected device to the correct audio input connector on your home theater. (see 'Set up the audio' on page 12)

- If you connect your home theater to the TV through an **HDMI ARC** connection, make sure that the TV audio is mapped to the ARC input on your home theater.

Note

- To change the EasyLink control settings, press **[MENU]** **SETUP**, select **[Video Setup]** > **[HDMI Setup]** > **[EasyLink Setup]** > **[EasyLink]**.

Set up the audio

If you cannot hear the audio output of a connected device through your home theater speakers, do the following:

- Check that you have enabled EasyLink on all the devices, (see 'Set up EasyLink (HDMI-CEC control)' on page 11) and
 - on your TV, set the audio output to "Amplifier" (instead of TV speakers). For details, see the TV user manual, and
 - setup the EasyLink audio control.
- 1** Press **[MENU]** **SETUP**.
 - 2** Select **[Video Setup]**, and then press **OK**.
 - 3** Select **[HDMI Setup]** > **[EasyLink Setup]** > **[System Audio Control]** > **[On]**.
 - To play the audio from the TV speakers, select **[Off]**, and skip the following steps.
 - 4** Select **[HDMI Setup]** > **[EasyLink Setup]** > **[Audio Input Mapping]**.
 - 5** Follow the onscreen instructions to map the connected device to the audio inputs on your home theater.

4 Use your home theater

This section helps you use the home theater to play media from a wide range of sources.

Before you start

- Make the necessary connections described in the Quick start guide and the user manual.
- Complete the first-time setup. First-time setup appears when you turn on your home theater for the first time or if you do not complete the setup.
- Switch the TV to the correct source for the home theater.

Choose sound

This section helps you choose the ideal sound for your video or music.

Sound mode

Select predefined sound modes to suit your video or music.

- 1 Press **SOUND** repeatedly to select a sound mode.
 - **MOVIE**: Enjoy a cinematic audio experience, specially enhanced for movies.
 - **MUSIC**: Recreate the original recording environment of your music, in the studio or at a concert.
 - **ORIGINAL**: Experience the original sound of your movies and music, without added sound effects.
 - **NEWS**: Hear every word with optimized speech and clear vocals.
 - **GAMING**: Enjoy thrilling arcade sounds, ideal for action-packed video games or loud parties.

Surround sound mode

Experience an immersive audio experience with surround sound modes.

- 1 Press **SURR** repeatedly to select a surround mode.
 - **MULTI-CH**: Traditional 5.1 channel for a more relaxing cinematic experience.
 - **STEREO**: Two-channel stereo sound. Ideal for listening to music.



Note

- If the audio source is a 2.1 channel, multi-channel mode will output 5-channel stereo sound.

Discs

Your home theater can play DVDs, VCDs, and CDs. It can also play discs that you've made at home, such as CD-R discs of photos and music.

What you need





- Audio and video connection between your home theater and the TV.
- An audio or a video disc.

Play discs

- 1 Insert a disc into the home theater.
 - ↳ Your TV switches to the correct source and the disc plays automatically. If it does not, press **DISC**.
- 2 Press the play buttons to control play (see 'Play buttons' on page 13).

Play buttons

Button	Action
Navigation buttons	Navigate menus.
OK	Confirm an entry or selection.
▶ (Play/Pause)	Start, pause or resume play.

Button	Action
	Stop play.
	Skip to the previous or next track, chapter or file.
	Fast backwards or fast forwards. Press repeatedly to change the search speed.
Navigation buttons (left/right)	Rotate the picture clockwise or counter-clockwise.
Navigation buttons (up/down)	Flip the picture vertically or horizontally.
SUBTITLE	Select subtitle language for video.
DISC	Access or exit the disc menu.
AUDIO SYNC	Select an audio language or channel.
 SCREEN FIT	Fit the picture format to the TV screen.
ZOOM	Zoom into a video scene or picture.
REPEAT	Select or turn off repeat mode.
REPEAT A-B	Mark two points within a chapter or track to repeat play, or turn off the repeat mode.
ANGLE	Select video scenes recorded in different camera angles.
 INFO	Access the advanced options when you play your audio, video, or media files.

Display menu for VCD and SVCD

Display the content menu on VCD and SVCD discs.

- 1 Press  **SETUP**.
- 2 Select [**Preference Setup**], and then press **OK**.
- 3 Select [**PBC**] > [**On**], and then press **OK**.

Note

- To skip the content menu, select [**Off**].
- While playing a VCD/SVCD, you can press **DISC** to turn off or on the PBC (playback control).

Display menu for MP3/JPEG

You can choose how you want the MP3 contents to display.

- 1 Press  **SETUP**.
- 2 Select [**Preference Setup**], and then press **OK**.
- 3 Select [**MP3/JPEG Display**], and then press **OK**.
- 4 Select the following options, then press **OK**.
 - [**View Folders**]: Display the MP3 folders.
 - [**View Files**]: Display the MP3 files.

Synchronize picture and sound

If the audio and video are not synchronized, delay the audio to match the video.

- 1 Press  **SETUP**.
- 2 Select [**Audio Setup**], and then press **OK**.
- 3 Select [**Audio Sync**], and then press **OK**.
- 4 Press the **Navigation buttons** (left/right) to synchronize the audio with the video.
- 5 Press **OK** to confirm.

Note

- Press and hold **AUDIO SYNC** on the remote control for quick access to the audio sync setup menu.

USB storage devices

Enjoy pictures, audio and video on a USB storage device.

What you need

- A USB storage device that is formatted for FAT, and complies with the Mass Storage Class.
- A USB extension cable, if the USB storage device does not fit into the connector.

Note

- You can use digital cameras connected by USB if they can play the files without using a special computer program.

Play files

- 1 Connect the USB storage device to the home theater.
- 2 Press **USB**.
↳ A content browser is displayed.
- 3 Select a file, and then press **OK**.
- 4 Press the playback buttons to control play (see 'Play buttons' on page 13).

DivX

Play DivX videos from :

- a disc (see 'Discs' on page 13),
- a USB storage device (see 'USB storage devices' on page 14).

VOD code for DivX

Before you purchase DivX videos and play them on your home theater, register the home theater on www.divx.com using the DivX VOD code.

- 1 Press **SETUP**.
- 2 Select **[General Setup]**, and then press **OK**.
- 3 Select **[DivX(R) VOD Code]**, and then press **OK**.
↳ The DivX VOD registration code for your home theater is displayed.

Subtitles

If your video has subtitles in multiple languages, select a subtitle language.

- 1 While playing video, press **SUBTITLE** to select a language.

Note

- Make sure that the subtitle file has the same name as the video file. For example, if the video file is named 'movie.avi', save the subtitle file as 'movie.srt' or 'movie.sub'.
- Your home theater can play subtitle files in the following formats: .srt, .sub, .txt, .ssa, .ass, .smi, and .sami. These files do not appear in the file navigation menu.
- If the subtitles do not appear correctly, change the character set.

Subtitle character set

If the subtitles do not appear correctly, change the character set that supports the DivX subtitle.

- 1 Press **SETUP**.
- 2 Select **[Preference Setup]**, and then press **OK**.
- 3 Select **[DivX Subtitle]**, and then press **OK**.
- 4 Select a character set, and then press **OK**.

Character Set	Language
[Standard]	English, Albanian, Danish, Dutch, Finnish, French, Gaelic, German, Italian, Kurdish (Latin), Norwegian, Portuguese, Spanish, Swedish and Turkish
[Central Europe]	Albanian, Croat, Czech, Dutch, English, German, Hungarian, Irish, Polish, Romanian, Slovak, Slovene and Sorbian
[Cyrillic]	Bulgarian, Belorussian, English, Macedonian, Moldavian, Russian, Serbian and Ukrainian
[Greek]	Greek
[Hebrew]	Hebrew
[Chinese(Simp)]	Simplified Chinese

Audio, video, and picture options

Use advanced features when you play audio, video, or media files from a disc or a USB storage device.

Audio options

- 1 Press **INFO** repeatedly to cycle through the following options:
 - Show the current track information and time.
 - **[Disc Go To:%c%2d:%2d%C]**: Skip to a specific part of the disc by entering the disc time.
 - **[Track Go To:%c%2d:%2d%C]**: Skip to a specific part of the track by entering the track time.
 - **[Select Track:%c%2d%C/%2d]**: Select a specific track.

Video options

- 1 Press **INFO**.
↳ The video options menu is displayed.
- 2 Press the **Navigation buttons** and **OK** to select and change:
 - **[Title]**: Select a specific title.
 - **[Chapter]**: Select a specific chapter.
 - **[Track]**: Select a specific track (for VCD/SVCD only).
 - **[Audio]**: Select audio language for video.
 - **[Subtitle]**: Select subtitle language for video.
 - **[Angle]**: Select video scenes recorded in different camera angles.
 - **[TT Time]**: Skip to a specific part of the video by entering the title time.
 - **[Ch Time]**: Skip to a specific part of the video by entering the chapter time.
 - **[Disc Time]**: Skip to a specific part of the video by entering the disc time (for VCD/SVCD only).

- **[Track Time]**: Skip to a specific part of the video by entering the track time (for VCD/SVCD only).
- **[Preview]**: Select a content preview for disc.
- **[Repeat]**: Select a repeat mode.
- **[Time Disp.]**: Select the information of time display.

Picture options

- 1 Press **INFO** to access picture preview mode.
↳ 12 thumbnail pictures are displayed.
- 2 Press **◀ / ▶** to go to previous or next preview page.
- 3 Press the **Navigation buttons** and **OK** to select a picture.

Slideshows

While playing audio, access fun features such as picture and musical slideshows.

Picture slideshows

View a slideshow of your pictures stored in your disc or a USB storage device.

- 1 Select a picture from a disc or USB storage device, and then press **▶||**.
- 2 Press **■** to stop the slideshow.

Musical slideshows

Create a musical slideshow to play music and pictures at the same time.

- 1 Select a music track, and then press **OK**.
- 2 Press **↵ BACK**, and go to the picture folder.
- 3 Select a picture, and then press **OK** to start the slideshow.
- 4 Press **■** to stop slideshow.
- 5 Press **■** again to stop music.

Radio

Listen to FM radio on your home theater, and store up to 40 radio stations.

What you need

- FM antenna.



Note

- AM and digital radio are not supported.
- If no stereo signal is detected, you are prompted to install the radio stations again.
- For the best reception, place the antenna away from the TV or other sources of radiation.

Tune stations

- 1 Connect the FM antenna as described in the Quick start guide.
- 2 Press **RADIO**.
 - ↳ If you have already installed the radio stations, the last channel that you listened to is played.
 - ↳ If you have not installed any radio stations, the message **AUTO INSTALL...PRESS PLAY** appears on the display panel. Press **▶ (Play)**.
- 3 Press the following buttons to listen or to change radio stations:

Button	Action
◀ / ▶	Select a preset radio station.
Navigation buttons (left/right)	Search for a radio station.
Navigation buttons (up/down)	Fine tune a radio frequency.
■	Press to stop the installation of radio stations. Press and hold to erase the preset radio station.

-
- PROGRAM** Manual:
- 1) Press **PROGRAM**.
 - 2) Press **Numeric buttons** to select a preset number.
 - 3) Press **OK** to store the radio station.
 - 4) Repeat the steps above to store other radio stations.
- Automatic: Press and hold for three seconds to reinstall the radio stations
-

Listen to radio

- 1 Press **RADIO**.
 - To listen to a preset station, press **◀** or **▶**.
 - To search for a radio station, and then listen, press **Navigation buttons** (left/right).
- 2 Press **+/- (Volume)** to change the volume.

MP3 player

Connect your MP3 player to play your audio files or music.

What you need

- An MP3 player.
- A 3.5mm stereo audio cable.

Play music

- 1 Connect the MP3 player to the home theater as described in the Quick start guide.
- 2 Press **AUDIO SOURCE** repeatedly until '**MUSIC I-LINK**' appears on the display panel.
- 3 Press the buttons on the MP3 player to select and play audio files or music.

Create MP3 files

Use your home theater to convert audio CDs into MP3 files.

What you need

- An audio disc.
- A USB storage device

- 1** Connect a USB storage device to the home theater.
- 2** Play your audio CD (CDDA/HDCCD).
- 3** Press **CREATE MP3**.
↳ The create MP3 screen is displayed.
- 4** Press the **Navigation buttons** and **OK** to select and change:
 - **[Speed]**: Select the write-to-file speed.
 - **[Bitrate]**: Select the conversion quality.
 - **[Device]**: Select the USB storage device which you use to store the MP3 files.
- 5** Navigate to the right panel, and then select the audio tracks and press **OK**.
 - To select all tracks, navigate to **[Select All]**, and then press **OK**.
- 6** Select **[Start]**, and then press **OK** to start the MP3 conversion.
↳ A new folder which contains the MP3 files is created in the USB storage device.
 - To exit the menu, select **[Exit]**, and then press **OK**.



Note

- When the conversion is in process, do not press any buttons.
- DTS CDs and copy-protected CDs cannot be converted.
- Write-protected or password-protected USB storage device cannot be used to store MP3 files.

5 Change settings

This section helps you to change the settings of your home theater.

Caution

- Most of the settings are already configured with the best value for your home theater. Unless you have a reason to change a setting, it is best to leave it at the default value.

Note

- You cannot change a setting that is grayed out.
- To return to the previous menu, press  BACK. To exit the menu, press  SETUP.

Picture

Change the picture settings to suit your preferences.

Note

- The best setting is automatically selected for the TV. If you change the setting, make sure that the TV supports the new settings.

Picture settings and format

- 1 Press  SETUP.
- 2 Select **[Video Setup]**, and then press **OK**.
- 3 Change the following settings, and then press **OK**:
 - **[TV System]**: For TV supported video format.
 - **[TV Display]**: For TV picture display format.
 - **[Picture Settings]**: Predefined color settings.

Picture resolution

To enjoy high definition HDMI video output, set the HDMI video settings that best match up with your TV capability.

- 1 Press  SETUP.
- 2 Select **[Video Setup]**, and then press **OK**.
- 3 Select **[HDMI Setup]**, and then press **OK**.
- 4 Change the following settings, and then press **OK**:
 - **[Wide Screen Format]**: For 16:9 wide screen TV display setting.
 - **[HDMI Video]**: HDMI resolution.

High definition picture

Support high definition JPEG pictures.

- 1 Press  SETUP.
- 2 Select **[Video Setup]**, and then press **OK**.
- 3 Select **[HD JPEG] > [On]**, and then press **OK**.

Sound

Change the sound settings to suit your preference.

HDMI audio

HDMI audio is automatically down-mixed to two channel for TV speakers. If you do not want to output audio through your TV, disable the HDMI audio.

- 1 Press  SETUP.
- 2 Select **[Audio Setup]**, and then press **OK**.
- 3 Select **[HDMI Audio] > [Off]**, and then press **OK**.

Night mode

For quiet listening, decrease the volume of loud sounds when you play discs. Night mode is only available for Dolby-encoded DVD and Blu-ray discs.

- 1 Press **⏏** **SETUP**.
- 2 Select **[Audio Setup]**, and then press **OK**.
- 3 Select **[Night Mode]** > **[On]**, and then press **OK**.

Language

Select a language for the home menu, audio, and subtitles.

Home menu

- 1 Press **⏏** **SETUP**.
- 2 Select **[General Setup]**, and then press **OK**.
- 3 Select **[OSD Language]**, and then press **OK**.
- 4 Select a menu language for your home theater, and then press **OK**.

Disc audio

- 1 Press **⏏** **SETUP**.
- 2 Select **[Preference Setup]**, and then press **OK**.
- 3 Select **[Audio]**, and then press **OK**.
- 4 Select an audio language for discs, and then press **OK**.

Note

- If your preferred disc language is not available, select **[Others]** from the list, and enter the 4-digit language code found at the end of this user manual (see 'Language code' on page 29).
- If you select a language that is not available on a disc, the home theater uses the default language of the disc.

Disc subtitle

- 1 Press **⏏** **SETUP**.
- 2 Select **[Preference Setup]**, and then press **OK**.
- 3 Select **[Subtitle]**, and then press **OK**.
- 4 Select a subtitle language for discs, and then press **OK**.

Disc menu

- 1 Press **⏏** **SETUP**.
- 2 Select **[Preference Setup]**, and then press **OK**.
- 3 Select **[Disc Menu]**, and then press **OK**.
- 4 Select a menu language for discs, and then press **OK**.

Note

- If your preferred disc language is not available, select **[Others]** from the list, and enter the 4-digit language code found at the end of this user manual (see 'Language code' on page 29).
- If you select a language that is not available on a disc, the home theater uses the default language of the disc.

Parental control

Restrict access to discs.

Password

You can set or change your password to play a restricted disc.

- 1 Press **⏏** **SETUP**.
- 2 Select **[Preference Setup]**, and then press **OK**.
- 3 Select **[Password]**, and then press **OK**.
↳ A change password menu is displayed.
- 4 Follow the instructions on the TV to set or change password.

- If you do not have a password or you have forgotten, enter **0000**.

5 Press **OK**.

Ratings

Some discs are recorded with ratings according to age. You can set up your home theater to play only discs with an age rating lower than your child's age.

- 1** Press **⏏ SETUP**.
- 2** Select **[Preference Setup]**, and then press **OK**.
- 3** Select **[Parental]**, and then press **OK**.
- 4** Select an age rating, and then press **OK**.
 - To play all discs irrespective of the rating, select level **8**.
- 5** Use the **Numeric buttons** to enter the password.

Lock disc

To restrict access to discs that are not encoded with ratings and parental control, lock the disc manually. You can lock up to 20 discs on your home theater.

- 1** While playing a disc, press **⏏ SETUP**.
- 2** Select **[General Setup]**, and then press **OK**.
- 3** Select **[Disc Lock] > [Lock]**, and then press **OK**.
 - ↳ A message prompts you to enter the password.
- 4** Enter the password with the **Numeric buttons**.
 - ↳ The disc is locked.
 - To play the locked disc, enter the password.

Energy saving

Save energy by changing the following settings.

Auto standby

When playing a disc or a USB storage device, automatically switch your home theater to standby if:

- it is in pause or stop mode, and
- no button is pressed for 30 minutes.

- 1** Press **⏏ SETUP**.
- 2** Select **[General Setup]**, and then press **OK**.
- 3** Select **[Auto Standby] > [On]**, and then press **OK**.

Sleep timer

Set timers to switch the home theater to standby after a specified time.

- 1** Press **⏏ SETUP**.
- 2** Select **[General Setup]**, and then press **OK**.
- 3** Select **[Sleep Timer]**, and then press **OK**.
- 4** Select the duration of the sleep timer.
 - ↳ The sleep timer can be set up to 60 minutes. If the sleep timer is set to **[Off]**, it switches off.
- 5** Press **OK** to activate.
 - ↳ The home theater switches to standby after the specified time.

Screen saver

Automatically switch your home theater to screen saver mode if:

- it is in pause or stop mode, and
- no button is pressed for 10 minutes.

- 1** Press **⏏ SETUP**.
- 2** Select **[General Setup]**, and then press **OK**.
- 3** Select **[Screen Saver] > [On]**, and then press **OK**.

Display panel

Change the brightness of the home theater display panel.

- 1 Press **⏏** **SETUP**.
- 2 Select [**General Setup**], and then press **OK**.
- 3 Select [**Display Dim**], and then press **OK**.
- 4 Select the brightness, and then press **OK**.

Apply factory settings

Reset your home theater to the default settings. You cannot reset the parental control settings.

- 1 Press **⏏** **SETUP**.
- 2 Select [**Preference Setup**], and then press **OK**.
- 3 Select [**Default**], and then press **OK**.
- 4 Select [**Reset**], and then press **OK**.

6 Update software

To continue to get the best features and support for your home theater, update the software regularly. Compare the version of your current software with the latest version on www.philips.com/support.

Check software version

- 1 Press **⏏** **SETUP**.
- 2 Select [**Preference Setup**], and then press **OK**.
- 3 Select [**Version Info.**], and then press **OK**.
↳ The software version is displayed.

Update software through USB or CD-R

What you need

- A CD-R or a USB flash drive with at least 75MB of memory. The USB flash drive must be FAT formatted. Do not use a USB hard drive.
- A computer with Internet access.
- An archive utility that supports the ZIP file format (for example, WinZip® for Microsoft® Windows® or Stuffit® for Macintosh®).

Step 1: Download the latest software

- 1 Connect a USB flash drive or insert a CD-R to your computer.
- 2 In your web browser, go to www.philips.com/support.
- 3 At the Philips Support website, find your product and locate the **Software and drivers**.

↳ The software update is available as a zip file.

- 4 Save the zip file in the root directory of your USB flash drive or CD-R.
- 5 Use the archive utility to extract the software update file in the root directory.
- 6 Remove the USB flash drive or CD-R from your computer.

Step 2: Update the software



Warning

- If you use a USB flash drive, make sure that there is no disc in the disc compartment, and the disc compartment is closed.

- 1 Connect the USB flash drive or insert the CD-R to your home theater.
- 2 Switch your TV to the correct source for your home theater.
- 3 Follow the instructions on the TV to complete the update.
↳ When the software update is complete, the home theater automatically switches off. If it does not, disconnect the power cord for a few seconds, and then reconnect it.



Note

- When the software update is in progress, do not turn off the power, or remove the USB flash drive or CD-R.

7 Product specifications

Note

- Specifications and design are subject to change without notice.

Region codes

The type plate on the back or bottom of the home theater shows which regions it supports.

Country	DVD
Europe, United Kingdom	
Asia Pacific, Taiwan, Korea	
Latin America	
Australia, New Zealand	
Russia, India	
China	

Media formats

- DVD-Video, DVD+R/+RW, DVD-R/-RW, DVD+R/-R DL, CD-R/CD-RW, Audio CD, Video CD/SVCD, Picture files, MP3 media, WMA media, DivX media, USB storage device

File formats

- Audio: .mp3, .wma

- Video: .avi, .divx, .mpg, .mpeg,
- Picture: .jpg, .jpeg

Amplifier

- Total output power: 300W RMS (30% THD)
- Frequency response: 20 Hz-20 kHz / ± 3 dB
- Signal-to-noise ratio: > 65 dB (CCIR) / (A-weighted)
- Input sensitivity:
 - AUX: 2 V
 - Music iLink: 1 V

Video

- Signal system: PAL / NTSC/Multi
- HDMI output: 480i/576i, 480p/576p, 720p, 1080i, 1080p

Audio

- S/PDIF Digital audio input:
 - Optical: TOSLINK
- Sampling frequency:
 - MP3: 32 kHz, 44.1 kHz, 48 kHz
 - WMA: 44.1 kHz, 48 kHz
- Constant bit rate:
 - MP3: 32 kbps - 320 kbps
 - WMA: 64 kbps - 192 kbps

Radio

- Tuning range:
 - Europe/Russia/China: FM 87.5-108 MHz (50 kHz)
 - Asia Pacific/Latin America: FM 87.5-108 MHz (50/100 kHz)
- Signal-to-noise ratio: FM 50 dB
- Frequency response: FM 200 Hz-12.5 kHz / ± 6 dB

USB

- Compatibility: Hi-Speed USB (2.0)

- Class support: USB Mass Storage Class (MSC)
- File system: FAT16, FAT32
- Maximum memory support: < 160 GB

Main unit

- Power supply:
 - Europe/China/Russia/India: 220-240V~, 50 Hz
 - Latin America/Asia Pacific: 110-240V~, 50-60 Hz
- Power consumption: 55 W
- Standby power consumption: ≤ 0.5 W
- Dimensions (WxHxD): 360 × 58 × 325 mm
- Weight: 2.3 kg

Subwoofer

- Output power: 50 W RMS (30% THD)
- Impedance: 4 ohm
- Speaker drivers: 133 mm (5.25") woofer
- Dimensions (WxHxD): 160 × 265 × 265 mm
- Weight: 2.50 kg
- Cable length: 3 m

Speakers

Center speaker:

- Output power: 50 W RMS (30% THD)
- System: 1 × 63.5 mm (2.5") full range
- Speaker impedance: 4 ohm
- Speaker drivers: 1 × 63.5 mm (2.5") woofer
- Dimensions (WxHxD): 84.5 × 89 × 89 mm
- Weight: 0.27 kg
- Cable length: 2 m

Front/Rear speaker:

- Output power: 4 × 50 W RMS (30% THD)
- Speaker impedance: 4 ohm
- Speaker drivers: 1 × 63.5 mm (2.5") full range
- Dimensions (WxHxD): 84.5 × 89 × 89 mm
- Weight (front): 0.27 kg/each
- Weight (rear): 0.27 kg/each
- Cable length (front): 3 m

- Cable length (rear): 7 m

Remote control batteries

- 2 × AAA-R03-1.5 V

Laser

- Type: Semiconductor laser GaAlAs (CD)
- Wave length: 645 - 665 nm (DVD), 770 - 800 nm (CD)
- Output power: 6 mW (DVD), 7 mW (VCD/CD)
- Beam divergence: 60 degrees.

8 Troubleshooting



Warning

- Risk of electric shock. Never remove the casing of the product.

To keep the warranty valid, never try to repair the product yourself.

If you have problems using this product, check the following points before you request service.

If you still have a problem, get support at www.philips.com/support.

Main unit

The buttons on the home theater do not work.

- Disconnect the home theater from the power supply for a few minutes, then reconnect.

Picture

No picture.

- Make sure that the TV is switched to the correct source for the home theater.

No picture on a TV connected through HDMI.

- Make sure that the HDMI cable is not faulty. If it is faulty, replace it with a new cable.
- If this happens when you change the HDMI video resolution, switch to its default mode: Press **▲** to open the disc compartment, and then press **304** on the remote control.
- Wait for 10 seconds for auto recovery, or change the HDMI video setting (see 'Picture resolution' on page 19).

Disc does not play high-definition video.

- Make sure that the disc contains high-definition video.

- Make sure that the TV supports high-definition video.
- Use an HDMI cable to connect to the TV.

Sound

No sound from home theater speakers.

- Connect the audio cable from your home theater to your TV or other devices.
- Reset your home theater to its factory settings (see 'Apply factory settings' on page 22), then switch it off and switch on again.
- On your home theater, press **SOURCE** repeatedly to select the correct audio input.

Distorted sound or echo.

- If you play audio from the TV through the home theater, make sure that the TV is muted.

Audio and video are not synchronized.

- 1) Press and hold **AUDIO SYNC**. 2) Press **+/-** within five seconds to synchronize the audio with the video.

Play

Cannot play a disc.

- Clean the disc.
- Make sure that the home theater supports the type of disc (see 'Media formats' on page 24).
- Make sure that the home theater supports the region code of the disc (see 'Region codes' on page 24).
- If the disc is a DVD±RW or DVD±R disc, make sure that it is finalized.

Cannot play a DivX file.

- Make sure that the DivX file is encoded according to the 'Home Theater Profile' with the DivX encoder.
- Make sure that the DivX file is complete.

DivX subtitles do not display correctly.

- Make sure that the subtitle file name is the same as the movie file name (see 'Subtitles' on page 15).
- Select the correct character set: 1) Press **⏏** **SETUP**. 2) Select **[Preference Setup]** > **[DivX Subtitle]**. 3) Select the supported character set. 4) Press **OK**.

Cannot read the contents of a USB storage device.

- Make sure that the format of the USB storage device is compatible with the home theater.
- Make sure that the file system on the USB storage device is supported by the home theater.

'input invalid' or 'x' sign appears on the TV.

- The operation is not possible.

EasyLink does not work.

- Make sure that the home theater is connected to a Philips brand EasyLink TV, and the EasyLink option is on.

When you switch on the TV, the home theater automatically switches on.

- This behavior is normal when you are using Philips EasyLink (HDMI-CEC). To make the home theater work independently, switch off EasyLink.

9 Notice

This section contains the legal and trademark notices.

Copyright



**Be responsible
Respect copyrights**

This item incorporates copy protection technology that is protected by U.S. patents and other intellectual property rights of Rovi Corporation. Reverse engineering and disassembly are prohibited.

Trademarks



Manufactured under license from Dolby Laboratories. Dolby and the double-D symbol are trademarks of Dolby Laboratories.



DivX®, DivX Ultra®, DivX Certified® and associated logos are trademarks of Rovi Corporation or its subsidiaries and are used under license.

DivX Ultra® Certified to play DivX® video with advanced features and premium content.
ABOUT DIVX VIDEO: DivX® is a digital video format created by DivX, LLC, a subsidiary of Rovi Corporation. This is an official DivX Certified® device that plays DivX video. Visit divx.com for more information and software tools to convert your files into DivX videos.
ABOUT DIVX VIDEO-ON-DEMAND: This DivX Certified® device must be registered in order to play purchased DivX Video-on-Demand (VOD) movies. To obtain your

registration code, locate the DivX VOD section in your device setup menu. Go to vod.divx.com for more information on how to complete your registration.



HDMI, and HDMI logo, and High-Definition Multimedia Interface are trademarks or registered trademarks of HDMI licensing LLC in the United States and other countries.



10 Language code

Abkhazian	6566	Inupiaq	7375	Pushto	8083
Afar	6565	Irish	7165	Russian	8285
Afrikaans	6570	Íslenska	7383	Quechua	8185
Amharic	6577	Italiano	7384	Raeto-Romance	8277
Arabic	6582	Ivrit	7269	Romanian	8279
Armenian	7289	Japanese	7465	Rundi	8278
Assamese	6583	Javanese	7486	Samoan	8377
Avestan	6569	Kalaallisut	7576	Sango	8371
Aymara	6589	Kannada	7578	Sanskrit	8365
Azerhijani	6590	Kashmiri	7583	Sardinian	8367
Bahasa Melayu	7783	Kazakh	7575	Serbian	8382
Bashkir	6665	Kernewek	7587	Shona	8378
Belarusian	6669	Khmer	7577	Shqip	8381
Bengali	6678	Kinyarwanda	8287	Sindhi	8368
Bihari	6672	Kirghiz	7589	Sinhalese	8373
Bislama	6673	Komi	7586	Slovensky	8373
Bokmål, Norwegian	7866	Korean	7579	Slovenian	8376
Bosanski	6683	Kuanyama; Kwanyama	7574	Somali	8379
Brezhoneg	6682	Kurdish	7585	Sotho; Southern	8384
Bulgarian	6671	Lao	7679	South Ndebele	7882
Burmese	7789	Latina	7665	Sundanese	8385
Castellano, Español	6983	Latvian	7686	Suomi	7073
Catalán	6765	Letzeburgesch;	7666	Swahili	8387
Chamorro	6772	Limburgan; Limburger	7673	Swati	8383
Chechen	6769	Lingala	7678	Svenska	8386
Chewa; Chichewa; Nyanja	7889	Lithuanian	7684	Tagalog	8476
中文	9072	Luxembourgish;	7666	Tahitian	8489
Chuang; Zhuang	9065	Macedonian	7775	Tajik	8471
Church Slavic; Slavonic	6785	Malagasy	7771	Tamil	8465
Chuvash	6786	Magyar	7285	Tatar	8484
Corsican	6779	Malayalam	7776	Telugu	8469
Česky	6783	Maltese	7784	Thai	8472
Dansk	6865	Manx	7186	Tibetan	6679
Deutsch	6869	Maori	7773	Tigrinya	8473
Dzongkha	6890	Marathi	7782	Tonga (Tonga Islands)	8479
English	6978	Marshallese	7772	Tsonga	8483
Esperanto	6979	Moldavian	7779	Tswana	8478
Estonian	6984	Mongolian	7778	Türkçe	8482
Euskara	6985	Nauru	7865	Türkmen	8475
Ελληνικά	6976	Navaho; Navajo	7886	Twí	8487
Faroese	7079	Ndebele, North	7868	Uighur	8571
Français	7082	Ndebele, South	7882	Ukrainian	8575
Frysk	7089	Ndonga	7871	Urdu	8582
Fijian	7074	Nederlands	7876	Uzbek	8590
Gaelic; Scottish Gaelic	7168	Nepali	7869	Vietnamese	8673
Gallegan	7176	Norsk	7879	Volapuk	8679
Georgian	7565	Northern Sami	8369	Walloon	8765
Gikuyu; Kikuyu	7573	North Ndebele	7868	Welsh	6789
Guarani	7178	Norwegian Nynorsk;	7878	Wolof	8779
Gujarati	7185	Occitan; Provençal	7967	Xhosa	8872
Hausa	7265	Old Bulgarian; Old Slavonic	6785	Yiddish	8973
Herero	7290	Oriya	7982	Yoruba	8979
Hindi	7273	Oromo	7977	Zulu	9085
Hiri Motu	7279	Ossetian; Ossetic	7983		
Hrwatski	6779	Pali	8073		
Ido	7379	Panjabi	8065		
Interlingua (International)	7365	Persian	7065		
Interlingue	7365	Polski	8076		
Inuktitut	7385	Português	8084		

11 Index

A	
amplifier	24
audio	
HDMI audio	19
predefined modes	13
settings	19
specifications	24
audio language	20
audio options	16
auto standby	21
<hr/>	
B	
brightness	22
<hr/>	
C	
care	
product	4
connectors	
front connectors	5
control	
disc play	13
main unit	5
parental control	20
radio	17
create MP3	18
<hr/>	
D	
discs	
audio language	20
audio options	16
control buttons	13
DivX	15
lock/unlock	21
menu language	20
options	16
picture	16
play	13
subtitle	20
synchronize picture and sound	14
time search	16
titles	16
<hr/>	
display	
MP3/JPEG menu	14
VCD/SVCD menu	14
display panel	5
DivX	
character set	15
subtitles	15
VOD code	15
<hr/>	
E	
enable	
auto standby	21
screen saver	21
energy	
auto standby	21
brightness	22
screen saver	21
sleep timer	21
<hr/>	
F	
factory settings	22
FM antenna	5
<hr/>	
H	
HDMI	
audio	19
video settings	19
<hr/>	
L	
language	
audio	20
disc menu	20
language code	29
onscreen menu	20
subtitle	20
<hr/>	
M	
main unit	
overview	5
specifications	25
troubleshooting	26
media formats	
MP3	24
<hr/>	
MP3	
connector	5

create MP3	18
display contents	14
play	17

O

options	
picture	16
overview	
main unit	5
remote control	6
settings	19

P

parental control	
lock disc	21
password	20
ratings	21
password	20
picture	
high resolution JPEG	19
options	16
settings	19
slideshows	16
troubleshooting	26
picture options	16
play	
discs	13
MP3	17
radio	24
slideshows	16
troubleshooting	26
USB	14
preference	
audio	19
auto standby	21
change password	20
disc menu	20
display panel	22
menu language	20
screen saver	21
sleep timer	21
subtitle	20
product specifications	24

R

radio	
control buttons	17
FM antenna	5
listen to radio	17
specifications	24
tune stations	17
ratings	21
region codes	24
remote control	
batteries	25
overview	6
repeat	16

S

safety	
use of the product	3
screen saver	21
settings	
audio	19
auto standby	21
default	22
disc language	20
HDMI audio	19
HDMI video	19
menu language	20
parental rating	21
password	20
picture	19
power	21
restore	22
screen saver	21
sleep timer	21
subtitle language	20
video	19
sleep timer	21
slideshows	
musical	16
picture	16
software	
check current version	23
update	23
sound	
predefined sound mode	13
surround sound	13

synchronize picture and sound	14
troubleshooting	26
sound mode	13
speakers	
specifications	25
surround sound	13
subtitle	
character set	15
language	20
subwoofer	
specifications	25
synchronize picture and sound	14

T

time search	16
titles	16
trademarks	28
troubleshooting	
connection	26
main unit	26
picture	26
play	26
sound	26

U

update software	
check current version	23
update	23
USB	
format	24
USB storage device	
options	16
play	15
specifications	24

V

video	
picture settings	19
synchronize picture and sound	14
VOD code for DivX	15
video formats	24
video options	16
VOD code for DivX	15



Specifications are subject to change without notice
© 2012 Koninklijke Philips Electronics N.V.
All rights reserved.

HTD3500_77_UM_V1.0

