

PHILIPS

Clock Radio

3000 Series

R3205

Quick start guide



Register your product and get support at
www.philips.com/support

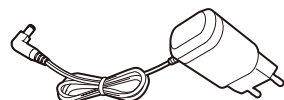
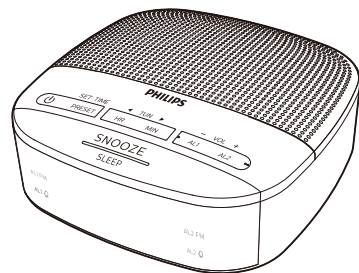

2

3

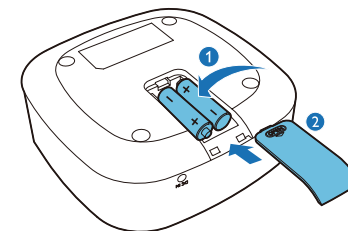
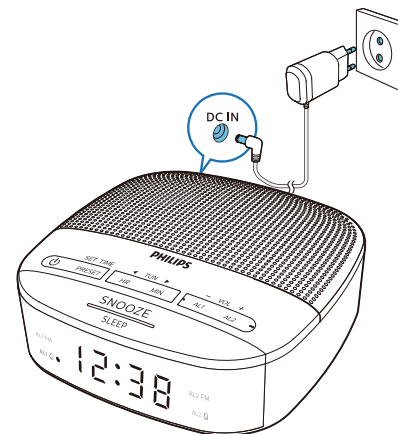

1

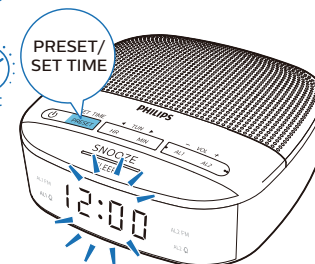

3

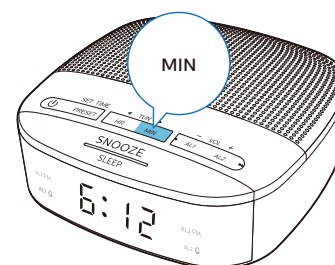

2

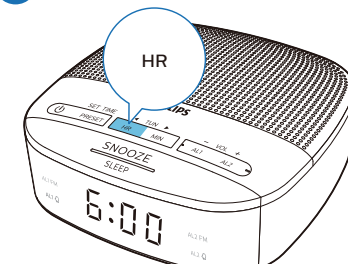

4

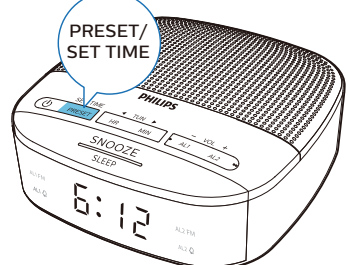

Specifications are subject to change without notice.
Philips and the Philips Shield Emblem are registered trademarks of Koninklijke Philips N.V. and are used under license.
This product has been manufactured by and is sold under the responsibility of MMD Hong Kong Holding Limited or one of its affiliates, and MMD Hong Kong Holding Limited is the warrantor in relation to this product.

TAR3205_12_QSG_V1.0



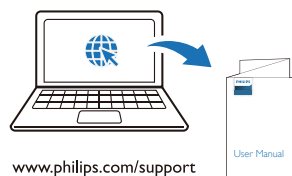
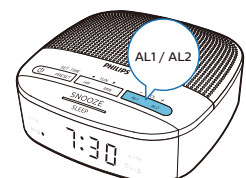
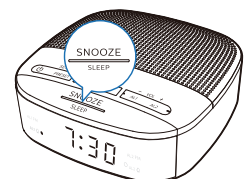
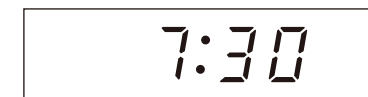
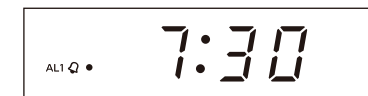
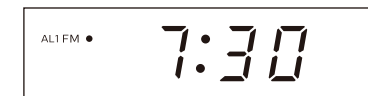
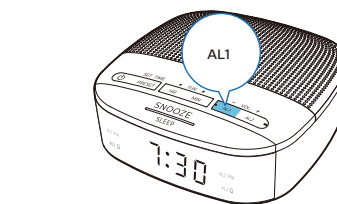
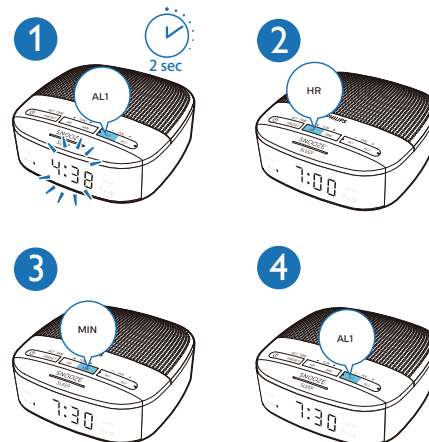
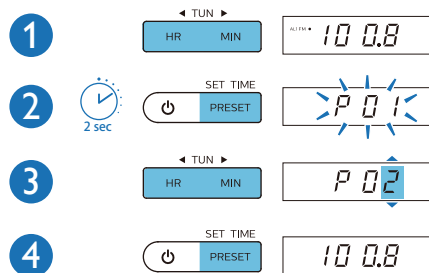
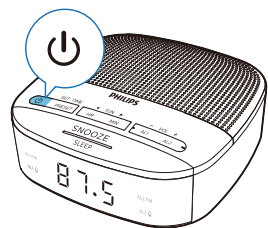
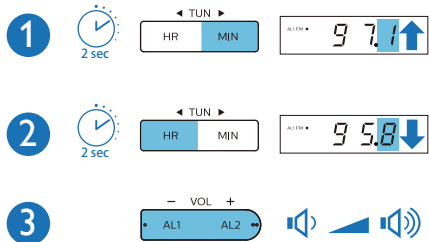
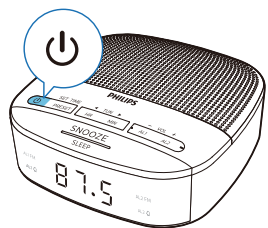

www.philips.com/support

EN To download the full user manual, visit www.Philips.com/support.

CS Úplný návod k použití si můžete stáhnout na adrese www.Philips.com/support.

DA For at downloade hele brugervejledningen, besøg www.Philips.com/support.

DE Besuchen Sie zum Herunterladen der vollständigen Bedienungsanleitung www.Philips.com/support.

EL Για να κατεβάσετε το πλήρες εγχειρίδιο χρήσης, μεταβείτε στη διεύθυνση www.Philips.com/support.

ES Para descargar el manual del usuario completo, visite www.Philips.com/support.

FI Täyden käyttöoppaan voit ladata osoitteesta www.Philips.com/support.

FR Pour télécharger le mode d'emploi complet, visitez www.Philips.com/support.

HU A teljes felhasználói kézikönyv letöltéséhez látogasson el a www.Philips.com/support címre.

IT Per scaricare il manuale utente completo, visitate il sito www.Philips.com/support.

KK Тольк пайдаланушы нускаулыгын жүктеп алу үшін мына бетке кіріңіз: www.Philips.com/support.

NL Ga naar www.Philips.com/support om de volledige gebruikershandleiding te downloaden.

NO Du kan laste ned en fullstendig brukerhåndbok fra www.Philips.com/support.

PL Aby pobrać kompletną instrukcję obsługi, odwiedź stronę www.Philips.com/support.

PT Para transferir o manual do utilizador completo, visite www.Philips.com/support.

RU Чтобы загрузить полную версию руководства пользователя, перейдите на веб-страницу www.Philips.com/support.

RO Pentru a descărca manualul complet al utilizatorului, accesați www.Philips.com/support.

SK Úplnú používateľskú príručku si môžete prebrať na adrese www.Philips.com/support.

SV Gå till www.Philips.com/support för att ladda ner hela bruksanvisningen.

TR Kullanıcı kılavuzunu indiremek için www.Philips.com/support adresini ziyaret edin.

UK Щоб завантажити повний посібник користувача, відвідайте www.Philips.com/support.

AR لتحميل دليل المستخدم الكامل، يمكنك زيارة الموقع الإلكتروني التالي www.Philips.com/support.

LT Jei norite atsisiųsti visą naudotojo vadovą, apsilankykite www.Philips.com/support.

LV Lai lejupielādētu pilnu lietotāja rokasgrāmatu, apmeklējiet vietni: www.Philips.com/support.

ET Terve kasutusjuhendi allaaladamiseks külastage www.Philips.com/support.

SL Za prenos celotnega uporabniškega priročnika obiščite www.philips.com/support.

HR Da biste preuzeli cijeli korisnički priručnik, idite na www.Philips.com/support.

SR Da biste preuzeli kompletan korisnički priručnik, posetite www.Philips.com/support.

BS Za preuzimanje kompletnog uputstva za upotrebu, posjetite www.Philips.com/support.

SQ Për të shkarkuar manualin e plotë të përdorimit, vizitoni www.Philips.com/support.

MK Да го преземете целосното корисничко упатство, посетете www.Philips.com/support.

ME Da biste preuzeli cijeli korisnički priručnik, posjetite www.Philips.com/support.

BG За да изтеглите цялото ръководство, посетете www.Philips.com/support.



Amplifier

Rated Output Power 200mW RMS

Tuner

Tuning Range FM: 87.5-108 MHz

Tuning Grid 50 KHz

Sensitivity

- Mono, 26 dB S/N Ratio <22 dBf

Total Harmonic Distortion <3%

Signal to Noise Ratio >50 dBA

General information

AC Power (power adaptor) Brand: Philips;
Model: AS030-050-EE060
Input: 100-240V~
50/60 Hz; 0.15A
Output: 5V \pm 0.6A

Operation Power Consumption <3W

Standby Power Consumption <1W

Dimensions (W x H x D) 131 x 54 x 131 mm

Weight (Main Unit) 198.9g