

Register your product and get support at
www.philips.com/welcome

DCB188



EN User manual

PHILIPS

Contents

1 Important	4	8 Listen to radio	15
Safety	4	Tune to a radio station	15
Notice	5	Program radio stations automatically	15
		Program radio stations manually	15
2 Your Micro Hi-Fi System	7	Select a preset radio station	16
Introduction	7	FM stations with RDS	16
What's in the box	7		
Overview of the main unit	8	9 Listen to Digital Audio Broadcast (DAB)	17
Overview of the remote control	9	Program DAB radio stations manually	17
		Listen to preset DAB stations	17
3 Connect	11	Display DAB information	17
Connect speakers	11	Use DAB menu	17
Connect power	11		
		10 Other features	19
4 Get started	12	Set the alarm timer	19
Prepare the remote control	12	Set the sleep timer	19
Set clock	12	Listen to an external device	19
Turn on	12		
		11 Product information	20
5 Play disc	13	Specifications	20
Play options	13	Supported MP3 disc formats	20
6 Play from iPod/iPhone	14	12 Troubleshooting	21
Compatible iPod/iPhone	14	About DAB	22
Listen to iPod/iPhone through this player	14		
Charge the iPod/iPhone	14		
Remove the iPod/iPhone	14		
7 Adjust volume level and sound effect	15		
Adjust volume level	15		
Enhance bass	15		
Select a preset sound effect	15		
Mute sound	15		

1 Important

Safety

Know these safety symbols



This 'bolt of lightning' indicates uninsulated material within your unit may cause an electrical shock. For the safety of everyone in your household, please do not remove product covering.

The 'exclamation mark' calls attention to features for which you should read the enclosed literature closely to prevent operating and maintenance problems. **WARNING:** To reduce the risk of fire or electric shock, this apparatus should not be exposed to rain or moisture and objects filled with liquids, such as vases, should not be placed on this apparatus.

CAUTION: To prevent electric shock, fully insert the plug. (For regions with polarized plugs: To prevent electric shock, match wide blade to wide slot.)

Important Safety Instructions

- ① Read these instructions.
- ② Keep these instructions.
- ③ Heed all warnings.
- ④ Follow all instructions.
- ⑤ Do not use this apparatus near water.
- ⑥ Clean only with dry cloth.
- ⑦ Do not block any ventilation openings. Install in accordance with the manufacturer's instructions.
- ⑧ Do not install near any heat sources such as radiators, heat registers, stoves, or other apparatus (including amplifiers) that produce heat.
- ⑨ Protect the power cord from being walked on or pinched, particularly at plugs, convenience receptacles, and the point where they exit from the apparatus.
- ⑩ Only use attachments/accessories specified by the manufacturer.
- ⑪ Use only with the cart, stand, tripod, bracket, or table specified by the manufacturer or sold with the apparatus. When a cart is used, use caution when moving the cart/apparatus combination to avoid injury from tip-over.
- ⑫ Unplug this apparatus during lightning storms or when unused for long periods of time.
- ⑬ Refer all servicing to qualified service personnel. Servicing is required when the apparatus has been damaged in any way, such as power-supply cord or plug is damaged, liquid has been spilled or objects have fallen into the apparatus, the apparatus has been exposed to rain or moisture, does not operate normally, or has been dropped.
- ⑭ Battery usage **CAUTION** – To prevent battery leakage which may result in bodily injury, property damage, or damage to the unit:
 - Install all batteries correctly, + and - as marked on the unit.
 - Do not mix batteries (old and new or carbon and alkaline, etc.).



- Remove batteries when the unit is not used for a long time.
- Batteries (battery pack or batteries installed) shall not be exposed to excessive heat such as sunshine, fire or the like.

- ⑮ **Apparatus shall not be exposed to dripping or splashing.**
- ⑯ **Do not place any sources of danger on the apparatus (e.g. liquid filled objects, lighted candles).**
- ⑰ **Where the plug of the Direct Plug-in Adapter is used as the disconnect device, the disconnect device shall remain readily operable.**

! Caution

- Use of controls or adjustments or performance of procedures other than herein may result in hazardous radiation exposure or other unsafe operation.

Hearing safety

Listen at a moderate volume.

- Using headphones at a high volume can impair your hearing. This product can produce sounds in decibel ranges that may cause hearing loss for a normal person, even for exposure less than a minute. The higher decibel ranges are offered for those that may have already experienced some hearing loss.
- Sound can be deceiving. Over time your hearing 'comfort level' adapts to higher volumes of sound. So after prolonged listening, what sounds 'normal' can actually be loud and harmful to your hearing. To guard against this, set your volume to a safe level before your hearing adapts and leave it there.

To establish a safe volume level:

- Set your volume control at a low setting.

- Slowly increase the sound until you can hear it comfortably and clearly, without distortion.

Listen for reasonable periods of time:

- Prolonged exposure to sound, even at normally 'safe' levels, can also cause hearing loss.
- Be sure to use your equipment reasonably and take appropriate breaks.

Be sure to observe the following guidelines when using your headphones.

- Listen at reasonable volumes for reasonable periods of time.
- Be careful not to adjust the volume as your hearing adapts.
- Do not turn up the volume so high that you can't hear what's around you.
- You should use caution or temporarily discontinue use in potentially hazardous situations. Do not use headphones while operating a motorized vehicle, cycling, skateboarding, etc.; it may create a traffic hazard and is illegal in many areas.

Notice

Any changes or modifications made to this device that are not expressly approved by Philips Consumer Lifestyle may void the user's authority to operate the equipment.



Your product is designed and manufactured with high quality materials and components, which can be recycled and reused.



When this crossed-out wheeled bin symbol is attached to a product it means that the product is covered by the European Directive 2002/96/EC.

Please inform yourself about the local separate collection system for electrical and electronic products.

Please act according to your local rules and do not dispose of your old products with your normal household waste. Correct disposal of your old product helps to prevent potential negative consequences for the environment and human health.



Your product contains batteries covered by the European Directive 2006/66/EC, which cannot be disposed with normal household waste. Please inform yourself about the local rules on separate collection of batteries because correct disposal helps to prevent negative consequences for the environmental and human health.

Environmental information

All unnecessary packaging has been omitted. We have tried to make the packaging easy to separate into three materials: cardboard (box), polystyrene foam (buffer) and polyethylene (bags, protective foam sheet.)

Your system consists of materials which can be recycled and reused if disassembled by a specialized company. Please observe the local regulations regarding the disposal of packaging materials, exhausted batteries and old equipment.



The making of unauthorized copies of copy-protected material, including computer programs, files, broadcasts and sound recordings, may be an infringement of copyrights and constitute a criminal offence. This equipment should not be used for such purposes.



“Made for iPod” and “Made for iPhone” mean that an electronic accessory has been designed to connect specifically to iPod, or iPhone respectively, and has been certified by the developer to meet Apple performance standards. Apple is not responsible for the operation of this device or its compliance with safety and regulatory standards. Please note that the use of this accessory with iPod, or iPhone may affect wireless performance.

Apple is not responsible for the operation of this device or its compliance with safety and regulatory standards.

iPod and iPhone are trademarks of Apple Inc., registered in the U.S. and other countries.

Class II equipment symbol



This symbol indicates that the unit has a double insulation system.

Note

- The type plate is located at the rear of the apparatus.

2 Your Micro Hi-Fi System

Congratulations on your purchase, and welcome to Philips! To fully benefit from the support that Philips offers, register your product at www.Philips.com/welcome.

Introduction

With this unit, you can:

- enjoy audio from audio CDs, iPod players, iPhone and other external devices
- listen to radio stations and Digital Audio Broadcasting (DAB) radio stations

You can enrich sound output with the sound effect:

- Dynamic Bass Boost (DBB)
- Digital Sound Control (DSC)

The unit supports the following media format:



What's in the box

Check and identify the contents of your package:

- Main unit
- Loudspeaker boxes x 2
- MP3 link cable x 1
- Remote control
- User manual
- Quick start guide

Overview of the main unit

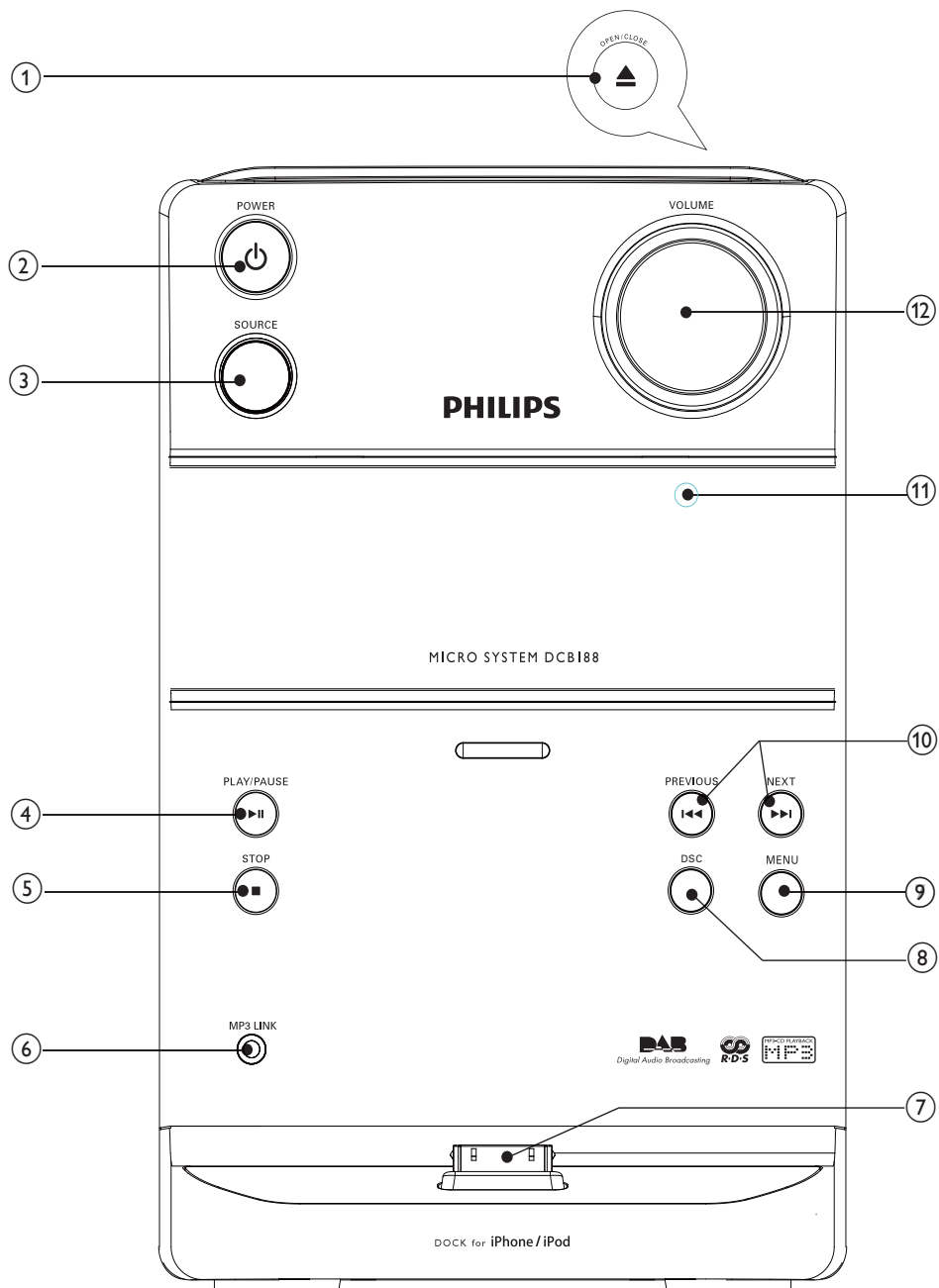

- ① **OPEN/CLOSE ▲**
 - Open or close the disc tray.
- ② **POWER**
 - Turn on the unit, switch to standby mode.
- ③ **SOURCE**
 - Select a source: Disc, Tuner, MP3 LINK, or iPod/iPhone.
- ④ **▶||**
 - Start or pause play.
- ⑤ **■**
 - Stop play or erase a program.
- ⑥ **MP3 LINK**
 - Jack for an external audio device.
- ⑦ **iPod/iPhone dock**
- ⑧ **DSC**
 - Select a preset sound setting: POP, JAZZ, CLASSIC or ROCK.
- ⑨ **MENU**
 - Access DAB menu.
- ⑩ **◀◀ / ▶▶**
 - Skip to the previous/next track.
 - Search within a track/ disc.
 - Tune to a radio station.
 - Adjust time.
- ⑪ **Remote control sensor**
- ⑫ **VOLUME**
 - Adjust volume.

Overview of the remote control

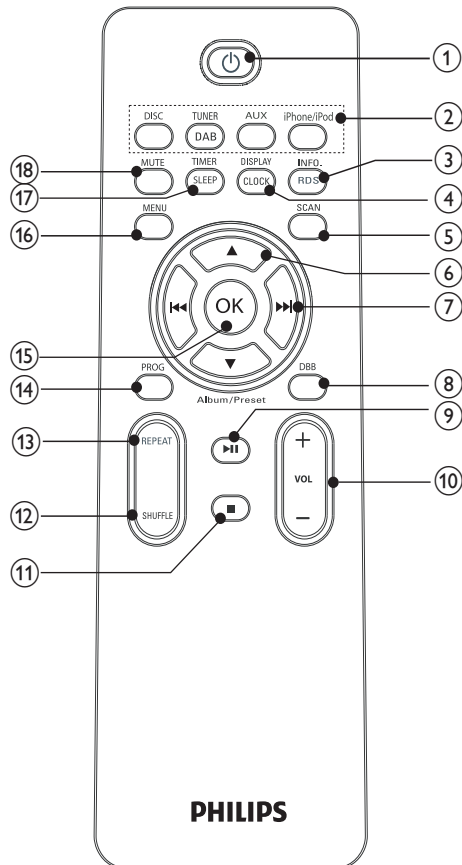

- ① **POWER**
 - Switch on/off the unit
 - Switch to standby mode.
- ② **Source selection keys (DISC, TUNER/DAB, AUX, iPhone/iPod)**
 - Select a source: CD, tuner/DAB, MP3 LINK, or iPod/iPhone.
- ③ **INFO/RDS**
 - Switch to FM RDS mode
 - Display DAB info.

- ④ **CLOCK/DISPLAY**
 - Set the clock.
 - View the clock.
 - During play, select display information.
- ⑤ **SCAN**
 - Select DAB auto scan or FM auto scan
- ⑥ **PRESET/ALBUM ▲▼**
 - Navigate through the iPod/iPhone menu.
 - Skip to the previous/next album.
 - Select a preset radio station.
- ⑦ **⏮/⏭**
 - Fast reverse or fast forward within a track or disc.
 - Skip to the previous/next track.
 - Tune to a radio station.
 - Adjust time.
- ⑧ **DBB**
 - Turns on or off dynamic bass enhancement.
- ⑨ **▶||**
 - Start or pause play.
- ⑩ **VOL +/-**
 - Adjust volume.
- ⑪ **■**
 - Stop play or erase a program.
- ⑫ **SHUFFLE**
 - Play tracks randomly.
- ⑬ **REPEAT**
 - Select a repeat play mode.
- ⑭ **PROG**
 - Program tracks.
 - Program radio stations.
 - Select 12 hour or 24 hour format.
- ⑮ **OK**
 - Confirm a selection.
- ⑯ **MENU**
 - Access the iPod/iPhone or DAB menu.
- ⑰ **TIMER/SLEEP**
 - Set the alarm timer.
 - Set the sleep timer.
- ⑱ **MUTE**
 - Mute volume.

3 Connect

Connect speakers

Note

- For optimal sound, use the supplied speakers only.
- Connect only speakers with impedance that is the same or higher than the supplied speakers. Refer to the Specifications section of this manual.

- 1 Fully insert the plugs from the speakers into the speaker sockets on the back of the main unit.

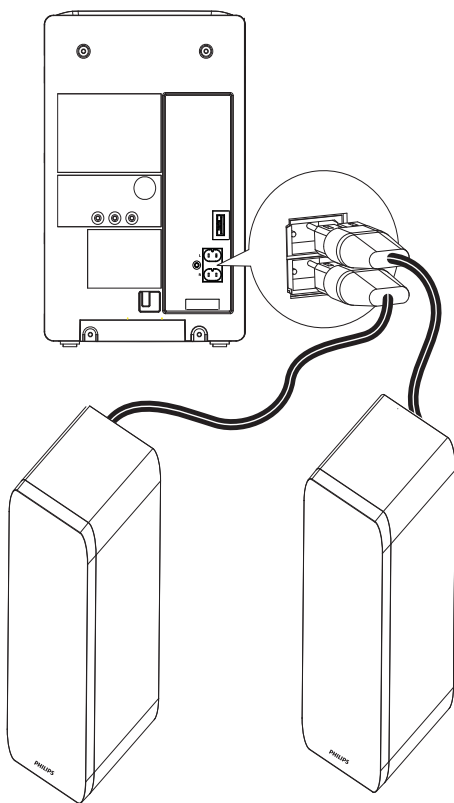

Connect power

Caution

- Risk of product damage! Make sure that the power supply voltage corresponds to the voltage printed on the back or the underside of the Micro Hi-Fi system.
- Before connecting the AC power cord, make sure that you have completed all other connections.

- 1 Connect the AC power cord to the power outlet.

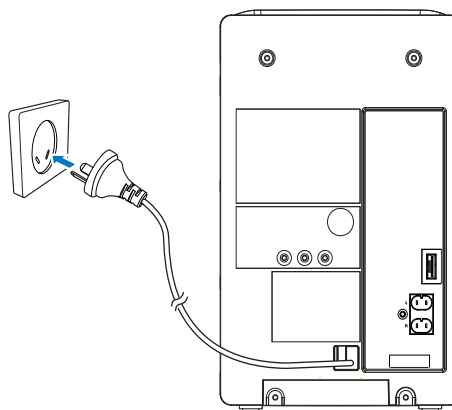

4 Get started

! Caution

- Use the controls only as stated in this user manual.
- Always follow the instructions in this chapter in sequence.

If you contact Philips, you will be asked for the model and serial number of your apparatus. The model number and serial number are on the back of the apparatus. Write the numbers here:
Model No. _____
Serial No. _____

Prepare the remote control

! Caution

- Risk of explosion! Keep batteries away from heat, sunshine or fire. Never discard batteries in fire.

To insert the remote control battery:

- 1 Open the battery compartment.
- 2 Insert 2 AAA batteries (not supplied) with correct polarity (+/-) as indicated.
- 3 Close the battery compartment.

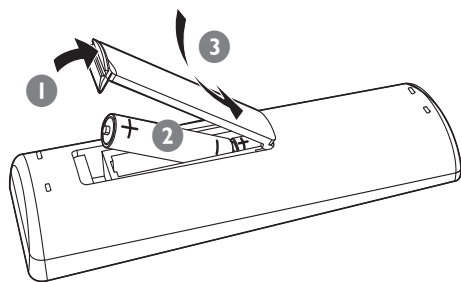

☰ Note

- If you are not going to use the remote control for a long time, remove the batteries.
- Do not use old and new or different types of batteries in combination.
- Batteries contain chemical substances, so they should be disposed of properly.

Set clock

- 1 In the standby mode, press and hold **CLOCK/DISPLAY** to activate the clock setting mode.
↳ The 12 hour or 24 hour format is displayed.
- 2 Press **PROG** repeatedly to select 12 hour or 24 hour format.
- 3 Press **CLOCK/DISPLAY** to confirm.
↳ The hour digits are displayed and begin to blink.
- 4 Press **◀/▶** to set the hour.
- 5 Press **CLOCK/DISPLAY** to confirm.
↳ The minute digits are displayed and begin to blink.
- 6 Press **◀/▶** to set the minute.
- 7 Press **CLOCK/DISPLAY** to confirm.

Turn on

- 1 Press **POWER**.
↳ The product switches to the last selected source.

Switch to standby

- 1 Press **POWER** to switch the unit to standby mode.
↳ The clock (if set) appears on the display panel.

5 Play disc

Caution

- Never look at the laser beam inside the unit.
- Risk of product damage! Never play discs with accessories such as disc stabilizer rings or disc treatment sheets.
- Do not push on the disc compartment or put any objects other than discs on the disc compartment. It may cause the disc player to malfunction.

Note

- With some disc/file types, play may differ.

- 1 Press **DISC** to select the disc source.
- 2 Lift the disc door at the top of the unit.
- 3 Insert a disc with the printed side facing up, then close the disc compartment.
- 4 Press **▶||** to start play.
 - To pause/resume play, press **▶||**.
 - To stop play, press **■**.

Play options

Skip to a track

For CD:

- 1 Press **◀◀/▶▶** to select another track.

For MP3 discs:

- 1 Press **PRESET/ALBUM ▲▼** to select an album or folder.
- 2 Press **◀◀/▶▶** to select a track or file.

Search within a track

- 1 During play, press and hold **◀◀/▶▶**.
- 2 Release to resume normal play.

Display play information

- 1 During play, press **CLOCK/DISPLAY** repeatedly to select different play information.

Repeat play

- 1 During play, press **REPEAT** repeatedly to select:
 - ↳ **[REP ALL]** : all tracks are played repeatedly.
 - ↳ **[REP ONE]** : The current track is played repeatedly.
- 2 To return to normal play, press **REPEAT** repeatedly until repeat mode is no longer displayed.

Random play

- 1 Press **SHUFFLE**.
 - ↳ **[SHUF]** is displayed: all tracks are played randomly.
- 2 To return to normal play, press **SHUFFLE** again.

Note

- Repeat and shuffle mode can not be activated at the same time.

Program tracks

You can program a maximum of 40 tracks.

- 1 In DISC mode, at the stop position
 - For MP3: press **PRESET/ALBUM ▲▼** to select an album, and then press **◀◀/▶▶** to select a track.
 - For CD: press **◀◀/▶▶** to select a track.
- 2 Press **PROG** to store the track.
- 3 Repeat step 1-2 to select and store all tracks to program.
- 4 Press **▶||** to play the programmed tracks.
 - ↳ During play, **[PROG]** is displayed.
 - To erase the program, in the stop position, press **■**.
 - ↳ **[PROG]** disappears.

6 Play from iPod/iPhone

You can enjoy audio from iPod/iPhone through this unit.

Compatible iPod/iPhone

Apple iPod and iPhone models with a 30-pin dock connector:

Made for:

- iPod with video (iPod 5th generation)
- iPod nano (1st generation)
- iPod nano (2nd generation)
- iPod nano (3rd generation)
- iPod nano (4th generation)
- iPod nano (5th generation)
- iPod nano (6th generation)
- iPod classic
- iPod touch (1st generation)
- iPod touch (2nd generation)
- iPod touch (3rd generation)
- iPod touch (4th generation)

Works with:

- iPhone
- iPhone 3G
- iPhone 3GS
- iPhone 4.

Listen to iPod/iPhone through this player

- 1 Place the iPod/iPhone in the dock.
 - ↳ The unit switches to iPod/iPhone mode automatically.
 - To start/pause/resume play, press **▶||**.
 - To skip to a track, press **◀◀ / ▶▶**.
 - To search during play: press and hold **◀◀ / ▶▶**, then release to resume normal play.
 - To navigate the menu: press **MENU**, then press **▲ / ▼** to select, and press **OK** to confirm.

Charge the iPod/iPhone

When the unit is connected to power, the docked iPod/iPhone starts charging.



Tip

- For certain iPod models, it may take up to a minute before the charging indication appears.

Remove the iPod/iPhone

- 1 Pull the iPod/iPhone out of the dock.

7 Adjust volume level and sound effect

Adjust volume level

- 1 During play, press **VOL +/-** to increase/decrease the volume level.

Enhance bass

- 1 During play, press **DBB** to turn on or off dynamic bass enhancement.
↳ If DBB is activated, DBB is displayed.

Select a preset sound effect

- 1 During play, press **DSC** on the main unit repeatedly to select:
 - [POP]
 - [JAZZ]
 - [ROCK]
 - [CLASSIC]

Mute sound

- 1 During play, press **MUTE** to mute/unmute sound.

8 Listen to radio

Tune to a radio station

- 1 Press **TUN** repeatedly to select FM.
- 2 Press **SCAN**.
↳ The radio automatically tunes to a station with sufficient signal strength.
- 3 Repeat step 2 to tune to more stations.
 - To tune to a station with weak signal, press **◀◀ / ▶▶** repeatedly until you find optimal reception.

Program radio stations automatically

You can program a maximum of 30 preset radio stations.

- 1 In the FM tuner mode, press and hold **SCAN** for 2 seconds to activate automatic program mode.
↳ All available stations are stored in the order of reception strength.
↳ The first programmed radio station is broadcast automatically.

Program radio stations manually

You can program a maximum of 30 preset radio stations.

- 1 Tune to a radio station. (See "Tune to a radio station" section.)
- 2 Press **PROG** to activate program mode.
- 3 Press **PRESET/ALBUM ▲ ▼** to allocate a number to this radio station.
- 4 Press and hold **PROG** to confirm.
- 5 Repeat the above steps to program other stations.

 Tip

- To overwrite a programmed station, store another station in its place.

Select a preset radio station

- 1 In tuner mode, press **PRESET/ALBUM ▲ ▼** to select a preset number.
 - ↳ The radio station stored under the selected number is broadcasted.

 Tip

- Position the antenna as far as possible from TV, VCR or other radiation source.
- For optimal reception, fully extend and adjust the position of the antenna.

FM stations with RDS

Radio Data System (RDS) is a service that sends additional broadcast information along with FM stations.

If you listen to a FM station with RDS signal, "RDS" displays.

Display RDS information

- 1 Tune to the desired RDS radio station on the FM waveband.
- 2 Press **INFO/RDS** on the remote control repeatedly to switch through the following information (if available):
 - Station name
 - Program type (for example: News, Sport, etc.)
 - Frequency
 - Stereo/Mono Mode
 - Current time
 - Date

Display RDS information

When the unit is on, the clock can be automatically set by synchronizing with the time signal broadcasts with the RDS signal. This only works if the RDS station is sending this time signal.

When clock synchronizing is turned on, clock is synchronized with the time set by DAB or RDS, and manually set clock is overwritten. To turn on or off clock synchronizing:

- 1 In DAB or FM mode, press and hold **MENU** on the main unit for around 2 seconds to switch it on or off.

 Note

- Some RDS radio station may be transmitting a real time clock at a minute interval. The accuracy of the transmitted time depends on the transmitting RDS radio station.

9 Listen to Digital Audio Broadcast (DAB)

Digital Audio Broadcasting (DAB), is a way of broadcasting radio digitally through a network of transmitters. It provides you with more choice, better sound quality and more information.

- 1 Press **TUNER** repeatedly to select DAB.
- 2 Press **SCAN**.
 - ↳ The system performs auto scan.
 - ↳ All the available DAB stations is stored.
 - ↳ The radio tunes to the first available station.

Program DAB radio stations manually

You can program a maximum of 30 preset DAB radio stations.

- 1 Tune to a DAB station.
- 2 Press **PROG** on the remote control to activate programming.
- 3 Press **▼ / ▲** on the remote control to allocate a number (1-30) for the preset.
- 4 Press and hold **PROG** to confirm.
 - ↳ The preset number of the saved station appears.

Note

- If a DAB station is already stored under a preset location, new DAB station assigned to this location will overwrite the old DAB station.
- DAB station presets will not overwrite FM presets.

Listen to preset DAB stations

- 1 In DAB mode, press **PRESET/ALBUM ▲ ▼** to select a preset number.
 - ↳ The DAB station stored under the selected number is broadcasted.

Display DAB information

On the display of DAB broadcasting, the first line shows station name, and the second line shows the service information for the current station. 7 types of service information are available.

- 1 Press **INFO/RDS** repeatedly to cycle through the display information (if available).
 - ↳ Dynamic label segment (DLS)
 - ↳ Program type (PTY)
 - ↳ Ensemble Name
 - ↳ Time
 - ↳ Channel and frequency
 - ↳ Bit rate and audio status
 - ↳ Signal error rate

Use DAB menu

- 1 In the DAB mode, press **MENU** to enter the DAB menu.
 - ↳ The first setup option [**Manual tune**] displays.
- 2 Press **◀ / ▶** to scroll the menu options:
 - [**Station list**]
 - [**Full scan**]
 - [**Manual tune**]
 - [**DRC**]
 - [**Prune**]
 - [**System**]
- 3 To select an option, press **OK**.

- 4 Repeat step 2-3 if sub-option is available under one option.

Full scan

Full scan is used to perform a wide range of DAB radio search.

- 1 In the DAB mode, press **MENU** to enter the menu options.
- 2 Press **◀◀ / ▶▶** repeatedly until **[Full scan]** displays.
- 3 Press **OK** to confirm the selection.
↳ Full scan starts automatically.

Manual tune

With this feature, you can tune to a specific channel/frequency manually. In addition to antenna orientation for better radio reception, the optimal reception can also be obtained with this feature.

- 1 In DAB mode, press **MENU** to display the **[Manual tune]** option.
- 2 Press **OK** to confirm the selection.
↳ The display shows a channel and its frequency.
- 3 Press **◀◀ / ▶▶** repeatedly until the desired channel/frequency appears.
- 4 Press **OK** to confirm the selection.



Tip

- You can press **INFO/RDS** to change the service information on the display.
- You can adjust the position of the antenna to obtain the optimal signal strength.

Dynamic Range Control (DRC)

DRC adds or removes a degree of compensation for the differences in the dynamic range between radio stations.

There are three levels of compensation:

- **[DRC Off]**: No compensation applied. (the default)
- **[DRC Low]**: Medium compensation applied.
- **[DRC High]**: Maximum compensation applied.

- 1 In DAB mode, press **MENU** to enter the menu options.

- 2 Press **◀◀ / ▶▶** repeatedly until **[DRC]** displays.
- 3 Press **OK** to enter the sub-menu.
↳ The current DRC level displays on the first line.
- 4 Press **◀◀ / ▶▶** to select a DRC value
↳ **[DRC Off]**, **[DRC Low]** and **[DRC High]** displays on the second line.
- 5 Press **OK** to confirm the selection.
↳ You should be able to hear the difference in compression immediately.



Note

- The best way to determine which of these DRC value settings suits you best is to experiment with them on a variety of source material.

Prune

This option will list active stations and remove any stations that are in the list but have no service in your area from the service list. Those invalid stations in the service list have a question mark (?) displayed in front of the station name.

- 1 Select Prune stations and press **OK**.
↳ All stations that have a question mark will be deleted from the service list.

System

- **[SW version]**: Display software version of the unit.
- **[Factory reset]**: Reset all the settings of this unit to factory default. Press **OK** to confirm reset.

10 Other features



Set the alarm timer

Note

- This player can set the Disc, Tuner, or iPod/iPhone as the source for the alarm timer.

- 1 Make sure that you have set the clock correctly.
- 2 In standby mode, press and hold **TIMER**.
- 3 Press **DISC**, **TUN**, or **iPhone/iPod** to select a source.
- 4 Press **TIMER** to confirm.
↳ The hour digits are displayed and begin to blink.
- 5 Press **◀◀/▶▶** to set the hour.
- 6 Press **TIMER** to confirm.
↳ The minute digits are displayed and begin to blink.
- 7 Press **◀◀/▶▶** to set the minute.
- 8 Press **TIMER** to confirm.
↳ The timer is set and activated.

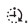
Activate and deactivate alarm timer

- 1 In the standby mode, press **SLEEP/TIMER** repeatedly to activate or deactivate timer.
↳ If timer is activated, the display shows .
↳ If timer is deactivated,  disappears.

Tip

- Alarm timer is not available in MP3 LINK mode.
- If the DISC/iPod/iPhone source is selected but no disc inserted or no iPod/iPhone connected, the system will switch to the tuner source automatically.

Set the sleep timer

This unit can switch to standby automatically after a set of time.

- 1 When the unit is on, press **SLEEP** repeatedly to select a set of time (in minutes).
↳ When sleep timer is activated, the display shows **zZ**.

To deactivate sleep timer

- 1 Press **SLEEP** repeatedly until "off" is displayed.
↳ When sleep timer is deactivated, **zZ** disappears.

Listen to an external device

You can also listen to an external audio device through this unit.

- 1 Press **AUX** to select MP3 link source.
- 2 Connect the supplied MP3 link cable to:
 - the **MP3 LINK** jack on this unit
 - the headphone jack on the device
- 3 Start to play the device. (See the device user manual)

11 Product information



Note

- Product information is subject to change without prior notice.

Specifications

Amplifier

Rated Output Power	15 W RMS
Frequency Response	60 - 16 kHz, ± 3 dB
Signal to Noise Ratio	>65 dBA
Aux Input	0.5 V RMS 20kohm

Disc

Laser Type	Semiconductor
Disc Diameter	12 cm/8 cm
Support Disc	CD-DA, CD-R, CD-RW, MP3-CD
Audio DAC	24 Bits / 44.1 kHz
Total Harmonic Distortion	<1%
Frequency Response	60 Hz -16 kHz (44.1 kHz)
S/N Ratio	>65 dBA

Tuner

Tuning Range	FM: 87.5 - 108 MHz DAB: 174.92 - 239.20 MHz
Tuning grid (FM)	50 KHz
Sensitivity	- Mono, 26dB S/N Ratio < 22 dBf - Stereo, 46dB S/N Ratio > 43 dBf
Search Selectivity	< 28 dBf
Total Harmonic Distortion	< 2%
Signal to Noise Ratio	>55 dB
Number of presets	30 (FM) 30 (DAB)

Speakers

Speaker Impedance	4 ohm
Speaker Driver	3.5"
Sensitivity	>82 dB/m/W

General information

AC power	230 - 240 V, 50 Hz
Operation Power Consumption	25 W
Standby Power Consumption	<2 W
Dimensions	
- Main Unit (W x H x D)	209 x 231 x 147 mm
- Speaker Box (W x H x D)	146 x 228 x 160 mm
Weight	
- Main Unit	1.95 kg
- Speaker Box	2 x 1.2 kg

Supported MP3 disc formats

- ISO9660, Joliet
- Maximum title number: 999 (depending on file name length)
- Maximum album number: 99
- Supported sampling frequencies: 32 kHz, 44.1 kHz, 48 kHz
- Supported Bit-rates: 32-256 (kbps), variable bit rates

12 Troubleshooting

Caution

- Never remove the casing of this apparatus.

To keep the warranty valid, never try to repair the system yourself.

If you encounter problems when using this apparatus, check the following points before requesting service. If the problem remains unsolved, go to the Philips web site (www.philips.com/welcome). When you contact Philips, ensure that the apparatus is nearby and the model number and serial number are available.

No power

- Ensure that the AC power cord of the unit is connected properly.
- Ensure that there is power at the AC outlet.
- As a power-saving feature, the system switches off automatically 15 minutes after track play reaches the end and no control is operated.

No sound or poor sound

- Adjust the volume.
- Disconnect the headphones.
- Check that the speakers are connected correctly.
- Check if the stripped speaker wires are clamped.

Left and right sound outputs reversed

- Check the speaker connections and location.

No response from the unit

- Disconnect and reconnect the AC power plug, then turn on the system again.

Remote control does not work

- Before you press any function button, first select the correct source with the remote control instead of the main unit.
- Reduce the distance between the remote control and the unit.

- Insert the battery with its polarities (+/- signs) aligned as indicated.
- Replace the battery.
- Aim the remote control directly at the sensor on the front of the unit.

No disc detected

- Insert a disc.
- Check if the disc is inserted upside down.
- Wait until the moisture condensation at the lens has cleared.
- Replace or clean the disc.
- Use a finalized CD or correct format disc.

Poor radio reception

- Increase the distance between the unit and your TV or VCR.
- Fully extend the antenna.

Timer does not work

- Set the clock correctly.
- Switch on the timer.

Clock/timer setting erased

- Power has been interrupted or the power cord has been disconnected.
- Reset the clock/timer.

About DAB

About Digital Audio Broadcasting (DAB)

DAB digital radio is a new way of broadcasting radio via a network of terrestrial transmitters.

It provides listeners with more choice and information delivered in crystal clear, crackle-free sound quality.

– The technology allows the receiver to lock on to the strongest signal it can find.

– With DAB digital stations there are no frequencies to remember, and sets are tuned by station name, so there's no returning on the move.

What is a multiplex?

Digital radio operation is made up of a single block of frequencies called a multiplex. Each multiplex works within a frequency spectrum, such as Band III for DAB broadcasts.

DAB BROADCASTERS AND DLS

Each DAB broadcaster (or multiplex operator) also provides text and audio data services.

Some programmes are supported by Dynamic Label Segments (DLS). This is data which you can read as scrolling text on your DAB radio display. Some stations transmit the latest news, travel, and weather; what's on now and next, website addresses and phone numbers.

For more information on digital radio coverage and services, please visit: www.drdb.org.



**PHILIPS CONSUMER LIFESTYLE
WARRANTY POLICY FOR AUSTRALIA**

Effective 1st July 2010

Philips provides its Consumer Electronics products with a 1 Year Manufacturers Warranty.

The benefits given to the purchaser by this warranty are in addition to all other rights and remedies, which the purchaser has in respect of the product under the Trade Practices Act or other Commonwealth or State Law.

The conditions contained in this warranty replace and override the provision of the Philips World-Wide Guarantee for products purchased in Australia and used in Australia.

Please record the following information for your records and keep in a safe place.

It is essential that you retain your original purchase receipt to make a warranty claim.

Model number :
Serial number :
Date of purchase :
Retailer :
Purchase Price :

If you require assistance with the operation of the product, its features or specifications, please call the **Philips Consumer Care Centre** on **1300 363 391** where support is provided by our trained staff.

If your product develops a fault during the 12 month warranty period and has a purchase price of less than \$250, please return the faulty product back to the place of purchase.

If your product develops a fault during the 12 month warranty period and has a purchase price of more than \$250, or if you would like to discuss a repair options for an out of warranty repair, please call **1300 361 392** for your nearest Philips Authorised Service Centre.

Conditions of Warranty

- a. For products with a purchase price of less than \$250, claims for warranty can only be made at the place of purchase. A copy of the purchase receipt will be required.
- b. For products with a purchase price of more than \$250, claims for warranty can only be made at a Philips Authorised Service Centre. A copy of the purchase receipt will be required.
- c. The warranty period is valid from the original date of purchase of the product.
- d. This warranty extends only to defects in material or workmanship occurring under normal use of the product when operated in accordance with the instructions.
- e. Philips may, at its discretion choose to repair or replace this product.
- f. If a replacement product is supplied, it is warranted for the remainder of the warranty period, from the original date of purchase.
- g. This Manufacturers Warranty is limited to 3 months for products used in commercial applications.
- h. Product accessories are covered by the same warranty period. If an accessory is faulty, please contact the Philips Consumer Care Centre on **1300 363 391**.
- i. This Manufacturers Warranty is neither transferable nor valid in countries other than Australia.

This Warranty does not cover:-

- a. Service costs arising from failure to correctly adjust the controls of the product or to observe the instructions, or inspections that reveal that the product is in normal working order.
- b. Product failures caused by misuse, neglect, accidental breakage, transit damage, repairs or modification by unauthorised persons, external fires, lightning strikes, floods, vermin infestation or liquid spillage.
- c. TV or radio signal reception problems, replacement of worn or used batteries or other consumables.
- d. Second hand or refurbished products.
- e. Products sold on the internet or online.
- f. Product failure, caused by other products.

Version 1.5: 1st July 2010

New Zealand - Guarantee and Service for New Zealand

Thank-you for purchasing this quality Philips product.

Philips New Zealand Ltd guarantees this product against defective components and faulty workmanship for a period of 12 months. Any defect in materials or workmanship occurring within 12 months from the date of purchase subject to the following conditions will be rectified free of charge by the retailer from whom this product was purchased.

Conditions

- 1.** The product must have been purchased in New Zealand. As proof of purchase, retain the original sales docket indicating the date of purchase.
- 2.** The guarantee applies only to faults caused by defective components, or faulty workmanship on the part of the manufacturer.
- 3.** The guarantee does not cover failures caused by misuse, neglect, normal wear and tear, accidental breakage, use on the incorrect voltage, use contrary to operating instructions, or unauthorised modification to the product or repair by an unauthorised technician.
- 4.** Reasonable evidence (in the form of a sales docket) must be supplied to indicate that the product was purchased no more than 12 months prior to the date of your claim.
- 5.** In the event of a failure, Philips shall be under no liability for any injury, or any loss or damage caused to property or products other than the product under guarantee.

This guarantee does not prejudice your rights under common law and statute, and is in addition to the normal responsibilities of the retailer and Philips.

How to claim

Should your Philips product fail within the guarantee period, please return it to the retailer from whom it was purchased. In most cases the retailer will be able to satisfactorily repair or replace the product.

However, should the retailer not be able to conclude the matter satisfactorily, or if you have other difficulties claiming under this guarantee, please contact

The Guarantee Controller

Philips New Zealand Ltd.

P.O. Box 41.021

Auckland

 **(09) 84 94 160**

fax  **(09) 84 97 858**



© 2011 Koninklijke Philips Electronics N.V.
All rights reserved.
DCB188_79_UM_V1.0

