

Always there to help you

Register your product and get support at
www.philips.com/support

BT4080



User manual

PHILIPS

Contents

1	Important	2
	Safety	2

2	Your Bluetooth speaker	3
	Introduction	3
	What's in the box	3
	Overview of the speaker	4

3	Get started	5
	Power supply	5

4	Use Bluetooth devices	6
	Connect a device	6
	Play from Bluetooth device	7
	Control your phone call	7
	Disconnect the Bluetooth-enabled device	7
	Connect another Bluetooth-enabled device	7
	Reconnect the Bluetooth device	7

5	Other features	8
	Listen to an external device	8
	Charge your mobile devices	8
	Adjust volume	8

6	Product information	9
	Specifications	9

7	Troubleshooting	10
	General	10
	About Bluetooth device	10

8	Notice	11
	Care of the environment	11
	Trademark notice	11

1 Important

Note

- The type plate is located on the bottom of the product.

Safety

Warning

- Never remove the casing of this speaker.
 - Never place this speaker on other electrical equipment.
 - Keep this speaker away from direct sunlight, naked flames or heat.
 - Make sure that you always have easy access to the power cord, plug, or adaptor to disconnect the speaker from the power.
-
- Make sure that there is enough free space around the speaker for ventilation.
 - Only use attachments/accessories specified by the manufacturer.
 - Unplug this apparatus during lightning storms or when unused for long periods of time.
 - Refer all servicing to qualified service personnel. Servicing is required when the apparatus has been damaged in any way, such as liquid has been spilled or objects have fallen into the apparatus, the apparatus has been exposed to rain or moisture, does not operate normally, or has been dropped.
 - Battery shall not be exposed to excessive heat such as sunshine, fire or the like.
 - Apparatus shall not be exposed to dripping or splashing.
 - Do not place any sources of danger on the apparatus (e.g. liquid filled objects, lighted candles).
 - Where the plug of the Direct Plug-in Adapter is used as the disconnect device, the disconnect device shall remain readily operable.

2 Your Bluetooth speaker

Congratulations on your purchase, and welcome to Philips! To fully benefit from the support that Philips offers, register your product at www.philips.com/welcome.

Introduction

With this speaker, you can

- enjoy audio from your Bluetooth-enabled devices, or other external audio devices; and
- charge your mobile devices.

What's in the box

Check and identify the contents of your package:

- Speaker
- Power adapter
- Short user manual

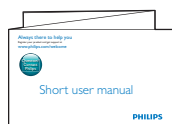
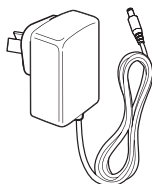
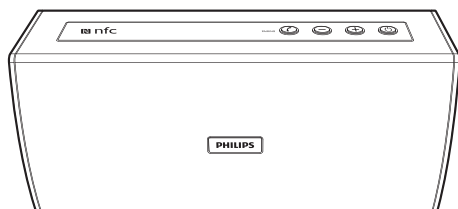

Overview of the speaker

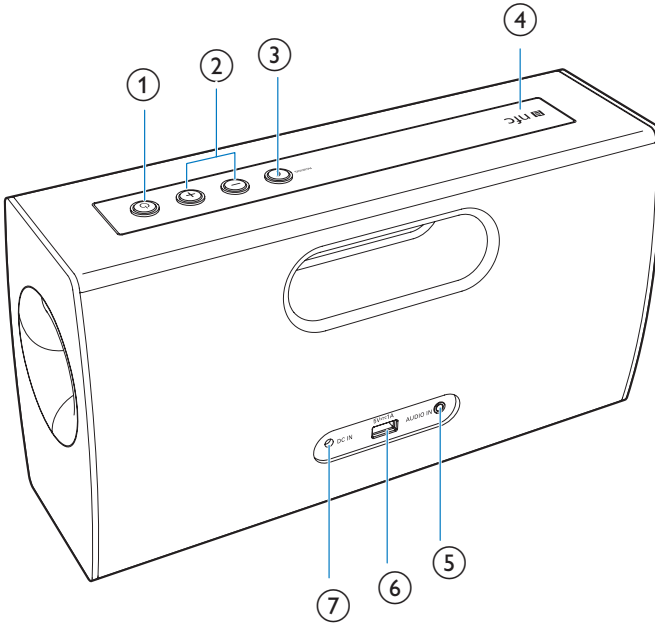

- ① **⏻**
 - Turn the speaker on or off.
- ② **+/-**
 - Adjust volume.
- ③ **📞 /PAIRING**
 - Answer or reject an incoming call.
 - End the current phone call.
 - Enter Bluetooth pairing mode.
- ④ **NFC**
 - Connect a device with NFC feature through Bluetooth.
- ⑤ **AUDIO IN**
 - Connect an external audio device.
- ⑥ **CHARGING 5V \equiv 1A**
 - Charge your mobile devices.
- ⑦ **DC IN**
 - Connect power.

3 Get started

Always follow the instructions in this chapter in sequence.

Power supply

The Bluetooth speaker can be powered by either AC mains or built-in battery.

Option 1: AC power

! Caution

- Risk of product damage! Make sure that the power voltage corresponds to the voltage printed on the back or underside of the speaker.

Connect the power adapter to:

- the **DC IN** socket on the speaker.
- the wall outlet.

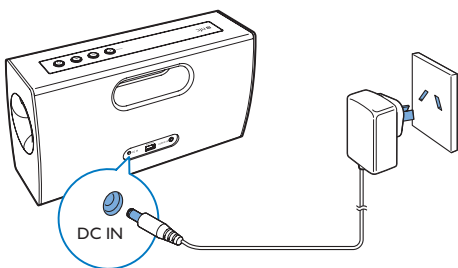

Option 2: Battery power

The speaker can operate on the built-in rechargeable battery.

≡ Note

- Rechargeable battery has a limited number of charge cycles. Battery life and number of charge cycles vary by use and settings.
- It takes approximately 6 hours to fully charge the battery.
- When battery is low or under charging, the LED indicator flashes red.

To recharge the built-in battery:

Connect the speaker to AC power supply.

Turn on

Press \odot to turn the speaker on.

↳ The LED indicator flashes blue.

≡ Note

- If battery is low, the LED indicator flashes red.

Turn off

Press \odot again to turn the speaker off.

≡ Note

- If the connection with Bluetooth devices or other external devices is invalid for 15 minutes, the speaker switches to standby mode automatically for power saving.

4 Use Bluetooth devices

With this speaker, you can listen to audio from Bluetooth-enabled devices and control the incoming call through Bluetooth.

Connect a device

Note

- Make sure that your Bluetooth device is compatible with this speaker.
- Before pairing a device with this speaker, read its user manual for Bluetooth compatibility.
- The speaker can memorize a maximum of four paired devices. The fifth paired device will replace the first one.
- Make sure that Bluetooth function is enabled on your device, and your device is set as visible to all other Bluetooth devices.
- The operational range between this speaker and a Bluetooth device is approximately 10 meters (30 feet).
- Any obstacle between this speaker and a Bluetooth device can reduce the operational range.
- Keep away from any other electronic device that may cause interference.

Option 1: Connect a device through NFC

Near Field Communication (NFC) is a technology that enables short-range wireless communication between various NFC compatible devices, such as mobile phones and IC tags.

If your Bluetooth device supports NFC, you can connect it with this speaker easily.

- 1 On your device, enable NFC and Bluetooth functions (refer to the user manual of the device).
- 2 Press ϕ on this speaker.
↳ The LED indicator flashes blue.

- 3 Touch the NFC tag on the top of the speaker with the NFC area of your Bluetooth device.

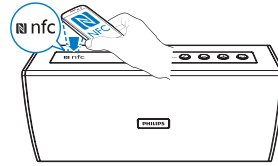

- 4 On your Bluetooth device, accept the pairing request with "PHILIPS BT4080". If necessary, input "0000" as the pairing password.
- 5 Follow the on-screen instructions to complete the pairing and connection.
↳ After successful connection, the speaker beeps twice, and the LED indicator turns solid blue.

Option 2: Connect a device manually

- 1 Press ϕ .
↳ The LED indicator flashes blue.
- 2 On your Bluetooth device, enable Bluetooth and search for Bluetooth devices that can be paired (see the user manual of the device).
- 3 When [Philips BT4080] is displayed on your device, select it to start pairing and connection. If necessary, input "0000" as the pairing password.
↳ After successful pairing and connection, the speaker beeps twice, and the LED indicator turns solid blue.
 - If you fail to find [Philips BT4080] for pairing, press and hold PAIRING for two seconds to enter pairing mode first.

LED indicator	Description
Flashing blue	Connecting; Waiting for pairing
Solid blue	Connected

Play from Bluetooth device

Note



- If there is an incoming call on the connected mobile phone, music play pauses.

After successful Bluetooth connection, play audio on the Bluetooth device.

- ↳ Audio streams from your Bluetooth device to the speaker.

Control your phone call

After Bluetooth connection, you can control an incoming call with this speaker.

Button	Function
	Press to answer an incoming call.
	Press and hold for two seconds to reject an incoming call.
	During a call, press to end the current call.

Note

- Music play pauses when there is an incoming call.

Disconnect the Bluetooth-enabled device

- Press and hold **PAIRING** for two seconds;
- Disable Bluetooth on your device; or
- Move the device beyond the communication range.
 - ↳ The LED indicator flashes.

Connect another Bluetooth-enabled device

- 1 Press and hold **PAIRING** for two seconds to disconnect the currently connected device;
 - ↳ The speaker enters Bluetooth pairing mode.
- 2 Connect another Bluetooth device.

Reconnect the Bluetooth device

- Next time when you turn on the speaker, it will reconnect the last connected device automatically; or
- On your Bluetooth device, select "**PHILIPS BT4080**" on your Bluetooth menu to start connection.

5 Other features

Listen to an external device

With this speaker, you can also listen to an external audio device such as an MP3 player.

Note

- Make sure that there is no Bluetooth connection, or music playback through Bluetooth is paused.

- 1 Connect an audio input cable (not supplied) with a 3.5 mm connector on both ends to
 - the **AUDIO IN** socket on this speaker, and
 - the headphone socket on the external device.

↳ The speaker switches to audio-in mode automatically.
- 2 Play audio on the external device (refer to its user manual).

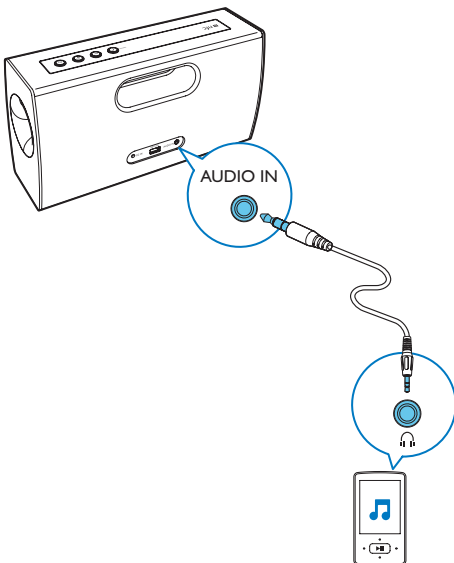

Charge your mobile devices

You can charge your mobile devices through the USB socket.

Note

- The USB socket is for charging only.

- 1 Connect this speaker to AC power.
- 2 Connect this speaker to your mobile device with a USB cable (not supplied).
 - ↳ Once the device is recognized, the charging starts.

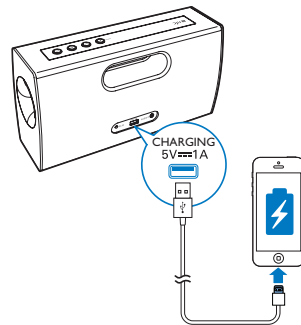

Adjust volume

During play, press + or - repeatedly to increase or decrease the volume level.

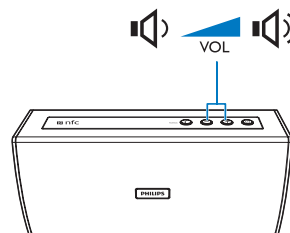

Tip

- To increase or decrease volume continuously, press and hold + or - for 2 seconds.
- When the volume reaches the maximum or minimum, the LED indicator flashes twice.

6 Product information



Note

- Product information is subject to change without prior notice.

Specifications

Amplifier

Rated Output Power	2 X 10 W RMS
Frequency Response	80 -16000 Hz, ± 3 dB
Signal to Noise Ratio	>67 dBA
Audio-in Input	600 mV RMS 20 kohm

Bluetooth

Bluetooth Version	V4.0
Supported Profiles	HFP,A2DP,AVRCP
Bluetooth Frequency Brand	2.4 GHz ~ 2.48 GHz
Bluetooth Range	10 m (Free space)

Speakers

Speaker Impedance	8 ohm
Speaker Driver	7cm full range
Sensitivity	>84dB/m/W \pm 3dB/m/W

General information

Power Supply	
- AC Power (Power Adapter)	Brand name: PHILIPS; Model: ASSA32-150240;
	Input: 100-240V~, 50/60 Hz, 1 A; Output: 15 V \equiv 2.4 A;
- Battery (Built-in)	11.1 V, 1500 mAh
Operation Power Consumption	12.5 W (with 1A charging loader)
Eco Standby Power Consumption	< 0.5 W
Charging current and voltage	5V, 1A
Dimensions - Main Unit (W x H x D)	300 x 163 x 96 mm
Weight - Main Unit	1.9 kg

7 Troubleshooting



Warning

- Never remove the casing of this device.

To keep the warranty valid, never try to repair the system yourself.

If you encounter problems when using this device, check the following points before requesting service. If the problem remains unsolved, go to the Philips Web page (www.philips.com/support). When you contact Philips, make sure that the device is nearby and the model number and serial number are available.

General

No power

- Make sure that the AC power plug of the speaker is connected properly.
- Make sure that there is power at the AC outlet.
- Recharge the built-in battery.

No sound or poor sound

- Adjust volume on the product.
- Adjust volume on the connected device.

No response from the speaker

- Restart the speaker.

The LED indicator flashes blue for 5 times, and the speaker has no response when pressing any key.

- The speaker is in DEMO mode. Press and hold  for 15 seconds to exit this mode.

About Bluetooth device

The audio quality is poor after connection with a Bluetooth-enabled device.

- The Bluetooth reception is poor: Move the device closer to this product or remove any obstacle between them.

Cannot connect with the device.

- The Bluetooth function of the device is not enabled. Refer to the user manual of the device for how to enable the function.
- This product is already connected with another Bluetooth-enabled device. Disconnect that device and then try again.

The paired device connects and disconnects constantly.

- The Bluetooth reception is poor: Move the device closer to this product or remove any obstacle between them.
- For some devices, Bluetooth connection may be deactivated automatically as a power-saving feature. This does not indicate any malfunction of this product.

8 Notice

Any changes or modifications made to this device that are not expressly approved by Gibson Innovations may void the user's authority to operate the equipment.

Care of the environment

Disposal of your old product



Your product is designed and manufactured with high quality materials and components, which can be recycled and reused. Do not throw away the product with the normal household waste at the end of its life, but hand it in at an official collection point or recycling. By doing this, you help to preserve the environment.

Caution

- Removal of the built-in battery invalidates the warranty and may destroy the product.

Always bring your product to a professional to remove the built-in battery.

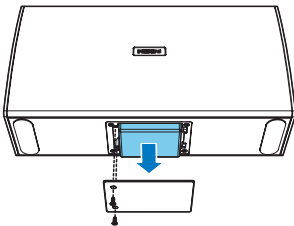

Environmental information

All unnecessary packaging has been omitted. We have tried to make the packaging easy to separate into three materials: cardboard (box), polystyrene foam (buffer) and polyethylene (bags, protective foam sheet.) Your system consists of materials which can be recycled and reused if disassembled by a specialized company. Please observe the local regulations regarding the disposal of packaging materials, exhausted batteries and old equipment.

Trademark notice



The Bluetooth® word mark and logos are registered trademarks owned by Bluetooth SIG, Inc. and any use of such marks by Gibson Innovations Limited is under license. Other trademarks and trade names are those of their respective owners.



The 'N' Mark is a trademark or registered trademark of NFC Forum, Inc. in the United States and in other countries.



This is CLASS II apparatus with double insulation, and no protective earth provided.



Specifications are subject to change without notice.

2015 © Gibson Innovations Limited. All rights reserved.

This product has been manufactured by, and is sold under the responsibility of Gibson Innovations Ltd., and Gibson Innovations Ltd. is the warrantor in relation to this product. Philips and the Philips Shield Emblem are registered trademarks of Koninklijke Philips N.V. and are used under license from Koninklijke Philips N.V.

BT4080_98_UM_V1.0

