

Register your product and get support at

www.philips.com/welcome

AS111



User manual

PHILIPS

Contents

1	Important	2
----------	------------------	----------

2	Your Docking Speaker for Android™	3
	Introduction	3
	What's in the box	3
	Overview of main unit	3

3	Get started	4
	Connect power	4
	Turn on	4
	Set time	4
	Adjust brightness of display panel	4
	Adjust brightness of night light	4

4	Play and charge	6
	Compatible with Android™	6
	Play audio through manual Bluetooth connection	6
	Play audio through auto Bluetooth connection with Philips DockStudio	7
	Dock and charge Android-powered phone	12
	Play audio with Philips Songbird	14

5	Use more features with DockStudio	17
	Listen to Internet radio	17
	Set sleep timer	17
	Set alarm timer	18

6	Product information	20
	Specifications	20

7	Troubleshooting	21
----------	------------------------	-----------

8	Notice	22
	Recycling	22

1 Important

- Read these instructions.
- Heed all warnings.
- Follow all instructions.
- Do not block any ventilation openings. Install in accordance with the manufacturer's instructions.
- Do not install near any heat sources such as radiators, heat registers, stoves, or other apparatus (including amplifiers) that produce heat.
- Protect the power cord from being walked on or pinched, particularly at plugs, convenience receptacles, and the point where they exit from the unit.
- Only use attachments/accessories specified by the manufacturer.
- Unplug this unit during lightning storms or when unused for long periods of time.
- Refer all servicing to qualified service personnel. Servicing is required when the unit has been damaged in any way, such as power-supply cord or plug is damaged, liquid has been spilled or objects have fallen into the unit, the unit has been exposed to rain or moisture, does not operate normally, or has been dropped.
- This unit shall not be exposed to dripping or splashing.
- Do not place any sources of danger on the unit (e.g. liquid filled objects, lighted candles).
- Where the plug of the Direct Plug-in Adapter is used as the disconnect device, the disconnect device shall remain readily operable.

2 Your Docking Speaker for Android™

Congratulations on your purchase, and welcome to Philips! To fully benefit from the support that Philips offers, register your product at www.philips.com/welcome.

Introduction

With this docking speaker, you can:

- enjoy audio from your Bluetooth-enabled device;
- charge your device through micro USB connector;
- Know the time; and
- experience various features brought by **Philips DockStudio** and **Philips Songbird** app.

What's in the box

Check and identify the contents of your package:

- Main unit
- Power adapter
- Dock extension
- Quick start guide
- Safety sheet

Overview of main unit

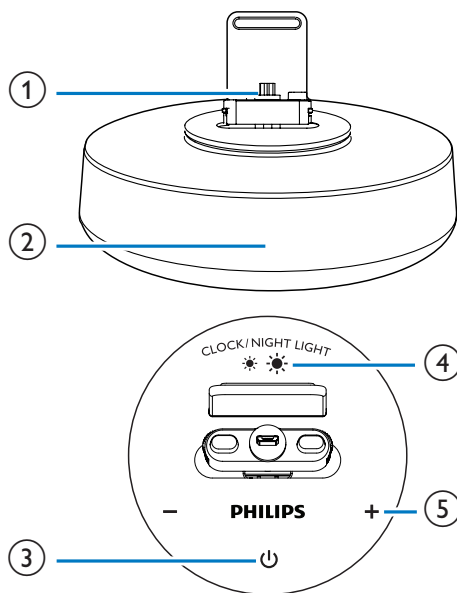

- ① Dock for Android-powered phone
- ② Display panel
 - Show time.
 - Show Bluetooth status.
- ③
 - Activate or deactivate Bluetooth function.
- ④ **CLOCK/NIGHT LIGHT**
 - Set time.
 - Adjust the brightness of display panel and night light.
- ⑤ +/-
 - Adjust volume.
 - Adjust time.

3 Get started

Always follow the instructions in this chapter in sequence.

Connect power

! Caution

- Risk of product damage! Ensure that the power voltage corresponds to the voltage printed on the back or underside of the unit.
- Risk of electric shock! When you unplug the AC adapter; always pull the plug from the socket. Never pull the cord.

Connect the power adapter to the wall outlet.

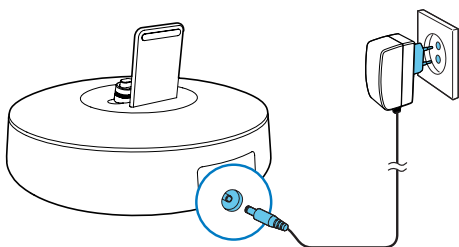

Turn on

Press \odot .

- ↳ The Bluetooth indicator \ast begins to blink.

Switch to standby mode

Press \odot again to switch the docking speaker to standby mode.

- ↳ The Bluetooth indicator \ast turns off.

Set time

- 1 In standby mode, press and hold **CLOCK/NIGHT LIGHT** for two seconds to activate clock setting mode.
↳ [24H] begins to blink.
- 2 Press +/- to set the 12/24 hour format.
- 3 Press **CLOCK/NIGHT LIGHT** to confirm.
↳ The hour digits begin to blink.
- 4 Repeat steps 2 to 3 to set the hour and minute.
↳ The set time is displayed.

Adjust brightness of display panel

In standby mode, press **CLOCK/NIGHT LIGHT** repeatedly to adjust the brightness of the display panel: high, medium, or low.

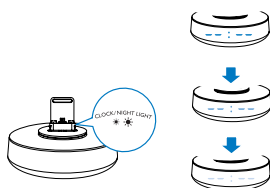

Adjust brightness of night light

- 1 Press \odot to turn on the speaker.

- 2 Press **CLOCK/NIGHT LIGHT** repeatedly to adjust the brightness of the night light: high, medium, or off.

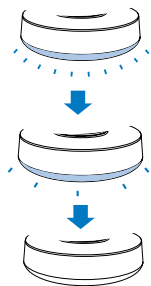
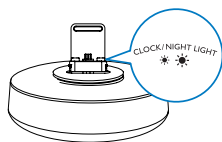

4 Play and charge

With this docking speaker, you can enjoy audio in two ways:

- through manual Bluetooth connection;
- through automatic Bluetooth connection with **Philips DockStudio** app.

Compatible with Android™

To make full use of your docking speaker, your Android-powered device should satisfy the following requirements:

- With Android operation system (Version 2.1 or above);
- With Bluetooth software (Version 2.1 or above); and
- With a micro USB connector.

For other devices with micro USB connector and Bluetooth function, you can still use the docking speaker to do the following:

- Charge your device through the USB connector;
- Enjoy audio through Bluetooth.

Tip



- For more details, go to www.philips.com/flexidock.

Play audio through manual Bluetooth connection

The docking speaker uses Bluetooth wireless technology to stream music from your portable device to the system.

Note

- Before you connect a Bluetooth device to this docking speaker, familiarize yourself with the Bluetooth capabilities of the device.
- Keep this docking speaker away from other electronic devices that may cause interference.

- 1 On your docking speaker, press  to activate Bluetooth.
↳ The Bluetooth indicator  blinks on the display panel.
- 2 Turn on Bluetooth function of your portable device.
 - Different devices may have different way to activate Bluetooth.

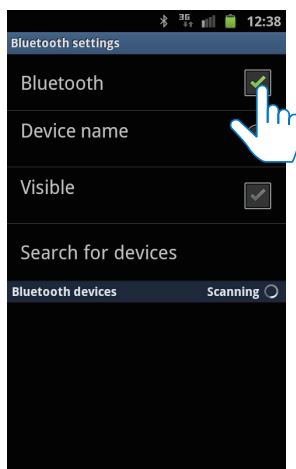

- 3 Scan Bluetooth devices that can pair with your portable device.
- 4 When **[PHILIPS AS111]** is displayed on your device, select it to start connection.
↳ If connection is successful, you will hear double beep confirmation tone and find a different Bluetooth icon on the top of the screen.

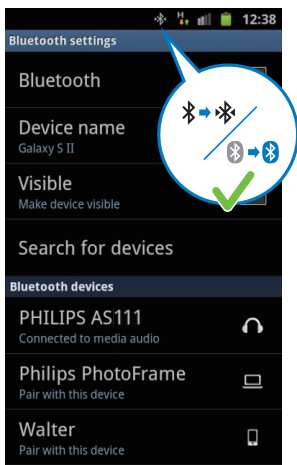

- 5 Play audio with the media player of your portable device.

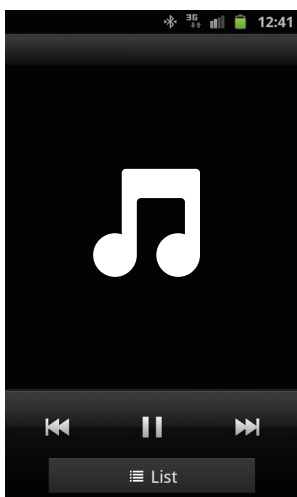

↳ The audio comes out through the docking speaker.

Tip

- The effective operation range between the docking speaker and the paired device is approximately 10 meters (30 feet).
- Any obstacle between the speaker and the device can reduce the operational range.

Play audio through auto Bluetooth connection with Philips DockStudio

Philips DockStudio app brings a suite of new features to your docking speaker; including automatic Bluetooth connection, Songbird music player; Internet radio and a multi-function alarm clock. To enjoy more features, you are recommended to download and install the free app.

Install DockStudio app onto Android-powered device

You have two ways to install **Philips DockStudio** on your Android-powered device.

Install DockStudio app through QR code

Note

- Make sure that your Android-powered device is connected to the Internet.
- Make sure that your device has a barcode scanner such as "QR Droid". If not, download one from the Android market.

- 1 Use the barcode scanner to scan the QR code on the package or Quick Start Guide.



- 2 Follow the on-screen instructions to install Philips DockStudio app.

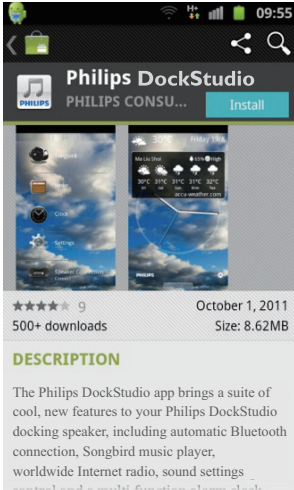

- 3 When installation is complete, tap [Done] (done).

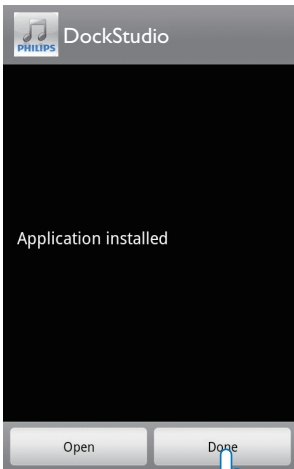

↳ The **DockStudio** icon appears on your portable device.

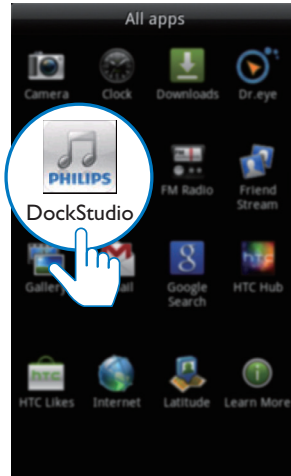

Install DockStudio app through Android Market

You can also search **Philips DockStudio** from Android Market directly, and then install the app.

Note

- Make sure that your Android-powered device is connected to the internet.
- Make sure that Android Market is available on your Android-powered device.

- 1 Tap the "Android Market" icon on your device.



- 2 Tap the search icon on the screen.

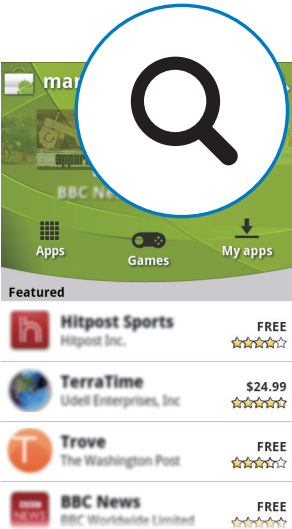

- 3 In the search bar, type in "Philips DockStudio" to search the app.
- 4 From the search result list, find and tap **Philips DockStudio** to start downloading.
- 5 Follow the on-screen instructions to install the **DockStudio** app.

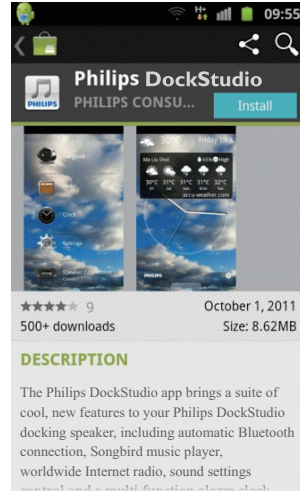

- 6 When installation is complete, tap **[Done]** (done).

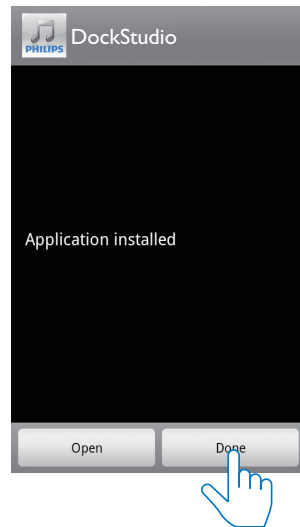

Activate Bluetooth with DockStudio app

Philips DockStudio app helps to connect your Android-powered device and docking speaker through Bluetooth automatically.

Note

- Make sure that your Android-powered device is connected to the Internet.

First-time launch

- 1 On your docking speaker, press ϕ to activate Bluetooth.
↳ ϕ blinks on the display panel.
- 2 On the home screen of your device, tap the **DockStudio** icon to launch the app.



↳ A prompt message asking you to download **Songbird** appears.

- 3 Tap **[Cancel]** (cancel).

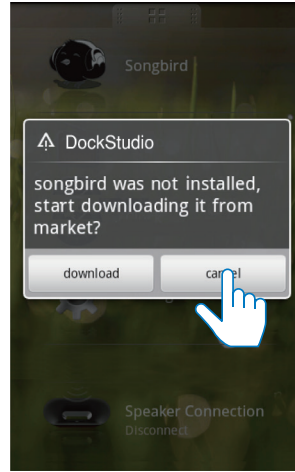

↳ The device starts to scan Philips devices that can be paired automatically.

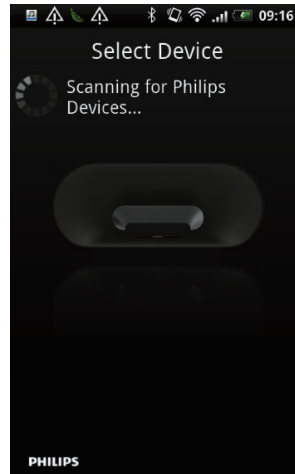

- 4 When **[PHILIPS AS111]** is displayed on your device, select it to start connection.
↳ It may take a few seconds to complete the connection.



- ↳ After Bluetooth connection, a different Bluetooth icon can be found on the top of the screen.

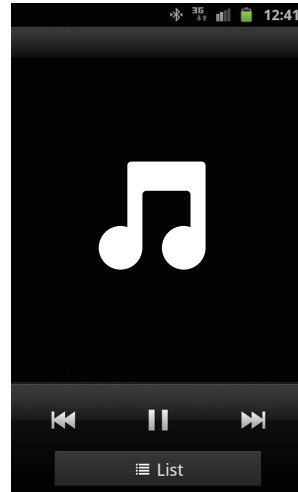

- ↳ Now you can enjoy audio through the speaker.

Next-time launch

Next time you launch the **DockStudio** app, connect to the docking speaker through Bluetooth as below.

- 1 Activate the Bluetooth function of your docking speaker.
- 2 Launch **Philips DockStudio** to access its menu.

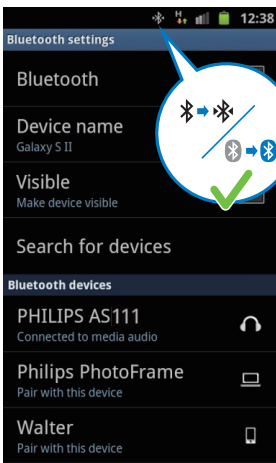

- 5 Play audio with the media player of your portable device.



- 3 Tap **[Speaker Connection]** (Speaker Connection) to activate automatic Bluetooth connection.

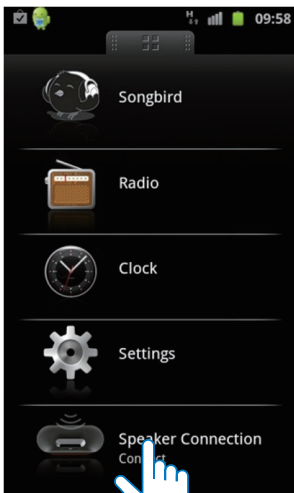

↳ It may take a few seconds to complete the connection.

- 4 Play audio on your portable device.

↳ The audio comes out through the docking speaker.

Sync time automatically

After you activate Bluetooth connection through **Philips DockStudio**, the docking speaker synchronizes time with your Bluetooth-enabled device automatically.

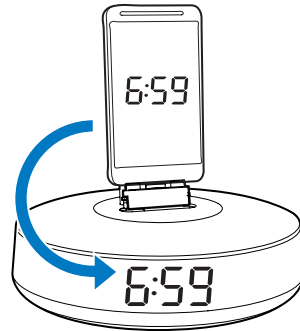

Dock and charge Android-powered phone

Dock Android-powered device

To charge your Android-powered phone, you need to dock it in the docking speaker first.

- 1 Check the orientation of the micro USB connector on your Android-powered phone. If your USB connector has a cover, flip it outwards.
- 2 If necessary, rotate the USB connector on the docking speaker, and then place your Android-powered phone onto the dock.

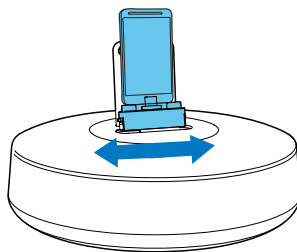
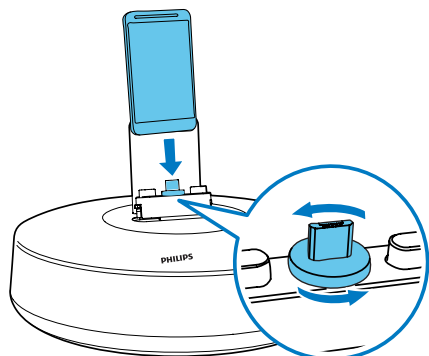

Tip

- If the micro USB connector is located at the top, and you are using Android system of version 2.3 or above, screen auto-rotation is available.

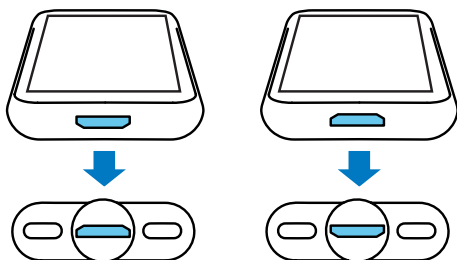

PHILIPS

PHILIPS

- 3** Adjust the bumpers on both sides of the connector to stabilize the phone.

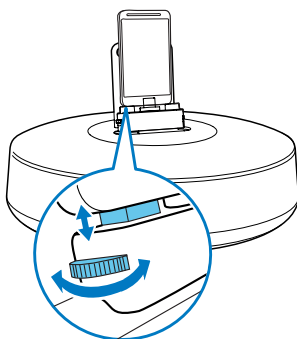

- 4** Slide the connector to place your phone in the middle of the docking speaker.

Use dock extension

If the USB connector on your phone is close to the edge, the supplied dock extension can balance the docked phone, as illustrated.

- 1** Adjust the bumpers on both sides to the lowest position.
- 2** Place the dock extension onto the dock.
- 3** Dock your Android-powered device.

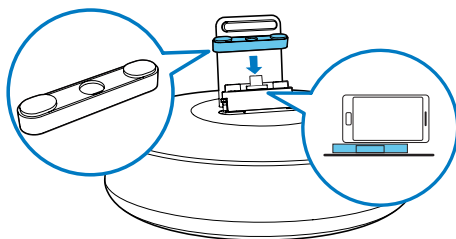

Charge Android-powered phone

When the docking speaker is connected to power, the docked phone starts charging automatically.

Tip

- This function is also available for non Android-powered device that has a micro USB connector.

Play audio with Philips Songbird

Philips Songbird is a simple, easy-to-use PC program and Android app. It lets you discover, play and sync your media from PC to your Android-powered devices seamlessly.

Install Songbird on Android-powered device

- 1 Tap the **DockStudio** icon on your Android-powered device.



↳ The **DockStudio** menu is displayed.



- 2 Tap **[Songbird]**.

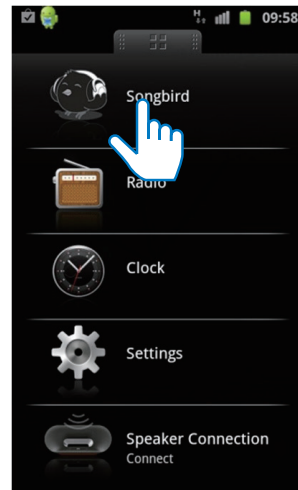

↳ You are requested to download **Songbird**.

- 3 Follow the on-screen instructions to download the app.

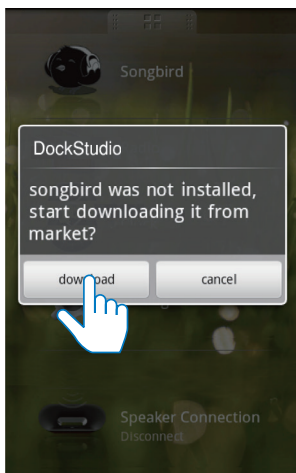

- 4 After installation, tap **[Open]** (Open) to access **Songbird** menu.

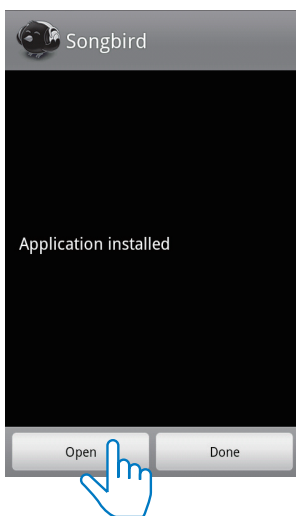

- 5 Select a track, and then tap ► to play music.

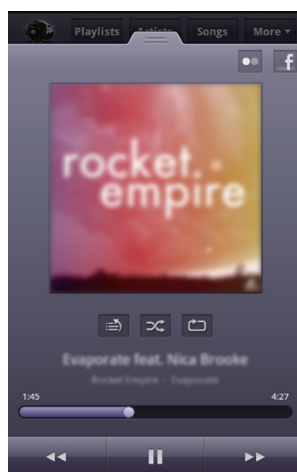
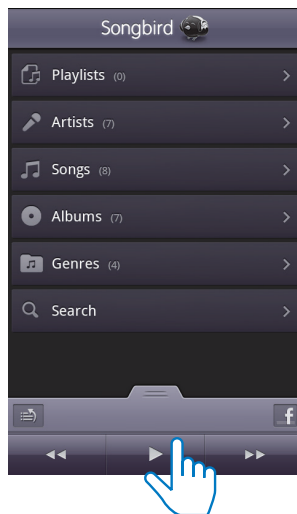

Install Songbird on PC

- 1 Go to www.philips.com/songbird.
- 2 Search **Songbird**.

songbird

- 3 Download the latest **Songbird** application.

- 4 Follow on-screen instructions to install **Philips Songbird** on your PC.

Sync with PC through Philips Songbird

Note

- Make sure that you have turned on the USB storage.

- 1 On your PC, launch **Philips Songbird**.
- 2 Connect your Android-powered device to PC with a USB cable. Wait until the device is recognized by the **Songbird**.
 - ↳ On **Philips Songbird**, the device is displayed when it is recognized by the PC.

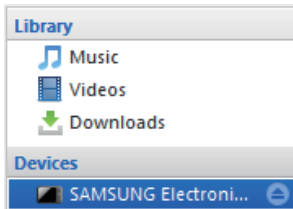

- ↳ If it is the first time you connect the device to **Philips Songbird**, a pop-up screen appears. Select auto sync as prompted.

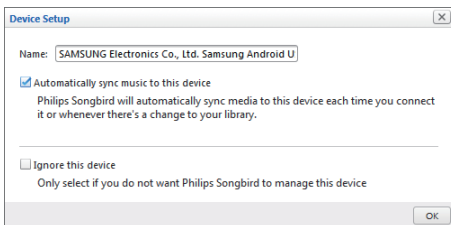

- ↳ The device synchronizes with **Philips Songbird** automatically.

If you didn't select auto sync, you can sync with **Songbird** manually.

- 1 Select the device under **Devices**.

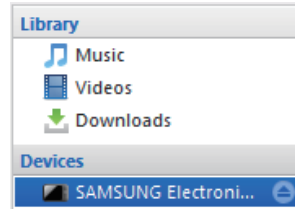

- 2 Select **Manual** or **Auto**.

Audio Syncing: |

- 3 Click **Sync**.
 - ↳ If you have selected auto sync, auto sync starts automatically when you connect the device to the PC.

5 Use more features with DockStudio

With **Philips DockStudio**, you can also listen to Internet radio, set alarm timer and sleep timer.

Note

- Make sure that your portable device is connected to the Internet.

Listen to Internet radio

- 1 Connect your Android-powered device and the docking system through Bluetooth.
- 2 Open **Philips DockStudio** to go to the main menu.
- 3 Tap **[Radio]** (Radio) on the screen.

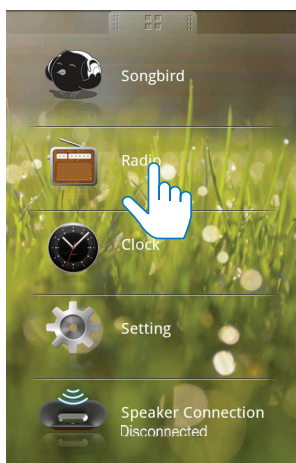

- 4 Search a radio station in the search bar.

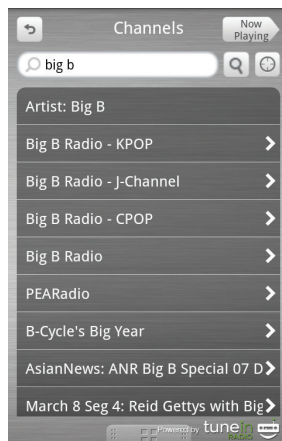

- 5 Select a radio station from the search result list.
 - ↳ The radio station begins to broadcast.

Set sleep timer

- 1 Launch **Philips DockStudio**.

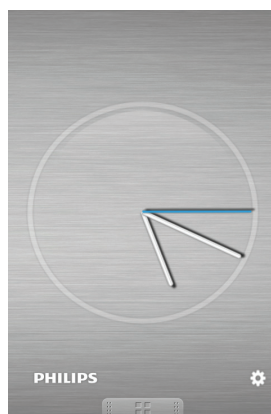

- 2 Tap the icon **⚙** to access the sleep timer menu.

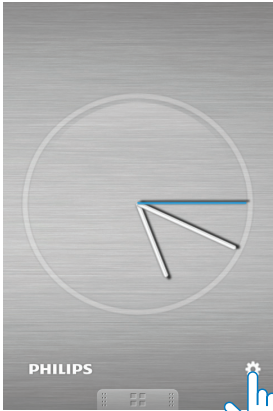

- 3 Select a time period for the sleep timer, and then tap **[Start]** (Start).

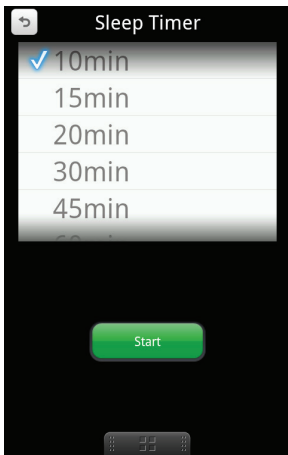

Note

- This function only works with **Philips Songbird**.

alerts you when weather conditions are suitable for your favorite outdoors activity.

- 1 Launch the app.

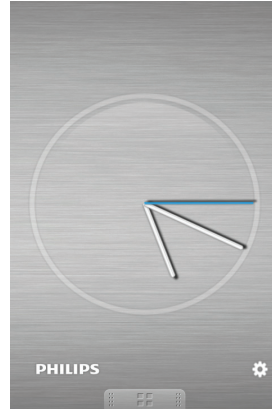

- 2 Tap the icon ***** to access clock setting menu.

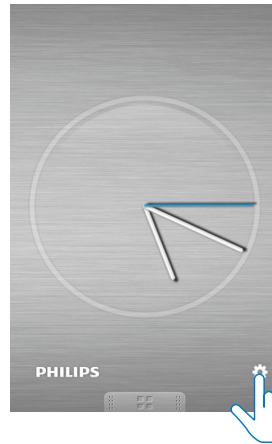

- 3 Tap **[Alarm settings]** (Alarm settings).

Set alarm timer

With **Philips DockStudio**, you can set multiple alarms and know the latest weather. It even

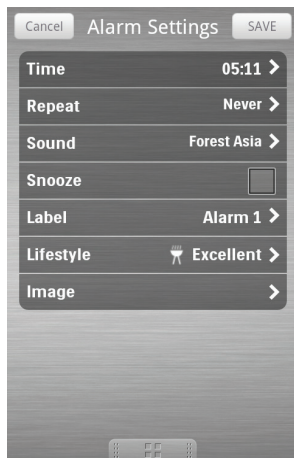

- 4 Tap **+** to access alarm setting menu.

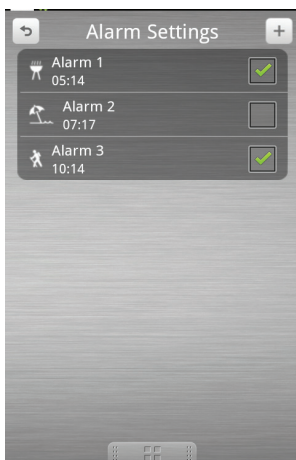

- 5 Set the alarm, and tap **[Save]** (Save) on the top right of the screen.
- ↳ The new alarm is saved and displayed on the screen.

Note

- From the **[Lifestyle]** (Lifestyle) tab, you can select your preferred sport and weather (excellent, good, or fair). The alarm will not ring if the weather is not good enough.

6 Product information

Dimensions - Main Unit (W x H x D)	171 X 102.6 X 171 mm
Weight - Main Unit	0.605 kg



Note

- Product information is subject to change without prior notice.

Specifications

Amplifier

Rated Output Power 2 X 2 W RMS

Signal to Noise Ratio 75 dBA

General information

AC Power (Power Adaptor) AS150-059-AA240(Philips); AS150-059-AI240(Philips); AS150-059-AE240(Philips);
Input: 100-240 V~, 50/60 Hz, 0.7 A;
Output: 5.9 V \equiv 2.4 A
S018KU0590240 (Philips);
S018KV0590240 (Philips);
S018KB0590240 (Philips);
S018KS0590240 (Philips);
Input: 100-240V~, 50/60Hz, 500mA;
Output: 5.9 V \equiv 2.4 A

Operation Power 8 W

Consumption Standby Power Consumption <1W

Charging (through micro USB connector) Max. 1A

7 Troubleshooting



Warning

- Never remove the casing of this device.

To keep the warranty valid, never try to repair the system yourself.

If you encounter problems when using this device, check the following points before requesting service. If the problem remains unsolved, go to the Philips Web page (www.philips.com/support). When you contact Philips, make sure that the device is nearby and the model number and serial number are available.

No power

- Make sure that the AC power adaptor of the device is connected properly.
- Make sure that there is power at the AC outlet.

No sound or poor sound

- Adjust the volume of the docking system.
- Adjust the volume of your phone.

No response from the unit

- Disconnect and reconnect the AC power plug, then turn on the unit again.

8 Notice

Any changes or modifications made to this device that are not expressly approved by WOOX Innovations may void the user's authority to operate the equipment.

C € 2150

This product complies with the radio interference requirements of the European Community.

Hereby, WOOX Innovations declares that this product is in compliance with the essential requirements and other relevant provisions of Directive 1999/5/EC. You can find the Declaration of Conformity on www.philips.com/support.

Recycling



Your product is designed and manufactured with high quality materials and components, which can be recycled and reused.

When you see the crossed-out wheel bin symbol attached to a product, it means the product is covered by the European Directive 2002/96/EC:



Never dispose of your product with other household waste. Please inform yourself about the local rules on the separate collection of electrical and electronic products. The correct disposal of your old product helps prevent potentially negative consequences on the environment and human health.

Environmental information

All unnecessary packaging has been omitted. We have tried to make the packaging easy to separate into three materials: cardboard (box), polystyrene foam (buffer) and polyethylene (bags, protective foam sheet.)

Your system consists of materials which can be recycled and reused if disassembled by a specialized company. Please observe the local regulations regarding the disposal of packaging materials, exhausted batteries and old equipment.



This is CLASS II apparatus with double insulation, and no protective earth provided.

 **Be responsible
Respect copyrights**

The making of unauthorized copies of copy-protected material, including computer programs, files, broadcasts and sound recordings, may be an infringement of copyrights and constitute a criminal offence. This equipment should not be used for such purposes.

Note

- The type plate is located on the bottom of the apparatus.

The Bluetooth® word mark and logos are registered

trademarks owned by Bluetooth SIG, Inc. and any use of such marks by WOOX Innovations is under license.





Specifications are subject to change without notice
2013 © WOOX Innovations Limited. All rights reserved.
This product was brought to the market by WOOX
Innovations Limited or one of its affiliates, further referred
to in this document as WOOX Innovations, and is the
manufacturer of the product. WOOX Innovations is the
warrantor in relation to the product with which this booklet
was packaged. Philips and the Philips Shield Emblem are
registered trademarks of Koninklijke Philips N.V.

