

User manual

Manual do usuário

Manual del usuario



# PHILIPS

## México



Es necesario que lea cuidadosamente su instructivo de manejo.

	<b>PRECAUCIÓN - ADVERTENCIA</b>	
	No abrir, riesgo de choque eléctrico	
	<b>ATENCIÓN</b>	
	Verifique que el voltaje de alimentación sea el requerido para su aparato	
Para evitar el riesgo de choque eléctrico, no quite la tapa. En caso de requerir servicio, dirijase al personal calificado.		

Descripción: **Minisistema de Audio**  
Modelo : **MCM299/55**  
Alimentación: **110-127 / 220-240V~; 50-60 Hz**  
Consumo: **60W**  
Importador: **Philips Mexicana, S.A. de C.V.**  
Domicilio: **Av. La Palma No.6**  
**Col. San Fernando La Herradura**  
**Huixquilucan**  
Localidad y Tel: **Edo. de México C.P. 52784**  
**Tel.52 69 90 00**  
Exportador: **Philips Electronics HK, Ltd.**  
País de Origen: **China**  
Nº de Serie: \_\_\_\_\_

**LEA CUIDADOSAMENTE ESTE INSTRUCTIVO  
ANTES DE USAR SU APARATO.**

### AVISO IMPORTANTE

*Philips Mexicana, S.A. de C.V. no se hace responsable por daños o desperfectos causados por:*

- Maltrato, descuido o mal uso, presencia de insectos o roedores (cucarachas, ratones etc.).*
- Cuando el aparato no haya sido operado de acuerdo con el instructivo del uso, fuera de los valores nominales y tolerancias de las tensiones (voltaje), frecuencia (ciclaje) de alimentación eléctrica y las características que deben reunir las instalaciones auxiliares.*
- Por fenómenos naturales tales como: temblores, inundaciones, incendios, descargas eléctricas, rayos etc. o delitos causados por terceros (choques asaltos, riñas, etc.).*

### CAUTION

*Use of controls or adjustments or performance of procedures other than herein may result in hazardous radiation exposure or other unsafe operation.*

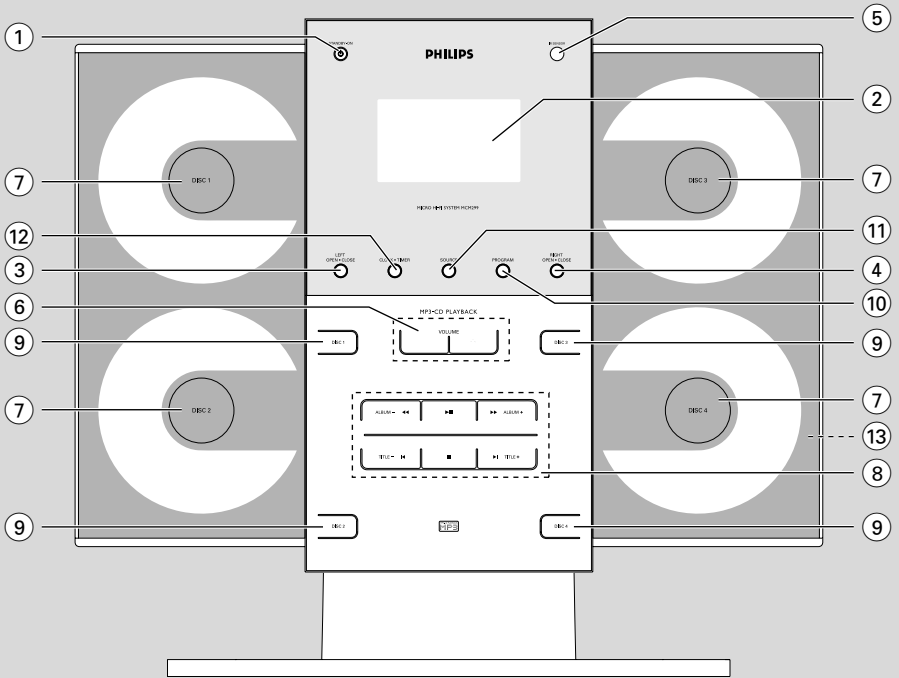

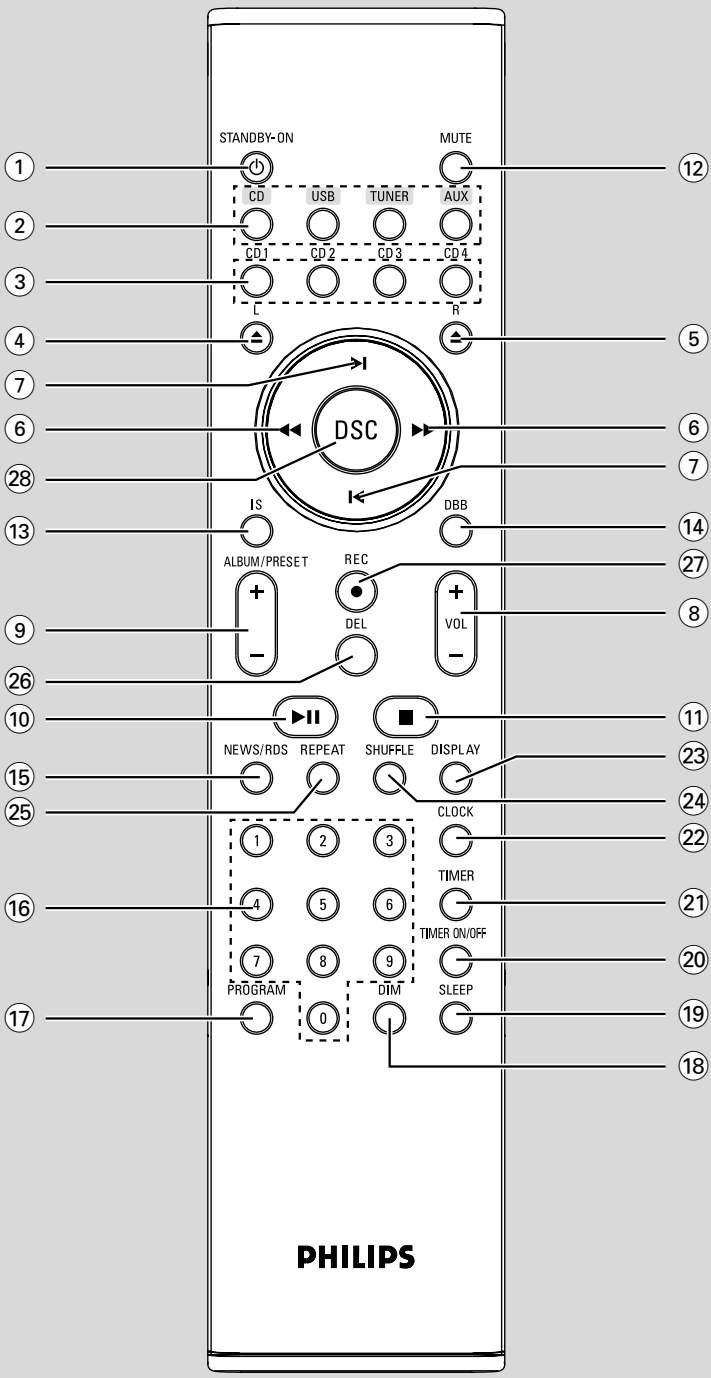

**PHILIPS**

# Index

---

English ..... 6

Español ..... 30

Português ..... 54

English

Español

Português

# Contents

---

## General Information

Environmental information .....	7
Supplied accessories .....	7
Safety information .....	7

---

## Preparations

Rear connections .....	8~9
Placing the set and speakers .....	9
Optional connection .....	9
Connecting other equipment to your system	
Inserting batteries into the Remote Control ...	
.....	10
Using the Remote Control to operate the Player	

---

## Controls

Controls on the system .....	11
Controls on the remote .....	11~12

---

## Basic Functions

Switching the system on .....	13
Power Saving Automatic Standby .....	13
Adjusting volume and sound .....	13
Dimming the display screen .....	13

---

## CD/MP3-CD Operation

Discs for playback .....	14
About MP3 disc .....	14
Loading a disc .....	14
Basic playback controls .....	15~16
Different play modes: SHUFFLE and REPEAT ...	
.....	16
Programming track numbers .....	16
Erasing the programme .....	16

---

## Radio Reception

Tuning to radio stations .....	17
Programming radio stations .....	17~18
Automatic programming	
Manual programming	
Tuning to preset radio stations .....	18
Changing tuning grid .....	18

---

## Clock/Timer

Clock setting .....	19
Timer setting .....	19~20
Sleep timer setting .....	20

---

## Specifications

---

## Maintenance

---

## Troubleshooting

---

## Appendix

## **IMPORTANT!**

**PLEASE NOTE THAT THE VOLTAGE SELECTOR LOCATED AT THE REAR OF THIS SYSTEM IS PRESET AT 220V FROM THE FACTORY. FOR COUNTRIES THAT OPERATE AT 110V-127V, PLEASE ADJUST TO 110V-127V BEFORE YOU SWITCH ON THE SYSTEM.**

## **Environmental Information**

All unnecessary packaging has been omitted. We have tried to make the packaging easy to separate into three materials: cardboard (box), polystyrene foam (buffer) and polyethylene (bags, protective foam sheet).

Your system consists of materials which can be recycled and reused if disassembled by a specialized company. Please observe the local regulations regarding the disposal of packaging materials, exhausted batteries and old equipment.

## **Supplied accessories**

- 2 speaker boxes
- remote control (with battery)
- MW loop antenna
- FM wire antenna
- 15-pin D-Sub cable
- stands for the main set and speakers
- wall mounting kit

## **Safety Information**

- Before operating the system, check that the operating voltage indicated on the typeplate (or the voltage indication beside the voltage selector) of your system is identical with the voltage of your local power supply. If not, please consult your dealer:
- Place the system on a flat, hard and stable surface.
- Place the system in a location with adequate ventilation to prevent internal heat build-up in your system. Allow at least 10 cm (4 inches) clearance from the rear and the top of the unit and 5 cm (2 inches) from each side.
- The ventilation should not be impeded by covering the ventilation openings with items, such as newspapers, table-cloths, curtains, etc.
- Do not expose the system, batteries or discs to excessive moisture, rain, sand or heat sources caused by heating equipment or direct sunlight.
- No naked flame sources, such as lighted candles, should be placed on the apparatus.
- No objects filled with liquids, such as vases, shall be placed on the apparatus.
- Install this unit near the AC outlet and where the AC power can be reached easily.
- If the system is brought directly from a cold to a warm location, or is placed in a very damp room, moisture may condense on the lens of the disc unit inside the system. Should this occur, the CD player would not operate normally. Leave the power on for about one hour with no disc in the system until normal playback is possible.
- The mechanical parts of the set contain self-lubricating bearings and must not be oiled or lubricated.
- **When the system is switched to Standby mode, it is still consuming some power. To disconnect the system from the power supply completely, remove the AC power plug from the wall socket.**

# Preparations

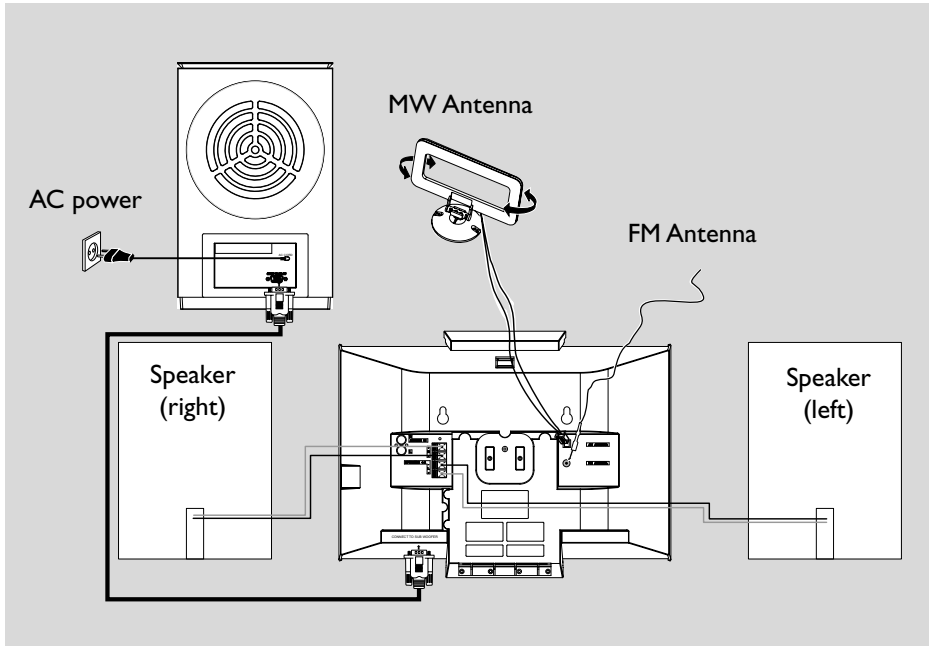

## Rear connections

**The type plate is located at the rear of the system.**

### A Power

Before connecting the AC power cord to the wall outlet, ensure that all other connections have been made.

#### Warning!

- For optimal performance, use only the original power cable.
- Never make or change any connections with the power switched on.

To avoid overheating of the system, a safety circuit has been built in. Therefore, your system may switch to Standby mode automatically under extreme conditions. If this happens, let the system cool down before reusing it (not available for all versions).

### B Antennas Connection

Connect the supplied MW loop antenna and FM antenna to the respective terminals. Adjust the position of the antenna for optimal reception.

#### MW Antenna

- Position the antenna as far as possible from a TV, VCR or other radiation source.

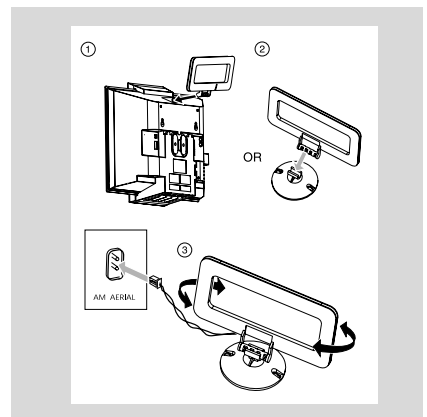



## FM Antenna

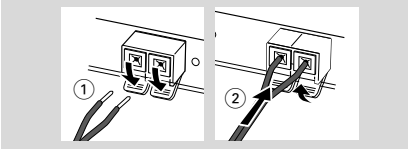

- For better FM stereo reception, connect an outdoor FM antenna to the FM ANTENNA terminal.

## C Speakers Connection

- 1 Connect the speaker wires to the SPEAKERS terminals, right speaker to "RIGHT" and left speaker to "LEFT", colored (marked) wire to "+" and black (unmarked) wire to "-".

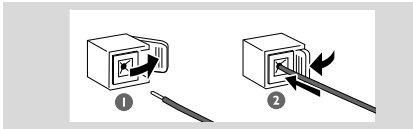

- Fully insert the stripped portion of the speaker wire into the terminal as shown.
- 2 Connect the **CONNECT TO SUB WOOFER** terminal of the main set to the **CONNECT TO MAIN SET** terminal of the subwoofer with the supplied 15-pin D-Sub cable by matching the pins. Fix the four screws on the connectors to ensure firm connection.

### Notes:

- For optimal sound performance, use the supplied speakers.
- Do not connect more than one speaker to any one pair of +/- speaker terminals.
- Do not connect speakers with an impedance lower than the speakers supplied. Please refer to the SPECIFICATIONS section of this manual.

## Placing the set and speakers

With the supplied detachable stands and wall mounting kit, you can either place the main set and speakers on desktop or mount them onto wall. Desktop installation is taken for example here. For how to mount the system onto wall, please refer to **Appendix** and the attached **Wall Mounting Instructions**.

- 1 Align the side marked **PRESS** of the larger-size stand with the slots at the bottom of the main set.

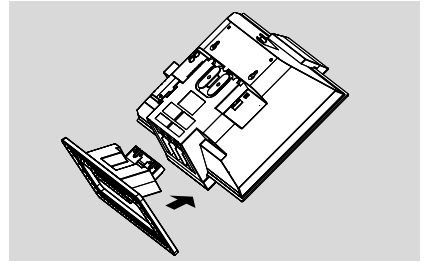

- 2 Push the stand down into the slots until you hear a click.
- 3 Attach the two smaller-size stands to the speakers in the same way.
- 4 Place the main set and speakers upright on the desktop with the support of the stands.

### Note:

- To remove the stand from the main set or either speaker, while pressing down **PRESS**, pull the stand out from the slots.

## Optional connection

The optional equipment and connecting cords are not supplied. Refer to the operating instructions of the connected equipment for details.

### Connecting other equipment to your system

Connect the audio left and right OUT terminals of a TV, VCR, Laser Disc player, DVD player or CD Recorder to the **AUX/CDR IN** terminals.

### Note:

- If you are connecting equipment with a mono output (a single audio out terminal), connect it to the AUX left terminal. Alternatively, you can use a "single to double" cinch cable (the output sound still remain mono).

# Preparations

## Inserting batteries into the Remote Control

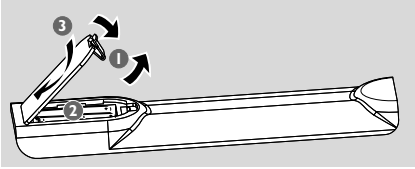

- 1 Open the battery compartment.
- 2 Insert two AAA batteries following the indications (+/-) inside the compartment.
- 3 Close the cover.

### Using the Remote Control to operate the Player



- 1 Aim the Remote Control directly at the remote sensor (IR) on the front panel.
- 2 Do not put any objects between the Remote Control and the system while operating the system.

### CAUTION!

- Remove batteries if they are exhausted or if the Remote Control is not being used for a long time.
- Do not use old and new or different types of batteries in combination.
- Batteries contain chemical substances, so they should be disposed of properly.

## Controls on the system (illustrations on page 3)

- ① **STANDBY-ON** 
  - switches the system on/off.
- ② **Display screen**
  - shows the status of the system.
- ③ **LEFT OPEN • CLOSE**
  - opens/closes the left CD door.
- ④ **RIGHT OPEN • CLOSE**
  - opens/closes the right CD door.
- ⑤ **IR**
  - remote sensor
- ⑥ **VOLUME** **- / +**
  - adjusts the volume level.
- ⑦ **Disc trays**
- ⑧ **Mode Selection**



**ALBUM** **- / +**  

for TUNER ..... tunes to a station.  
for CD/MP3-CD ..... fast searches back and forward within a track/disc (press and hold).  
for MP3-CD ..... skips to the beginning of a current/previous/subsequent album.

for Clock/Timer ..... sets the hour.

 ..... stops disc playback or erases a disc program.

 ..... starts or interrupts playback.

**TITLE** **- / +**  

for TUNER ..... selects a preset radio station.

for CD/MP3-CD ..... skips to the beginning of a current/previous/subsequent track.





for Clock/Timer ..... sets the minute.
- ⑨ **DISC 1/2/3/4**
  - selects a disc tray for playback.
- ⑩ **PROGRAM**

for CD/MP3-CD ..... programmes tracks and reviews the program.



for TUNER ..... programs tuner stations.
- ⑪ **SOURCE**
  - selects the respective sound source for CD/TUNER (FM/MW)/ AUX.

- ⑫ **CLOCK • TIMER**
  - sets the clock or timer function.
- ⑬ 
  - connects headphones

## Controls on the remote (illustrations on page 4)

- ① **STANDBY-ON** 
  - switches the system on/off.
- ② **Source selection (USB unavailable for this version)**
  - selects the respective sound source for CD/TUNER (FM/MW)/ AUX.
- ③ **CD 1/2/3/4**
  - selects a disc tray for playback.
- ④ **L** 
  - opens/closes the left CD door:
- ⑤ **R** 
  - opens/closes the right CD door:
- ⑥  

for TUNER ..... tunes to a station.  
for CD/MP3-CD ..... fast searches back and forward within a track/disc (press and hold).  
for MP3-CD ..... skips to the beginning of a current/previous/subsequent album.

for Clock/Timer ..... sets the hour.
- ⑦  

for CD/MP3-CD ..... skips to the beginning of a current/previous/subsequent track.
- ⑧ **VOL +/-**
  - adjusts the volume level.
- ⑨ **ALBUM/PRESET +/-**

for TUNER ..... selects a preset radio station.

for MP3-CD ..... skips to the beginning of a current/previous/subsequent album.

for Clock/Timer ..... sets the minute.
- ⑩ 
  - starts or interrupts playback.

# Controls

- ⑪ ■
  - stops disc playback or erases a disc program.
- ⑫ **MUTE**
  - interrupts and resumes sound reproduction.
- ⑬ **IS (Incredible Surround)**
  - activates or deactivates the surround sound effect.
- ⑭ **DBB (Dynamic Bass Boost)**
  - enhances the bass.
- ⑮ **NEWS/RDS (unavailable for this version)**
- ⑯ **Numeric Keypad (0-9)**
  - for CD/MP3-CD ..... selects a track for playback directly.
- ⑰ **PROGRAM**
  - for CD/MP3-CD ..... programs tracks and reviews the program.
  - for TUNER ..... programs tuner stations.
- ⑱ **DIM**
  - turns on or off the dim function for the display screen.
- ⑲ **SLEEP**
  - activates/deactivates or selects the sleeper time.
- ⑳ **TIMER ON/OFF**
  - activates/deactivates the timer function.
- ㉑ **TIMER**
  - sets the timer function.
- ㉒ **CLOCK**
  - sets the clock function.
- ㉓ **DISPLAY**
  - displays disc information during playback.
- ㉔ **SHUFFLE**
  - plays disc tracks in random order.
- ㉕ **REPEAT**
  - repeats a track/disc program/entire disc.
- ㉖ **DEL (unavailable for this version)**
- ㉗ **REC • (unavailable for this version)**
- ㉘ **DSC (Digital Sound Control)**
  - selects sound characteristics: ROCK/JAZZ/POP/CLASSIC.

## Notes for remote control:

- First select the source you wish to control by pressing one of the source select keys on the remote control (for example CD, TUNER).
- Then select the desired function (for example ► II, ◀ ▶).

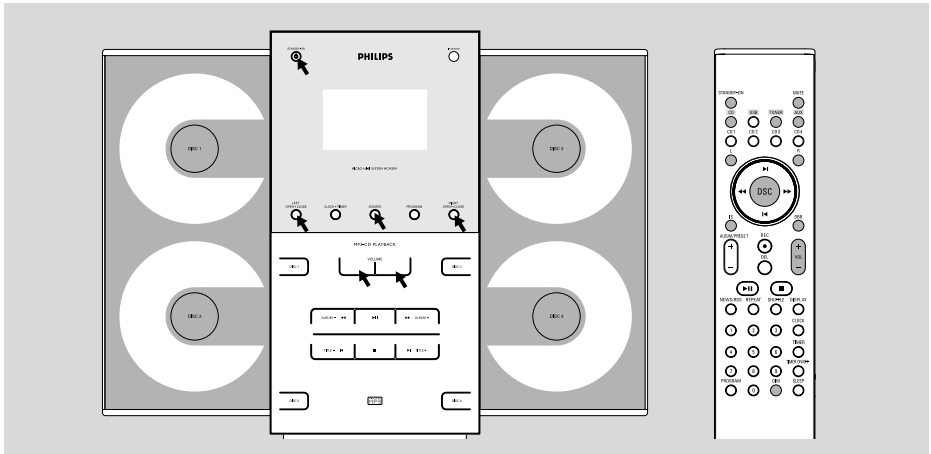

### Important!

Before you operate the system, complete the preparation procedures.

### Switching the system on/off

- Press **STANDBY-ON** .
  - The system will switch to the last selected source.
- Press **SOURCE** on the front panel or **CD**, **TUNER** or **AUX** on the remote control.
  - The system will switch to the selected source.
- Press **LEFT OPEN • CLOSE** or **RIGHT OPEN • CLOSE** on the front panel (**L ▲** or **R ▲** on the remote).
  - The system will switch to the CD source.

### To switch the system to standby mode

- Press **STANDBY-ON** .
  - The volume level (up to a maximum volume level of 13), interactive sound settings, last selected mode, source and tuner presets will be retained in the player's memory.

### Power Saving Automatic Standby

As a power-saving feature, the system automatically switches to Standby 30 minutes after a CD has reached the end and no control is operated.

### Adjusting volume and sound

- 1 Press **VOLUME +/- (VOL +/-)** on the remote to decrease or increase the volume.
    - Display shows the volume level VOL and a number from MIN1, 2, ...30, 31 MAX.
  - 2 Press **DSC** on the remote repeatedly to select the desired sound effect: **ROCK/ JAZZ/ POP/ CLASSIC**.
  - 3 Press **DBB** on the remote to switch bass enhancement on or off.
    - Display shows: **DBB**.
  - 4 Press **IS** on the remote repeatedly.
    - If activated, **INCR SUR** is displayed.
    - If deactivated, **IS OFF** is displayed.
  - 5 Press **MUTE** on the remote to interrupt sound reproduction instantly.
    - Playback will continue without sound and the display shows **MUTE**.
- To activate sound reproduction you can:
    - press **MUTE** again;
    - adjust the volume controls;
    - change source.

### Dimming the display screen

- Press **DIM** on the remote repeatedly to turn on or off the dim function for the display screen.

# CD/MP3-CD Operation

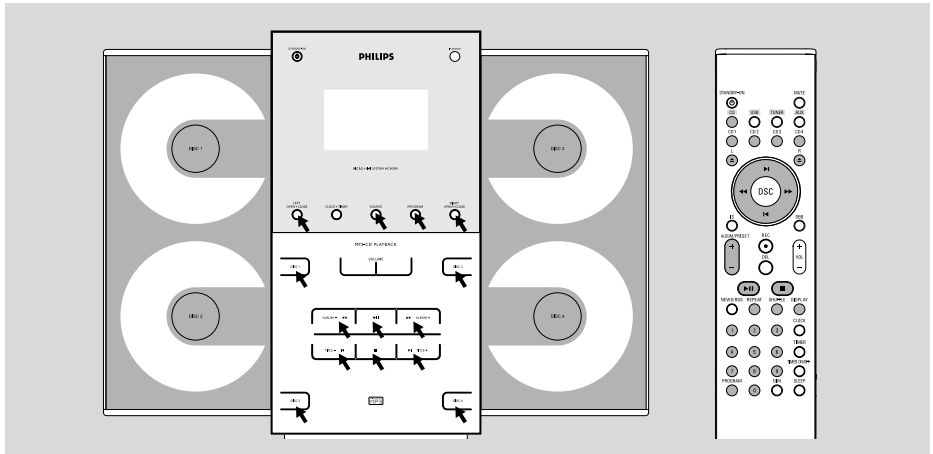

## IMPORTANT!

- This system is designed for regular discs. Therefore, do not use any accessories such as disc stabiliser rings or disc treatment sheets, etc., as offered on the market, because they may jam the changer mechanism.
- Do not load more than one disc into each tray.
- The lens of the CD player should never be touched.

## Discs for playback

This CD player plays Audio Discs including CD Recordables, CD-Rewritables and MP3 CD.

- CD-ROM, CD-I, CDV, VCD, DVD or computer CDs, however, are not possible.

## About MP3 disc

### Supported MP3 disc formats:

- ISO9660, Joliet, UDF 1.5
- Maximum title number: 256 (depending on filename length)
- Maximum album number: 99
- Supported sampling frequencies: 32 kHz, 44.1kHz, 48 kHz
- Supported Bit-rates: 32~256 (kbps), variable bitrates

## Loading discs

- 1 Press **SOURCE** on the front panel of the system to select CD or press **CD** on the remote.
- 2 Press **LEFT OPEN • CLOSE** or **RIGHT OPEN • CLOSE** on the front panel (**L ▲** or **R ▲** on the remote) to open the left or right CD door respectively.  
→ **OPEN** is displayed when the left or right CD door slides open.
- 3 Insert one or more discs with the printed side facing you. Press **LEFT OPEN • CLOSE** or **RIGHT OPEN • CLOSE** on the front panel (**L ▲** or **R ▲** on the remote) again to close the CD door:  
→ **CLOSE** is displayed briefly. Then, the CD player will play all the discs in the four disc trays one by one starting from "DISC 1". If no disc is found in a disc tray, the CD player will automatically turn to the next one. In this case, **CHANGING** will be displayed briefly followed by **TOC READ**. If no disc is found in any of the four disc trays, **NO DISC** will be displayed.  
→ **TOC READ** is displayed as the CD player scans the contents of a disc, and then the total number of tracks and playing time (or the total number of albums and tracks for MP3 disc) are shown.

## Basic playback controls

### To play currently available disc(s) on the disc trays

- Press **▶ ||** to start playback.
  - All loaded discs will play once, then stop.
  - The current track number and elapsed playing time of the track are displayed during disc playback.
  - For mixed mode discs, only one mode will be selected for playback depending on the recording format.

### To play the selected disc only

- In CD mode, press **DISC 1/2/3/4 (CD 1/2/3/4)** on the remote).
  - The selected disc will play once, then stop.

### To select a different track

- Press **TITLE +/- ◀ / ▶** (◀ / ▶ on the remote) once or repeatedly until the desired track number appears in the display.
- If you have selected a track number shortly after loading a disc or in the PAUSE position, you will need to press **▶ ||** to start playback.

### To select a desired album/title (MP3 disc only)

#### To select a desired album

- Press **ALBUM +/- ◀ ▶▶ (ALBUM/PRESET +/-)** on the remote) repeatedly.
  - The album name will scroll through the display once.

#### To select a desired title

- Press **TITLE +/- ◀ / ▶** (◀ / ▶ on the remote) repeatedly.
  - The title name will scroll through the display once.

#### Note:

– The album and title names will only be displayed once when selected. To view again, press the **DISPLAY** button repeatedly to display **ALBUM** and **TITLE** alternatively.

## Text display during playback

### In CD mode

- Press **DISPLAY** to see the following information:
  - Current track number and elapsed playback time of the current track.
  - Current track number and remaining playback time of the current track.
  - Current track number and total remaining playback time of the whole disc.

### In MP3-CD mode

- Press **DISPLAY** repeatedly to show the current file and album names.

### To find a passage within a track

- 1 Press and hold down on **ALBUM +/- ◀▶▶** (◀▶▶ on the remote).
  - The disc is played at high speed and low volume.
- 2 When you recognize the passage you want, release **ALBUM +/- ◀▶▶** (◀▶▶ on the remote).
  - Normal playback continues.

### To replace discs during playback

- During playback of a disc in "DISC 1" or "DISC 2", you can press **RIGHT OPEN • CLOSE (R ▲)** on the remote) to open the right CD door to replace discs without affecting the current playback.
- During playback of a disc in "DISC 3" or "DISC 4", you can press **LEFT OPEN • CLOSE (L ▲)** to open the left CD door to replace discs without affecting the current playback.

### To interrupt playback

- Press **▶ ||** during playback.
  - The display freezes and the elapsed playing time flashes when playback is interrupted.
  - To resume, press **▶ ||** again.

### To stop playback

- Press **■**.

# CD/MP3-CD Operation

## Notes:

CD playback will also stop when;

- the CD door where the disc is playing is opened.
- you select another source: TUNER or AUX.
- you select standby.
- the set auto off time is out.
- no button is pressed within 15 minutes in the CD PAUSE position.

## Different play modes: SHUFFLE and REPEAT

You can select and change the various play modes before or during playback. The REPEAT modes can also be combined with PROGRAM.

SHUF .....tracks of the entire disc are played in random order.

REPEAT .....repeats the entire disc/ program.

REP .....plays the current track continuously.

- 1 To select your play mode, press **SHUFFLE** or **REPEAT** on the remote control before or during playback until the display shows the desired function. (SHUF, REP, REP ALL)
  - 2 Press **▶ ||** to start playback if in the STOP position.  
→ If you have selected SHUFFLE, playback starts automatically.
  - 3 To return to normal playback, press the respective **SHUFFLE** or **REPEAT** button until the various SHUFFLE / REPEAT modes are no longer displayed.
- You can also press **■** to cancel your play mode.

## Programming track numbers

Programming tracks is possible when playback is stopped. Up to 40 tracks can be stored in the memory in any order:

- 1 Load the desired discs on the disc tray (refer to "Loading discs").
- 2 Press **DISC 1/2/3/4** (**CD 1/2/3/4** on the remote) to select a disc.
- 3 Press **PROGRAM** to start programming.  
→ **PROG** starts flashing.
- 4 Press **TITLE +/- ◀ / ▶** (◀ / ▶ on the remote) repeatedly to select the desired track.

- For MP3 disc, press **ALBUM +/- ◀ ▶** (**ALBUM/PRESET +/-** on the remote) and **TITLE +/- ◀ / ▶** (◀ / ▶ on the remote) to select the desired album and title for programming.

- 5 Press **PROGRAM** to store the track.

- 6 To end programming, press **■ once**.  
→ **PROG** stays and the programme mode remains active.  
→ The total number of tracks programmed and the total playing time are displayed.  
→ For MP3 disc, total playing time will not be shown.

- 7 To start program play, press **▶ ||**.

## Notes:

- It is not possible to create a programme with MP3 tracks from multiple CDs, or combined with normal audio tracks.
- If the total playing time is more than "99:59" then "-:--" is displayed instead of the total playing time.
- If you attempt to programme more than 40 tracks, "PROGRAM FULL" is displayed.
- During programming, if no button is pressed within 20 seconds, the system will exit the programme mode automatically.

## To review the program

- Stop playback and press **TITLE +/- ◀ / ▶** (◀ / ▶ on the remote) repeatedly.
- To exit review mode, press **■**.

## Erasing the program

- Press **■ once** when playback is stopped or **twice** during playback.  
→ **PROG** disappears and "PROGRAM CLEARED" is displayed.

## Note:

- The program will be erased when the system is disconnected from the power supply or when the disc tray is opened.



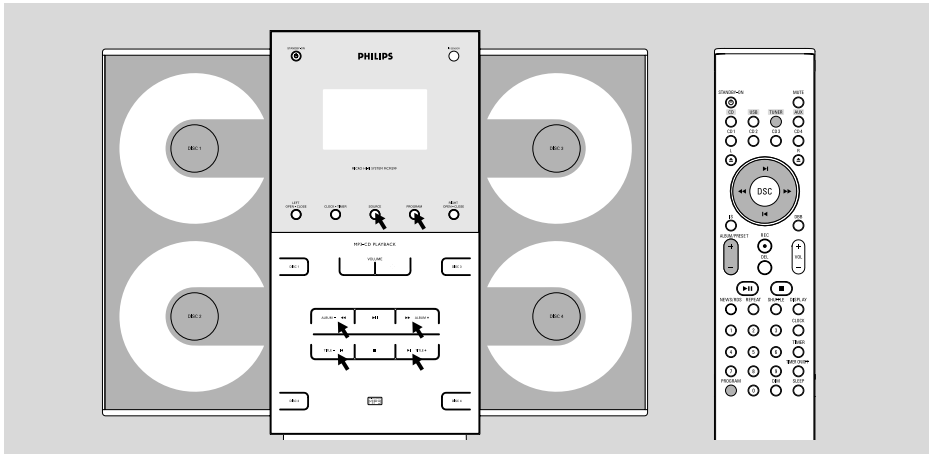

## Tuning to radio stations

- 1 Press **SOURCE** on the front panel of the system repeatedly or **TUNER** on the remote to select **TUNER**.  
→ **TUNER** is displayed briefly.
- 2 Press **SOURCE** on the front panel of the system or **TUNER** on the remote once or more to select your waveband (FM/MW).
- 3 Press and hold **ALBUM +/- << / >>** (<< / >>) on the remote).  
→ The radio automatically tunes to a station with sufficient reception. Display indication during automatic tuning: **SEARCH**.
- 4 Repeat step 3 if necessary until you find the desired station.
- To tune to a weak station, press **ALBUM +/- << / >>** (<< / >>) on the remote) briefly and repeatedly until you have found optimal reception.

## Programming radio stations

You can store up to a total of 40 radio stations in the memory for each band.

### Automatic programming

Automatic programming will start with a chosen preset number. From this preset number upwards, former programmed radio stations will be overridden.

- 1 Press **TITLE +/- < / >** (**ALBUM/PRESET +/-** on the remote) to select the preset number where programming should start.

**Note:**

– *If no preset number is selected, default is preset (1) and all your presets will be overridden.*

- 2 Press **PROGRAM** for more than 2 seconds to activate programming.  
→ **AUTO** is displayed and available stations are programmed in order of waveband reception strength: FM followed by MW. The last preset automatically stored will then be played.

# Radio Reception

## Manual programming

- 1 Tune to your desired station (see "Tuning to radio stations").
  - 2 Press **PROGRAM** to activate programming.
  - 3 Press **TITLE +/- ◀ / ▶ (ALBUM/PRESET +/-** on the remote) on the remote to allocate a number from 1 to 40 to this station.
  - 4 Press **PROGRAM** again to confirm the setting.  
→ The preset number and the frequency of the preset station are shown.
  - 5 Repeat the above four steps to store other stations.
- You can override a preset station by storing another frequency in its place.

## Tuning to preset radio stations

- Press **TITLE +/- ◀ / ▶ (ALBUM/PRESET +/-** on the remote) until the desired preset station is displayed.

## Changing tuning grid *(not available for all versions)*

In North and South America, the frequency step between adjacent channels in the MW band is 10 kHz (9 kHz in some areas). The preset frequency step in the factory is 10 kHz.

### **Changing the tuning grid will erase all previously stored preset radio stations.**

Press and hold ■ on the system in the tuner mode.

→ The display will show "GRID 9" or "GRID 10".

#### Notes:

- GRID 9 and GRID 10 indicate that the tuning grid is in step of 9 kHz and 10 kHz respectively.

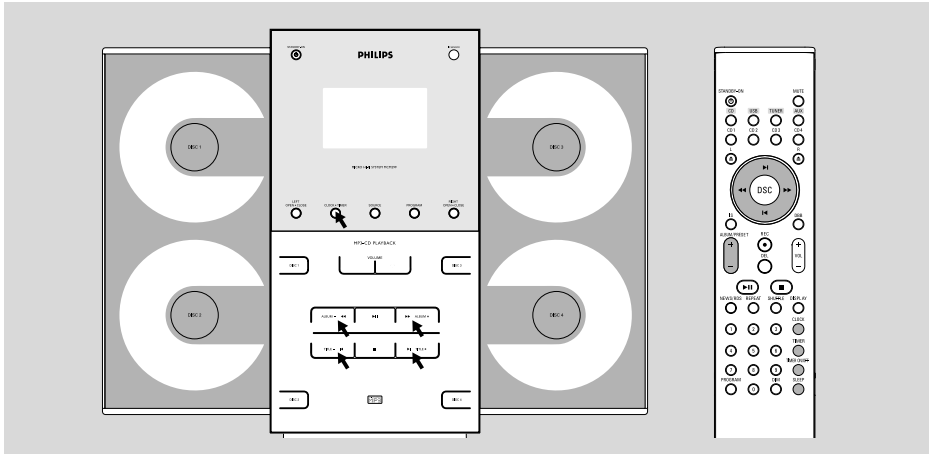

## Clock setting

The system only supports 12-hour time mode.

- 1 In active mode, press **CLOCK•TIMER** (**CLOCK** on the remote) repeatedly until the time digits flash.
- 2 Press **ALBUM-/+ <<>><<>> >><<><** on the remote) repeatedly to set the hour.
- 3 Press **TITLE +/- <<>> / >><<><** (**ALBUM/PRESET +/-** on the remote) repeatedly to set the minute.
- 4 Press **CLOCK•TIMER** (**CLOCK** on the remote) again to store the setting.  
→ The clock starts working.

### To exit without storing the setting

- Press **■** on the system.

#### Notes:

- The clock setting will be cancelled when the power cord is disconnected or if a power failure occurs.
- During clock setting, if no button is pressed within 70 seconds, the system will exit clock setting mode automatically.

## Timer setting

The system can switch on to CD or TUNER mode automatically at a preset time, serving as an alarm to wake you up.

### IMPORTANT!

– Before setting the timer, ensure that the clock is set correctly.

- 1 Press and hold **CLOCK•TIMER** on the front panel of the system for more than **two seconds** or press **TIMER** on the remote to select timer mode.  
→ The last timer setting starts flashing.  
→ The selected source will be lighted.
- 2 Press **SOURCE** (**CD** or **TUNER** on the remote) to select the desired source.
- You can press **DISC 1/2/3/4** (**CD 1/2/3/4** on the remote) to select the specific disc you would like to play.
- Before setting timer, make sure the music source has been prepared.  
**CD** – Load the disc(s). To start from a specific track, make a program (refer to “CD/MP3 CD Operation - Programming the disc tracks”).  
**TUNER** – tune to the desired radio station.
- 3 Press **ALBUM-/+ <<>><<>> >><<><** on the remote) repeatedly to set the hour for the timer to start.

# Clock/Timer

- 4 Press **TITLE +/-** **◀ / ▶** (**ALBUM/PRESET +/-** on the remote) repeatedly to set the minute for the timer to start.
  - 5 Press **CLOCK•TIMER** (**TIMER** on the remote) to store the start time.
- At the preset time, the selected source will play.

## To exit without storing the setting

- Press **■** on the system.

### Notes:

- When the preset time is reached and the selected disc tray is empty, the next available disc will be selected. If all the disc trays are not available, Tuner will be selected automatically.
- During timer setting, if no button is pressed within 70 seconds, the system will exit timer setting mode automatically.

## To deactivate the TIMER

- Press **TIMER ON/OFF** on the remote control.  
→  will disappear from the display.

## To activate the TIMER

- Press **TIMER ON/OFF** on the remote control.  
→  will appear on the display.

## Sleep timer setting

The sleep timer enables the system to switch to standby mode automatically at a preset time.

- 1 Press **SLEEP** on the remote control repeatedly to select a preset time.  
→ The selections are as follows (time in minutes):  
15 → 30 → 45 → 60 → 90 → 120 → OFF → 15 ...
- 2 When you reach the desired length of time, stop pressing **SLEEP**.  
→ **ZZZ** is shown, except for "OFF" mode.  
→ The sleep timer is now set.

## To check the remaining length of time after sleep timer is activated

- Press **SLEEP** once.

## To change the preset sleep timer

- Press **SLEEP** again while the remaining sleep timer is shown.  
→ The display will show the next sleep timer options.

## To deactivate the sleep timer

- Press **SLEEP** repeatedly until "OFF" is displayed, or press **STANDBY-ON/ECO POWER** .

### Note:

- **ZZZ** will start flashing when the remaining length of time after activation of the sleep timer is less than 1 minute.

## AMPLIFIER

Output power .....	2 x 20 W+60W RMS
Signal-to-noise ratio .....	≥ 60 dBA
LR frequency response .....	130 –18 kHz, ± 3 dB
SUB Frequency response .....	50 – 120Hz, ± 3 dB
Input sensitivity AUX .....	600mV
Impedance loudspeakers .....	6 Ω
Impedance headphones .....	32 Ω – 1000 Ω
.....	<0.5W
(1) (6 Ω, 120-12.5 kHz, 10% THD)	

## CD PLAYER

Frequency range .....	40 - 18000 Hz
Signal-to-noise ratio .....	60 dBA
Total harmonic distortion.....	≤ 3%
LR Frequency response .....	130 - 18 kHz, ± 3 dB
SUB Frequency response .....	50 - 120Hz, ± 3 dB

## TUNER

FM wave range .....	87.5 – 108 MHz
MW wave range (9 kHz) .....	531 – 1602 kHz
MW wave range (10 kHz) .....	530 – 1700 kHz
Tuning grid .....	9/10 kHz
Antenna	
– FM .....	300 Ω Wire
– MW .....	Loop antenna

## SPEAKERS

Bass reflex system	
Dimensions (w x h x d) ....	171 x 297 x 89 (mm)

## SUBWOOFER

Subwoofer (not magnetically shielded design).....	
.....	15cm
Impedance.....	6 Ω
Dimensions (w x h x d) .....	
.....	220 mm x 350 mm x 357 mm
Weight.....	7.5 kg

## GENERAL INFORMATION

AC Power .....	110 – 127 / 220 – 240 V;
.....	50/60 Hz Switchable
Dimensions (w x h x d) .	450 x 335 x 115 (mm)
Weight(with/without speakers) .....	6.5 / 4.2 kg
Power consumption	
Active .....	60 W
Standby .....	<15 W

**Specifications and external appearance are subject to change without notice.**

# Maintenance

## Cleaning the Cabinet

- Use a soft cloth slightly moistened with a mild detergent solution. Do not use a solution containing alcohol, spirits, ammonia or abrasives.

## Cleaning Discs

- When a disc becomes dirty, clean it with a cleaning cloth. Wipe the disc from the centre out.
- Do not use solvents such as benzene, thinner, commercially available cleaners, or antistatic spray intended for analogue records.



## Cleaning the disc lens

- After prolonged use, dirt or dust may accumulate at the disc lens. To ensure good playback quality, clean the disc lens with Philips CD Lens Cleaner or any commercially available cleaner. Follow the instructions supplied with cleaner.

# Troubleshooting

## WARNING

*Under no circumstances should you try to repair the system yourself, as this will invalidate the warranty. Do not open the system as there is a risk of electric shock.*

*If a fault occurs, first check the points listed below before taking the system for repair. If you are unable to remedy a problem by following these hints, consult your dealer or Philips for help.*

Problem	Solution
<b>"NO DISC" is displayed.</b>	<ul style="list-style-type: none"><li>✓ Insert a disc.</li><li>✓ Check if the disc is inserted upside down.</li><li>✓ Wait until the moisture condensation at the lens has cleared.</li><li>✓ Replace or clean the disc, see "Maintenance".</li><li>✓ Use a finalised CD-RW or a correct MP3-CD format disc.</li></ul>
<b>Radio reception is poor.</b>	<ul style="list-style-type: none"><li>✓ If the signal is too weak, adjust the antenna or connect an external antenna for better reception.</li><li>✓ Increase the distance between the Micro HiFi System and your TV or VCR.</li></ul>
<b>The system does not react when buttons are pressed.</b>	<ul style="list-style-type: none"><li>✓ Remove and reconnect the AC power plug and switch on the system again.</li></ul>
<b>Sound cannot be heard or is of poor quality.</b>	<ul style="list-style-type: none"><li>✓ Adjust the volume.</li><li>✓ Disconnect the headphones.</li><li>✓ Check that the speakers are connected correctly.</li><li>✓ Check if the stripped speaker wire is clamped.</li><li>✓ Make sure the MP3-CD was recorded within 32~256 kbps bit rate with sampling frequencies at 48 kHz, 44.1 kHz or 32 kHz.</li></ul>
<b>The left and right sound outputs are reversed.</b>	<ul style="list-style-type: none"><li>✓ Check the speaker connections and location.</li></ul>
<b>The remote control does not function properly.</b>	<ul style="list-style-type: none"><li>✓ Select the source (CD or TUNER, for example) before pressing the function button (▶▶, ◀◀, ▶ ).</li><li>✓ Reduce the distance between the remote control and the system.</li><li>✓ Insert the battery with its polarities (+/- signs) aligned as indicated.</li><li>✓ Replace the battery.</li><li>✓ Point the remote control directly toward IR sensor on the front of the system.</li></ul>
<b>The timer is not working.</b>	<ul style="list-style-type: none"><li>✓ Set the clock correctly.</li><li>✓ Press TIMER to switch on the timer.</li></ul>
<b>The Clock/Timer setting is erased.</b>	<ul style="list-style-type: none"><li>✓ Power has been interrupted or the power cord has been disconnected. Reset the clock/timer.</li></ul>

## How to mount your system onto wall

### IMPORTANT!

- The wall mounting instructions are for use by the qualified wall mounting person only!
- Ask a qualified person to help you with the wall mounting, which includes drilling holes on the wall and mounting the set onto wall.

### What's in the supplied mounting kit

1 x template

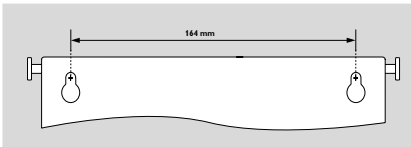

6 x screws and dowels

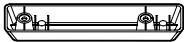

2 x speaker brackets

### What else you'll need

- Drilling tools (e.g. an electric drill)

### Preparation

- 1 Find a suitable location for mounting and complete necessary rear connections (see **Preparations**).
- 2 Ask a qualified person to help you with the wall mounting, who should:
  - to avoid unexpected damage, learn about the piping, wiring and other relevant information inside your wall;
  - according to the drilling requirements, choose suitable drilling tools;
  - take other precautions necessary for the wall mounting work.

### Mounting your main unit onto wall

- 1 Align the template in the chosen location on a wall. Use a pencil to mark the drilling positions (as shown).

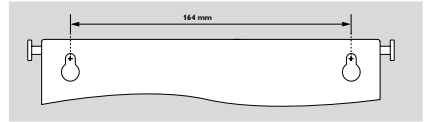

- 2 Drill two 6mm diameter holes as marked.
- 3 Secure the dowels and screws in the holes respectively, leaving the screws 5mm proud of the wall.

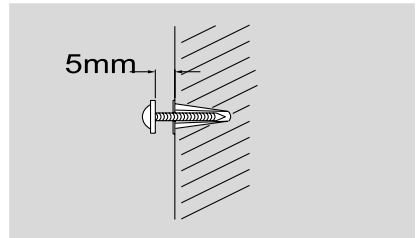

- 4 To detach the stand from the main unit,
  - a. As shown, hold down **PRESS▼**.
  - b. Move out the stand to detach.

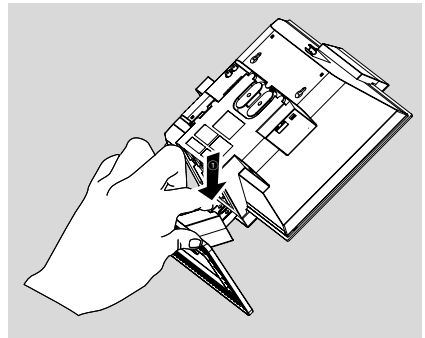

- 5 Hang the main unit on the fastening screws.

## Mounting your speakers onto wall

The supplied speaker brackets enable you to mount your speakers onto wall too.

- 1 Position the brackets on the wall where you want to hang the speakers one by one. Drill 2 holes slightly undersized for each bracket to ensure a firm fit.
- 2 Secure each bracket on the wall using 2 dowels and 2 screws (supplied).

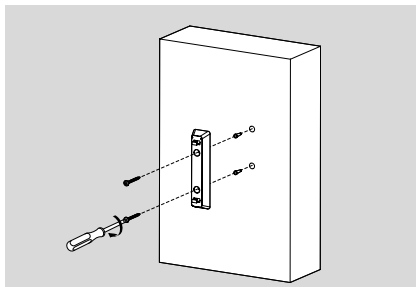

- 3 Detach the speaker stands in the same way as you do the main unit stand.

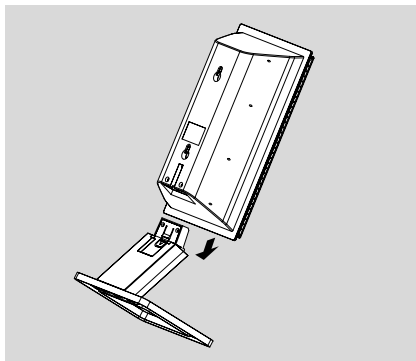

- 4 Hang the speakers on the brackets securely.

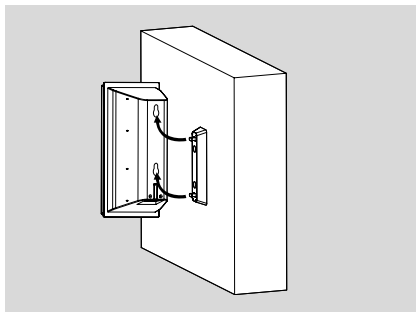



Meet Philips at the Internet  
<http://www.philips.com>

English

Español

Português

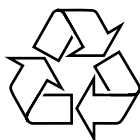

MCM299

