



Philips CarStudio
Car audio system

USB/SDHC

Bluetooth
Lossless audio

CarStudio

CE235BT

Experience live music in car

Obsessed with sound

Enjoy multiple source music in your car with the Philips CE235BT. Stay connected to your music on your mobile & important calls, thanks to the built-in Bluetooth® receiver. Also features anti-theft detachable front panels for security.

Enjoy superior sound

- MAX Sound for instant power boost
- Music Zone for adjustable sweet spots
- Dynamic Bass Boost electronically enhances the low tones
- Super anti-shock protection for smooth music enjoyment
- Built-in 50W x 4 amplifiers for excellent sound quality
- Support lossless audio formats for clear and authentic sound

Easy to use

- Browse by folder or song for instant search or quick access
- Built-in Bluetooth receiver for call and music streaming
- USB slot for music playback and quick charging
- Audio out for amplifier addition

Design that blends into your car

- High contrast LCD for perfect viewing
- Detachable front panel for anti-theft security

PHILIPS

Highlights

Music Zone

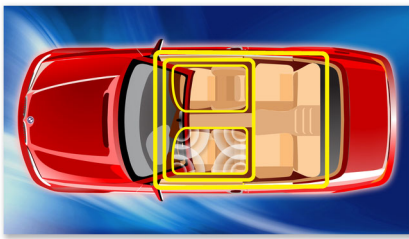

Philips' innovative Music Zone technology lets the driver and the passengers enjoy their music with more vivid spatial effect, just as the artist intended it to be heard. Users can easily switch the music listening zones from the driver to the passengers and back again to get the best sonic focus in the car. A dedicated zone control button provides three pre-defined settings - Left, Right and Front (and All) - so you can best match your listening needs easily and dynamically alone or with your passengers.

DBB Dynamic Bass Boost



Activate the Dynamic Bass Boost (DBB), and the low-end bass frequencies are electronically enhanced to achieve consistent sound reproduction, especially when the speaker volume is set at a low level. You hear impressive bass at all times.

Browse by folder or song

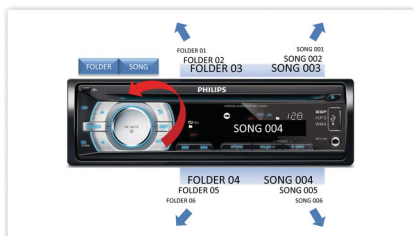

This function allows you to find a track or album much faster by letting you browse

through songs and folders, which are the usual contents of USB/SDHC devices. With the dedicated folder/song button, only three simple steps are needed to make a search – press folder/song, rotate the volume knob and push to select. This simple process lets you search through your music quickly and easily, letting you to focus on your driving.

MAX Sound



MAX Sound technology produces an instant boost in bass and treble, maximizing volume performance and instantly creating the most impressive listening experience with just the touch of a button. Its sophisticated electronic circuitry calibrates existing sound and volume settings, instantly boosting bass, treble and volume beyond original maximum levels without distortion. The end result is a noticeable amplifying of both sound spectrum and volume and a potent audio boost that will add mileage to any music.

Built-in Bluetooth receiver



The Bluetooth hands-free feature lets you use your mobile phone safely while driving and you don't have to miss any important calls. With the built-in Bluetooth® receiver, you can also conveniently stream your music files from your phone to your car entertainment system.

USB Play and Quick Charge



The new Philips Universal USB charging interface supplies 1 Amp of current to a smart device, sufficient to charge its battery and power it up for intensive use. The software protocol is also designed to be universally compatible with virtually all smart phones available in the market and starts the charging process instantly when USB is connected.

Support lossless audio formats



FLAC (Free Lossless Audio Codec) is an audio coding format for lossless compression of digital audio. Digital audio compressed by FLAC's algorithm can typically be reduced to around half of its original size and it can be decompressed to an identical copy of the original audio data, giving a clear and authentic sound experience..



Specifications

Display

- Type: High contrast B/W LCD
- Key illumination: Blue

Playback media

- USB flash drive
- SD/SDHC card
- MP3 Link: for portable MP3 music playback
- Bluetooth streaming music

Audio Playback

- Compression format: MP3, FLAC, WAV
- ID3 Tag support: Song title, artist, album
- MP3 bit rates: 32-320kbps and variable bit rate
- USB / SDHC Modes: Fast Backward/Fast Forward, Play/Pause, Previous/Next, Repeat, Shuffle

Tuner/Reception/Transmission

- Tuner Bands: AM, FM Stereo
- Auto digital tuning
- Tuner Enhancements: Auto search and store
- No. of preset stations: 18(FM), 12(AM)
- RDS: Station Name, Program Type, News & Traffic, Auto-frequency

Sound

- Equalizer: 2-bands
- Equalizer settings: Classic, Jazz, Pop, Rock, Flat, Optimal, Techno, User defined
- Sound Enhancement: MAX Sound, Dynamic Bass

Boost, Music zone

- Output power (MAX): 50Wx4 channels
- Output power (RMS): 22Wx4 channels (4 ohms, 10% T.H.D.)

Connectivity

- Microphone: Built-in microphone
- Preamp output: 1 pair RCA(L/R)
- Bluetooth profiles: A2DP, AVRCP, Handsfree
- Bluetooth version: 2.0+EDR
- Hard-wired remote input

Security/Anti-theft

- Front panel: Detachable

Accessories

- Remote control: Not included
- User Manual: English, Spanish, Portuguese
- Quick start guide: English, Portuguese, Spanish

Power

- Power supply: 12V DC
- USB quick charge: 5V 1AMP (MAX)

Dimensions

- Chassis: 1 Din
- Product Dimensions (w/ panel): 188 x 58 x 120 mm (W x H x D)
- Product Dimensions (w/o panel): 188 x 58 x 95 mm (W x H x D)



Issue date 2022-04-24

Version: 2.1.4

12 NC: 8670 001 48592
EAN: 69 51613 99396 5

© 2022 Koninklijke Philips N.V.
All Rights reserved.

Specifications are subject to change without notice.
Trademarks are the property of Koninklijke Philips N.V.
or their respective owners.

www.philips.com