

Register your product and get support at
www.philips.com/welcome

FWM417



EN User manual

PHILIPS

Contenido

1 Important	4	7 Listen to radio	16
Safety	4	Tune to a radio station	16
Notice	5	Program radio stations automatically	16
		Program radio stations manually	16
2 Your Mini Hi-Fi System	6	Select a preset radio station	16
Introduction	6	Change AM tuning grid	16
What's in the box	6		
Overview of the main unit	7	8 USB record	17
Overview of the remote control	8	Record to USB	17
		Schedule radio-to-USB record	17
3 Get started	10		
Connect FM antenna	10	9 Other features	18
Connect AM antenna	10	Set the alarm timer	18
Connect speakers	10	Set the sleep timer	18
Connect power	11	Listen to an external device	18
Prepare the remote control	11	Delete from USB device	19
Auto install radio stations	12	Karaoke	19
Set clock	12	Adjust display brightness	19
Turn on	12		
4 Play	13	10 Product information	20
Play disc	13	Specifications	20
Play from USB	13	USB playability information	21
		Supported MP3 disc formats	21
5 Play options	14	Maintenance	21
Repeat and random play	14		
Program tracks	14	11 Troubleshooting	22
Display play information	14		
6 Adjust volume level and sound effect	15		
Adjust volume level	15		
Mute sound	15		
Boost sound power	15		
Select a preset sound effect	15		
Enhance bass	15		
Incredible surround	15		
Customize sound for room acoustics	15		

1 Important

Safety

- ① Read these instructions.
 - ② Keep these instructions.
 - ③ Heed all warnings.
 - ④ Follow all instructions.
 - ⑤ Do not use this apparatus near water.
 - ⑥ Clean only with dry cloth.
 - ⑦ Do not block any ventilation openings. Install in accordance with the manufacturer's instructions.
 - ⑧ Do not install near any heat sources such as radiators, heat registers, stoves, or other apparatus (including amplifiers) that produce heat.
 - ⑨ Protect the power cord from being walked on or pinched, particularly at plugs, convenience receptacles, and the point where they exit from the apparatus.
 - ⑩ Only use attachments/accessories specified by the manufacturer.
 - ⑪ Use only with the cart, stand, tripod, bracket, or table specified by the manufacturer or sold with the apparatus. When a cart is used, use caution when moving the cart/apparatus combination to avoid injury from tip-over.
- 
- ⑫ Unplug this apparatus during lightning storms or when unused for long periods of time.
 - ⑬ Refer all servicing to qualified service personnel. Servicing is required when the apparatus has been damaged in any way, such as power-supply cord or plug is damaged, liquid has been spilled or objects have fallen into the apparatus, the apparatus has been exposed to rain or moisture, does not operate normally, or has been dropped.
 - ⑭ Battery usage **CAUTION** – To prevent battery leakage which may result in bodily injury, property damage, or damage to the unit:
 - Install all batteries correctly, + and - as marked on the unit.
 - Do not mix batteries (old and new or carbon and alkaline, etc.).
 - Remove batteries when the unit is not used for a long time.
 - ⑮ Apparatus shall not be exposed to dripping or splashing.
 - ⑯ Do not place any sources of danger on the apparatus (e.g. liquid filled objects, lighted candles).
 - ⑰ This product may contain lead and mercury. Disposal of these materials may be regulated due to environmental considerations. For disposal or recycling information, please contact your local authorities or the Electronic Industries Alliance: www.eiae.org.
 - ⑱ Where the MAINS plug or an appliance coupler is used as the disconnect device, the disconnect device shall remain readily operable.



Warning

- Never remove the casing of this apparatus.
- Never lubricate any part of this apparatus.
- Never place this apparatus on other electrical equipment.
- Keep this apparatus away from direct sunlight, naked flames or heat.
- Never look into the laser beam inside this apparatus.
- Ensure that you always have easy access to the power cord, plug or adaptor to disconnect this apparatus from the power.



Caution

- Use of controls or adjustments or performance of procedures other than herein may result in hazardous radiation exposure or other unsafe operation.

Notice

Any changes or modifications made to this device that are not expressly approved by Philips Consumer Lifestyle may void the user's authority to operate the equipment.

The making of unauthorized copies of



**Be responsible
Respect copyrights**

copy-protected material, including computer programs, files, broadcasts and sound recordings, may be an infringement of copyrights and constitute a criminal offence. This equipment should not be used for such purposes.

Environmental information

All unnecessary packaging has been omitted. We have tried to make the packaging easy to separate into three materials: cardboard (box), polystyrene foam (buffer) and polyethylene (bags, protective foam sheet.)

Your system consists of materials which can be recycled and reused if disassembled by a specialized company. Please observe the local regulations regarding the disposal of packaging materials, exhausted batteries and old equipment.

Windows Media and the Windows logo are trademarks, or registered trademarks of Microsoft Corporation in the United States and/or other countries.



This apparatus includes this label:

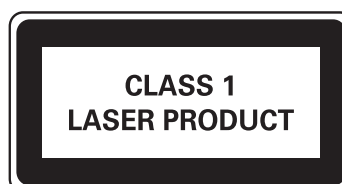

2 Your Mini Hi-Fi System

Congratulations on your purchase, and welcome to Philips! To fully benefit from the support that Philips offers, register your product at www.Philips.com/welcome.

Introduction

With this unit, you can enjoy audio from discs, USB devices, external devices, or radio stations. For your convenience, you can load up to 3 discs at once.

To enrich sound, this unit offers you these sound effects:

- MAX sound for instant power boost
- Digital Sound Control (DSC)
- Dynamic Bass Boost (DBB)
- Incredible surround (IS)
- Virtual Ambience-based Control (VAC)

The unit supports the following media formats:



What's in the box

Check and identify the contents of your package:

- Main unit x 1
- AC power cable x 1
- Loudspeaker box x 2
- Remote control with 2 AAA batteries
- FM wire antenna x 1
- AM loop antenna x 1
- MP3 link cable x 1
- Quick start guide
- User manual

Overview of the main unit

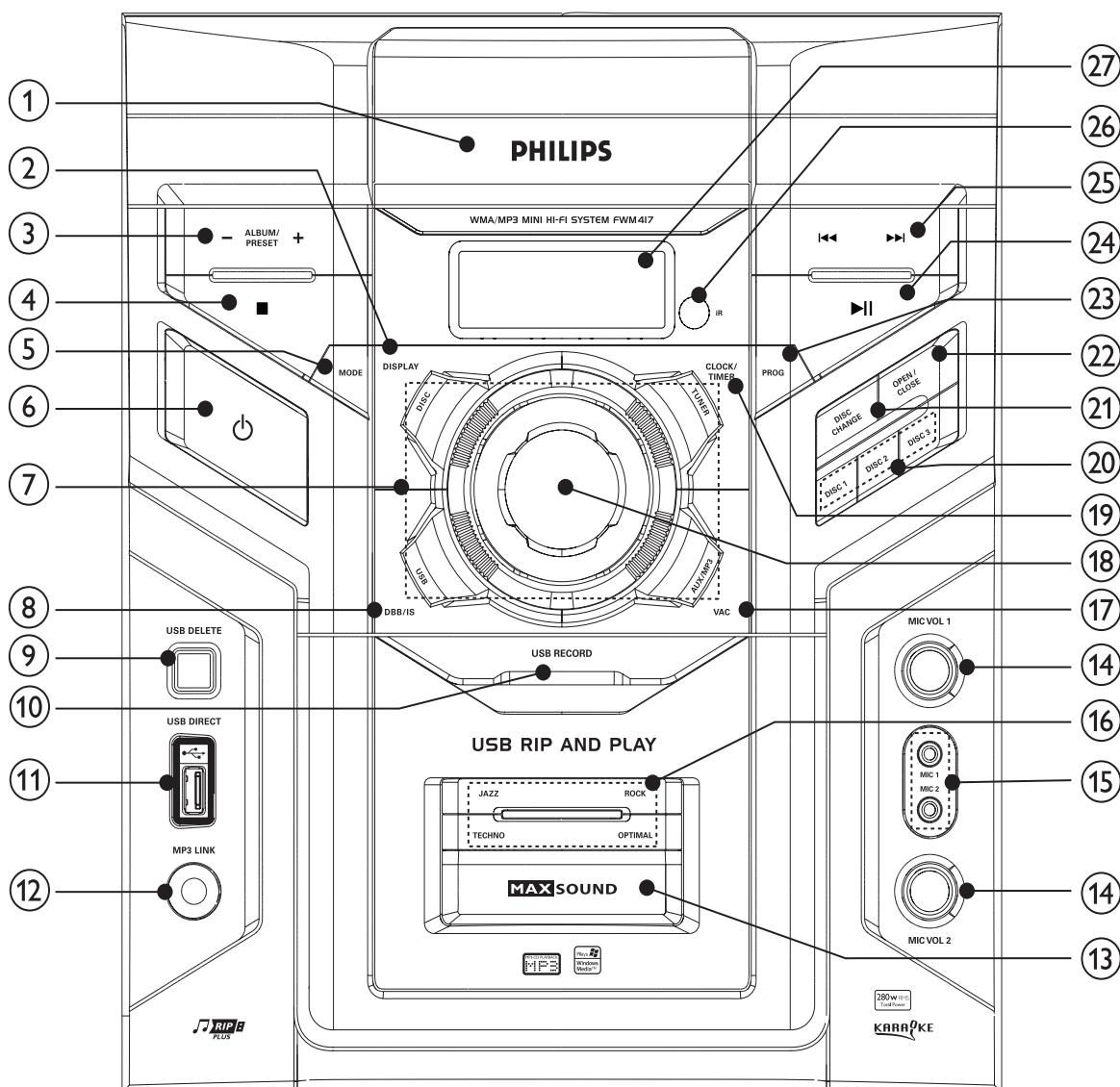

① Disc compartment door

② DISPLAY

- Select display information.

③ ALBUM/PRESET+/-

- Skip to the previous/next album.
- Select a preset radio station.
- Adjust time.
- Select 12 hour or 24 hour format.

④ ■

- Stop play or erase a program.

⑤ MODE

- Select repeat play or random play.

⑥ ⏻

- Turn on the unit or switch to standby mode.

⑦ Source selection keys

- Select a source.

⑧ DBB/IS

- Turn on or off dynamic bass enhancement.
- Turn on or off incredible surround.

⑨ USB DELETE

- Delete audio files stored on a USB device.

⑩ USB RECORD

- Record from a disc or radio to a USB device.

⑪ USB DIRECT ↔

- Jack for a USB mass storage device.

- ⑫ **MP3 LINK**
 - Audio input jack (3.5mm) for an external audio device.
- ⑬ **MAX SOUND**
 - Turn on or off instant power boost for sound.
- ⑭ **MIC VOL**
 - Adjust microphone volume.
- ⑮ **MIC 1/2**
 - Jack for a microphone.
- ⑯ **DSC**
 - Select a preset sound equalizer setting.
- ⑰ **VAC**
 - Select an ambience-based equaliser setting.
- ⑱ **VOLUME**
 - Adjust volume.
- ⑲ **CLOCK/TIMER**
 - Set the clock.
 - Set the alarm timer.
- ⑳ **DISC 1/2/3**
 - Select a disc.
- ㉑ **DISC CHANGE**
 - Change a disc.
- ㉒ **OPEN/CLOSE**
 - Open or close the disc compartment.
- ㉓ **PROG**
 - Program tracks.
 - Program radio stations.
- ㉔ **▶||**
 - Start or pause play.
- ㉕ **⏮️/⏭️**
 - Skip to the previous/next track.
 - Search within a track/ disc/USB.
 - Tune to a radio station.
 - Adjust time.
- ㉖ **iR**
 - Remote sensor.

- ㉗ **Display panel**
 - Show current status.

Overview of the remote control

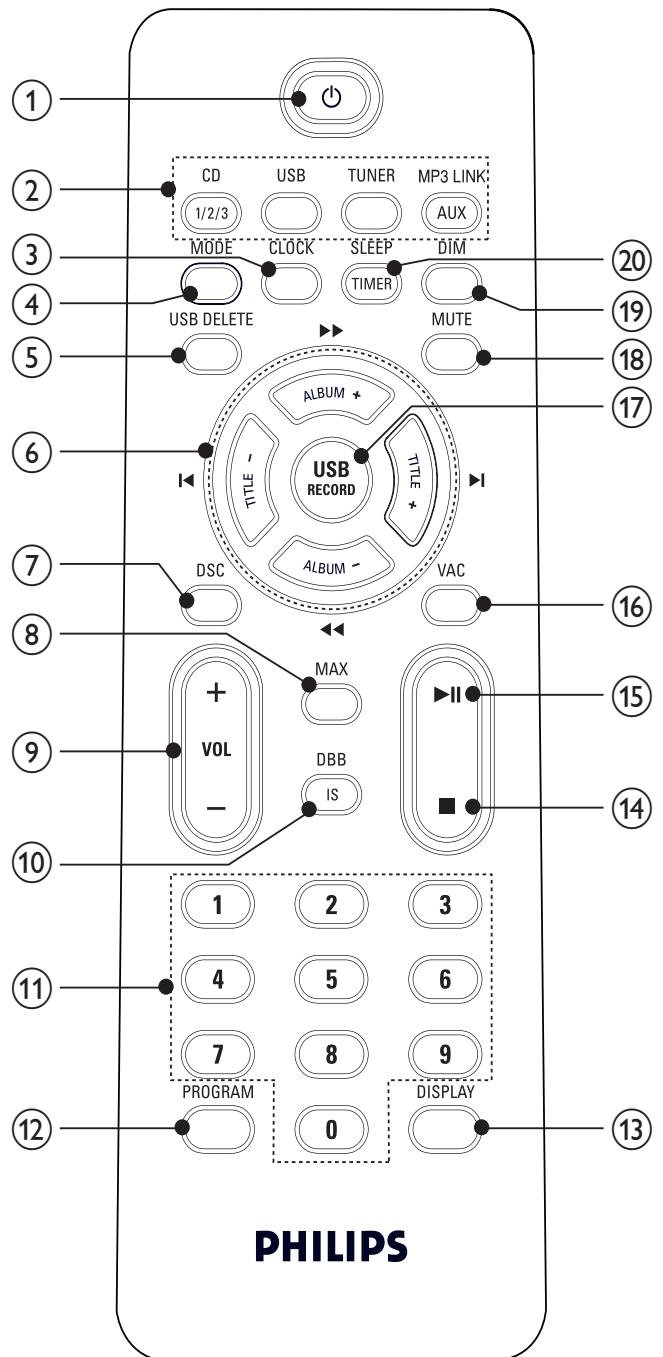

- ① **⏻**
 - Turn on the unit, or switch to standby mode.
- ② **Source selection keys**
 - Select a source.

- ③ **CLOCK**
 - Set the clock.
- ④ **MODE**
 - Select repeat play or random play.
- ⑤ **USB DELETE**
 - Delete audio files stored on a USB device.
- ⑥ **TITLE+/-◀▶**
 - Skip to the previous/next track.
 - Select a preset radio station.
 - Adjust time.
 - **ALBUM +/-**/Skip to the previous/next album.
 - Search within a track/ disc/USB.
 - Tune to a radio station.
 - Adjust time.
 - Select 12 hour or 24 hour format.
- ⑦ **DSC**
 - Select a preset sound equalizer setting.
- ⑧ **MAX**
 - Turn on or off instant power boost for sound.
- ⑨ **VOL +/-**
 - Adjust volume.
- ⑩ **DBB/IS**
 - Turn on or off dynamic bass enhancement.
 - Turn on or off incredible surround.
- ⑪ **Numeric keypad**
 - Select a track from a disc directly.
- ⑫ **PROGRAM**
 - Program tracks.
 - Program radio stations.
- ⑬ **DISPLAY**
 - Select display information.
- ⑭ **■**
 - Stop play or erase a program.
- ⑮ **▶||**
 - Start or pause play.
- ⑯ **VAC**
 - Select an ambience-based equaliser setting.
- ⑰ **USB RECORD**
 - Record to a USB device.
- ⑱ **MUTE**
 - Mute volume.
- ⑲ **DIM**
 - Select different levels of display brightness.
- ⑳ **SLEEP/TIMER**
 - Set the sleep timer.
 - Set the alarm timer.
 - Turn on or off sleep/alarm timer.

3 Get started

! Caution

- Use of controls or adjustments or performance of procedures other than herein may result in hazardous radiation exposure or other unsafe operation.

Always follow the instructions in this chapter in sequence.

If you contact Philips, you will be asked for the model and serial number of this apparatus. The model number and serial number are on the back of the apparatus. Write the numbers here:

Model No. _____

Serial No. _____

Connect FM antenna

- 1 Connect the supplied FM antenna to the **FM** jack on the back of the main unit.

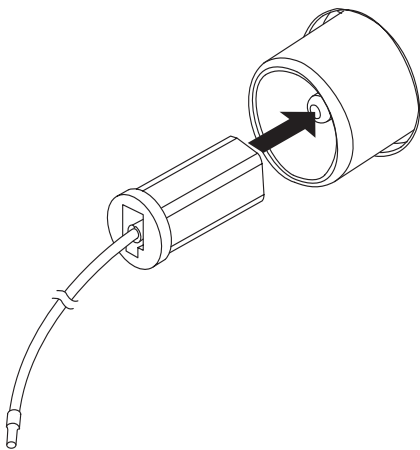

Connect AM antenna

- 1 Assemble the AM loop antenna.

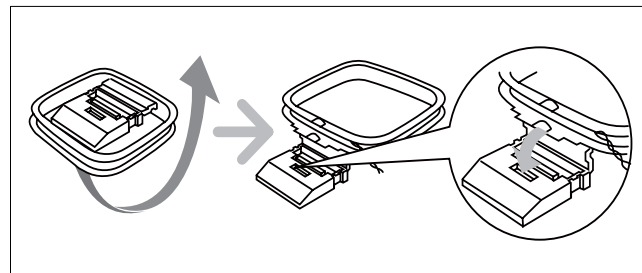

- 2 Connect the AM loop antenna to the **AM** jack on the back of the main unit.

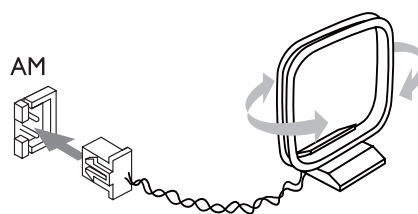

Connect speakers

! Caution

- For optimal sound, use the supplied speakers only.
- Connect only speakers with impedance that is the same or higher than the supplied speakers. Refer to the Specifications section of this manual.

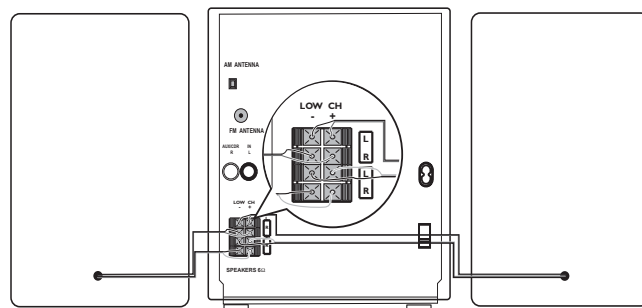

≡ Note

- Ensure that the colors of the speaker wires and terminals are matched.

- 1 Hold down the socket flap.
- 2 Insert the stripped part of the wire completely.
 - Insert the right speaker wires to "R", left speaker wires to "L".
 - Insert the red wires and blue wires to "+", black wires to "-".
 - Release the socket flap.

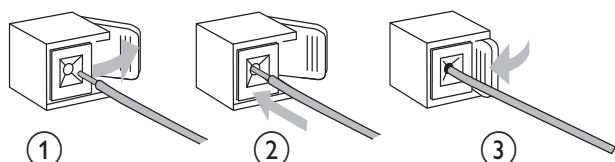

Connect power

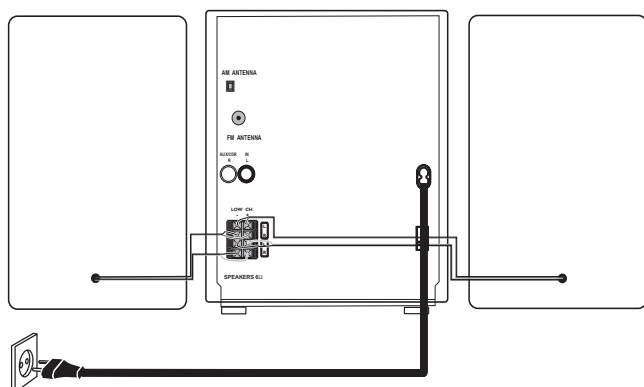

Caution

- Risk of product damage! Ensure that the power supply voltage corresponds to the voltage set on the voltage selector on the back of the unit.
- Before connecting the AC power cord, ensure you have completed all other connections.



Note

- The type plate is located on the back of the main unit.

- 1 If your power supply voltage is 110V-127V, adjust the voltage selector to 110V-127V.

- 2 Connect the AC power cable to:
 - the main unit.
 - the wall socket.

Prepare the remote control



Caution

- Risk of explosion! Keep batteries away from heat, sunshine or fire. Never discard batteries in fire.

To replace the remote control battery:

- 1 Open the battery compartment.
- 2 Insert 2 AAA batteries with correct polarity (+/-) as indicated.
- 3 Close the battery compartment.

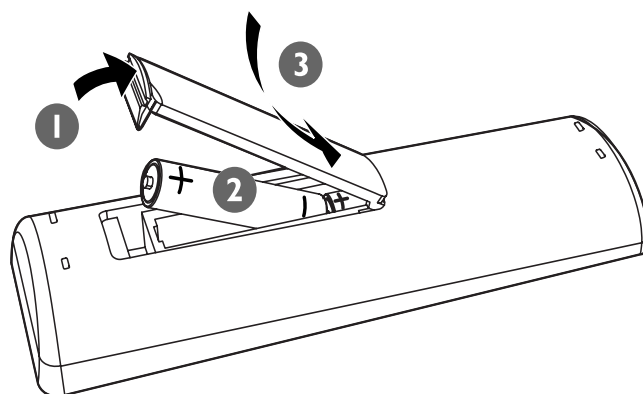

Note

- If you are not going to use the remote control for a long time, remove the batteries.
- Do not use old and new or different types of batteries in combination.
- Batteries contain chemical substances, so they should be disposed of properly.

Auto install radio stations

When you connect power and no radio stations are stored, the unit automatically begins to store radio stations.

- 1 Connect the unit to the power supply.
 - ↳ [AUTO INSTALL - PRESS PLAY] (auto install - press the PLAY button) is displayed.
- 2 Press ►|| on the main unit to start installation.
 - ↳ [AUTO] (auto) is displayed.
 - ↳ The unit automatically stores radio stations with sufficient signal strength.
 - ↳ When all the available radio stations are stored, the first preset radio station is broadcast automatically.

Set clock

- 1 In the standby mode, press **CLOCK** to activate the clock setting mode.
 - ↳ The 12 hour or 24 hour format is displayed.
- 2 Press **ALBUM +/-◀▶** repeatedly to select 12 hour or 24 hour format.
- 3 Press **CLOCK** to confirm.
 - ↳ The clock digits are displayed and begin to blink.
- 4 Press **ALBUM +/-◀▶** to set the hour.
- 5 Press **TITLE +/-◀▶** to set the minute.
- 6 Press **CLOCK** to confirm.



Tip

- To view the clock during play, press **CLOCK**.

Turn on

- 1 Press **⏻**.
 - ↳ The unit switches to the last selected source.

Switch to standby

- 1 Press **⏻** to switch the unit to standby mode.
 - ↳ The backlight on the display panel turns off.
 - ↳ The clock (if set) appears on the display panel.

4 Play

Play disc

- 1 Press **CD 1/2/3** to select the disc source.
- 2 Press **OPEN/CLOSE** on the main unit to open the disc compartment.
- 3 Load up to two discs on the disc trays, with the printed side facing up.
 - To load the third disc, press **DISC CHANGE** on the main unit to rotate to the disc tray.

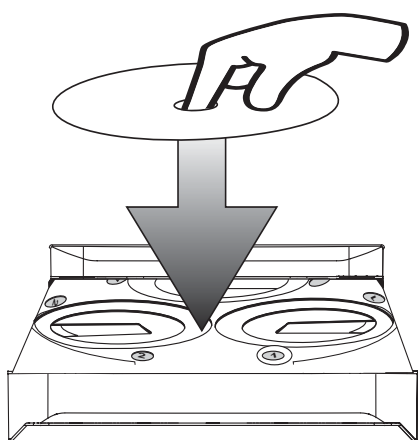

- 4 Press **OPEN/CLOSE** on the main unit to close the disc compartment.
- 5 If the disc doesn't play, press **▶II**.
 - To select a disc, press **CD 1/2/3**.
 - To pause/resume play, press **▶II**.
 - To stop play, press **■**.
 - To select another track, press **TITLE+/-◀/▶**, or press a numeric button.
 - To select an album, press **ALBUM +/-◀◀/▶▶**.
 - To search within a track, press and hold **ALBUM +/-◀◀/▶▶**, then release to resume normal play.

Play from USB

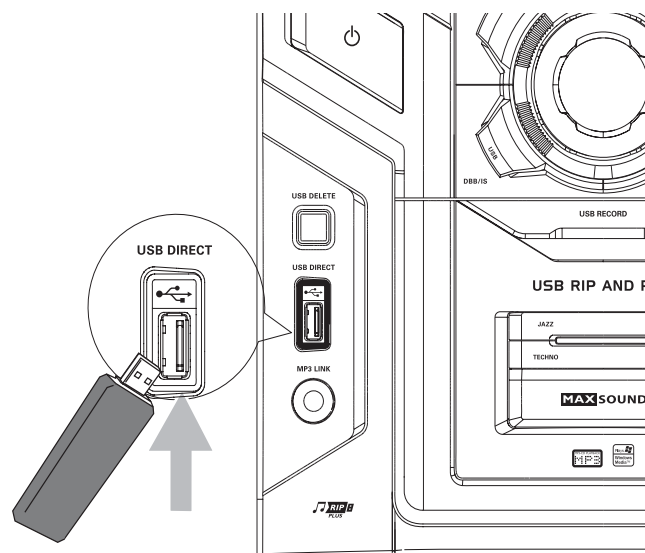





Note

- Ensure that the USB device contains playable audio contents for supported formats. (see 'USB playability information' on page 21)

- 1 Plug the USB device into the socket of this unit.
- 2 Press **USB** to select the USB source.
- 3 Press **ALBUM +/-◀◀/▶▶** to select a folder.
- 4 Press **TITLE+/-◀/▶** to select an audio file.
- 5 If the USB device doesn't play, press **▶II**.
 - To pause/resume play, press **▶II**.
 - To stop play, press **■**.
 - To search within an audio file, press and hold **ALBUM +/-◀◀/▶▶**, then release to resume normal play.

5 Play options

Repeat and random play

- 1 Press **MODE** repeatedly to select:
 - : the current track is played repeatedly.
 - ALL: all tracks are played repeatedly.
 - ALL: all tracks are played randomly and repeatedly.
 - : all tracks are played randomly.
- 2 To return to normal play, press **MODE** repeatedly until play mode is no longer displayed.









Tip

- Shuffle play cannot be selected when you play programmed tracks.

Program tracks

You can program a maximum of 40 tracks.

- 1 At CD/USB mode, in the stop position, press **PROGRAM** to activate the program mode.
↳ [PROG] (program) is displayed.
- 2 For MP3/WMA tracks, press **ALBUM +/-**   to select an album.
- 3 Press **TITLE +/-**   to select a track number; then press **PROGRAM** to confirm.
- 4 Repeat steps 2 to 3 to select and store all tracks to program.
- 5 Press  to play the programmed tracks.
↳ During play, [PROG] (program) is displayed.
 - To erase the program, in the stop position, press .

Display play information

- 1 During play, press **DISPLAY** repeatedly to select different play information.

6 Adjust volume level and sound effect



Note

- MAX sound and DSC (Digital Sound Control) cannot be activated at the same time.

Adjust volume level

- 1 During play, press **VOL +/-** to increase/decrease the volume level.

Mute sound

- 1 During play, press **MUTE** to mute/unmute sound.

Boost sound power

MAX gives an instant boost to the sound power.

- 1 Press **MAX** to turn on or off the instant power boost.

Select a preset sound effect

The DSC (Digital Sound Control) enables you to enjoy special sound effects.

- 1 During play, press **DSC** repeatedly to select:
 - [JAZZ] (jazz)
 - [ROCK] (rock)
 - [TECHNO] (techno)
 - [OPTIMAL] (optimal)

Enhance bass

The best DBB (Dynamic Bass Enhancement) setting is generated automatically for each DSC selection. You can manually select the DBB setting that best suits your listening environment.

- 1 During play, press **DBB/IS** repeatedly to select:
 - DBB 1
 - DBB 2
 - DBB 3
 - DBB off
 ↳ If DBB is activated, **DBB** is displayed.

Incredible surround

You can enhance audio with a virtual surround sound effect.

- 1 Press and hold **DBB/IS** to turn on or off the incredible surround.
 - ↳ If the incredible surround is activated, [INC SURR] (incredible surround) is displayed.

Customize sound for room acoustics

- 1 During play, press **VAC** repeatedly to select a type of listening environment:
 - [HALL] (hall)
 - [CONCERT] (concert)
 - [CINEMA] (cinema)

7 Listen to radio

Tune to a radio station

- 1 Press **TUNER** repeatedly to select FM or AM.
- 2 Press and hold **ALBUM +/-◀▶** for more than 2 seconds.
 - ↳ [SEARCH] (search) is displayed.
 - ↳ The radio tunes to a station with strong reception automatically.
- 3 Repeat step 2 to tune to more stations.
 - To tune to a weak station, press **ALBUM +/-◀▶** repeatedly until you find optimal reception.

Program radio stations automatically

You can program a maximum of 40 (FM + AM) preset radio stations.

- 1 In the tuner mode, press and hold **PROGRAM** more than 2 seconds to activate automatic program mode.
 - ↳ [AUTO] (auto) is displayed.
 - ↳ All available stations are programmed in the order of waveband reception strength.
 - ↳ The first programmed radio station is broadcast automatically.

Program radio stations manually

You can program a maximum of 40 (FM + AM) preset radio stations.

- 1 Tune to a radio station.

- 2 Press **PROGRAM** to activate program mode.
 - ↳ [PROG] (program) is displayed.
- 3 Press **TITLE +/-◀▶** to allocate a number to this radio station, then press **PROGRAM** to confirm.
- 4 Repeat the above steps to program other stations.



Tip

- To overwrite a programmed station, store another station in its place.

Select a preset radio station

- 1 In tuner mode, press **TITLE +/-◀▶** to select a preset number.



Tip

- Position the antenna as far as possible from TV, VCR or other radiation source.
- For optimal reception, fully extend and adjust the position of the antenna.

Change AM tuning grid

In some countries, the AM radio frequency step between adjacent channels is 10 kHz (9 kHz in some areas).

- 1 Select the tuner source.
- 2 Press and hold **■** on the main unit for more than 5 seconds.
 - ↳ The frequency step is changed to 9 kHz or 10 kHz.
 - ↳ All preset stations are erased and need to be re-programmed.

8 USB record

Audio CD tracks, MP3 files, radio and audio from external devices are recorded in .mp3 format, and WMA files are recorded in .wma format. The first time you record to USB, a folder called 'PHILIPS' is automatically created in the USB device. Each time you record to USB, the recorded files are stored in a sub-folder in the 'PHILIPS' folder. Files and sub-folders are named numerically in the order in which they are created.

Record to USB

- 1 Plug the USB device into the  socket of this unit.
- 2 Prepare the source to record from.
 - Disc - Select the disc source and load a disc. You can select a track from which a recording starts.
 - Radio - Tune to a radio station.
 - MP3 LINK/AUX - Select the MP3 link/AUX source, then connect and start to play an external device.
- 3 Press **USB RECORD** to start recording.
 - For discs, press **USB RECORD** repeatedly to select:
 - (A) [REC ONE] (record one): the first/current track is recorded.
 - (B) [REC ALL] (record all): all tracks/the remaining tracks are recorded.
 - ↳ Disc play starts automatically from the beginning of the disc/the selected track, and the recording starts.
 - To stop recording, press ■.



Note

- If the USB device does not have enough memory to store the audio files, a message about a full memory is displayed.



Schedule radio-to-USB record

Schedule radio recordings in advance and you can listen to your favorite programs at your convenience.



Note

- A recording is activated only in the standby mode.
- The maximum length of a recording is 12 hours.

- 1 Ensure that you set the clock correctly.
- 2 Plug the USB device into the  socket of this unit.
- 3 Tune to a radio station.
- 4 Press  to switch to standby mode.
- 5 Press and hold **SLEEP/TIMER** for more than 2 seconds.
 - ↳ A prompt to select the source is displayed.
- 6 Press **TUNER** repeatedly to select FM or AM.
- 7 Press **USB RECORD**.
 - ↳ The start timer digits are displayed and begin to blink.
- 8 Press **ALBUM +/-◀◀▶▶** to set the hour.
- 9 Press **TITLE+/-◀▶▶▶** to set the minute.
- 10 Press **SLEEP/TIMER** to confirm.
 - ↳ The end timer digits are displayed and begin to blink.
- 11 Press **ALBUM +/-◀◀▶▶** to set the hour.
- 12 Press **TITLE+/-◀▶▶▶** to set the minute.
- 13 Press **SLEEP/TIMER** to confirm.
 - ↳  is displayed.
 - ↳ At the scheduled times, the recording begins and ends automatically.
 - ↳ When the recording ends, the unit switches to standby mode.

To deactivate or re-activate a record timer

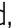
- 1 In the standby mode, press **SLEEP/TIMER** repeatedly.
 - ↳ If the timer is activated,  is displayed.
 - ↳ If the timer is deactivated,  disappears.

9 Other features

Set the alarm timer



This unit can be used as an alarm clock. The disc, radio or USB is activated to play at a preset time.

Note

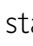
- If you have set a record timer and an alarm timer, only the latest timer is activated.

- 1 Ensure that you have set the clock correctly.
- 2 Press  to switch to standby mode.
- 3 Press and hold **SLEEP/TIMER** for more than 2 seconds.
 - ↳ A prompt to select the source is displayed.
- 4 Press **CD 1/2/3**, or **TUNER** or **USB** to select a source.
- 5 Press **SLEEP/TIMER** to confirm.
 - ↳ The clock digits are displayed and begin to blink.
- 6 Press **ALBUM +/-<<||>>** to set the hour.
- 7 Press **TITLE +/-<<||>>** to set the minute.
- 8 Press **SLEEP/TIMER** to confirm.
 - ↳ The timer is set and activated.

To deactivate or re-activate an alarm timer

- 1 In the standby mode, press **SLEEP/TIMER** repeatedly.
 - ↳ If the timer is activated,  is displayed.
 - ↳ If the timer is deactivated,  disappears.

Tip

- In MP3 link or AUX mode, the alarm timer cannot be set.
- If disc or USB source is selected but no audio file can be played, radio is activated automatically.

Set the sleep timer

This unit can switch to standby automatically after a set period of time.

- 1 When the unit is turned on, press **SLEEP/TIMER** repeatedly to select a set period of time (in minutes).
 - ↳ When sleep timer is activated, **zzz** is displayed.

To deactivate sleep timer

- 1 Press **SLEEP/TIMER** repeatedly until [OFF] (off) is displayed.
 - ↳ When sleep timer is deactivated, **zzz** disappears on the display.

Listen to an external device

You can listen to an external audio device through this unit.

For audio players with headphone sockets

- 1 Press **MP3 LINK/AUX** repeatedly to select the MP3 link source.
- 2 Connect the supplied MP3 link cable to:
 - the **MP3 LINK** jack (3.5mm) on the unit.
 - the headphone jack on an external device.
- 3 Start to play the device (refer to the device's user manual).

For audio players with red/white audio output sockets

- 1 Press **MP3 LINK/AUX** repeatedly to select the AUX source.
- 2 Connect the audio cables (white/red jacks, not supplied) to:
 - the **AUX IN** jacks on the back of the unit.
 - the **AUDIO OUT** jacks on an external device.
- 3 Start to play the device (refer to the device's user manual).

Delete from USB device

- 1 During USB play, press **TITLE**+**[-/▶]** to select an audio file.
 - To delete an audio folder, in the stop position, press **ALBUM** +**[-◀▶]** to select an audio folder.
- 2 Press **USB DELETE**.
 - ↳ A confirmation message is displayed.
- 3 While the message is displayed, press **USB DELETE** again to confirm.
 - To cancel, press **■**.

Karaoke

You can connect a microphone and sing along with a music source.

- 1 Turn **MIC VOL** to the minimum level.
- 2 Connect a microphone to the **MIC 1/2** jack on the unit.
- 3 Press **CD 1/2/3**, or **TUNER**, or **USB**, or **MP3 LINK/AUX** to select the source, and start play.
- 4 Sing through the microphone.
 - To adjust the volume of the source, press **VOL +/-**.
 - To adjust the volume of the microphone, turn **MIC VOL**.

Adjust display brightness

- 1 Press **DIM** repeatedly to select different levels of display brightness.

10 Product information



Note

- Product information is subject to change without prior notice.

Specifications

Amplifier

Total output power	280W RMS
Frequency response	60 - 16kHz
Signal-to- noise ratio	>67dB A (IEC)
Aux input	1500mV/2000mV

Disc

Laser type	Semiconductor
Disc diameter	12cm/8cm
Support disc	CD-DA, CD-R, CD-RW, MP3-CD, WMA-CD
Audio DAC	24Bits / 44.1kHz
Total harmonic distortion	<1.5%
Frequency response	60Hz -16kHz (44.1kHz)
S/N ratio	>75dBA

Tuner

Tuning range	FM: 87.5 - 108MHz; AM: 531 - 1602kHz (9kHz); 530 - 1700kHz (10kHz)
Tuning grid	100kHz (FM); 9kHz/10kHz (AM)
Number of presets	40 (FM + AM)
FM	75ohm wire
AM	loop antenna

Speakers

Speaker Impedance	6ohm
Woofer	2 x 5.25"
Tweeter	2 x 1.75"
Dimensions (W x H x D)	249 x 344 x 250mm
Weight	3.58kg each

General information

AC power	110 - 127/220 - 240V, 50/60Hz
Operation power consumption	180W
Standby power consumption	<2W
USB direct	Version 2.0/1.1
Dimensions Main Unit (W x H x D)	265 x 310 x 403mm
Weight (without speakers)	6.09kg

USB playability information

Compatible USB devices:

- USB flash memory (USB 2.0 or USB 1.1)
- USB flash players (USB 2.0 or USB 1.1)
- memory cards (requires an additional card reader to work with this unit)

Supported formats:

- USB or memory file format FAT12, FAT16, FAT32 (sector size: 512 bytes)
- MP3 bit rate (data rate): 32-320 Kbps and variable bit rate
- WMA v9 or earlier
- Directory nesting up to a maximum of 8 levels
- Number of albums/ folders: maximum 99
- Number of tracks/titles: maximum 999
- ID3 tag v2.0 or later
- File name in Unicode UTF8 (maximum length: 128 bytes)

Unsupported formats:

- Empty albums: an empty album is an album that does not contain MP3/WMA files, and is not be shown in the display.
- Unsupported file formats are skipped. For example, Word documents (.doc) or MP3 files with extension .dlf are ignored and not played.
- AAC, WAV, PCM audio files
- DRM protected WMA files (.wav, .m4a, .m4p, .mp4, .aac)
- WMA files in Lossless format

Supported MP3 disc formats

- ISO9660, Joliet
- Maximum title number: 999 (depending on file name length)
- Maximum album number: 99
- Supported sampling frequencies: 32 kHz, 44.1kHz, 48 kHz
- Supported Bit-rates: 32-320 (kbps), variable bit rates
- ID3 tag v2.0 or later
- Directory nesting up to a maximum of 8 levels

Maintenance

Clean the cabinet

- Use a soft cloth slightly moistened with a mild detergent solution. Do not use a solution containing alcohol, spirits, ammonia or abrasives.

Clean discs

- When a disc becomes dirty, clean it with a cleaning cloth. Wipe the disc from the centre out.
- Do not use solvents such as benzene, thinner, commercially available cleaners, or antistatic spray intended for analogue records.

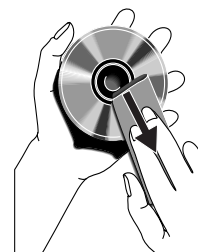

Clean the disc lens

- After prolonged use, dirt or dust may accumulate at the disc lens. To ensure good play quality, clean the disc lens with Philips CD lens cleaner or any commercially available cleaner. Follow the instructions supplied with cleaner.

11 Troubleshooting



Warning

- Never remove the casing of this apparatus.

To keep the warranty valid, never try to repair the system yourself.

If you encounter problems when using this apparatus, check the following points before requesting service. If the problem remains unsolved, go to the Philips web site www.philips.com/welcome. When you contact Philips, ensure that the apparatus is nearby and the model number and serial number are available.

No power

- Ensure that the AC power plug of the unit is connected properly.
- Ensure that there is power at the AC outlet.
- To save power, the unit switches to standby automatically 15 minutes after a play reaches the end and no control is operated.

No sound or poor sound

- Adjust the volume.
- Check that the speakers are connected correctly.
- Check if the stripped speaker wires are clamped.

Left and right sound outputs reversed

- Check the speaker connections and location.

No response from the unit

- Disconnect and reconnect the AC power plug, then turn on the unit again.

Remote control does not work

- Before you press any function button, first select the correct source with the remote control instead of the main unit.
- Reduce the distance between the remote control and the unit.

- Insert the batteries with their polarities (+/– signs) aligned as indicated.
- Replace the batteries.
- Aim the remote control directly at the sensor on the front of the main unit.

No disc detected

- Insert a disc.
- Check if the disc is inserted upside down.
- Wait until the moisture condensation at the lens has cleared.
- Replace or clean the disc.
- Use a finalized CD or correct format disc.

Cannot display some files in USB device

- The number of folders or files in the USB device has exceeded a certain limit. This phenomenon is not a malfunction.
- The formats of these files are not supported.

USB device not supported

- The USB device is incompatible with the unit. Try another one.

Poor radio reception

- Increase the distance between the unit and your TV or VCR.
- If the signal is too weak, adjust the antenna or connect an external antenna for better reception.

Clock/timer setting erased

- Power has been interrupted or the power cord has been disconnected.
- Reset the clock/timer.

Timer does not work

- Set the clock correctly.
- Switch on the timer.

LISTA DE SERVIÇO AUTORIZADO - BRASIL

ACRE							
CRUZEIRO DO SUL	68-33227216	BAIXO GUANDU	27-37321142	BELO HORIZONTE	31-32257262	BELEM	91-32353091
RIO BRANCO	68-32217642	BARRA DE SAO FRANCISCO	27-37562245	BELO HORIZONTE	31-32254066	BELEM	91-32542424
RIO BRANCO	68-32249116	CACHOEIRA DE ITAPEMIRIM	28-35223524	BETIM	31-35322088	CAPANEMA	91-34621100
		COLATINA	27-37222288	BOM DESPACHO	37-35222511	CASTANHAL	91-37215052
		GUARAPARI	27-33614355	CARANGOLA	32-37412017	ITAUBA	93-3518-502C
ALAGOAS		SAO MATEUS	27-37633806	CARATINGA	33-33213433	MARABA	94-33211891
ARAPIRACA	82-35222367	SERRA	27-3328-4292	CASSIA	35-35412293	ORIXIMINA	93-35491606
MACEIO	82-32417237	VILA VELHA	27-32891233	CATAGUASES	32-34227986	PARAGOMINAS	91-30110778
PALMEIRA DOS INDIOS	82-34213452	VITORIA	27-32233899	CONGONHAS	31-37311638	PARAUPEBAS	94-33561756
UNIAO DOS PALMARES	82-32811305			CONSELHEIRO LAFAIETE	31-37622001	SANTAREM	93-35235322
		GOIÁS		CONTAGEM	31-33912994		
AMAZONAS		ANAPOLIS	62-33243562	CONTAGEM	31-33953461	PARAÍBA	
MANAUS	92-36633366	CALDAS NOVAS	64-34532878	CORONEL FABRICIANO	31-38411804	CAMPINA GRANDE	83-33212128
MANAUS	92-32324252	CATALAO	64-34412786	CURVELO	38-37213009	ESPERANCA	83-3612273
		FORMOSA	61-6318166	DIVINOPOLIS	37-32212351	GUARABIRA	83-32711159
BAHA		GOIANESIA	62-33534967	FORMIGA	37-33214177	JOAO PESSOA	83-32469689
ALAGOINHAS	75-34211128	GOIANIA	62-32919095	FRUTAL	34-34235279	JOAO PESSOA	83-32446044
BARREIRAS	77-36117592	GOIANIA	62-32292908	GOVERNADOR VALADARES	33-32716650	JOAO PESSOA	83-3221-046C
CAETITE	77-34541183	GOIATUBA	64-34952401	GOVERNADOR VALADARES	33-32217250	NOVA FLORESTA	83-3741014
CAMACARI	71-36218288	ITAPURANGA	62-33551484	GUAXUPE	35-35513891		
CRUZ DAS ALMAS	75-6212839	ITUMBARA	64-34310837	GUAXUPE	35-35514124	PARANÁ	
ESPLANADA	75-34271454	JATAI	64-36367458	IPATINGA	31-38222332	ASSIS CHATEAUBRIAND	44-35285181
EUNAPOLIS	73-32815181	LUZIANIA	61-36228519	ITABIRA	31-38316218	BANDEIRANTES	43-35421711
FEIRA DE SANTANA	75-32232882	MINEIROS	64-36618259	ITAJUBA	35-36211315	CAMPO MOURAO	44-30164500
FEIRA DE SANTANA	75-32213427	PIRES DO RIO	64-34611133	ITAPECERICA	37-33411326	CASCADEL	45-32254005
GUANAMBI	77-34512791	RIALMA	62-3971320	ITAUNA	37-32412468	CIANORTE	44-36292842
ILHEUS	73-32315995	RIO VERDE	64-36132034	JOAO MONLEVADE	31-38512909	CURITIBA	41-33334764
IRECE	74-36410202	TRINDADE	62-35051505	JOAO PINHEIRO	38-35611327	CURITIBA	41-32648791
ITABUNA	73-36137777	URUACU	62-33571285	JUIZ DE FORA	32-32151514	FOZ DO IGUAÇU	45-35234115
ITAPETINGA	77-32613003			LAGOA DA PRATA	37-32613493	FOZ DO IGUAÇU	45-35233029
JACOBINA	74-36211323	MARANHÃO		LAVRAS	35-38219188	IBIPORA	43-32581863
JEQUIE	73-3525-4141	ACAILANDIA	99-35381889	LAVRAS	35-38210550	IRATI	42-34221337
JUAZEIRO	74-36116456	ACAILANDIA	99-35381889	LUZ	37-34214344	LAPA	41-36222410
JUAZEIRO	74-36111002	BACABAL	99-36212794	MANHUACU	33-33314735	LONDRINA	43-33241002
LAURO DE FREITAS	71-33784021	CAXIAS	99-35212377	MONTE CARMELO	34-38422082	LONDRINA	43-33213820
MURITIBA	75-34241908	COELHO NETO	98-34731414	MONTE SANTO DE MINAS	35-35911888	MAL CANDIDO RONDON	45-32542605
PAULO AFONSO	75-32811349	IMPERATRIZ	99-33216052	Montes Claros	38-32218925	MANDAGUARI	44-2331335
RIBEIRA DO POMBA	75-2761853	PEDREIRAS	99-36423142	MURIAE	32-37224334	MARINGA	44-32264620
SALVADOR	71-32473659	SAO JOSE DE RIBAMAR	98-32241581	NANUQUE	33-36212165	MEDIANEIRA	45-32642580
SALVADOR	71-32072070	SAO LUIS	98-32323236	NOVA LIMA	31-35412026	PARANAGUA	41-34252780
SALVADOR	71-33356233			OLIVEIRA	37-33314444	PATO BRANCO	46-32242786
SENHOR DO BONFIM	74-35413143	MAT O GROSSO		PARA DE MINAS	37-32316369	RIO NEGRO	47-36450251
SERRINHA	75-32611794	BARRA DO GARCAS	66-34011394	PARACATU	38-36711250	ROLANDIA	43-2561947
STO ANTONIO JESUS	75-36314470	CUIABA	65-33176464	PASSOS	35-35214342	S MIGUEL DO IGUAÇU	45-5651429
TEIXEIRA DE FREITAS	73-30111600	LUCAS DO RIO VERDE	65-35491333	PATOS DE MINAS	34-38222588	SAO JOSE DOS PINHAIS	41-32822522
VALENCA	75-36413710	PONTES E LACERDA	65-32662326	PATROCINIO	34-38311531	STO ANTONIO PLATINA	43-35341809
VITORIA DA CONQUISTA	77-34241183	PRIMAVERA DO LESTE	66-34981682	PIUMHI	37-33714632	TELEMACO BORBA	42-32726044
		RONDONOPOLIS	66-34233888	POCOS DE CALDAS	35-37121866	TOLEDO	45-32522471
		TANGARA DA SERRA	65-33261431	POCOS DE CALDAS	35-37224448	UMUARAMA	44-30561485
		VARZEA GRANDE	65-36826502	PONTE NOVA	31-38172486		
CEARÁ				POUSO ALEGRE	35-34212120	PERNAMBUCO	
CRATEUS	88-36910019	MAT O GROSSO DO SUL		S SEBASTIAO PARAISO	35-35313094	CABO SANTO AGOSTINHO	81-35211823
FORTALEZA	85-32875506	AMAMBAI	67-4811543	SAO JOAO DEL REI	32-33718306	CAMARAGIBE	81-34581246
FORTALEZA	85-40088555	CAMPO GRANDE	67-33242804	SETE LAGOAS	31-37718570	CARPINA	81-36213116
IGUATU	88-35810512	CAMPO GRANDE	67-33831540	TEOFILO OTONI	33-35225831	CARUARU	81-37220235
ITAPIPOCA	88-36312030	CAMPO GRANDE	67-33213898	TIMOTEO	31-38482728	FLORESTA	81-8771274
SOBRAL	88-36110605	DOURADOS	67-34217117	TRES CORACOES	35-32324143	GARANHUNS	87-37610085
SOBRAL	88-36115065	NOVA ANDRADINA	67-34413851	UBA	32-35323626	PAULISTA	81-34331142
TAUA	88-34371987	PONTA PORA	67-34314313	UBERABA	34-33332520	RECIFE	81-32313399
TIANGUA	88-36713336	TRES LAGOAS	67-35240849	UBERLANDIA	34-32123636	RECIFE	81-34656042
UBAJARA	88-36341233			VARGINHA	35-32227889	RECIFE	81-34629090
		MINAS GERAIS		VARGINHA	35-32228414	RECIFE	81-32286123
DISTRITO FEDERAL		ANDRADAS	35-37312970	VARZEA DA PALMA	38-3731-154E	SERRA TALHADA	87-38311401
BRASILIA	61-35564840	ARAGUARI	34-32416026	VICOSA	31-38918000		
BRASILIA	61-33549615	ARAXA	34-36611132	PARÁ		PIAUÍ	
BRASILIA	61-3445 1991	ARAXA	34-36691869	ANANINDEUA	91-32354831	FLORIANO	89-35221154
ESPIRITO SANTO		ARCOS	37-33513455	BELEM	91-32421090	PARNABA	86-3222877
ALEGRE	28-35526349	BAMBUI	37-34311473			PICOS	89-34155135
ARACRUZ	27-32561251						

LISTA DE SERVIÇO AUTORIZADO - BRASIL

TERESINA	86-32230825	PORTO ALEGRE	51-32226941	SÃO PAULO	19-38241524	S BERNARDO CAMPO	11-41257000
TERESINA	86-32214618	PORTO ALEGRE	51-33256653	AGUAS DE LINDOIA	19-34062914	S BERNARDO CAMPO	11-43681788
RIO DE JANEIRO		PORTO ALEGRE	51-32268834	AMERICANA	19-38072674	S JOAO BOA VISTA	19-36232990
B JESUS ITABAPOANA	22-38312216	RIO GRANDE	53-32323211	AMPARO	18-36218775	S JOSE CAMPOS	12-39239508
BARRA DO PIRAI	24-24437745	SANTA CRUZ DO SUL	51-37153048	ARACATUBA	16-33368710	S JOSE DO RIO PARDO	19-36085760
BELFORD ROXO	21-27795797	SANTA MARIA	55-30282235	ARARAQUARA	18-33242649	SALTO	11-40296563
CABO FRIO	22-26451819	SANTA ROSA	55-35113449	ASSIS	11-44118145	SANTO ANDRE	11-49905288
CAMPOS GOYTACAZES	22-27221499	SAO JOSE DO OURO	54-33521216	ATIBAIA	14-37322142	SANTOS	13-32272947
CORDEIRO	22-25512099	SAO LUIZ GONZAGA	55-33523215	AVARE	17-33222742	SANTOS	13-32847339
DUQUE DE CAXIAS	21-27711508	SOBRADINHO	51-37421409	BARRETOS	16-37614455	SAO CAETANO DO SUL	11-35654748
ITAGUAI	21-26886491	STA CRUZ DO SUL	51-3715 5456	BATATAIS	14-31049551	SAO CARLOS	16-3361-2646
ITAOCARA	22-38612740	TAPEJARA	54-33442353	BAURU	18-36424011	SAO JOSE DO RIO PRETO	17-32325680
ITAPERUNA	22-38220605	TAPEIRA	54-3851160	BIRIGUI	14-38821081	SAO PAULO	11-22964622
ITAPERUNA	22-38236825	TRES DE MAIO	55-35352101	BOTUCATU	14-38155044	SAO PAULO	11-29791184
MACAE	22-27591358	TRES DE MAIO	55-35358727	BOTUCATU	19-32369199	SAO PAULO	11-38659897
MAGE	21-26333342	URUGUAIANA	55-34118069	CAMPINAS	19-32336498	SAO PAULO	11-2215-6667
NITEROI	21-2622-0157	VACARIA	54-32311396	CAMPINAS	19-37372500	SAO PAULO	11-26940101
NOVA FRIBURGO	22-25227692	VENANCIO AIRES	51-37411443	CAMPINAS	12-36622142	SAO PAULO	11-32077111
PETROPOLIS	24-22454997	VERA CRUZ	51-37181350	CAMPOS DO JORDAO	17-35232524	SAO PAULO	11-39757996
RESENDE	24-33550101			CATANDUVA	15-32842121	SAO PAULO	11-22976464
RIO DE JANEIRO	21-24264702	RONDÔNIA		CERQUILHO	12-31433859	SAO PAULO	11-56679695
RIO DE JANEIRO	21-25892030	ARIQUEMES		CRUZEIRO	11-40430669	SAO PAULO	11-38751333
RIO DE JANEIRO	21-25096851	BURITIS	69-35353491	DIADEMA	18-38212479	SAO PAULO	11-38457575
RIO DE JANEIRO	21-24315759	CACOAL	69-32383830	DRACENA	17-34423752	SAO PAULO	11-2296-6122
RIO DE JANEIRO	21-22566260	GUAJARA-MIRIM	69-34431415	FERNANDOPOLIS	16-37223898	SAO PAULO	11-62809411
RIO DE JANEIRO	21-31592187	JARU	69-35414430	FRANCA	11-44492608	SAO PAULO	11-20713907
RIO DE JANEIRO	21-25714999	PIMENTA BUENO	69-35211584	FRANCO DA ROCHA	12-31335030	SAO PAULO	11-37714709
RIO DE JANEIRO	21-3381-0711	PORTO VELHO	69-34512934	GUARATINGUETA	13-33582942	SAO PAULO	11-25770899
SAO GONCALO	21-27013214			GUARUJA	11-64431153	SAO PAULO	11-32222311
TERESOPOLIS	21-27439467	RORAMA		GUARULHOS	16-33417665	SAO ROQUE	11-47125635
TRES RIOS	24-22521388	BOA VISTA	95-32249605	IBITINGA	16-31724600	SAO VICENTE	13-34646559
VOLTA REDONDA	24-33481601	SANTA CATARINA		IGARAPAVA	19-38753831	SOROCABA	15-32241170
RIO GRANDE DO NORTE		ARARANGUA	48-35220304	INDAIAL	15-32710936	SUZANO	11-47598671
CAICO	84-4171844	BALNEARIO CAMBORIU	47-3363 0706	ITAPETILINGA	19-38633802	TABOAO DA SERRA	11-47871480
NATAL	84-32231249	BLUMENAU	47-33227742	ITAPIRA	16-32622524	TAQUARITINGA	16-32524039
NATAL	84-32132345	BRUSQUE	47-33557518	ITAPOLIS	11-46404162	TAUBATE	12-36219080
PAU DOS FERROS	84-3351.2334	CANOINHAS	47-36223615	ITAQUAQUECETUBA	15-35322743	TUPA	14-34962596
RIO GRANDE DO SUL		CAPINZAL	49-35552266	ITARARE	11-40230188	VALINHOS	19-38716629
BAGE	53-32411295	CHAPECO	49-33223304	ITU	16-37293365		
BENTO GONCALVES	54-34526825	CHAPECO	49-33221144	ITUVERAVA	16-32021580	SERGIPE	
CAMPINAS DO SUL	54-3661300	CONCORDIA	49-3442 3704	JABOTICABAL		ARACAJU	79-32119764
CANELA	54-32821551	CRICUMA	48-21015555	JALES	17-36324479	ARACAJU	79-32176080
CARAZINHO	54-33302292	CUNHA PORA	49-6460043	JAU	14-36222117	ESTANCIA	79-5222325
CAXIAS DO SUL	54-30211808	CURITIBANOS	49-32410851	JUNDIAI	11-45862182	ITABAIANA	79-34313023
DOIS IRMAOS	51-35641286	FLORIANOPOLIS	48-3204-9700	LEME	19-35713528	LAGARTO	79-36312656
ERECHIM	54-33211933	GAROPABA	48-3254.4104	LIMEIRA	19-34413179	TOCANTINS	
ESTANCIA VELHA	51-35612142	INDAIAL	47-33333275	LINS	14-35227283	ARAGUAINA	63-34141811
FARROUPELHA	54-32683603	IPORA DO OESTE	49-36341289	MARILIA	14-34547437	ARAGUAINA	63-34111818
FAXINAL DO SOTURNO	55-32631150	ITAJAI	47-33444777	MATAO	16-33821046	GUARAI	63-34641590
FLORES DA CUNHA	54-32922625	JARAGUA DO SUL	47-33722050	MAUA	11-45145233	GURUPI	63-33511038
FREDERICO WESTPHALEN	55-37441850	JOACABA	49-35220418	MOGI DAS CRUZES	11-47941814	PALMAS	63-32175628
GRAVATAI	51-30422830	JOINVILLE	47-34331146	MOGI-MIRIM	19-38624401		
HORIZONTINA	55-35371680	LAGES	49-32244414	MOJI-GUACU	19-38181171		
IBIRAIARAS	54-33551359	LAGUNA	48-36443153	OLIMPIA	17-32805378		
IJUI	55-33327766	LAURO MULLER	48-4643202	OSASCO	11-36837343		
IMBE	51-36272704	MARAVILHA	49-36640052	OURINHOS	14-33225457		
LAJEADO	51-37145155	PINHALZINHO	49-36640052	PIRACICABA	19-34340454		
MARAU	54-33424571	PORTO UNIAO	49-33661014	PIRASSUNUNGA	19-35614091		
MONTENEGRO	51-36324187	RIO DO SUL	42-35232839	PORTO FERREIRA	19-35812441		
NONOAI	54-3621126	RIO NEGRINHO	47-35211920	PORTO FERREIRA	19-35851891		
NOVA PRATA	54-32421328	SAO MIGUEL D'OESTE	47-36440979	PRES PRUDENTE	18-32225168		
NOVO HAMBURGO	51-35823191	TUBARAO	49-36220026	PROMISSAO	14-35411696		
OSORIO	51-36632524	TUBARAO	48-36261651	REGISTRO	13-38212324		
PASSO FUNDO	54-33111104	VIDEIRA	48-36224448	RIBEIRAO PRETO	16-36368156		
PELOTAS	53-32223633	XANXERE	49-35660376	RIBEIRAO PRETO	16-36107553		
			49-34333026	RIO CLARO	19-35348543		
				ROSANA	18-32881469		

CERTIFICADO DE GARANTIA NO BRASIL

Este aparelho é garantido pela Philips da Amazônia Indústria Eletrônica Ltda., por um período superior ao estabelecido por lei. Porém, para que a garantia tenha validade, é imprescindível que, além deste certificado, seja apresentada a nota fiscal de compra do produto.

A Philips da Amazônia Indústria Eletrônica Ltda., assegura ao proprietário consumidor deste aparelho as seguintes garantias, a partir da data de entrega do produto, conforme expresso na nota fiscal de compra, que passa a fazer parte deste certificado:

Garantia para rádios e reprodutores de CD portáteis

(sem caixa acústica destacável): 180 dias

Garantia para os demais produtos da marca Philips: 365 dias.

Esta garantia perderá sua validade se:

- O defeito apresentado for ocasionado pelo uso indevido ou em desacordo com o seu manual de instruções.
- O produto for alterado, violado ou consertado por pessoa não autorizada pela Philips.
- O produto for ligado a fonte de energia (rede elétrica, pilhas, bateria, etc.) de características diferentes das recomendadas no manual de instruções e/ou no produto.
- O número de série que identifica o produto estiver de alguma forma adulterado ou rasurado.

Estão excluídos desta garantia defeitos decorrentes do descumprimento do manual de instruções do produto, de casos fortuitos ou de força maior, bem como aqueles causados por agentes da natureza e acidentes. Excluem-se igualmente desta garantia defeitos decorrentes do uso dos produtos em serviços não doméstico/residencial regular ou em desacordo com o uso recomendado.

ESTÃO EXCLUÍDAS DA GARANTIA ADICIONAL AS PILHAS OU BATERIAS FORNECIDAS JUNTO COM O CONTROLE REMOTO.

Nos municípios onde não exista oficina autorizada de serviço Philips, as despesas de transporte do aparelho e/ou do técnico autorizado, correm por conta do Sr. Consumidor requerente do serviço. A garantia não será válida se o produto necessitar de modificações ou adaptações para habilitá-lo a operar em qualquer outro país que não aquele para o qual foi designado, fabricado, aprovado e/ou autorizado, ou ter sofrido qualquer dano decorrente deste tipo de modificação.

Philips da Amazônia Indústria Eletrônica Ltda.

Dentro do Brasil, para informações adicionais sobre o produto ou para eventual necessidade de utilização da rede de oficinas autorizadas, ligue para o Centro de Informações ao Consumidor (CIC). Em São Paulo - Capital e demais localidades com DDD 011 - tel. 2121-0203, nas demais localidades e estados - tel. 0800 701 02 03 (discagem direta gratuita), ou escreva para Caixa Postal: n 21.315 - CEP04602-970 - São Paulo - SP, ou envie um e-mail para: cic@philips.com.br
Horário de atendimento: de segunda à sexta-feira, das 08:00 às 20:00h; aos sábados das 08:00 às 13:00h



*Para atendimento fora do Brasil, contate a Philips local ou a:
Philips Consumer Service Beukenlaan 2 - 5651 CD Eindhoven
The Netherlands*

