



© 2011 Koninklijke Philips Electronics N.V.
All rights reserved.

Specifications are subject to change without notice.
Trademarks are the property of Koninklijke Philips
Electronics N.V. or their respective owners.

DCB242_79_QSG_V1.0



Register your product and get support at
www.philips.com/welcome



Docking Entertainment System
DCB242

- 1** Connect
- 2** Install
- 3** Enjoy

What's in the box

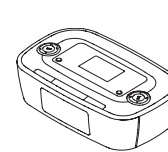

Main unit



Remote control



MP3 link cable



Power adaptor

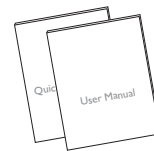

User Manual
Quick Start Guide

1 Connect

A Connect power

- 1** Connect the AC power adaptor to:
 - the DC socket on the main unit
 - the power socket.

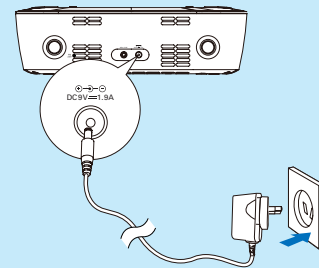

PHILIPS

2 Setup

A Set time and date

- 1 In standby mode, press and hold **SET TIME/AUTO SCAN** for 2 seconds.
↳ **[SYNC ON]** is displayed and **[ON]** begins to blink.
- 2 Press **PRESET + ▲/PRESET - ▼** to select ON or OFF.
↳ If you select **[ON]**, the unit reads the DAB+ or iPod/iPhone time and sets the clock automatically.
↳ If you select **[OFF]**, the unit turns off the time synchronization.
- 3 Press **SET TIME/AUTO SCAN** to confirm. The time format [24H] or [12H] begins to blink.
- 4 Press **PRESET + ▲/PRESET - ▼** to select 24H or 12H.
- 5 Press **SET TIME/AUTO SCAN** to confirm. The hour digits begin to blink.
- 6 Repeat steps 4-5 to set the hour, minute, year, month, and day.

B Set the alarm timer

You can set two alarms which go off at different time.

- 1 Ensure that you have set the clock correctly.
↳ The [AL1] or [AL2] icon and the hour digits begin to blink.
- 2 Press and hold **AL1** or **AL2** for 2 seconds.
↳ The [AL1] or [AL2] icon and the hour digits begin to blink.
- 3 Press **TUNING - ◀/TUNING + ▶** to set the hour.
- 4 Press **AL1** or **AL2** to confirm.
↳ The [AL1] or [AL2] icon and the minute digits begin to blink.
- 5 Repeat steps 3-4 to set the minute.
- 6 Repeat steps 3-4 to select whether to ring alarm the whole week, on weekdays, or at weekend.
- 7 Repeat steps 3-4 to select an alarm sound source: Buzzer, iPhone, FM, or DAB+.
- 8 Repeat steps 3-4 to set the alarm volume.

2 Setup

C Turn on/off the alarm timer

- 1 Press **AL1/AL2** to turn on or off the alarm timer.
↳ If the alarm timer is turned on, the alarm icon appears.
↳ If the alarm timer is turned off, the alarm icon disappears.

D Repeat alarm

- 1 When the alarm rings, press **REP AL/BRIGHTNESS**.
↳ The alarm repeats ringing minutes later.

E View the alarm settings

- 1 Press **AL1** or **AL2**.

3 Enjoy

A Play from iPod/iPhone

- 1 Lift up the iPod/iPhone dock cover on the top panel.

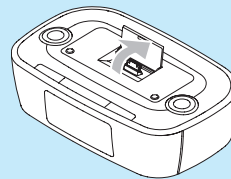

- 2 Place the iPod/iPhone into the dock.

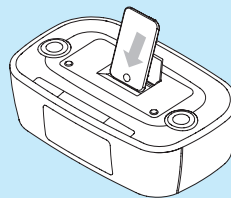

3 Enjoy

- 3 Press **iPod/iPhone** on the remote control to select iPod/iPhone source.

- ↳ The connected iPod/iPhone plays automatically.
- To pause/resume play, press **OK/▶||**
- To skip to a track, press **TUNING - ◀/TUNING + ▶** on the remote control.
- To search during play, press and hold **TUNING - ◀/TUNING + ▶**, then release to resume normal play.
- To go back to the previous iPod/iPhone menu, press **MENU**. To scroll through the menu, press **PRESET + ▲/PRESET - ▼**. To confirm a selection, press **OK/▶||**.
- ↳ If no key is pressed for more than 10 seconds, **OK/▶||** acts back as the play/pause key.

B Program and listen to radio stations

- 1 In the tuner mode, press and hold **SET TIME/AUTO SCAN** for more than 2 seconds to activate automatic program mode.
↳ The unit starts to search for radio stations.
↳ All available stations are programmed in the order of waveband reception strength.
↳ The first programmed radio station is broadcast automatically.
- 2 Press **PRESET + ▲/PRESET - ▼** to select a preset number.

* Tip

- Detailed functions and features are described in the user manual.