

English

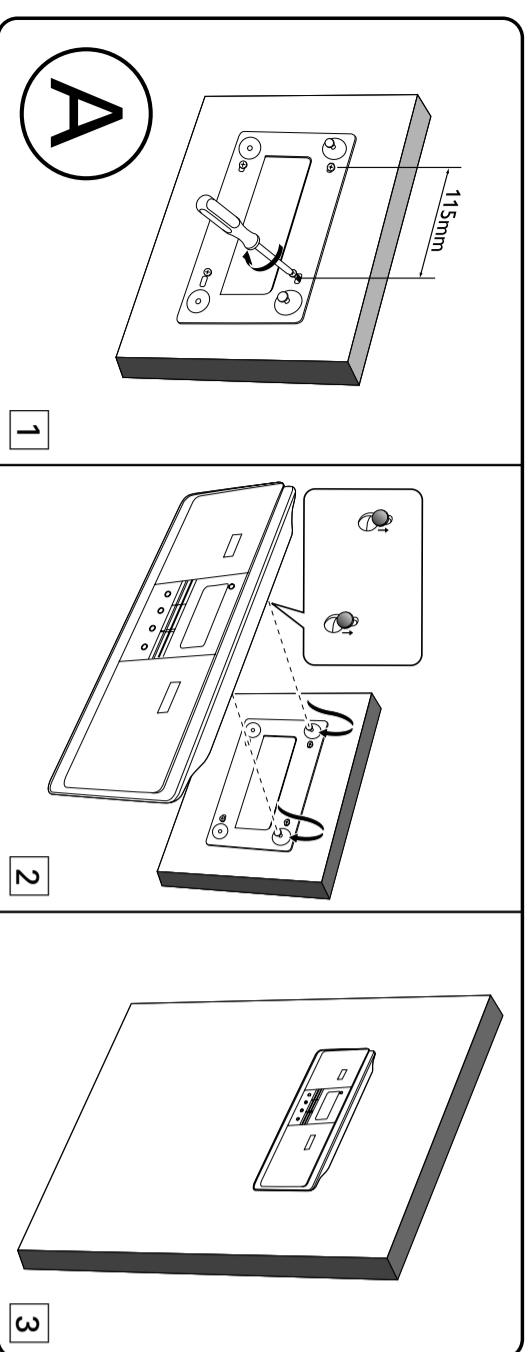

How to mount your system onto wall
The wall mounting instructions are only for use by qualified wall mounting personnel.

Ask a qualified person to help you with the wall mounting, which includes drilling holes on the wall and mounting the set onto wall.

What else you'll need?

Drilling tools (e.g. an electrical drill).

Find a suitable location for mounting and complete the necessary rear connections.

The person for wall mounting should:

- learn about the piping, wiring and other relevant information inside your wall, to avoid unexpected damage;
- choose suitable drilling tools according to the drilling requirements;
- take other precautions necessary for the wall mounting work.

A Mounting your main unit onto wall

IMPORTANT!
– Leave adequate space on both sides of the main unit to facilitate disc door opening!

- 1 Find an appropriate location on the wall and use the wall mounting bracket for the main unit as a template to drill four 6mm-diameter holes.
- 2 Secure four longer screws (supplied) in the holes.
- 3 Hook the main unit onto the bracket.

B Mounting your speakers onto wall

- 1 Detach the stand from any speaker. Place the detached screws aside for step 3.
- 2 Drill two 6mm-diameter holes at the chosen locations on the wall, with 46mm between them.
- 3 Secure the screws (obtained from step 1) in the holes respectively, leaving the screws 5mm proud of the wall.
- 4 Install the bracket on the speaker with the supplied shorter screws as shown.

- 5 Hook and mount the speaker in place.
Repeat the steps above to mount the other speaker.

C Install the DIN cable and cabling channel (optional) onto wall

- 1 Fix the bottom half of the DIN cable on the wall with screws as shown.
- 2 Guide the DIN cable between the main set and the subwoofer into the cabling channel.
- 3 Fit the upper half of the cabling channel on the bottom piece as shown.

中文(简体)

如何将系统安装在墙壁上
壁挂安装指示仅供合格的壁挂安装人员使用。
要求合格的人员协助您进行壁挂安装，包括在墙上钻孔以及将装置架设在墙上。
您还需要什么？
钻孔工具 (例如电钻)。

找到合适的架设位置并完成所需的后方连接工作 (请参与“安装”)。

要进行壁挂安装的人员应该要：

- 了解您墙壁内部的管线以及其他相关信息，以避免造成未预期的伤害；
- 根据钻孔需求选择适当的钻孔工具；
- 在进行壁挂安装作业前，采取其他必要的预防措施。

A 将主机安装在墙壁上

重要

– 在主机两边预留足够的空间，以便CD前盖板开启！

- 1 在墙上合适的位置上使用主机壁挂安装支架作为模板钻出四个直径 6 毫米的孔。
- 2 将随附的尺寸稍长的螺丝分别牢固地锁入孔中。
- 3 将主机挂在支架上。

B 将喇叭安装在墙壁上

- 1 从任一喇叭上卸下底座。将卸下的螺丝放在一旁以备第3步时使用。
- 2 将木钉与螺丝分别牢固地锁入孔中，让螺丝距离墙面 5 毫米远。
- 3 将进行第 1 步时获取的螺丝分别牢固地锁入孔中，让螺丝距离墙面 5 毫米远。
- 4 利用随附的尺寸稍短的螺丝安装喇叭上的托架，如图所示。

重复上述步骤以安装其他喇叭。

C 在墙壁上安装DIN缆线以及缆线通道 (选购)

- 1 利用螺丝将DIN缆线的下半部固定在墙上，如图所示。
- 2 将DIN缆线从主机与重低音喇叭间穿过进入缆线通道。
- 3 将底座缆线通道的上半部如图所示安装。



© Royal Philips Electronics N.V. 2007

All rights reserved.

<http://www.philips.com>

