

PhotoFrame



8FF3CDW

8FF3CME

10FF3CDW

10FF3CME

10FF3CMI

Quick start guide

1 Connect

2 Setup

3 Enjoy

What's in the box

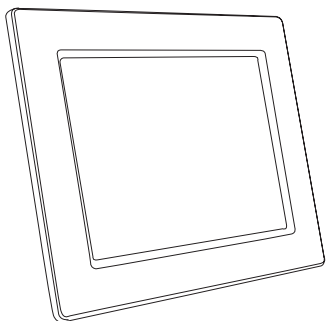

Photoframe

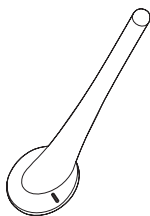

Stand

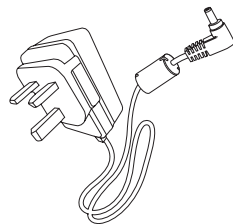

AC-DC Mains adaptor

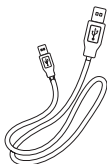

USB cable to PC



Quick Start Guide

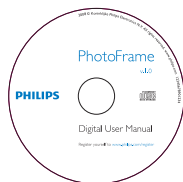

Digital User Manual
Philips PhotoFrame Manager
software and user manual

What you also need

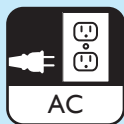

AC Mains

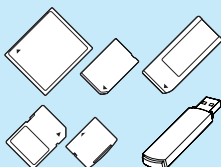

Memory card/USB

or

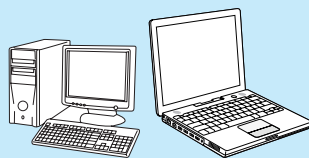

PC

1

Connect

A Install the stand

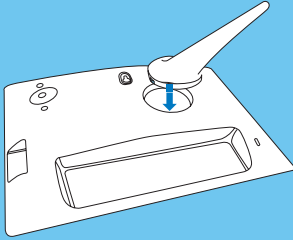

Step 1 Insert the stand into the PhotoFrame.

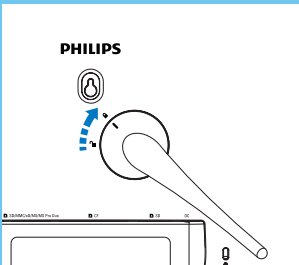

Step 2 Turn the stand clockwise 45 degrees to attach it to the PhotoFrame.

C Insert a storage device

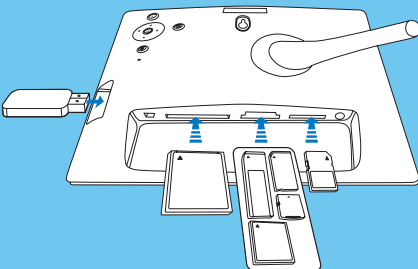

B Connect the Mains

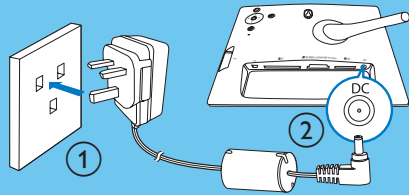

Step 1 Connect the Mains plug to the PhotoFrame.

Step 2 Connect the Mains cord to a power supply socket.

Insert a memory card or a USB flash drive.

- Compact Flash type I
- Secure Digital (SD)
- Secure Digital (SDHC)
- Multimedia Card
- xD card
- Memory Stick
- Memory Stick Pro
- Memory Stick Duo
- Memory Stick Pro Duo
- USB flash drive

2

Setup

A Turn on the PhotoFrame

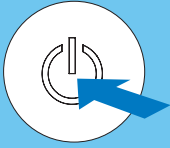

Press and hold  for more than 1 second.
↳ The PhotoFrame starts to display all the valid images in slideshow mode.

B Access the main menu



In slideshow mode, press  to access the main menu.

C Select on-screen language





- Step 1** In the main menu, select **[Setup]** > **[Options]** > **[Language]**, then press **OK** to confirm.
- Step 2** Select **[Language Setting]** and press **OK** to confirm.
- Step 3** Select a language and press **OK** to confirm.

3

Enjoy

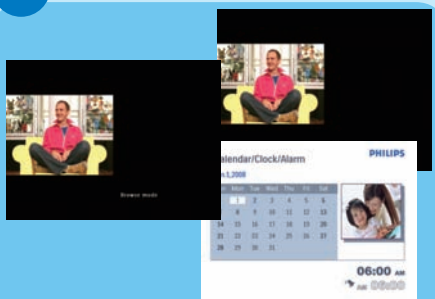
A Select display mode



In slideshow mode, press  to toggle between Slideshow mode, Browse mode and Calendar mode.

B Display collage photos



Step 1 In the main menu, select **[Slideshow]** > **[Collage]** > **[Multi]**, then press **OK** to confirm.

Step 2 Select a format and press **OK** to confirm.

Step 3 Press **◀ (RIGHT)** to select **[Photo 1]**.

Step 4 Press **◀ (RIGHT)** again to select a photo source, then press **OK** to confirm.

Step 5 Select an album and press **OK** to confirm.

Step 6 Select a photo and press **OK** to confirm.

Step 7 Repeat steps 3 to 6 to select other photos.

Step 8 Press **OK** to confirm.

↳ If you select a collage layout, the PhotoFrame displays a static collage and the slideshow mode is deactivated.

↳ If you select **[Random]** format, the PhotoFrame automatically does the random collage base on the optimal layout of photos and displays the collages in slideshow mode.



Step 9 To stop Collage display, select **[Slideshow]** > **[Collage]** > **[Single]** and press **OK** to confirm.

3

Enjoy

C Zoom and crop pictures



- Step 1** In the main menu, select **[Photos]** > **[Source]** > **[PhotoFrame]**, then press **OK** to confirm.
- Step 2** Select an album and press **OK** to confirm.
- Step 3** Select a photo and press **OK** to confirm.
- Step 4** Press  to access **[Photo Menu]**.
- Step 5** Select **[Zoom and Crop]** and press **OK** to confirm.
- Step 6** Press  /  repeatedly to zoom in/out the photo.
• Press **▲** / **▼** / **◀** / **▶** to crop the photo.
- Step 7** Press **OK** to confirm.
- Step 8** Select **[Yes]** and press **OK** to confirm.

3

Enjoy

D

Set the display auto on/off by lighting



Tip

If the **[On - Set current]** brightness level is too close with the **[Off - Set current]** brightness level, the display Auto on/off function may not work.

You can use the default brightness of ambient lighting condition and you can also set the brightness of ambient lighting condition.

Step 1 In the main menu, select **[Setup]** > **[Options]** > **[Smart power]** > **[Lighting]**, then press **OK** to confirm.

Step 2 Select **[Settings]** and press **OK** to confirm.

- To use the default setting, select **[Default]** and press **OK** to confirm.

Step 3 Select **[On - Set current]** and press **OK** to confirm.

- ↳ The PhotoFrame wakes up when the brightness of environment reaches the **[On - Set current]** brightness.
- To have the PhotoFrame sleep at the set brightness of ambient lighting condition, select **[Off - Set current]**.

3

Enjoy

E Set display auto on/off by time

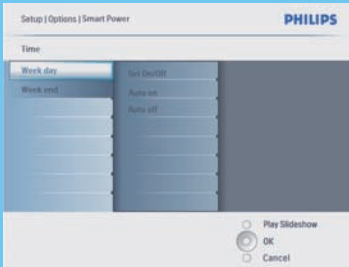

Step 1 In the main menu, select **[Setup]** > **[Smart power]**, then press **OK** to confirm.

Step 2 Select **[Time]** and press **OK** to confirm.

Step 3 Select **[Weekday]** and press **OK** to confirm. To enable the Smart Sleep function at weekends, select **[Weekend]**.

Step 4 Select **[Auto on]/[Auto off]** and press **OK** to confirm. To cancel **[Auto on]/[Auto off]**, select **[Set On/Off]** > **[Off]**.

Step 5 Press **▲/▼/◀/▶** and **OK** to set the time for auto-on function.

F Set Radiant Color

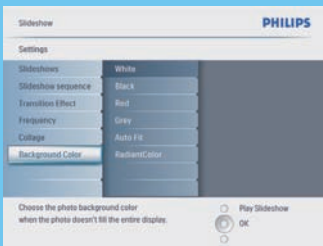

Step 1 In the main menu, select **[Slideshow]** > **[Settings]** > **[Background Color]** then press **OK** to confirm.

Step 2 Select **[RadiantColor]** and press **OK** to confirm.

- If you select **[RadiantColor]**, the PhotoFrame extends the colour on the edges of a photo that is smaller than the full screen to fill the screen without black bars or aspect ratio distortion.

3

Enjoy

G

Set an event reminder

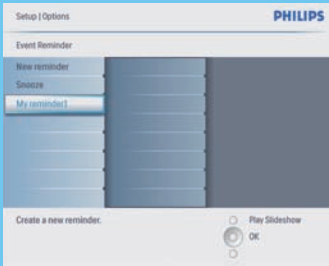

Step 1 In the main menu, select **[Setup]** > **[Options]**>**[Event reminder]** > **[New reminder]**, then press **OK** to confirm.

Step 2 Select an alphabet and press **OK** to confirm.

Step 3 When the album name (up to 24 characters) is complete, select **[Enter]** and press **OK** to confirm.

Step 4 Select the reminder and press **OK** to confirm.

Step 5 Select **[Time]** and press **OK** to confirm.

Step 6 Press **▲ / ▼ / ◀ / ▶** and **OK** to set up time, and press **OK** to confirm.

Step 7 Repeat steps 5 to 6 to set date.

H

Create an album

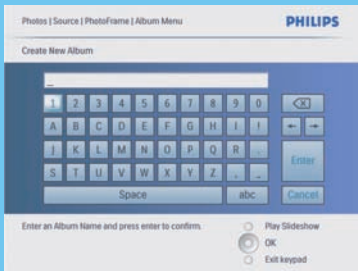

Step 1 In the main menu, select **[Photos]** > **[Source]** > a storage device, then press **OK** to confirm.

Step 2 Select **[New Album]** and press **OK** to confirm.

Step 3 Select an alphabet/number and press **OK** to confirm.

Step 4 When the album name (up to 24 characters) is complete, select **[Enter]** and press **OK** to confirm.

3

Enjoy

1

Set Auto Orientation function

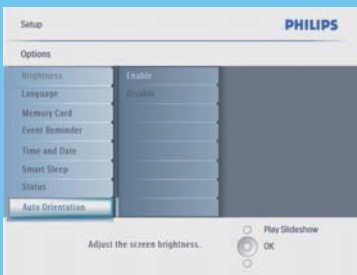

Step 1 In the main menu, select **[Setup]** > **[Options]**> **[Auto Orientation]**, then press **OK** to confirm.

Step 2 Select **[Enable]** and press **OK** to confirm.

Troubleshooting

Problem

My Digital PhotoFrame does not go into Auto-off status after I set it.

My Digital PhotoFrame is ON but the system does not respond anymore!

My Digital PhotoFrame does not show some of my photos.

Why the photos distort?

What is the difference between background, Auto fit and RadiantColor?

Tip

Ensure that you set current time, **Auto off** and **Auto on** correctly.

- Ensure that the PhotoFrame is properly powered.
- Use a pin to trigger the **RESET** button located on the back to restore the PhotoFrame.

- The PhotoFrame shows photos in JPEG format.

If the format of picture is different as the PhotoFrame (for example, if you set "auto fit" on the PhotoFrame, a 4x3 photo input into a (16x9) PhotoFrame may distort. You can set a background colour or set RadiantColor. A background colour keeps the correct aspect ratio but may have black bar (or the background colour you select). We recommend you to select RadiantColor to keep the correct aspect ratio with the exterior of photo colour. RadiantColor does give you the best viewing experience. Users can go to: Main menu>Slideshow>Background>RadiantColor/Auto fit/black/red/gray.

If the picture format is different as the PhotoFrame, the PhotoFrame provides several solutions for it.

1. Auto fit: it is just like wide screen TV, the PhotoFrame extends the photo to fill fully the screen with picture distortion.
2. Background colour: the PhotoFrame displays a photo without distortion but with black bar or a selected background colour.
3. RadiantColor: the PhotoFrame displays a photo without distortion with RadiantColor. RadiantColor is a new technology that the system analyses the colour of picture edge and extend the colour to fill the screen. This does improve the viewing experience. Users can go to: Main menu>Slideshow>Background>RadiantColor/Auto fit/black/red/gray.

Welcome to Philips!

Register your product and get support at
www.philips.com/welcome



© Royal Philips Electronics N.V. 2008
All rights reserved.

Specifications are subject to change without notice.
Trademarks are the property of Koninklijke Philips
Electronics N.V. or their respective owners.